

30.Rear Gate Garnish

A: REMOVAL

- 1) Disconnect the ground cable from battery.
- 2) Remove the rear gate trim.
 - (1) Remove the rear gate upper trim.
 - a) Remove the claws on the trim edge.
 - b) Disconnect the claws in the center of trim, and remove the rear gate upper trim.

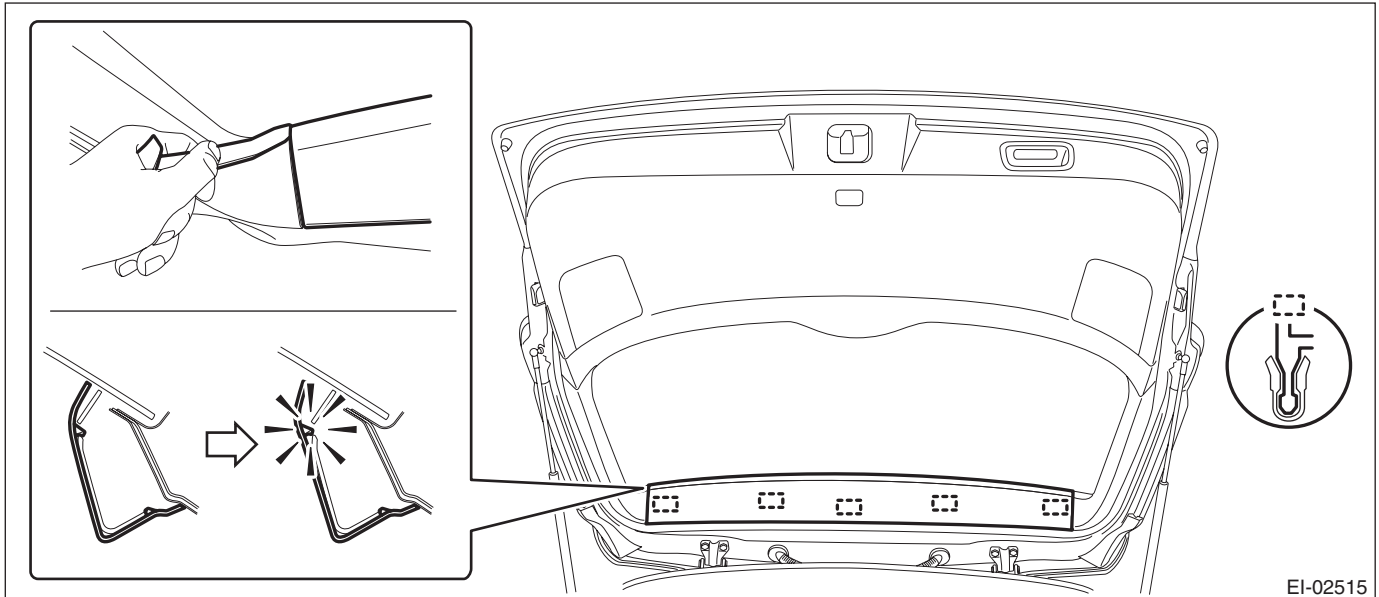

- (2) Remove the rear gate pillar trim.
 - a) Release the claws.
 - b) Remove the claws on the bottom of trim, and remove the rear gate pillar trim.

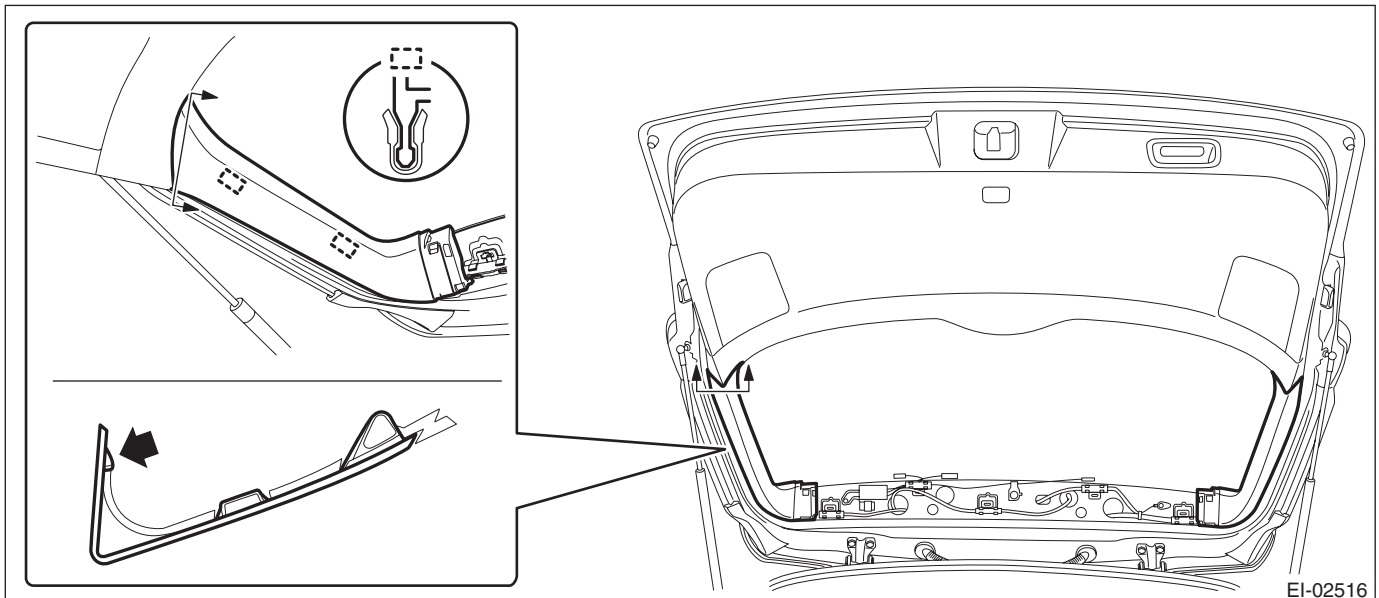

Rear Gate Garnish

EXTERIOR/INTERIOR TRIM

(3) Remove the hand grip of rear gate.

CAUTION:

- Be careful not to scratch the trim.
- To protect the trim from damage, attach a protective tape to the tool in use.
 - a) Insert a precision screwdriver (a).
 - b) With the screwdriver inserted, move the precision screwdriver toward the claw and open the cap.
 - c) Remove the screws and detach the hand grip.

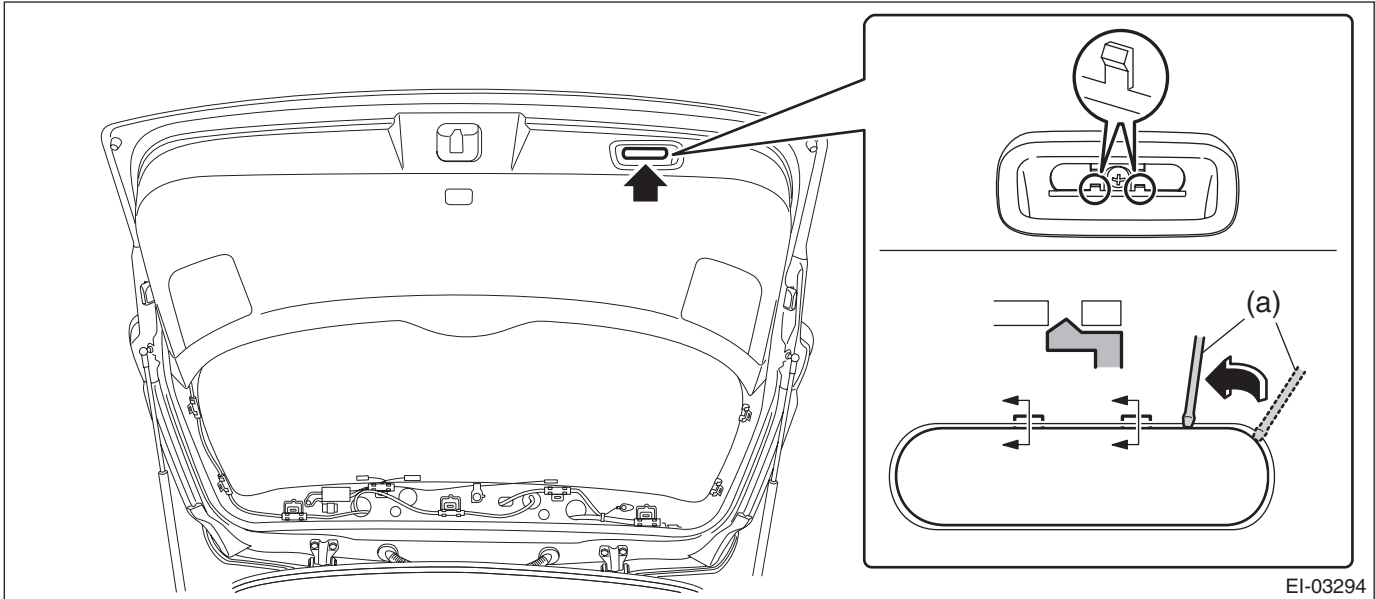

(4) Remove the rear gate lower trim.

- a) Remove the clips on both ends.
- b) Release the clips and remove the rear gate lower trim.

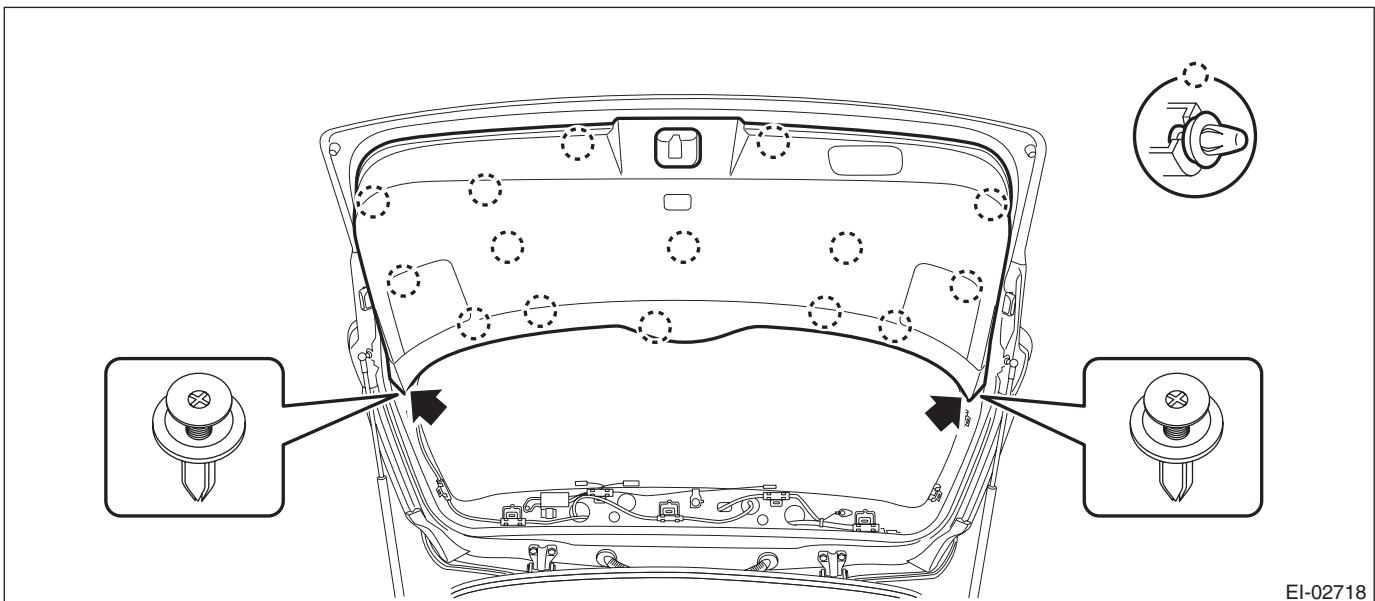

3) Remove the rear gate garnish.

(1) Release the clips and claws, then detach the rear finisher light side cover.

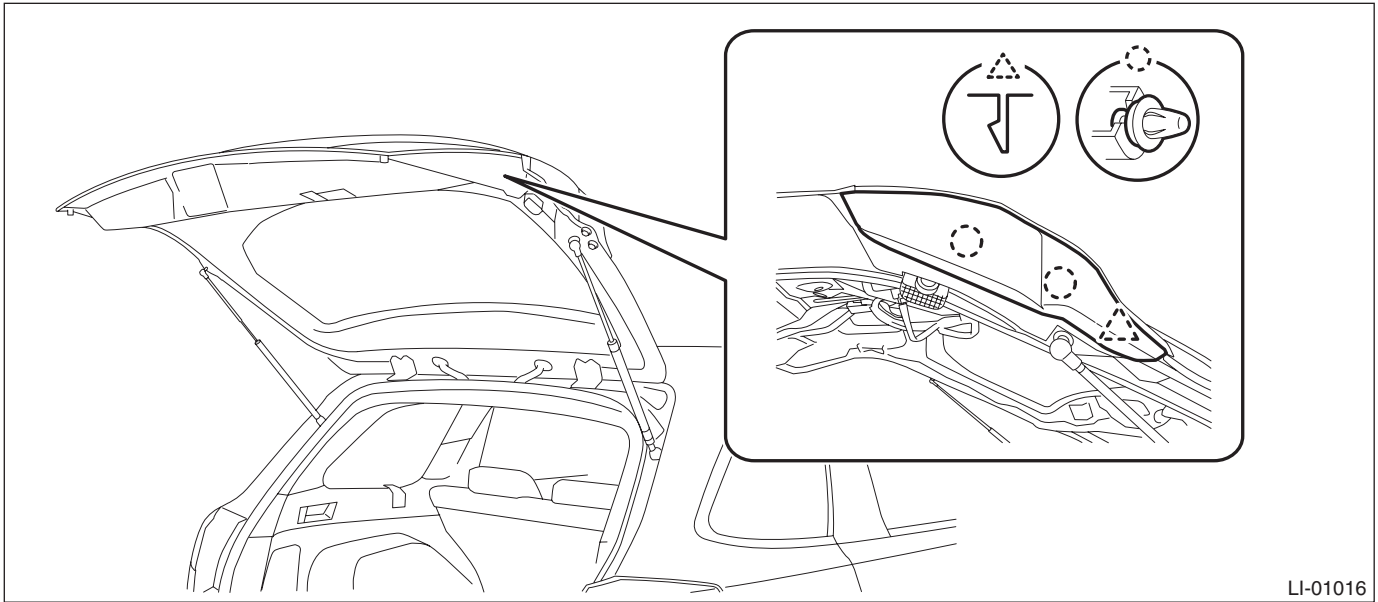

LI-01016

(2) Disconnect the harness connector of license plate light assembly.

(3) Remove the nuts.

(4) Remove the clips, and remove the rear gate garnish.

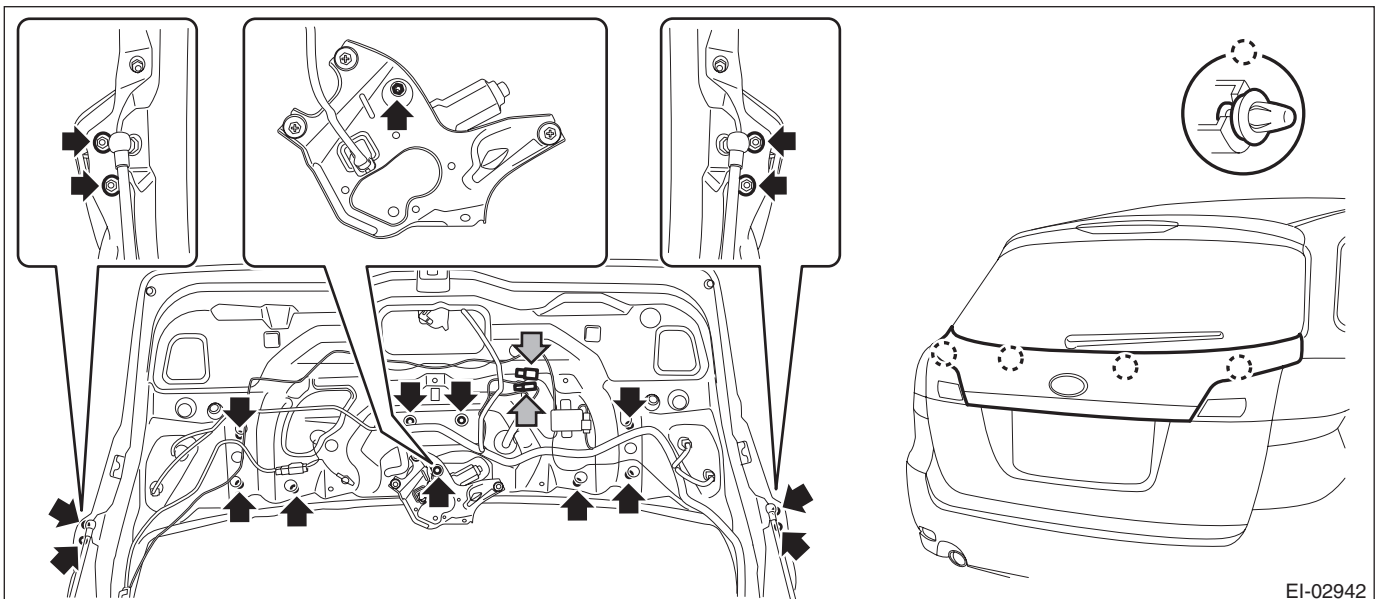

EI-02942

B: INSTALLATION

CAUTION:

Make sure that the harness grommet is installed securely.

Incomplete installation causes water leak.

Install each part in the reverse order of removal.

Tightening torque

Rear gate garnish: 4.5 N·m (0.46 kgf·m, 3.3 ft·lb)