

# Rear Window Glass

GLASS/WINDOWS/MIRRORS

## 14.Rear Window Glass

### A: REMOVAL

- 1) Disconnect the ground cable from battery.
- 2) Disconnect the rear defogger connector and radio antenna connector.
- 3) Remove the rear window glass in the same procedure as for windshield glass. <Ref. to GW-36, REMOVAL, Windshield Glass.>

### B: INSTALLATION

- 1) Fabricate the cartridge nozzle tip as shown and set the sealant gun with the adhesive.

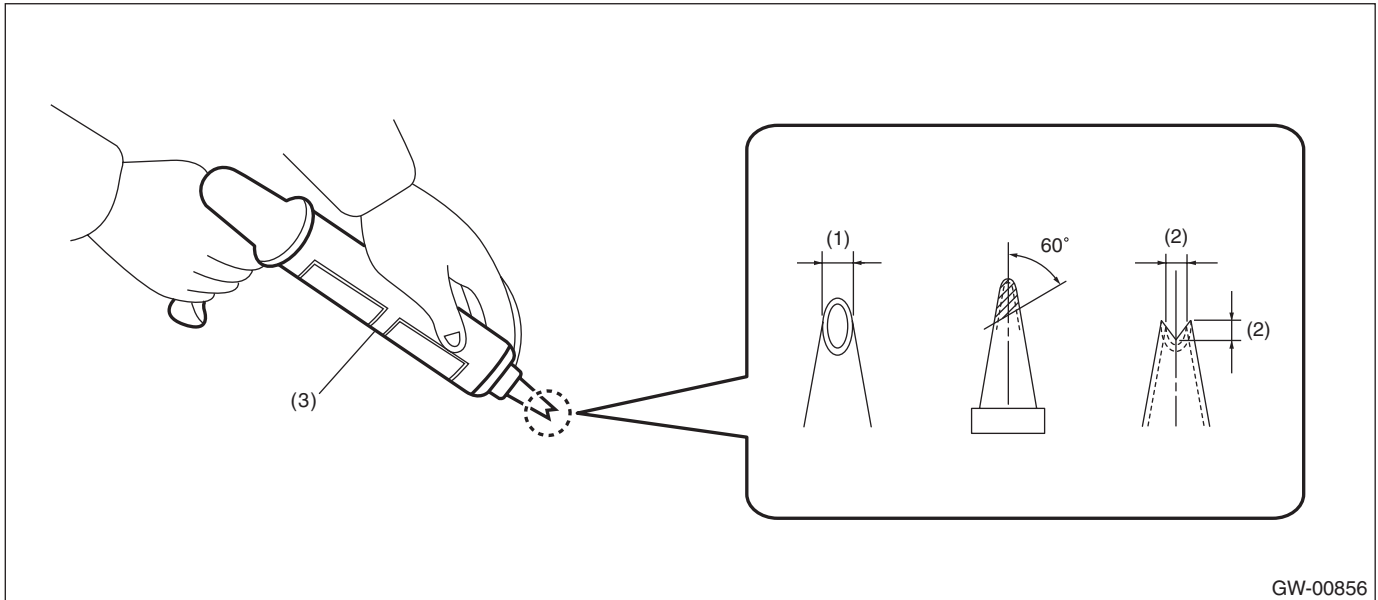

(1) 10 mm (0.39 in)

(2) 8 mm (0.31 in)

(3) Sealant gun

- 2) Prepare and clean the adhesion surfaces of the glass and body using the same procedures as for the windshield glass. <Ref. to GW-39, INSTALLATION, Windshield Glass.>

- 3) Attach the dam rubber to the glass.

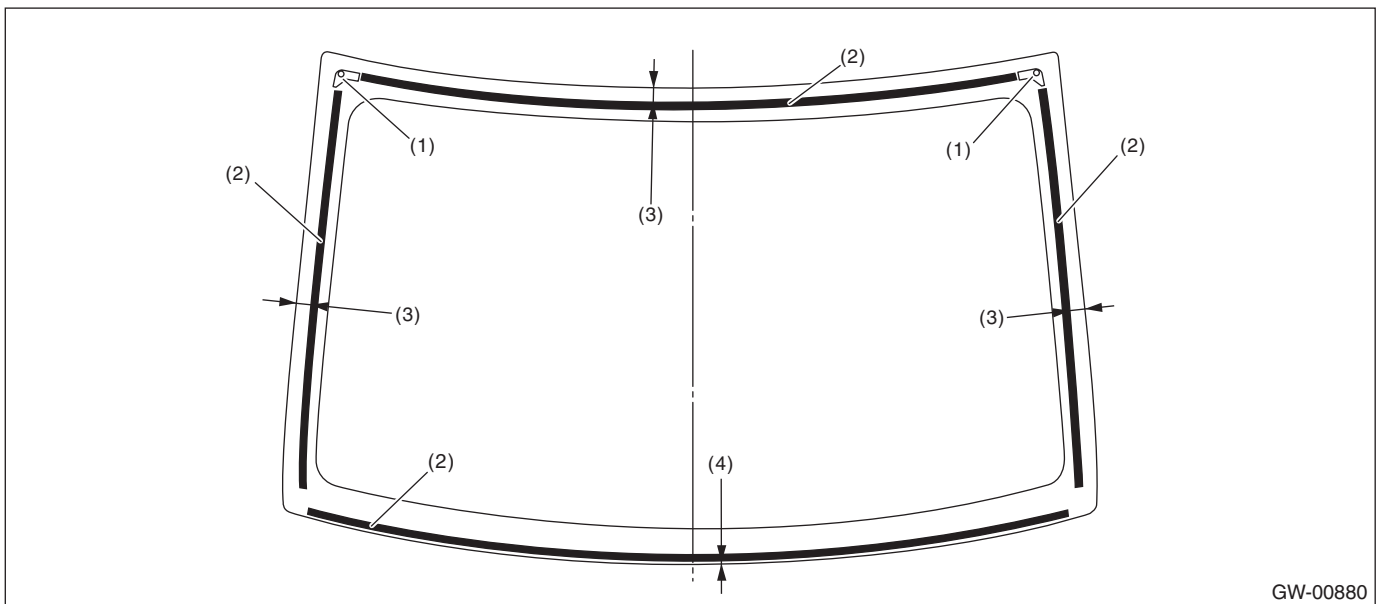

(1) Locating pin

(3) 16 mm (0.63 in)

(4) 1 mm (0.04 in)

(2) Dam rubber

4) Install the molding to the glass.

**CAUTION:**

Be careful to attach the molding so that the molding has no loose or undulating part.

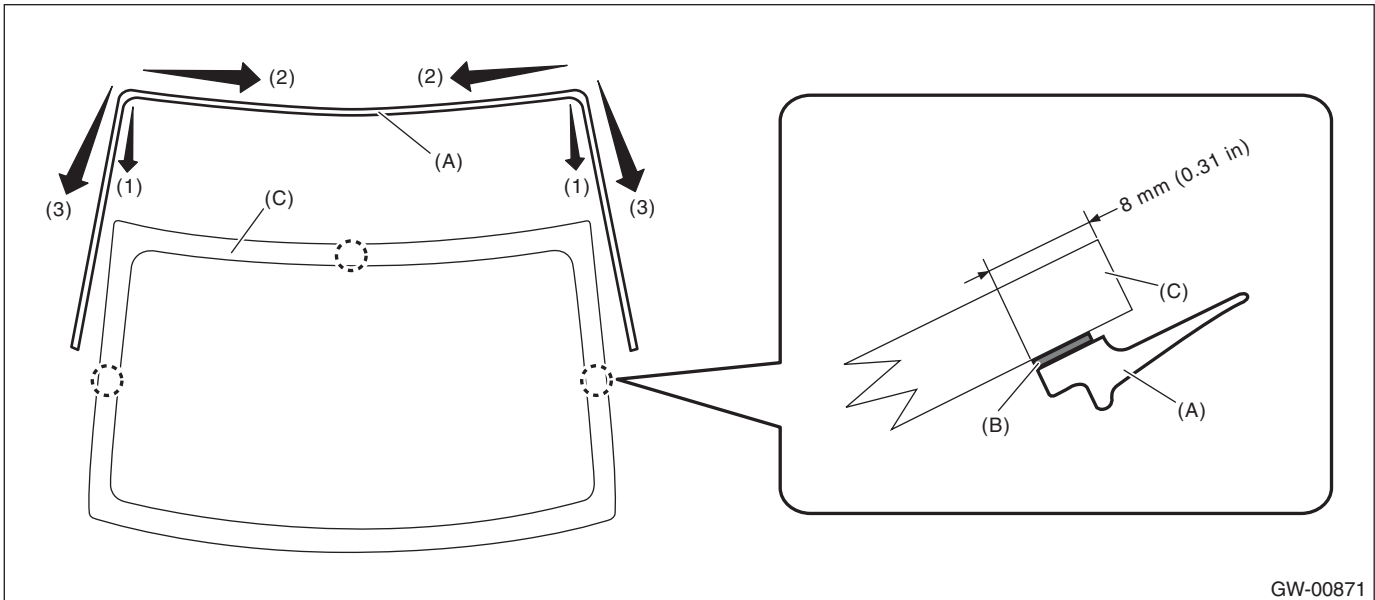

GW-00871

- (1) Align the molding (A) to the upper ends of the glass (C).
- (2) Install the molding from both corners of the upper edge toward the center.
- (3) Install the molding from both corners of the upper edge toward the lower side.
- (4) Firmly apply the double sided tape (B) of the molding evenly to the glass surface.

5) Install the rear glass in the same procedure as for windshield glass. <Ref. to GW-39, INSTALLATION, Windshield Glass.>

- (1) Apply the primer to the adhesive surface of glass side and body side using sponge.
- (2) Apply adhesive to the glass end back surface.

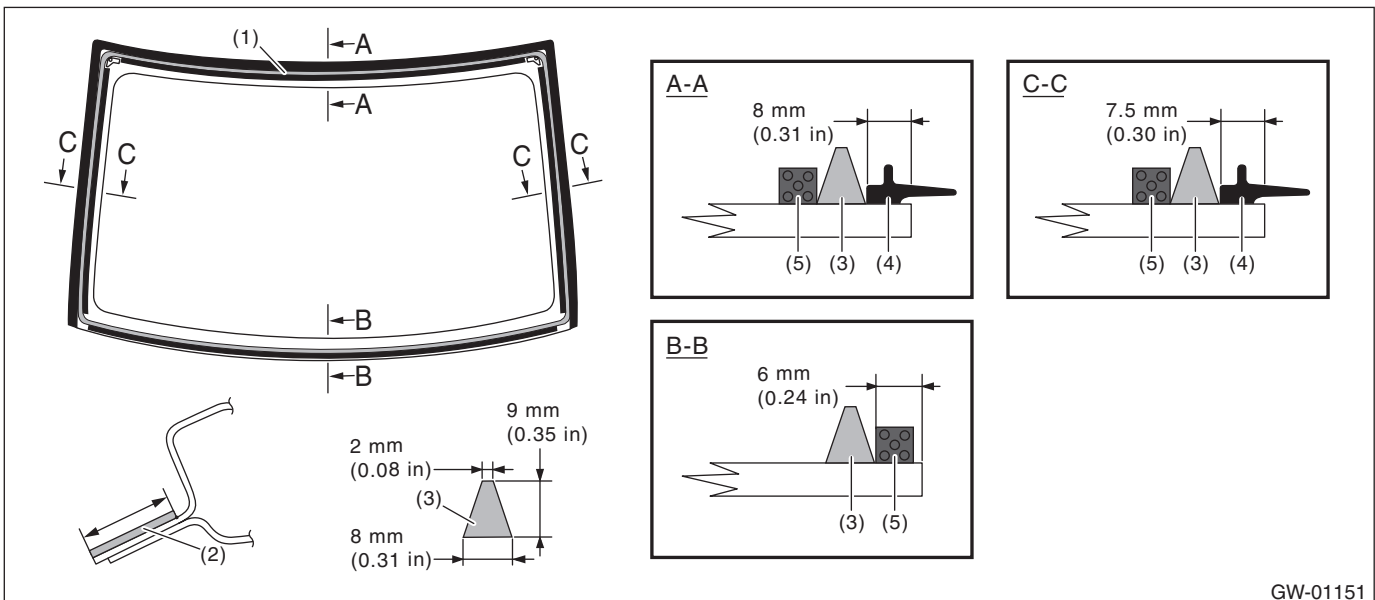

GW-01151

- |  |              |                |
|--|--------------|----------------|
| (1) Application of primer (glass side) | (3) Adhesive | (5) Dam rubber |
| (2) Application of primer (body side)  | (4) Molding  |                |

- (3) Insert the glass locating pins in the rear panel holes and install the rear glass.
- (4) Lightly press the entire perimeter of rear glass for tight fit.
- (5) Make flush the adhesive surface jugged out using spatula.

## Rear Window Glass

### GLASS/WINDOWS/MIRRORS

---

6) After completion of all work, allow the vehicle to stand for about 24 hours.

**NOTE:**

- When door is opened/closed after glass is bonded, always lower the door glass first, and then open/close it carefully.
- Move the vehicle slowly.
- For minimum drying time and vehicle standing time before driving after bonding, follow instructions or instruction manual from the adhesive manufacturer.

7) Connect the rear defogger connector and radio antenna connector.

8) Connect the battery ground terminal.

9) After curing of adhesive, pour the water on external surface of vehicle to check that there are no water leaks.

**NOTE:**

When a vehicle is returned to the user, tell him or her that the vehicle should not be subjected to heavy impact for at least three days.