

7. Turn Signal Light and Hazard Light System

A: WIRING DIAGRAM

Refer to “Turn Signal Light and Hazard Light System” in the wiring diagram. <Ref. to WI-296, WIRING DIAGRAM, Turn Signal Light and Hazard Light System.>

B: INSPECTION

1. CHECK TURN SIGNAL SWITCH

Measure the resistance between turn signal switch terminals. <Ref. to LI-23, INSPECTION, Combination Switch (Light).>

2. CHECK HAZARD SWITCH

- 1) Remove the A/C control panel.
 - Manual A/C model: <Ref. to AC-49, MANUAL A/C MODEL, REMOVAL, Control Panel.>
 - Auto A/C model: <Ref. to AC-46, AUTO A/C MODEL, REMOVAL, Control Panel.>
- 2) Measure the resistance between hazard switch terminals.

Preparation tool:

Circuit tester

- Auto A/C model

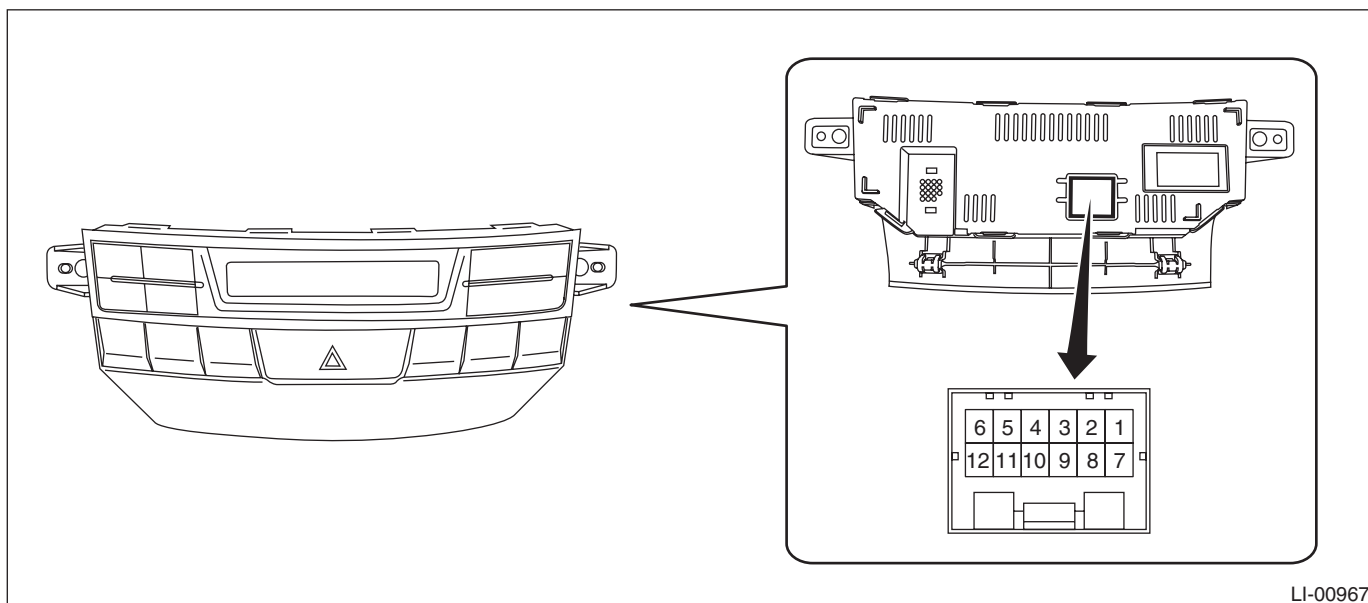

Terminal No.	Inspection conditions	Standard
1 — 2	Switch OFF	1 MΩ or more
	Switch ON	Less than 1 Ω

Turn Signal Light and Hazard Light System

LIGHTING SYSTEM

- Manual A/C model

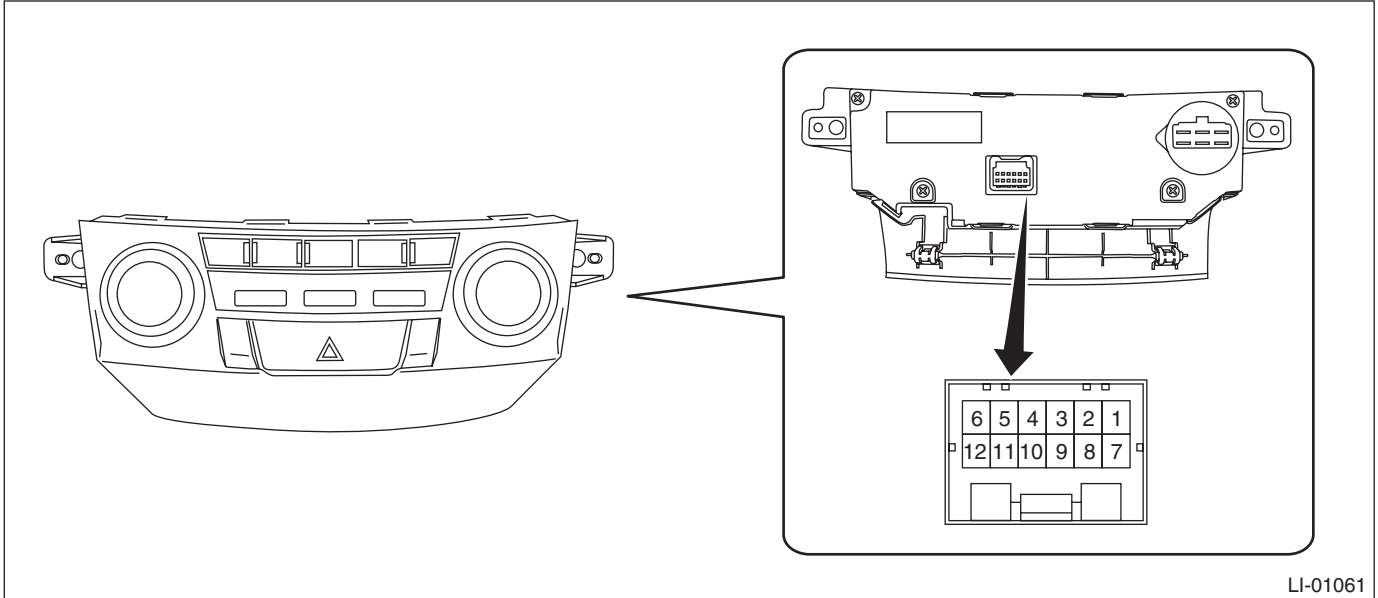

Terminal No.	Inspection conditions	Standard
4 — 5	Switch OFF	1 M Ω or more
	Switch ON	Less than 1 Ω

3) Replace the A/C control panel if the inspection result is not within the standard value.

3. CHECK TURN SIGNAL AND HAZARD MODULE

1) Measure the voltage between turn signal & hazard module connector and chassis ground.

Preparation tool:

Circuit tester

Connector

Terminal No.	Input/Output	Inspection conditions	Standard
6 \longleftrightarrow Chassis ground	Input	Turn signal switch (Right) OFF \rightarrow ON	9 V or more \rightarrow less than 1 V
5 \longleftrightarrow Chassis ground	Input	Turn signal switch (Left) OFF \rightarrow ON	9 V or more \rightarrow less than 1 V
8 \longleftrightarrow Chassis ground	Input	Hazard switch OFF \rightarrow ON	9 V or more \rightarrow less than 1 V
2 \longleftrightarrow Chassis ground	Output	Turn signal switch (Right) OFF \rightarrow ON	Repeat less than 1 V \rightarrow less than 1 V \longleftrightarrow more than 9 V at 60 to 120 times per minute.
3 \longleftrightarrow Chassis ground	Output	Turn signal switch (Left) OFF \rightarrow ON	Repeat less than 1 V \rightarrow less than 1 V \longleftrightarrow more than 9 V at 60 to 120 times per minute.
2 \longleftrightarrow Chassis ground	Output	Hazard switch OFF \rightarrow ON	Repeat less than 1 V \rightarrow less than 1 V \longleftrightarrow more than 9 V at 60 to 120 times per minute.
3 \longleftrightarrow Chassis ground	Output	Hazard switch OFF \rightarrow ON	Repeat less than 1 V \rightarrow less than 1 V \longleftrightarrow more than 9 V at 60 to 120 times per minute.

2) Replace the turn signal and hazard module if the inspection result is not within the standard value.

C: NOTE

For operation procedures of each component of the turn signal and hazard light system, refer to the respective sections.

- Combination switch (light): <Ref. to LI-19, Combination Switch (Light).>
- Front turn signal light bulb: <Ref. to LI-36, Front Turn Signal Light Bulb.>
- Side turn signal light assembly: <Ref. to LI-47, Side Turn Signal Light Assembly.>
- Rear combination light assembly: <Ref. to LI-48, Rear Combination Light Assembly.>
- Rear turn signal light bulb: <Ref. to LI-54, Rear Turn Signal Light Bulb.>