

28. Access Key

A: REMOVAL

NOTE:

Refer to keyless transmitter for models without keyless access. <Ref. to SL-81, KEYLESS TRANSMITTER BATTERY, REMOVAL, Keyless Transmitter.>

1. ACCESS KEY BATTERY

CAUTION:

To prevent static electricity damage to the access key printed circuit board, touch the steel area of building with hand to discharge static electricity carried on body or clothes before disassembling the access key.

- 1) Remove the mechanical key from the access key.
- 2) Insert a flat tip screwdriver into the slot indicated by (A) after the mechanical key is removed to open the case.

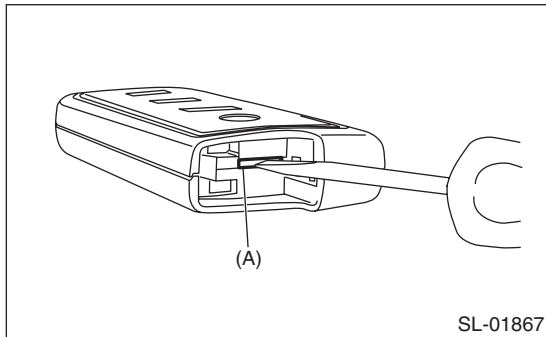

- 3) Being careful not to touch the access key printed circuit, remove the printed circuit board (A).

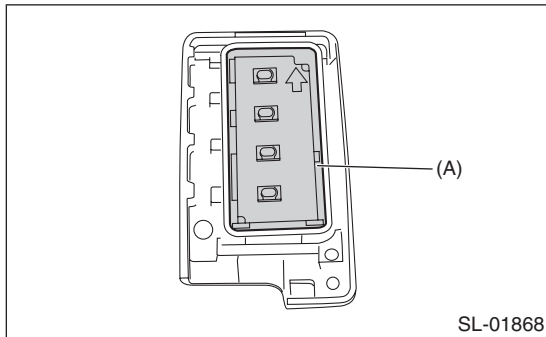

- 4) Insert a flat tip screwdriver along the side of the access key battery to remove the battery.

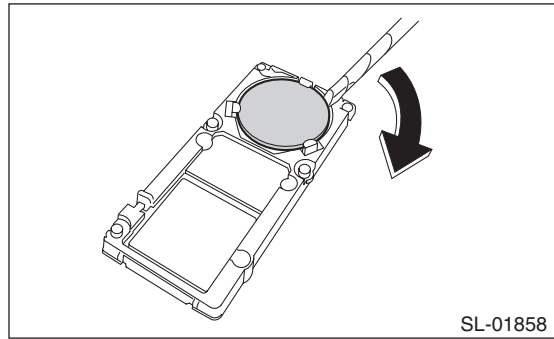

B: INSTALLATION

1. ACCESS KEY BATTERY

Install each part in the reverse order of removal.

C: INSPECTION

1. ACCESS KEY BATTERY

Check the access key battery voltage.

Preparation tool:
Circuit tester

NOTE:

Complete the measurement within 5 seconds because the battery discharges during measurement.

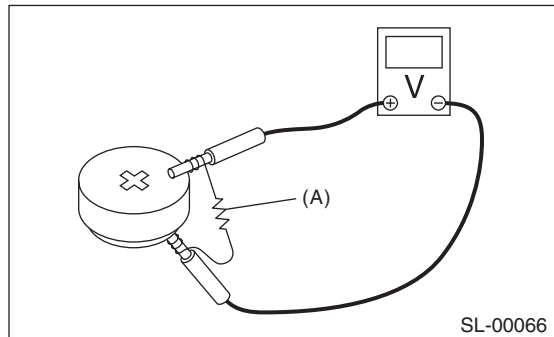

Battery terminal	Inspection conditions	Standard
(+) — (-)	Connect resistor (A) 47 Ω	2.5 — 3.0 V

Replace the battery if the inspection result is not within the standard value. (Use CR1632 V or equivalent.)

D: REPLACEMENT

1. ACCESS KEY REGISTRATION

NOTE:

- A maximum of seven access keys can be registered for each individual vehicle.
- When replacing or adding an access key, new registration of the access key is necessary.
- When replacing the access key, registration in the immobilizer system is necessary.

Refer to the “PC application help for Subaru Select Monitor” for access key registration.

2. CLEARING ACCESS KEY REGISTRATION

Refer to the “PC application help for Subaru Select Monitor” for clearing access key registration.