

## 5. Washer Tank and Motor

### A: REMOVAL

- 1) Open the front hood.
- 2) Disconnect the ground cable from battery.
- 3) Remove the front bumper face assembly.
  - (1) Remove the clips and turn over the front end of front mud guard. (Model with fog light)

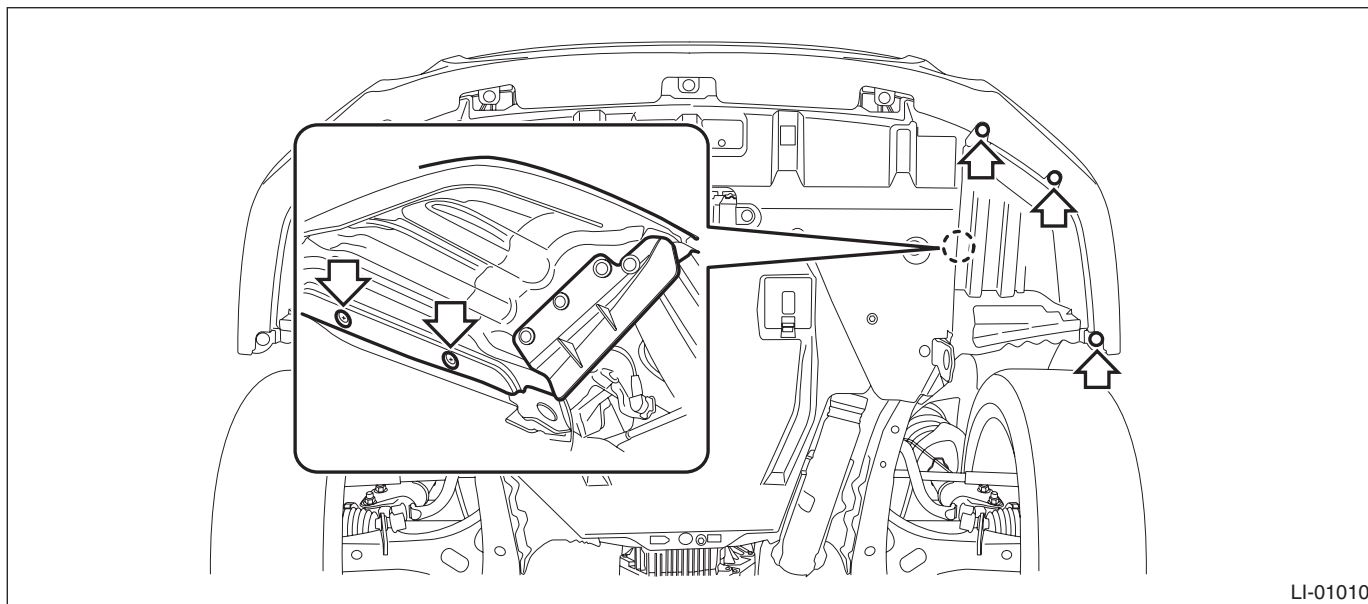

- (2) Disconnect the front fog light connector. (Model with fog light)

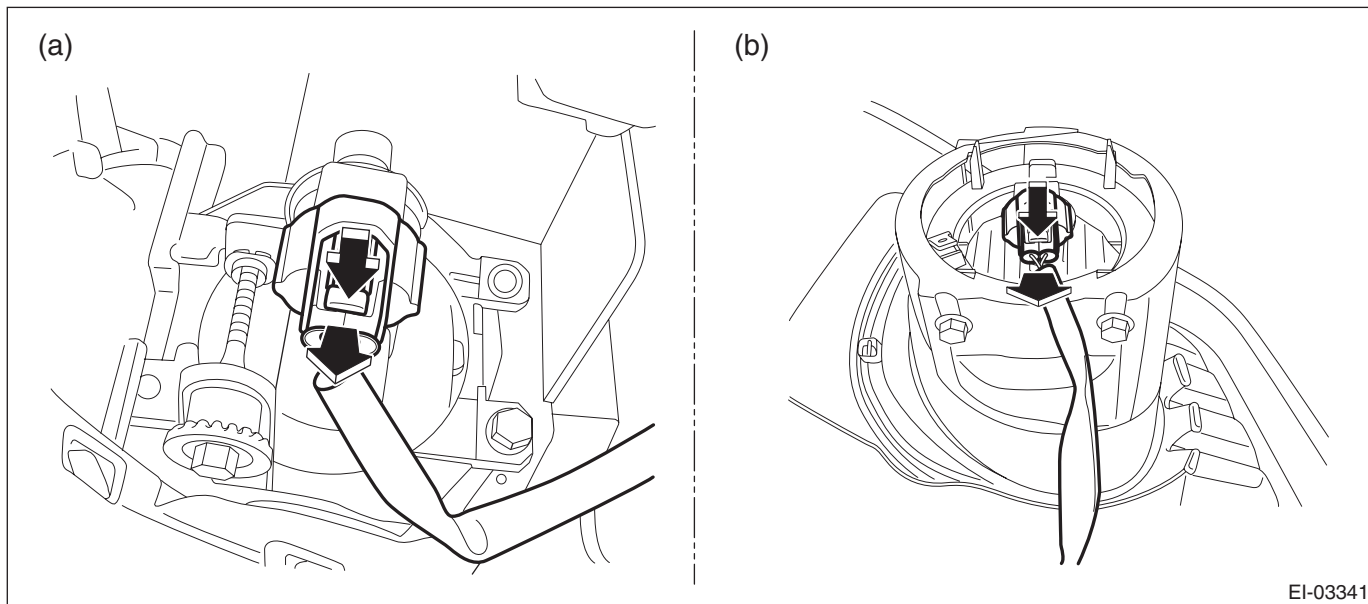

(a) Except for OUTBACK model      (b) OUTBACK model

- (3) Remove the clips at the upper side of the bumper.
- (4) Remove the clips from the fender.

# Washer Tank and Motor

## WIPER AND WASHER SYSTEMS

(5) Remove the clips at the lower side of bumper.

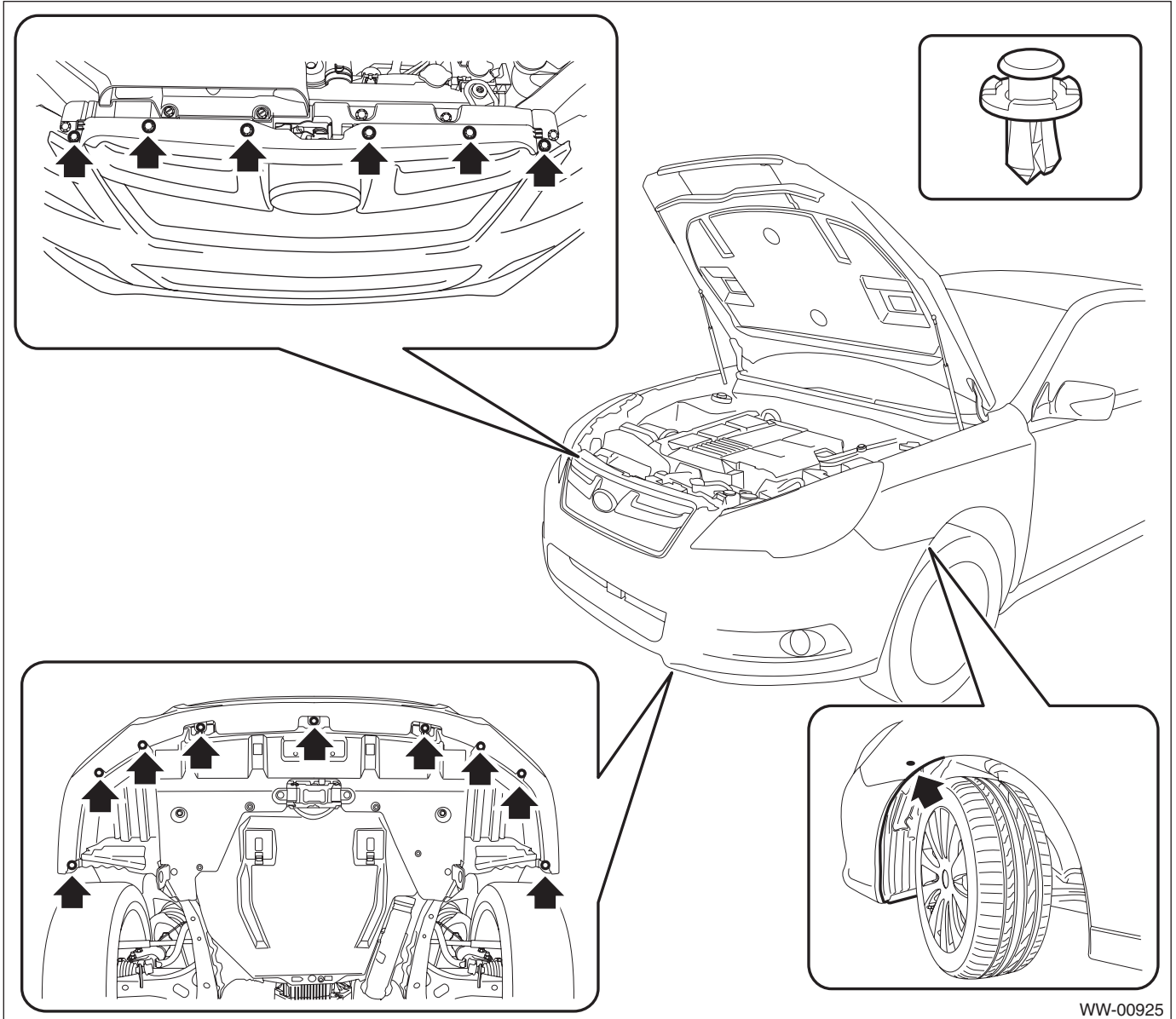

WW-00925

(6) Detach the flange section on the bumper face side from the bracket side front UPR.

**CAUTION:**

**Do not pull forcibly. It may damage the flange section on the bumper face - front side when it comes off from the claws of bracket side front UPR.**

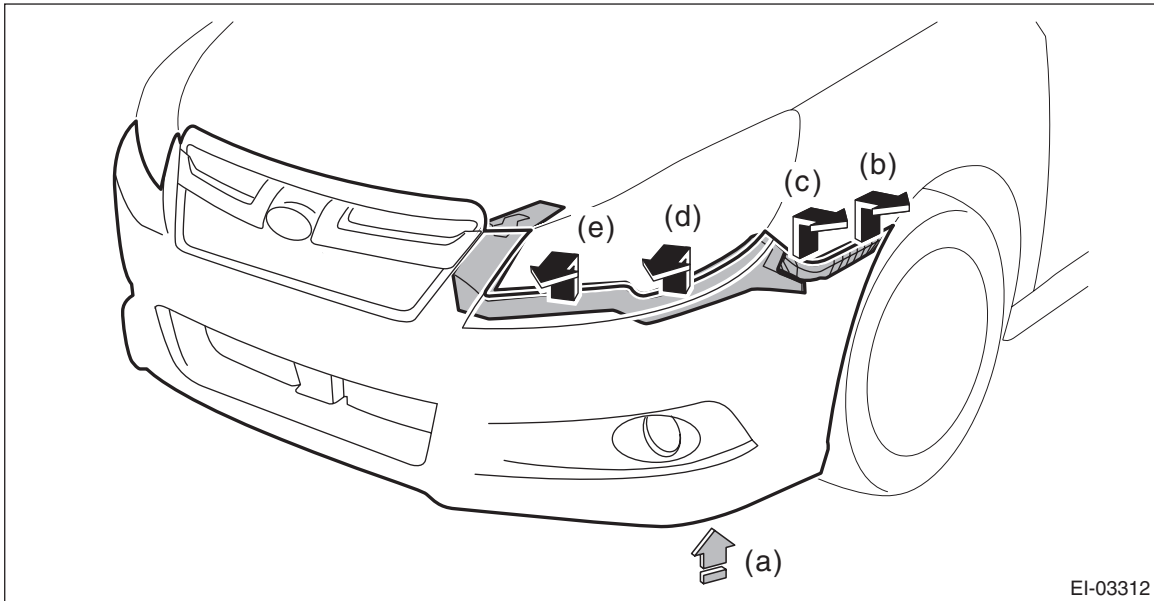

**NOTE:**

Pushing up the lower side (a) of the fog light, remove from (b) to (e).

Detach the opposite side in the same manner.

4) Remove the washer tank assembly.

(1) Remove the clip of the washer tank duct.

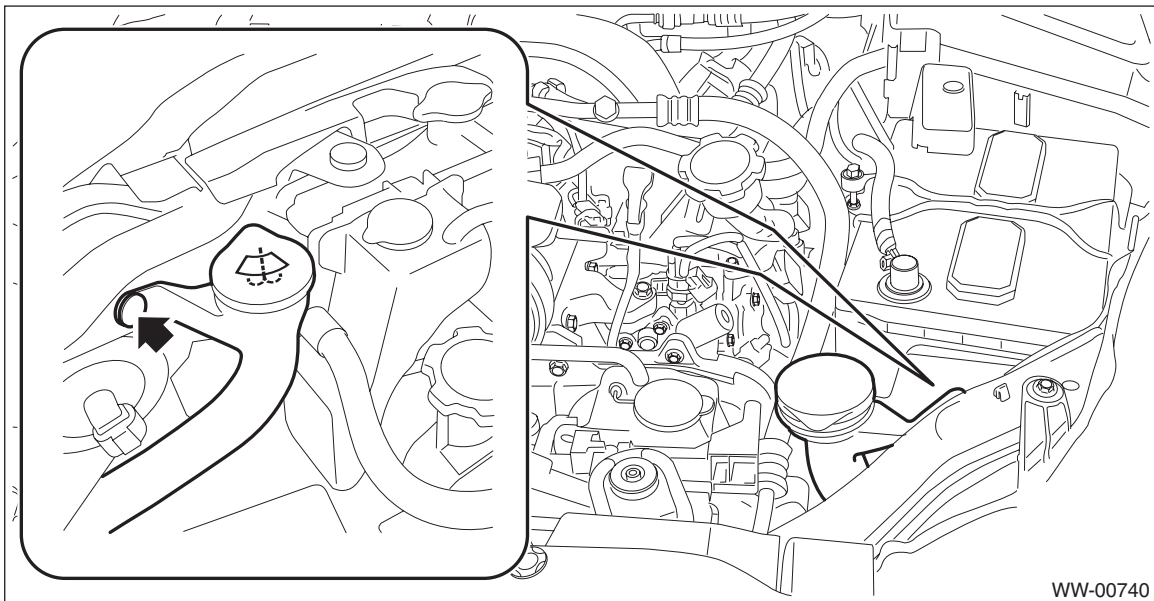

(2) Prepare a container before disconnecting the washer hose and drain all washer fluid in the tank.

(3) Disconnect the connector from the washer motor and washer tank level sensor, and then remove the harness clip.

# Washer Tank and Motor

## WIPER AND WASHER SYSTEMS

(4) Remove the bolt and nuts and remove the washer tank assembly.

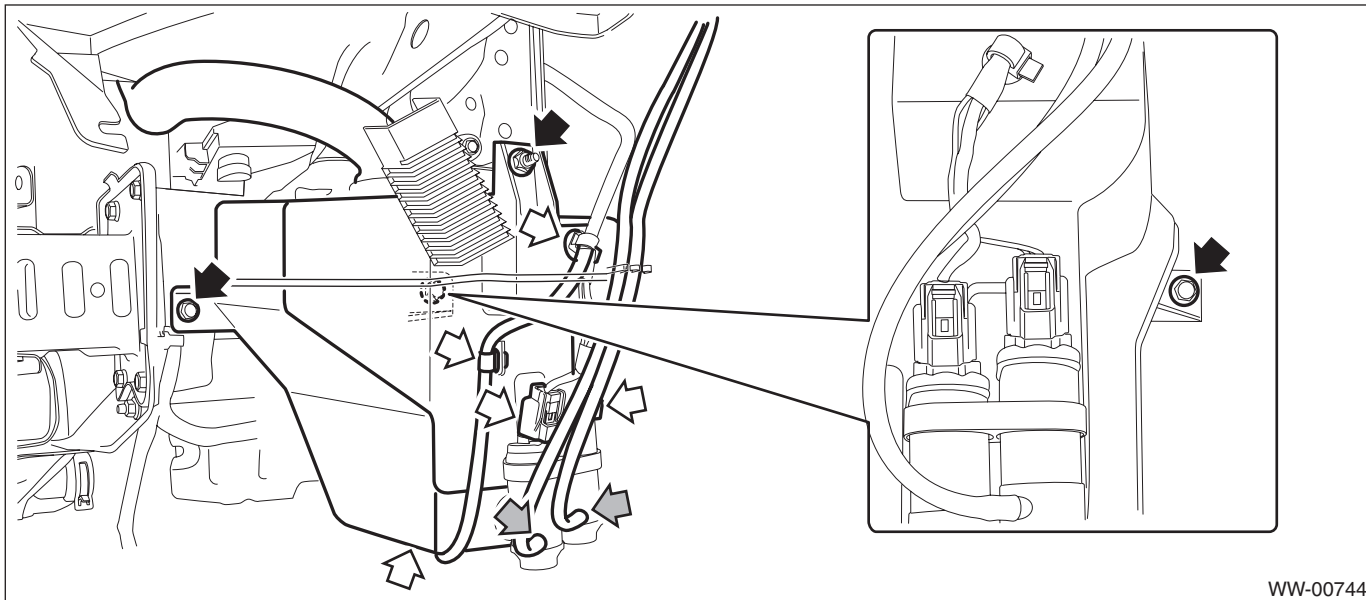

5) Remove the washer motor from the tank.

## B: INSTALLATION

1) Install each part in the reverse order of removal.

### CAUTION:

- Install the bumper face so that the under cover front end (b) comes inside the front bumper face (a).

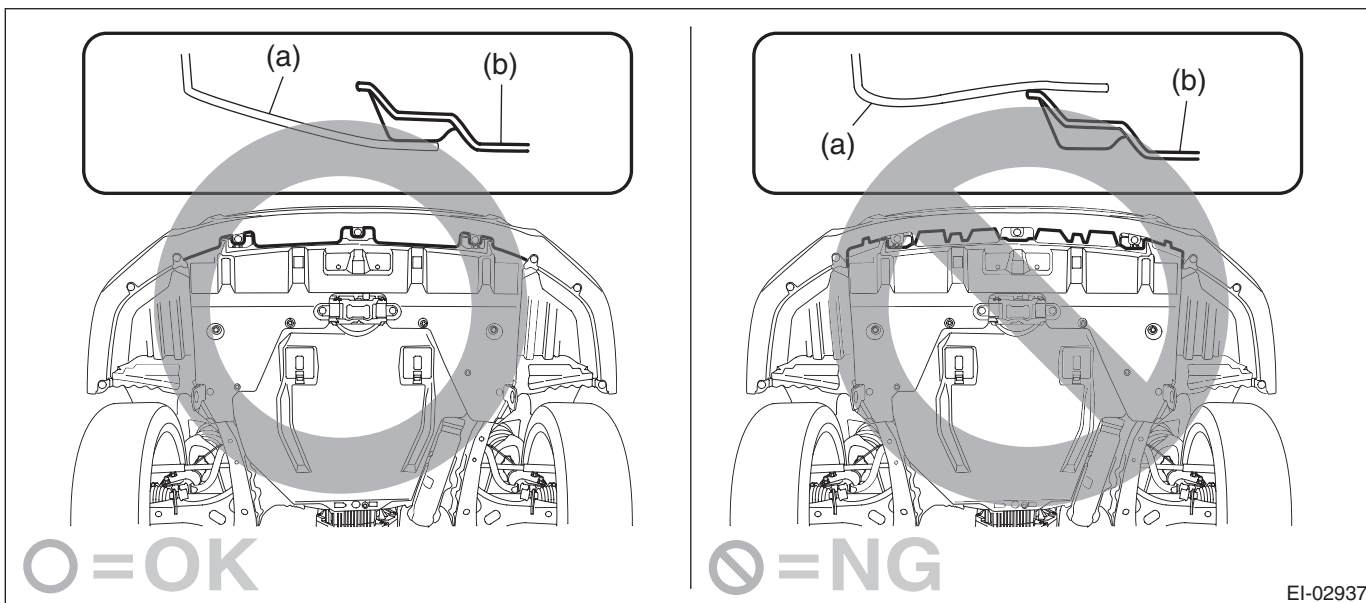

- Before installing the bumper face, match the claws on the bracket - front bumper with the engaging position of flange section on the bumper face side. If the engaging position is not correct, the flange section may be broken or the clearance between fender panel and bumper face may not be uniform.

2) Add new washer fluid.

### Tightening torque:

**6 N·m (0.61 kgf·m, 4.4 ft·lb)**

3) Adjust the fog light beam. (Model with fog light)<Ref. to LI-42, FOG LIGHT AIMING, ADJUSTMENT, Front Fog Light Assembly.>

## C: INSPECTION

### 1. WASHER MOTOR

Apply battery voltage to the connector terminal of the washer motor and make sure that the motor operates.

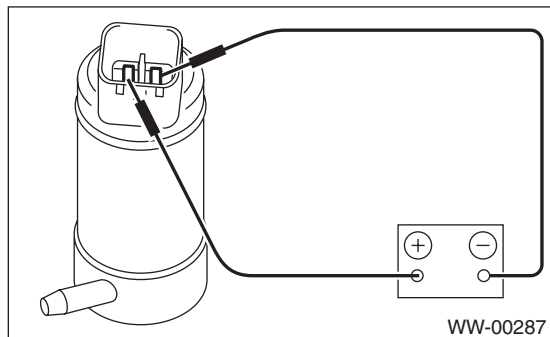

### 2. WASHER FLUID LEVEL SENSOR

- 1) Check the connection status of washer fluid level sensor connector.
- 2) Does the low washer fluid warning light illuminate after draining the washer fluid? And does the low washer fluid warning light go off after refilling the washer fluid?
  - **Yes** → Normal
  - **No** → Go to step 3.
- 3) Using a tester, measure the voltage of the washer fluid level sensor connector.
  - (1) Is the voltage approx. 8.5 V or more?
    - **Yes** → Go to step 4.
    - **No** → Check harness, meter and body integrated unit, and replace if necessary.
- 4) Does the meter indicator illuminate if you short the washer fluid level sensor connector?
  - **Yes** → Go to step 5.
  - **No** → Check meter and body integrated unit, and replace if necessary.
- 5) Using a tester, measure the resistance of the washer fluid level sensor.
  - (1) Turn over the mud guard.
  - (2) Measure the resistance of the washer fluid level sensor.

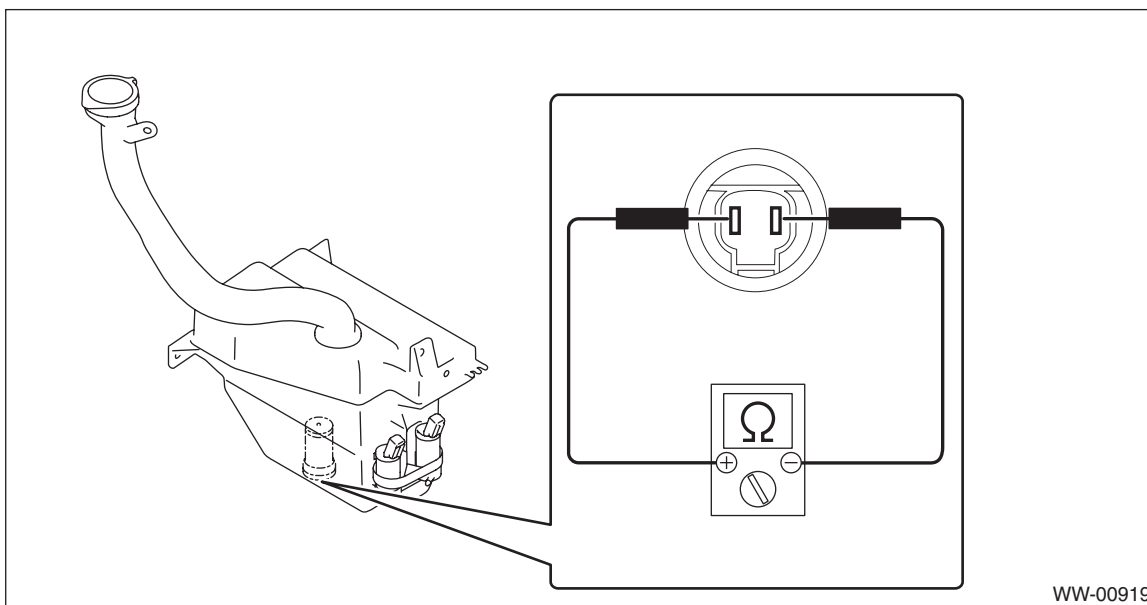

Amount of washer fluid in the tank	Standard
No remaining quantity (ON)	Less than 10 Ω
There is remaining quantity (OFF)	1 MΩ or more

## Washer Tank and Motor

### WIPER AND WASHER SYSTEMS

---

(3) Is the resistance within the standard?

- **Yes** → Normal
- **No** → Replace the washer fluid level sensor along with the washer tank.