

4. Anticorrosion Wax

A: SPECIFICATION

Used material:

Rust-stop aerosol (K0877YA015)

▨: Application area

- Door (Application thickness = 20 μm or more)

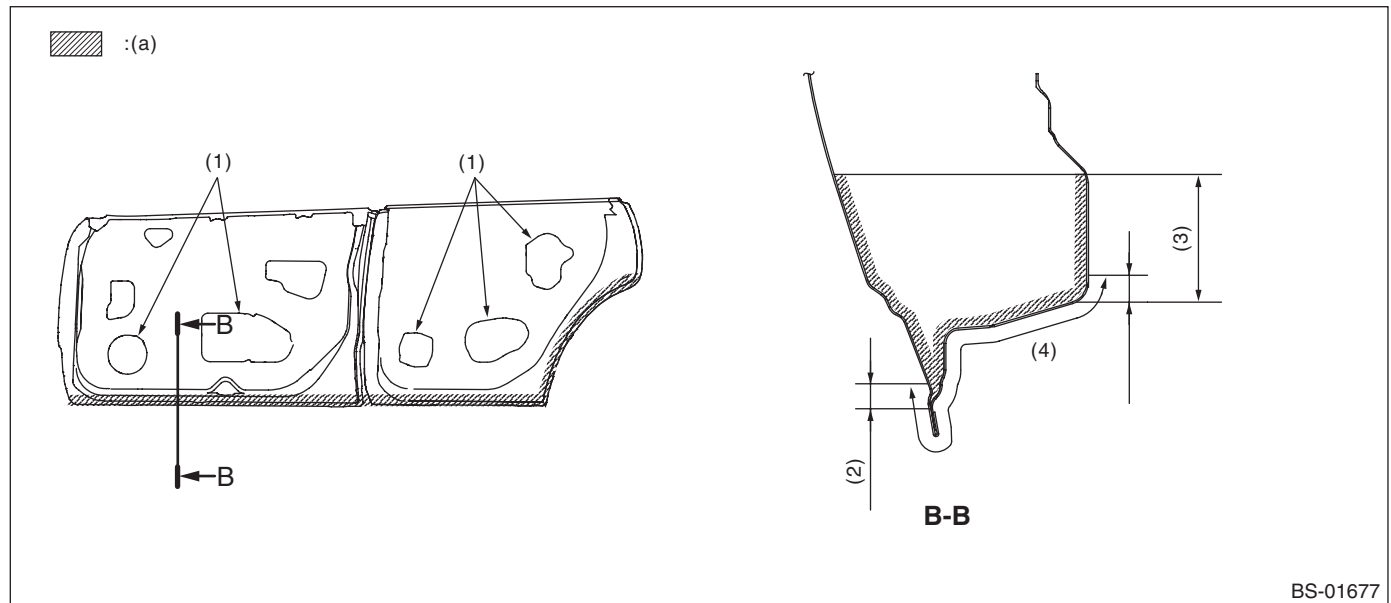

(a) Rust-stop aerosol

(1) Wax application work openings

(3) 50 mm (1.97 in)

(4) Application thickness = 50 μm or more

(2) 10 mm (0.39 in)

Anticorrosion Wax

BODY STRUCTURE

- Rear gate (Application thickness = 15 μm or more)

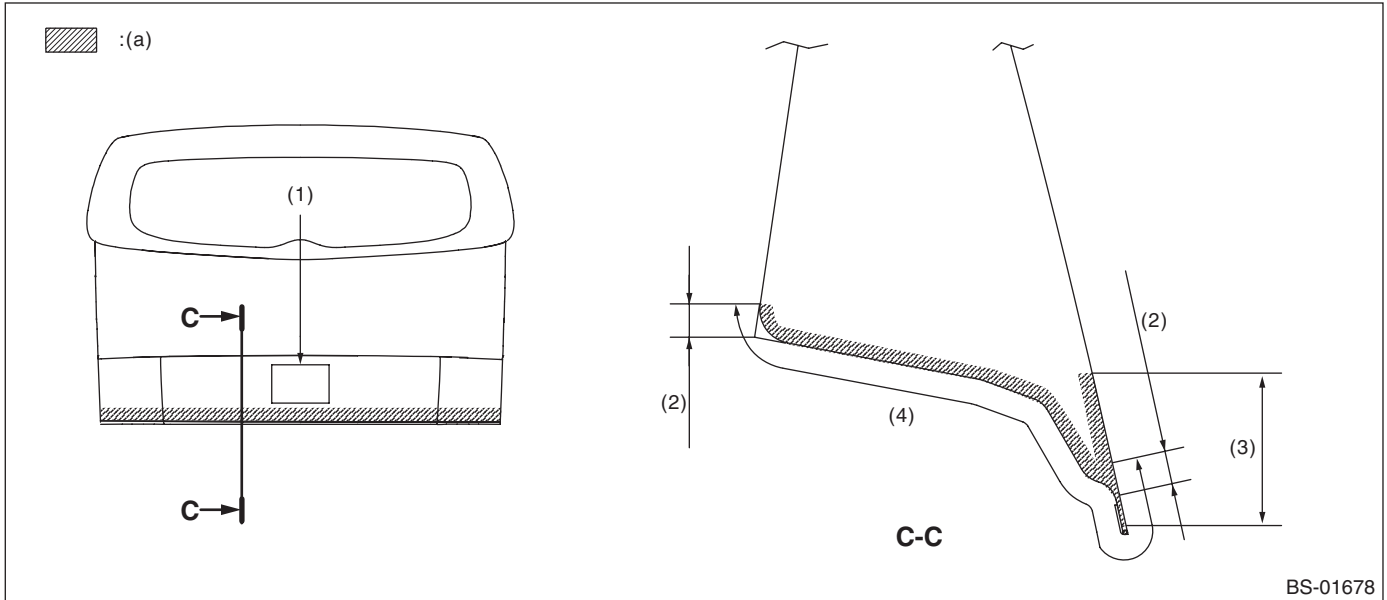

(a) Rust-stop aerosol

(1) Wax application work openings

(3) 50 mm (1.97 in)

(4) Application thickness = 50 μm or more

(2) 10 mm (0.39 in)

- Front hood hinge (Application thickness = 15 μm or more)

Apply around the installation outer circumference (indicated range) at two locations on the left and right.

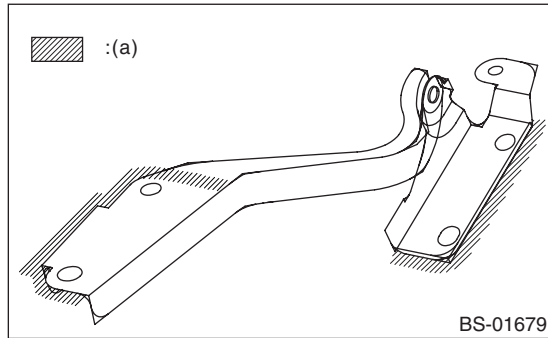

(a) Rust-stop aerosol

- Rear gate hinge (Application thickness = 15 μm or more)

Apply around the installation outer circumference (plate edges) at two locations on the left and right.

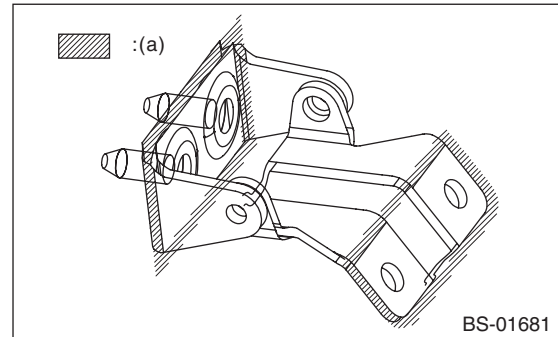

(a) Rust-stop aerosol

- Door hinge (Application thickness = 15 μm or more)

Apply to the installation outer circumference (indicated range) at two locations at the top and bottom (eight locations in all).

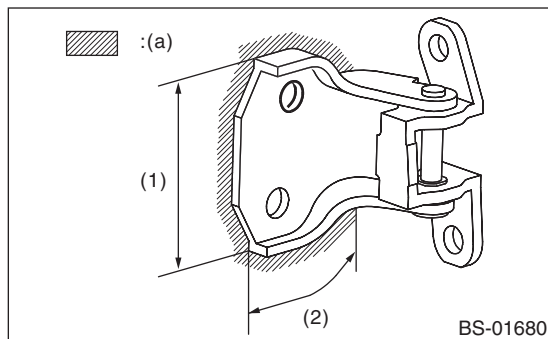

(a) Rust-stop aerosol

- (1) Application thickness of 15 μm or less is acceptable only on the front door hinge
- (2) Application thickness of 15 μm or less is acceptable both on the front and rear door hinge

Anticorrosion Wax

BODY STRUCTURE

- Overall view 1

 : (a)

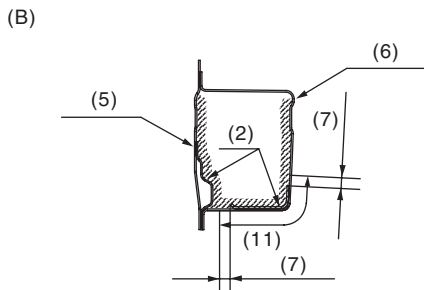
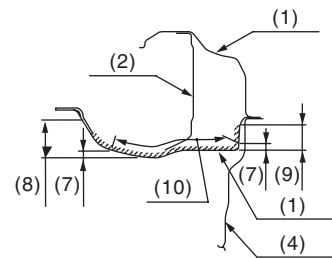
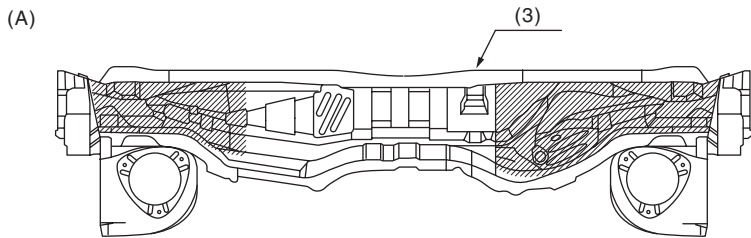
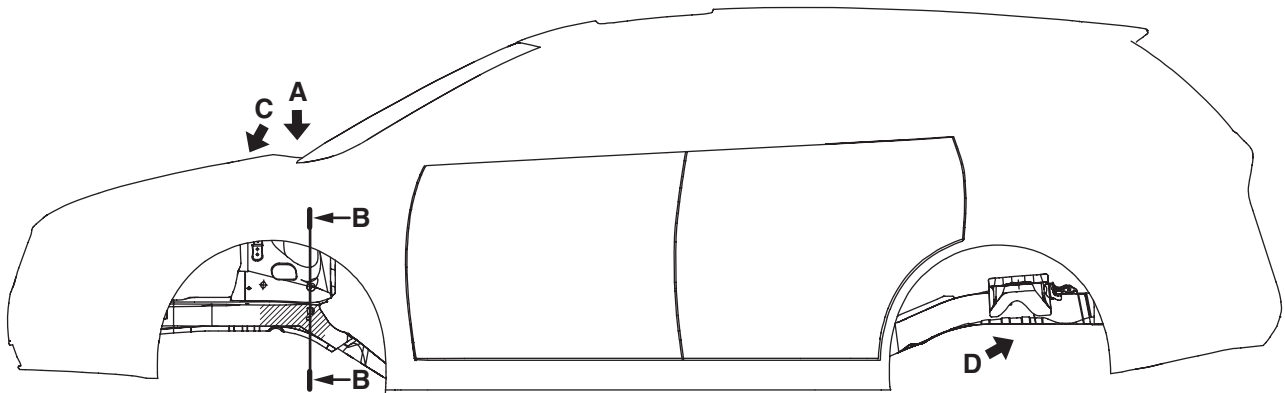
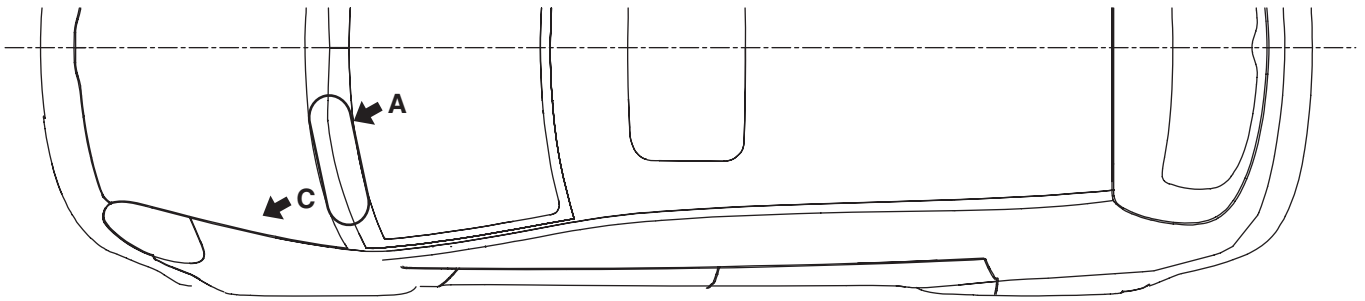

BS-01682

(a) Rust-stop aerosol

(A) View A (Application thickness = 20 μm or more)

(B) Cross section B — B (Application thickness = 15 μm or more)

(1) Front panel

(7) 10 mm (0.39 in)

(11) Application thickness = 50 μm or more

(2) Reinforcement

(8) 50 mm (1.97 in)

(Reinforcement mating surface)

(3) Bulkhead

(9) 35 mm (1.38 in)

(4) Toe board

(10) Application thickness = 50 μm or more

(5) Closing plate

(6) Side frame

Anticorrosion Wax

BODY STRUCTURE

- Overall view 2

 : (a)

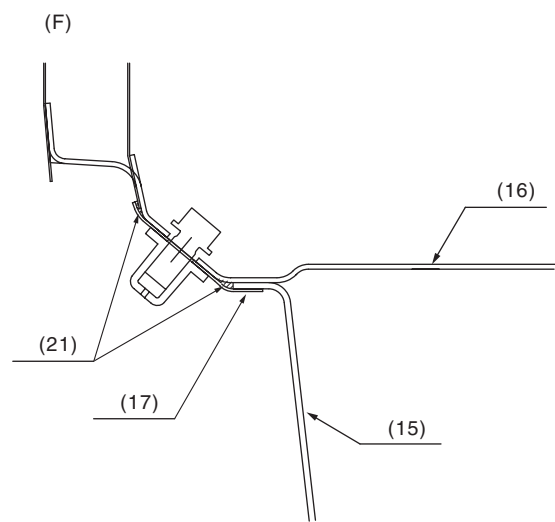
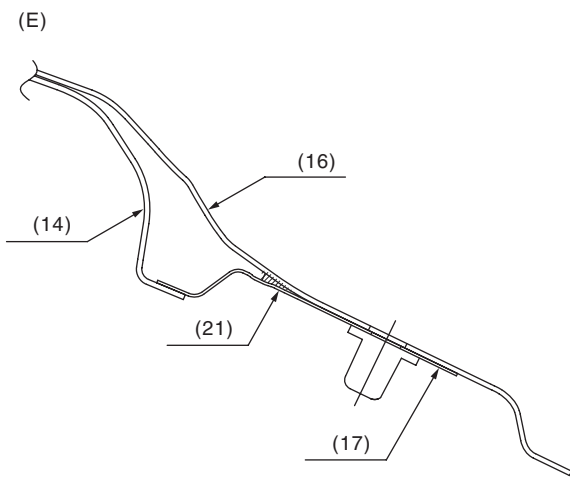
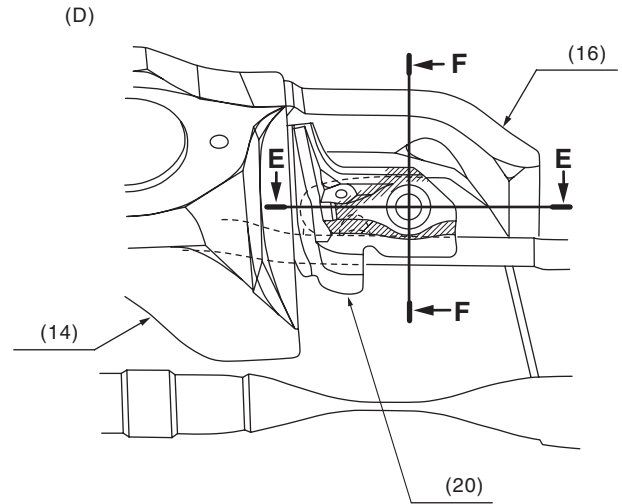
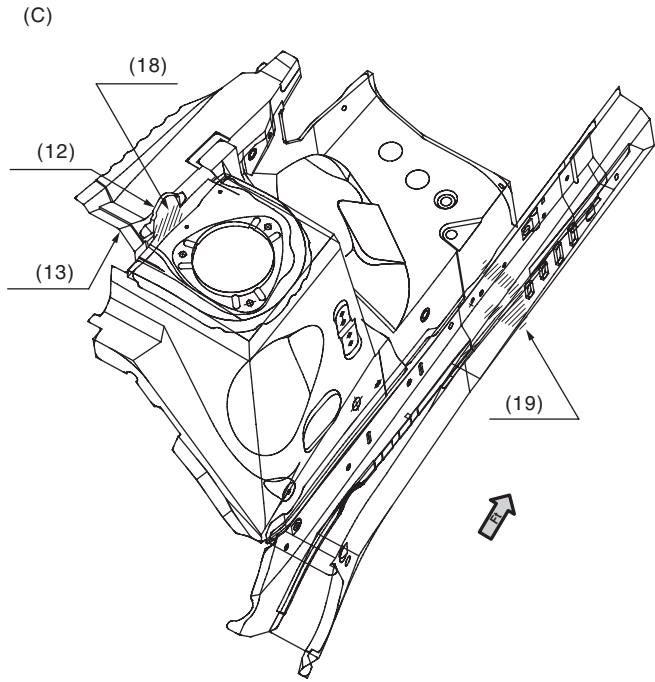

BS-01716

(a) Rust-stop aerosol

(C) View C

(D) View D

(E) Cross section E — E

(F) Cross section F — F

(12) Hood stay bracket

(13) Wheel apron upper

(14) Damper bracket

(15) Side frame

(16) Closing plate

(17) Anchor bracket

(18) Apply to the mating surface between the hood stay bracket and wheel apron upper.
(Application thickness = 15 µm or more)

(19) Apply to the side frame welded seam.
(Application thickness = 15 µm or more)

(20) Third-row seat anchor bracket

(21) Application area

Anticorrosion Wax

BODY STRUCTURE

- Bottom view

 : (a)

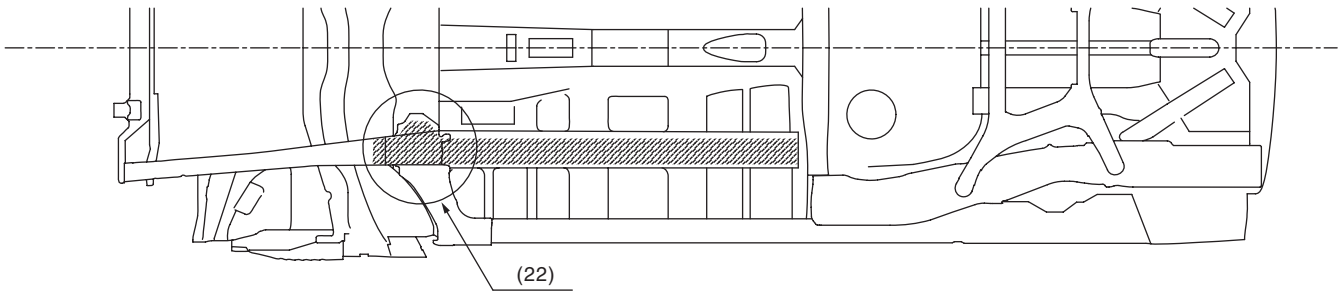

(G)

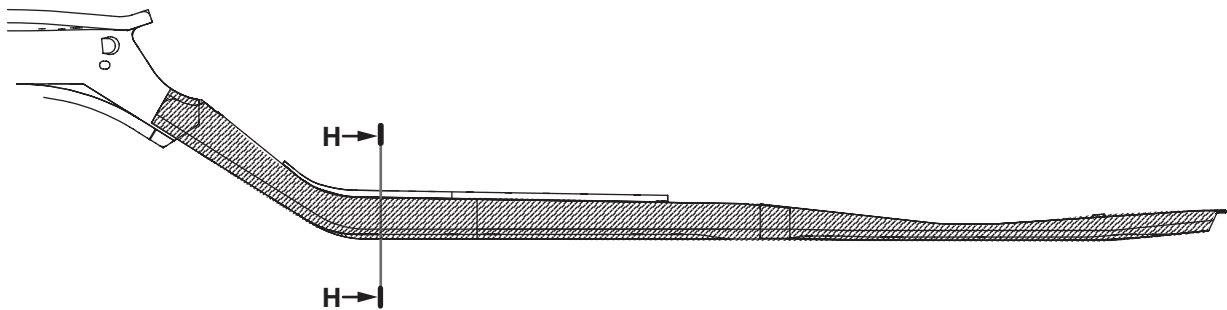

(H)

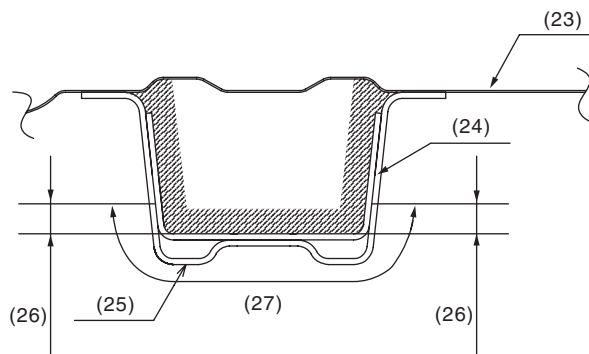

BS-01710

(a) Rust-stop aerosol

(G) Side frame side view

(H) Cross section H — H (Application thickness = 20 µm or more)

(22) Apply to the inside of suspension bracket.

(24) Reinforcement

(27) Application thickness = 50 µm or more

(25) Side frame

(23) Floor pan

(26) 10 mm (0.39 in)