

18.Hose and Tube

A: REMOVAL

CAUTION:

- When disconnecting/connecting hoses, do not apply an excessive force to them. After installing, check that no torsion or excessive tension applied to the hoses.
- Seal the disconnected hose with a plug or vinyl tape to prevent foreign matter from entering.

1. FRONT

- 1) Disconnect the ground cable from the battery.
- 2) Using the refrigerant recovery system, discharge refrigerant. <Ref. to AC-21, PROCEDURE, Refrigerant Recovery Procedure.>
- 3) Remove the evaporator unit mounting bolt (A) and low-pressure hose bracket bolt (B).
- 4) Remove the low-pressure hose attaching bolts (C).
- 5) Disconnect the low-pressure hose from evaporator unit.
- 6) Disconnect the low-pressure hose from compressor.
- 7) Remove the low-pressure hose from vehicle.
- 8) Remove the high-pressure hose attaching bolt (D).
- 9) Disconnect the high-pressure hose from compressor.
- 10) Disconnect the high-pressure hose from condenser.
- 11) Remove the high-pressure hose from vehicle.
- 12) Remove the high-pressure tube attaching bolt (E).

- 13) Remove the high-pressure tube from vehicle.

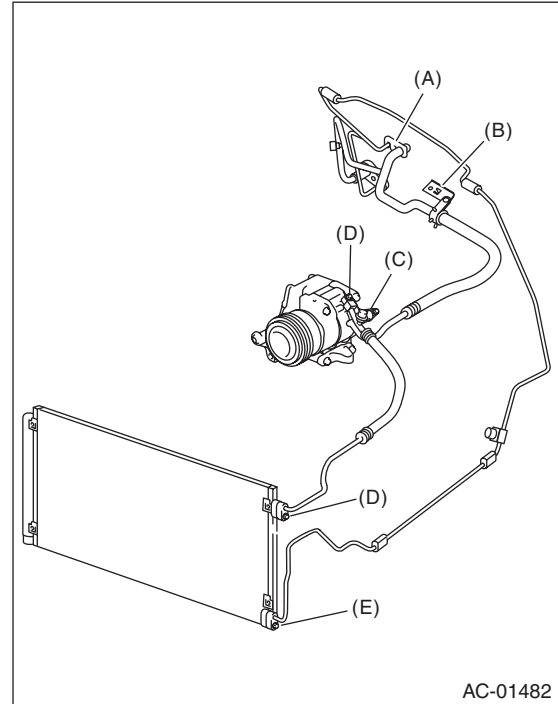

2. REAR

- 1) Disconnect the ground cable from the battery.
 - 2) Using the refrigerant recovery system, discharge refrigerant. <Ref. to AC-21, PROCEDURE, Refrigerant Recovery Procedure.>
 - 3) Remove the sheet and floor mat. <Ref. to EI-47, REMOVAL, Floor Mat.>
 - 4) Remove the ECM bracket. <Ref. to FU(H6DO)-33, REMOVAL, Engine Control Module (ECM).>
 - 5) Remove the quick connectors (A and B).
- ST 73499XA01A REMOVER PS
ST 73499XA00A REMOVER PD

NOTE:

Description for handling the special tool

1. Face collar side (A) of the quick connector (1) to the remover (2), and set lock part (B) on the stopper side (C) of the remover.

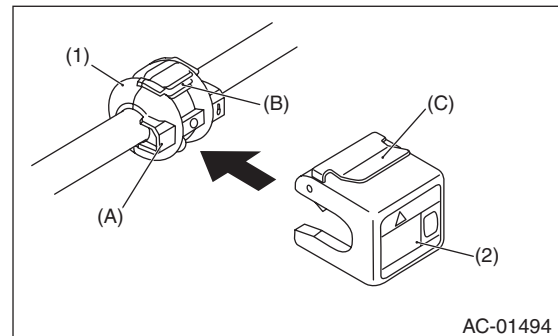

Hose and Tube

HVAC SYSTEM (HEATER, VENTILATOR AND A/C)

2. Insert the remover.

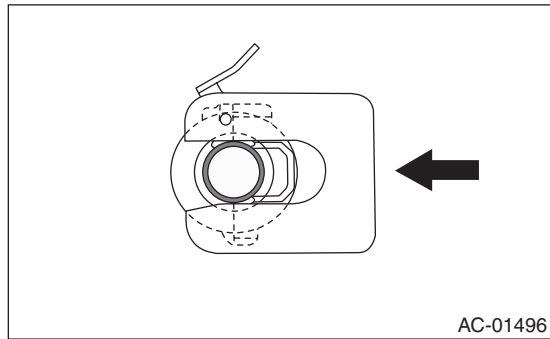

Do not bend the needle (4) in the remover.

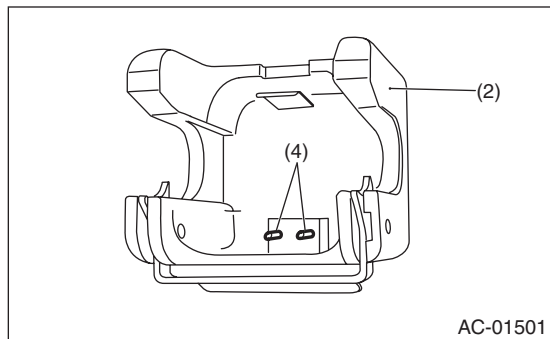

3. With the tube secured, press the label part (D) of the remover with a thumb. Connector is unlocked and the quick connector opens.

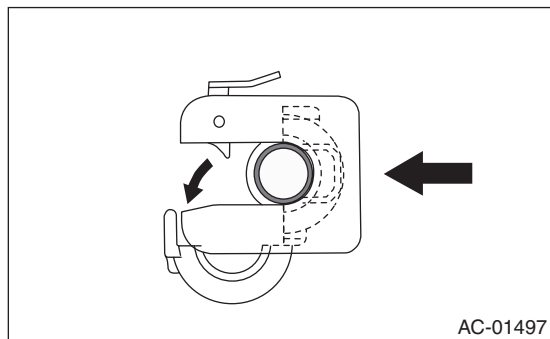
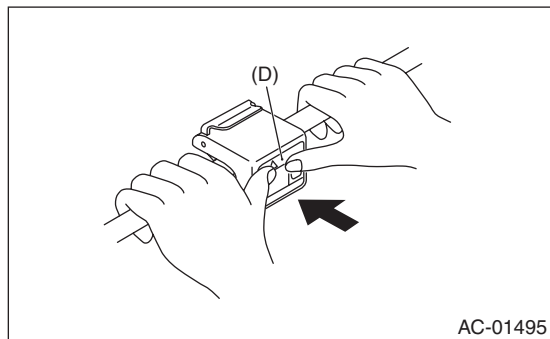

4. Pull the remover (2) and separate the tube (3) from the quick connector (1).

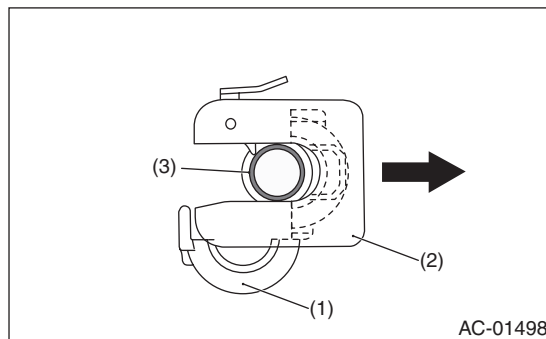

5. Pull up the stopper (C) and remove the remover (2) and quick connector (1) from the tube.

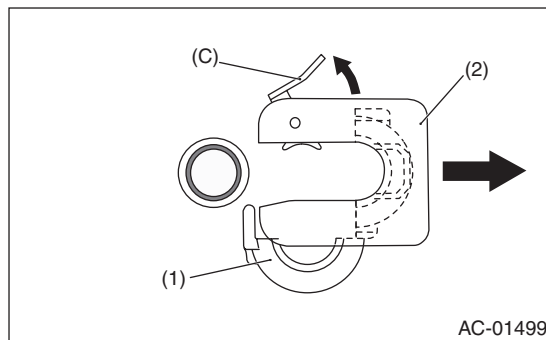

6. Disconnect the quick connector (1) from the remover (2).

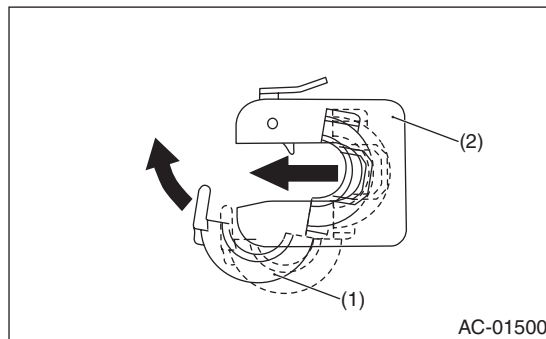

6) Remove the tube bracket.

7) Remove the front tube and rear tube connecting bolts (C)

8) Remove the connecting bolts (D) of the rear cooler unit.

9) Remove the front tube (E) and rear tube (F).

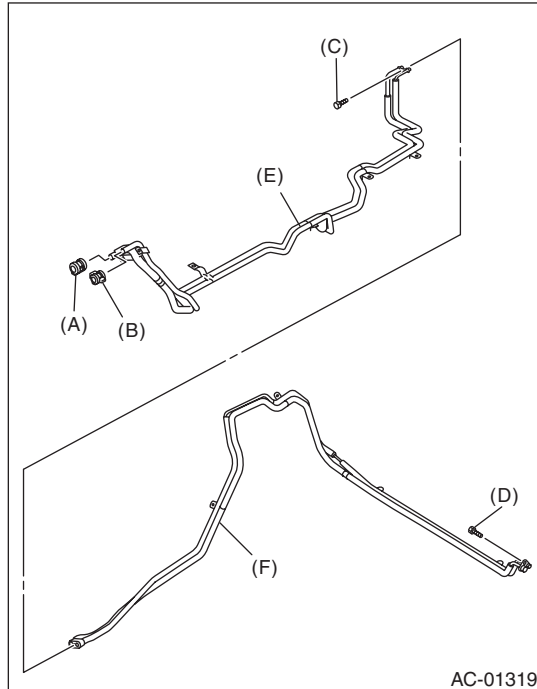

B: INSTALLATION

CAUTION:

- When disconnecting or connecting the hoses, do not apply excessive force. After installing, check that no torsion or excessive tension applied to the hoses.
- Seal the disconnected hose with a plug or vinyl tape to prevent foreign matter from entering.

1) Install in the reverse order of removal.

2) Charge refrigerant. <Ref. to AC-22, PROCEDURE, Refrigerant Charging Procedure.>

Tightening torque:

Refer to “**COMPONENT**” of “**General Description**”. <Ref. to AC-11, AIR CONDITIONING UNIT, **COMPONENT**, **General Description**.>

C: INSPECTION

Check the hoses for cracks, damage and expansion. If any fault is found, replace with new parts.