

FRONT BUMPER COMPONENTS

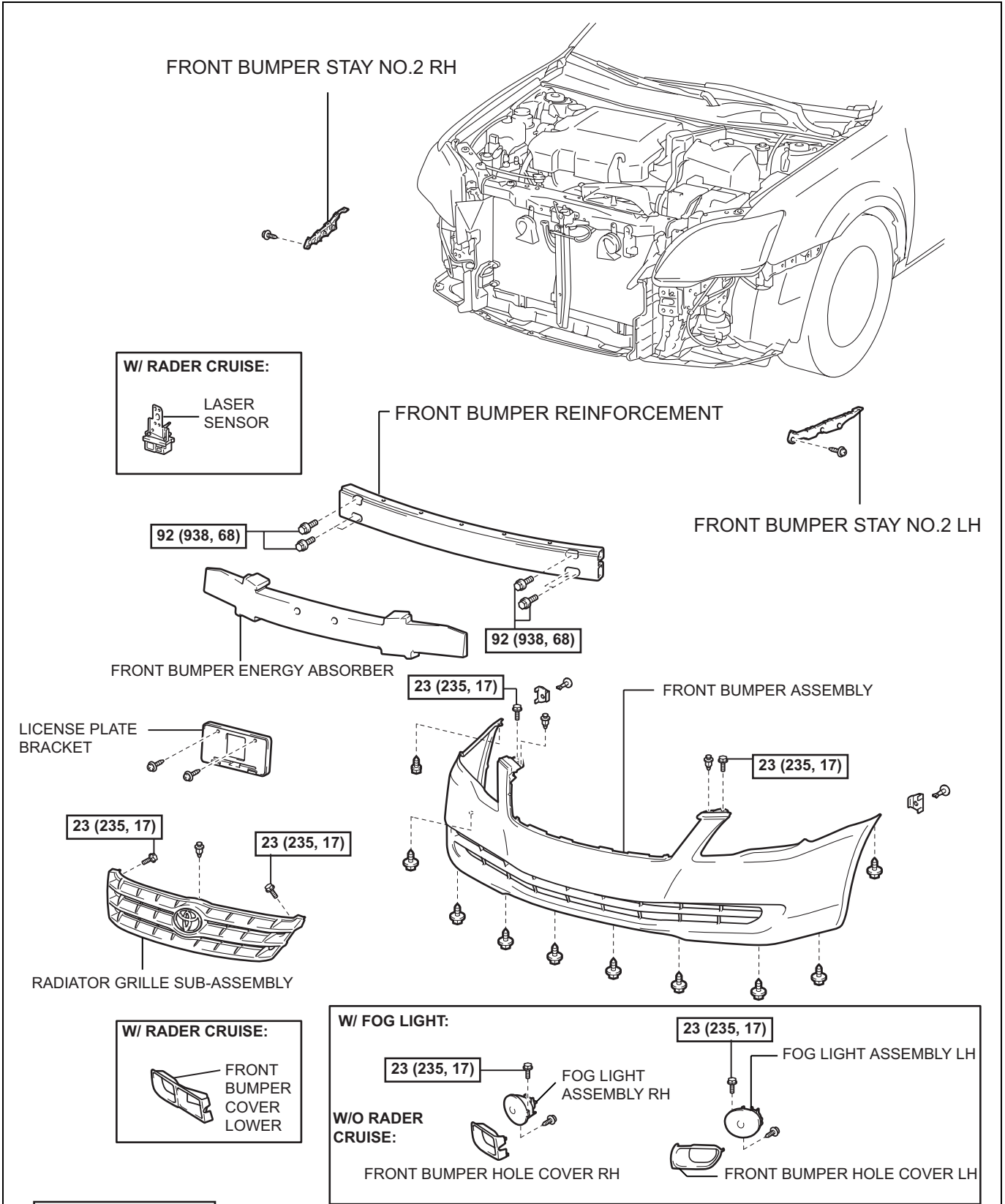

ET

P N*m (kgf*cm, ft.*lbf) : Specified torque

REMOVAL

1. REMOVE RADIATOR GRILLE SUB-ASSEMBLY

- (a) Remove the 2 bolts and clip.
- (b) Disengage the 5 claws and remove the radiator grille sub-assembly.

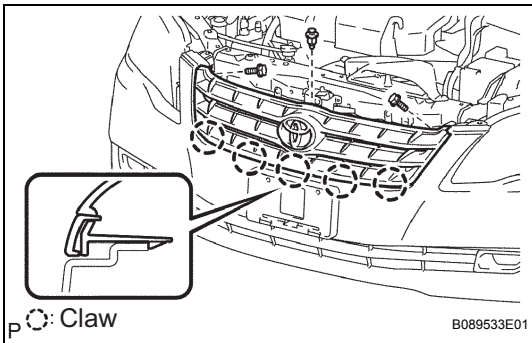

2. REMOVE FRONT BUMPER ASSEMBLY

- (a) Turn the pin hold clip 90° as shown in the illustration and remove it. (LH side)

HINT:

Remove the RH side by following the same procedure as for the LH side.

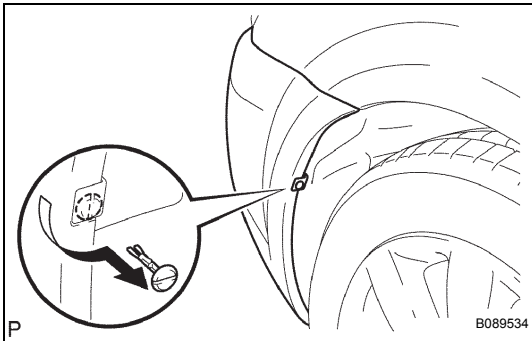

- (b) Remove the 2 bolts, 10 screws and 2 clips.

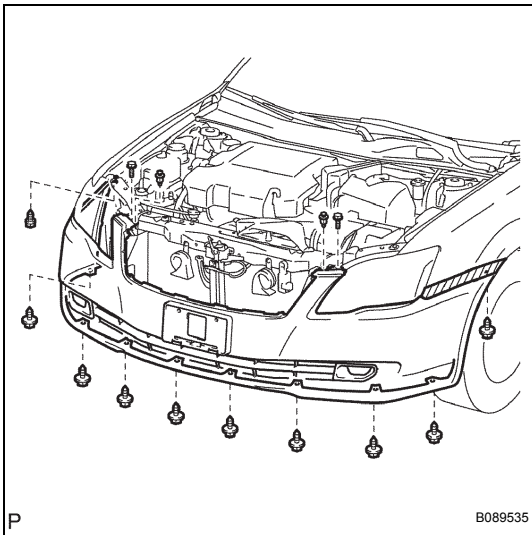

- (c) Disengage the 4 claws by pulling the left side of the front bumper cover in the direction shown by the arrow. (LH side)

HINT:

Disengage the RH side by following the same procedure as for the LH side.

- (d) Disconnect the fog light connector (w/ fog light) and remove the front bumper assembly.

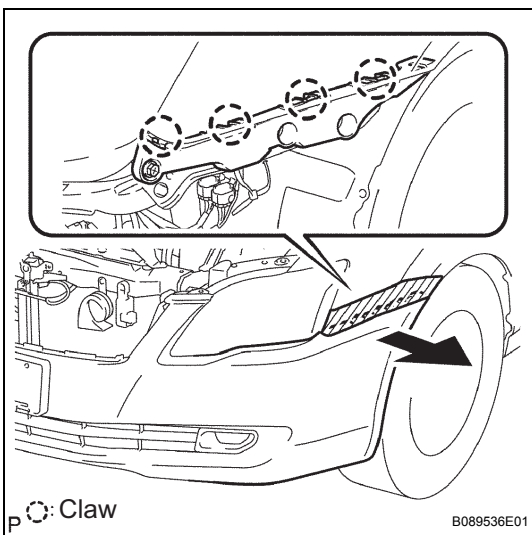

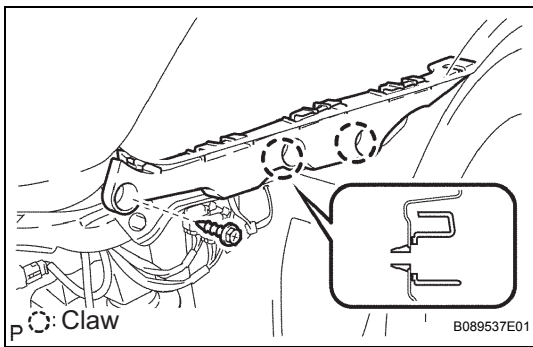

3. REMOVE FRONT BUMPER STAY NO.2 LH

- (a) Remove the screw.
- (b) Disengage the 2 claws and remove the front bumper stay No.2 LH.

4. REMOVE FRONT BUMPER STAY NO.2 RH

HINT:

Removal of the front bumper stay No.2 RH is the same as the front bumper stay No.2 LH.

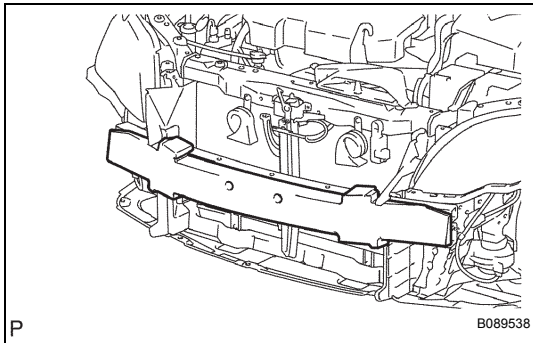

5. REMOVE FRONT BUMPER ENERGY ABSORBER

- (a) Remove the front bumper energy absorber.

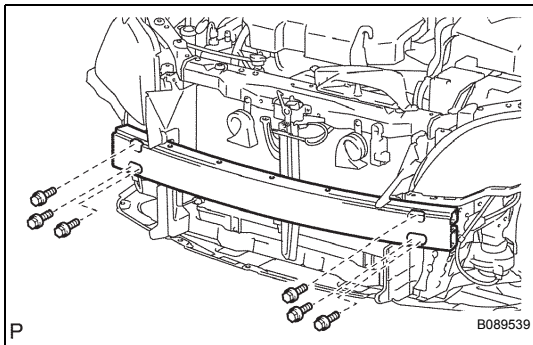

6. REMOVE FRONT BUMPER REINFORCEMENT

- (a) Remove the 6 bolts and the front bumper reinforcement.

7. REMOVE LASER SENSOR (w/ Dynamic Radar Cruise Control System)

HINT:

See page [CC-121](#)

DISASSEMBLY

1. **REMOVE FOG LIGHT ASSEMBLY LH (w/ Fog Light)**
HINT:
See page [LI-121](#)
2. **REMOVE FOG LIGHT ASSEMBLY RH (w/ Fog Light)**
HINT:
See page [LI-121](#)
3. **REMOVE FRONT BUMPER HOLE COVER LH**
4. **REMOVE FRONT BUMPER HOLE COVER RH (w/o Dynamic Radar Cruise Control System)**
5. **REMOVE FRONT BUMPER COVER LOWER (w/ Dynamic Radar Cruise Control System)**

REASSEMBLY

1. INSTALL FOG LIGHT ASSEMBLY RH (w/ Fog Light)

HINT:

See page [LI-124](#)

2. INSTALL FOG LIGHT ASSEMBLY LH (w/ Fog Light)

HINT:

See page [LI-124](#)

INSTALLATION

1. INSTALL FRONT BUMPER REINFORCEMENT

- (a) Install the front bumper reinforcement with the 6 bolts.

Torque: 92 N*m (938 kgf*cm, 68 ft.*lbf)

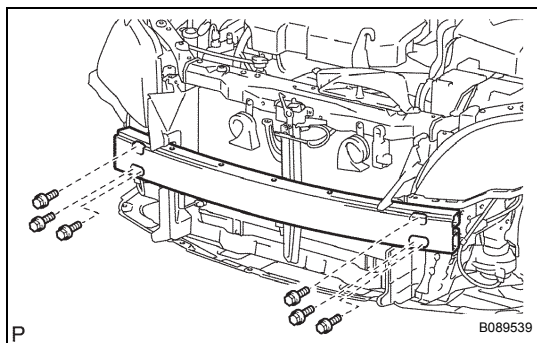

2. INSTALL FRONT BUMPER ASSEMBLY

- (a) Install the front bumper assembly with the 2 bolts, 10 screws and 2 clips.

Torque: 23 N*m (235 kgf*cm, 17 ft.*lbf)

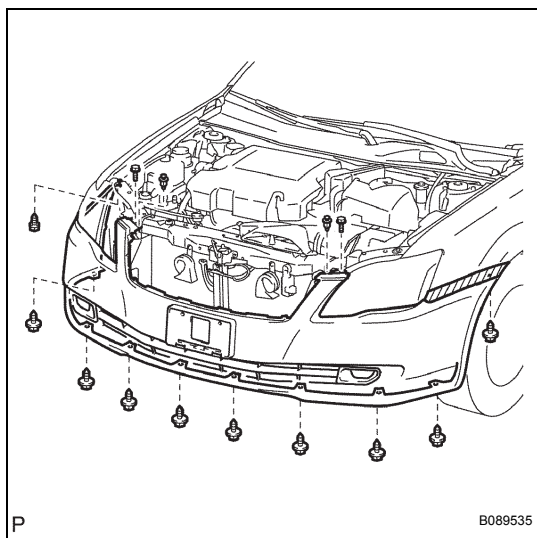

3. INSTALL RADIATOR GRILLE SUB-ASSEMBLY

- (a) Engage the 5 claws.

- (b) Install the radiator grille sub-assembly with the 2 bolts and clip.

Torque: 23 N*m (235 kgf*cm, 17 ft.*lbf)

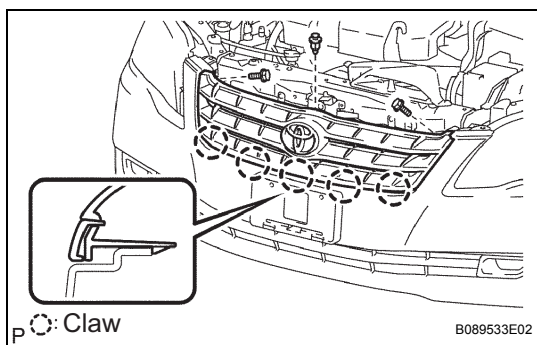

4. VEHICLE PREPARATION FOR FOG LIGHT AIM ADJUSTMENT (See page [LI-121](#))

5. PREPARATION FOR FOG LIGHT AIMING (See page [LI-122](#))

6. FOG LIGHT AIMING INSPECTION (See page [LI-123](#))

7. FOG LIGHT AIMING ADJUSTMENT (See page [LI-124](#))

8. ADJUST LASER SENSOR

HINT:

See page [CC-121](#)

REAR BUMPER COMPONENTS

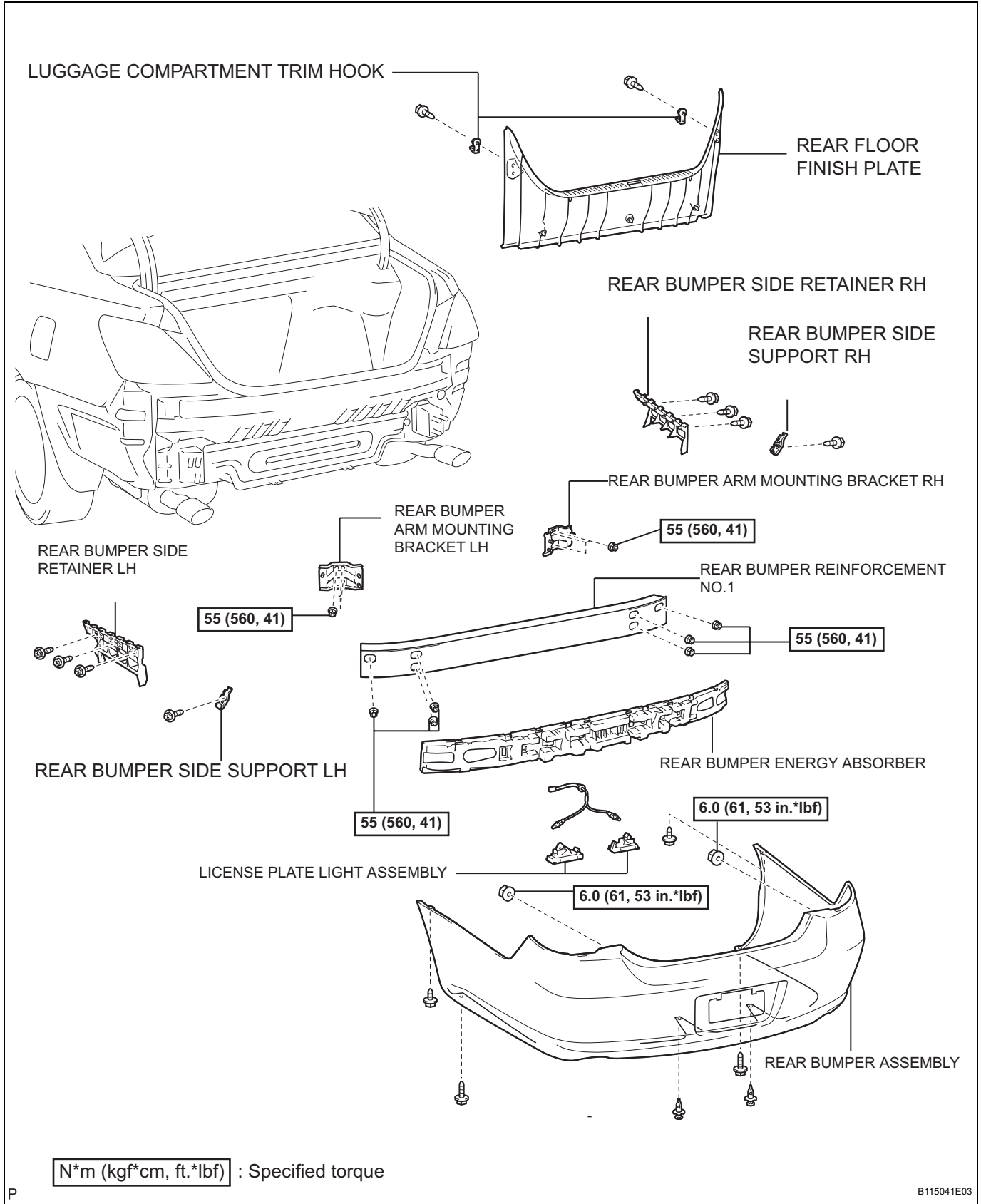

ET

REMOVAL

1. REMOVE REAR FLOOR FINISH PLATE

- (a) Remove the 2 screws and the 2 luggage compartment trim hooks.
- (b) Disengage the 7 clips and remove the rear floor finish plate.

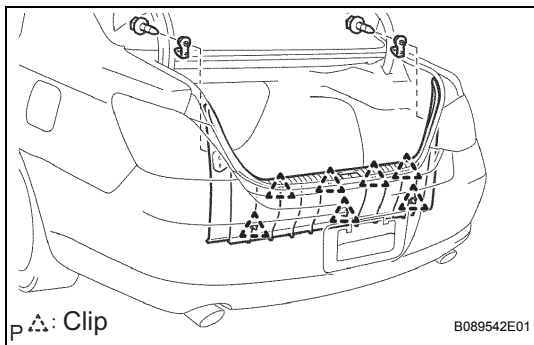

2. REMOVE REAR BUMPER ASSEMBLY

- (a) Remove the 2 nuts, 4 screws and 2 clips.

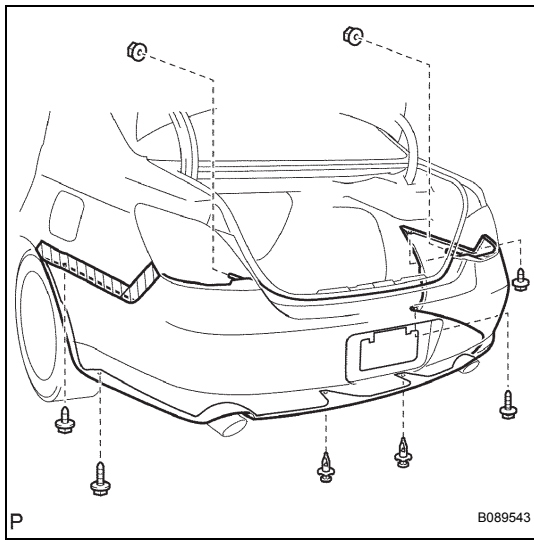

- (b) Disengage the 11 claws by pulling the left side of the rear bumper cover in the direction shown by the arrows. (LH side)

HINT:

Disengage the RH side by following the same procedure as for the LH side.

- (c) Disconnect the connector.

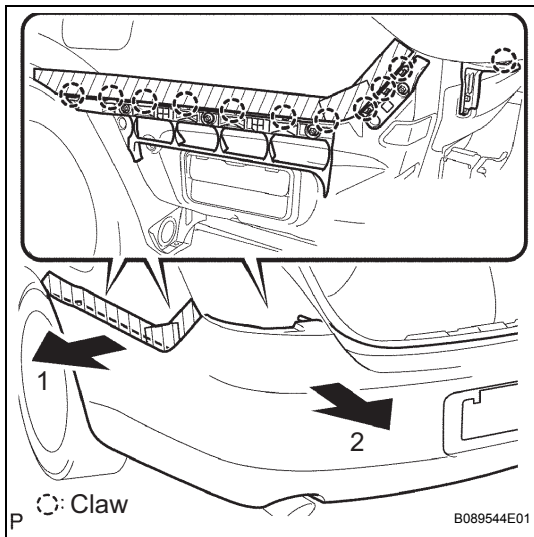

3. REMOVE REAR BUMPER SIDE RETAINER LH

- (a) Remove the 3 screws.
- (b) Disengage the 2 claws and remove the rear bumper side retainer LH.

4. REMOVE REAR BUMPER SIDE RETAINER RH

HINT:

Removal of the rear bumper side retainer RH is the same as the rear bumper side retainer LH.

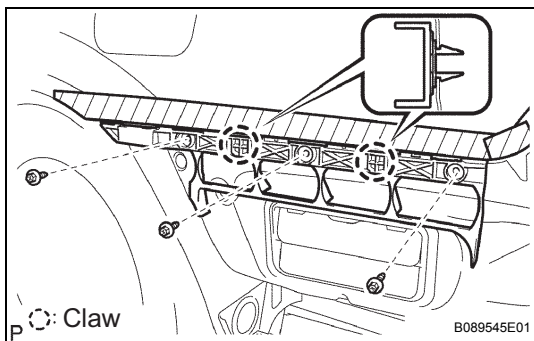

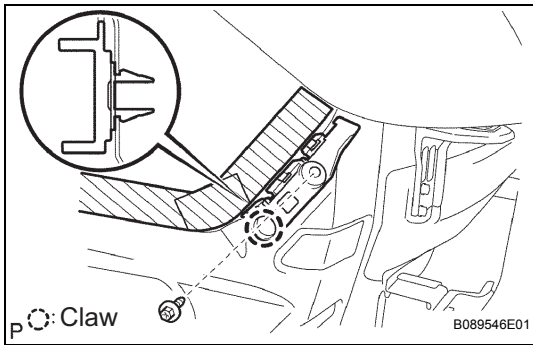
**5. REMOVE REAR BUMPER SIDE SUPPORT LH**

- (a) Remove the screw.
- (b) Disengage the claw and remove the rear bumper side support LH.

6. REMOVE REAR BUMPER SIDE SUPPORT RH

HINT:

Removal of the rear bumper side support RH is the same as the rear bumper side support LH.

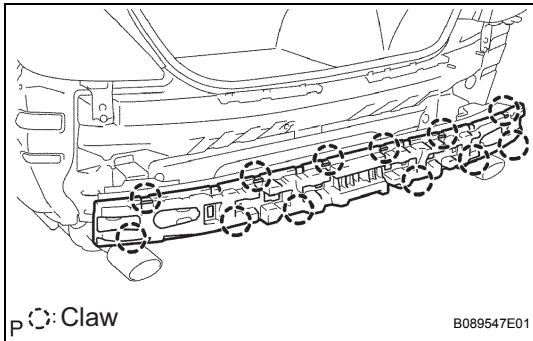
**7. REMOVE REAR BUMPER ENERGY ABSORBER**

- (a) Disengage the 12 claws and remove the rear bumper energy absorber.

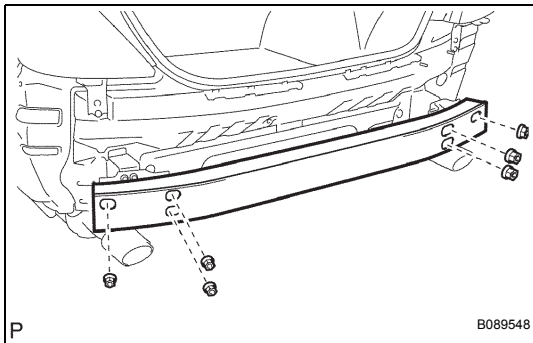
**8. REMOVE REAR BUMPER REINFORCEMENT NO.1**

- (a) Remove the 6 nuts and the rear bumper reinforcement No.1.

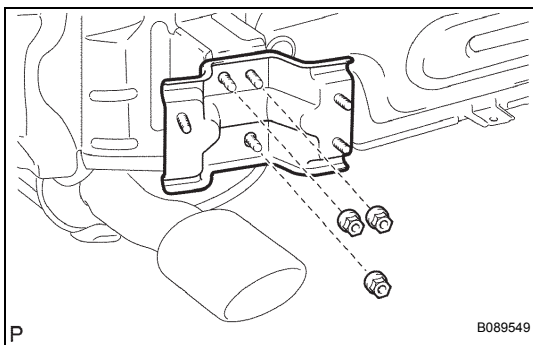
**9. REMOVE REAR BUMPER ARM MOUNTING BRACKET LH**

- (a) Remove the 3 nuts and the rear bumper arm mounting bracket LH.

10. REMOVE REAR BUMPER ARM MOUNTING BRACKET RH

HINT:

Removal of the rear bumper arm mounting bracket RH is the same as the rear bumper arm mounting bracket LH.

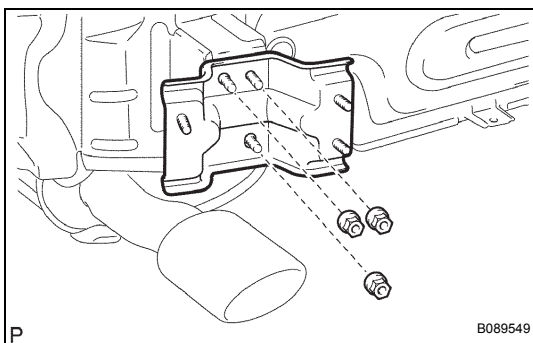
**11. REMOVE LICENSE PLATE LIGHT ASSEMBLY INSTALLATION****1. INSTALL REAR BUMPER ARM MOUNTING BRACKET LH**

- (a) Install the rear bumper arm mounting bracket LH with the 3 nuts.

Torque: 55 N*m (560 kgf*cm, 41 ft.*lbf)

2. INSTALL REAR BUMPER ARM MOUNTING BRACKET RH

HINT:

Installation of the rear bumper arm mounting bracket RH is the same as the rear bumper arm mounting bracket LH.

3. INSTALL REAR BUMPER REINFORCEMENT NO.1

- (a) Install the rear bumper reinforcement No.1 with the 6 nuts.

Torque: 55 N*m (560 kgf*cm, 41 ft.*lbf)

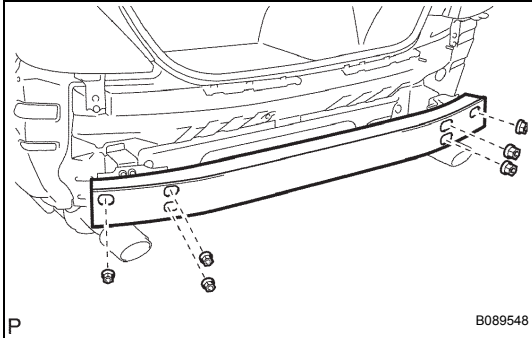

4. INSTALL REAR BUMPER ASSEMBLY

- (a) Install the rear bumper assembly with the 2 nuts, 4 screws and 2 clips.

Torque: 6.0 N*m (61 kgf*cm, 53 in.*lbf)

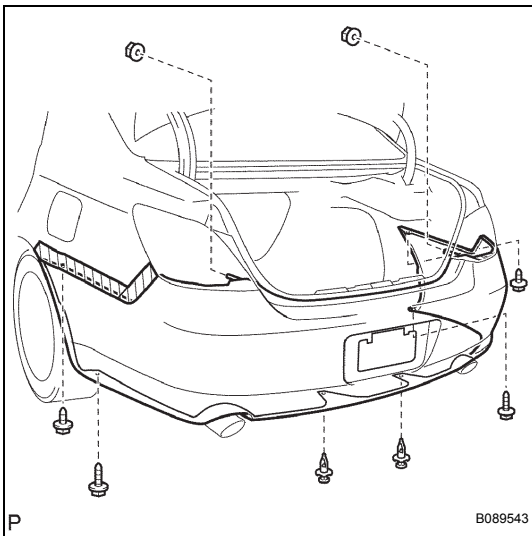

NAME PLATE COMPONENTS

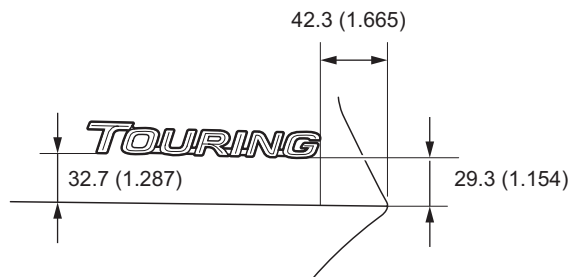
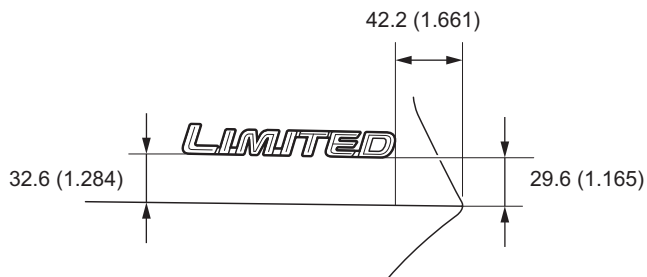
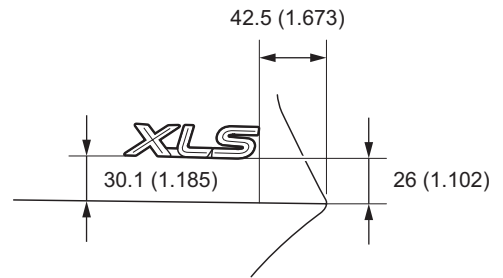
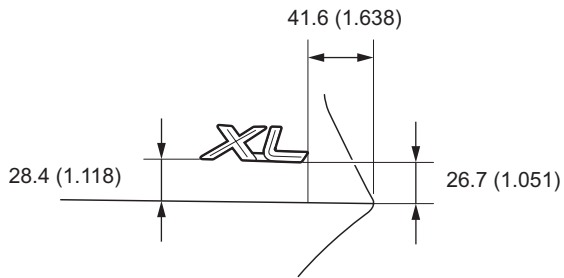
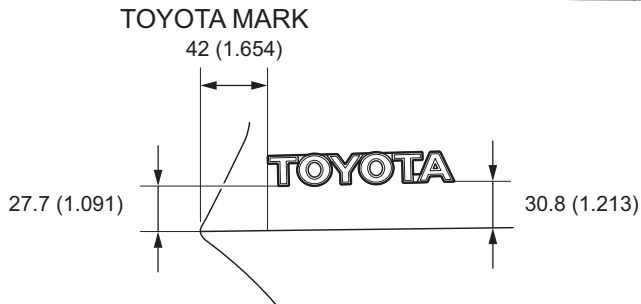
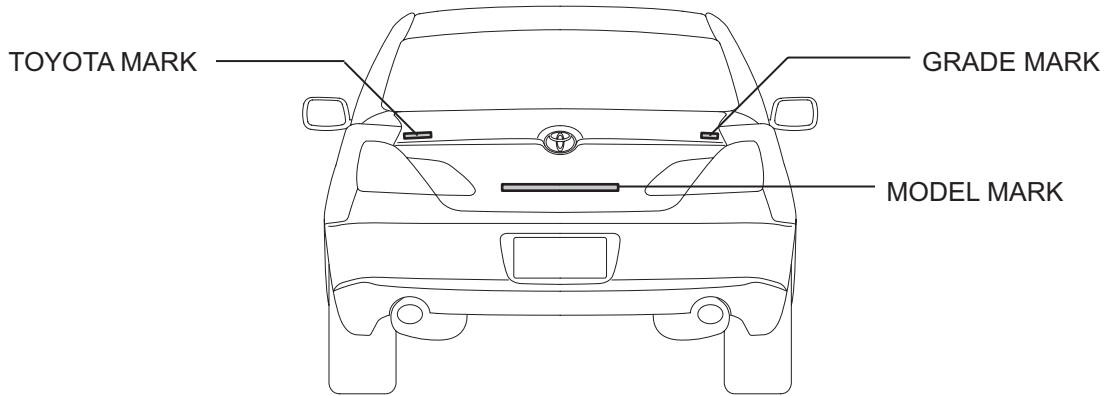

mm (in.)

ENGINE HOOD MOULDING

COMPONENTS

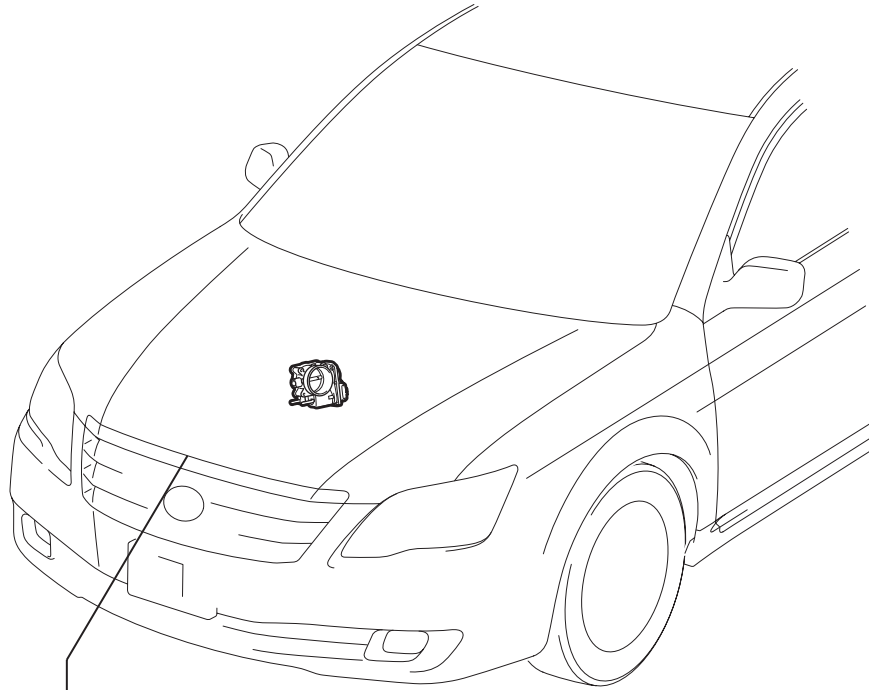

ENGINE HOOD MOULDING

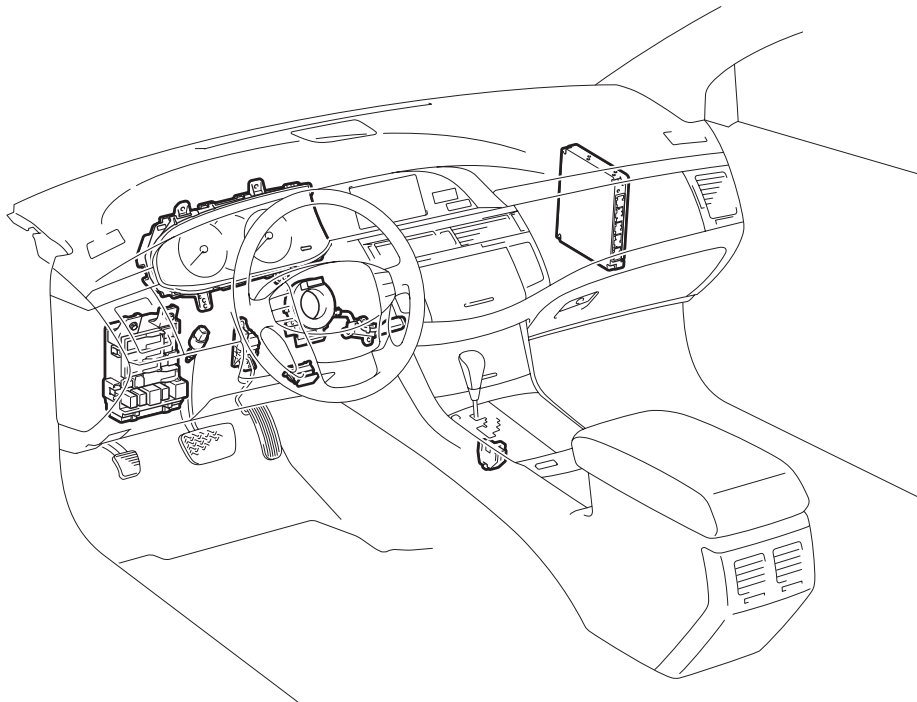

ET

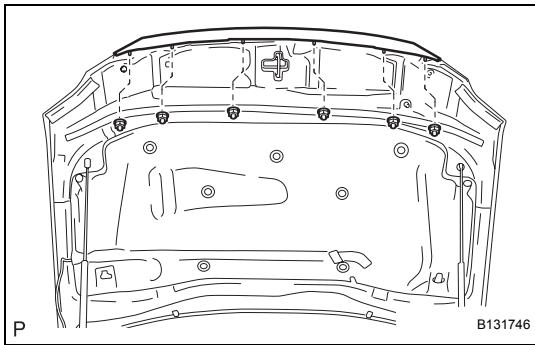

REMOVAL

1. **REMOVE ENGINE HOOD MOULDING**
 - (a) Remove the 6 nuts and the engine hood moulding.

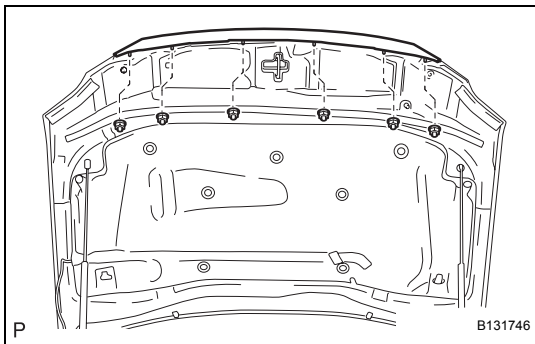

INSTALLATION

1. **INSTALL ENGINE HOOD MOULDING**
 - (a) Install the engine hood moulding with the 6 nuts.

ENGINE HOOD MOULDING

COMPONENTS

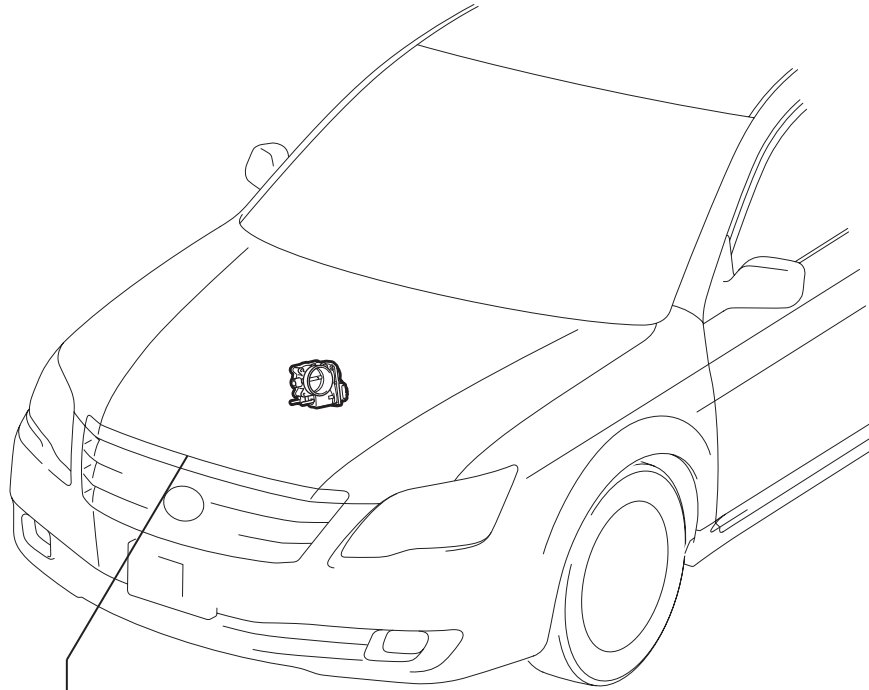

ENGINE HOOD MOULDING

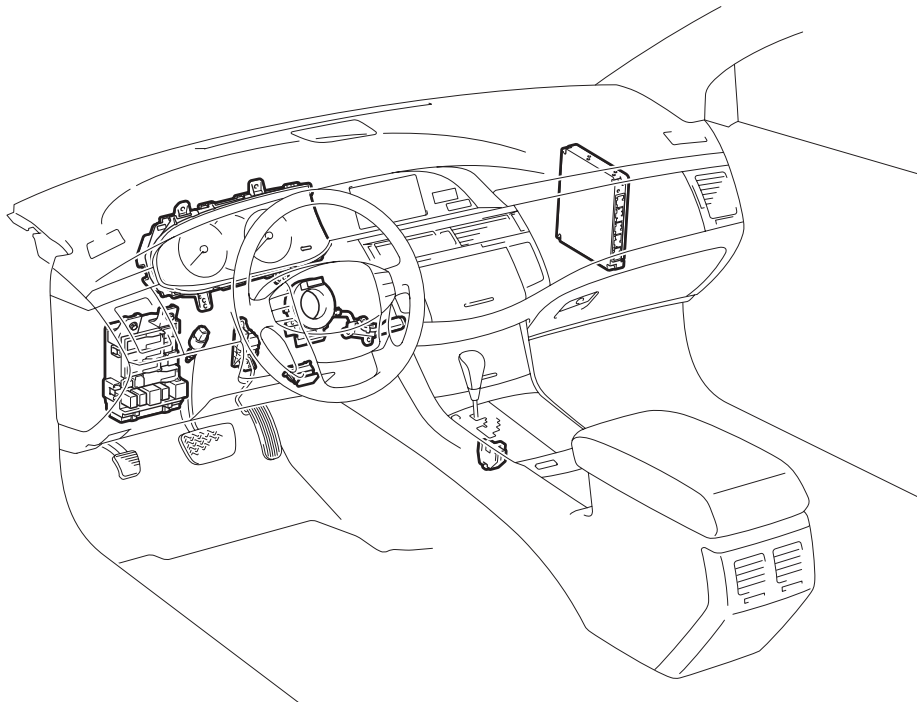

ET

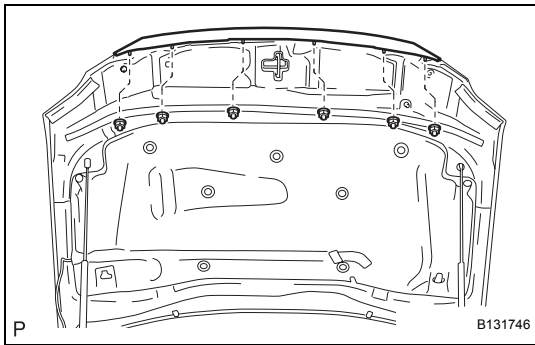

REMOVAL

1. **REMOVE ENGINE HOOD MOULDING**
 - (a) Remove the 6 nuts and the engine hood moulding.

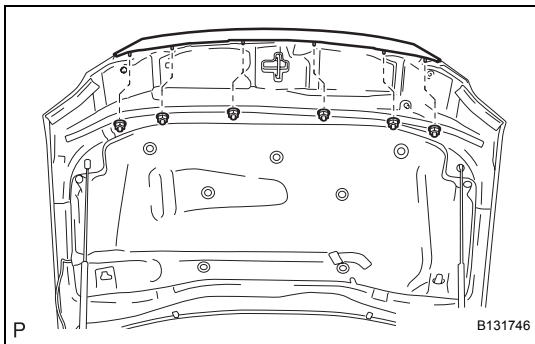

INSTALLATION

1. **INSTALL ENGINE HOOD MOULDING**
 - (a) Install the engine hood moulding with the 6 nuts.

FRONT DOOR BELT MOULDING

COMPONENTS

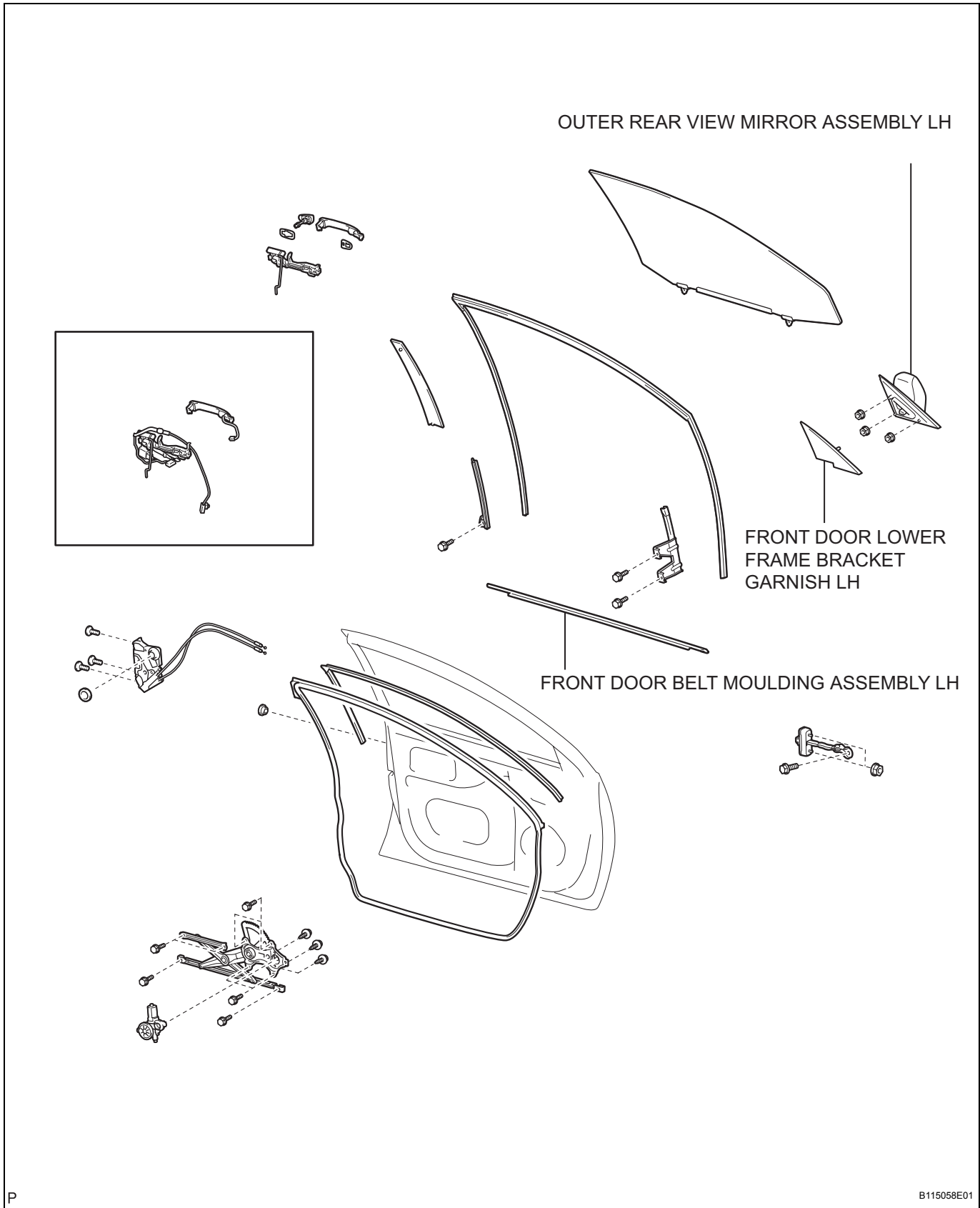

ET

FRONT ARMREST BASE PANEL UPPER LH

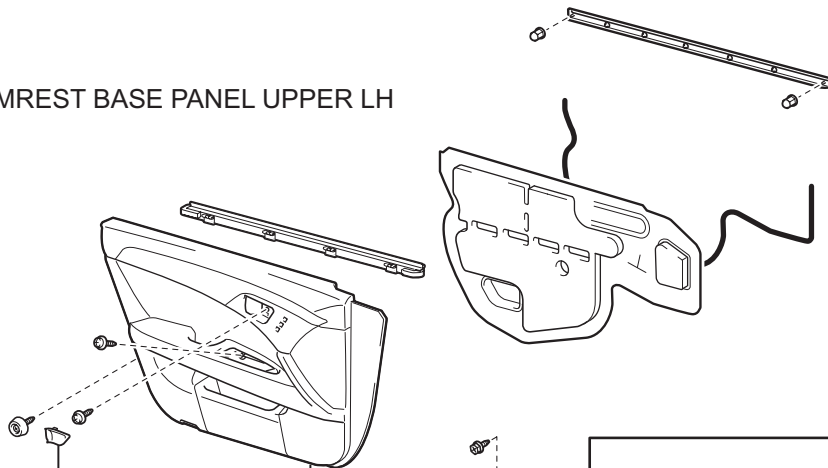
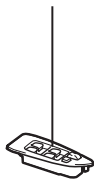

FRONT DOOR INSIDE
HANDLE BEZEL PLUG LH

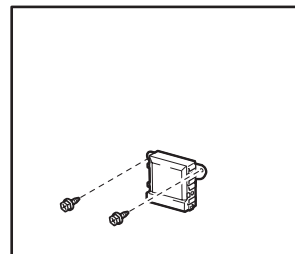
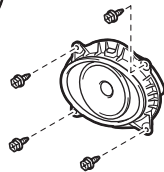

FRONT DOOR TRIM BOARD SUB-ASSEMBLY LH

REMOVAL

1. REMOVE FRONT DOOR LOWER FRAME BRACKET GARNISH LH
2. REMOVE FRONT DOOR INSIDE HANDLE BEZEL PLUG LH
3. REMOVE FRONT ARMREST BASE PANEL UPPER LH
4. REMOVE FRONT DOOR TRIM BOARD SUB-ASSEMBLY LH
5. REMOVE OUTER REAR VIEW MIRROR ASSEMBLY LH
HINT:
See page [MI-37](#)
6. REMOVE FRONT DOOR BELT MOULDING ASSEMBLY LH
 - (a) Completely lower window glass.
 - (b) Using a screwdriver with its tip taped, slide the 6 clips (A) along the front door belt moulding to disengage them from the door.
 - (c) Rotated the front door belt moulding in the arrow direction to disengage the 2 clips (B).

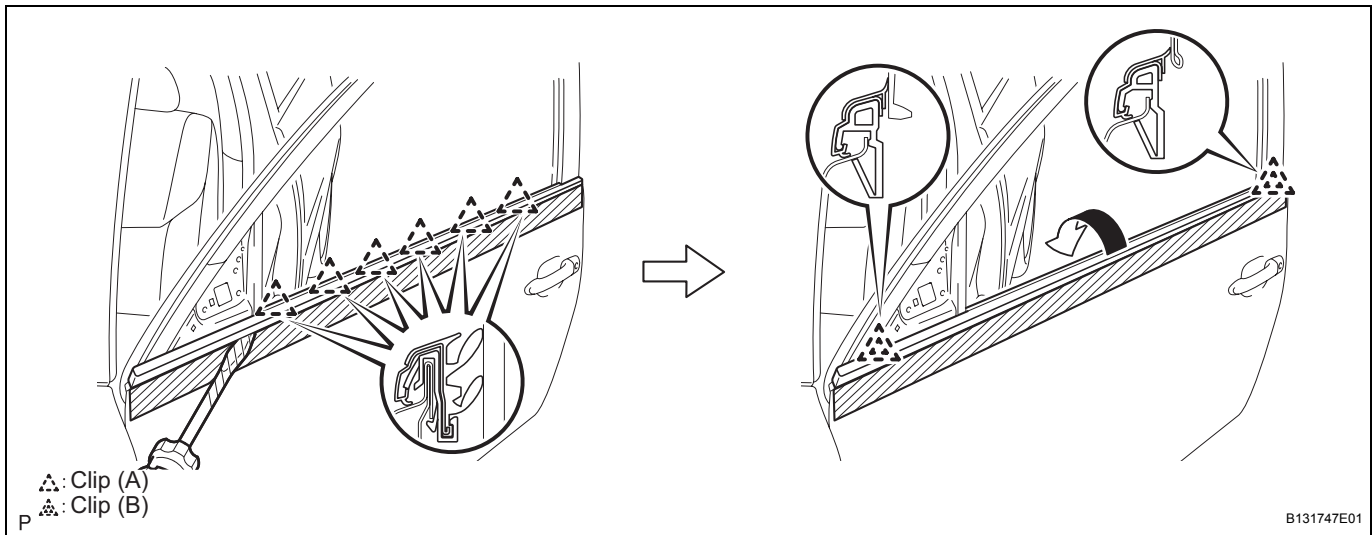

- (d) Remove the front door belt moulding assembly LH.
NOTICE:
When disengaging the clips (B), be careful not to break them because they are easy to break.

INSTALLATION

1. INSTALL FRONT DOOR BELT MOULDING ASSEMBLY LH

- (a) If reusing the belt moulding:
Put the clips (B) back to each mark on the belt moulding before installing it to the door.

2. INSTALL OUTER REAR VIEW MIRROR ASSEMBLY LH

HINT:

See page [MI-39](#)

REMOVAL

1. REMOVE REAR DOOR BELT MOULDING ASSEMBLY LH

- (a) Completely lower window glass.
- (b) Using a screwdriver with its tip taped, slide the 6 clips (A) along the rear door belt moulding to disengage them from the door.
- (c) Rotated the rear door belt moulding in the arrow direction to disengage the 2 clips (B).

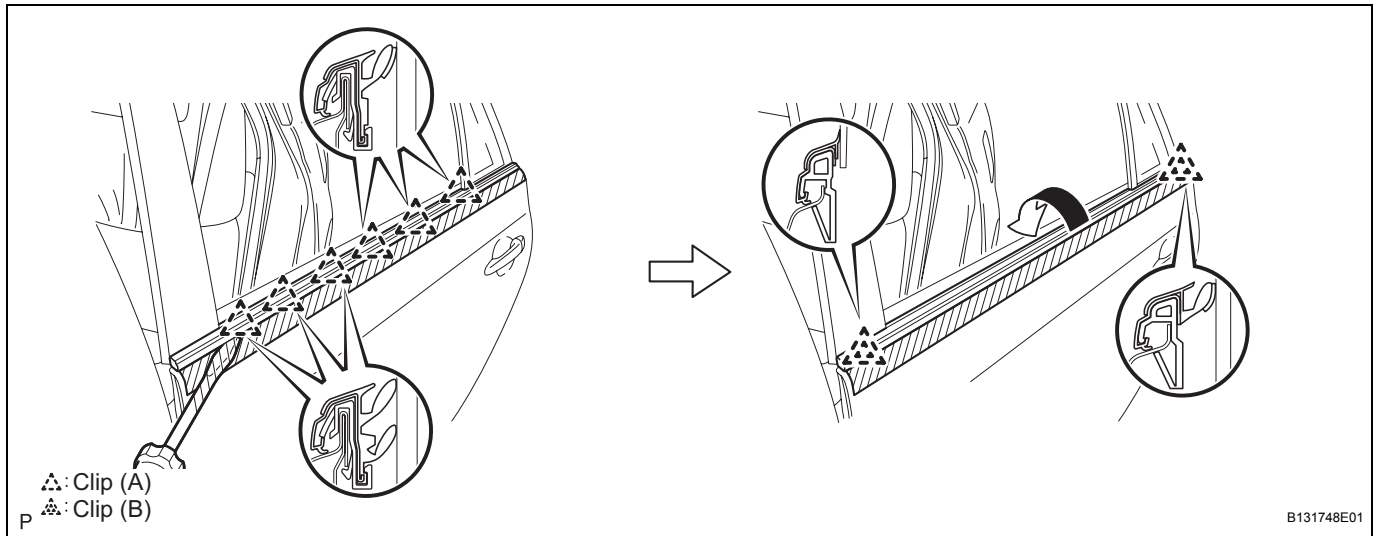

- (d) Remove the rear door belt moulding assembly LH.
NOTICE:
When disengaging the clips (B), be careful not to break them because they are easy to break.

INSTALLATION

1. **INSTALL REAR DOOR BELT MOULDING ASSEMBLY LH**
 - (a) If reusing the belt moulding:
Put the clips (B) back to each mark on the belt moulding before installing it to the door.

ROOF DRIP SIDE FINISH MOULDING

COMPONENTS

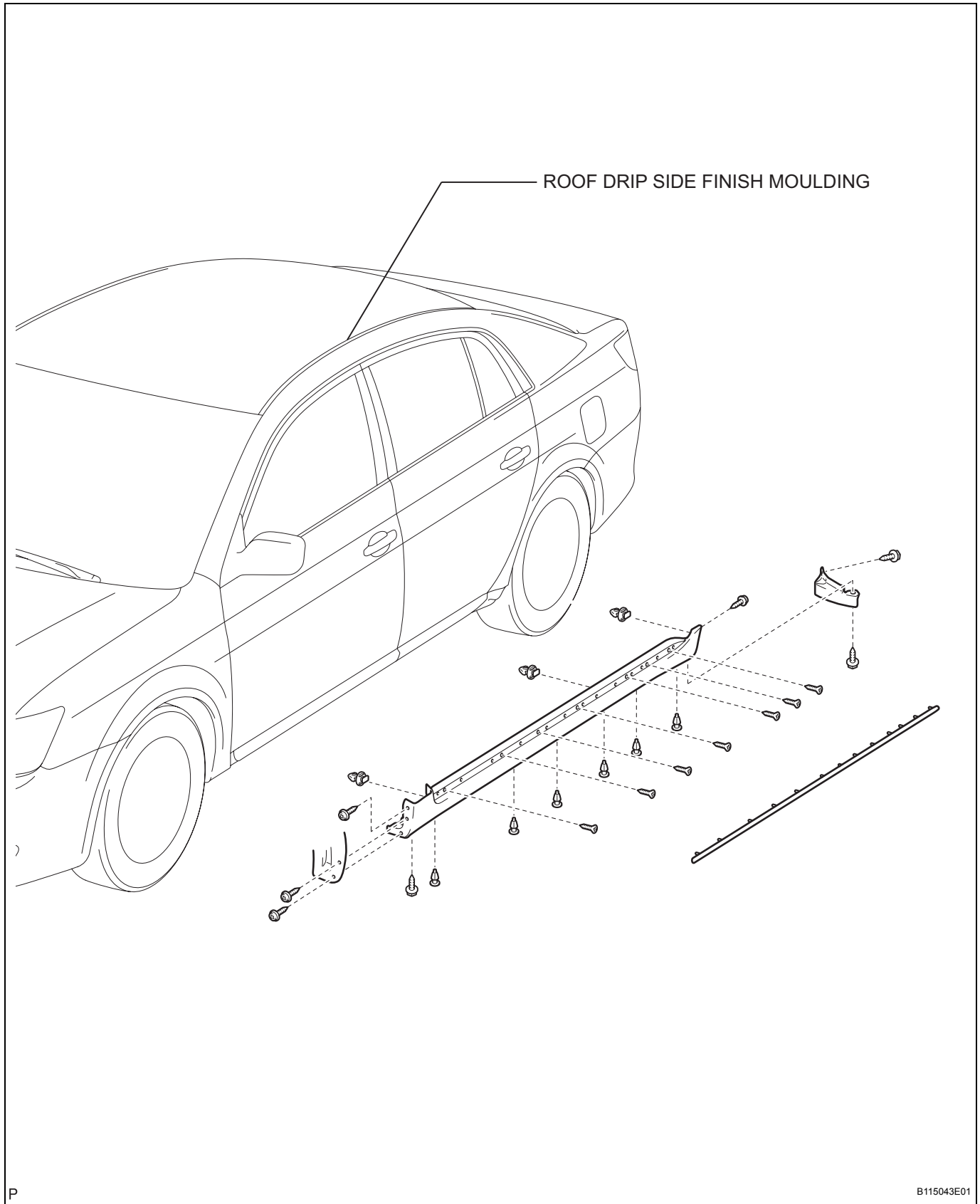

ET

REMOVAL

HINT:

When replacing the moulding, heat the body and moulding using a heat light.

Heating temperature

Item	Temperature
Body	40 to 60°C (104 to 140°F)
Moulding	20 to 30°C (68 to 86°F)

NOTICE:

Do not heat the body and moulding excessively.

1. REMOVE ROOF DRIP SIDE FINISH MOULDING

- (a) Put protective tape around the edges of the moulding.
- (b) Using a moulding remover, disengage the 2 moulding's front and rear end clips from the vehicle.
- (c) Remove the roof drip finish moulding.

NOTICE:

- Do not remove the clips from the vehicle body.
- If the clips are damaged or removed accidentally, replace them.

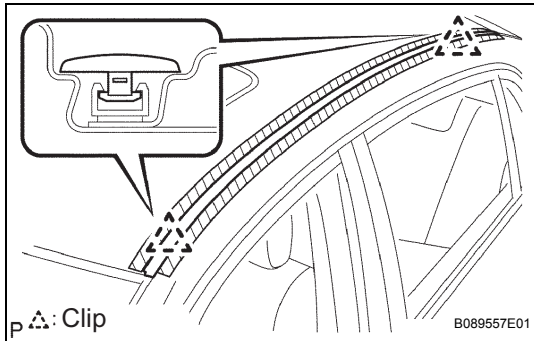

INSTALLATION

1. INSTALL ROOF DRIP SIDE FINISH MOULDING CLIP

HINT:

Follow steps (a) to (c) only when replacing the clips.

(a) Remove the tape that remains on the mounting surface of the body, and then clean the surface with white gasoline.

(b) Heat the clip installation surfaces of the body and moulding.

NOTICE:

Do not heat the body and moulding excessively.

(c) Install new clips in the positions shown in the illustration. Press-fit the clips by hand.

NOTICE:

After press-fitting the clips, wait for 30 minutes or more before installing the moulding.

HINT:

- Minimum hardening time: 30 minutes
- Time needed for complete hardening: 24 hours

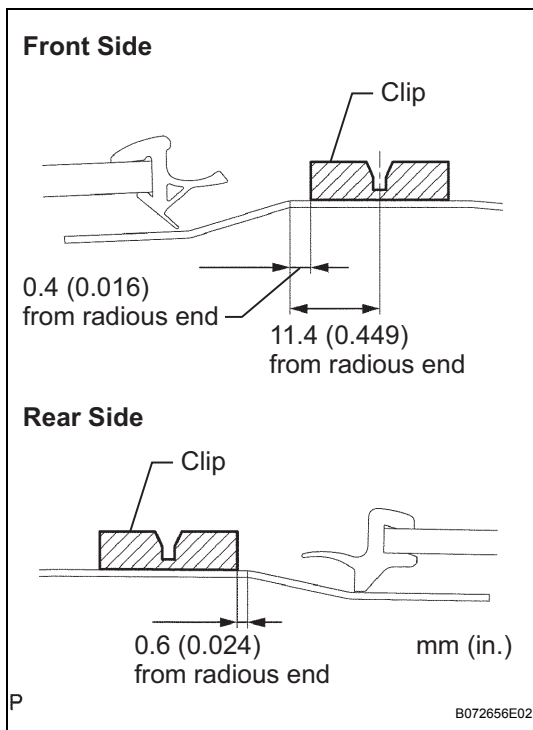

OUTSIDE MOULDING

COMPONENTS

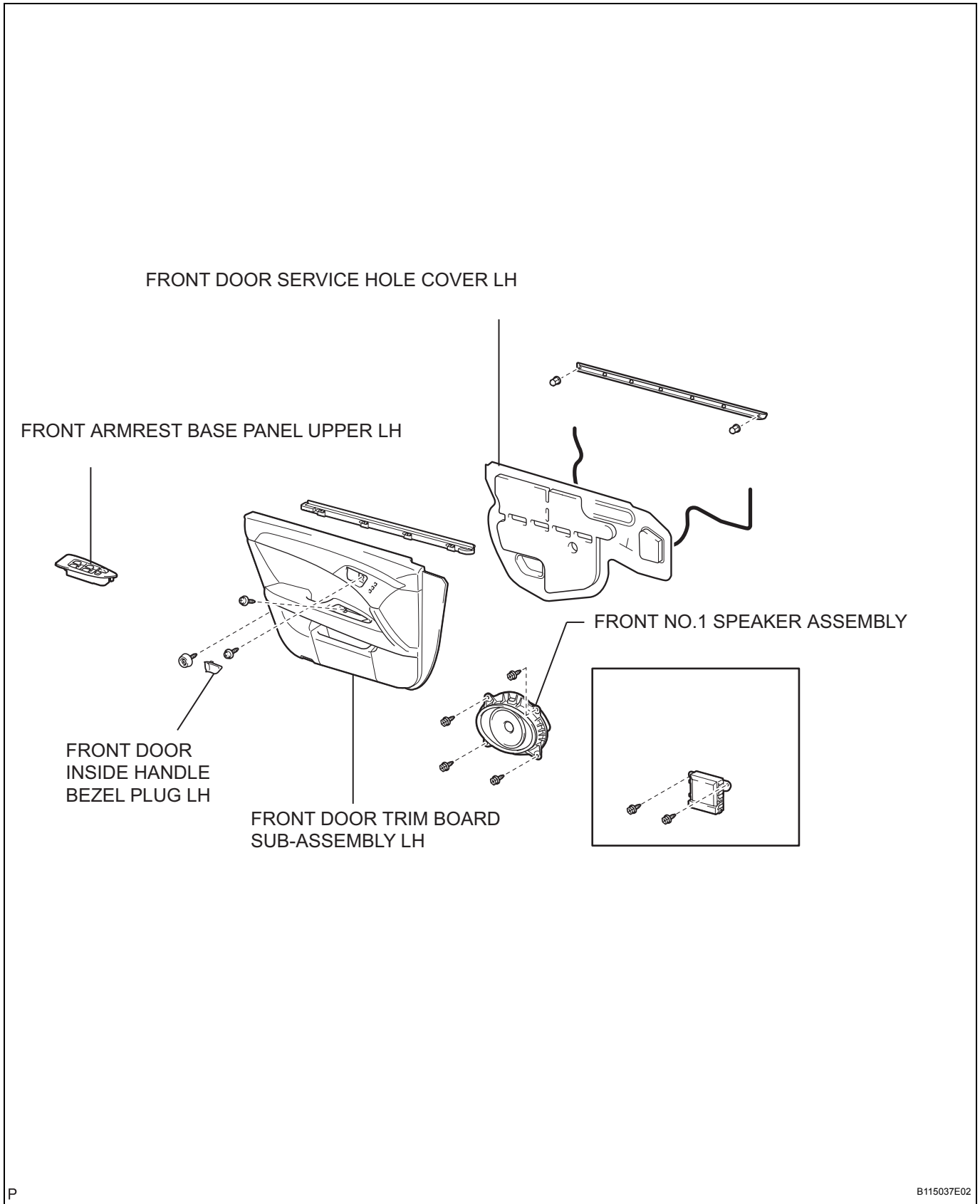

ET

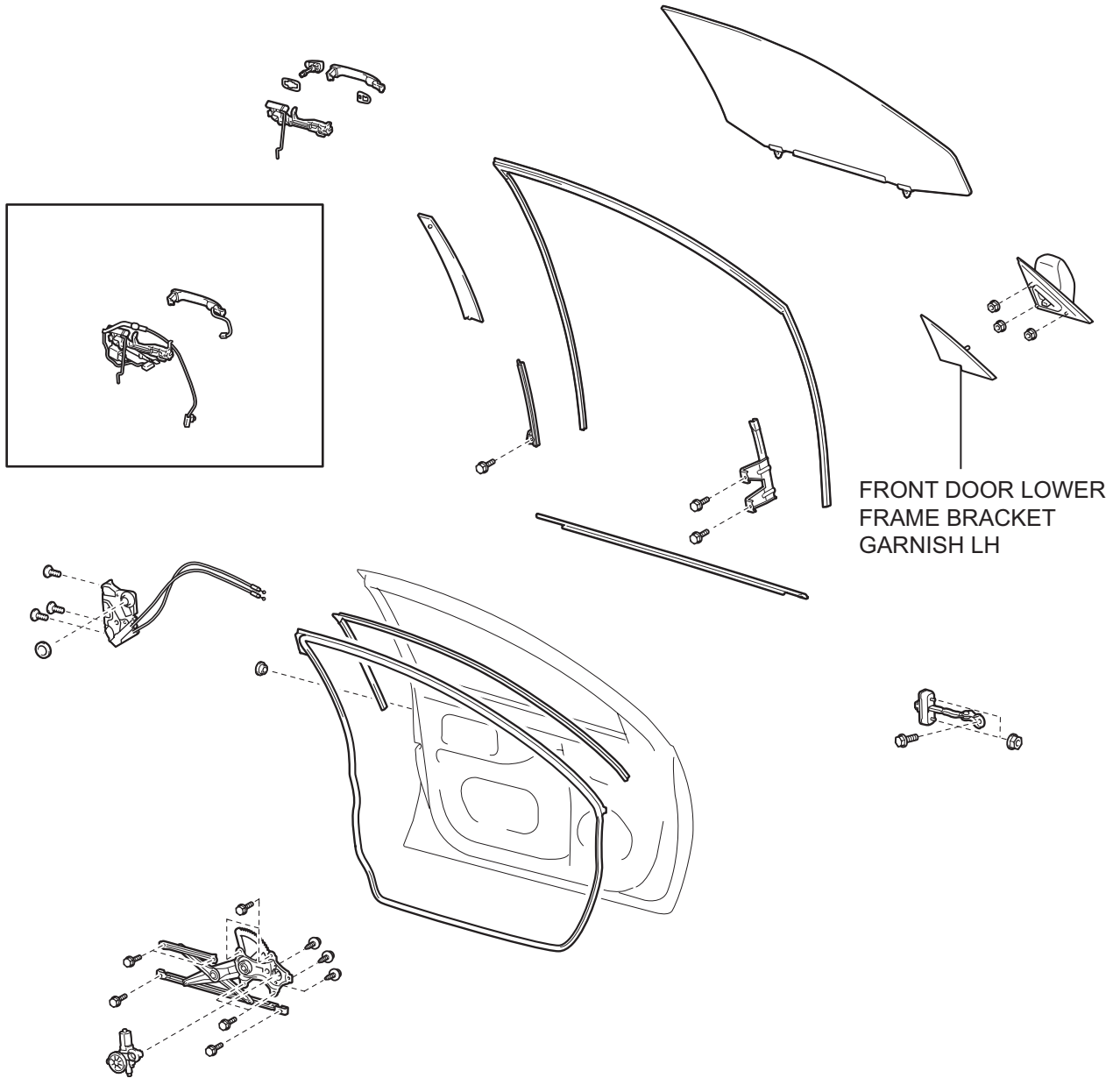

ET

REAR DOOR ARMREST BASE PANEL UPPER LH

REAR DOOR SERVICE HOLE COVER LH

REAR DOOR TRIM BOARD SUB-ASSEMBLY LH

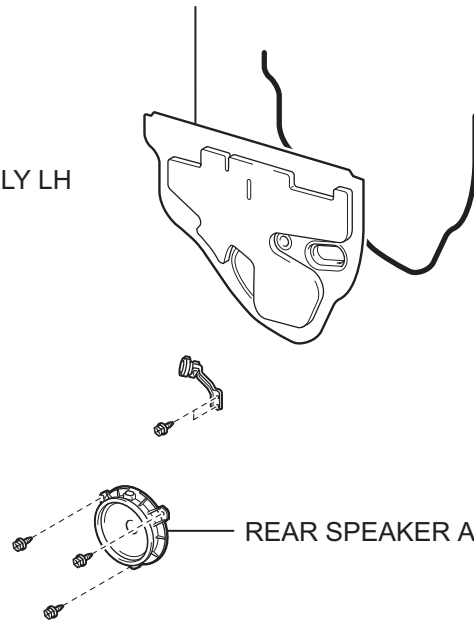
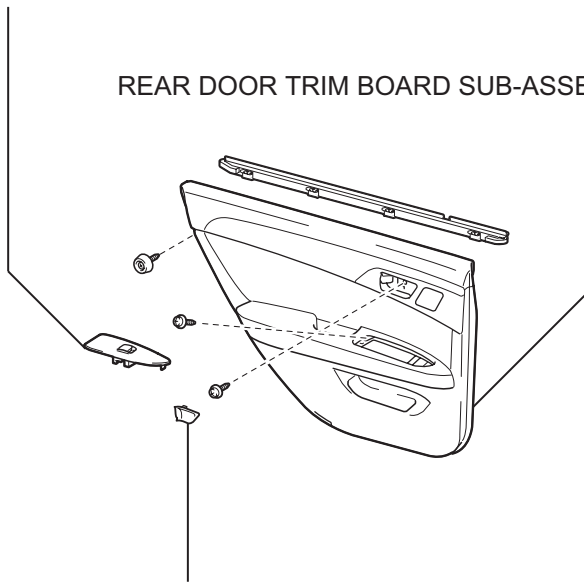

REAR DOOR INSIDE HANDLE BEZEL PLUG LH

REAR SPEAKER ASSEMBLY

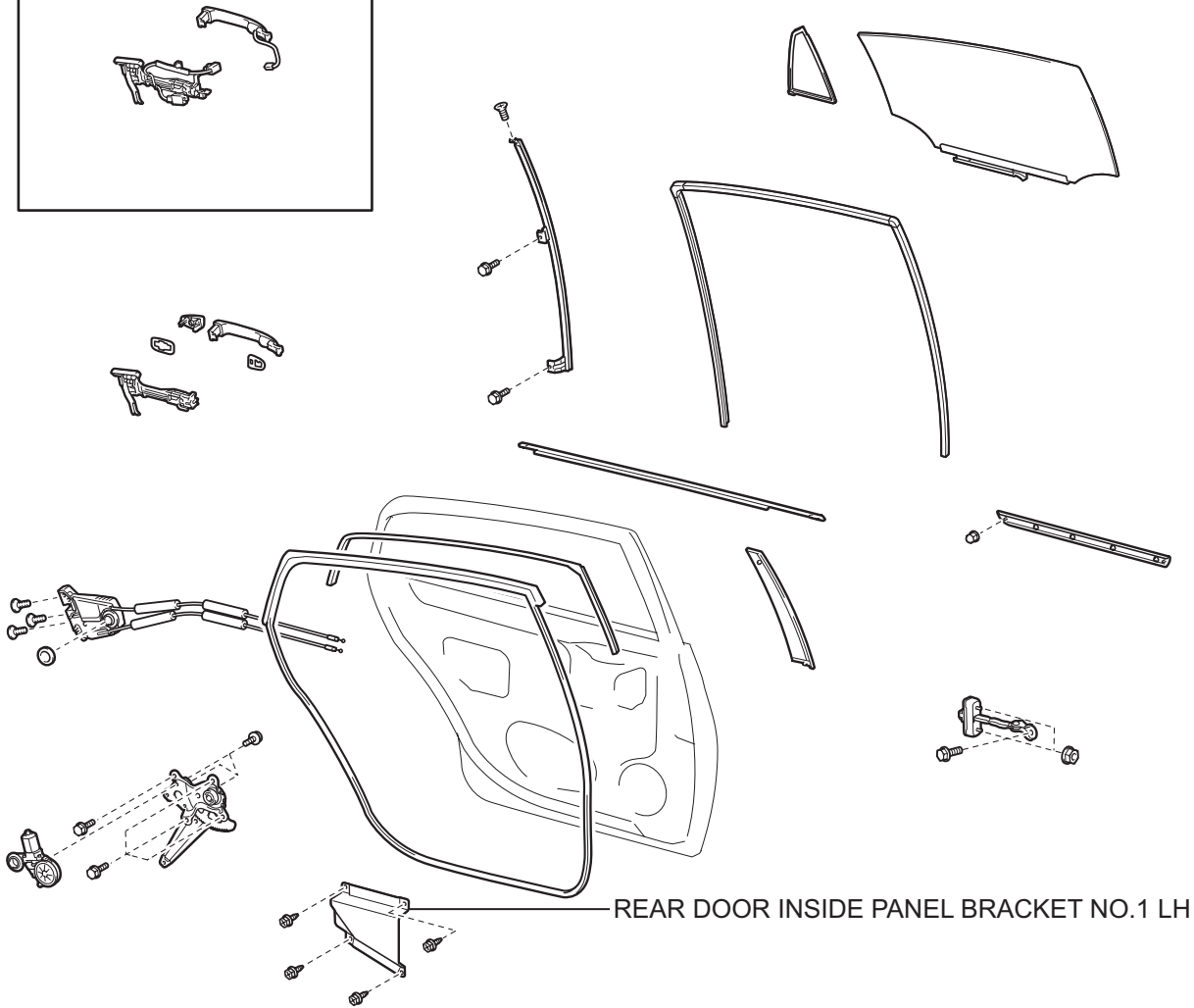
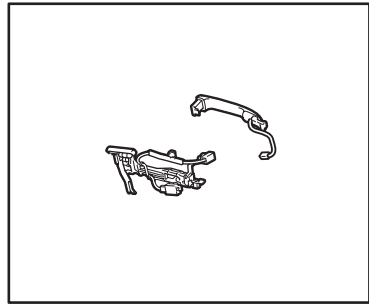

REAR DOOR INSIDE PANEL BRACKET NO.1 LH

ET

OUTSIDE MOULDING

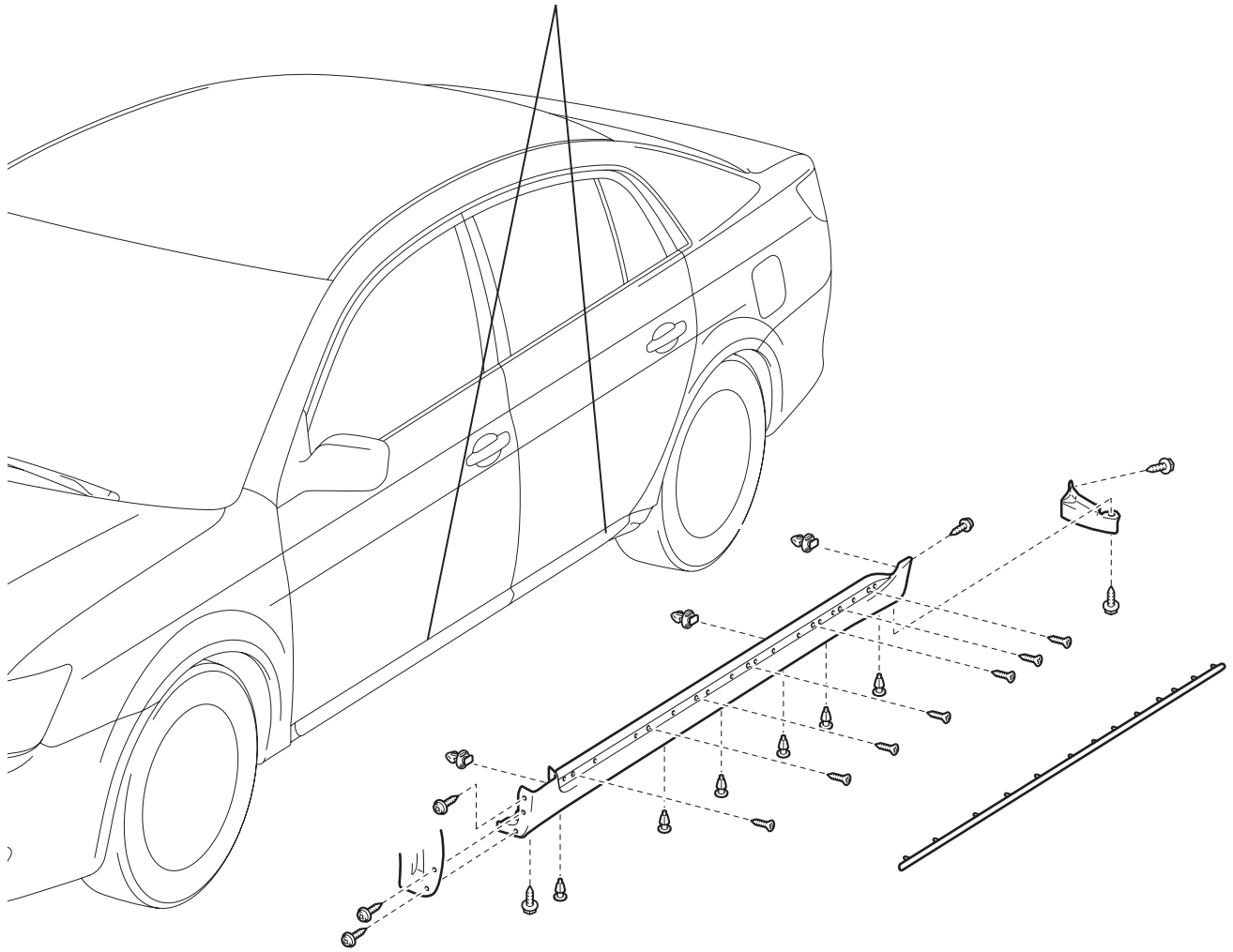

ET

REMOVAL

1. REMOVE FRONT DOOR LOWER FRAME BRACKET GARNISH LH
2. REMOVE FRONT DOOR INSIDE HANDLE BEZEL PLUG LH
3. REMOVE FRONT ARMREST BASE PANEL UPPER LH
4. REMOVE FRONT DOOR TRIM BOARD SUB-ASSEMBLY LH
5. REMOVE FRONT NO.1 SPEAKER ASSEMBLY
6. REMOVE FRONT DOOR SERVICE HOLE COVER LH
7. REMOVE REAR DOOR INSIDE HANDLE BEZEL PLUG LH
8. REMOVE REAR DOOR ARMREST BASE PANEL UPPER LH
9. REMOVE REAR DOOR TRIM BOARD SUB-ASSEMBLY LH
10. REMOVE REAR DOOR INSIDE PANEL BRACKET NO.1 LH
11. REMOVE REAR SPEAKER ASSEMBLY
12. REMOVE REAR DOOR SERVICE HOLE COVER LH

HINT:

When replacing the moulding, heat the body and moulding using a heat light.

Heating temperature

Item	Temperature
Body	40 to 60°C (104 to 140°F)
Moulding	20 to 30°C (68 to 86°F)

NOTICE:

Do not heat the body and moulding excessively.

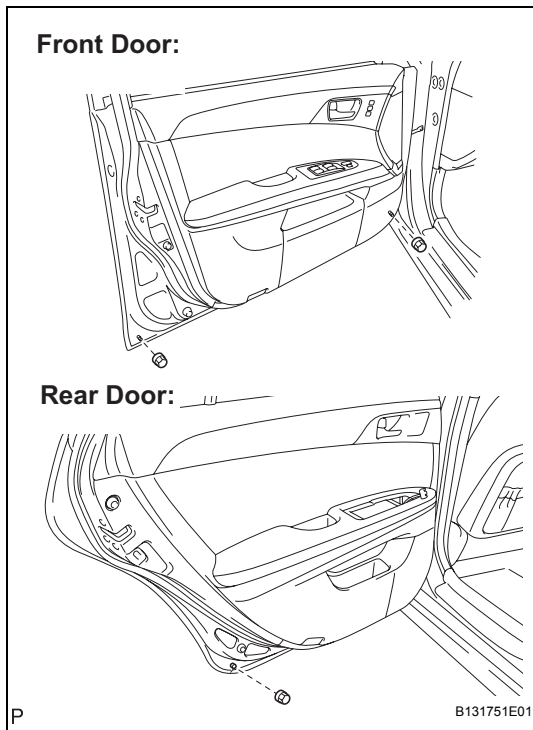
**13. REMOVE OUTSIDE MOULDING**

- (a) Front Door:
Remove the 2 nuts.
- (b) Rear Door:
Remove the nut.

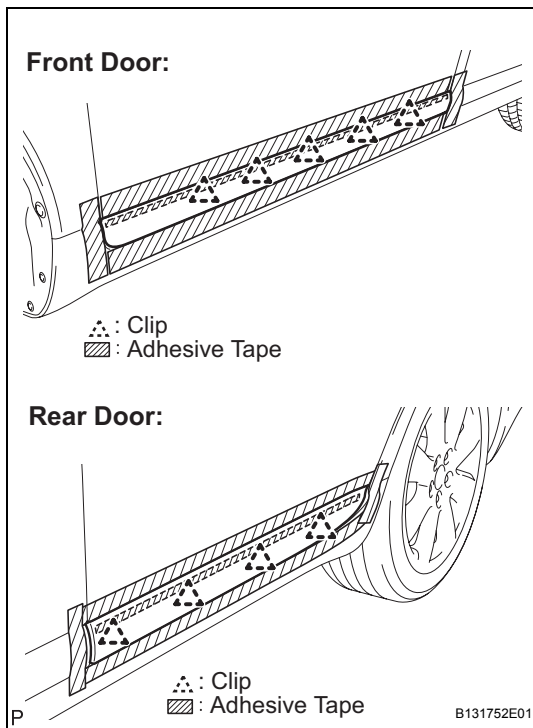

- (c) Put protective tape around the edges of the moulding.
- (d) Using a heat light, heat the moulding.
NOTICE:
Do not heat the moulding excessively.
- (e) Using a moulding remover, remove the clips and the outside moulding.

INSTALLATION

1. INSTALL OUTSIDE MOULDING

- (a) Using a heat light, heat the body.
- (b) Remove the protective tape from the body.
- (c) Wipe off the stains with cleaner.
- (d) Clean the moulding (if reusing the moulding).
 - (1) Using a heat light, heat the moulding.
 - (2) Remove the double-sided tape from the moulding.
 - (3) Wipe off the stains with cleaner.
 - (4) Apply new double-sided tape to the moulding as shown in the illustration.
- (e) Using a heat light, heat the body and moulding.
- (f) Remove the peeling paper from the face of the moulding and attach the moulding securely to the vehicle body.

NOTICE:

Be careful that dirt or foreign objects do not stick to adhesive part when removing the peeling paper.

- (g) Push the moulding to the body.

NOTICE:

Do not apply excessive force onto the moulding. Instead, apply steady pressure with your thumbs.

- (h) Front Door:
Install the outside moulding with the 2 nuts.
- (i) Rear Door:
Install the outside moulding with the nut.

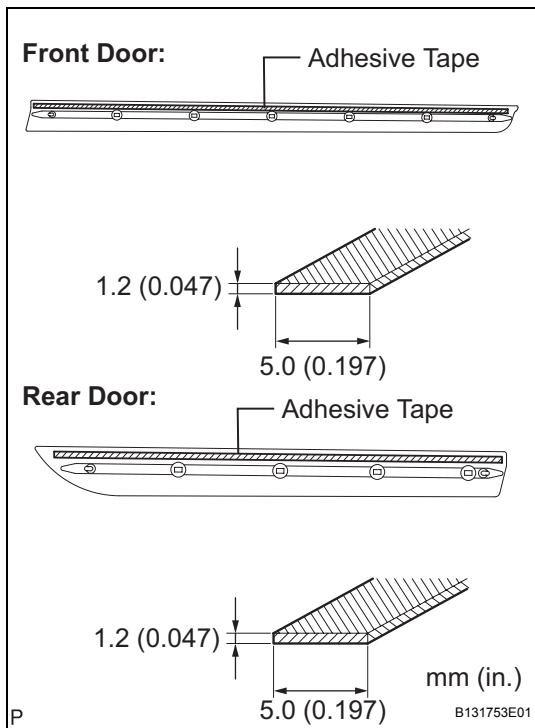

ROCKER PANEL MOULDING

COMPONENTS

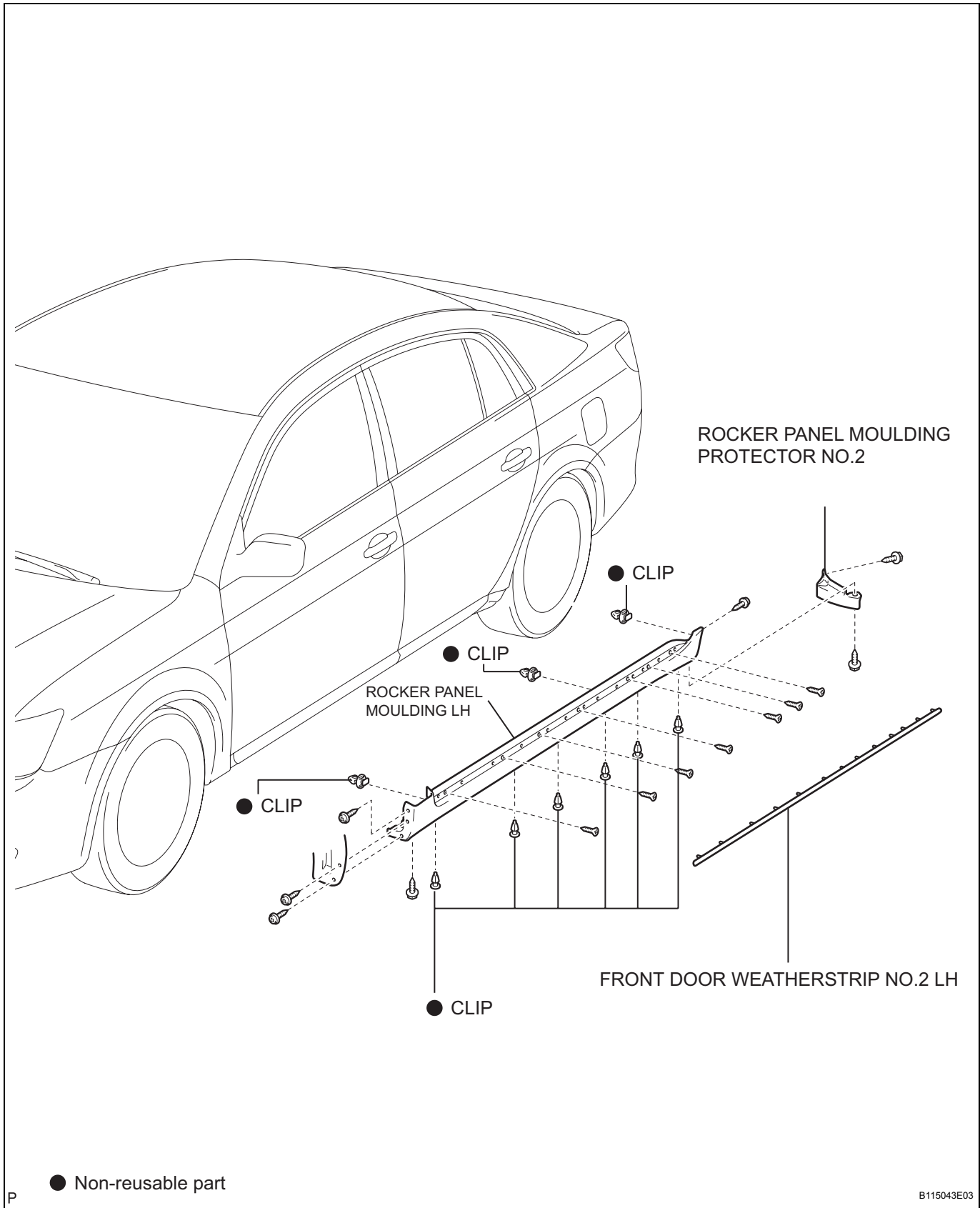

REMOVAL

1. REMOVE ROCKER PANEL MOULDING PROTECTOR NO.2
2. REMOVE FRONT DOOR WEATHERSTRIP NO.2 LH
3. REMOVE ROCKER PANEL MOULDING LH
 - (a) Remove the 6 clips.

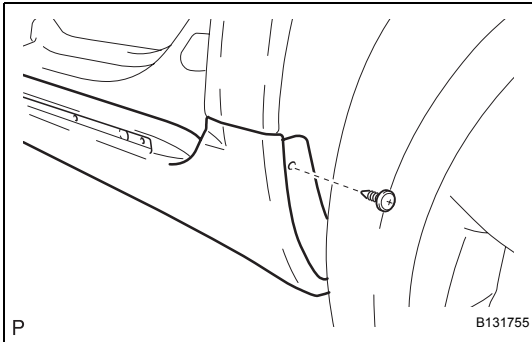
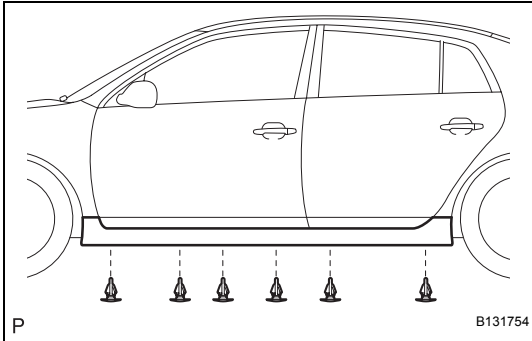

- (b) Remove the screw.

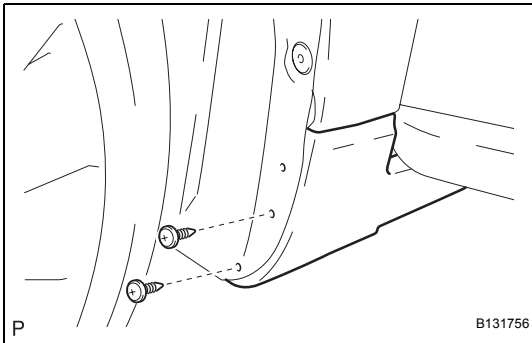

- (c) Remove the 2 screws.

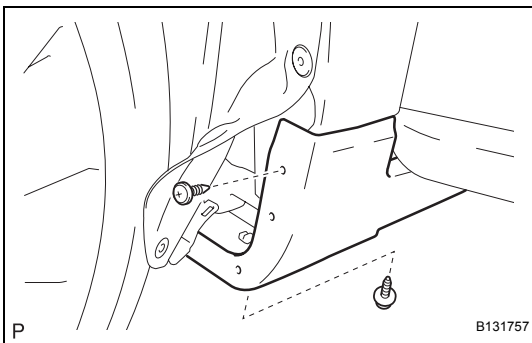

- (d) Remove the 2 screws.

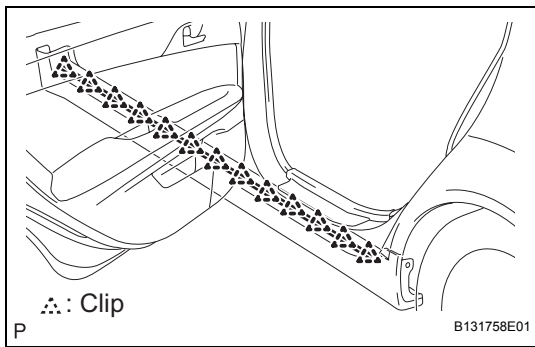

(e) Disengage the 13 clips and remove the front door weatherstrip No.2 LH.

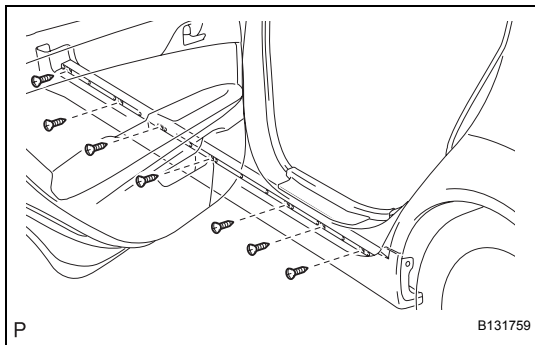

(f) Remove the 7 screws.

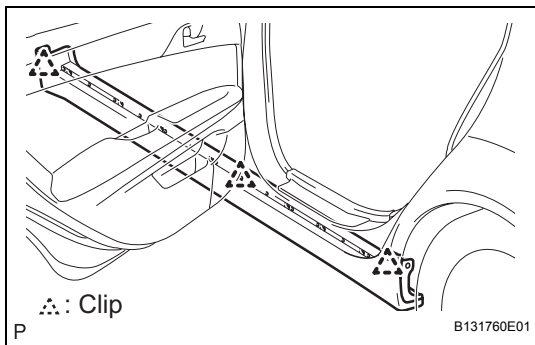

(g) Disengage the 3 clips and remove the rocker panel moulding LH.

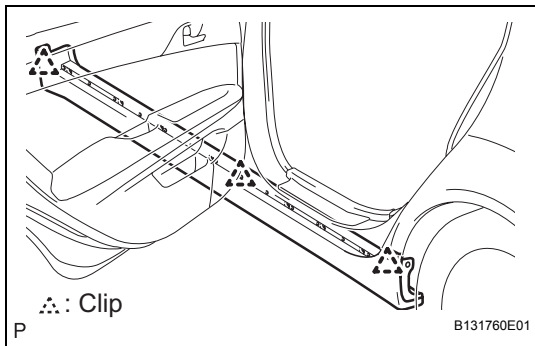

INSTALLATION

1. INSTALL ROCKER PANEL MOULDING LH

(a) Engage the 3 new clips and the rocker panel moulding LH.

NOTICE:

Always use new clips at the time of installation.

(b) Install the rocker panel moulding LH with the 6 new clips.

NOTICE:

Always use new clips at the time of installation.

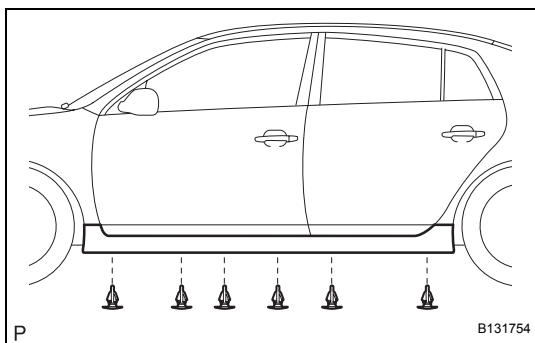

FRONT DOOR WINDOW FRAME MOULDING

COMPONENTS

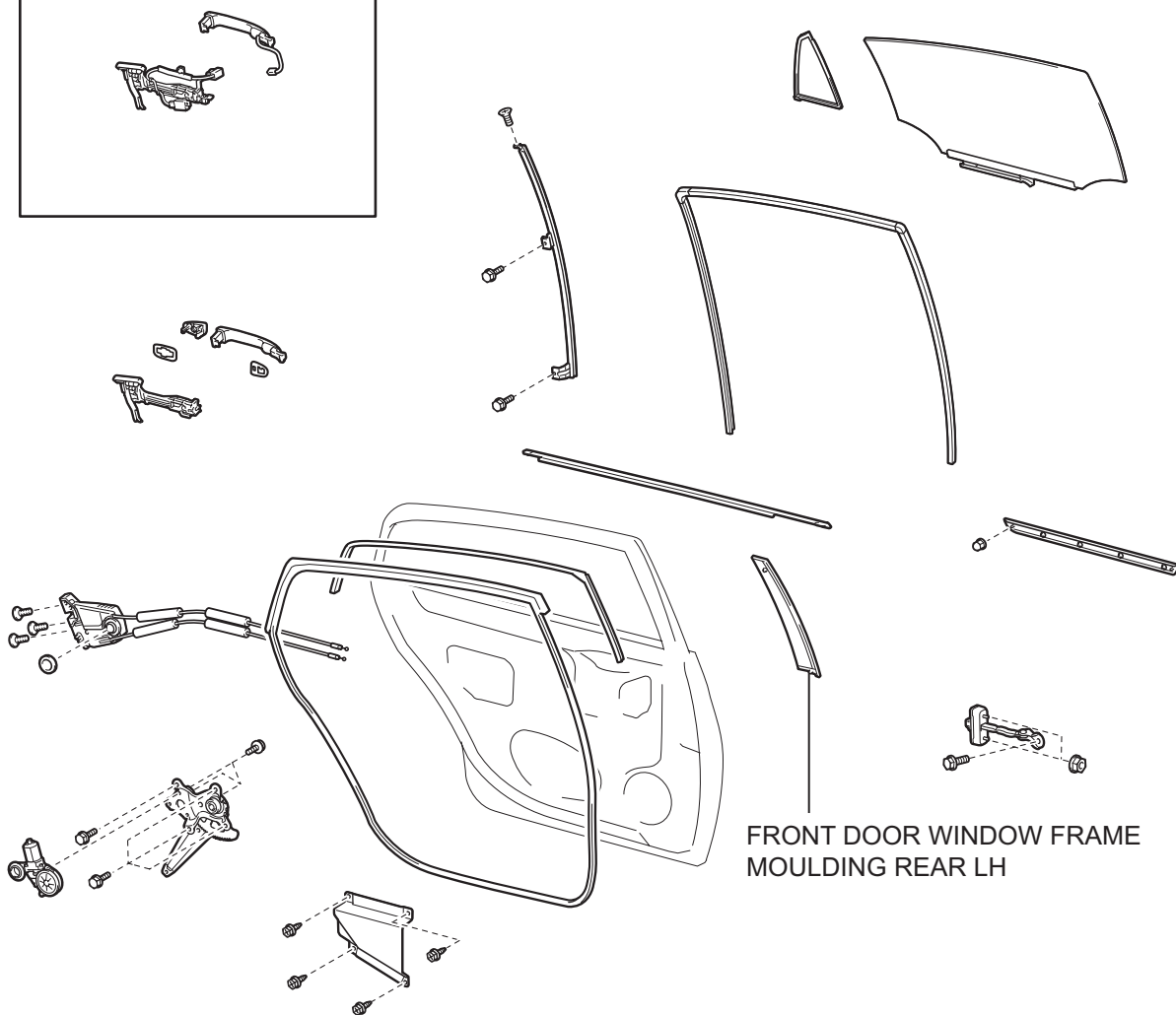
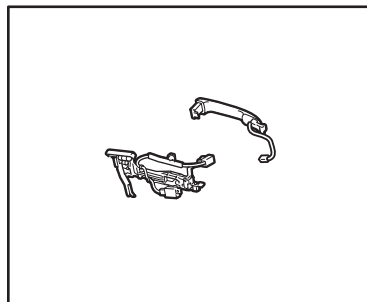

FRONT DOOR WINDOW FRAME MOULDING REAR LH

ET

REMOVAL

HINT:

When replacing the moulding, heat the body and moulding using a heat light.

Heating temperature

Item	Temperature
Body	40 to 60°C (104 to 140°F)
Moulding	20 to 30°C (68 to 86°F)

NOTICE:

Do not heat the moulding excessively.

1. REMOVE FRONT DOOR WINDOW FRAME MOULDING REAR LH

- (a) Completely lower window glass.
- (b) Using a heat light, heat the body moulding.

NOTICE:

Do not heat the moulding excessively.

- (c) Using a moulding remover, remove the clip and the front door window frame moulding rear LH.

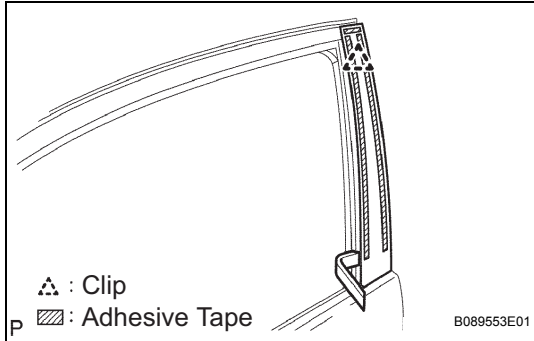

INSTALLATION

1. INSTALL FRONT DOOR WINDOW FRAME MOULDING REAR LH

- (a) Using a heat light, heat the body mounting surface.

NOTICE:

Do not heat the spoiler excessively.

- (b) Remove the protective tape from the body.
(c) Wipe off the stains with cleaner.
(d) Align the standard point with the hole on the door window frame.
(e) Engage the clip and install the front door window frame moulding rear LH.

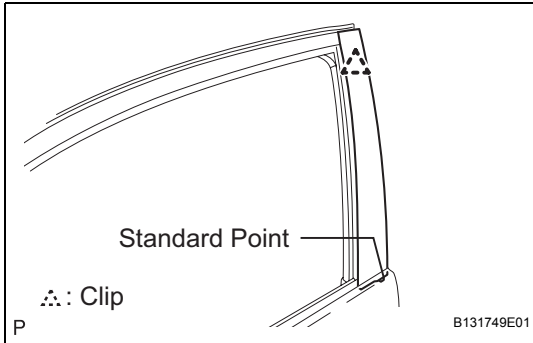

REAR DOOR WINDOW FRAME MOULDING

COMPONENTS

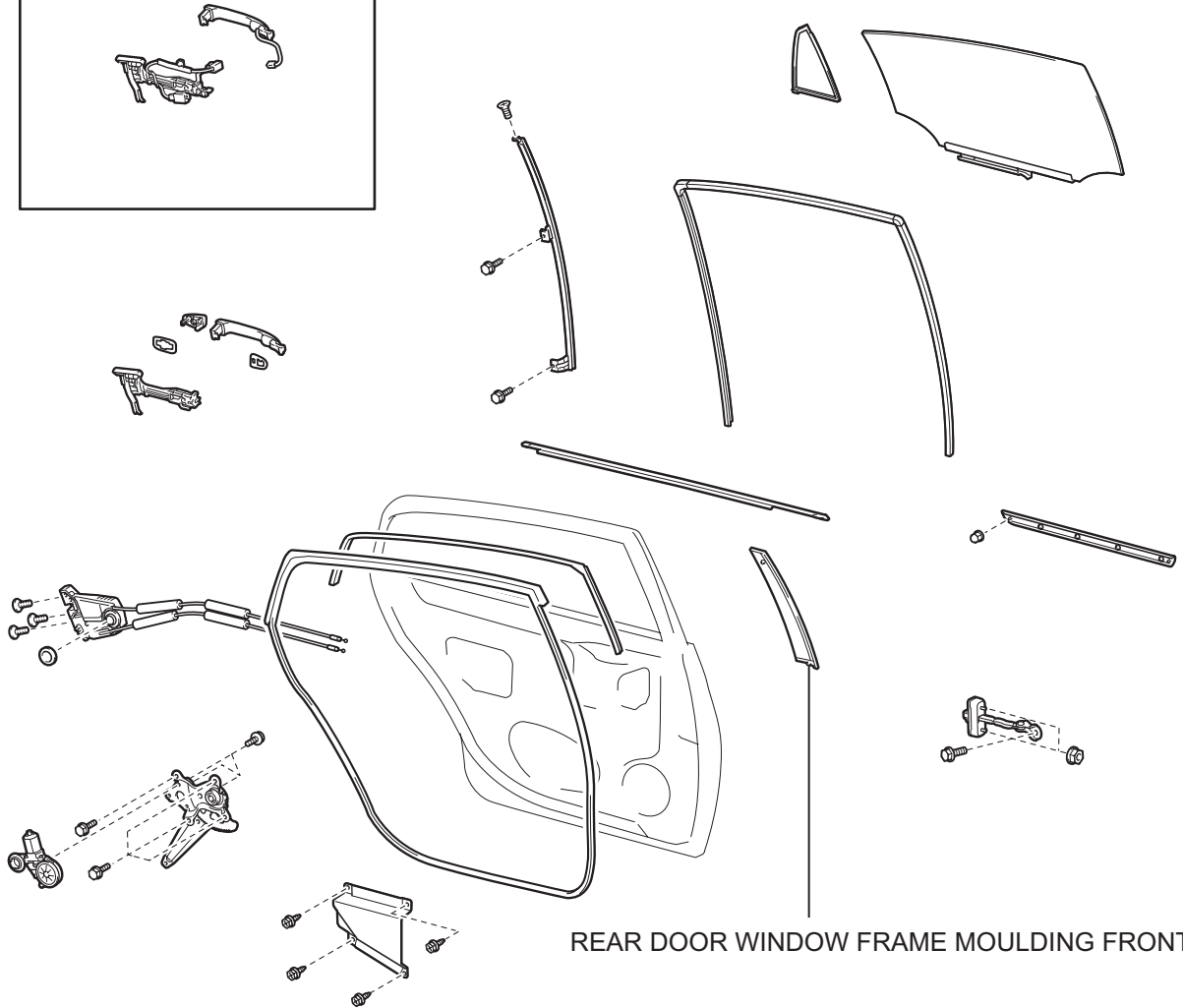
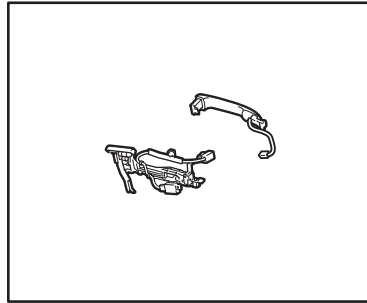

REAR DOOR WINDOW FRAME MOULDING FRONT LH

ET

REMOVAL

HINT:

When replacing the moulding, heat the body and moulding using a heat light.

Heating temperature

Item	Temperature
Body	40 to 60°C (104 to 140°F)
Moulding	20 to 30°C (68 to 86°F)

NOTICE:

Do not heat the body and moulding excessively.

1. REMOVE REAR DOOR WINDOW FRAME MOULDING FRONT LH

- (a) Completely lower window glass.
- (b) Using a heat light, heat the body moulding.

NOTICE:

Do not heat the moulding excessively.

- (c) Using a moulding remover, remove the clip and the rear door window frame moulding front LH.

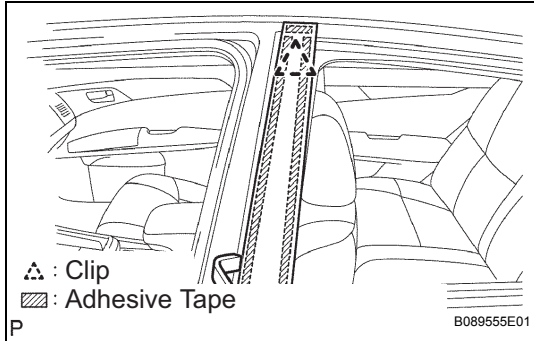

INSTALLATION

1. INSTALL REAR DOOR WINDOW FRAME MOULDING FRONT LH

- (a) Using a heat light, heat the body mounting surface.

NOTICE:

Do not heat the spoiler excessively.

- (b) Remove the protective tape from the body.
(c) Wipe off the stains with cleaner.
(d) Align the standard point with the hole on the door window frame.
(e) Engage the clip and install the rear door window frame moulding rear LH.

