

SEAT BELT SYSTEM

PRECAUTION

CAUTION:

Replace the faulty parts of the seat belt systems (outer belt, inner belt, bolts, nuts, adjustable shoulder anchor, tether anchor hardware, sill-bar, etc.).

Seat belt systems not in use at the time of a collision should also be inspected and replaced if found to be damaged or working improperly.

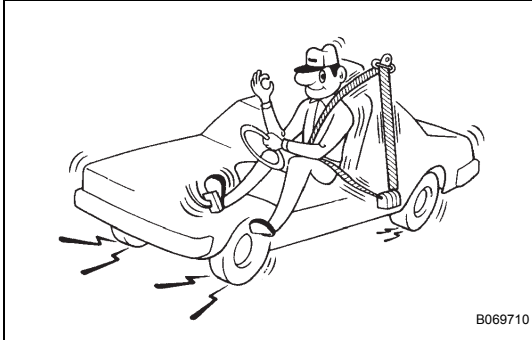
SB

1. RUNNING TEST (IN SAFE AREA)

- (a) Fasten the front seat belts.
- (b) Drive the vehicle at 16 km/h (10 mph) and slam on the brakes. Check that the belt locks and cannot be extended at this time.

HINT:

Conduct this test in a safe area. If the belt does not lock, remove the belt assembly and perform the inspections. Also whenever installing a new belt assembly, verify the proper operation before installation.

COMPONENTS

SB

POWER SEAT TYPE:

FRONT SEAT OUTER BELT ASSEMBLY LH

LAP BELT OUTER ANCHOR COVER

REAR SEAT TRACK BRACKET COVER INNER LH

FRONT LH SEAT ASSEMBLY

37 (377, 27)

42 (428, 31)

42 (428, 31)

5.5 (56, 49 in.*lbf)

CENTER PILLAR GARNISH LH

42 (428, 31)

FRONT SEAT TRACK COVER LH REAR OUTER

REAR DOOR OPENING TRIM WEATHERSTRIP LH

37 (377, 27)

SEAT TRACK BRACKET COVER OUTER FRONT LH

SEAT TRACK BRACKET COVER INNER FRONT LH

FRONT DOOR OPENING TRIM WEATHERSTRIP LH

REAR DOOR SCUFF PLATE LH

FRONT DOOR SCUFF PLATE LH

CENTER PILLAR GARNISH LOWER LH

42 (428, 31)

FRONT SEAT INNER BELT ASSEMBLY LH



N*m (kgf*cm, ft.*lbf) : Specified torque

MANUAL SEAT TYPE:

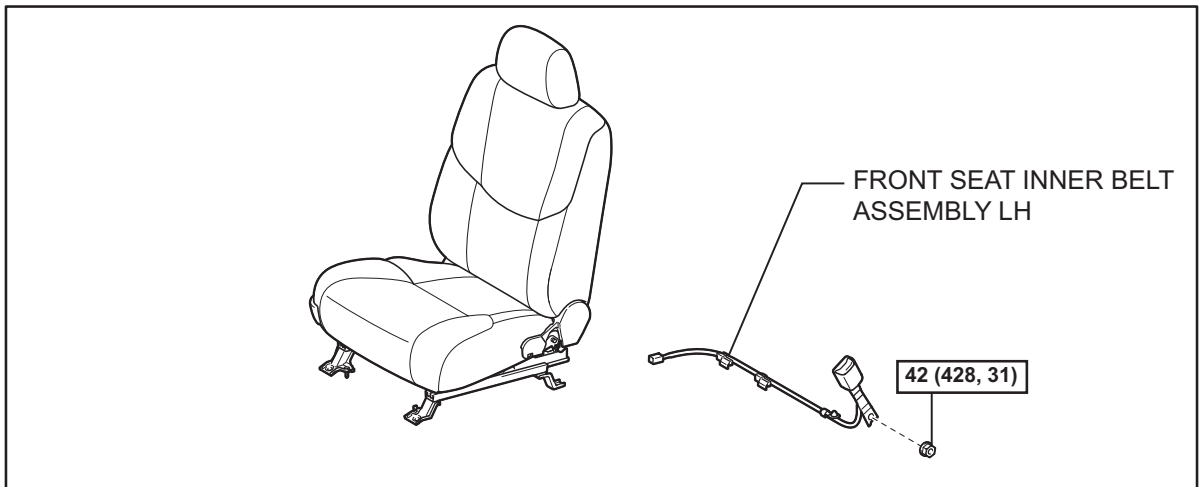
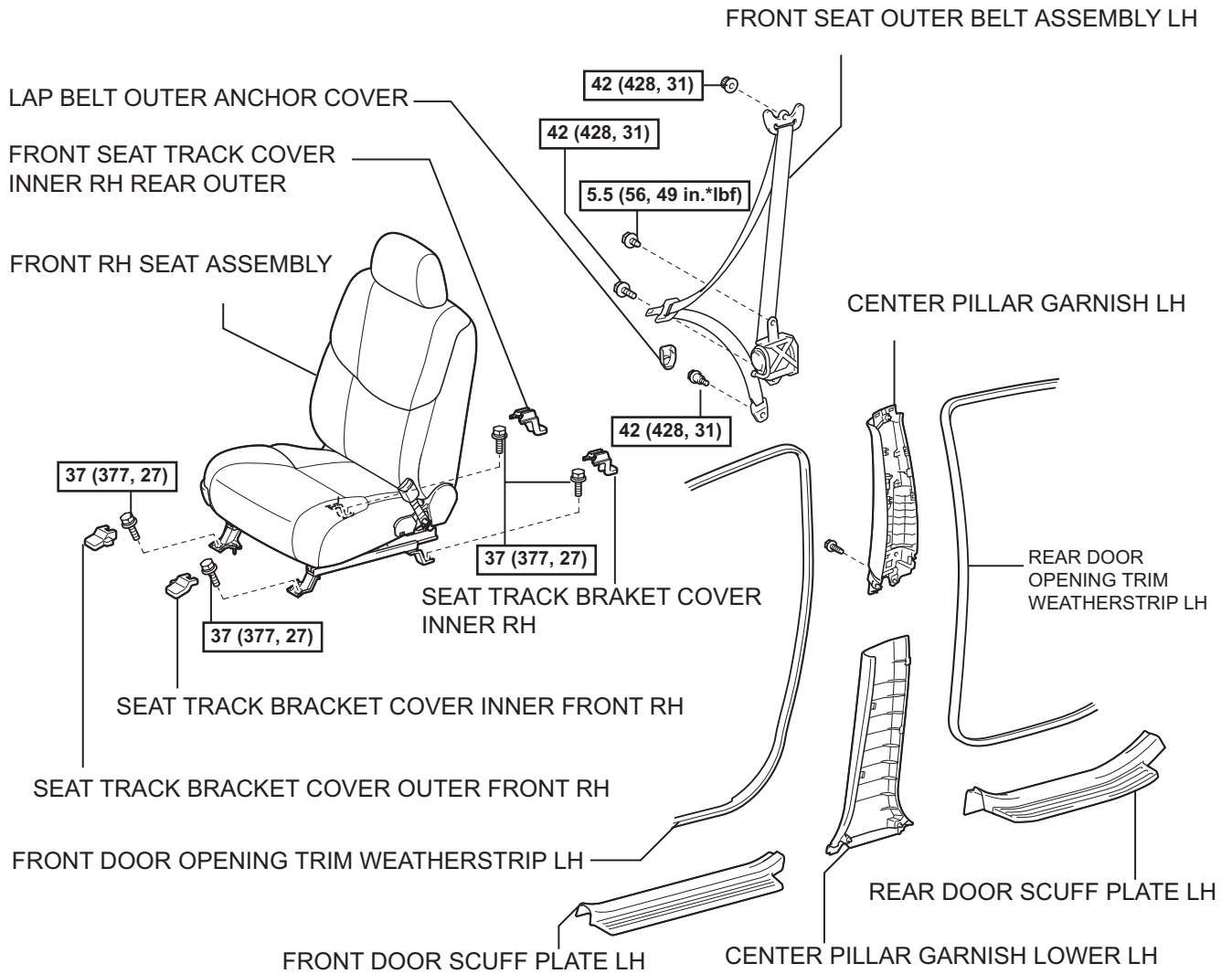

N*m (kgf*cm, ft.*lbf) : Specified torque

SB

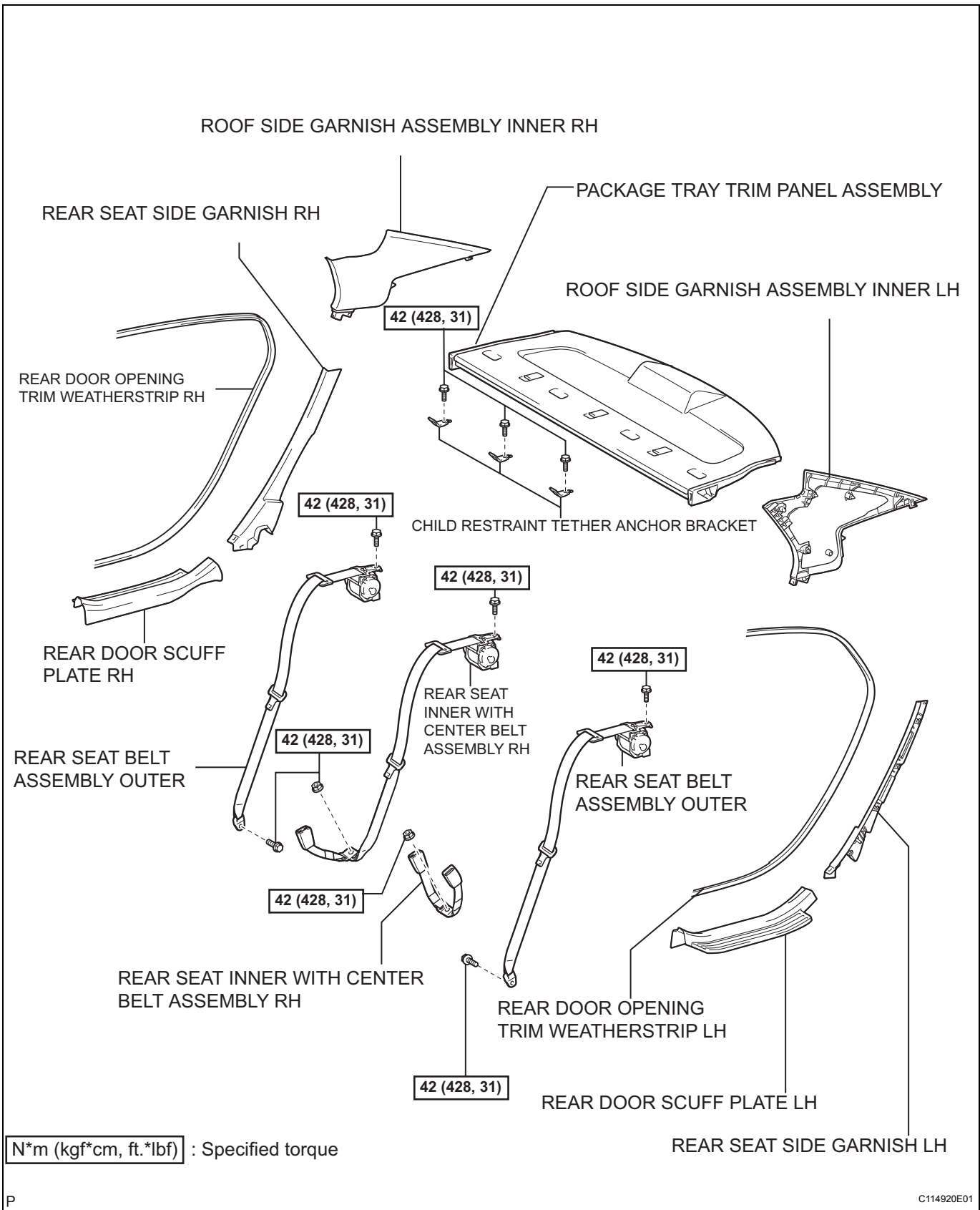

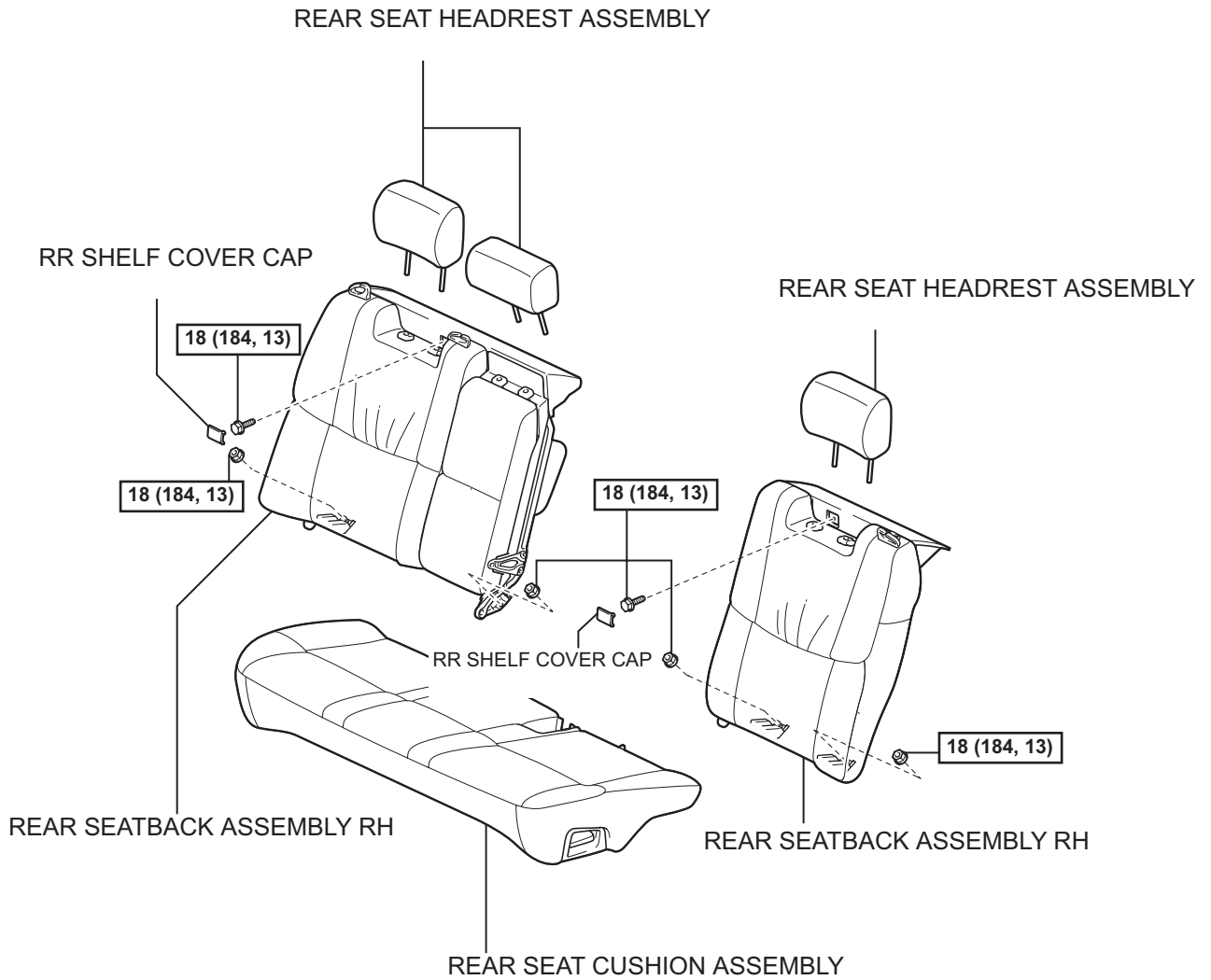

N*m (kgf*cm, ft.*lbf) : Specified torque

FRONT SEAT INNER BELT ASSEMBLY

COMPONENTS

SB

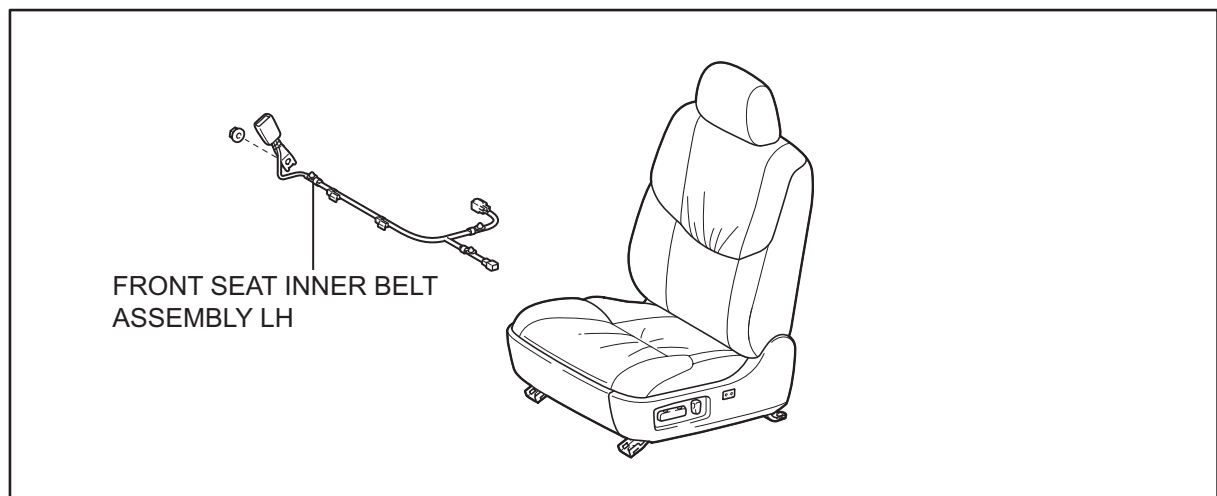
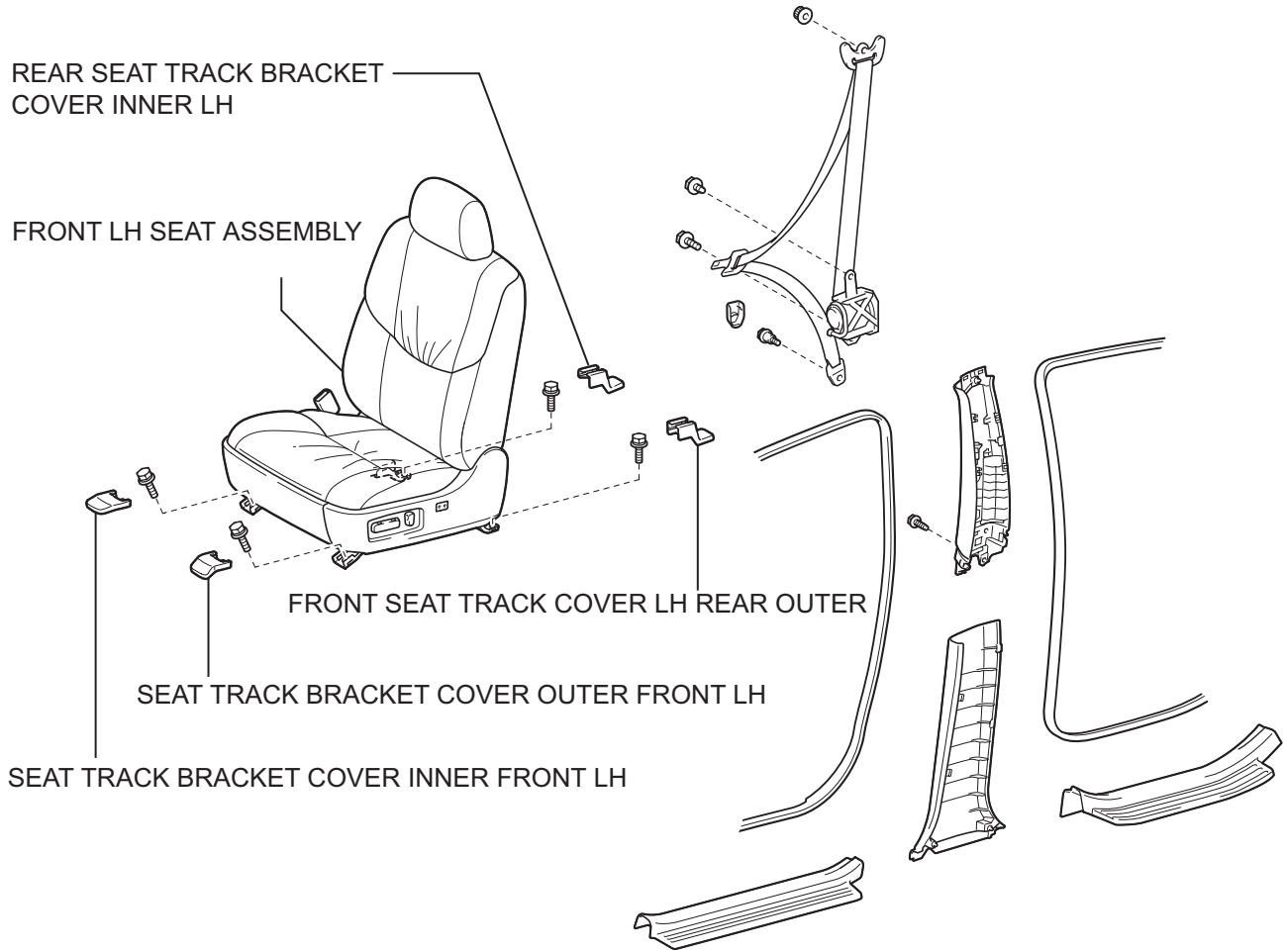

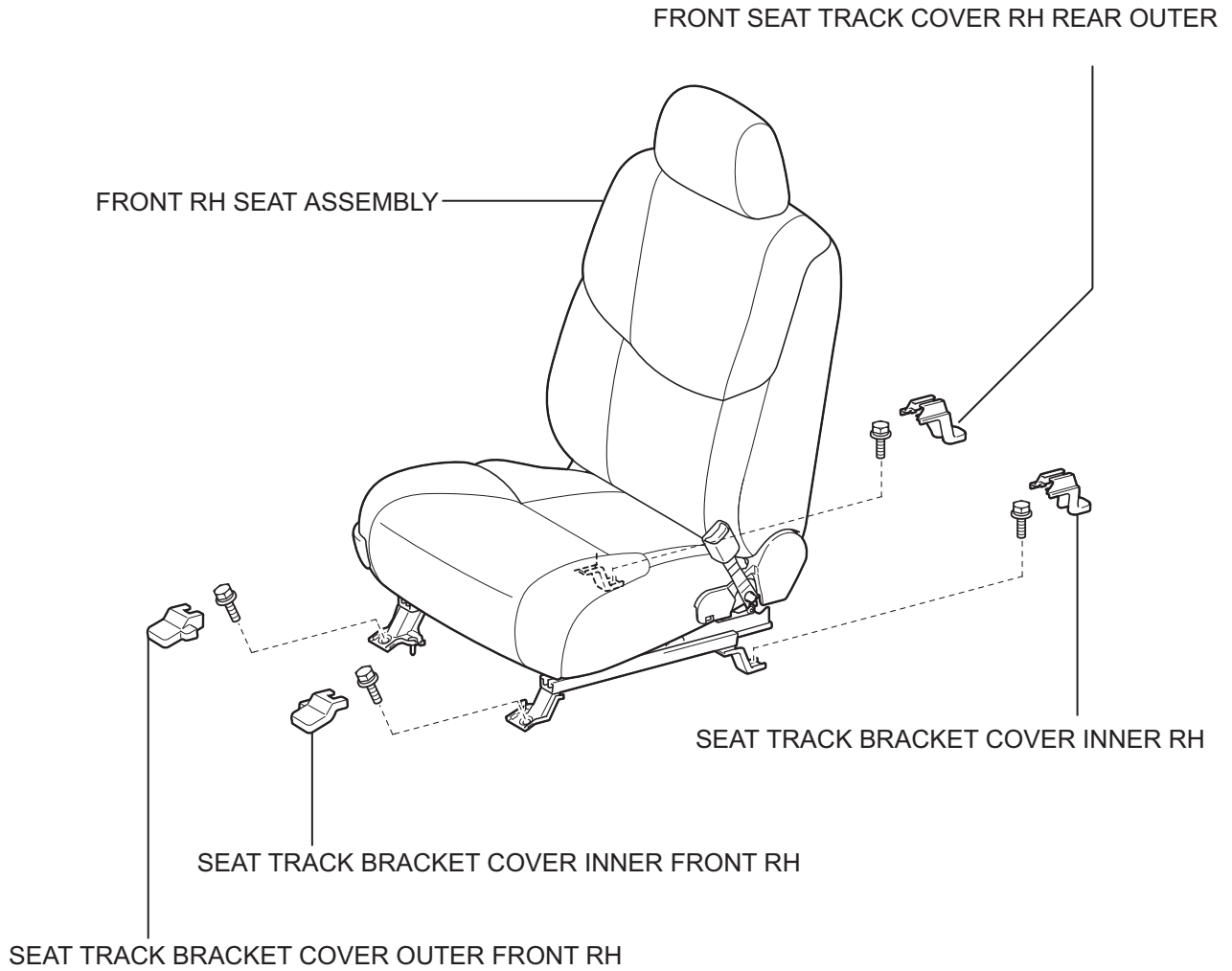

REMOVAL

HINT:

Use the same procedures for the RH side and LH side.

1. REMOVE SEAT TRACK BRACKET COVER OUTER FRONT LH (for Power Seat) (See page [SE-50](#))
2. REMOVE SEAT TRACK BRACKET COVER INNER FRONT LH (for Power Seat) (See page [SE-50](#))
3. REMOVE FRONT SEAT TRACK COVER LH REAR OUTER (for Power Seat) (See page [SE-50](#))
4. REMOVE REAR SEAT TRACK BRACKET COVER INNER LH (for Power Seat) (See page [SE-51](#))
5. REMOVE FRONT LH SEAT ASSEMBLY (for Power Seat) (See page [SE-51](#))
6. DISCONNECT CABLE FROM NEGATIVE BATTERY TERMINAL (for Manual Seat)

HINT:

See page [RS-1](#)

7. REMOVE SEAT TRACK BRACKET COVER OUTER FRONT RH (for Manual Seat) (See page [SE-40](#))
8. REMOVE SEAT TRACK BRACKET COVER INNER FRONT RH (for Manual Seat) (See page [SE-40](#))
9. REMOVE FRONT SEAT TRACK COVER RH REAR OUTER (for Manual Seat) (See page [SE-40](#))
10. REMOVE SEAT TRACK BRACKET COVER INNER RH (for Manual Seat) (See page [SE-40](#))
11. REMOVE FRONT RH SEAT ASSEMBLY (for Manual Seat) (See page [SE-40](#))
12. REMOVE FRONT SEAT INNER BELT ASSEMBLY LH
 - (a) Driver's seat:
 - (1) Disconnect the connector.
 - (2) Disengage the claw and the 4 clamps.

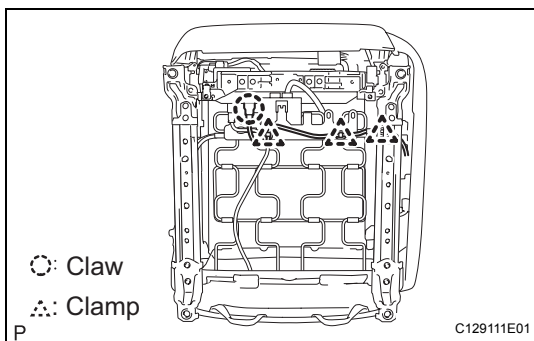
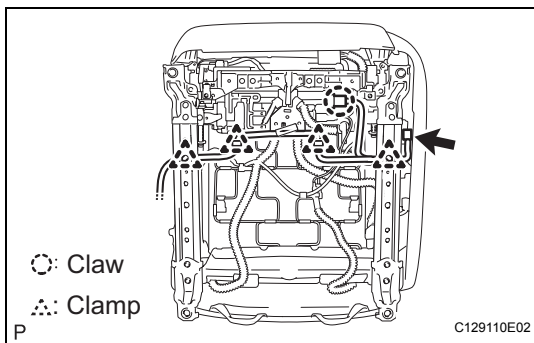

- (b) Passenger's manual seat:
 - (1) Disengage the claw and the 3 clamps.

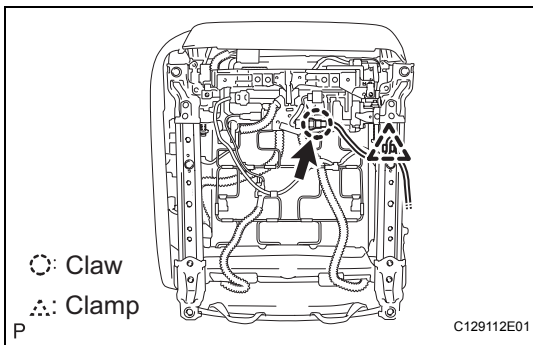

- (c) Passenger's power seat:
- (1) Disconnect the connector.
 - (2) Disengage the claw and the clamp.

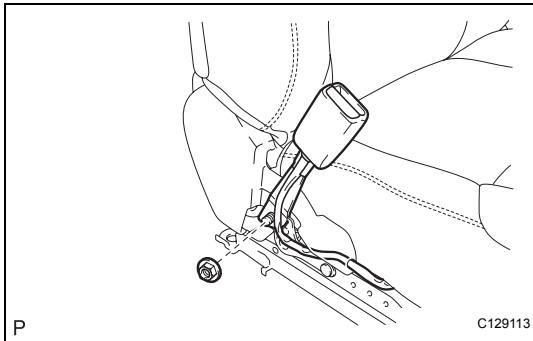

- (d) Remove the nut and the front seat inner belt assembly LH.

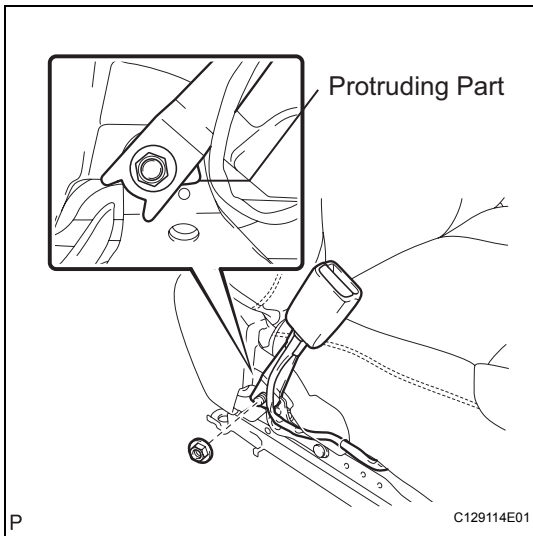

INSTALLATION

1. **INSTALL FRONT SEAT INNER BELT ASSEMBLY LH**
 - (a) Install the front seat inner belt assembly LH with the nut.
Torque: 42 N*m (428 kgf*cm, 31 ft.*lbf)
NOTICE:
Do not overlap the anchor part of the rear belt and the protruding part of the rear seat adjuster.

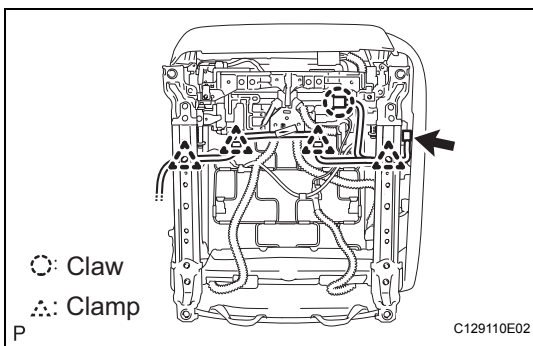

- (b) Driver's seat:
- (1) Engage the claw and the 4 clamps.
 - (2) Connect the connector.

SB

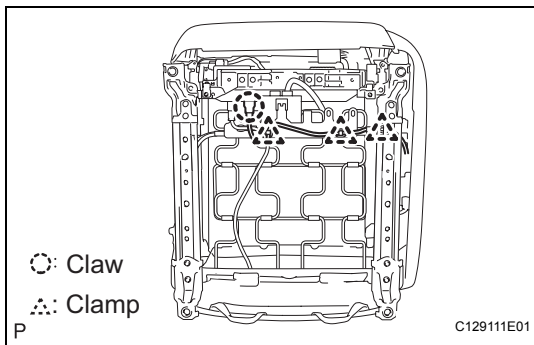

- (c) Passenger's manual seat:
 (1) Engage the claw and the 3 clamps.

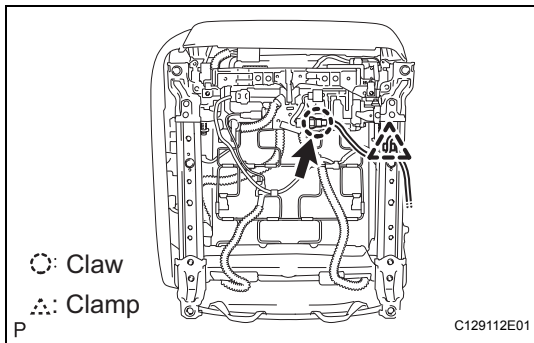

- (d) Passenger's power seat:
 (1) Engage the claw and the clamp.
 (2) Connect the connector.

2. **INSTALL FRONT LH SEAT ASSEMBLY (for Power Seat) (See page SE-63)**
3. **INSTALL FRONT RH SEAT ASSEMBLY (for Manual Seat) (See page SE-42)**
4. **CONNECT CABLE TO NEGATIVE BATTERY TERMINAL (for Manual Seat)**
5. **PERFORM INITIALIZATION**
 HINT:
 See page IN-29
6. **INSPECT FUNCTION OF POWER SEAT OPERATION (for Power Seat)**
 HINT:
 See page SE-28
7. **CHECK SEAT SLIDE ADJUSTER LOCKS (for Manual Seat) (See page SE-43)**
8. **CHECK SEAT HEATER OPERATION (w/ Seat Heater System)**
9. **INITIALIZE FRONT PASSENGER OCCUPANT CLASSIFICATION SYSTEM (for Front Passenger Seat)**
 HINT:
 See page IN-29
10. **INSPECT SRS WARNING LIGHT**
 HINT:
 See page RS-28

FRONT SEAT OUTER BELT ASSEMBLY

COMPONENTS

SB

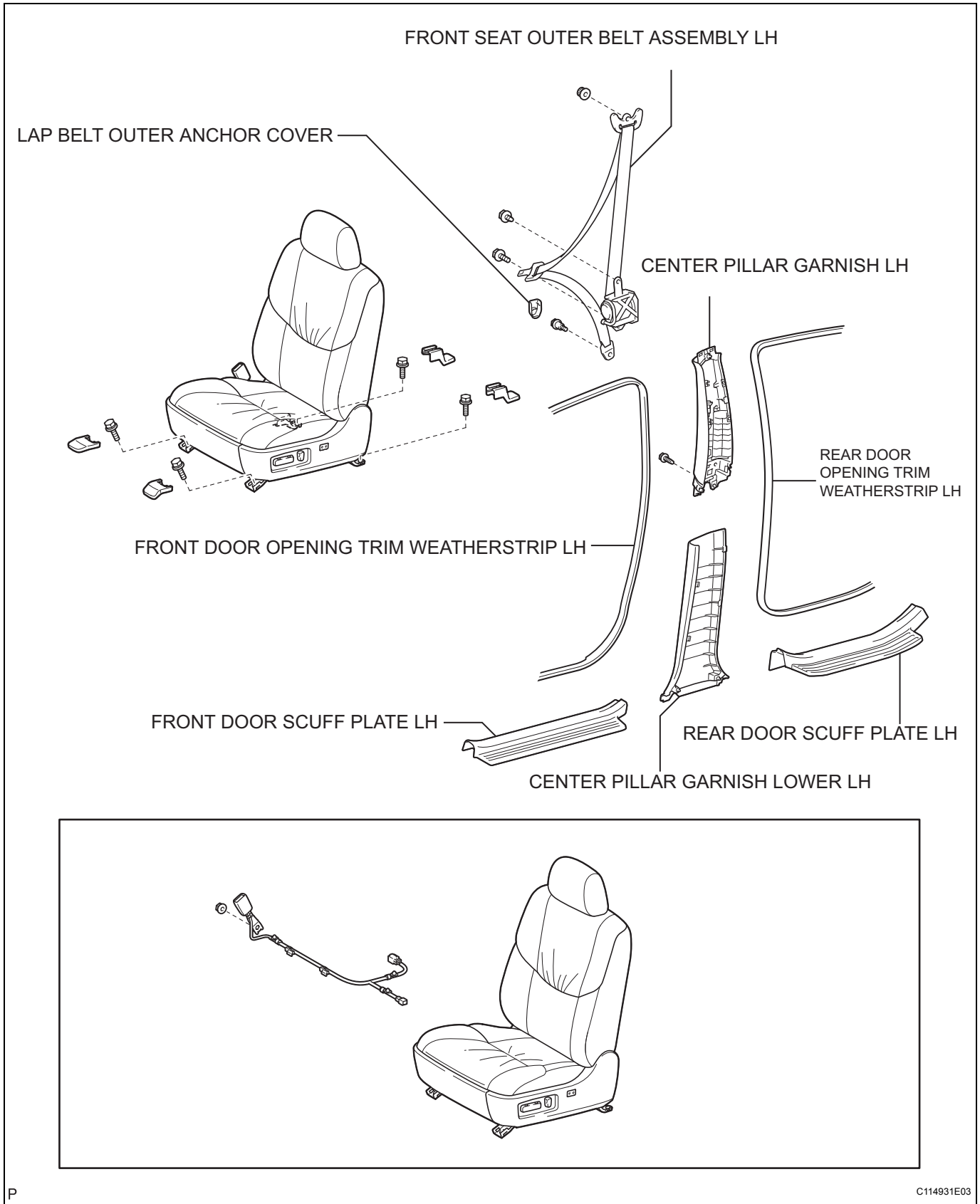

REMOVAL

CAUTION:

- Removal of the seat belt pretensioner must be started at least 90 seconds after the ignition switch is turned off and the negative (-) terminal cable is disconnected from the battery.
- Carefully read the notices for the "pretensioner" in the SRS airbag system section and the front seat outer belt section (See page [RS-1](#)).

HINT:

- The installation procedures are the removal procedures in reverse order. However, only installation procedures requiring additional information are included.
- Use the same procedures for the RH side and LH side.

1. DISCONNECT CABLE FROM NEGATIVE BATTERY TERMINAL

HINT:

See page [RS-1](#)

2. REMOVE FRONT DOOR SCUFF PLATE LH (See page [IR-12](#))

3. REMOVE REAR DOOR SCUFF PLATE LH (See page [IR-12](#))

4. REMOVE FRONT DOOR OPENING TRIM WEATHERSTRIP LH

5. REMOVE REAR DOOR OPENING TRIM WEATHERSTRIP LH

6. REMOVE CENTER PILLAR GARNISH LOWER LH

7. REMOVE LAP BELT OUTER ANCHOR COVER

- (a) Disengage the 2 claws and remove the lap belt outer anchor cover.

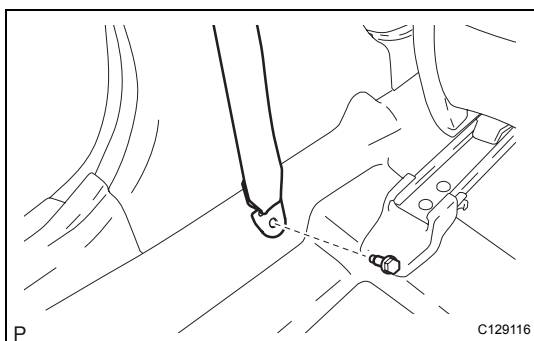
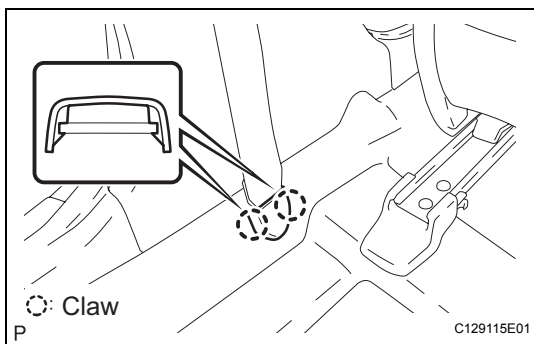

8. DISCONNECT FRONT SEAT OUTER BELT ASSEMBLY LH

- (a) Remove the bolt and disconnect the front seat outer belt assembly LH.

9. REMOVE CENTER PILLAR GARNISH LH (See page [IR-13](#))

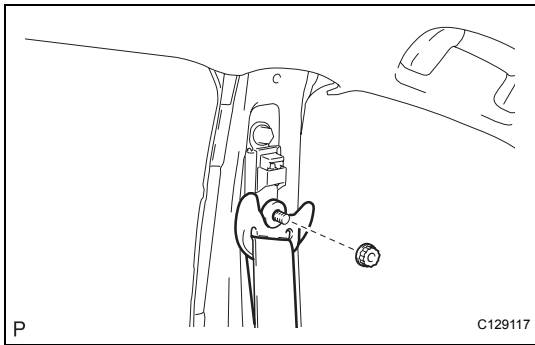
**10. REMOVE FRONT SEAT OUTER BELT ASSEMBLY LH**

(a) Remove the nut.

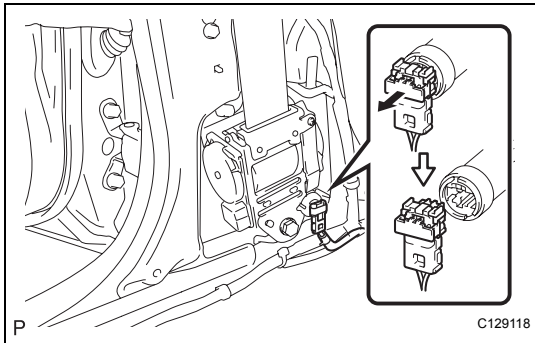

(b) Disconnect the pretensioner connector, as shown in the illustration.

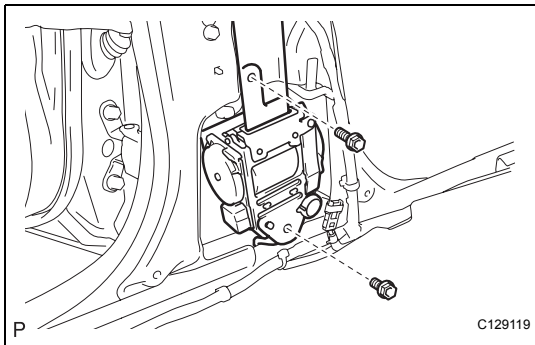

(c) Remove the 2 bolts and the front seat outer belt assembly LH.

INSTALLATION

1. INSTALL FRONT SEAT OUTER BELT ASSEMBLY LH

NOTICE:

Do not disassemble the retractor.

- (a) Check the degree of inclination required to lock the retractor.

- (1) When the inclination of the retractor is 15° or less, check that the belt can be pulled from the retractor. When the inclination of the retractor is over 45° , check that the belt locks. If operation is not as specified, replace the outer belt assembly.

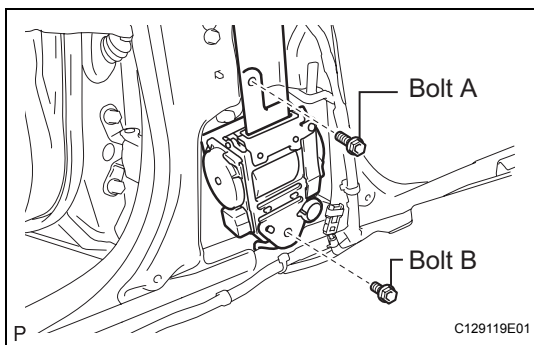
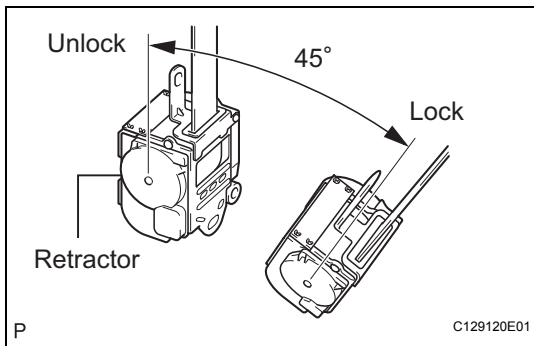

- (b) Install the front seat outer belt assembly LH with the 2 bolts.

Torque: Bolt A

5.5 N*m (56 kgf*cm, 49 in.*lbf)

Bolt B

42 N*m (428 kgf*cm, 31 ft.*lbf)

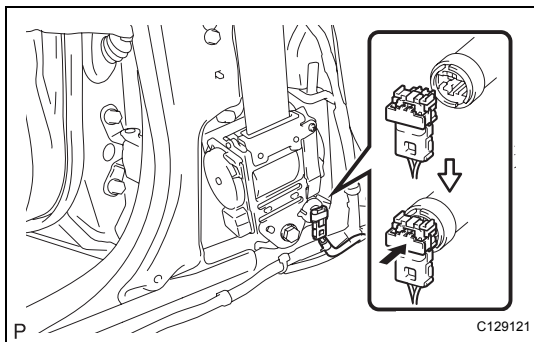

- (c) Connect the pretensioner connector, as shown in the illustration.

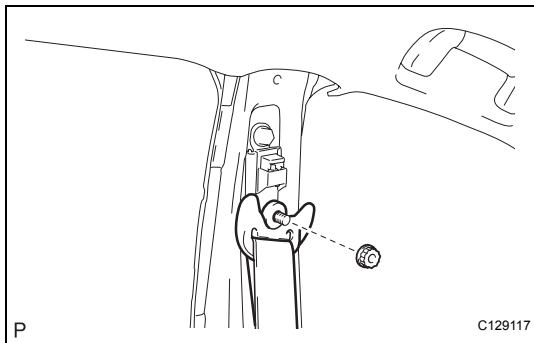

- (d) Install the nut.

Torque: 42 N*m (428 kgf*cm, 31 ft.*lbf)

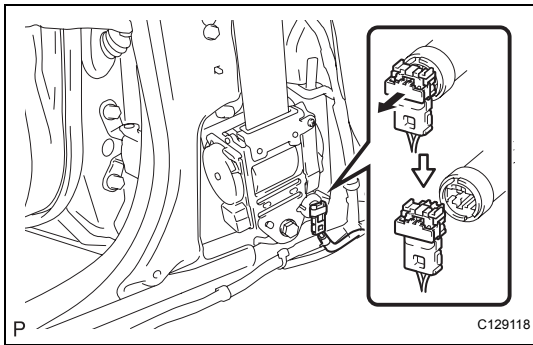
**2. INSTALL FRONT SEAT OUTER BELT ASSEMBLY LH**

- (a) Install the front seat outer belt assembly with the bolt.

Torque: 42 N*m (428 kgf*cm, 31 ft.*lbf)

- (b) Check if the ELR locks.

NOTICE:

The check should be performed with the outer belt assembly installed.

- (1) With the belt assembly installed, check that the belt locks when it is pulled out quickly.
If operation is not as specified, replace the outer belt assembly.

3. CONNECT CABLE TO NEGATIVE BATTERY TERMINAL**4. PERFORM INITIALIZATION**

HINT:

See page [IN-29](#)

5. INSPECT SRS WARNING LIGHT

HINT:

See page [RS-28](#)

DISPOSAL

HINT:

When scrapping vehicles equipped with a seat belt pretensioner or disposing of a front seat outer belt (with a seat belt pretensioner), always activate the seat belt pretensioner first in accordance with the procedures described below. If any abnormality occurs during activation of the seat belt pretensioner, contact the SERVICE DEPARTMENT of TOYOTA MOTOR SALES, USA, INC. When disposing of a front seat outer belt assembly (with a seat belt pretensioner) that was activated in a collision, perform procedure "A" to "B" in this section.

CAUTION:

- **Never dispose of a front seat outer belt assembly that has an inactivated pretensioner.**
- **The seat belt pretensioner produces a loud exploding sound when it activates. Perform the operation where it will not surprise or disturb people nearby.**
- **When activating a front seat outer belt (with a seat belt pretensioner), stand at least 10 m (33ft) away from the front seat outer belt.**
- **Use gloves and safety glasses when handling a front seat belt with an activated pretensioner.**
- **Always wash your hands with water after completing the disposal.**
- **Do not apply water to a front seat outer belt that has an activated pretensioner.**
- **Perform procedures in a place away from electrical interference.**
- **When activating the seat belt pretensioner, always use the specified SST (SRS airbag deployment tool).**

1. DISPOSE OF FRONT SEAT OUTER BELT ASSEMBLY LH

HINT:

Prepare a battery for power activation of the seat belt pretensioner.

- (a) Check if SST functions. (Procedure "A")

CAUTION:

When activating the seat belt pretensioner, always use the specified SST.

SST 09082-00700, 09082-00770

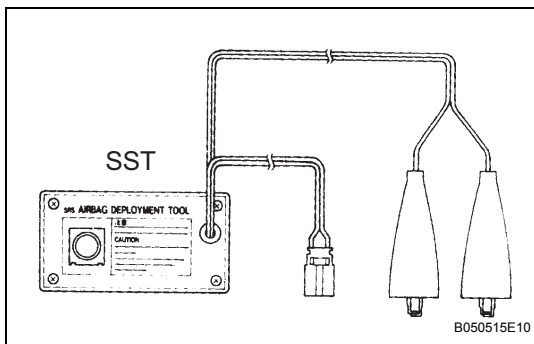

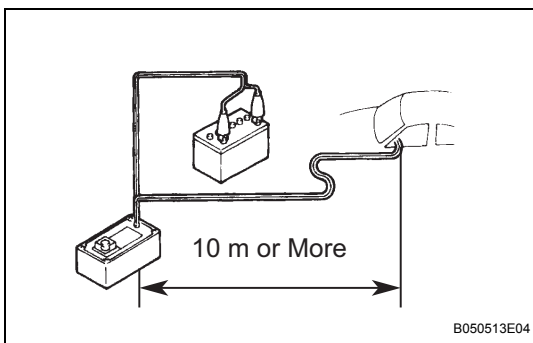
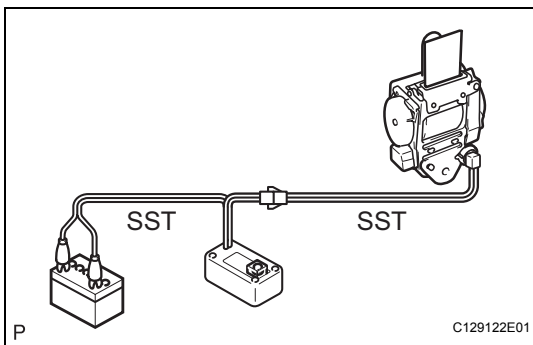
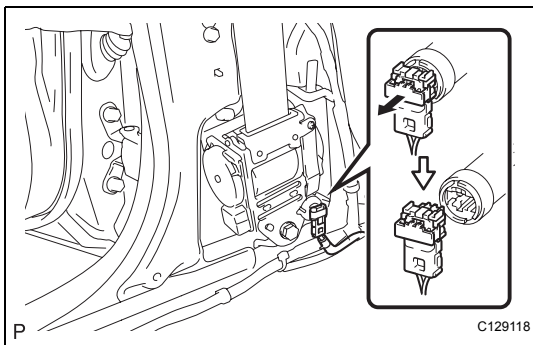
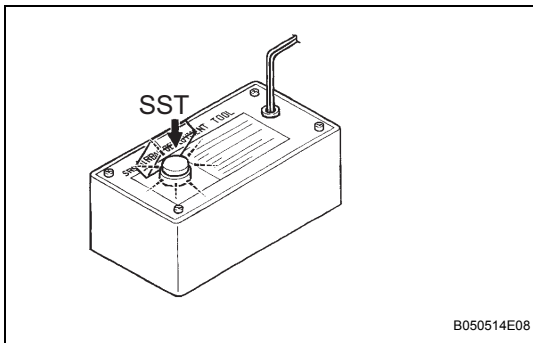
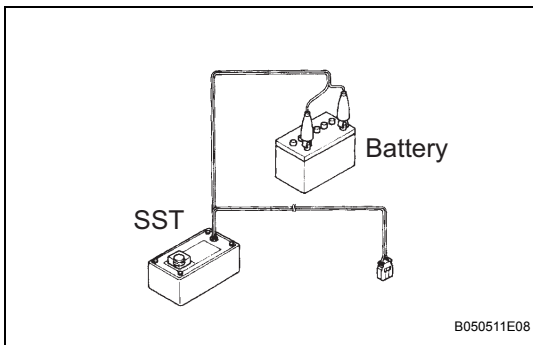

- (1) Connect the SST red clip to the battery's positive (+) terminal and the black clip to the battery's negative (-) terminal.
HINT:
Do not connect the yellow connector. It is used to connect to the seat belt pretensioner.

SB

- (2) Press the SST activation switch and check that the LED of the SST activation switch turns on.
CAUTION:
If the LED turns on when the activation switch is not being pressed, SST may be malfunctioning. Replace the SST with a new one.
- (b) Disconnect the SST from the battery.
- (c) Disconnect the pretensioner connector, as shown in the illustration.
- (d) Install the front seat outer belt assembly floor anchor with the bolt.
Torque: 42 N*m (428 kgf*cm, 31 ft.*lbf)

- (e) Connect SST.
 - (1) Connect SST, then connect the yellow connector to the seat belt pretensioner.
SST 09082-00700, 09082-00770
NOTICE:
To avoid damaging the SST connector and wire harness, do not lock the secondary lock of the twin lock.
 - (2) Move the SST at least 10 m (33 ft) away from the front of the vehicle.
 - (3) Close all the doors and windows of the vehicle.
HINT:
Leave a gap in one of the windows for inserting the SST wire harness.
NOTICE:
Take care not to damage the SST wire harness.

- (4) Connect the SST red clip to the battery's positive (+) terminal and the black clip to the negative (-) terminal.
- (f) Activate the seat belt pretensioner (Procedure B).
- (1) Confirm that no one is inside the vehicle or within a 10 m (33 ft) radius of the vehicle.
 - (2) Press the SST activation switch to activate the seat belt pretensioner.
- HINT:
The seat belt pretensioner operates at the same time as the SST activation switch's LED light.

- (g) Dispose of the outer belt (with the seat belt pretensioner).

CAUTION:

- **Do not touch the outer belt for at least 30 minutes after the seat belt pretensioner has been activated. It is very hot.**
- **Use gloves and safety glasses when handling an outer belt whose pretensioner has been activated.**
- **Always wash your hands with water after completing the disposal.**
- **Do not apply water to a front seat outer belt that has an activated pretensioner.**

HINT:

When scrapping a vehicle, activate the seat belt pretensioner, and then scrap the vehicle with the activated outer belt installed.

2. DISPOSE OF FRONT SEAT OUTER ASSEMBLY LH**HINT:**

Prepare a battery for power activation of the seat belt pretensioner.

NOTICE:

- **When disposing of the front seat outer belt (with the seat belt pretensioner) only, never use the customer's vehicle to activate the seat belt pretensioner.**
- **Be sure to follow the procedures listed below before activating the seat belt pretensioner.**

- (a) Remove the front seat outer belt assembly.
- (1) Wind the seat belt with the retractor
 - (2) When the seat belt is sufficiently wound, cut the seat belt approximately 100 mm (3.93 in.) from the retractor, as shown in the illustration.
- HINT:
The seat belt is designed so that winding the seat belt as much as possible before pretensioner activation will decrease the pulling power of the seat belt during pretensioner activation.

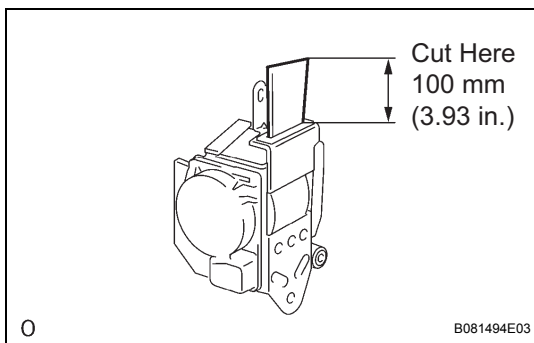

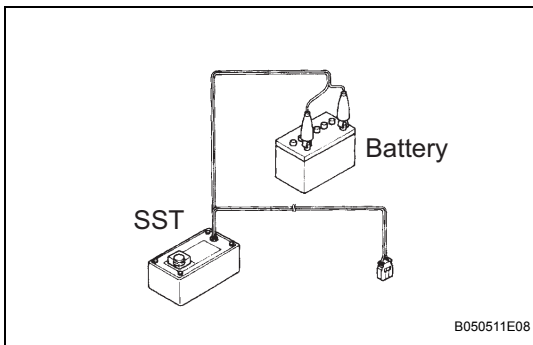

- (b) Check if SST functions. (See procedure "A")

CAUTION:

When activating a seat belt pretensioner, always use the specified SST.

SST 09082-00700, 09082-00770

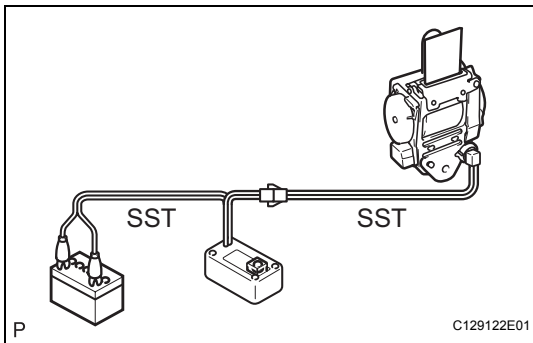

- (c) Connect the SST.

- (1) Connect the SST, then connect the yellow connector to the seat belt pretensioner.

NOTICE:

To avoid damaging the SST connector and wire harness, do not lock the secondary lock of the twin lock.

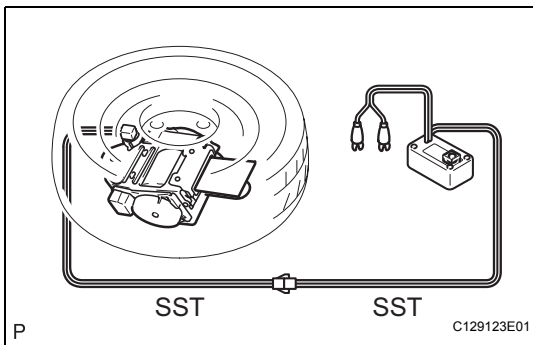

- (2) Place the outer belt on the ground and cover it with a tire with the wheel attached.

NOTICE:

Set up the front seat outer belt assembly as shown in the illustration.

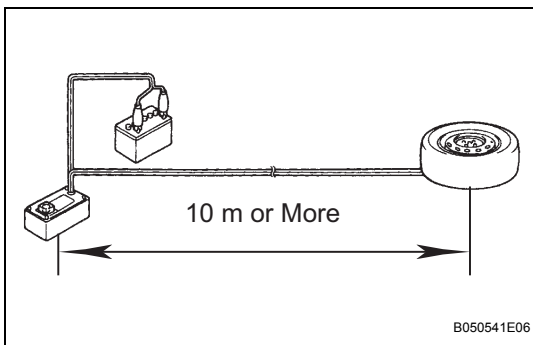

- (3) Move the SST at least 10 m (33 ft) away from the wheel.

NOTICE:

Take care not to damage the SST wire harness.

- (d) Activate the seat belt pretensioner.

- (1) Connect the SST red clip to the battery's positive (+) terminal and the black clip to the battery's negative (-) terminal.
- (2) Check that no one is within a 10 m (33 ft) radius of the wheel.
- (3) Press the SST activation switch to activate the seat belt pretensioner.

HINT:

The seat belt pretensioner operates at the same time as the SST activation switch's LED light.

SB

- (e) Dispose of the outer belt (with the seat belt pretensioner).

CAUTION:

- **Do not touch the outer belt for at least 30 minutes after the seat belt pretensioner has been activated. It is very hot.**
- **Use gloves and safety glasses when handling an outer belt assembly whose pretensioner has been activated.**
- **Always wash your hands with water after completing disposal.**
- **Do not apply water to an outer belt assembly that has an activated pretensioner.**

- (1) Remove the tire with wheel and SST.
- (2) Place the outer belt in a plastic bag, tie the end tightly and dispose of it in the same way as other general parts.

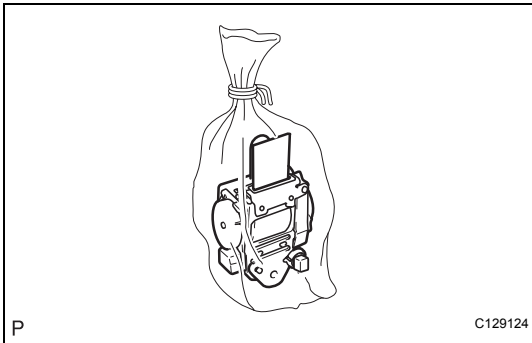

REAR SEAT OUTER BELT ASSEMBLY

COMPONENTS

SB

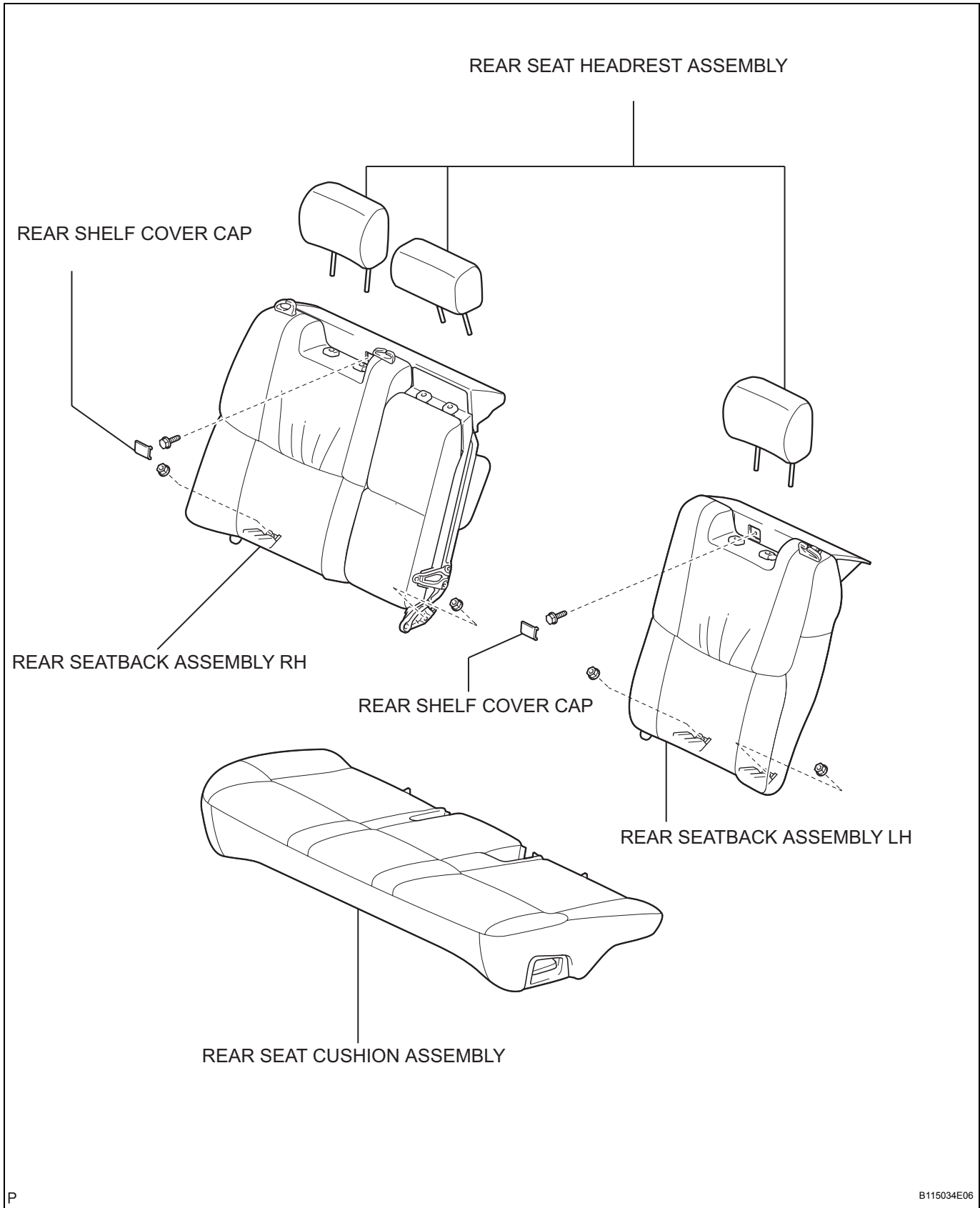

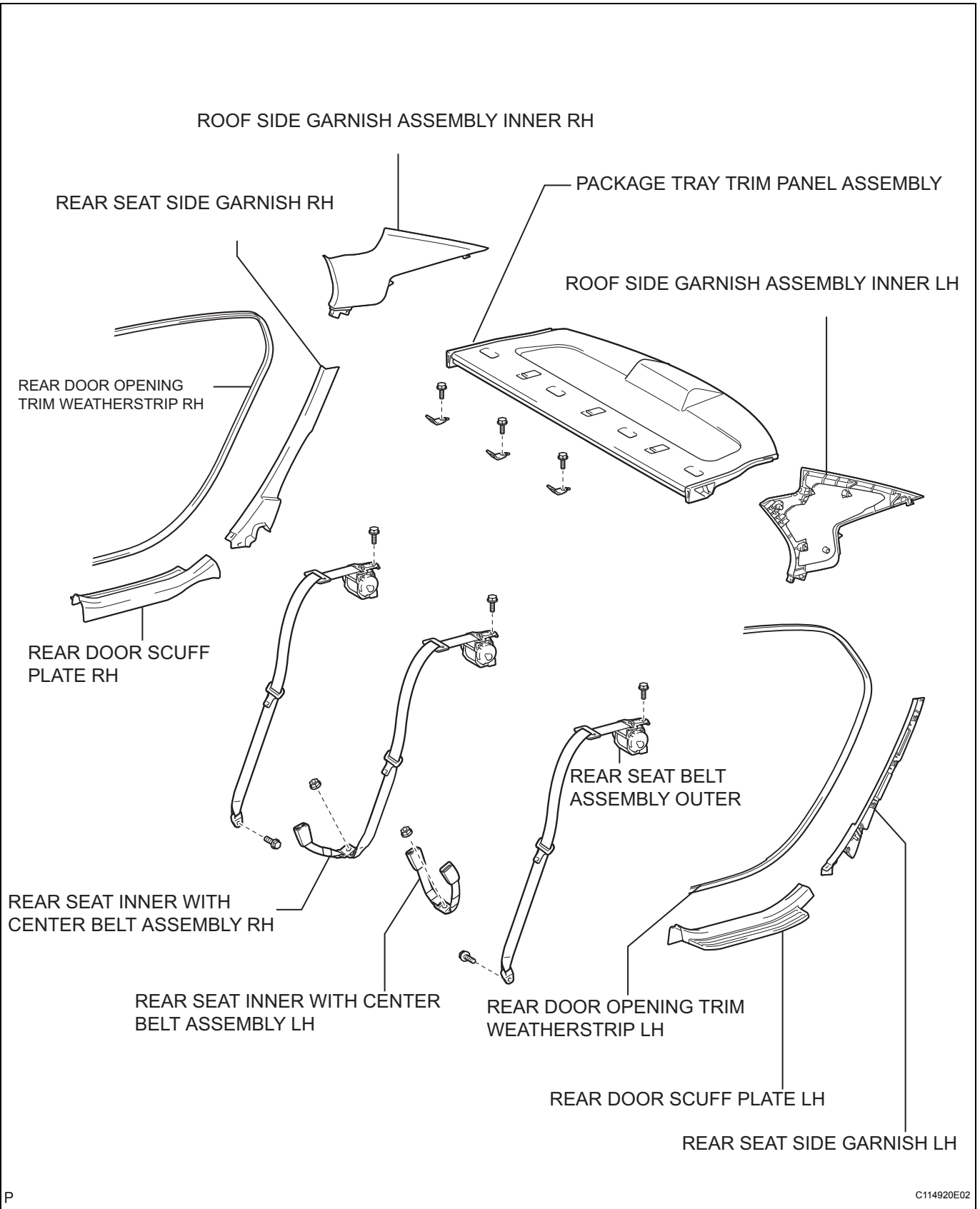

SB

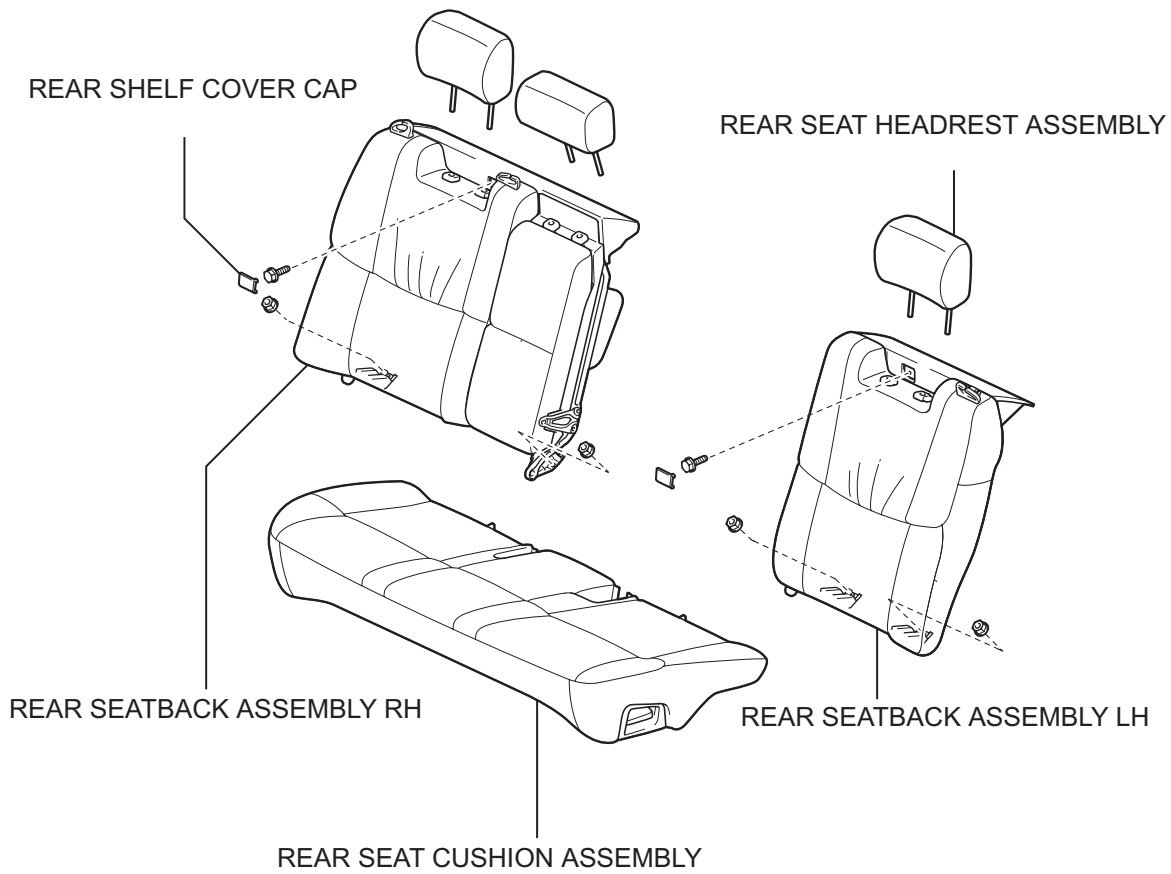

REMOVAL

HINT:

- Use the same procedures for the RH side and LH side.
- The procedures listed below are for the LH side.

1. DISCONNECT CABLE FROM NEGATIVE BATTERY TERMINAL

HINT:

See page [RS-1](#)

2. REMOVE REAR SEAT CUSHION ASSEMBLY (See page [SE-68](#))

3. REMOVE REAR SEAT HEADREST ASSEMBLY

4. REMOVE REAR SHELF COVER CAP (See page [SE-68](#))

5. REMOVE REAR SEATBACK ASSEMBLY LH (See page [SE-68](#))

6. REMOVE REAR SEATBACK ASSEMBLY RH (See page [SE-69](#))

7. REMOVE REAR DOOR SCUFF PLATE LH (See page [IR-12](#))

8. REMOVE REAR DOOR SCUFF PLATE RH (See page [IR-12](#))

9. REMOVE REAR DOOR OPENING TRIM WEATHERSTRIP LH

10. REMOVE REAR DOOR OPENING TRIM WEATHERSTRIP RH

11. REMOVE REAR SEAT SIDE GARNISH LH (See page [IR-14](#))

12. REMOVE REAR SEAT SIDE GARNISH RH (See page [IR-14](#))

13. REMOVE ROOF SIDE GARNISH ASSEMBLY INNER LH (See page [IR-14](#))

14. REMOVE ROOF SIDE GARNISH ASSEMBLY INNER RH (See page [IR-14](#))

15. REMOVE PACKAGE TRAY TRIM PANEL ASSEMBLY

- (a) Remove the bolt and disconnect the rear seat belt assembly outer.

HINT:

Use the same procedures for the RH side and LH side.

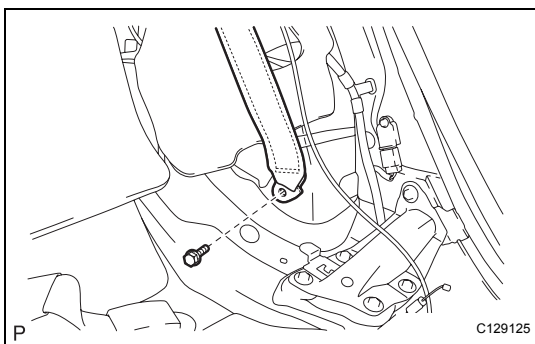

SB

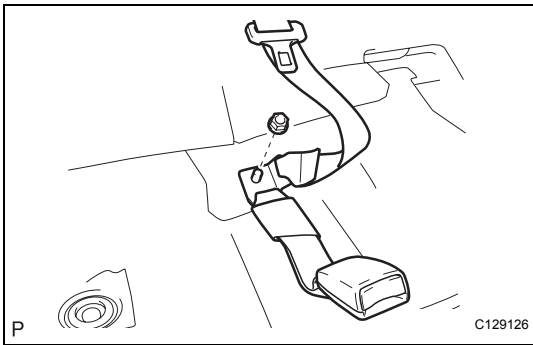

(b) Remove the nut and disconnect the rear seat inner w/ center belt assembly RH.

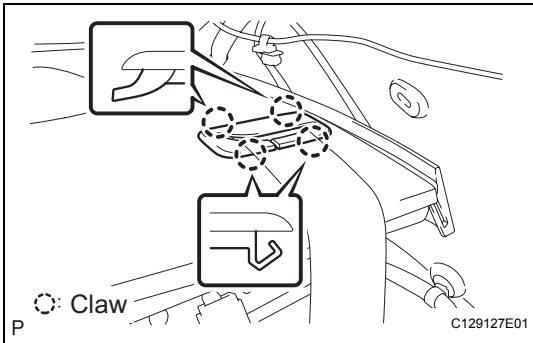

(c) Disengage the 4 claws and the rear seat shoulder belt cover.

HINT:

Use the same procedures for the RH side and LH side.

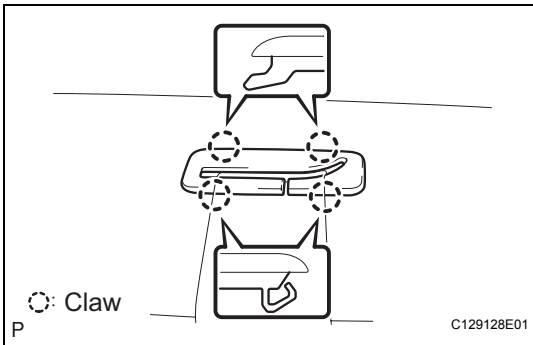

(d) Disengage the 4 claws and the rear seat shoulder belt cover.

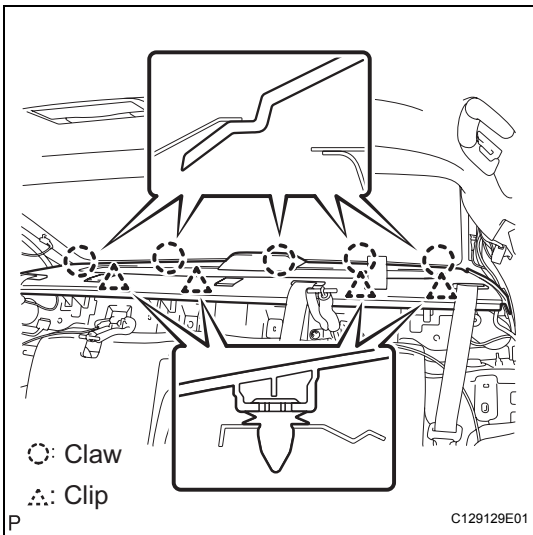

(e) Disengage the 5claws, 4clips, and the package tray panel assembly.

(f) Disconnect the connector and remove the package tray panel assembly.

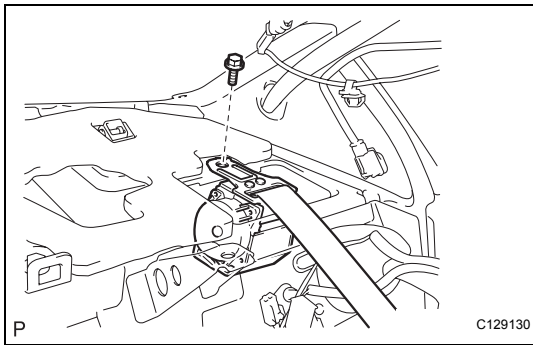

- 16. REMOVE REAR SEAT BELT ASSEMBLY OUTER**
(a) Remove the bolt and the rear seat belt assembly outer.

INSTALLATION

1. INSTALL REAR SEAT BELT ASSEMBLY OUTER

NOTICE:

Do not disassemble the retractor.

- (a) Check the degree of inclination when the belt begins to lock the ELR.

- (1) When the inclination of the retractor is 15° or less, check that the belt can be pulled from the retractor. When the inclination of the retractor is over 45° , check that the belt locks. If operation is not as specified, replace the belt assembly.

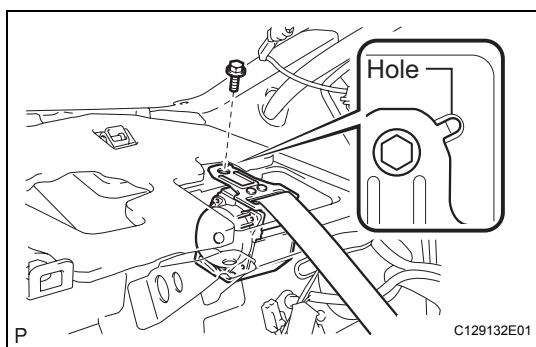
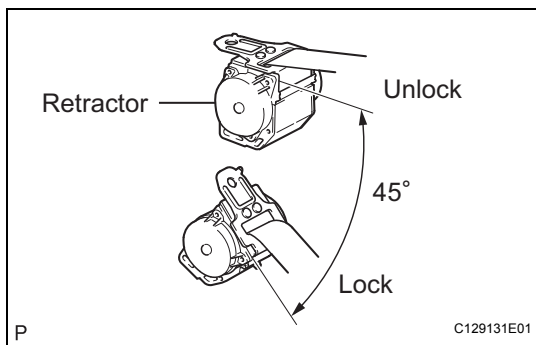

- (b) Install the rear seat belt assembly outer with the bolt.

Torque: 42 N*m (428 kgf*cm, 31 ft.*lbf)

2. INSTALL PACKAGE TRAY TRIM PANEL ASSEMBLY

- (a) Connect the connector.
 (b) Engage the 5 claws and the 4 clips and install the package tray panel assembly.

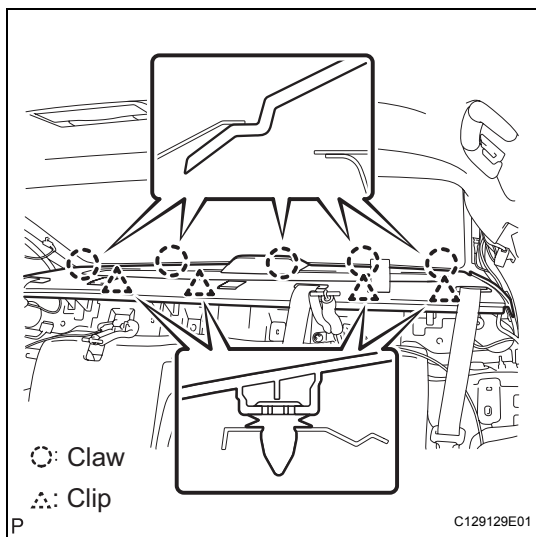

- (c) Engage the 4 claws and install the rear seat shoulder belt cover.

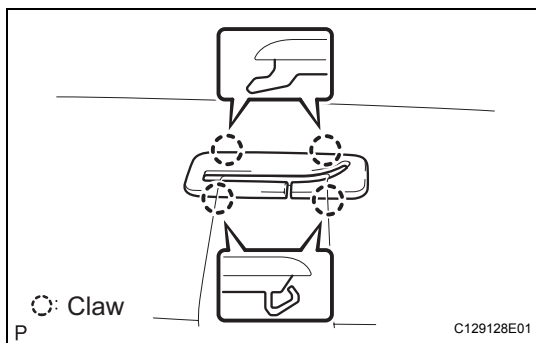

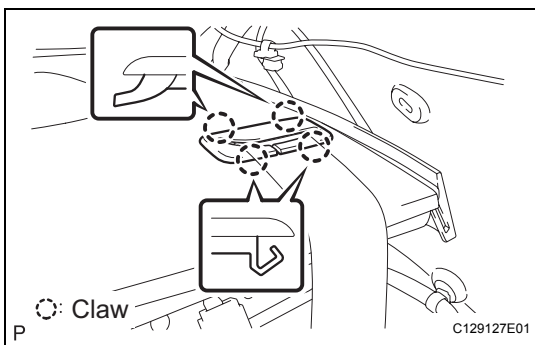

- (d) Engage the 4 claws and the rear seat shoulder belt cover.

HINT:

Use the same procedures for the RH side and LH side.

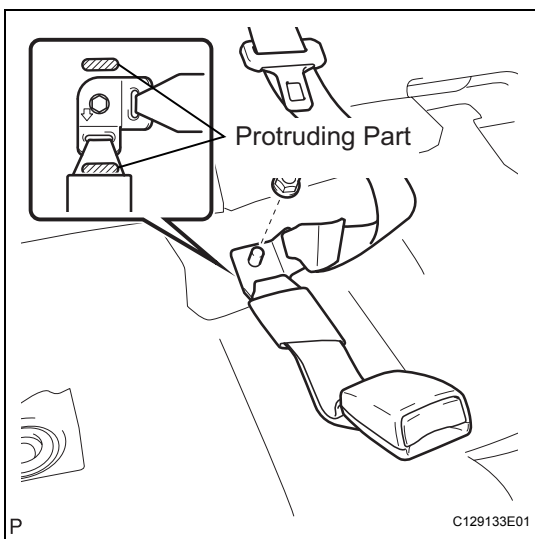

- (e) Install the rear seat inner w/ center belt assembly RH with the nut.

Torque: 42 N*m (428 kgf*cm, 31 ft.*lbf)

NOTICE:

- Do not overlap the anchor part of the rear belt and the protruding parts of the rear seat adjuster.
- Make sure arrow is pointing towards the front of the vehicle.

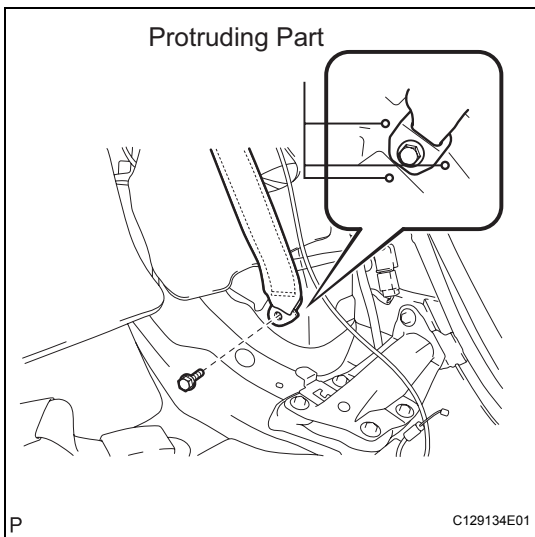

- (f) Install the rear seat belt assembly outer with the bolt.

Torque: 42 N*m (428 kgf*cm, 31 ft.*lbf)

NOTICE:

Do not overlap the anchor part of the rear belt and the protruding parts of the rear seat adjuster.

HINT:

Use the same procedures for the RH side and LH side.

- (g) Check if the ELR locks.

NOTICE:

The check should be performed with the outer belt assembly installed.

- (1) With the belt assembly installed, check that the belt locks when it is pulled out quickly.
If operation is not as specified, replace the belt assembly.

3. INSTALL ROOF SIDE GARNISH ASSEMBLY INNER LH (See page [IR-19](#))
4. INSTALL ROOF SIDE GARNISH ASSEMBLY INNER RH (See page [IR-19](#))
5. INSTALL REAR SEATBACK ASSEMBLY RH (See page [SE-76](#))

SB

6. **INSTALL REAR SEATBACK ASSEMBLY LH (See page [SE-77](#))**
7. **INSTALL REAR SEAT CUSHION ASSEMBLY**
8. **CONNECT CABLE TO NEGATIVE BATTERY TERMINAL**
9. **PERFORM INITIALIZATION**
HINT:
See page [IN-29](#)
10. **INSPECT SRS WARNING LIGHT**
HINT:
See page [RS-28](#)

REAR CENTER SEAT INNER BELT ASSEMBLY

COMPONENTS

SB

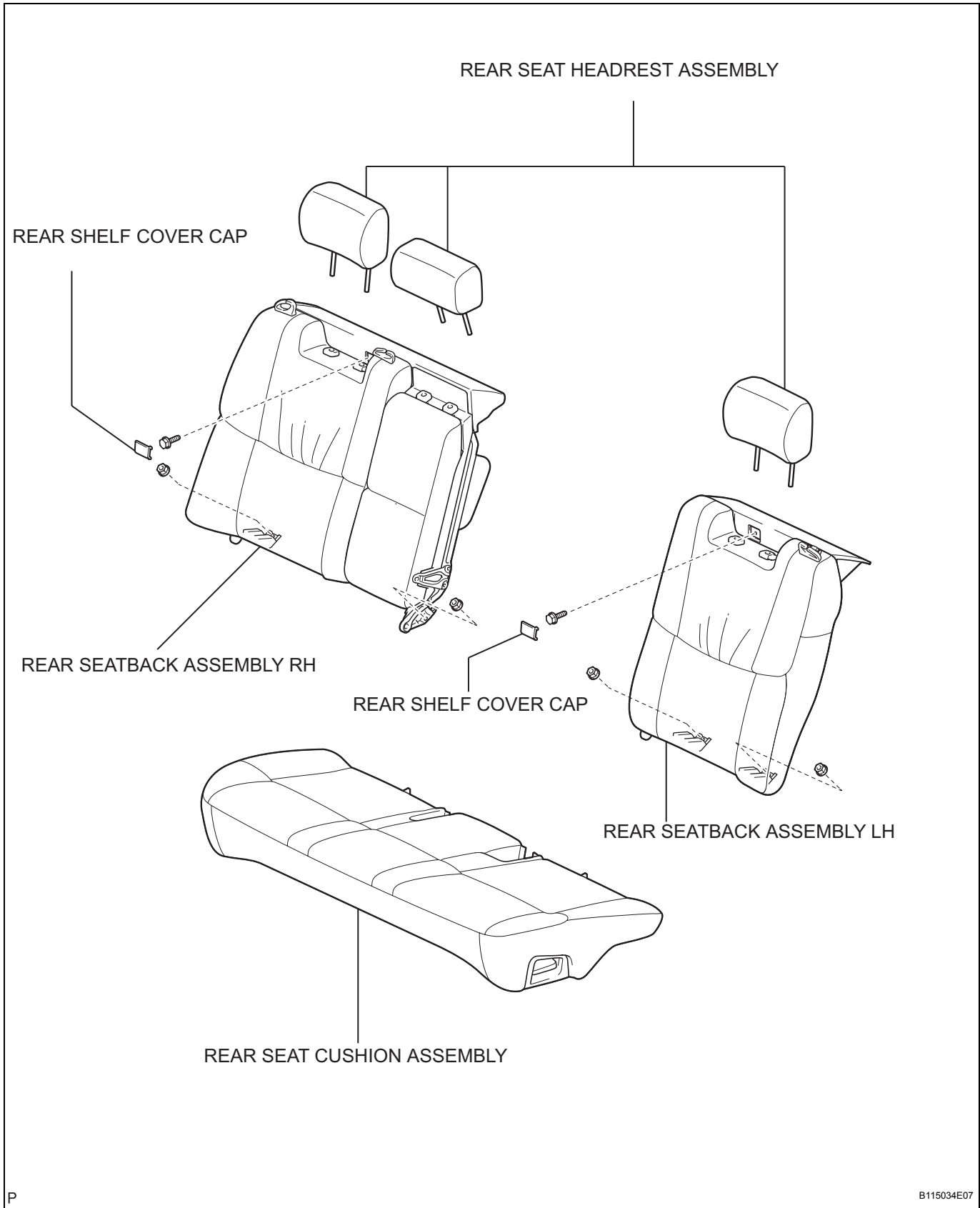

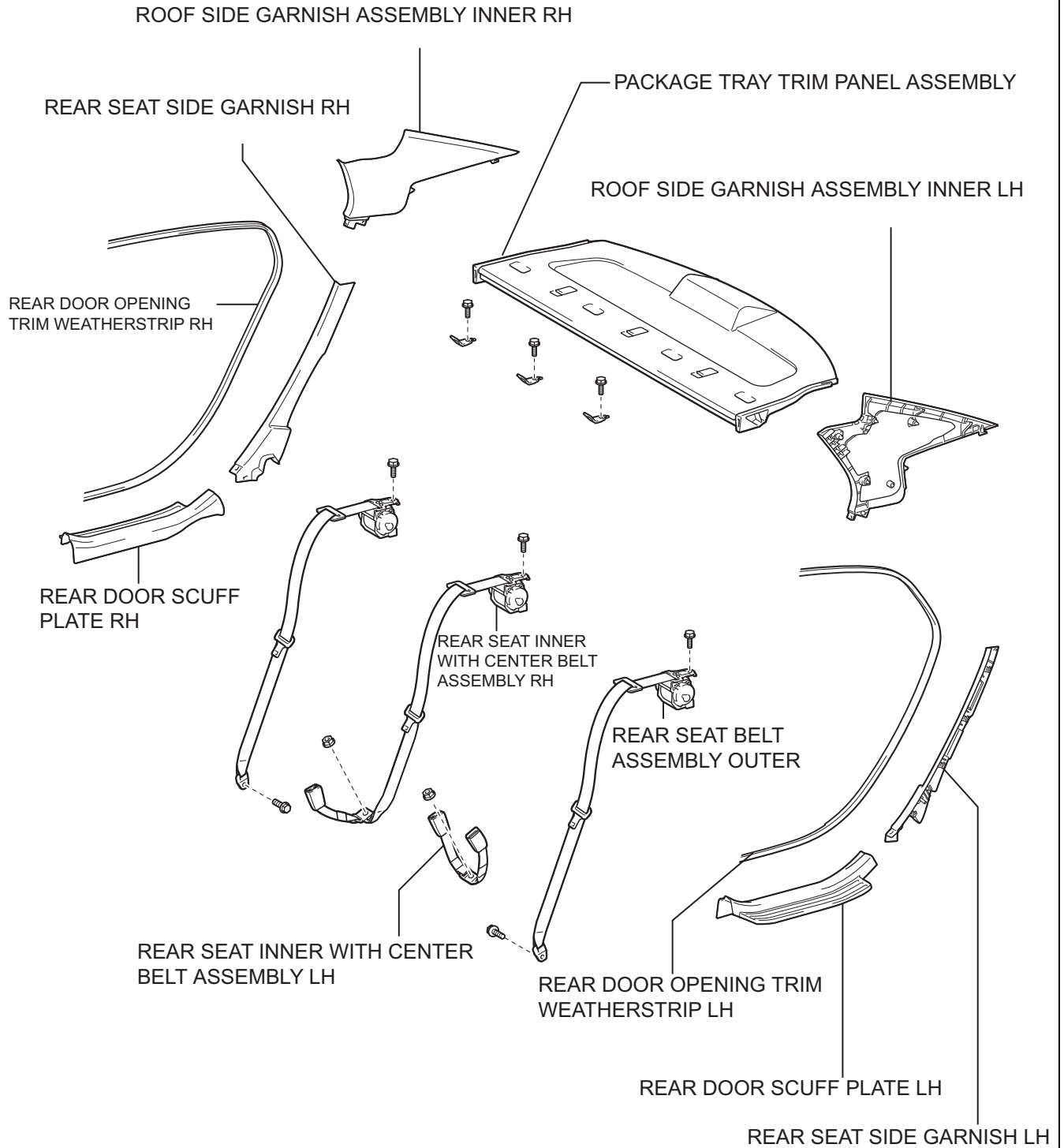

SB

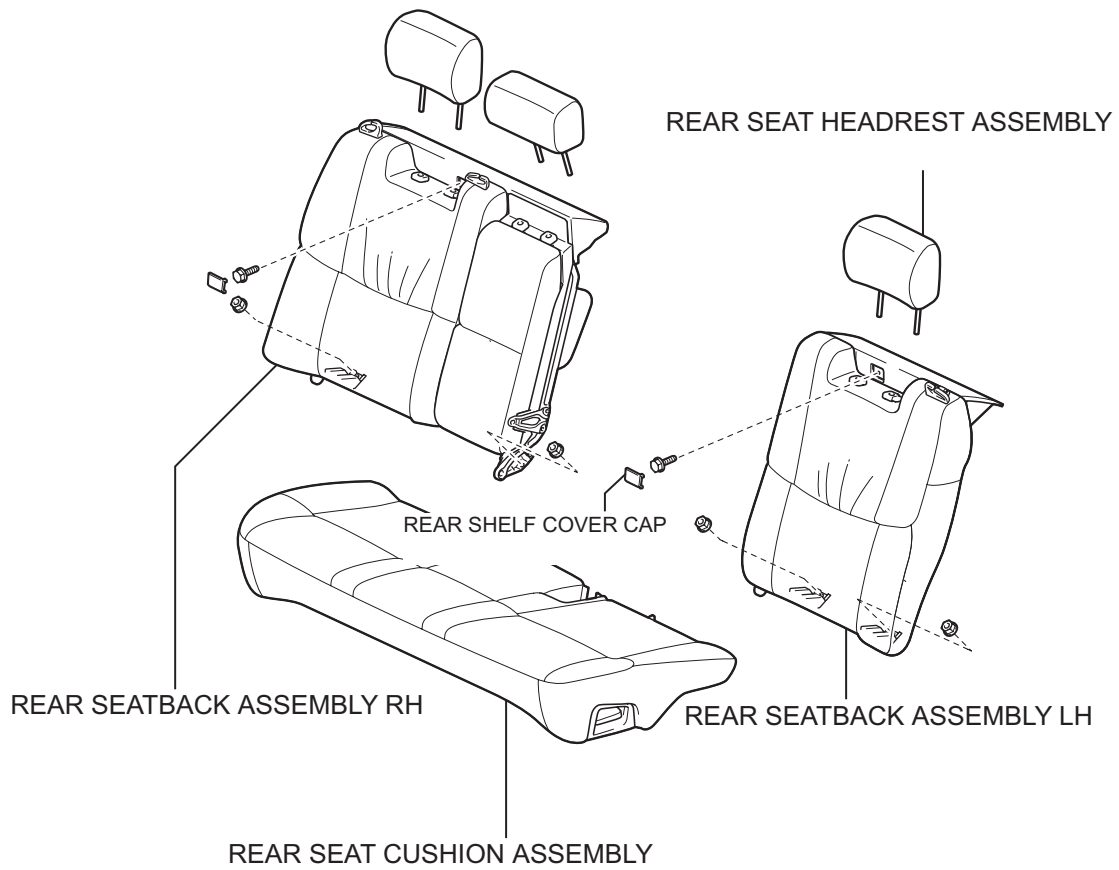

REMOVAL

HINT:

- The installation procedures are the removal procedures in reverse order. However, only installation procedures requiring additional information are included.
- Use the same procedures for the RH side and LH side.
- The procedures listed below are for the LH side.

1. DISCONNECT BATTERY NEGATIVE TERMINAL

HINT:

See page [RS-1](#)

2. REMOVE REAR SEAT CUSHION ASSEMBLY (See page [SE-68](#))

3. REMOVE REAR SEAT HEADREST ASSEMBLY

4. REMOVE REAR SHELF COVER CAP (See page [SE-68](#))

5. REMOVE REAR SEATBACK ASSEMBLY LH (See page [SE-68](#))

6. REMOVE REAR SEATBACK ASSEMBLY RH (See page [SE-69](#))

7. REMOVE REAR DOOR SCUFF PLATE LH (See page [IR-12](#))

8. REMOVE REAR DOOR SCUFF PLATE RH (See page [IR-12](#))

9. REMOVE REAR DOOR OPENING TRIM WEATHERSTRIP LH

10. REMOVE REAR DOOR OPENING TRIM WEATHERSTRIP RH

11. REMOVE REAR SEAT SIDE GARNISH LH (See page [IR-14](#))

12. REMOVE REAR SEAT SIDE GARNISH RH (See page [IR-14](#))

13. REMOVE ROOF SIDE GARNISH ASSEMBLY INNER LH (See page [IR-14](#))

14. REMOVE ROOF SIDE GARNISH ASSEMBLY INNER RH (See page [IR-14](#))

15. REMOVE PACKAGE TRAY TRIM PANEL ASSEMBLY

- (a) Remove the bolt and disconnect the rear seat belt assembly outer.

HINT:

Use the same procedures for the RH side and LH side.

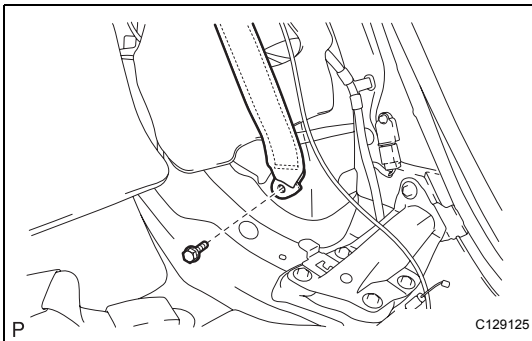

SB

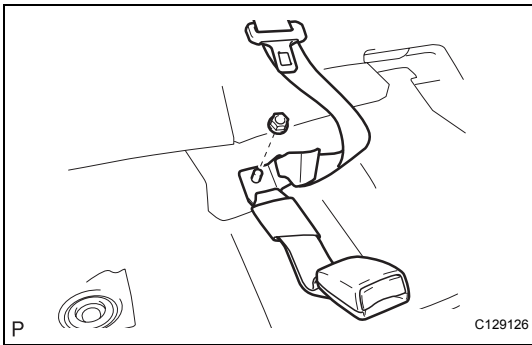

- (b) Remove the nut and disconnect the rear seat inner w/ center belt assembly RH.

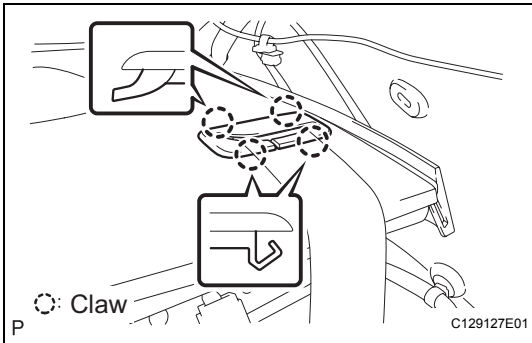

- (c) Disengage the 4 claws and the rear seat shoulder belt cover.
HINT:
Use the same procedures for the RH side and LH side.

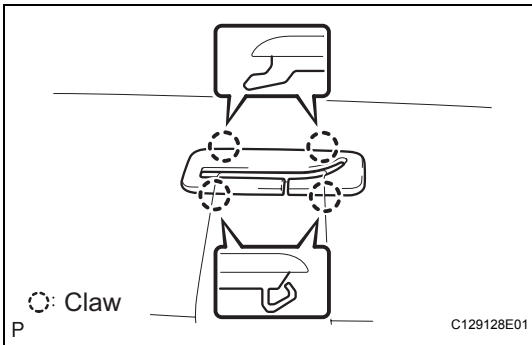

- (d) Disengage the 4 claws and the rear seat shoulder belt cover.

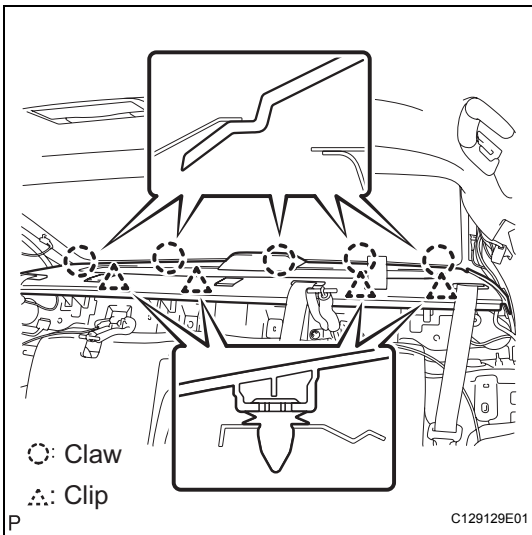

- (e) Disengage the 5 claws, 4 clips, and the package tray panel assembly.
(f) Disconnect the connector and remove the package tray panel assembly.

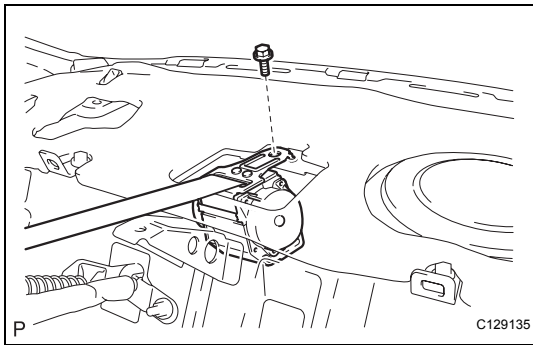

16. REMOVE REAR SEAT INNER WITH CENTER BELT ASSEMBLY RH

- (a) Remove the bolt and the rear seat inner w/ center belt assembly RH.

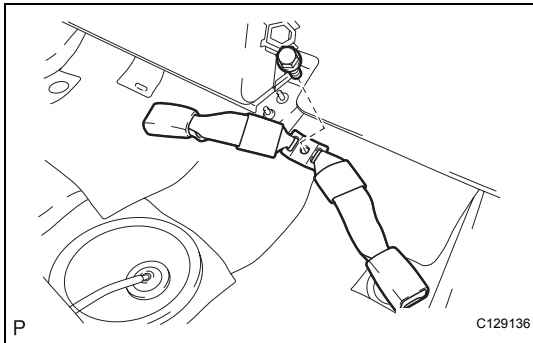

17. REMOVE REAR SEAT INNER WITH CENTER BELT ASSEMBLY LH

- (a) Remove the bolt and remove the rear seat inner w/ center belt assembly LH.

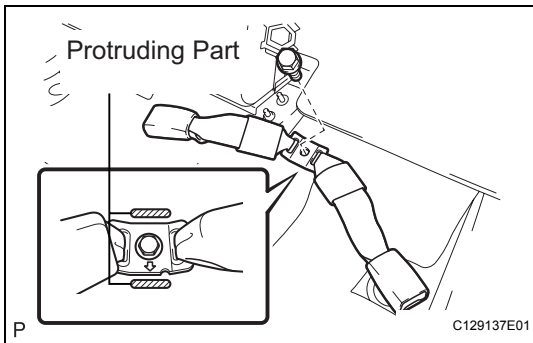

INSTALLATION

1. INSTALL REAR SEAT INNER WITH CENTER BELT ASSEMBLY LH

- (a) Install the rear seat inner w/ center belt assembly LH with the bolt.

Torque: 42 N*m (428 kgf*cm, 31 ft.*lbf)

NOTICE:

- Do not overlap the anchor part of the rear belt and the protruding parts of the rear seat adjuster.
- Make sure arrow is pointing towards the front of the vehicle.

2. INSTALL REAR SEAT INNER WITH CENTER BELT ASSEMBLY RH

NOTICE:

Do not disassemble the retractor.

- (a) Check the degree of inclination when the belt begins to lock the ELR.

- (1) When the inclination of the retractor is 15° or less, check that the belt can be pulled from the retractor. When the inclination of the retractor is over 45°, check that the belt locks. If operation is not as specified, replace the belt assembly.

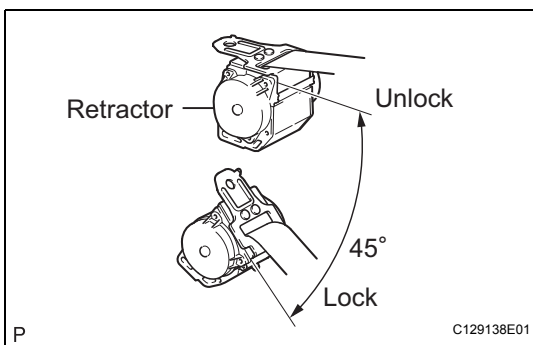

SB

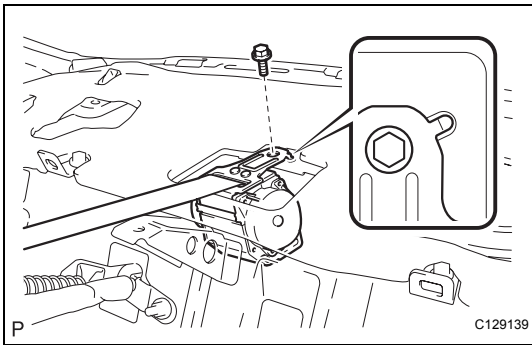

- (b) Install the rear seat inner w/ center belt assembly RH with the bolt.

Torque: 42 N*m (428 kgf*cm, 31 ft.*lbf)

3. INSTALL PACKAGE TRAY TRIM PANEL ASSEMBLY

- (a) Connect the connector.
 (b) Engage the 5 claws and the 4 clips and install the package tray panel assembly.

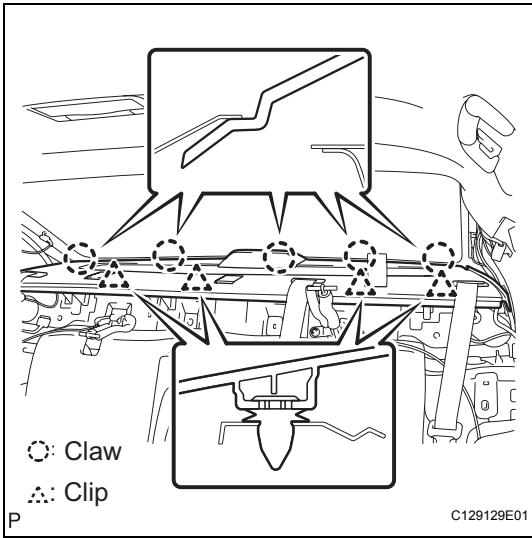

- (c) Engage the 4 claws and install the rear seat shoulder belt cover.

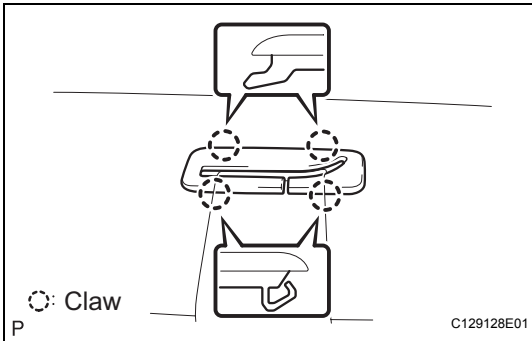

- (d) Engage the 4 claws and the rear seat shoulder belt cover.

HINT:

Use the same procedures for the RH side and LH side.

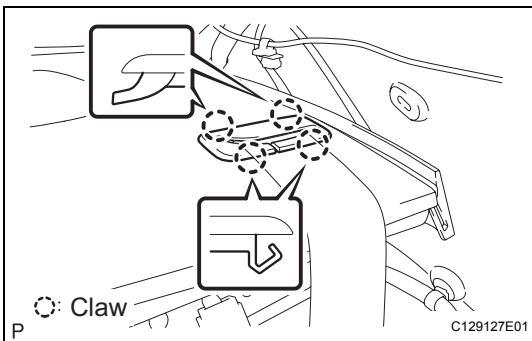

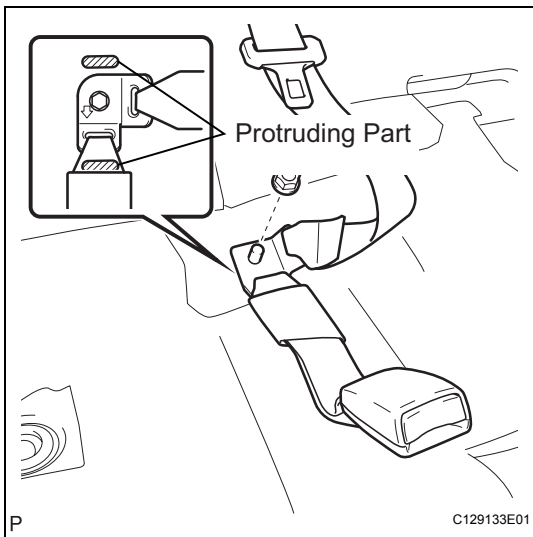

- (e) Install the rear seat inner w/ center belt assembly RH with the nut.

Torque: 42 N*m (428 kgf*cm, 31 ft.*lbf)

NOTICE:

- Do not overlap the anchor part of the rear belt and the protruding parts of the rear seat adjuster.
- Make sure arrow is pointing towards the front of the vehicle.

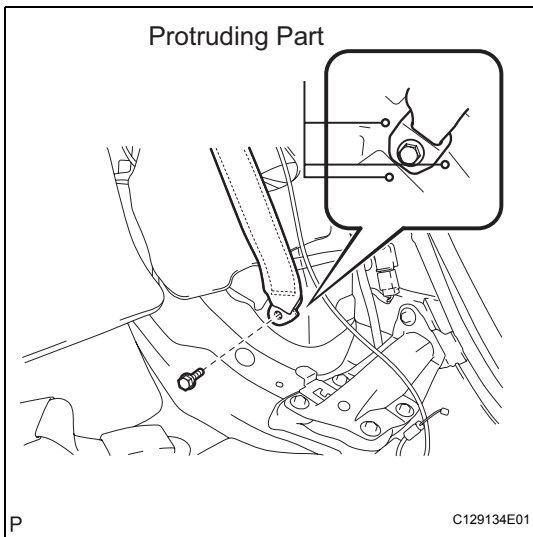

- (f) Install the rear seat belt assembly outer with the bolt.

Torque: 42 N*m (428 kgf*cm, 31 ft.*lbf)

NOTICE:

Do not overlap the anchor part of the rear belt and the protruding parts of the rear seat adjuster.

HINT:

Use the same procedures for the RH side and LH side.

- (g) Check if the ELR locks.

NOTICE:

The check should be performed with the outer belt assembly installed.

- (1) With the belt assembly installed, check that the belt locks when it is pulled out quickly.
If operation is not as specified, replace the belt assembly.

4. **INSTALL ROOF SIDE GARNISH ASSEMBLY INNER LH (See page [IR-19](#))**

5. **INSTALL ROOF SIDE GARNISH ASSEMBLY INNER RH (See page [IR-19](#))**

6. **INSTALL REAR SEATBACK ASSEMBLY RH (See page [SE-76](#))**

7. **INSTALL REAR SEATBACK ASSEMBLY LH (See page [SE-77](#))**

8. **REMOVE REAR SEAT CUSHION ASSEMBLY**

9. **CONNECT CABLE TO NEGATIVE BATTERY TERMINAL**

10. **PERFORM INITIALIZATION**

HINT:

See page [IN-29](#)

11. INSPECT SRS WARNING LIGHT

HINT:

See page [RS-28](#)

CHILD RESTRAINT SEAT ANCHOR BRACKET

COMPONENTS

SB

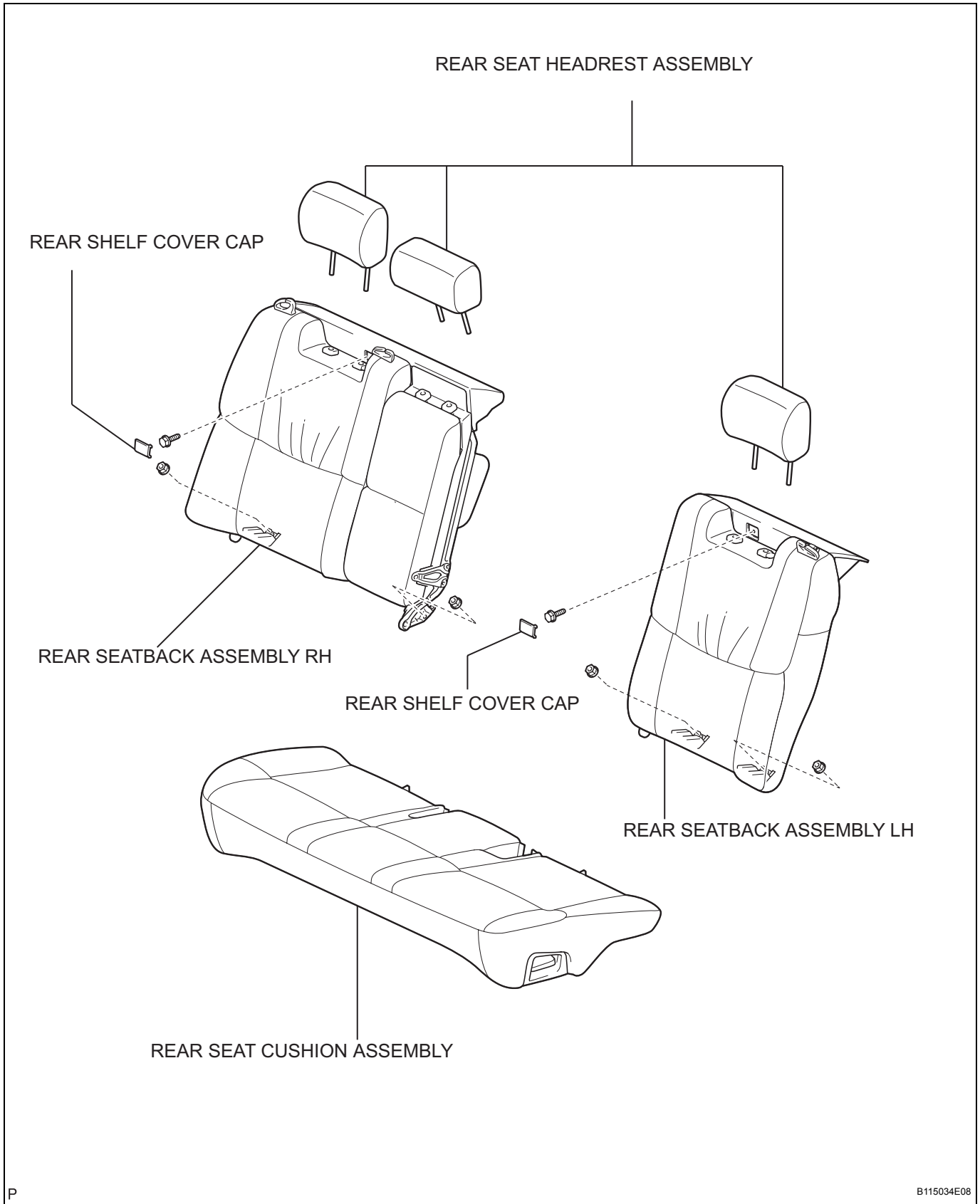

SB

ROOF SIDE GARNISH ASSEMBLY INNER RH

REAR SEAT SIDE GARNISH RH

PACKAGE TRAY TRIM PANEL ASSEMBLY

ROOF SIDE GARNISH ASSEMBLY INNER LH

REAR DOOR OPENING TRIM WEATHERSTRIP RH

CHILD RESTRAINT SEAT TETHER ANCHOR BRACKET

REAR DOOR SCUFF PLATE RH

REAR DOOR OPENING TRIM WEATHERSTRIP LH

REAR DOOR SCUFF PLATE LH

REAR SEAT SIDE GARNISH LH

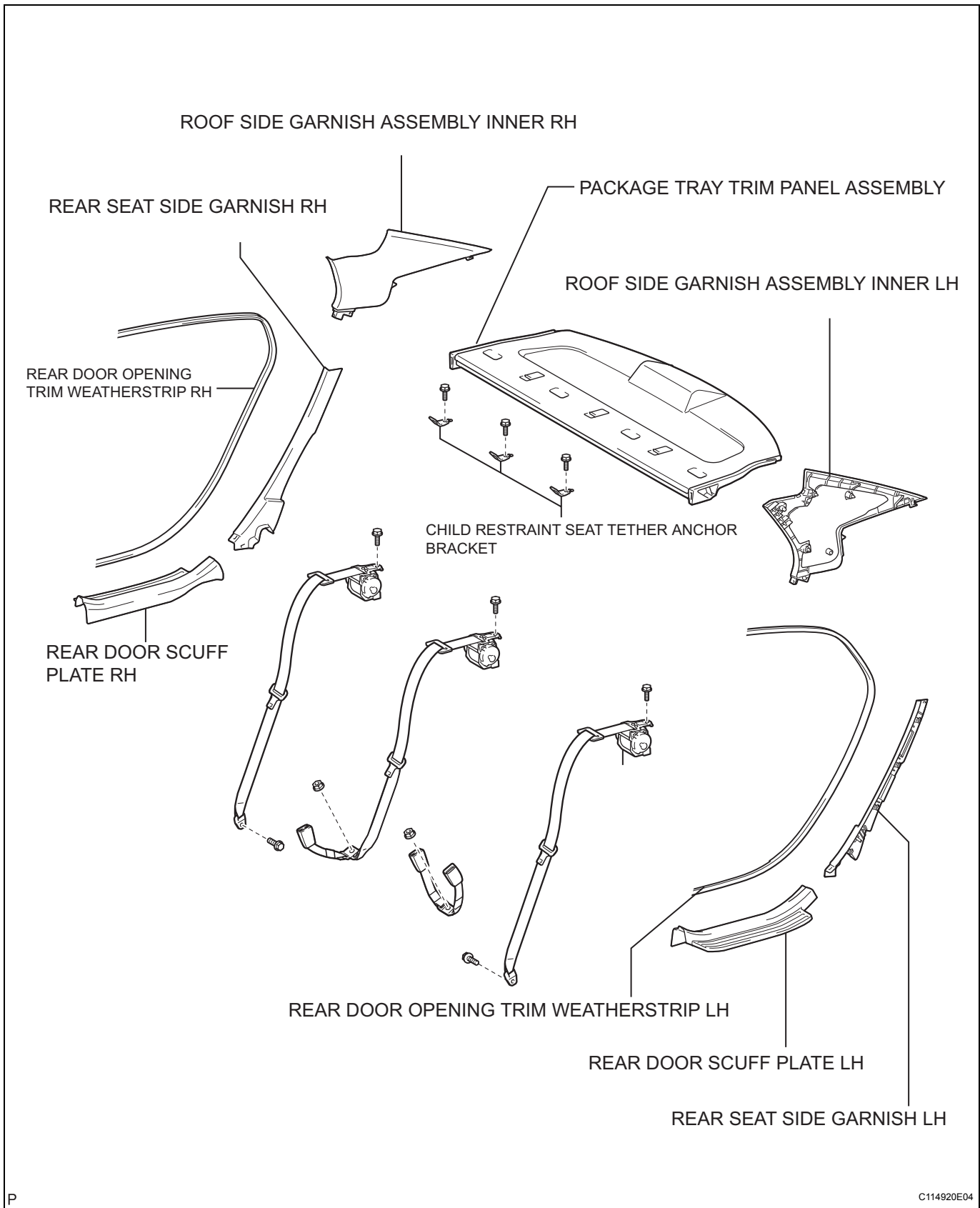

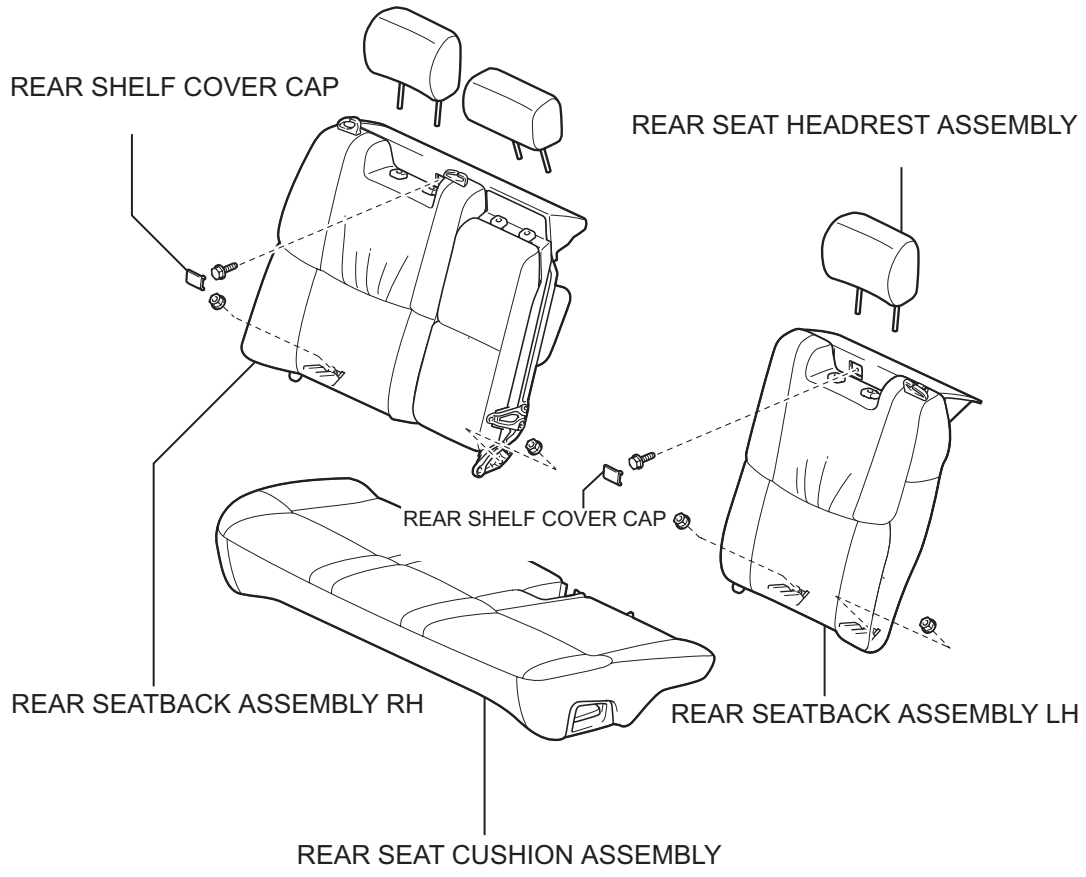

REMOVAL

HINT:

The procedures listed below are for the LH side.

1. DISCONNECT CABLE FROM NEGATIVE BATTERY TERMINAL

HINT:

See page [RS-1](#)

2. REMOVE REAR SEAT CUSHION ASSEMBLY (See page [SE-68](#))

3. REMOVE REAR SEAT HEADREST ASSEMBLY

4. REMOVE REAR SHELF COVER CAP (See page [SE-68](#))

5. REMOVE REAR SEATBACK ASSEMBLY LH (See page [SE-68](#))

6. REMOVE REAR SEATBACK ASSEMBLY RH (See page [SE-69](#))

7. REMOVE REAR DOOR SCUFF PLATE LH (See page [IR-12](#))

8. REMOVE REAR DOOR SCUFF PLATE RH (See page [IR-12](#))

9. REMOVE REAR DOOR OPENING TRIM WEATHERSTRIP LH

10. REMOVE REAR DOOR OPENING TRIM WEATHERSTRIP RH

11. REMOVE REAR SEAT SIDE GARNISH LH (See page [IR-14](#))

12. REMOVE REAR SEAT SIDE GARNISH RH (See page [IR-14](#))

13. REMOVE ROOF SIDE GARNISH ASSEMBLY INNER LH (See page [IR-14](#))

14. REMOVE ROOF SIDE GARNISH ASSEMBLY INNER RH (See page [IR-14](#))

15. REMOVE PACKAGE TRAY TRIM PANEL ASSEMBLY

- (a) Remove the bolt and disconnect the rear seat belt assembly outer.

HINT:

Use the same procedures for the RH side and LH side.

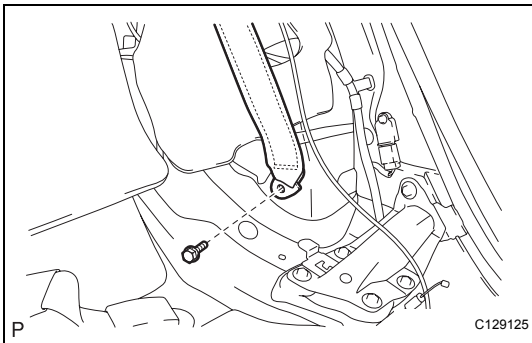

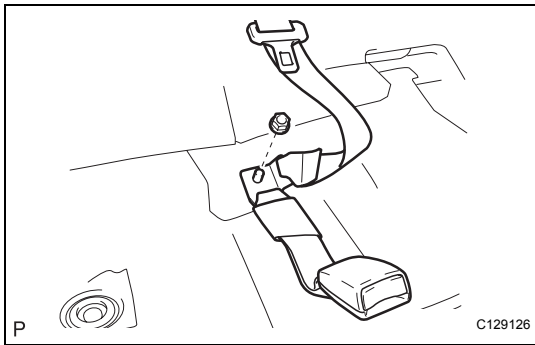

- (b) Remove the nut and disconnect the rear seat inner w/ center belt assembly RH.

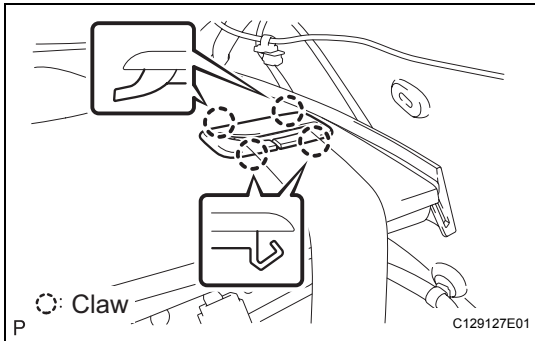

- (c) Disengage the 4 claws and the rear seat shoulder belt cover.
HINT:
Use the same procedures for the RH side and LH side.

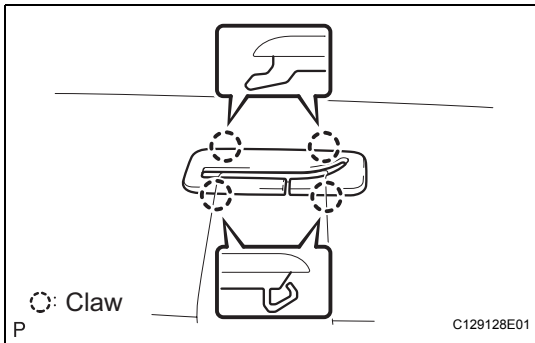

- (d) Disengage the 4 claws and the rear seat shoulder belt cover.

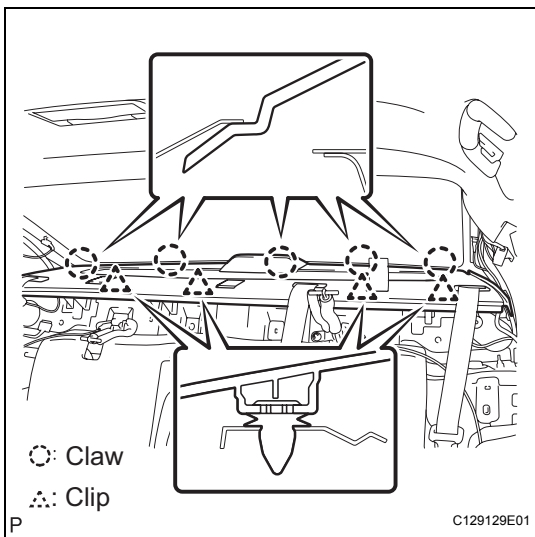

- (e) Disengage the 5 claws, 4 clips, and the package tray panel assembly.
(f) Disconnect the connector and remove the package tray panel assembly.

SB

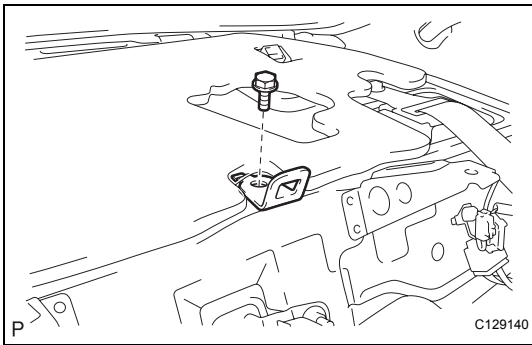

16. REMOVE CHILD RESTRAINT SEAT TETHER ANCHOR BRACKET

- (a) Remove the bolt and the child restraint seat tether anchor bracket.

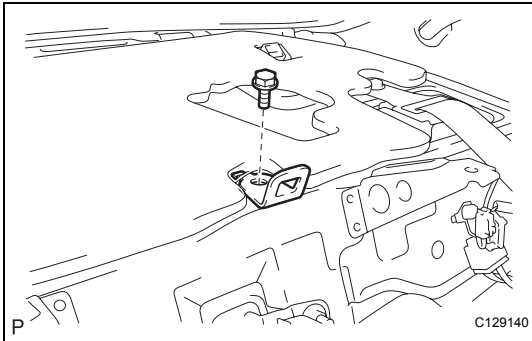

INSTALLATION

1. INSTALL CHILD RESTRAINT SEAT TETHER ANCHOR BRACKET

- (a) Install the child restraint seat tether anchor bracket with the bolt.

Torque: 42 N*m (428 kgf*cm, 31 ft.*lbf)

2. INSTALL PACKAGE TRAY TRIM PANEL ASSEMBLY

- (a) Connect the connector.
 (b) Engage the 5 claws and the 4 clips and install the package tray panel assembly.

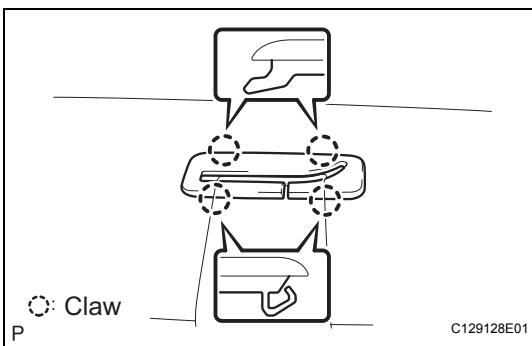
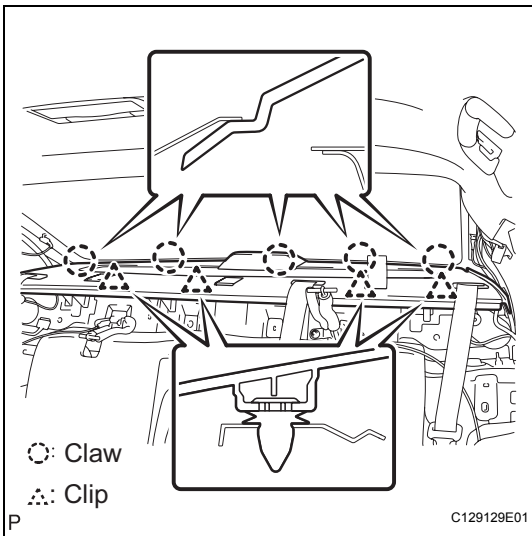

- (c) Engage the 4 claws and install the rear seat shoulder belt cover.

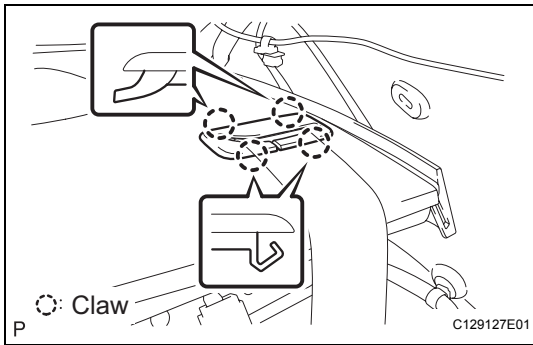

- (d) Engage the 4 claws and the rear seat shoulder belt cover.

HINT:

Use the same procedures for the RH side and LH side.

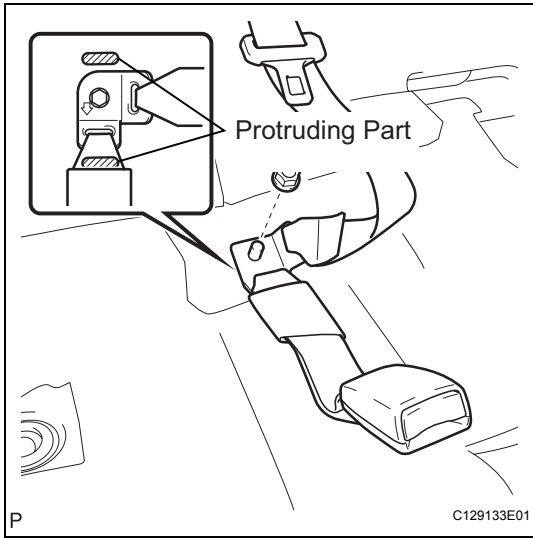

- (e) Install the rear seat inner w/ center belt assembly RH with the nut.

Torque: 42 N*m (428 kgf*cm, 31 ft.*lbf)

NOTICE:

- Do not overlap the anchor part of the rear belt and the protruding parts of the rear seat adjuster.
- Make sure arrow is pointing towards the front of the vehicle.

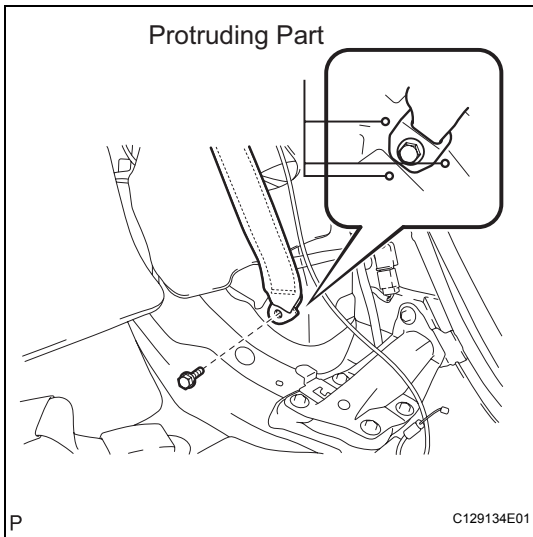

- (f) Install the rear seat belt assembly outer with the bolt.

Torque: 42 N*m (428 kgf*cm, 31 ft.*lbf)

NOTICE:

Do not overlap the anchor part of the rear belt and the protruding parts of the rear seat adjuster.

HINT:

Use the same procedures for the RH side and LH side.

- (g) Check if the ELR locks.

NOTICE:

The check should be performed with the outer belt assembly installed.

- (1) With the belt assembly installed, check that the belt locks when it is pulled out quickly.
If operation is not as specified, replace the belt assembly.

3. **INSTALL ROOF SIDE GARNISH ASSEMBLY INNER LH (See page [IR-19](#))**
4. **INSTALL ROOF SIDE GARNISH ASSEMBLY INNER RH (See page [IR-19](#))**
5. **INSTALL REAR SEATBACK ASSEMBLY RH (See page [SE-76](#))**

SB

6. **INSTALL REAR SEATBACK ASSEMBLY LH (See page [SE-77](#))**
7. **INSTALL REAR SEAT CUSHION ASSEMBLY**
8. **CONNECT CABLE TO NEGATIVE BATTERY TERMINAL**
9. **PERFORM INITIALIZATION**
HINT:
See page [IN-29](#)
10. **INSPECT SRS WARNING LIGHT**
HINT:
See page [RS-28](#)