

2007-08 ACCESSORIES AND EQUIPMENT

Dashboard - Element

DRIVER'S DASHBOARD PANEL REMOVAL/INSTALLATION

**NOTE:** Take care not to scratch the dashboard and related parts.

1. Open the driver's door, and gently pull out on the front of the dashboard side lid (A) to release the hooks (B), then remove the lid.

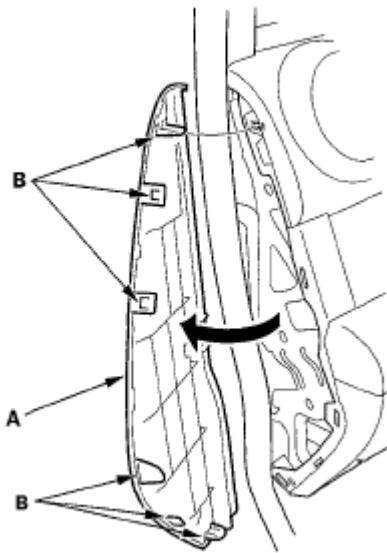
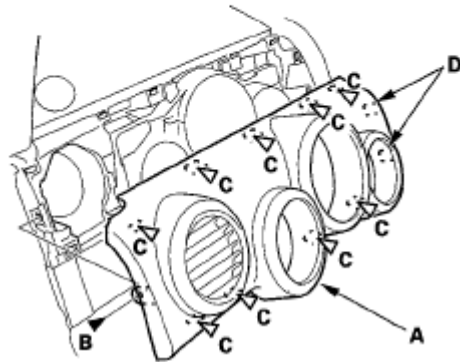
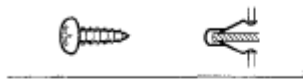

**Fig. 1: Pulling Out On Front Of Dashboard Side Lid**

2. Tilt the steering column down.
3. Remove the driver's dashboard panel (A).
  - 1 Open the driver's door, and remove the screw (B).
  - 2 Gently pull out the panel along the bottom to detach the clips (C).
  - 3 Gently pull out the panel along the top to detach the clips.
  - 4 Gently release the hooks (D) on the inside edge of the panel.

**Fastener Locations**

**B ▶ : Screw, 1    C ▷ : Clip, 9**



**Fig. 2: Identifying Driver's Dashboard Panel And Hooks**

4. Install the panel in the reverse order of removal, and note these items:
  - Check if the clips are damaged or stress-whitened, and if necessary, replace them with new ones.
  - Push the clips and hooks into place securely.

## **DRIVER'S DASHBOARD LOWER COVER REMOVAL/INSTALLATION**

**NOTE:**        **Take care not to scratch the dashboard and related parts.**

1. Remove the driver's dashboard lower cover (A).
  - 1 Turn the lock knobs (B) 90°.
  - 2 Gently pull out on the bottom edge to release the side hooks (C).
  - 3 Release the upper hooks (D).

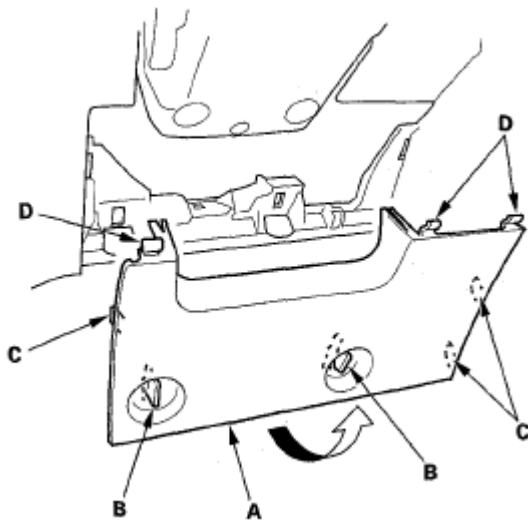

**Fig. 3: Releasing Upper Hooks**

2. Install the cover in the reverse order of removal, and push the side hooks into place securely.

## DRIVER'S POCKET REMOVAL/INSTALLATION

**NOTE:**

- Put on gloves to protect your hands.
- Take care not to scratch the dashboard and related parts.

1. Reach under the dashboard, and push on lock tabs (A) to release the cruise control main switch (B), and the VSA OFF switch (C), then remove the cruise control main switch and the VSA OFF switch. Disconnect the connectors (D, E).

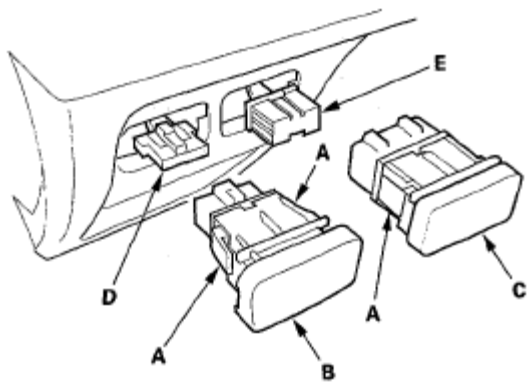
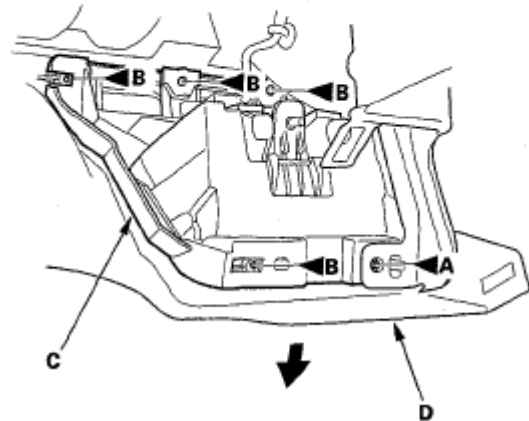
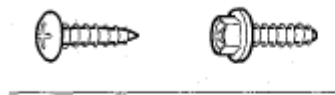

**Fig. 4: Identifying Cruise Control Main Switch And VSA OFF Switch Connectors**

2. From under the dash, remove the screws (A, B) securing the driver's pocket (C).

**Fastener Locations**

A ▶ : Screw, 1    B ▶ : Screw, 4

**Fig. 5: Removing Screws Securing Driver's Pocket**

3. While pulling out on the bottom edge of the dashboard (D), remove the pocket.
4. Install the pocket in the reverse order of removal, and make sure the switch connector is plugged in properly.

**DRIVER'S VENT REMOVAL/INSTALLATION****Special Tools Required**

KTC trim tool set SOJATP2014 \*

\* Available through the American Honda Tool and Equipment Program; call 888-424-6857

**NOTE:**

- Use the appropriate tool from the KTC trim tool set to avoid damage when prying components.
- The passenger's vent is similar.

1. Apply protective tape around the related parts to prevent damage. Carefully insert the appropriate tool from the KTC trim tool set next to the clips, and detach the clips by prying on the driver's vent (A). Take care not to scratch the dashboard and related parts.

**Fastener Locations**

▷ : Clip, 3

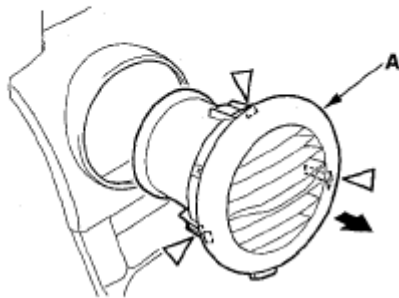

**Fig. 6: Detaching Clips By Prying On Driver's Vent**

2. Pull out on the driver's vent, then remove it.
3. Install the driver's vent by pushing the clips into place securely.

## DRIVER'S OUTER DASHBOARD TRIM REMOVAL/INSTALLATION

**NOTE:** Take care not to scratch the dashboard and related parts.

1. Pull out on the driver's outer dashboard trim (A) to release the clips and hooks (B) from the dashboard.

**Fastener Locations**

▷ : Clip, 2

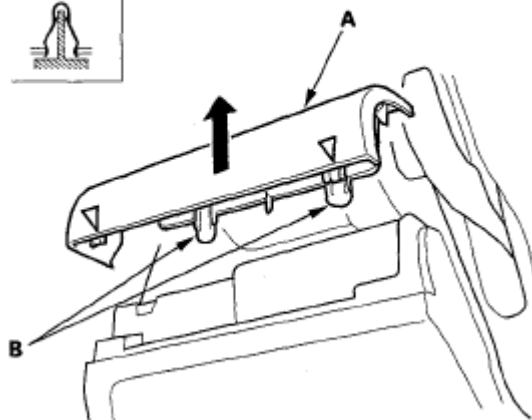

**Fig. 7: Pulling Out On Driver's Outer Dashboard Trim**

2. Install the dashboard trim in the reverse order of removal, and push the clip and hook portions into place securely.

## DRIVER'S INNER DASHBOARD TRIM REMOVAL/INSTALLATION

**NOTE:** Take care not to scratch the dashboard and related parts.

1. Pull out on the driver's inner dashboard trim (A) to release the clips and hooks (B) from the dashboard.

### Fastener Locations

▷ : Clip, 2

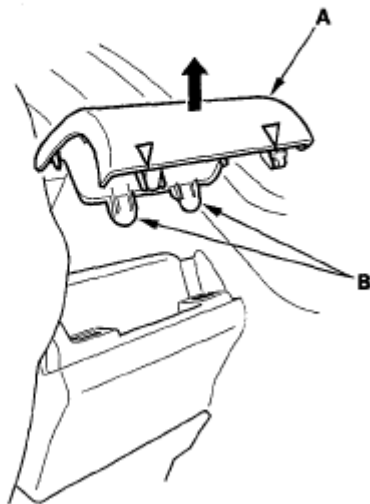

**Fig. 8: Pulling Out On Driver's Inner Dashboard Trim**

2. Install the dashboard trim in the reverse order of removal, and push the clip and hook portions into place securely.

## CENTER LOWER COVER REMOVAL/INSTALLATION

### Special Tools Required

KTC trim tool set SOJATP2014 \*

\* Available through the American Honda Tool and Equipment Program; call 888-424-6857

### NOTE:

- Use the appropriate tool from the KTC trim tool set to avoid damage when prying components.
- Take care not to scratch the dashboard and related parts.

1. Remove the clips (A) and detach the clips (B) then remove the center rear cover (C).

Fastener Locations

A▷: Clip, 2 B▷: Clip, 2

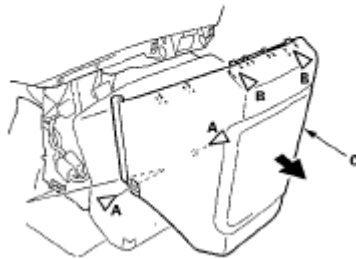
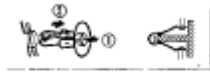
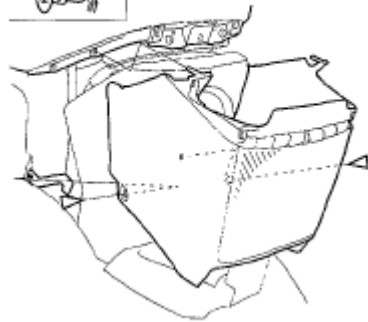
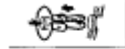

**Fig. 9: Removing Center Rear Cover**

2. SC model: Remove the clips (A), then remove the center rear cover (B).

Fastener Locations

▷: Clip, 2



**Fig. 10: Removing Center Rear Cover For SC Model**

3. Install the cover the reverse order of removal, and note these items:
  - Check if the clips are damaged or stress-whitened, and if necessary, replace them with new ones.
  - Push the clips into place securely.

## SHIFT LEVER TRIM REMOVAL/INSTALLATION

**NOTE:**

- Put on gloves to protect your hands.
- Do not pry the panel surface with a flat-tip screwdriver, to prevent damage.
- Take care not to scratch the dashboard and related parts.

1. Remove these items:
  - Center lower cover (see **CENTER LOWER COVER REMOVAL/INSTALLATION** )
  - Subwoofer, for some models (see **SUBWOOFER** )
2. M/T model: Remove the shift knob (A).

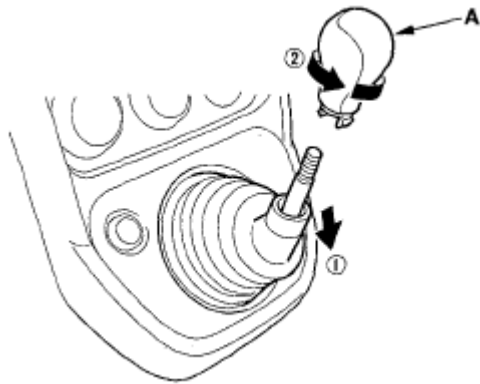

**Fig. 11: Removing Shift Knob**

3. Using the handle end of a hammer (A), carefully insert the handle through the center lower cover opening, and push on the back side of the shift lever trim (B) to start to release the clips.

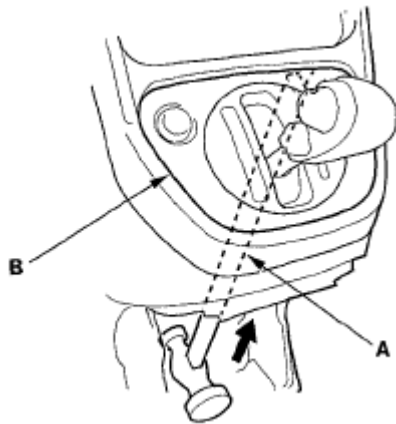

**Fig. 12: Inserting Handle Through Center Lower Cover Opening**

4. Pull out the shift lever trim (A) to release the remaining clips, hooks (B), and disconnect hazard warning switch connector (C).



## Fastener Locations

▷: Clip, 4

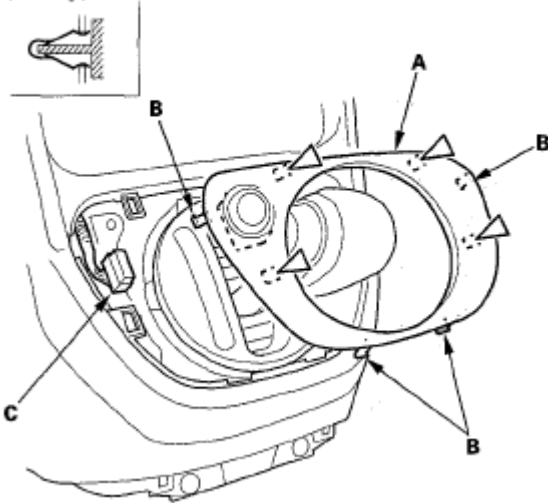

**Fig. 13: Pulling Out Shift Lever Trim**

5. Install the panel in the reverse order of removal, and note these items:
  - Make sure each connector is plugged in properly.
  - Push the clip and hook portions into place securely.

## CENTER PANEL REMOVAL/INSTALLATION

### Special Tools Required

KTC trim tool set SOJATP2014 \*

\* Available through the American Honda Tool and Equipment Program; call 888-424-6857

### NOTE:

- Use the appropriate tool from the KTC trim tool set to avoid damage when prying components.
- Take care not to scratch the dashboard and related parts.

1. Remove these items:
  - Center lower cover (see **CENTER LOWER COVER REMOVAL/INSTALLATION** )
  - Shift lever trim (see **SHIFT LEVER TRIM REMOVAL/INSTALLATION** )
2. Release the lower clips in the radio panel (A) by putting a hook-snapped tool into the notches (B) and pulling out carefully. Pull out on the radio panel to release the upper clips.

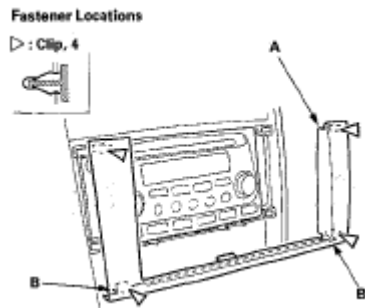

**Fig. 14: Releasing Lower Clips In Radio Panel**

3. Pull on the center panel (A) to release the clips, then disconnect the heater control unit connector (B).

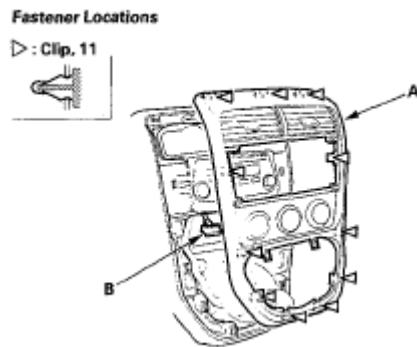

**Fig. 15: Identifying Center Panel And Heater Control Unit Connector**

4. Install the panel in the reverse order of removal, and note these items:
  - Make sure the heater control unit connector is plugged in properly.
  - Push the clips into place securely.

## **GLOVE BOX REMOVAL/INSTALLATION**

**NOTE:** Take care not to scratch the dashboard and related parts.

1. While holding the glove box (A), remove the glove box stop (B) on each side.

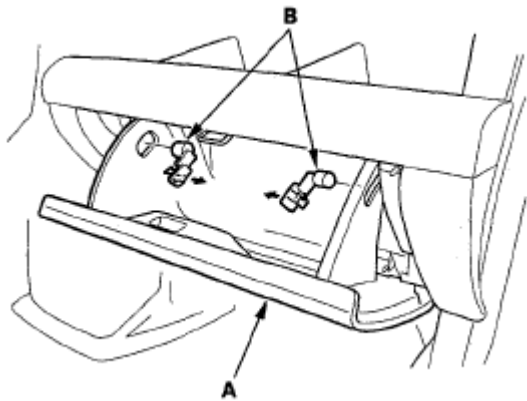
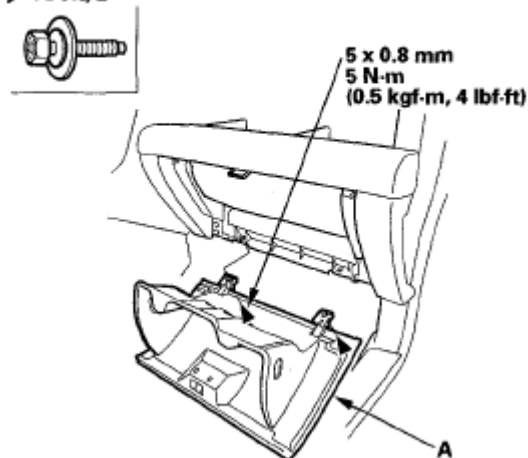

**Fig. 16: Removing Glove Box Stop**

2. Remove the bolts, then remove the glove box (A).

**Fastener Locations**

► : Bolt, 2



**Fig. 17: Removing Glove Box**

3. Install the glove box in the reverse order of removal.

## PASSENGER'S DASHBOARD UNDERCOVER REMOVAL/INSTALLATION

**NOTE:** Take care not to scratch the dashboard and related parts.

1. Remove the passenger's dashboard undercover (A).
  - 1 Gently pull down the rear edge to release the clips.
  - 2 Pull the cover away to release the pins (B) from the holders (C).

**Fastener Locations**

▷ : Clip, 3

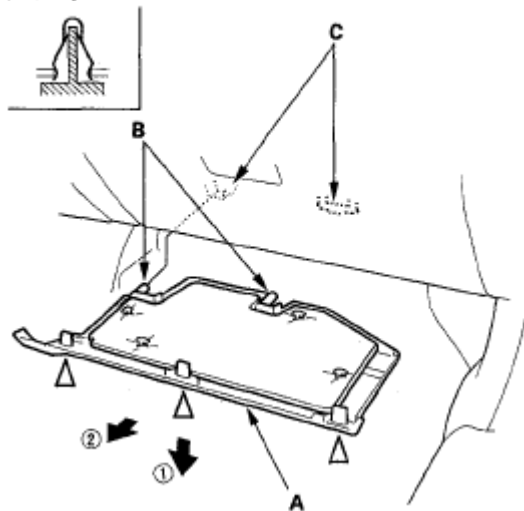

**Fig. 18: Releasing Pins From Holders**

2. Install the cover in the reverse order of removal, and push the clip portions into place securely.

## PASSENGER'S DASHBOARD UPPER PANEL AND DASHBOARD TRAY COVER REMOVAL/INSTALLATION

**NOTE:**

- Put on gloves to protect your hands.
- Take care not to scratch the dashboard and related parts.

1. Open the passenger's door, and gently pull out on the front of the dashboard side lid (A) to release the hooks (B), then remove the lid.

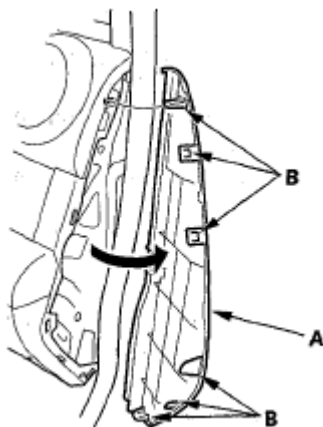
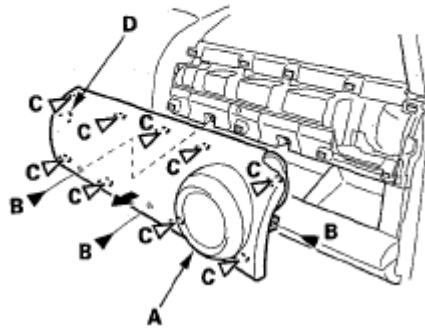

**Fig. 19: Releasing Hooks**

2. Remove the dashboard upper panel (A).
  - 1 Remove the screws (B).
  - 2 Gently pull out on the panel to release the clips (C) and hook (D).

**Fastener Locations**

**B** ▶ : Screw, 3    **C** ▷ : Clip, 9

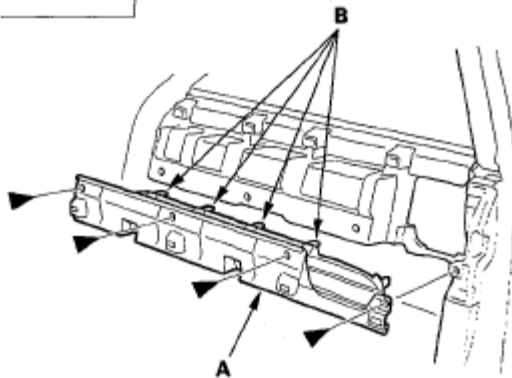

**Fig. 20: Releasing Clips And Hook**

3. Remove the dashboard tray cover (A).
  - 1 Remove the screws.
  - 2 Gently pull out on the cover to release the hooks (B).

**Fastener Locations**

▶ : Screw, 4



**Fig. 21: Removing Dashboard Tray Cover**

4. Install the cover and panel in the reverse order of removal, and push the clips and hooks into place securely.

## PASSENGER'S DASHBOARD LOWER PANEL REMOVAL/INSTALLATION

**NOTE:** Take care not to scratch the dashboard and related parts.

1. Remove the glove box stop on each side, then lower the glove box (see step 1 ).
2. Remove the dashboard lower panel (A).
  - 1 Remove the screws (B).
  - 2 Gently pull out the panel to release the clips (C) and hooks (D).

### Fastener Locations

B ▶ : Screw, 2 C ▷ : Clip, 5

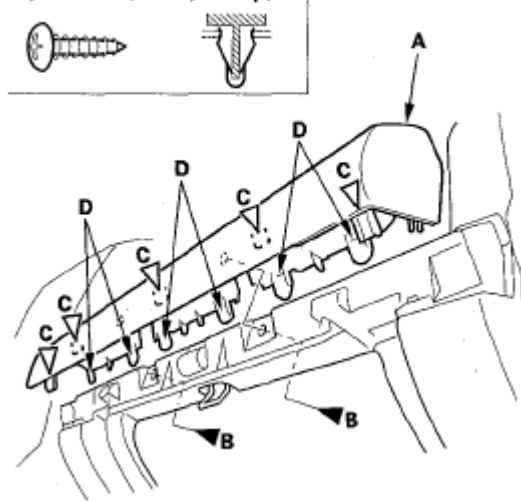

**Fig. 22: Identifying Clips And Hooks**

3. Install the panel in the reverse order of removal, and push the clips into place securely.

## DASHBOARD REMOVAL/INSTALLATION

### Special Tools Required

KTC trim tool set SOJATP2014 \*

SRS components are located in this area. Review the SRS component locations (see COMPONENT LOCATION INDEX ) and the precautions and procedures (see PRECAUTIONS AND PROCEDURES ) before doing repairs or service.

- NOTE:**
- Use the appropriate tool from the KTC trim tool set to avoid damage when prying components.
  - Have an assistant help you when prying and installing the dashboard.
  - Take care not to scratch the dashboard, body, and other related parts.

- **Put on gloves to protect your hands.**

1. Make sure you have the anti-theft code for the audio system, then write down the audio presets.
2. Disconnect the negative cable from the battery, and wait at least 3 minutes before beginning work.
3. Remove these items:
  - Driver's dashboard lower cover (see **DRIVER'S DASHBOARD LOWER COVER REMOVAL/INSTALLATION** )
  - Glove box (see **GLOVE BOX REMOVAL/INSTALLATION** )
  - Passenger's dashboard undercover (see **PASSENGER'S DASHBOARD UNDERCOVER REMOVAL/INSTALLATION** )
  - Center lower cover (see **CENTER LOWER COVER REMOVAL/INSTALLATION** )
  - Passenger's vent (see **DRIVER'S VENT REMOVAL/INSTALLATION** )
  - A-pillar trim, both sides (see **A-PILLAR TRIM** )
  - Kick panel, passenger's side (see **TRIM REMOVAL/INSTALLATION - DOOR AREAS** )
  - Steering column (see **STEERING COLUMN REMOVAL AND INSTALLATION** )
  - A/T model: Disconnect the A/T control cable (see **SHIFT LEVER REMOVAL** )
  - M/T model: Disconnect shift cable (see **GEARSHIFT MECHANISM REPLACEMENT** )
  - Subwoofer, for some models (see **SUBWOOFER** )

**Driver's side**

4. From under the dash, disconnect the tweeter harness connector (A) (on some models), driver's door wire harness connectors (B), brake pedal position switch connector (C), and clutch switch connectors (D) (on M/T model). Disconnect the engine compartment wire harness connectors (E) from the under-dash fuse/relay box (F).

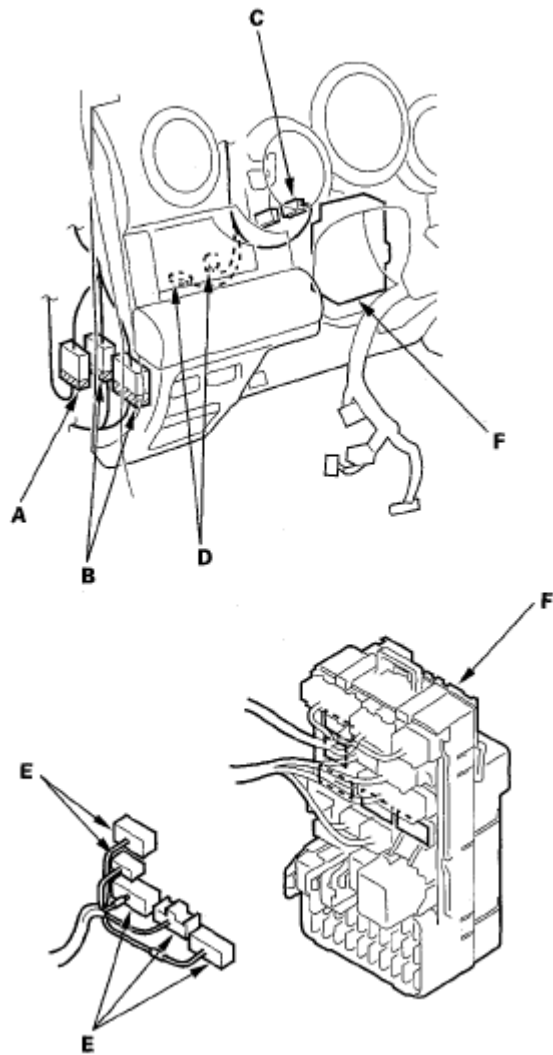
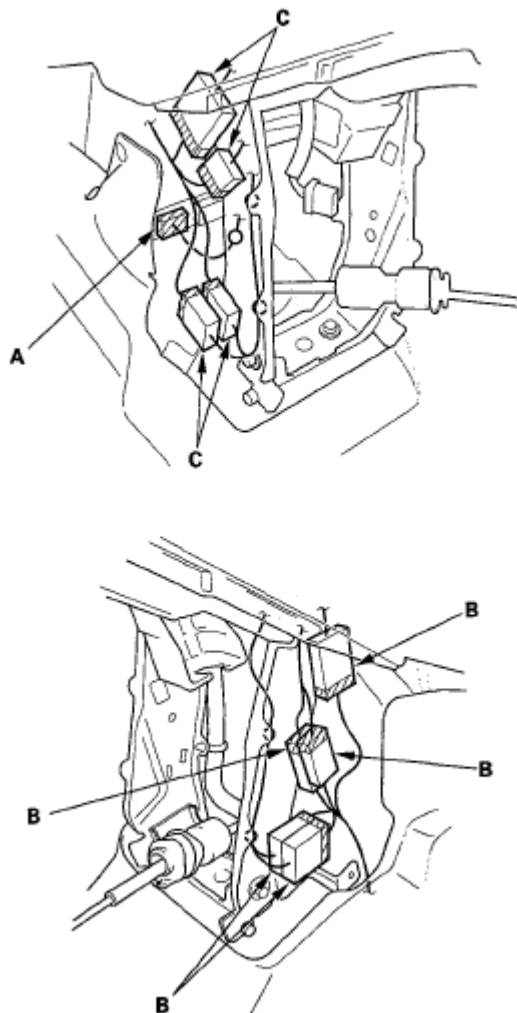

**Fig. 23: Identifying Tweeter Harness Connector And Brake Pedal Position Switch Connector**

**Middle portion**

5. Disconnect the SRS unit connector (A), floor wire harness connectors (B), and engine compartment wire harness connectors (C).

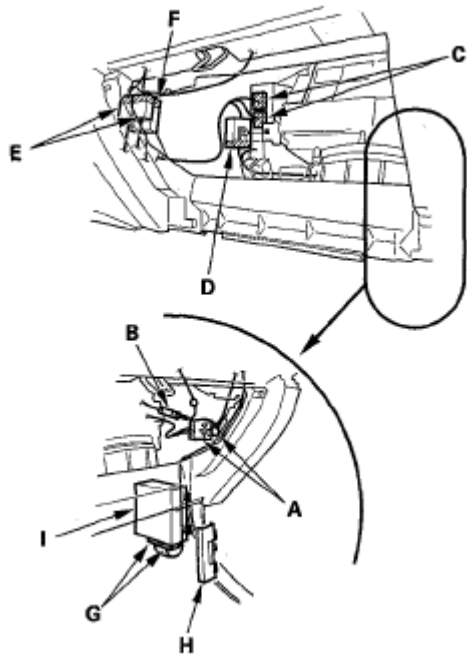



**Fig. 24: Disconnecting SRS Unit Connector, Floor Wire Harness Connectors And Engine Compartment Wire Harness Connectors**

**Passenger's side**

6. From under the dash, disconnect the passenger's door wire harness connectors (A), antenna lead (B), ECM/PCM connectors (C), engine wire harness connector (D), heater subharness connectors (E), and passenger's airbag connector (F). Disconnect the amplifier connectors (G), and release the wire harness protector (H) from the amplifier (I) (on some models).



**Fig. 25: Identifying ECM/PCM Connectors And Engine Wire Harness Connector**

7. Detach all of the harness and connector clips.
8. Remove the bolts (A, B, C) and nut (D), then lift up on the dashboard (E) to release it from the guide pins (F, G) on the body.

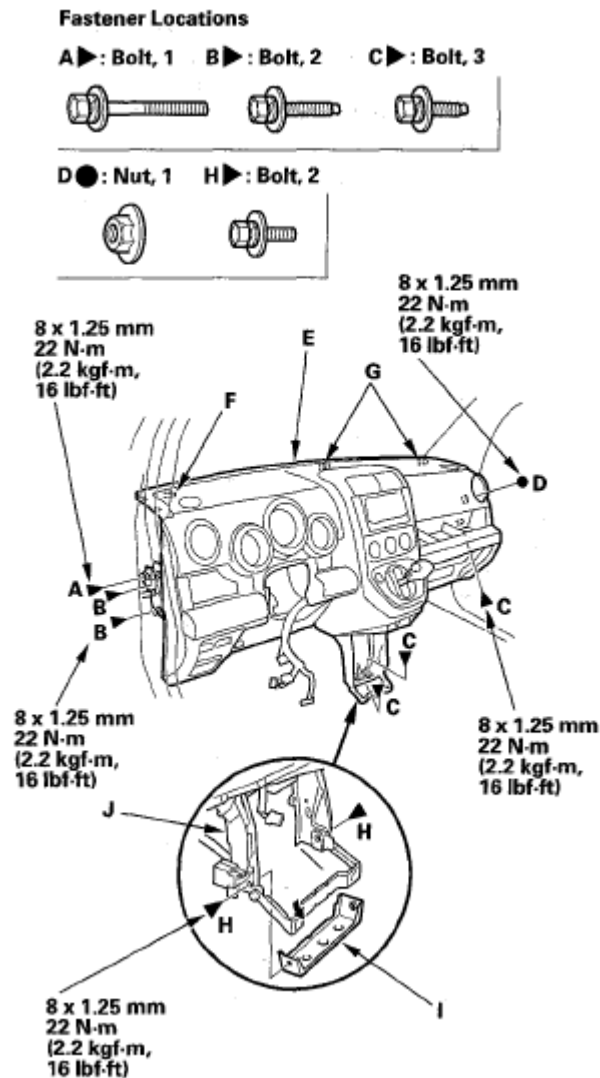

**Fig. 26: Removing Bolts And Nut**

9. Carefully remove the dashboard through the front door opening.
10. Remove the center frame mounting bolts (H), then remove the center bracket (I) from the center frame (J).
11. Install the dashboard in the reverse order of removal, and note these items:
  - Make sure the dashboard fits onto the guide pins correctly.
  - Apply liquid thread lock to the center frame mounting bolts before reinstallation.
  - Reinstall the center bracket on the center frame, and slightly tighten the mounting bolts. Reinstall the dashboard on the body. After tightening both dashboard mounting bolts and nut, tighten the center bracket mounting bolts and center frame mounting bolts.
  - Before tightening the bolts, make sure each wire harness is not pinched.
  - Make sure the connectors are plugged in properly, and the antenna lead is connected properly.
  - Reconnect the negative cable to battery.

- Enter the anti-theft code for the audio system, then enter the audio presets.
- Reset the clock.
- Do the power window control unit reset procedure (see **RESETTING THE POWER WINDOW CONTROL UNIT** ).

## STEERING HANGER BEAM REPLACEMENT

### NOTE:

- Have an assistant help you when removing and installing the steering hanger beam.
- Take care not to scratch the dashboard.
- Put on gloves to protect your hands.

1. Remove the dashboard (see **DASHBOARD REMOVAL/INSTALLATION** ).
2. Remove these items from the dashboard:
  - Driver's dashboard panel (see **DRIVER'S DASHBOARD PANEL REMOVAL/INSTALLATION** )
  - Gauge control module (see **REWRITING THE ODO DATA AND TRANSFERRING MAINTENANCE MINDER ON A NEW GAUGE CONTROL MODULE** )
  - Shift lever:
    - A/T model (see **SHIFT LEVER REMOVAL** )
    - M/T model (see **GEARSHIFT MECHANISM REPLACEMENT** )
  - Audio unit (see **AUDIO UNIT REMOVAL/INSTALLATION** )
  - Front passenger's airbag (see **FRONT PASSENGER'S AIRBAG REPLACEMENT** )
3. Remove the bolts (A) from the dashboard.

#### Fastener Locations

A ▶ : Bolt, 8

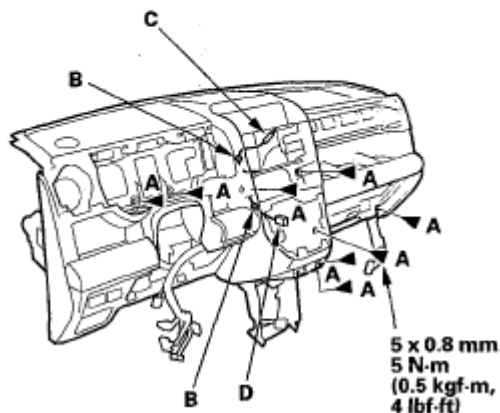
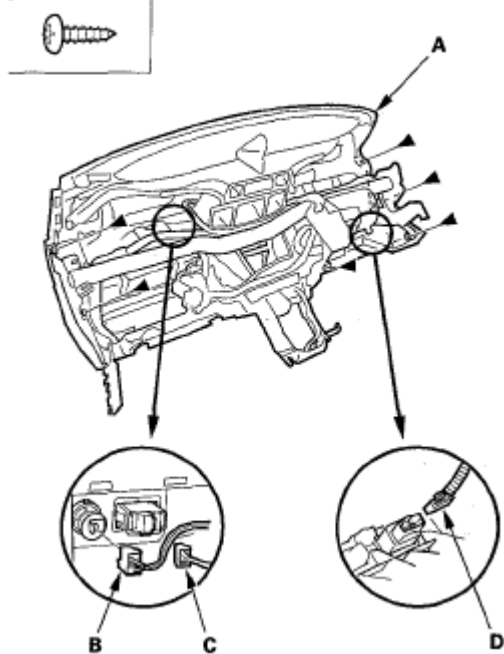

**Fig. 27: Removing Bolts From Dashboard**

4. Detach the harness clips (B) securing the antenna lead (C) and hazard warning switch wire harness (D).
5. From the back of the dashboard (A), remove the screws.

**Fastener Locations**

▶ : Screw, 6

**Fig. 28: Detaching Harness Clips Securing Antenna Lead**

6. Disconnect the front accessory power socket connector (B), auxiliary jack connector (C), cruise control main switch connector (D).
7. With the help of an assistant, separate the dashboard and steering hanger beam.
8. Install the beam in the reverse order of removal, and note these items:
  - Make sure the dashboard wire harness is not pinched.
  - Make sure the connectors are plugged in properly.