

## GROUP 52A

## INTERIOR

### GENERAL

#### OUTLINE OF CHANGES

- The seat cushion assembly for fixed mounting boss-type front seats has been integrated with the seat leg assembly. Disassembly service points have been established to correspond to this.
- The suspension mechanism in front suspension seats has been changed from a shock absorber – spring mechanism to a rubber-moulded spring mechanism. Disassembly service points have been established to correspond to this.

#### • Normal seats

<New>

Seat cushion assembly

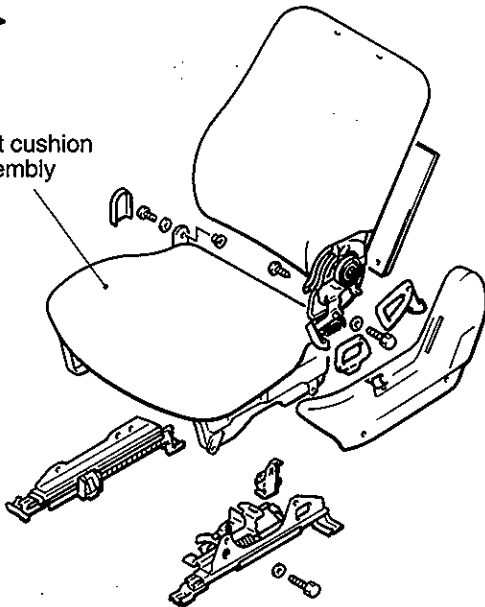

19E0226

<Old>

Seat cushion assembly

Seat leg assembly

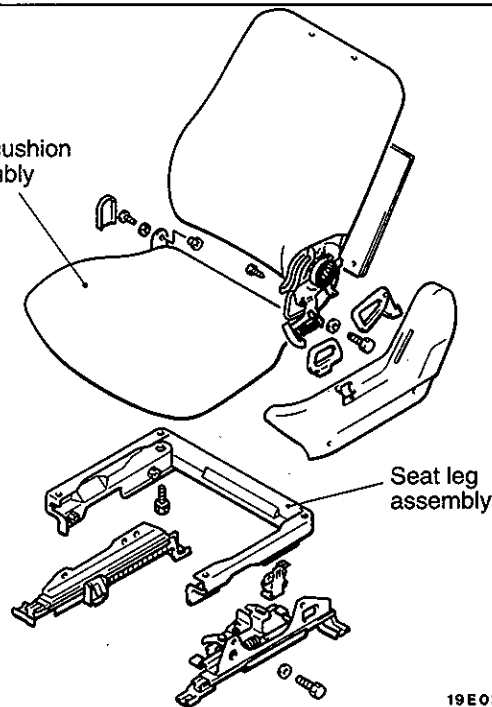

19E0225

#### • Suspension seats

<New>

Suspension assembly

Rubber-moulded springs

Adjustment knob

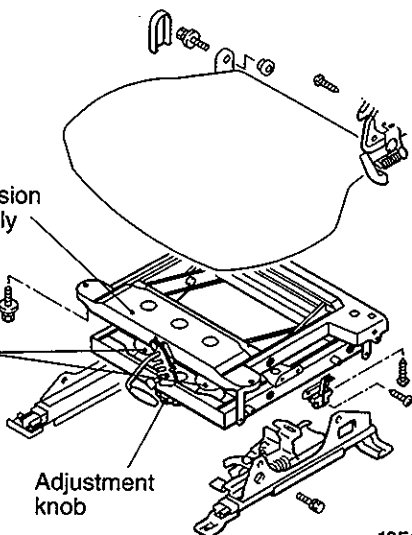

19E0246

<Old>

Suspension assembly

Shock absorber – spring

Adjustment knob

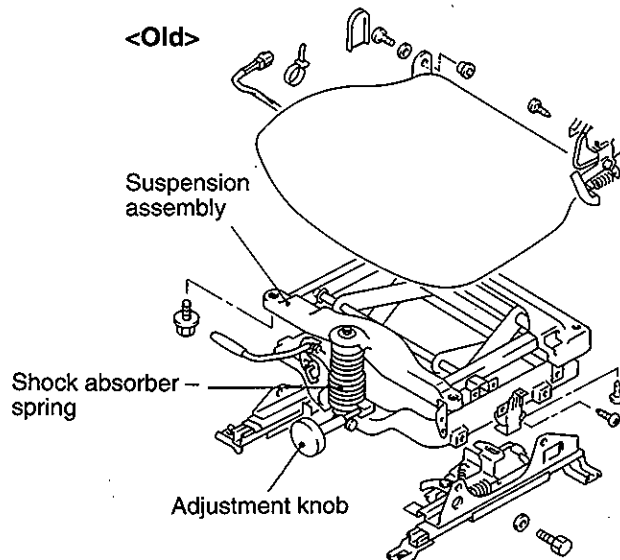

19E0070

## FRONT SEAT

## DISASSEMBLY AND REASSEMBLY

## &lt;Normal seats&gt;

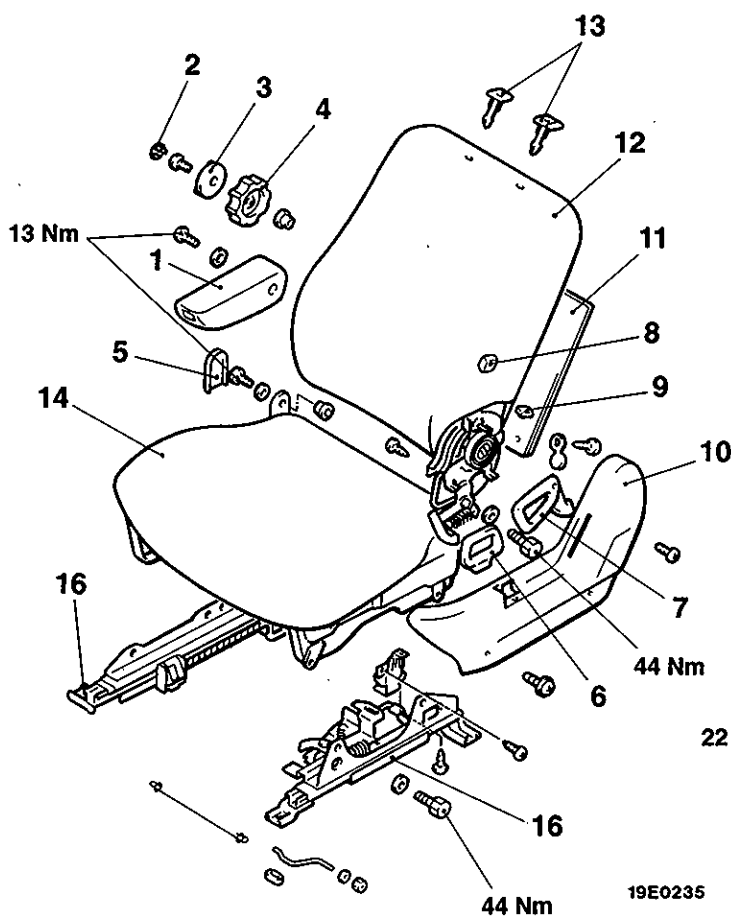

## Disassembly steps

1. Armrest assembly
2. Side support lever cap
3. Side support lever
4. Lumbar support lever
5. Free hinge protector
6. Slide knob
7. Reclining knob
8. Reclining memory knob



## Pre-removal and Post-installation Operation

- Removal and Installation of Front Inner Seat Belt assembly

## &lt;Suspension seats&gt;

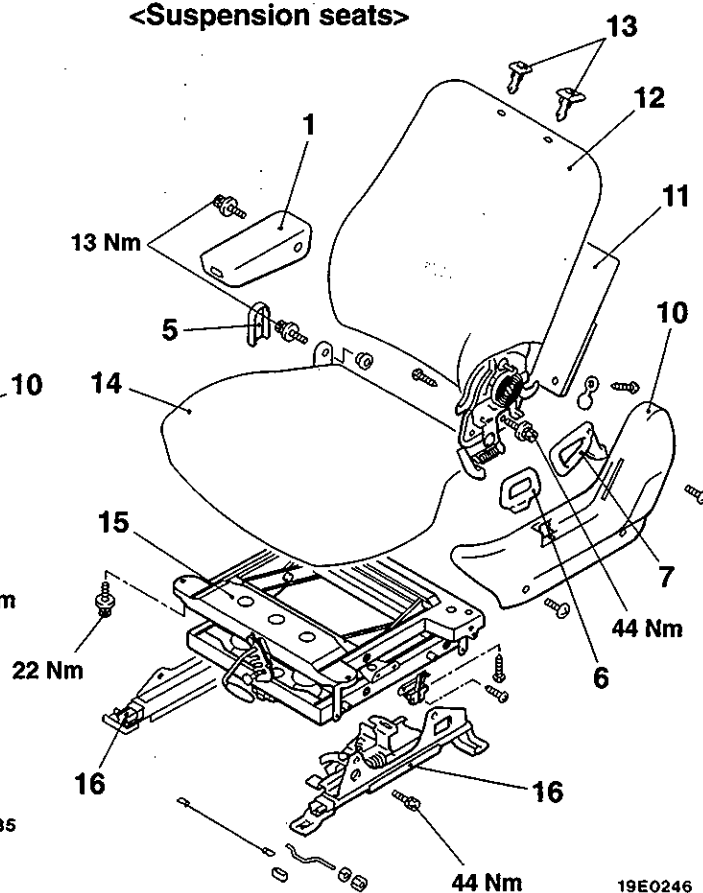

9. Walk-in knob
10. Shield cover
11. Back pocket assembly
12. Seatback assembly
13. Headrest guide
14. Seat cushion assembly
15. Suspension assembly
16. Seat adjuster

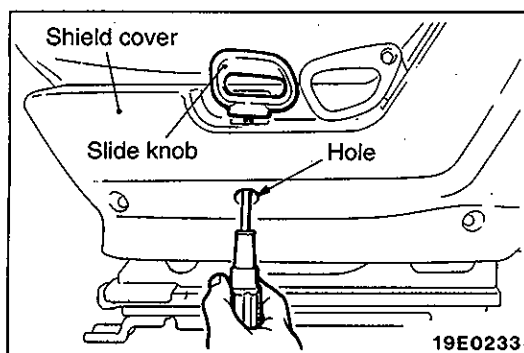

## DISASSEMBLY SERVICE POINT

## 6. SLIDE KNOB REMOVAL

Pass a screwdriver through the shield cover hold and remove the slide knob mounting screw.