

ENGINE <4M41>

INTAKE AND EXHAUST

INTAKE MANIFOLD

The intake manifold has been changed and an air intake pipe has been added.

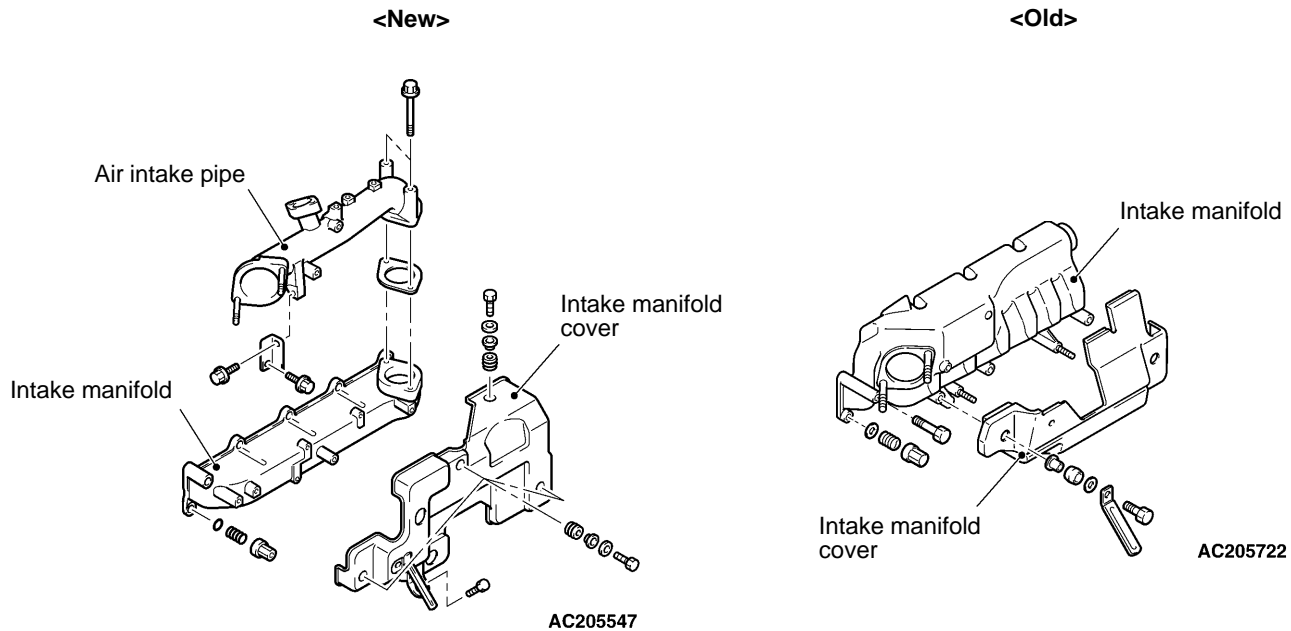

FUEL SYSTEM

INJECTION PUMP

The injection pump cover has been changed.

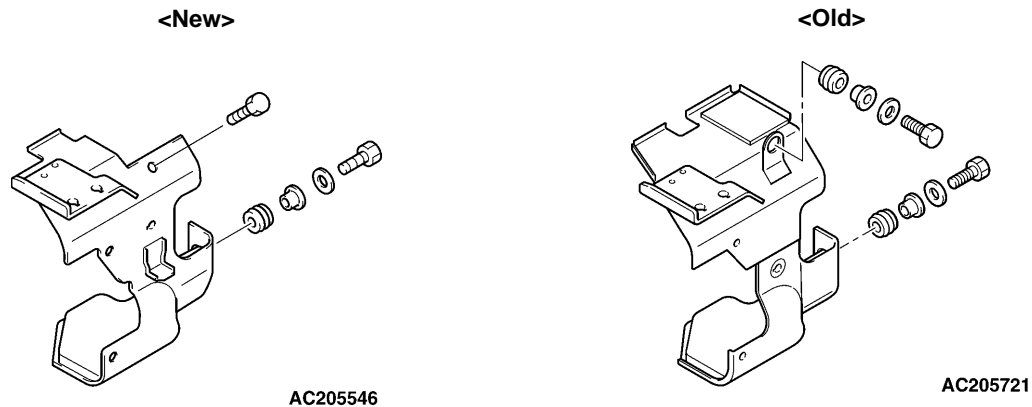

EMISSION CONTROL SYSTEM

EGR SYSTEM

The EGR pipe has been changed.

<M/T>

<New>

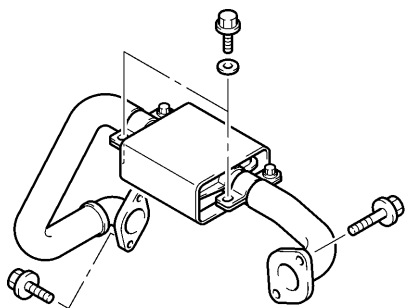

AC205548

<Old>

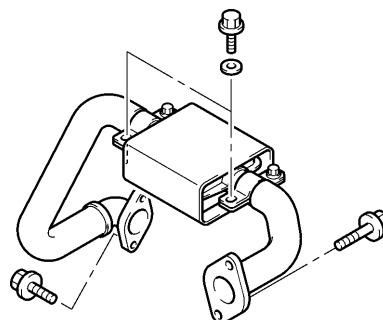

AC205723

<A/T>

<New>

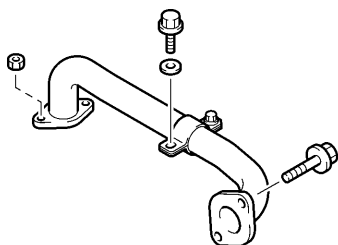

AC205549

<Old>

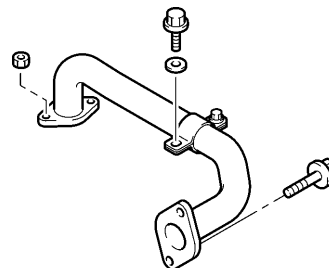

AC205724

AUTO-CRUISE CONTROL SYSTEM

AUTO-CRUISE CONTROL SWITCH

The auto-cruise control switch for the vehicles with 4M41 engine has been changed.

<New>

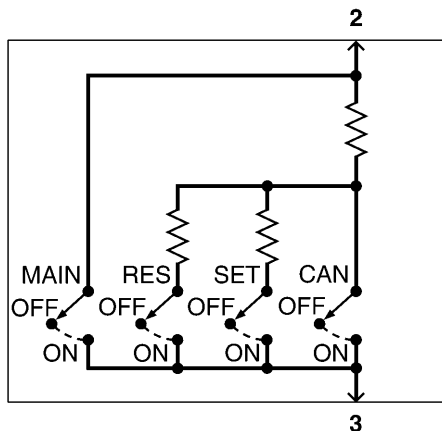
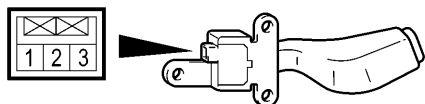

AC203822AB

<Old>

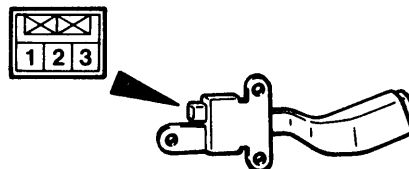

0310105

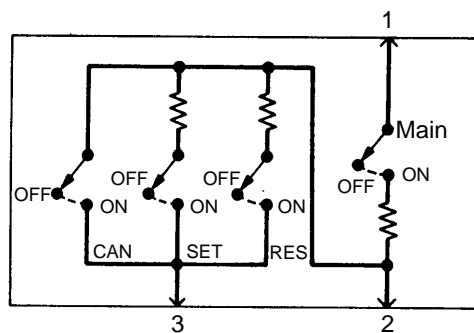

0310106
00008225