

## 2 WIRING HARNESS CONFIGURATION DIAGRAMS

### 1 OVERALL WIRING DIAGRAM

1-1 L.H. drive vehicles .....	2- 2
1-2 R.H. drive vehicles .....	2- 3

### 2 ENGINE COMPARTMENT **A**

2-1 L.H. drive vehicles with MPI-SOHC engine <Vehicles without ABS> .....	2- 4
2-2 R.H. drive vehicles with MPI-SOHC engine <Vehicles without ABS> .....	2- 6
2-3 L.H. drive vehicles with MPI-SOHC engine <Vehicles with ABS> .....	2- 8
2-4 R.H. drive vehicles with MPI-SOHC engine <Vehicles with ABS> .....	2-10
2-5 L.H. drive vehicles with MPI-DOHC engine .....	2-12
2-6 R.H. drive vehicles with MPI-DOHC engine .....	2-14

### 3 ENGINE AND TRANSMISSION **B**

3-1 MPI-SOHC engine .....	2-16
3-2 MPI-DOHC engine .....	2-18

### 4 DASH PANEL **C**

4-1 L.H. drive vehicles .....	2-20
4-2 R.H. drive vehicles .....	2-24

### 5 INSTRUMENT PANEL **D**

5-1 L.H. drive vehicles .....	2-28
5-2 R.H. drive vehicles .....	2-29

### 6 INTERIOR **E**

6-1 L.H. drive vehicles .....	2-30
6-2 R.H. drive vehicles .....	2-32

### 7 DOOR **F**

7-1 L.H. drive vehicles .....	2-34
7-2 R.H. drive vehicles .....	2-35

### 8 LUGGAGE COMPARTMENT **G**

8-1 L.H. drive vehicles .....	2-36
8-2 R.H. drive vehicles .....	2-37

### 9 TRUNK LID **H**

### 10 UNDER REAR FLOOR **J**

.....	2-39
-------	------

## 1 OVERALL WIRING DIAGRAM

### 1-1 L.H. drive vehicles

#### <Vehicles without ACTIVE-ECS>

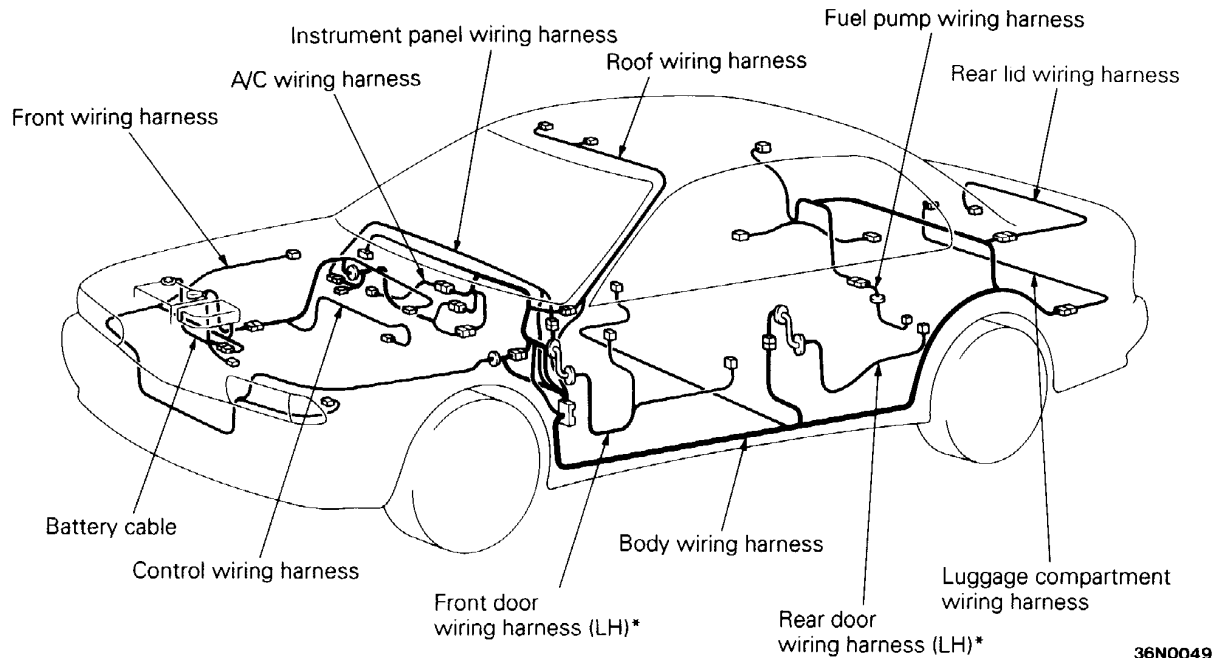

#### <Vehicles with ACTIVE-ECS>

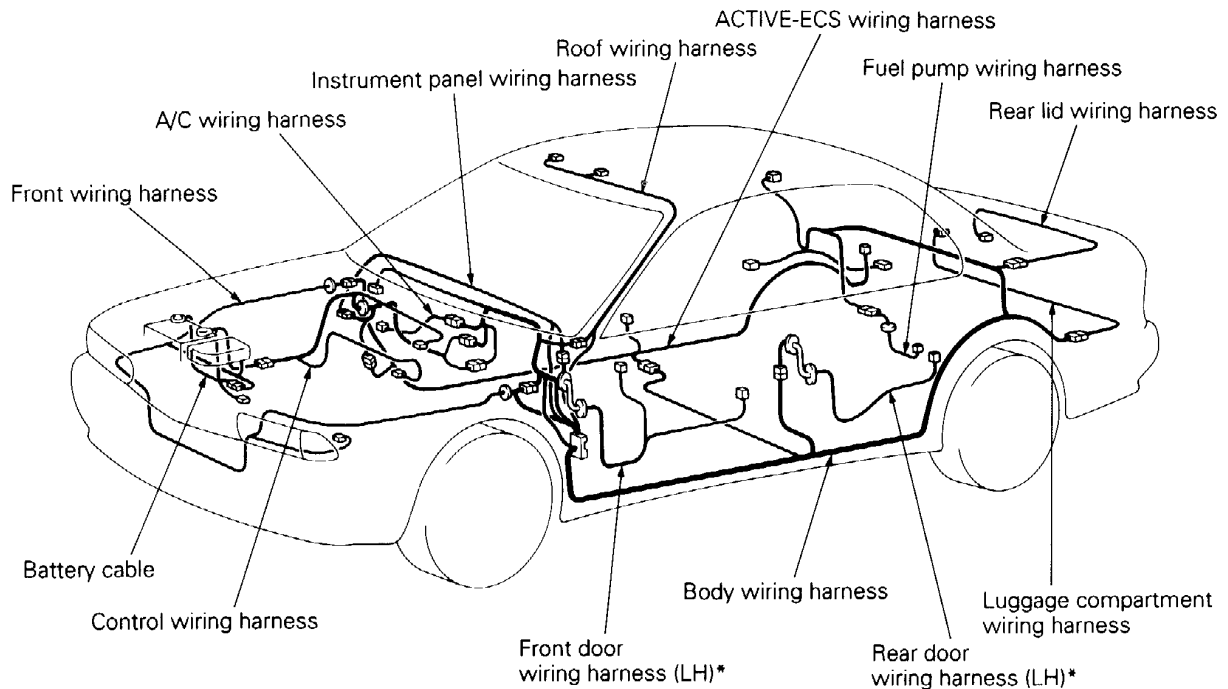

#### NOTE

- (1) These illustrations show only major wiring harnesses.
- (2) \*: also equipped at the right side.

## 1-2 R.H. drive vehicles

### <Vehicles without ABS>

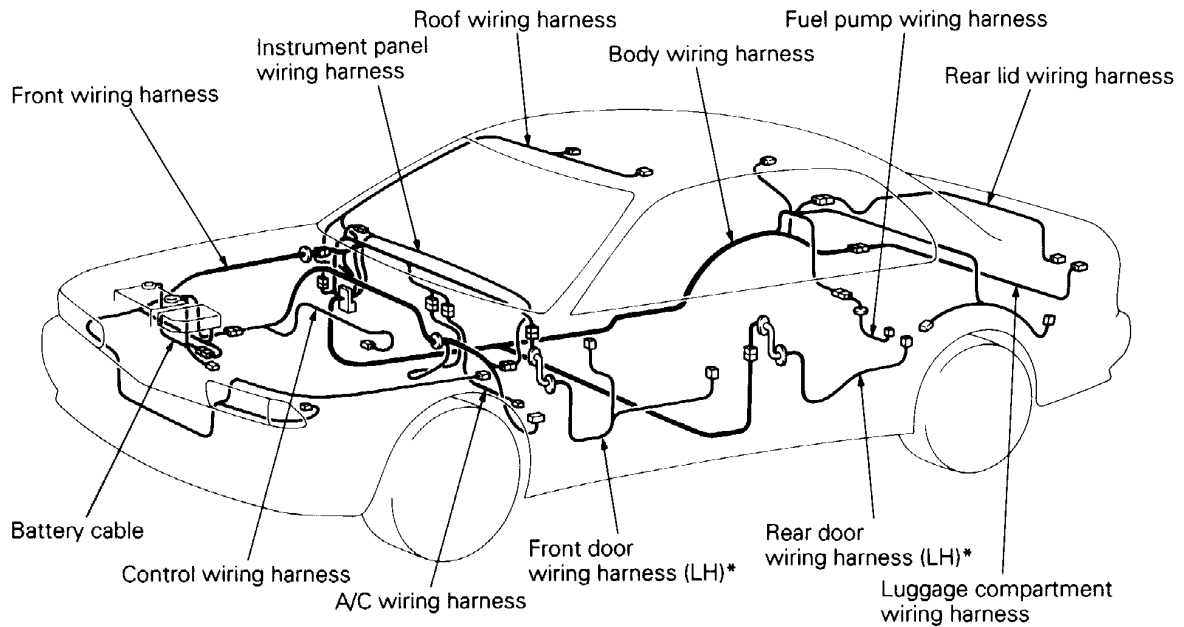

36N0050

### <Vehicles with ABS>

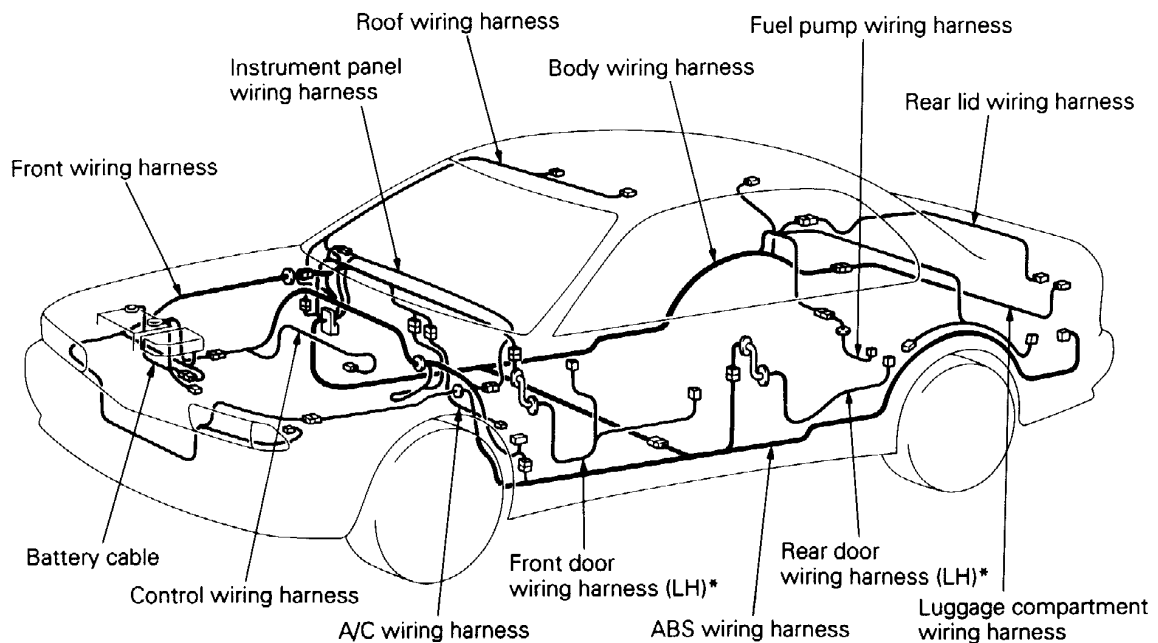

36N0048

#### NOTE

- (1) These illustrations show only major wiring harnesses.
- (2) \*: also equipped at the right side.

## 2 ENGINE COMPARTMENT

### 2-1 L.H. drive vehicles with MPI-SOHC engine <Vehicles without ABS>

Connector  
symbol

**A**

A-01X  
A-02X  
A-03X  
A-04X  
A-05X  
A-06X  
A-07X  
A-08X  
A-09X  
A-10X  
A-11X  
A-12X  
A-13X  
A-14X

Refer to CENTRALIZED JUNCTION

A-15 Side turn signal lamp (RH)  
A-16 –  
A-17 Pulse generator <A/T>  
A-18 Kickdown servo switch <A/T>  
A-19 A/T fluid temperature sensor <A/T>  
A-20 Windshield wiper motor  
A-21 Brake fluid level sensor  
A-22 Air flow sensor  
A-23 –  
A-24 –  
A-25 Purge control solenoid valve  
A-26 }  
to } –  
A-28 }  
A-29 Ignition timing adjustment connector  
A-30 –  
A-31 Fuel pump check connector  
A-32 –  
A-33 Side turn signal lamp (LH)  
A-34 }  
to } –  
A-39 }  
A-40 No connection  
A-41 Front turn signal lamp (LH)  
A-42 }  
to } –  
A-45 }

A-01X  
A-02X  
A-03X  
A-04X  
A-05X  
A-06X  
A-07X  
A-08X  
A-09X  
A-10X  
A-12X  
A-13X  
A-14X

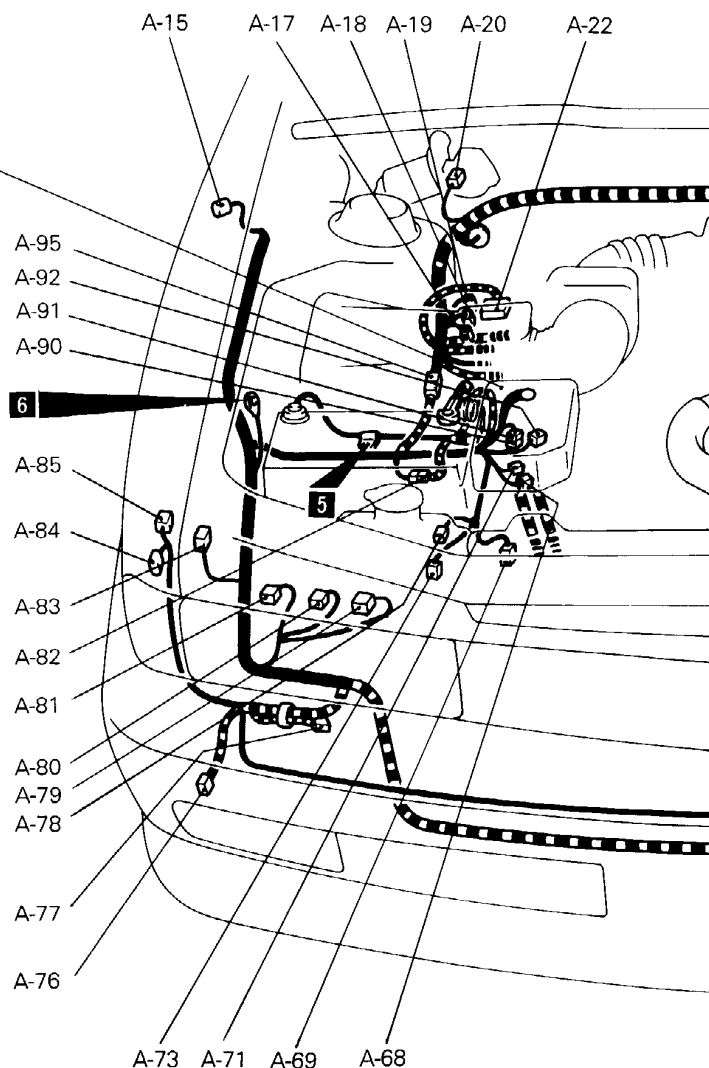

A-46 Headlamp leveling unit (LH)  
A-47 }  
A-48 } Headlamp (LH)  
A-49 No connection  
A-50 Front fog lamp (LH)  
A-51 Dual pressure switch <A/C>  
A-52 –  
A-53 Headlamp washer motor  
A-54 A/C compressor  
A-55 Condenser fan motor  
A-56 Resistor  
A-57 }  
to } Horn  
A-60 }  
A-61 } –  
to }  
A-67 }

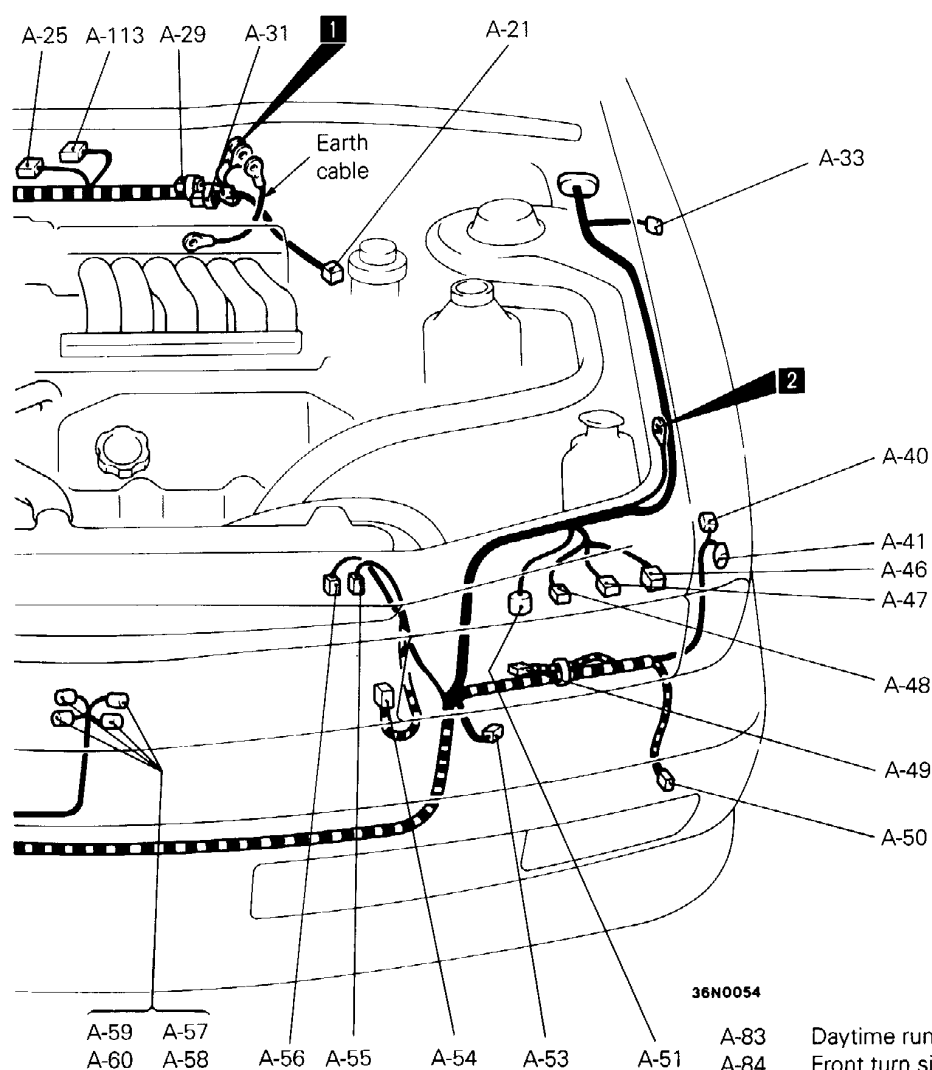

36N0054

A-68	Daytime running lamp control unit or jumper connector
A-69	Radiator fan motor
A-70	–
A-71	Daytime running lamp relay 2
A-72	–
A-73	Windshield washer motor
A-74	–
A-75	–
A-76	Front fog lamp (RH)
A-77	No connection
A-78	Windshield washer fluid level sensor
A-79	Headlamp (RH)
A-80	
A-81	Headlamp leveling unit (RH)
A-82	Front wiring harness and battery cable combination

A-83	Daytime running lamp relay 1
A-84	Front turn signal lamp (RH)
A-85	No connection
A-86	to } –
A-89	
A-90	
A-92	Joint connector (for rear fog lamp circuit)
A-93	
A-94	–
A-95	Front wiring harness and control wiring harness combination
A-96	to } –
A-112	
A-113	No connection

## Remark

For details concerning the earth point (example: **1**), refer to P.3-20.

## 2-2 R.H. drive vehicles with MPI-SOHC engine &lt;Vehicles without ABS&gt;

Connector  
symbol**A**

A-01X	
A-02X	
A-03X	
A-04X	
A-05X	
A-06X	
A-07X	
A-08X	Refer to CENTRALIZED JUNCTION
A-09X	
A-10X	
A-11X	
A-12X	
A-13X	
A-14X	
A-15	Side turn signal lamp (RH)
A-16	–
A-17	Pulse generator <A/T>
A-18	Kickdown servo switch <A/T>
A-19	A/T fluid temperature sensor <A/T>
A-20	Windshield wiper motor
A-21	Brake fluid level sensor
A-22	Air flow sensor
A-23	–
A-24	–
A-25	Purge control solenoid valve
A-26	
to	–
A-28	
A-29	Ignition timing adjustment connector
A-30	–
A-31	Fuel pump check connector
A-32	–
A-33	Side turn signal lamp (LH)
A-34	
to	–
A-39	
A-40	No connection
A-41	Front turn signal lamp (LH)
A-42	
to	–
A-45	

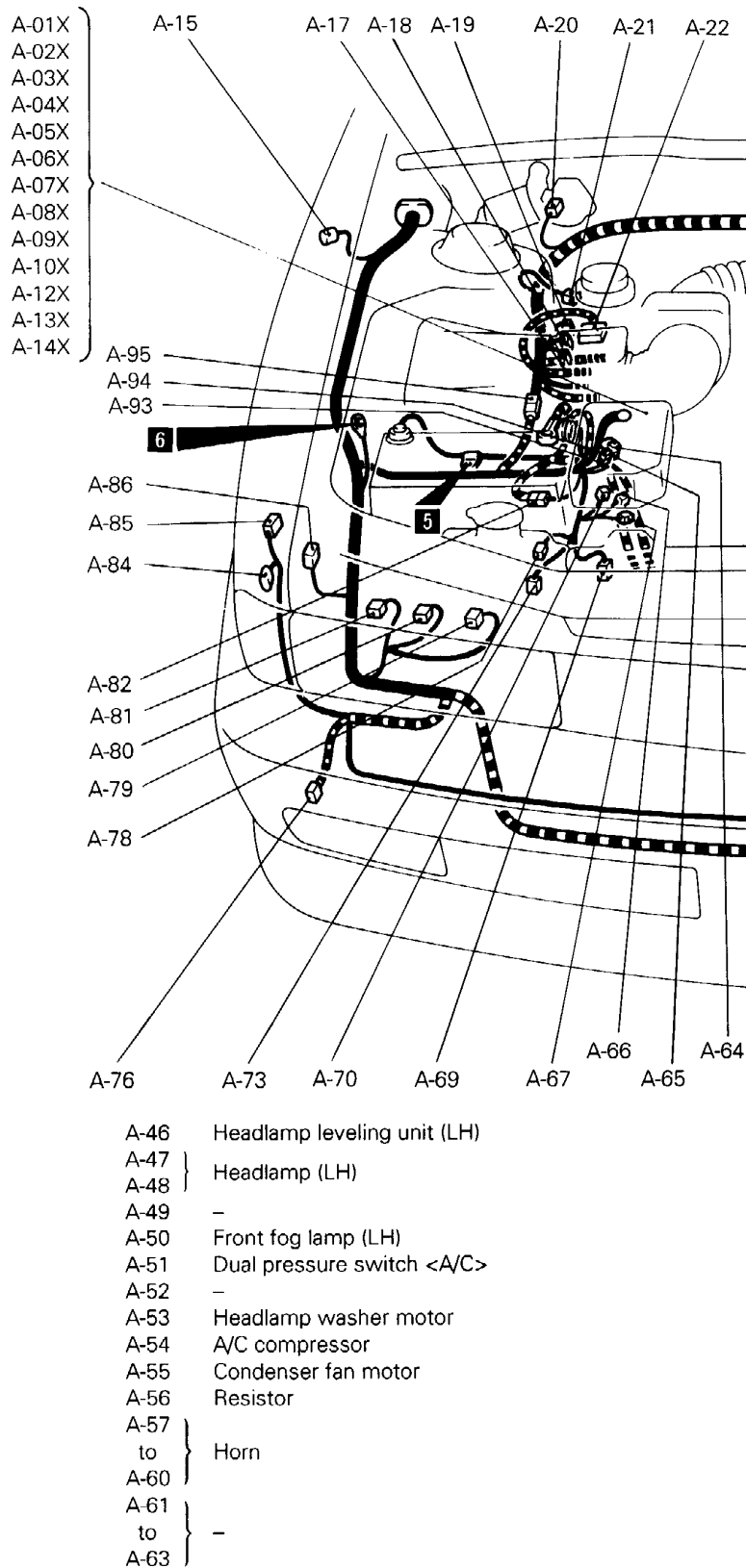

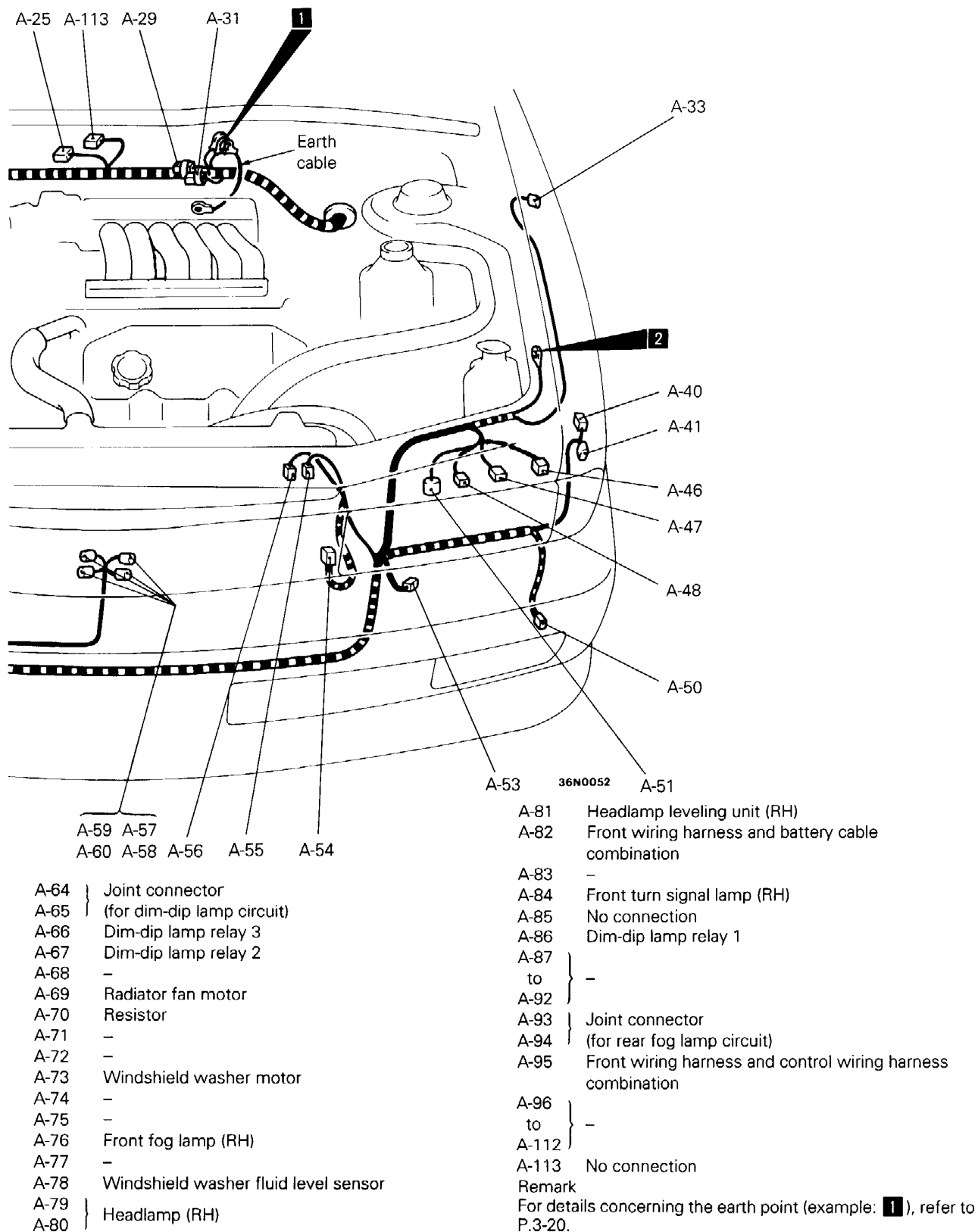

## 2-3 L.H. drive vehicles with MPI-SOHC engine <Vehicles with ABS>

Connector  
symbol

**A**

A-01X	
A-02X	
A-03X	
A-04X	
A-05X	
A-06X	
A-07X	Refer to CENTRALIZED JUNCTION
A-08X	
A-09X	
A-10X	
A-11X	
A-12X	
A-13X	
A-14X	
A-15	Side turn signal lamp (RH)
A-16	–
A-17	Pulse generator <A/T>
A-18	Kickdown servo switch <A/T>
A-19	A/T fluid temperature sensor <A/T>
A-20	Windshield wiper motor
A-21	Brake fluid level sensor
A-22	Air flow sensor
A-23	–
A-24	–
A-25	Purge control solenoid valve
A-26	–
to	
A-28	
A-29	Ignition timing adjustment connector
A-30	–
A-31	Fuel pump check connector
A-32	–
A-33	Side turn signal lamp (LH)
A-34	ABS speed sensor (Front: LH)
A-35	–
A-36	ABS valve relay
A-37	ABS motor relay
A-38	–
A-39	–
A-40	No connection
A-41	Front turn signal lamp (LH)
A-42	ABS hydraulic unit
to	
A-44	
A-45	–
A-46	Headlamp leveling unit (LH)
A-47	Headlamp (LH)
A-48	
A-49	No connection
A-50	Front fog lamp (LH)

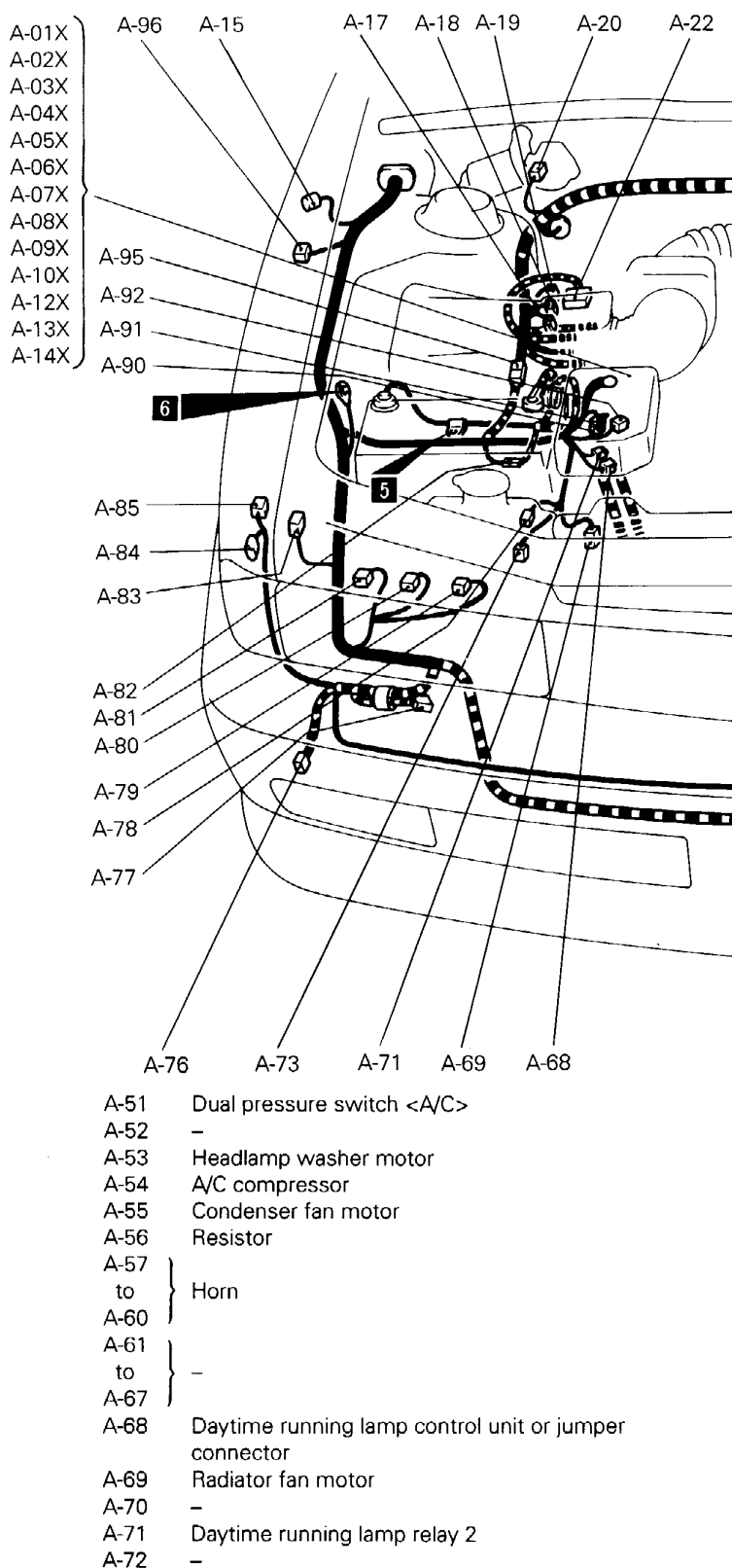



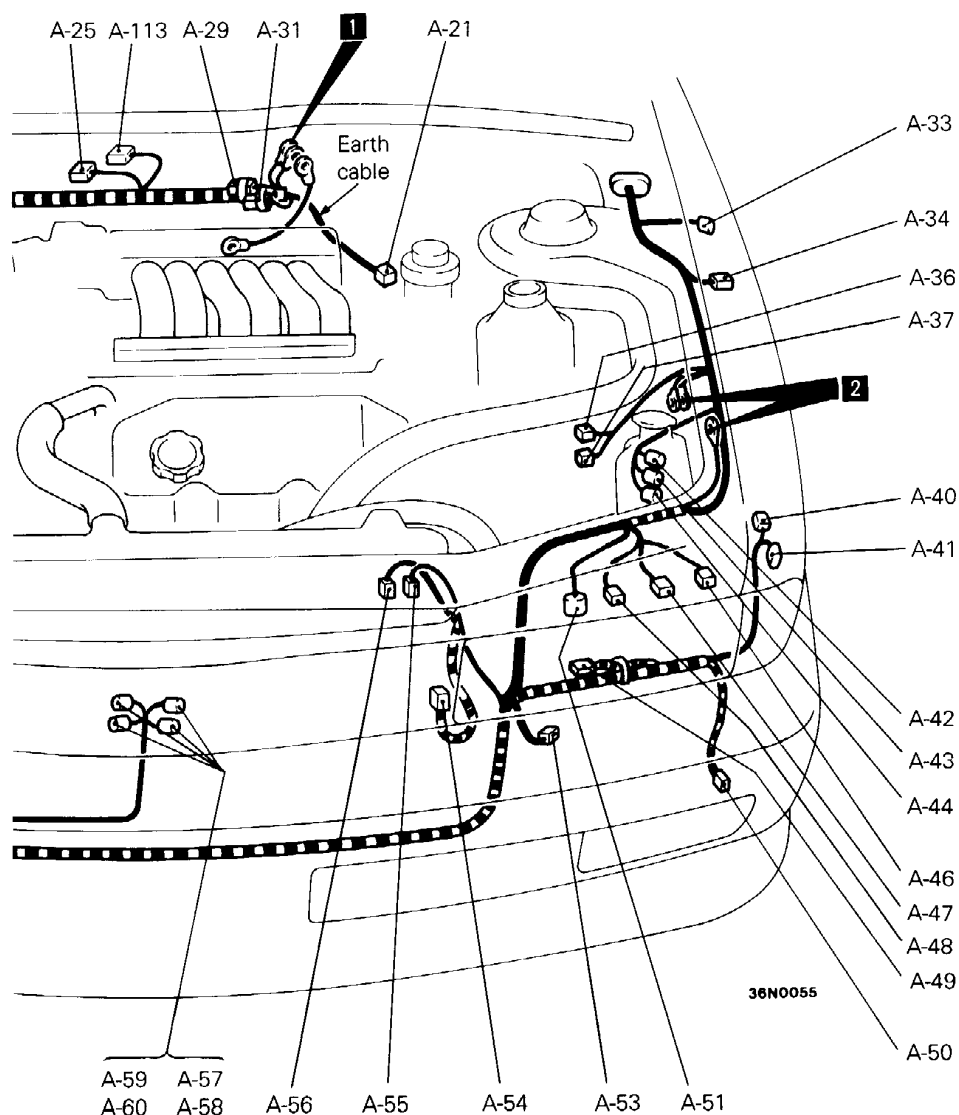

A-73	Windshield washer motor
A-74	-
A-75	-
A-76	Front fog lamp (RH)
A-77	No connection
A-78	Windshield washer fluid level sensor
A-79	Headlamp (RH)
A-80	
A-81	Headlamp leveling unit (RH)
A-82	Front wiring harness and battery cable combination
A-83	Daytime running lamp relay 1
A-84	Front turn signal lamp (RH)
A-85	No connection
A-86	-
to	
A-89	

A-90	Joint connector to (for rear fog lamp circuit)
A-92	
A-93	-
A-94	-
A-95	Front wiring harness and control wiring harness combination
A-96	ABS speed sensor (Front: RH)
A-97	-
to	
A-112	-
A-113	No connection

Remark  
For details concerning the earth point (example: **1**), refer to P.3-20.

## 2-4 R.H. drive vehicles with MPI-SOHC engine <Vehicles with ABS>

Connector  
symbol

**A**

A-01X  
A-02X  
A-03X  
A-04X  
A-05X  
A-06X  
A-07X  
A-08X  
A-09X  
A-10X  
A-11X  
A-12X  
A-13X  
A-14X

Refer to CENTRALIZED JUNCTION

A-15 Side turn signal lamp (RH)  
A-16 –  
A-17 Pulse generator <A/T>  
A-18 Kickdown servo switch <A/T>  
A-19 A/T fluid temperature sensor <A/T>  
A-20 Windshield wiper motor  
A-21 Brake fluid level sensor  
A-22 Air flow sensor  
A-23 –  
A-24 –  
A-25 Purge control solenoid valve  
A-26 } –  
to  
A-28 }  
A-29 Ignition timing adjustment connector  
A-30 –  
A-31 Fuel pump check connector  
A-32 –  
A-33 Side turn signal lamp (LH)  
A-34 ABS speed sensor (Front: LH)  
A-35 –  
A-36 ABS valve relay  
A-37 ABS motor relay  
A-38 } Front wiring harness and ABS wiring  
A-39 } harness combination  
A-40 No connection  
A-41 Front turn signal lamp (LH)  
A-42 }  
to } ABS hydraulic unit  
A-44 }  
A-45 –  
A-46 Headlamp leveling unit (LH)  
A-47 } Headlamp (LH)  
A-48 }  
A-49 –  
A-50 Front fog lamp (LH)

A-01X  
A-02X  
A-03X  
A-04X  
A-05X  
A-06X  
A-07X  
A-08X  
A-09X  
A-10X  
A-12X  
A-13X  
A-14X

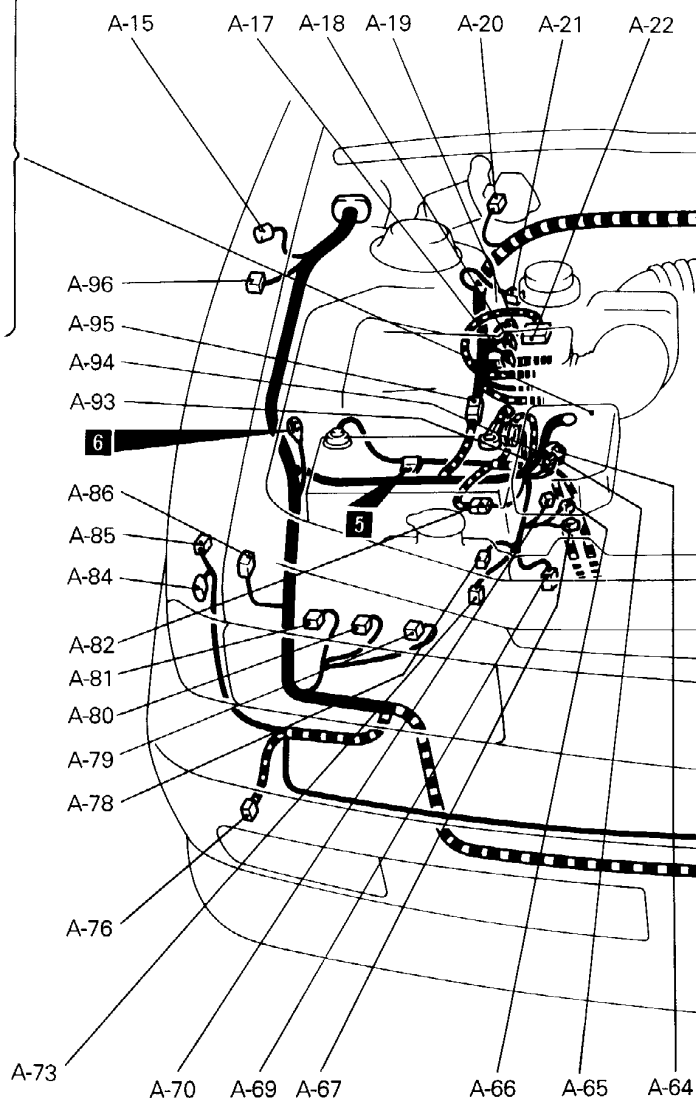

A-51 Dual pressure switch <A/C>  
A-52 –  
A-53 Headlamp washer motor  
A-54 A/C compressor  
A-55 Condenser fan motor  
A-56 Resistor  
A-57 }  
to } Horn  
A-60 }  
A-61 } –  
to }  
A-63 }  
A-64 Joint connector  
A-65 (for dim-dip lamp circuit)  
A-66 Dim-dip lamp relay 3  
A-67 Dim-dip lamp relay 2

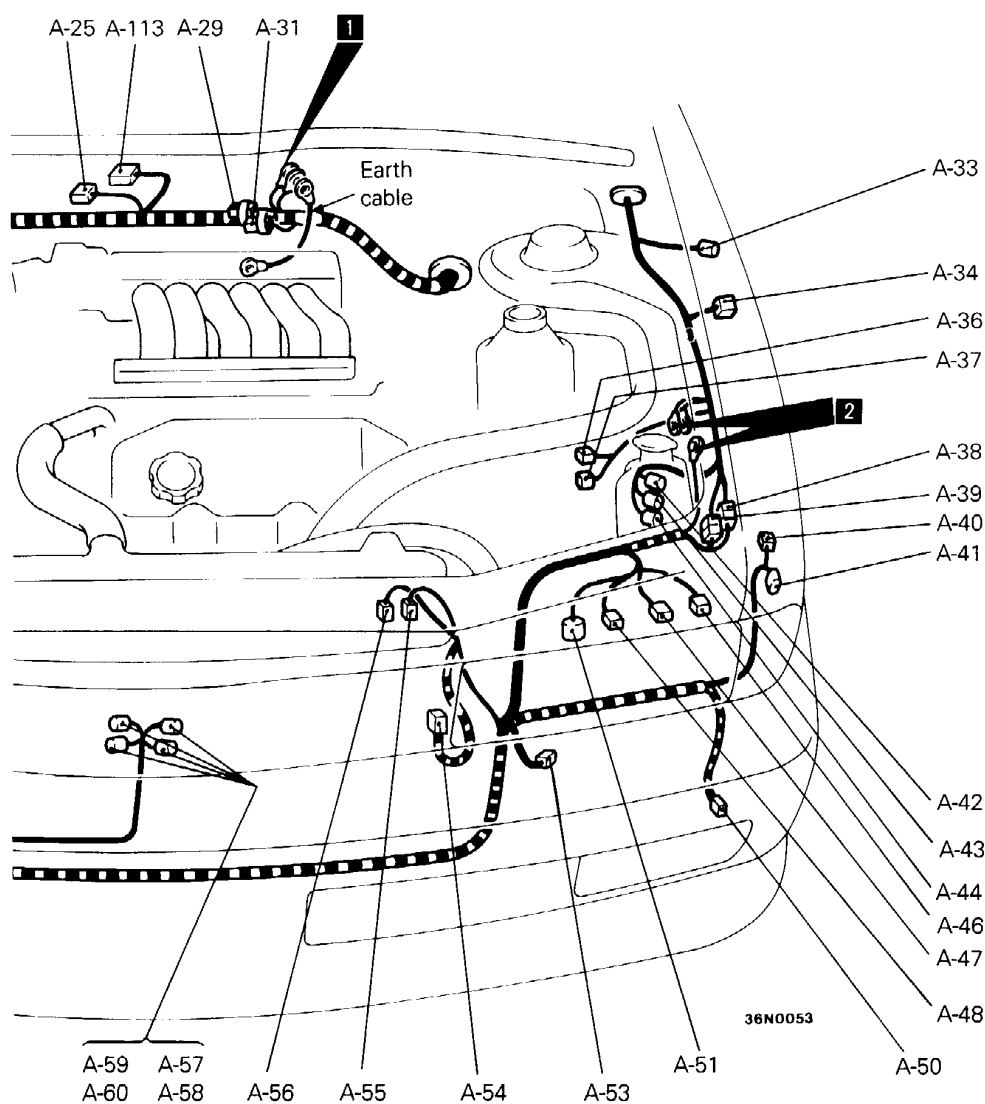

A-68	–
A-69	Radiator fan motor
A-70	Resistor
A-71	–
A-72	–
A-73	Windshield washer motor
A-74	–
A-75	–
A-76	Front fog lamp (RH)
A-77	–
A-78	Windshield washer fluid level sensor
A-79	} Headlamp (RH)
A-80	
A-81	Headlamp leveling unit (RH)
A-82	Front wiring harness and battery cable combination
A-83	–

A-84	Front turn signal lamp (RH)
A-85	No connection
A-86	Dim-dip lamp relay 1
A-87	} –
A-92	
A-93	} Joint connector (for rear fog lamp circuit)
A-94	
A-95	Front wiring harness and control wiring harness combination
A-96	ABS speed sensor (Front: RH)
A-97	} –
A-112	
A-113	No connection
Remark	
For details concerning the earth point (example: <b>1</b> ), refer to P.3-20.	

## 2-5 L.H. drive vehicles with MPI-DOHC engine

Connector  
symbol

**A**

- A-01X  
A-02X  
A-03X  
A-04X  
A-05X  
A-06X  
A-07X  
A-08X  
A-09X  
A-10X  
A-11X  
A-12X  
A-13X  
A-14X
- Refer to CENTRALIZED JUNCTION
- A-15 Side turn signal lamp (RH)  
A-16 ACTIVE-ECS front actuator (RH)  
A-17 Pulse generator <A/T>  
A-18 Kickdown servo switch <A/T>  
A-19 A/T fluid temperature sensor <A/T>  
A-20 Windshield wiper motor  
A-21 Brake fluid level sensor  
A-22 Air flow sensor  
A-23 ACTIVE-ECS front solenoid valve  
A-24 Auto-cruise control actuator  
A-25 Purge control solenoid valve  
A-26 Ventilation solenoid valve <TCL>  
A-27 Vacuum solenoid valve <TCL>  
A-28 EPS solenoid valve  
A-29 Ignition timing adjustment connector  
A-30 Engine speed detection connector  
A-31 Fuel pump check connector  
A-32 ACTIVE-ECS front actuator (LH)  
A-33 Side turn signal lamp (LH)  
A-34 ABS speed sensor (Front: LH)  
A-35 4WS fluid level sensor  
A-36 ABS valve relay  
A-37 ABS motor relay  
A-38 –  
A-39 –  
A-40 No connection  
A-41 Front turn signal lamp (LH)  
A-42 }  
to } ABS hydraulic unit  
A-44 }

- A-01X  
A-02X  
A-03X  
A-04X  
A-05X  
A-06X  
A-07X  
A-08X  
A-09X  
A-10X  
A-11X  
A-12X  
A-13X  
A-14X

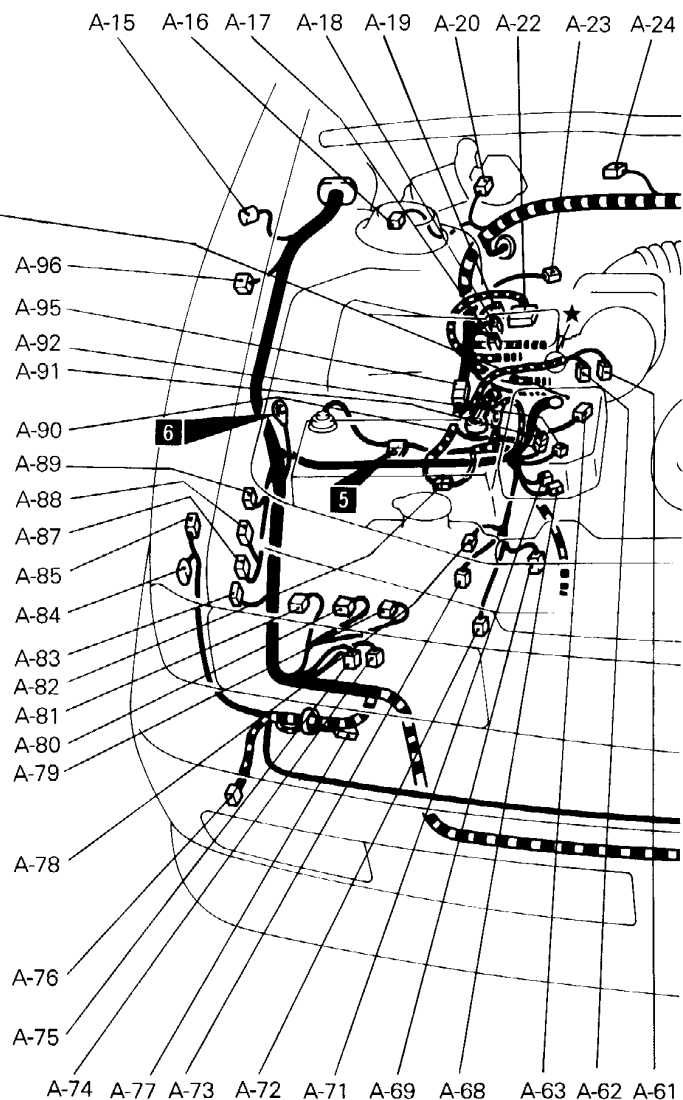

- A-45 ABS hydraulic unit <TCL>  
A-46 Headlamp leveling unit (LH)  
A-47 }  
A-48 } Headlamp (LH)  
A-49 No connection  
A-50 Front fog lamp (LH)  
A-51 Dual pressure switch <A/C>  
A-52 ACTIVE-ECS G sensor  
A-53 Headlamp washer motor  
A-54 –  
A-55 Condenser fan motor  
A-56 Resistor  
A-57 }  
to } Horn  
A-60 }  
A-61 ACTIVE-ECS compressor  
A-62 ACTIVE-ECS exhaust solenoid valve  
A-63 ACTIVE-ECS front height sensor

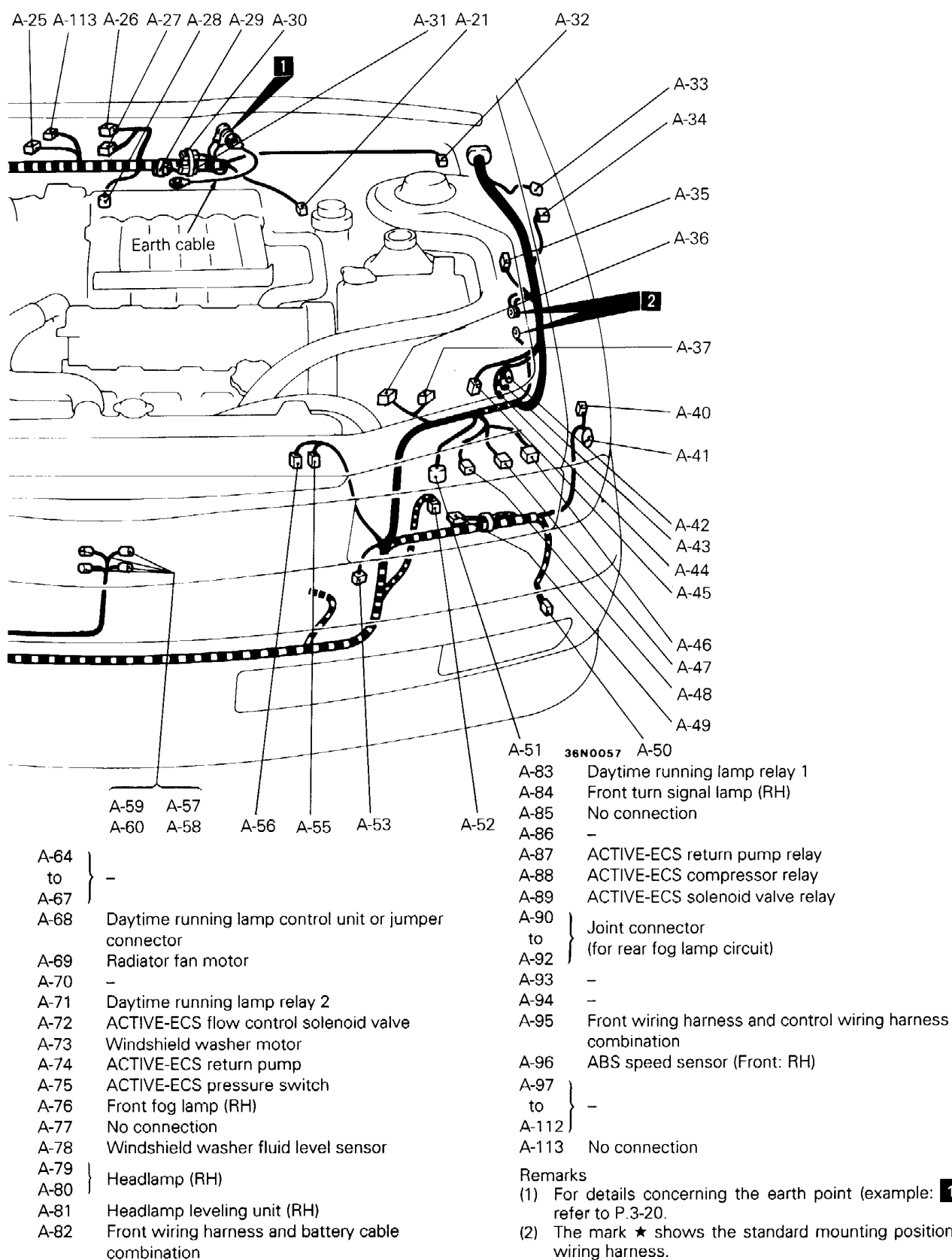

## 2-6 R.H. drive vehicles with MPI-DOHC engine

Connector  
symbol

**A**

A-01X  
A-02X  
A-03X  
A-04X  
A-05X  
A-06X  
A-07X  
A-08X  
A-09X  
A-10X  
A-11X  
A-12X  
A-13X  
A-14X

Refer to CENTRALIZED JUNCTION

A-15 Side turn signal lamp (RH)  
A-16 ACTIVE-ECS front actuator (RH)  
A-17 Pulse generator <A/T>  
A-18 Kickdown servo switch <A/T>  
A-19 A/T fluid temperature sensor <A/T>  
A-20 Windshield wiper motor  
A-21 Brake fluid level sensor  
A-22 Air flow sensor  
A-23 ACTIVE-ECS front solenoid valve  
A-24 Auto-cruise control actuator  
A-25 Purge control solenoid valve  
A-26 Ventilation solenoid valve <TCL>  
A-27 Vacuum solenoid valve <TCL>  
A-28 EPS solenoid valve  
A-29 Ignition timing adjustment connector  
A-30 Engine speed detection connector  
A-31 Fuel pump check connector  
A-32 ACTIVE-ECS front actuator (LH)  
A-33 Side turn signal lamp (LH)  
A-34 ABS speed sensor (Front: LH)  
A-35 4WS fluid level sensor  
A-36 ABS valve relay  
A-37 ABS motor relay  
A-38 Front wiring harness and ABS wiring  
A-39 harness combination  
A-40 No connection  
A-41 Front turn signal lamp (LH)  
A-42 to ABS hydraulic unit  
A-44  
A-45 ABS hydraulic unit <TCL>  
A-46 Headlamp leveling unit (LH)

A-01X  
A-02X  
A-03X  
A-04X  
A-05X  
A-06X  
A-07X  
A-08X  
A-09X  
A-10X  
A-11X  
A-12X  
A-13X  
A-14X

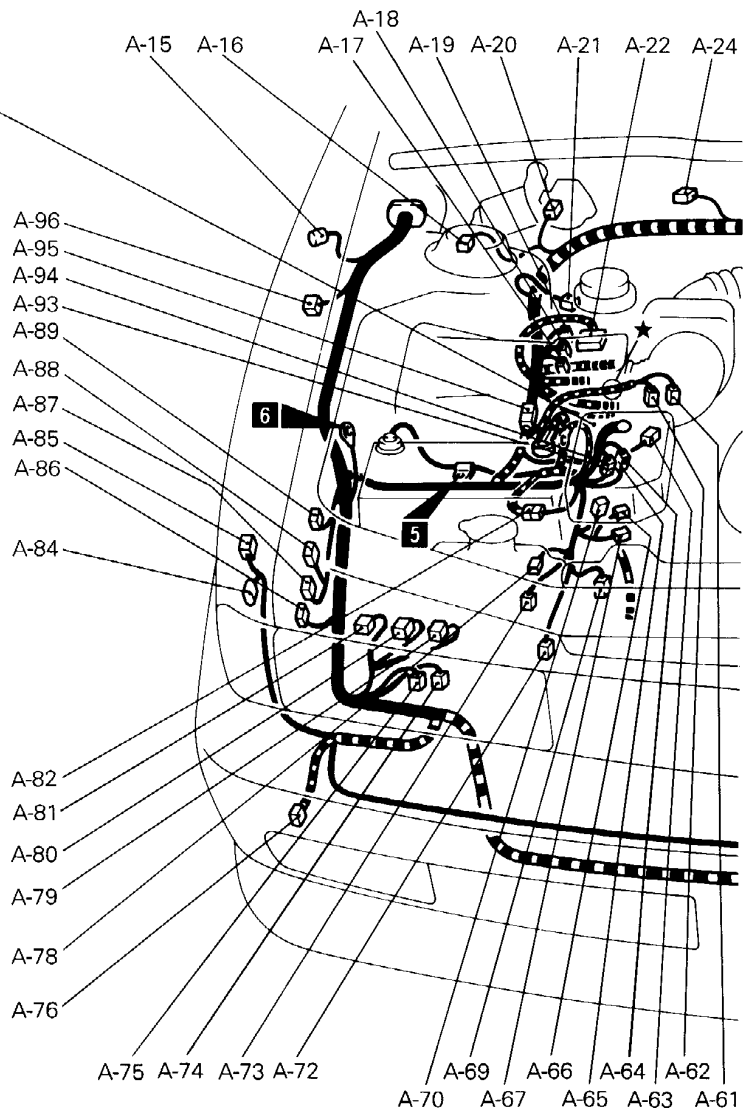

A-47 } Headlamp (LH)  
A-48 }  
A-49 -  
A-50 Front fog lamp (LH)  
A-51 Dual pressure switch <A/C>  
A-52 ACTIVE-ECS G sensor  
A-53 Headlamp washer motor  
A-54 -  
A-55 Condenser fan motor  
A-56 Resistor  
A-57 }  
to } Horn  
A-60 }  
A-61 ACTIVE-ECS compressor  
A-62 ACTIVE-ECS exhaust solenoid valve  
A-63 ACTIVE-ECS front height sensor  
A-64 } Joint connector  
A-65 } (for dim-dip lamp circuit)

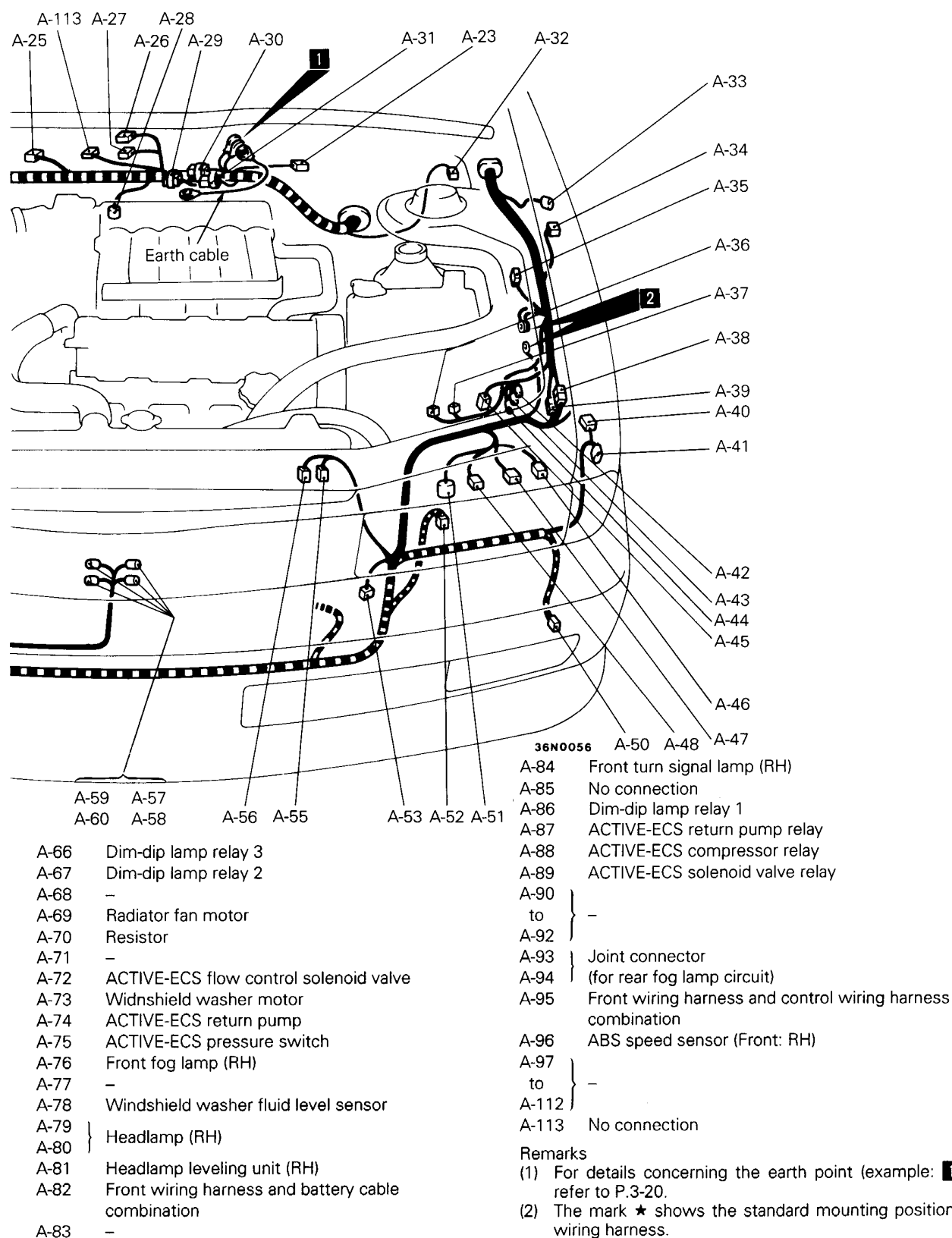

### 3 ENGINE AND TRANSMISSION

#### 3-1 MPI-SOHC engine

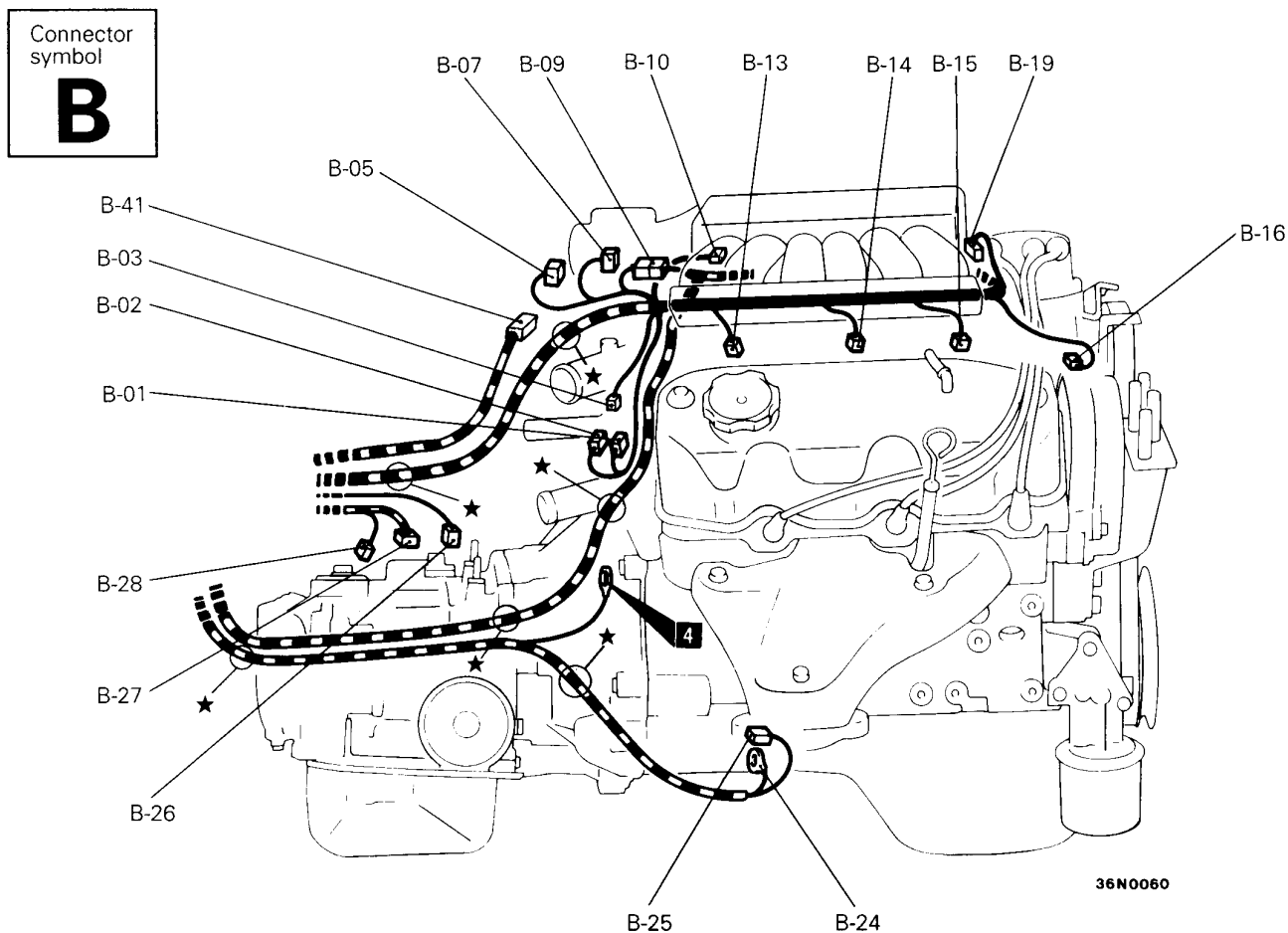

- B-01 Engine coolant temperature gauge unit
- B-02 Engine coolant temperature sensor (for engine control)
- B-03 Engine coolant temperature switch (for A/C compressor control)
- B-04 Crank angle sensor and top dead center sensor
- B-05 Idle speed control servo
- B-06 –
- B-07 Throttle position sensor
- B-08 –
- B-09 Control wiring harness and injector wiring harness combination
- B-10 Detonation sensor

- B-11 } Variable induction control servo
- B-12 }
- B-13 Injector No. 5
- B-14 Injector No. 3
- B-15 Injector No. 1
- B-16 Power steering oil pressure switch
- B-17 Ignition coil
- B-18 Capacitor
- B-19 Power transistor
- B-20 –
- B-21 } Alternator
- B-22 }



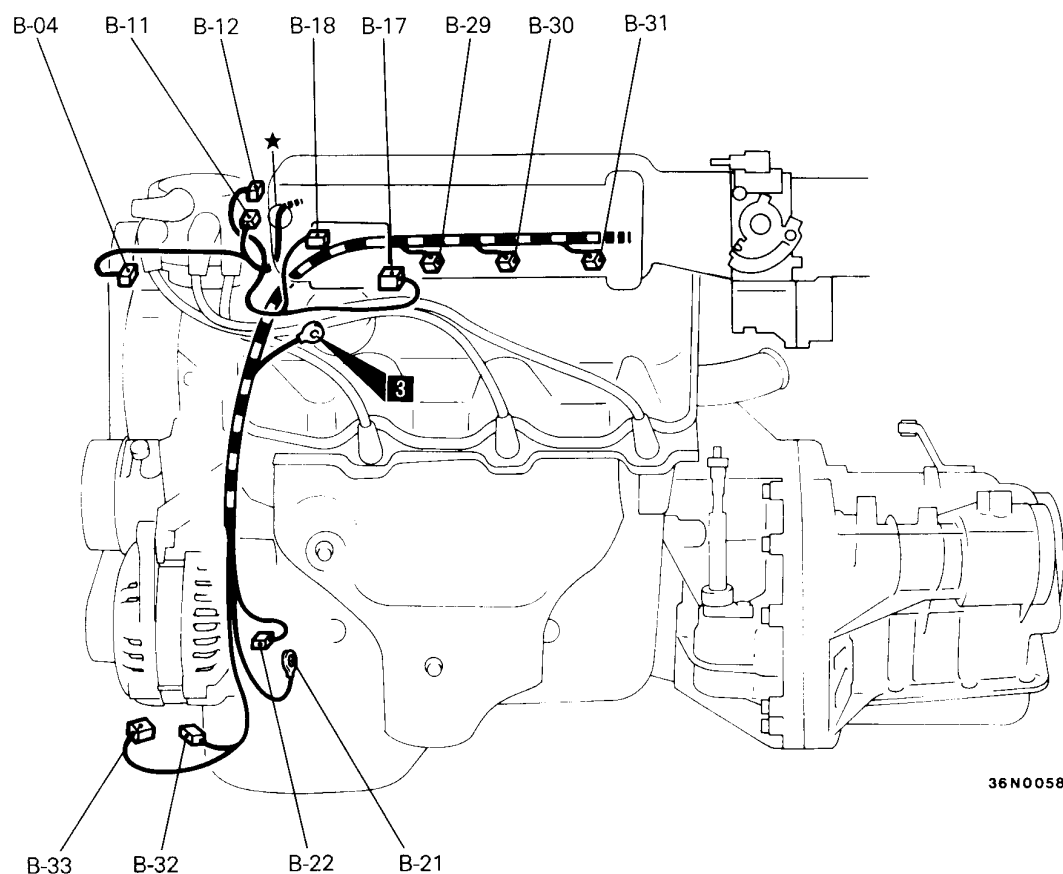

36N0058

B-23	–
B-24	} Starter
B-25	
B-26	Back-up lamp switch <M/T>
B-27	Inhibitor switch <A/T>
B-28	ELC-4A/T control solenoid valve
B-29	Injector No. 2
B-30	Injector No. 4
B-31	Injector No. 6
B-32	Engine oil pressure switch
B-33	Engine oil level sensor

B-34	} –
to	
B-40	} –
B-41	
B-41	No connection

#### Remarks

- (1) For details concerning the earth point (example: **3**), refer to P.3-20.
- (2) The mark ★ shows the standard mounting position of wiring harness.

## 3-2 MPI-DOHC engine

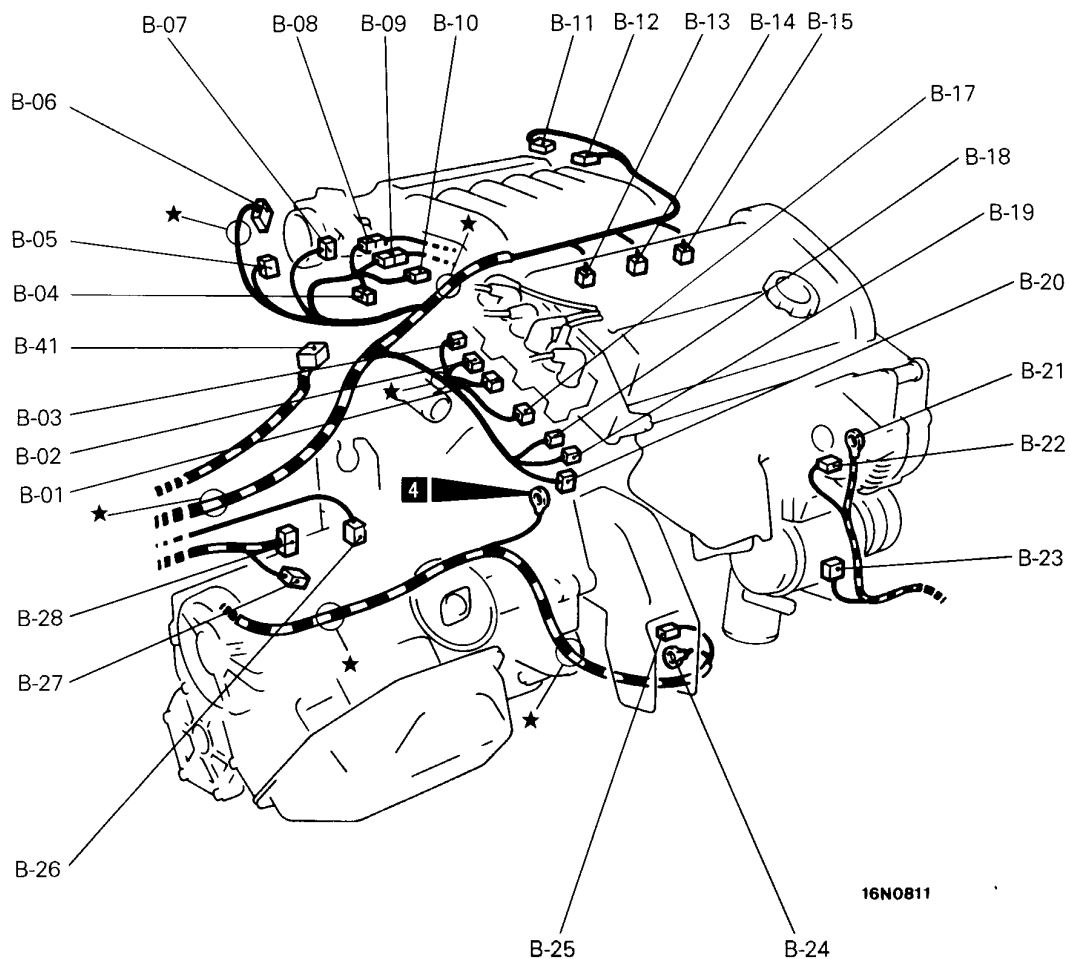
Connector  
symbol**B**

- B-01 Engine coolant temperature gauge unit
- B-02 Engine coolant temperature sensor (for engine control)
- B-03 Engine coolant temperature switch (for A/C compressor control)
- B-04 Crank angle sensor and top dead center sensor
- B-05 Idle speed control servo
- B-06 Accelerator position sensor <TCL>
- B-07 Throttle position sensor
- B-08 Control wiring harness and oil pressure wiring harness combination
- B-09 Control wiring harness and injector wiring harness combination
- B-10 Detonation sensor

- B-11 } Variable induction control servo
- B-12 }
- B-13 Injector No. 5
- B-14 Injector No. 3
- B-15 Injector No. 1
- B-16 Power steering oil pressure switch
- B-17 Ignition coil
- B-18 Capacitor
- B-19 } Power transistor
- B-20 }
- B-21 } Alternator
- B-22 }
- B-23 A/C compressor

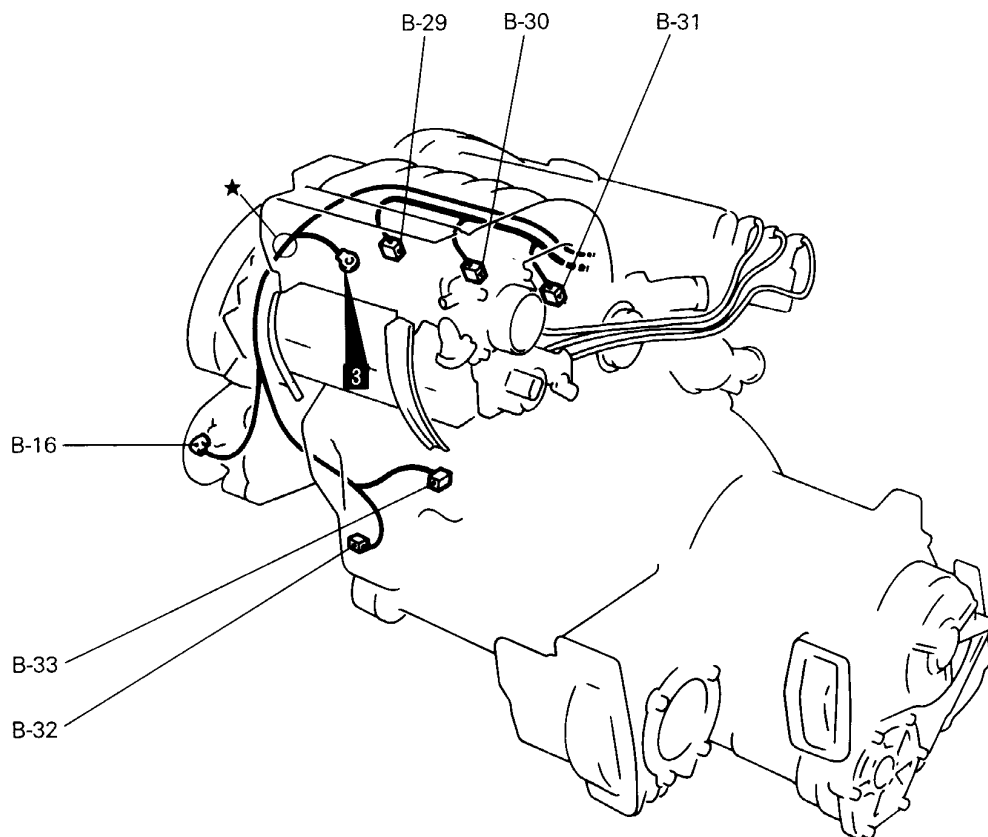

36N0059

B-24	}	Starter
B-25		
B-26		Back-up lamp switch <M/T>
B-27		Inhibitor switch <A/T>
B-28		ELC-4A/T control solenoid valve
B-29		Injector No. 2
B-30		Injector No. 4
B-31		Injector No. 6
B-32		Engine oil pressure switch
B-33		Engine oil level sensor
B-34	}	-
to		
B-40		
B-41		No connection

Remarks

- (1) For details concerning the earth point (example: **3**), refer to P.3-20.
- (2) The mark ★ shows the standard mounting position of wiring harness.

## 4 DASH PANEL

### 4-1 L.H. drive vehicles

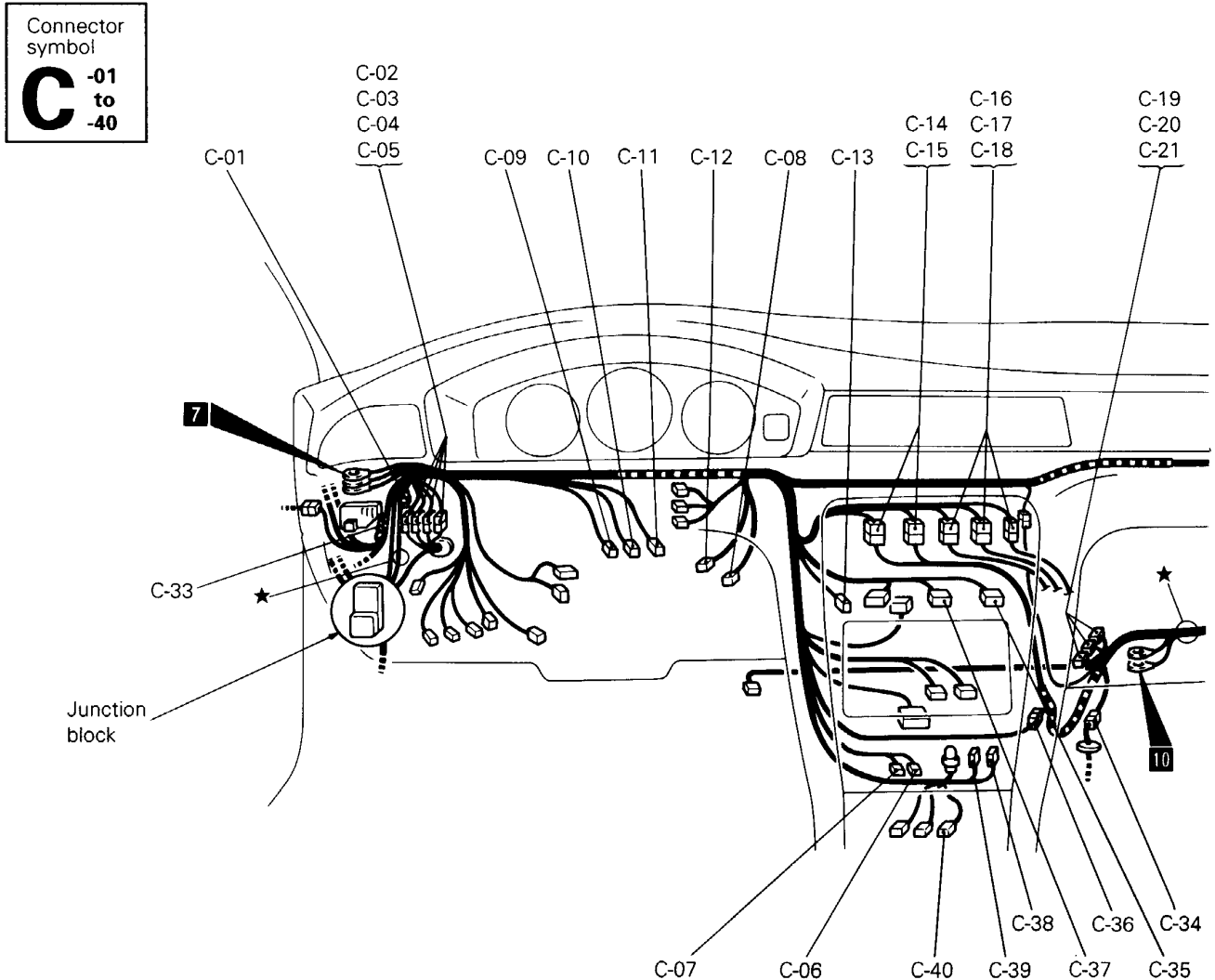

C-01 Diode (for idle-up circuit) <DOHC>  
 C-02 } Body wiring harness and  
 to } front wiring harness combination  
 C-04 }  
 C-05 Body wiring harness and front wiring harness  
 combination <ABS>  
 C-06 } ETACS unit  
 C-07 }  
 C-08 Accelerator pedal switch <A/T>  
 C-09 Stop lamp switch (4-pin) <Auto-cruise control> or  
 no connection  
 C-10 Stop lamp switch (2-pin) or no connection  
 <Auto-cruise control>

C-11 Clutch pedal switch <Auto-cruise control (M/T)>  
 C-12 Headlamp leveling switch  
 C-13 No connection  
 C-14 } Body wiring harness and  
 C-15 } control wiring harness combination  
 C-16 } Body wiring harness and  
 to } A/C wiring harness combination  
 C-18 }  
 C-19 } ELC-4A/T control unit  
 to }  
 C-21 }  
 C-22 Engine oil level relay  
 C-23 Headlamp washer relay

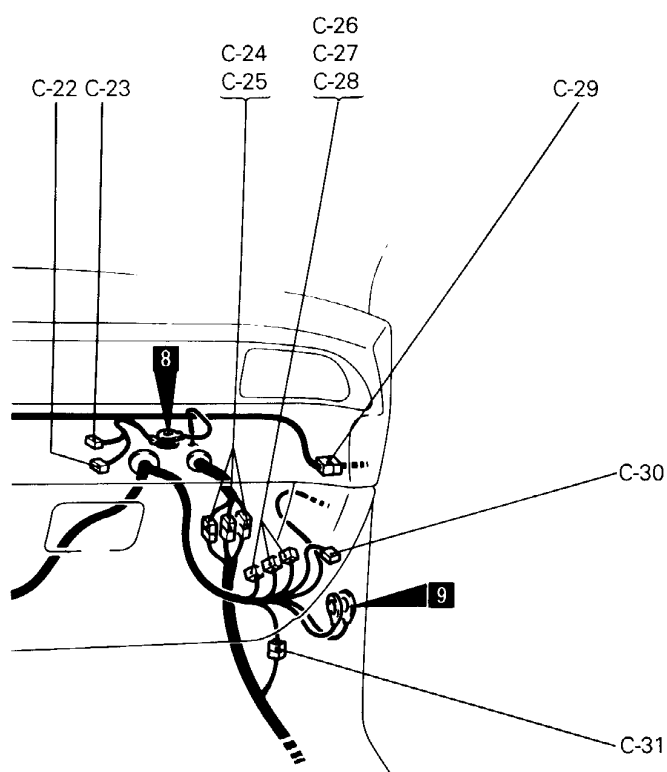

36N0062

C-24 } Front wiring harness and  
C-25 } ACTIVE-ECS wiring harness combination  
C-26 }  
to } Engine control unit  
C-28 }  
C-29 Body wiring harness and front door wiring harness  
(RH) combination  
C-30 Engine control relay  
C-31 Control wiring harness and ACTIVE-ECS wiring  
harness combination  
C-32 –  
C-33 Diode (for ABS circuit)  
C-34 Oxygen sensor

C-35 Rear fog lamp switch  
C-36 Body wiring harness and control wiring harness  
combination <TCL>  
C-37 Defogger switch  
C-38 } Cigarette lighter  
C-39 }  
C-40 Heated seat switch (RH)

## Remarks

- (1) For details concerning the earth point (example: **7**), refer to P.3-21.
- (2) The mark ★ shows the standard mounting position of wiring harness.

## 4-1 L.H. drive vehicles

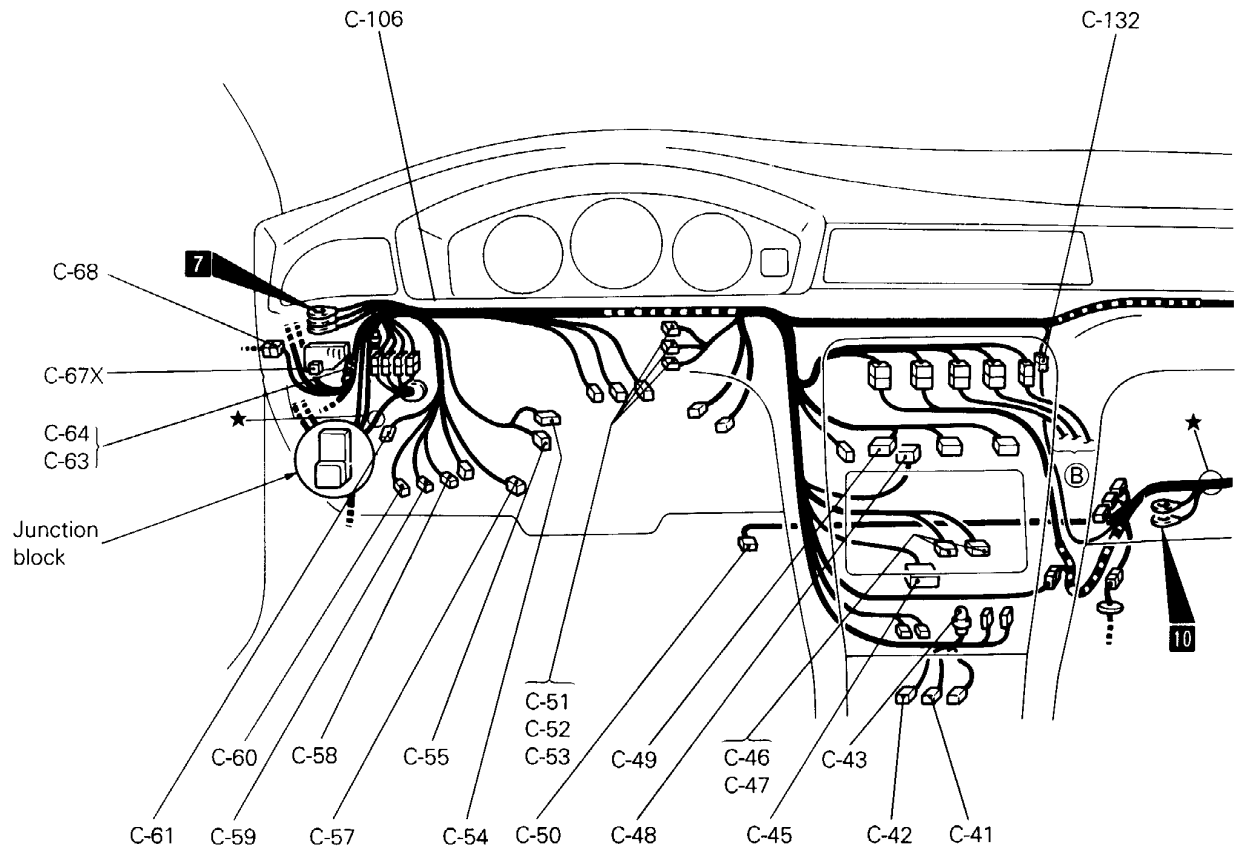
Connector  
symbol**C** -41  
to  
-132

C-41 ACTIVE-ECS switch  
 C-42 Heated seat switch (LH)  
 C-43 Cigarette lighter illumination lamp  
 C-44 –  
 C-45 Auto-cruise control unit  
 C-46 } Audio  
 C-47 }  
 C-48 EPS control unit  
 C-49 Hazard warning switch  
 C-50 Wide open throttle switch <A/T>  
 C-51 }  
 to } Column switch  
 C-53 }  
 C-54 Ignition switch  
 C-55 Key reminder switch  
 C-56 Foot lamp (RH)  
 C-57 Foot lamp (LH)  
 C-58 } Accessory socket  
 C-59 }  
 C-60 Rear wiper and washer switch

C-61 No connection  
 C-62 –  
 C-63 Diode (for ACTIVE-ECS circuit)  
 C-64 Diode (for headlamp circuit)  
 C-65X }  
 to } Refer to CENTRALIZED JUNCTION  
 C-67X }  
 C-68 Body wiring harness and front door wiring harness (LH) combination  
 C-69 } A/C control panel assembly  
 C-70 }  
 C-71 Mode selection damper control motor  
 C-72 Air mixing damper control motor  
 C-73 Power transistor  
 C-74 Water temperature sensor  
 C-75 Fin thermo sensor  
 C-76 Air inlet sensor  
 C-77 Air selection damper control motor  
 C-78 Blower motor  
 C-79 Blower motor high relay

The diagram illustrates the connection of the junction block to the vehicle chassis and the junction block itself with its terminals.

**Vehicle Chassis Connection:**

- Diagram 36N0062 shows the junction block (36N0064) connected to the vehicle chassis. The junction block is labeled with terminals C-69, C-70, C-71, C-72, C-73, C-74, C-75, C-76, C-77, C-78, C-79, C-80, C-81, C-82, and C-131. The chassis connection points are labeled 8 and 9.

**Junction block (Front):**

- Diagram 36N0067 shows the front view of the junction block with terminals C-85, C-86, C-87, C-88, C-89, C-90, C-91, C-92, and C-93.

**Junction block (Rear):**

- Diagram 36N0065 shows the rear view of the junction block with terminals C-94, C-95, C-129, C-98, C-99, C-100, C-101, C-102, C-103, C-104, and C-105.

- |       |   |   |
|-------|---|---|
| C-98  | } | Body wiring harness and junction<br>block combination             |
| C-99  |   |   |
| C-100 |   |   |
| C-101 |   |   |
| C-102 | } | TCL valve relay   |
| C-103 |   |   |
| C-104 |   |   |
| C-105 |   |   |
| C-106 | } | Body wiring harness and junction<br>block combination             |
| C-107 |   |   |
| to    |   |   |
| C-128 |   |   |
| C-129 | } | TCL switch  |
| C-130 |   |   |
| C-131 |   |   |
| C-132 |   |   |
| C-132 | } | -   |
|       |   |   |
|       |   |   |
|       |   |   |
| C-129 | } | Diode (for power seat circuit)                                    |
| C-130 |   |   |
| C-131 |   |   |
| C-132 |   |   |
| C-131 | } | Front wiring harness and ACTIVE-ECS wiring<br>harness combination |
| C-132 |   |   |
|       |   |   |
|       |   |   |
| C-132 | } | Body wiring harness and control wiring harness<br>combination     |
|       |   |   |
|       |   |   |
|       |   |   |

- (1) For details concerning the earth point (example: **7**), refer to P.3-21.
- (2) The mark ★ shows the standard mounting position of wiring harness.

## 4-2 R.H. drive vehicles

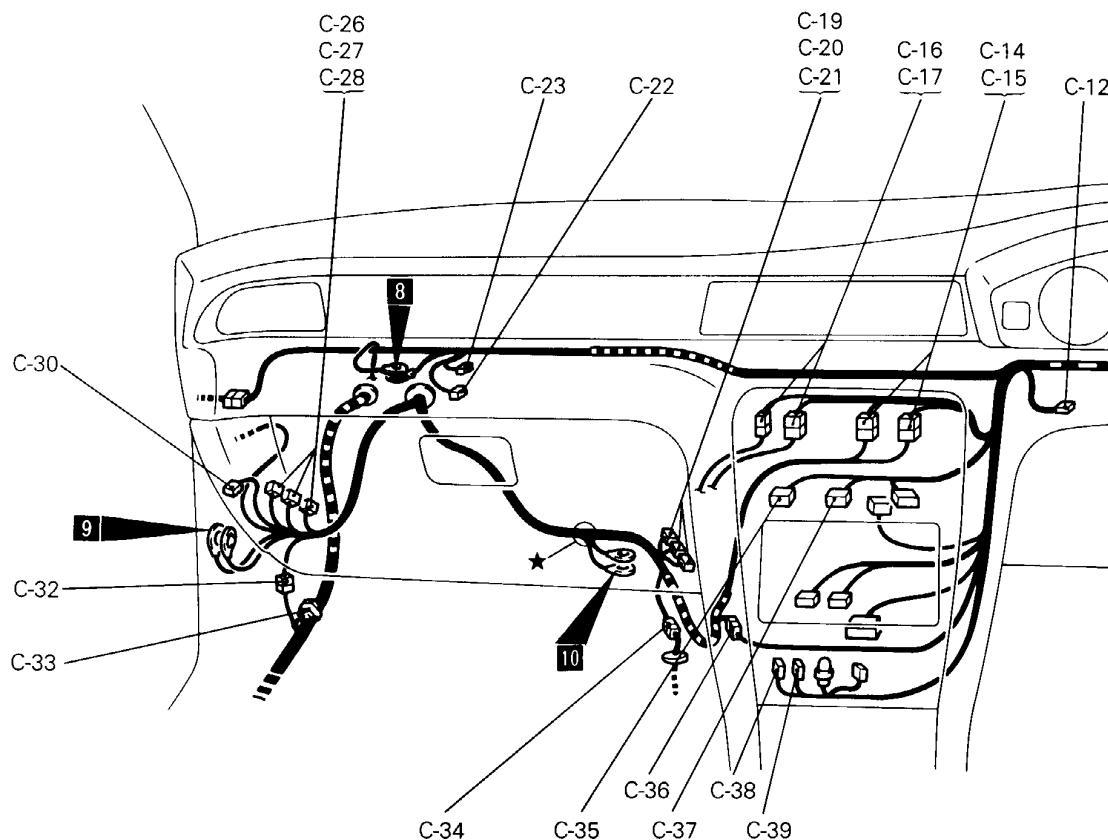
Connector  
symbolC  
-01  
to  
-40

C-01	Diode (for idle-up circuit) <DOHC>	C-11	Clutch pedal switch <Auto-cruise control (M/T)>
C-02	Body wiring harness and front wiring harness combination	C-12	Headlamp leveling switch
C-04		C-13	–
C-05	Body wiring harness and front wiring harness combination <ACTIVE-ECS>	C-14	Body wiring harness and control wiring harness combination
C-06	ETACS unit	C-16	
C-07		C-17	Body wiring harness and A/C wiring harness combination
C-08	Accelerator pedal switch <A/T>	C-18	–
C-09	Stop lamp switch (4-pin) <Auto-cruise control> or no connection	C-19	ELC-4A/T control unit
C-10	Stop lamp switch (2-pin) or no connection <Auto-cruise control>	C-21	
		C-22	Engine oil level relay
		C-23	Headlamp washer relay



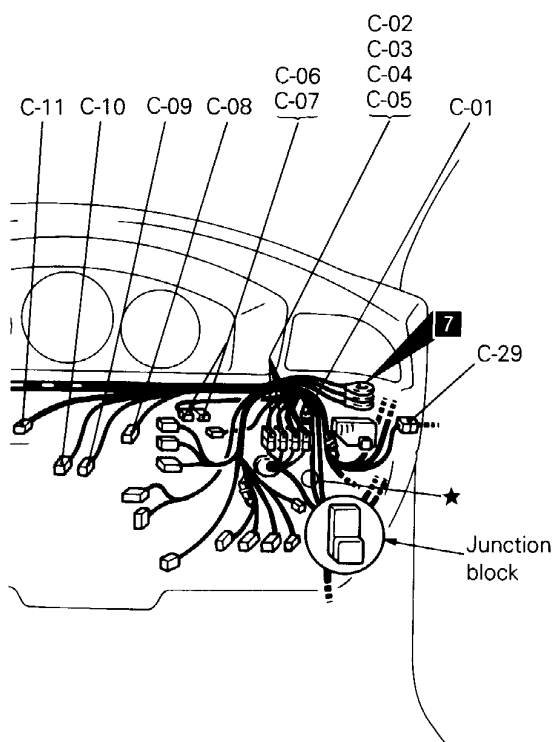

36N0061

C-24	-
C-25	-
C-26	} Engine control unit
to	
C-28	} Body wiring harness and front door wiring harness (RH) combination
C-29	
C-30	Engine control relay
C-31	-
C-32	Control wiring harness and ABS wiring harness combination <TCL>
C-33	Diode (for ABS circuit)
C-34	Oxygen sensor

C-35	Rear fog lamp switch
C-36	Body wiring harness and control wiring harness combination <ACTIVE-ECS or Auto-cruise control>
C-37	Defogger switch
C-38	} Cigarette lighter
C-39	
C-40	-

## Remarks

- (1) For details concerning the earth point (example: **7**), refer to P.3-21.
- (2) The mark ★ shows the standard mounting position of wiring harness.

## 4-2 R.H. drive vehicles

Connector  
symbol

**C** -41  
to  
-129

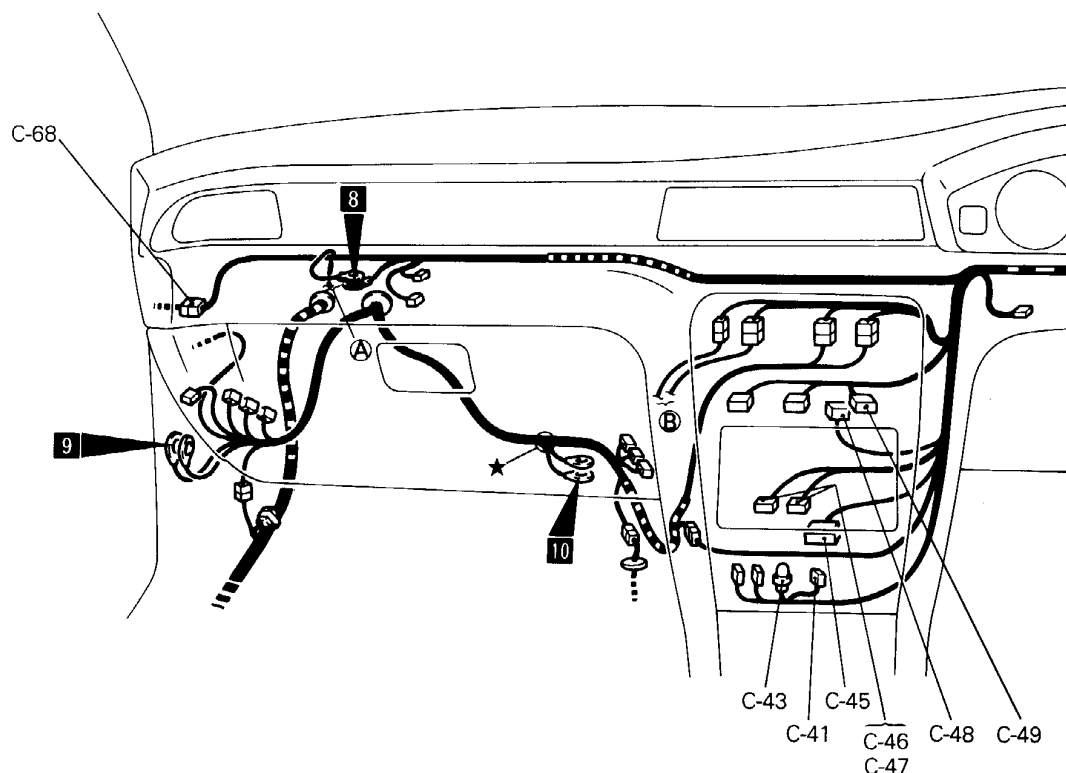

C-41 ACTIVE-ECS switch  
C-42 –  
C-43 Cigarette lighter illumination lamp  
C-44 ACC spare connector  
C-45 Auto-cruise control unit  
C-46 } Audio  
C-47 }  
C-48 EPS control unit  
C-49 Hazard warning switch  
C-50 –  
C-51 }  
to } Column switch  
C-53 }  
C-54 Ignition switch  
C-55 Key reminder switch  
C-56 Foot lamp (RH)  
C-57 Foot lamp (LH)  
C-58 } Accessory socket  
C-59 }  
C-60 Rear wiper and washer switch

C-61 } No connection  
C-62 }  
C-63 Diode (for ACTIVE-ECS circuit)  
C-64 –  
C-65X }  
to } Refer to CENTRALIZED JUNCTION  
C-67X }  
C-68 Body wiring harness and front door wiring harness  
(LH) combination  
C-69 } A/C control panel assembly  
C-70 }  
C-71 Mode selection damper control motor  
C-72 Air mixing damper control motor  
C-73 Power transistor  
C-74 Water temperature sensor  
C-75 Fin thermo sensor  
C-76 Air inlet sensor  
C-77 Air selection damper control motor  
C-78 Blower motor  
C-79 Blower motor high relay

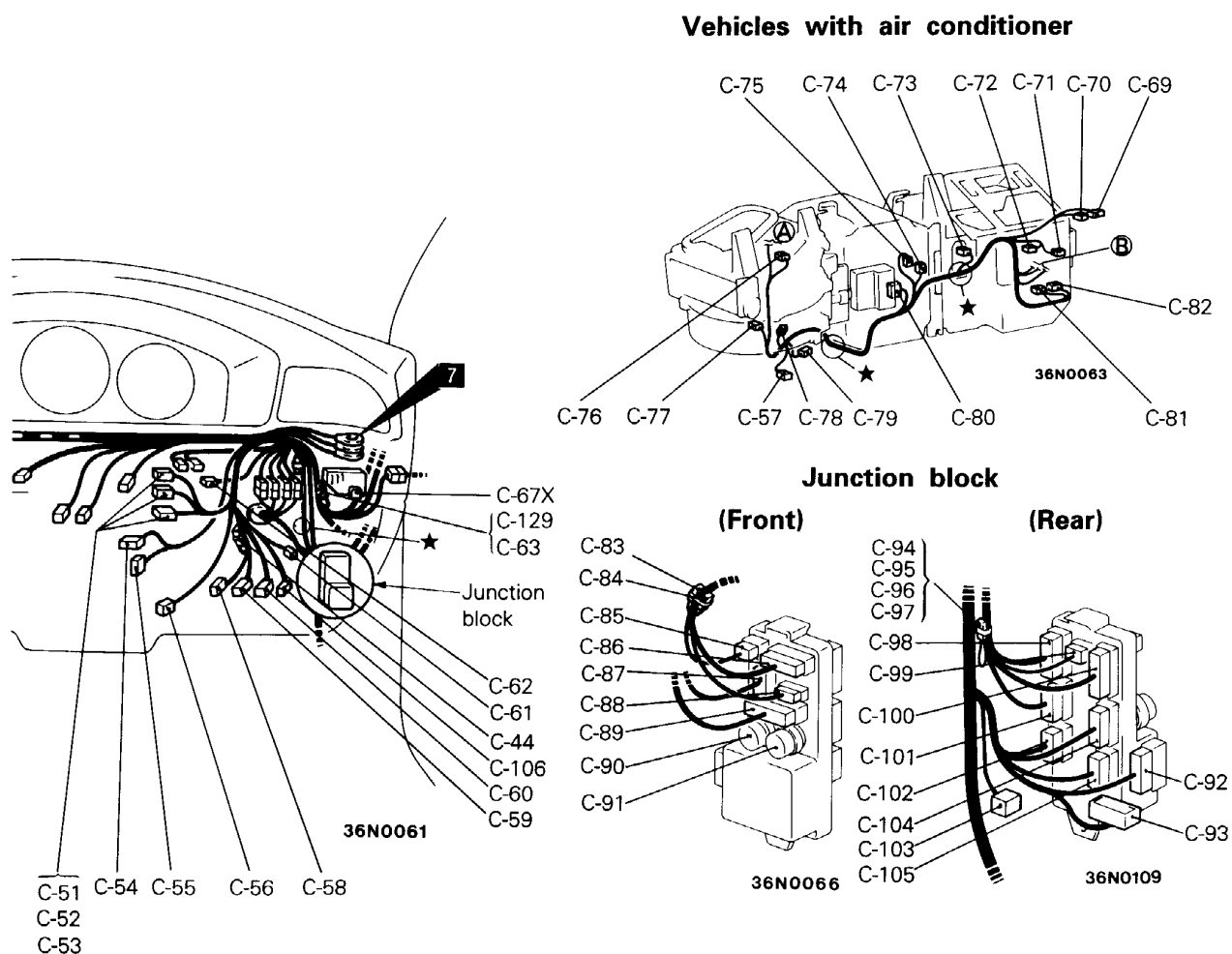

C-80	A/C belt lock controller <DOHC>
C-81	A/C control unit
C-82	
C-83	Diode (for dim-dip lamp circuit)
C-84	
C-85	Front wiring harness and junction block combination
C-86	
C-87	Roof wiring harness and junction block combination
C-88	
C-89	Instrument panel wiring harness and junction block combination
C-90	
C-91	Defogger relay
C-92	Blower motor relay
C-93	Diagnosis connector
C-94	Diagnosis connector <TCL>
C-95	Diode <4WS>
C-96	Diode (for ACTIVE-ECS circuit)
C-97	
C-129	Diode (for dim-dip lamp circuit)

C-98	Body wiring harness and junction block combination
C-99	
C-100	
C-101	
C-102	TCL valve relay
C-103	
C-104	Body wiring harness and junction block combination
C-105	
C-106	TCL switch
C-107	-
C-128	
C-129	Diode (for power seat circuit)

**Remarks**

- (1) For details concerning the earth point (example: **7**), refer to P.3-21.
- (2) The mark ★ shows the standard mounting position of wiring harness.

## 5 INSTRUMENT PANEL

### 5-1 L.H. drive vehicles

Connector  
symbol

**D**

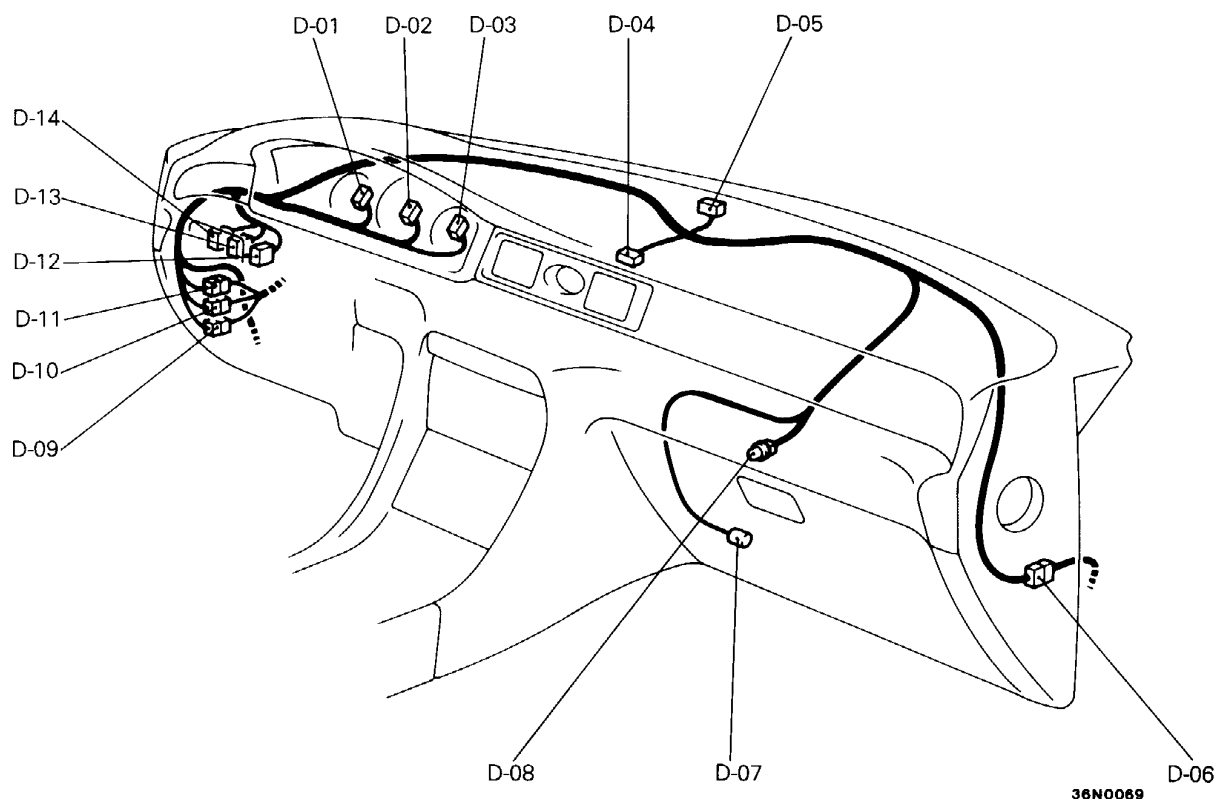

- |         |   |  |
|---------|---|--|
| D-01    | } | Combination meter  |
| to D-03 |   |  |
| D-04    |   | Clock  |
| D-05    |   | Photo sensor   |
| D-06    |   | Control wiring harness and instrument panel wiring harness combination <A/T> |
| D-07    |   | Glove box lamp switch  |
| D-08    |   | Glove box lamp   |

- |         |   |   |
|---------|---|---|
| D-09    | } | Body wiring harness and instrument panel wiring harness combination |
| to D-11 |   |   |
| D-12    |   | Rheostat  |
| D-13    |   | Front fog lamp switch   |
| D-14    |   | Auto-cruise control main switch or no connection                    |

36N0069

## 5-2 R.H. drive vehicles

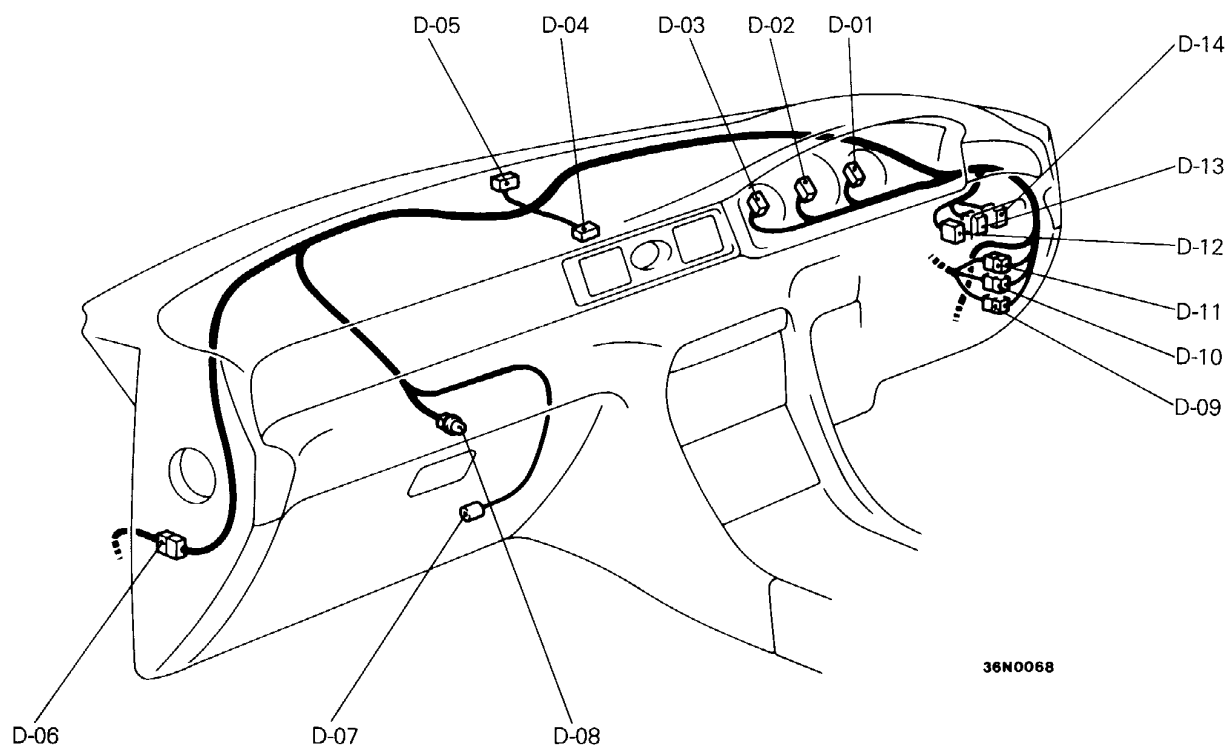
Connector  
symbol**D**

36N0068

D-01 }  
to } Combination meter  
D-03 }

D-04 Clock  
D-05 Photo sensor  
D-06 Control wiring harness and instrument panel wiring  
harness combination <A/T>  
D-07 Glove box lamp switch  
D-08 Glove box lamp

D-09 }  
to } Body wiring harness and  
D-11 } instrument panel wiring harness combination

D-12 Rheostat  
D-13 Front fog lamp switch  
D-14 Auto-cruise control main switch or  
no connection

## 6 INTERIOR

### 6-1 L.H. drive vehicles

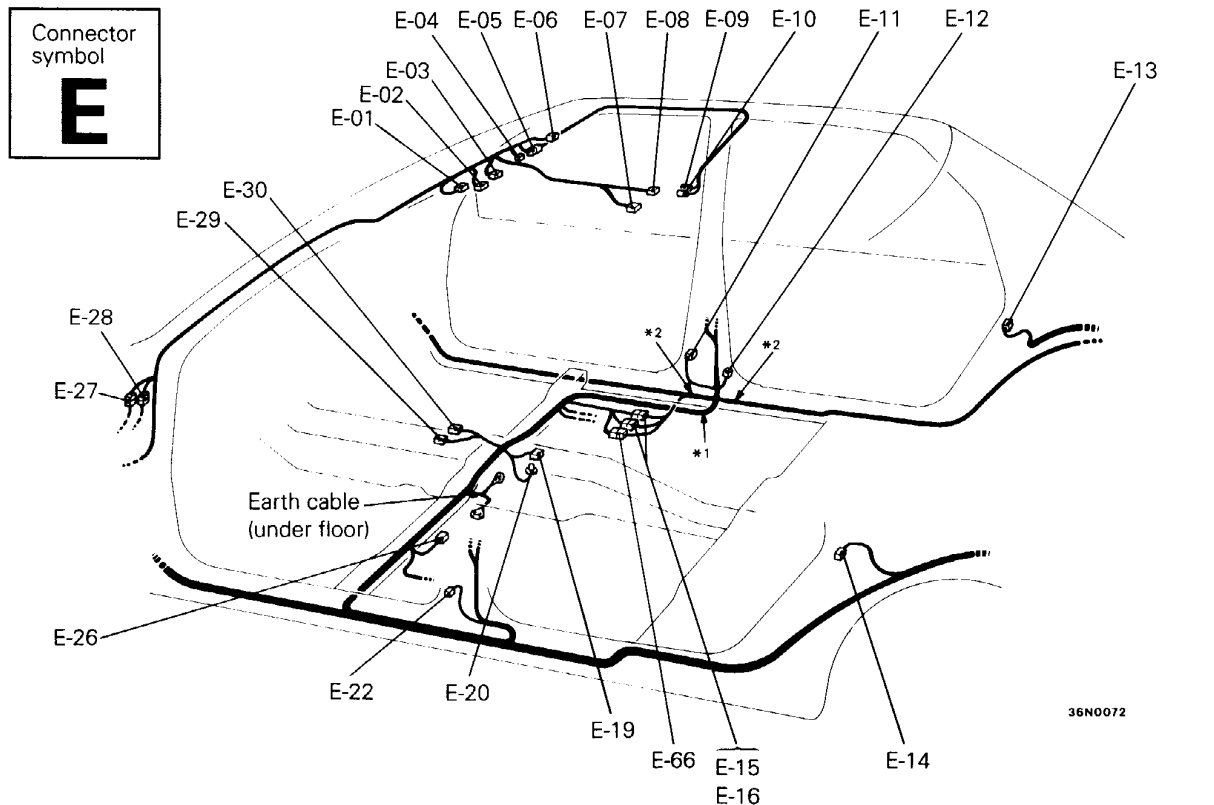

E-01	Sunroof motor	E-26	No connection
E-02	Map lamp <Vehicles without sunroof>	E-27	Body wiring harness and roof wiring harness combination
E-03	Room lamp <Vehicles with sunroof>	E-28	Body wiring harness and roof wiring harness combination <Power seat>
E-04	Power seat memory switch	E-29	Overdrive switch <A/T>
E-05	Roof wiring harness and interior temperature sensor joint harness combination <Vehicles with sunroof>	E-30	Power/Economy changeover switch <A/T>
E-06	Sunroof control unit	E-31	Front height adjusting motor (Passenger's side)
E-07	Interior temperature sensor <Vehicles without sunroof>	E-32	Front height limit switch (Passenger's side)
E-08	Room lamp <Vehicles without sunroof>	E-33	Power seat switch (Passenger's side)
E-09	Interior temperature sensor <Vehicles with sunroof>	E-34	Rear height limit switch (Passenger's side)
E-10		E-35	Reclining position adjusting motor (Passenger's side)
E-11	Front door switch (RH)	E-36	Rear height adjusting motor (Passenger's side)
E-12	No connection	E-37	Seat back heater (Passenger's side)
E-13	Rear door switch (RH)	E-38	Body wiring harness and heated seat wiring harness combination (Passenger's side)
E-14	Rear door switch (LH)		
E-15	Body wiring harness and ACTIVE-ECS wiring harness combination		
E-16			
E-17	–		
E-18	–		
E-19	Parking brake switch		
E-20	Front ashtray illumination lamp		
E-21	–		
E-22	Front door switch (LH)		
E-23	–		
to			
E-25			

## &lt;Vehicles with power seat or heated seat&gt;

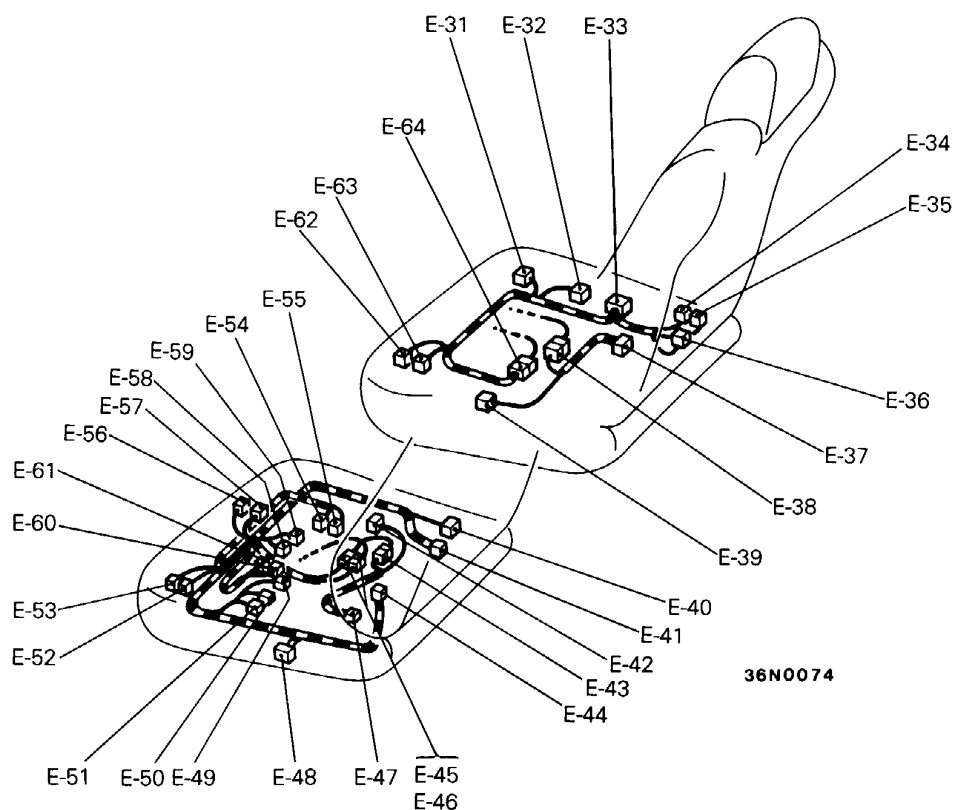

- E-39 Seat cushion heater (Passenger's side)
- E-40 Slide position limit switch (Driver's side)
- E-41 Reclining position limit switch (Driver's side)
- E-42 Seat cushion heater (Driver's side)
- E-43 Body wiring harness and heated seat wiring harness combination (Driver's side)
- E-44 Rear height limit switch (Driver's side)
- E-45 } Body wiring harness and power seat wiring
- E-46 } harness combination (Driver's side)
- E-47 Seat back heater (Driver's side)
- E-48 Power seat switch (Driver's side)
- E-49 Reclining position adjusting motor/reclining position sensor (Driver's side)
- E-50 Rear height adjusting motor/rear height position sensor (Driver's side)
- E-51 Front height limit switch (Driver's side)
- E-52 Slide position sensor (Driver's side)
- E-53 Front height adjusting motor/front height position sensor (Driver's side)
- E-54 } Power seat control unit
- E-55 } Power seat inspection connector
- E-56 Slide position adjusting motor (Driver's side)
- E-57 to } Power seat control unit
- E-61 }

- E-62 Slide position limit switch (Passenger's side)
- E-63 Slide position adjusting motor (Passenger's side)
- E-64 Body wiring harness and power seat wiring harness combination (Passenger's side)
- E-65 –
- E-66 Body wiring harness and ACTIVE-ECS wiring harness combination

## Remarks

- (1) \*1: Vehicles without ACTIVE-ECS.
- (2) \*2: Vehicles with ACTIVE-ECS.

## 6-2 R.H. drive vehicles

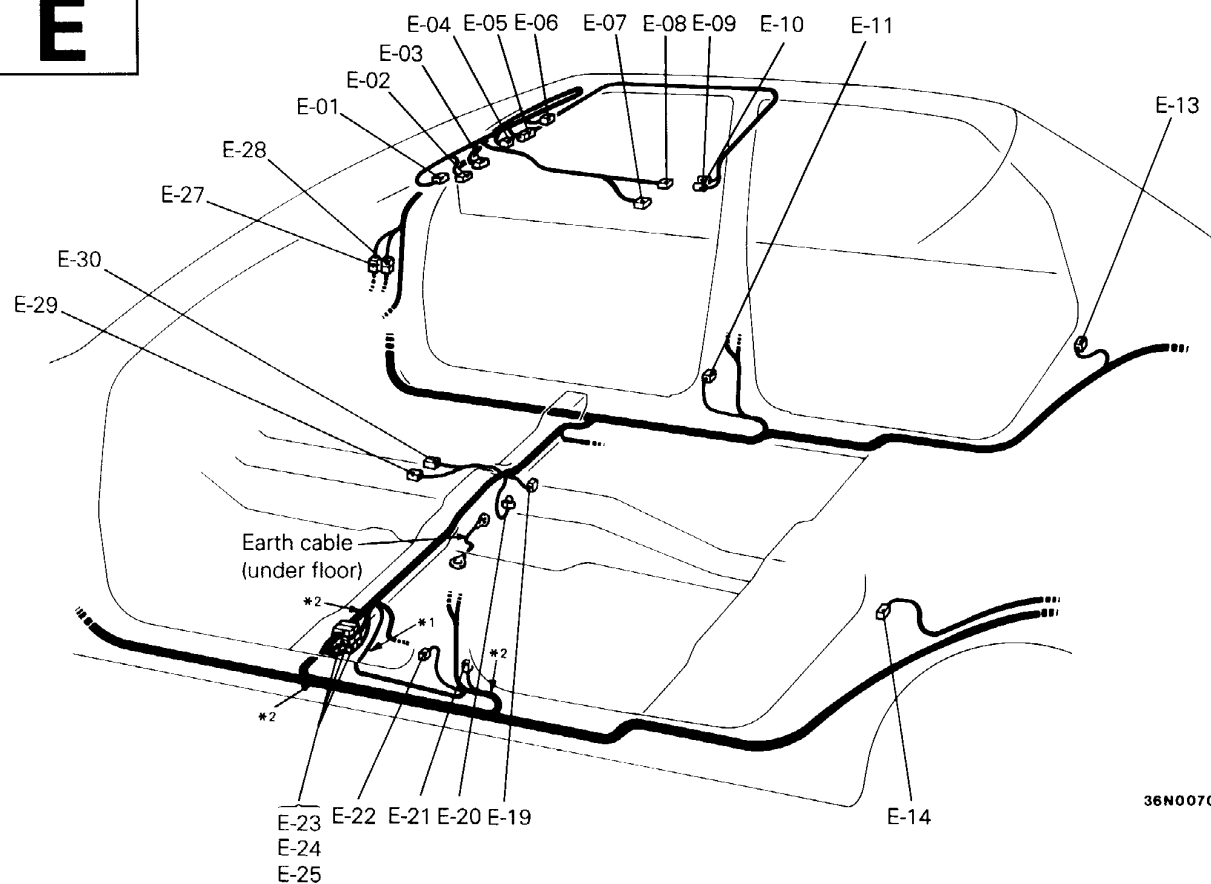
Connector  
symbol**E**

36N0070

- E-01 Sunroof motor
- E-02 Map lamp <Vehicles without sunroof>
- E-03 Room lamp <Vehicles with sunroof>
- E-04 Power seat memory switch
- E-05 Roof wiring harness and interior temperature sensor joint harness combination <Vehicles with sunroof>
- E-06 Sunroof control unit
- E-07 Interior temperature sensor <Vehicles without sunroof>
- E-08 Room lamp <Vehicles without sunroof>
- E-09 } Interior temperature sensor
- E-10 } <Vehicles with sunroof>
- E-11 Front door switch (RH)
- E-12 –
- E-13 Rear door switch (RH)
- E-14 Rear door switch (LH)
- E-15 } –
- E-18 } –
- E-19 Parking brake switch

- E-20 Front ashtray illumination lamp
- E-21 No connection
- E-22 Front door switch (LH)
- E-23 } Body wiring harness and ABS
- E-24 } to wiring harness combination
- E-25 }
- E-26 –
- E-27 Body wiring harness and roof wiring harness combination
- E-28 Body wiring harness and roof wiring harness combination <Power seat>
- E-29 Overdrive switch <A/T>
- E-30 Power/Economy changeover switch <A/T>
- E-31 Front height adjusting motor (Passenger's side)
- E-32 Front height limit switch (Passenger's side)
- E-33 Power seat switch (Passenger's side)
- E-34 Rear height limit switch (Passenger's side)
- E-35 Reclining position adjusting motor (Passenger's side)
- E-36 Rear height adjusting motor (Passenger's side)



## &lt;Vehicles with power seat&gt;

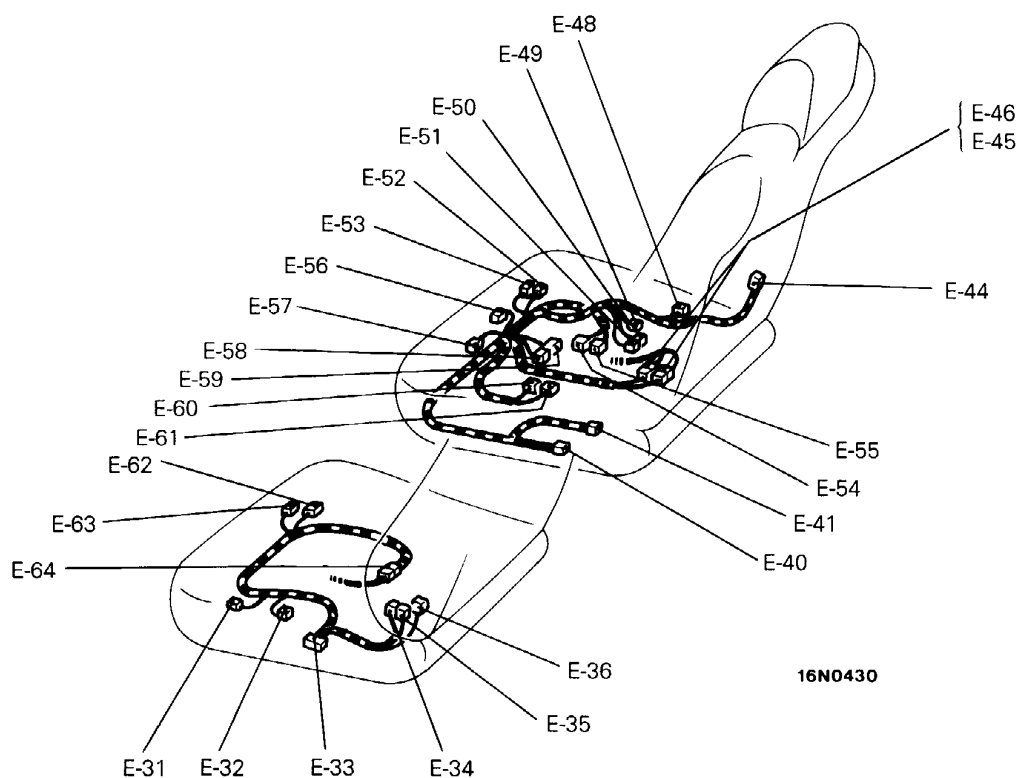

- E-37 }  
 to } -  
 E-39 }  
 E-40 Slide position limit switch (Driver's side)  
 E-41 Reclining position limit switch (Driver's side)  
 E-42 -  
 E-43 -  
 E-44 Rear height limit switch (Driver's side)  
 E-45 } Body wiring harness and power seat wiring  
 E-46 } harness combination (Driver's side)  
 E-47 -  
 E-48 Power seat switch (Driver's side)  
 E-49 Reclining position adjusting motor/reclining  
 position sensor (Driver's side)  
 E-50 Rear height adjusting motor/rear height position  
 sensor (Driver's side)  
 E-51 Front height limit switch (Driver's side)  
 E-52 Slide position sensor (Driver's side)  
 E-53 Front height adjusting motor/front height position  
 sensor (Driver's side)

- E-54 }  
 E-55 } Power seat control unit  
 E-56 Power seat inspection connector  
 E-57 Slide position adjusting motor (Driver's side)  
 E-58 }  
 to } Power seat control unit  
 E-61 }  
 E-62 Slide position limit switch (Passenger's side)  
 E-63 Slide position adjusting motor (Passenger's side)  
 E-64 Body wiring harness and power seat wiring  
 harness combination (Passenger's side)

## Remarks

- (1) \*: Vehicles without ABS.  
 (2) \*: Vehicles with ABS.

## 7 DOOR

### 7-1 L.H. drive vehicles

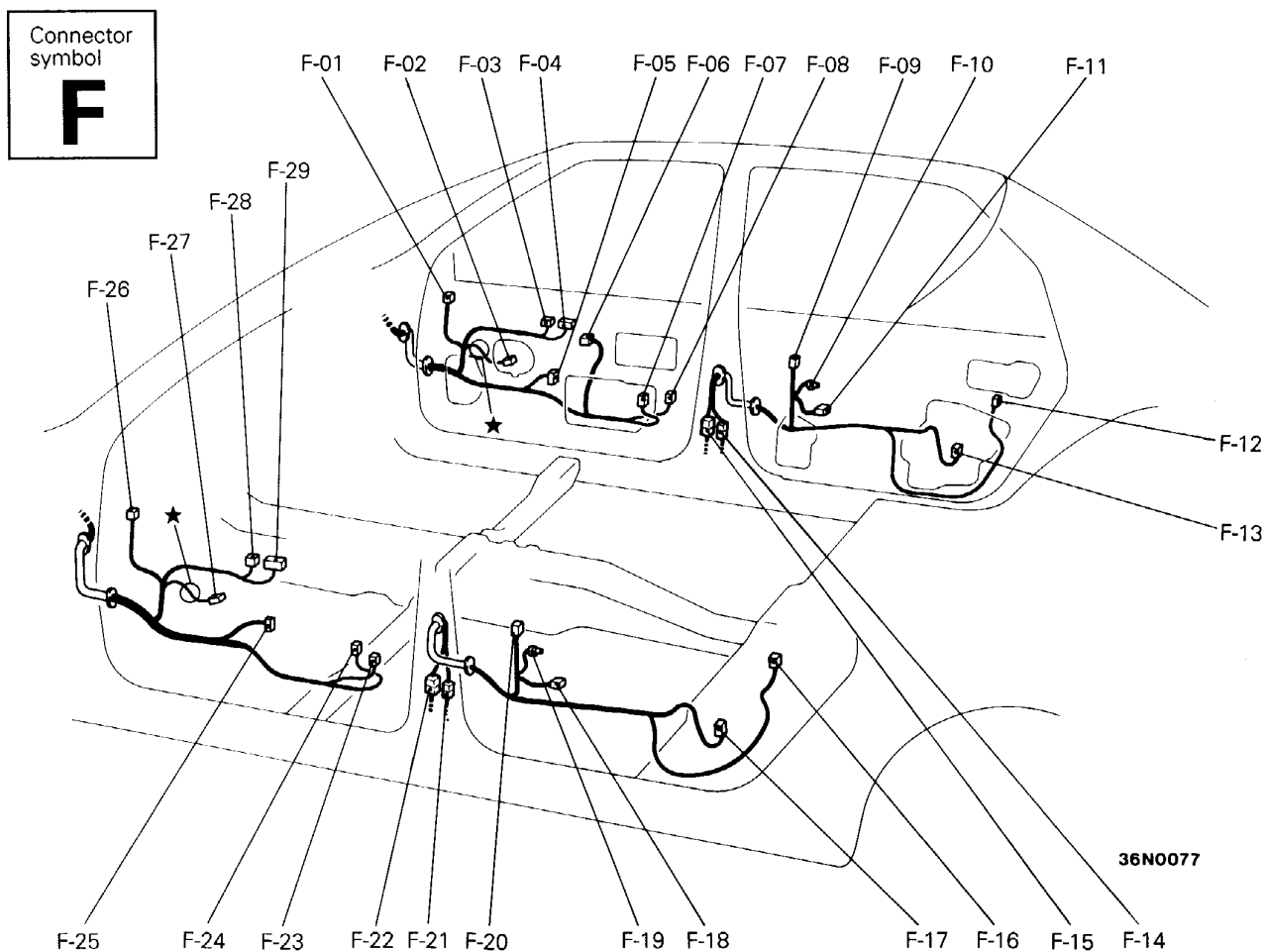

F-01	Door mirror (R.H.)
F-02	Door speaker (R.H.)
F-03	Door control unit (R.H.)
F-04	
F-05	Power window motor (Front: R.H.)
F-06	Door lock key cylinder switch
F-07	Door lamp (Front: R.H.)
F-08	Door lock actuator (Front: R.H.)
F-09	Rear power window unit (R.H.)
F-10	Rear ashtray illumination lamp (R.H.)
F-11	Power window motor (Rear: R.H.)
F-12	Door lock actuator (Rear: R.H.)
F-13	Door lamp (Rear: R.H.)
F-14	Body wiring harness and rear door wiring harness (R.H.) combination <Vehicles without ACTIVE-ECS> or ACTIVE-ECS wiring harness and rear door wiring harness (R.H.) combination <Vehicles with ACTIVE-ECS>
F-15	

F-16	Door lock actuator (Rear: L.H.)
F-17	Door lamp (Rear: L.H.)
F-18	Power window motor (Rear: L.H.)
F-19	Rear ashtray illumination lamp (L.H.)
F-20	Rear power window unit (L.H.)
F-21	Body wiring harness and rear door wiring harness (L.H.) combination
F-22	
F-23	Door lock actuator (Front: L.H.)
F-24	Door lamp (Front: L.H.)
F-25	Power window motor (Front: L.H.)
F-26	Door mirror (L.H.)
F-27	Door speaker (L.H.)
F-28	Door control unit (L.H.)
F-29	

Remark  
The mark ★ shows the standard mounting position of wiring harness.

## 7-2 R.H. drive vehicles

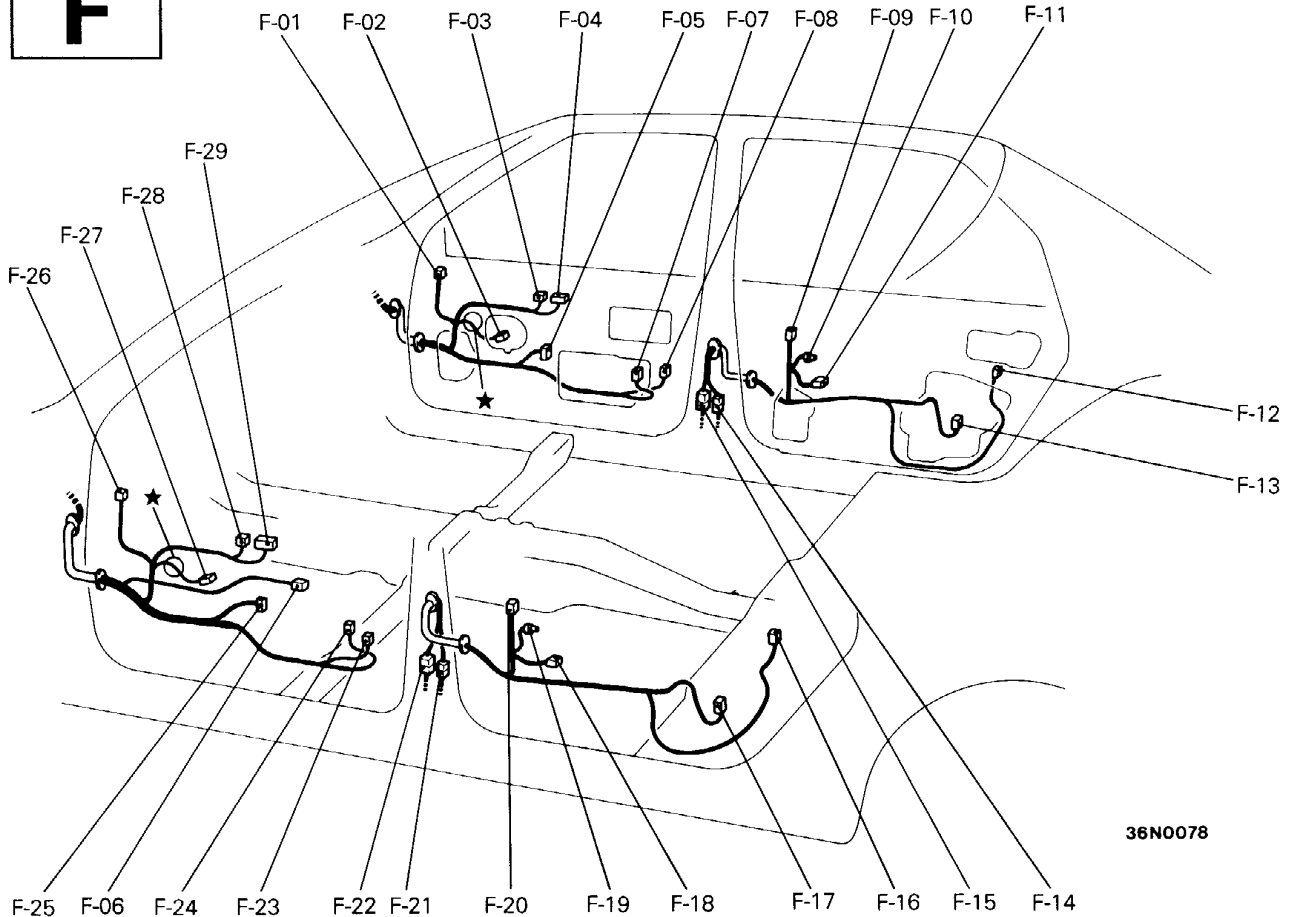
Connector  
symbol**F**

36N0078

F-01	Door mirror (R.H.)
F-02	Door speaker (R.H.)
F-03	Door control unit (R.H.)
F-04	
F-05	Power window motor (Front: R.H.)
F-06	Door lock key cylinder switch
F-07	Door lamp (Front: R.H.)
F-08	Door lock actuator (Front: R.H.)
F-09	Rear power window unit (R.H.)
F-10	Rear ashtray illumination lamp (R.H.)
F-11	Power window motor (Rear: R.H.)
F-12	Door lock actuator (Rear: R.H.)
F-13	Door lamp (Rear: R.H.)
F-14	Body wiring harness and rear door wiring harness (R.H.) combination
F-15	
F-16	Door lock actuator (Rear: L.H.)
F-17	Door lamp (Rear: L.H.)

F-18	Power window motor (Rear: L.H.)
F-19	Rear ashtray illumination lamp (L.H.)
F-20	Rear power window unit (L.H.)
F-21	Body wiring harness and rear door wiring harness (L.H.) combination <Vehicles without ABS> or ABS wiring harness and rear door wiring harness (L.H.) combination <Vehicles with ABS>
F-22	
F-23	Door lock actuator (Front: L.H.)
F-24	Door lamp (Front: L.H.)
F-25	Power window motor (Front: L.H.)
F-26	Door mirror (L.H.)
F-27	Door speaker (L.H.)
F-28	Door control unit (L.H.)
F-29	

## Remark

The mark ★ shows the standard mounting position of wiring harness.

## 8 LUGGAGE COMPARTMENT

### 8-1 L.H. drive vehicles

Connector  
symbol

**G**

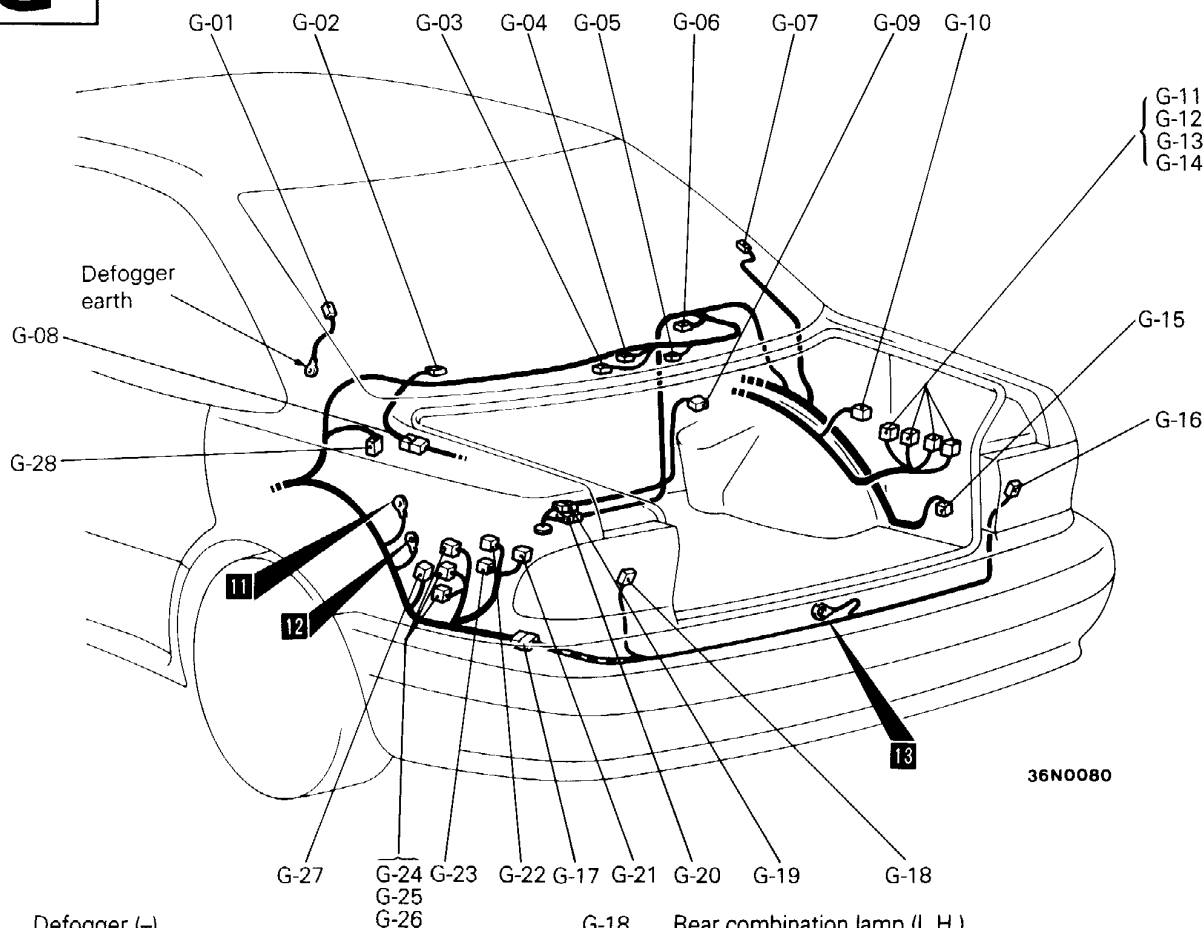

- G-01 Defogger (-)
- G-02 Rear speaker (L.H.)
- G-03 Rear wiper motor
- G-04 Rear intermittent wiper relay
- G-05 Trunk room lamp
- G-06 Rear speaker (R.H.)
- G-07 Defogger (+)
- G-08 Body wiring harness and rear lid wiring harness combination
- G-09 ACTIVE-ECS damping force switching actuator (Rear: R.H.)
- G-10 ACTIVE-ECS rear solenoid valve assembly
- G-11 to G-14 } ACTIVE-ECS control unit
- G-15 Rear washer motor
- G-16 Rear combination lamp (R.H.)
- G-17 Body wiring harness and trunk room wiring harness combination

- G-18 Rear combination lamp (L.H.)
- G-19 Body wiring harness and fuel pump wiring harness combination
- G-20 Body wiring harness and fuel pump wiring harness combination <ABS>
- G-21 Diagnosis code erasure connector <ABS>
- G-22 } ABS control unit
- G-23 }
- G-24 to } TCL control unit
- G-26 }
- G-27 Motor antenna
- G-28 ACTIVE-ECS damping force switching actuator (Rear: L.H.)

Remark  
For details concerning the earth point (example: 11), refer to P.3-21.

## 8-2 R.H. drive vehicles

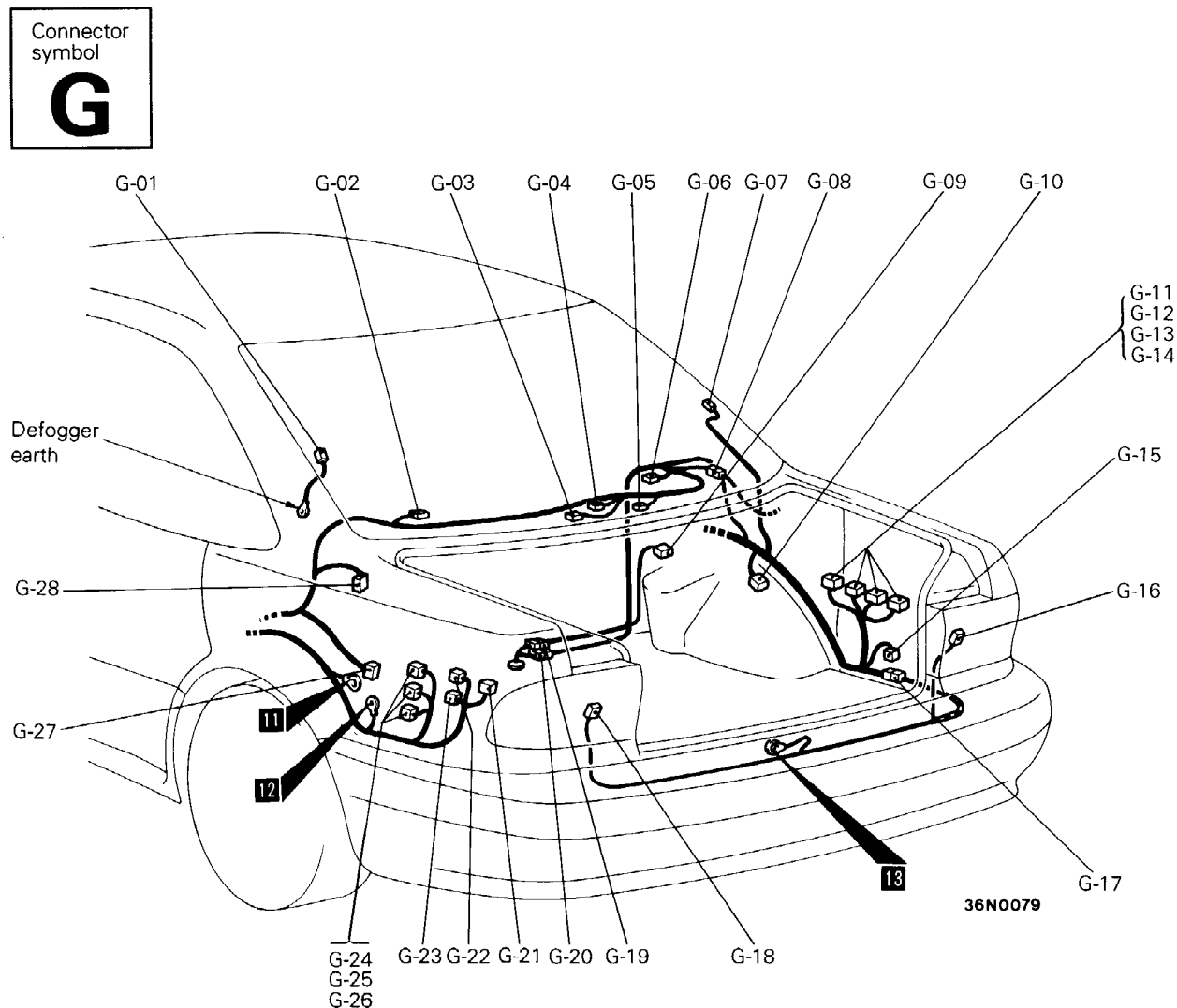

- G-01 Defogger (-)
- G-02 Rear speaker (L.H.)
- G-03 Rear wiper motor
- G-04 Rear intermittent wiper relay
- G-05 Trunk room lamp
- G-06 Rear speaker (R.H.)
- G-07 Defogger (+)
- G-08 Body wiring harness and rear lid wiring harness combination
- G-09 ACTIVE-ECS damping force switching actuator (Rear: R.H.)
- G-10 ACTIVE-ECS rear solenoid valve assembly
- G-11 to G-14 } ACTIVE-ECS control unit
- G-15 Rear washer motor
- G-16 Rear combination lamp (R.H.)
- G-17 Body wiring harness and trunk room wiring harness combination

- G-18 Rear combination lamp (L.H.)
- G-19 Body wiring harness and fuel pump wiring harness combination
- G-20 Body wiring harness and fuel pump wiring harness combination <ABS>
- G-21 Diagnosis code erasure connector <ABS>
- G-22 } ABS control unit
- G-23 } ABS control unit
- G-24 to G-26 } TCL control unit
- G-27 Motor antenna
- G-28 ACTIVE-ECS damping force switching actuator (Rear: L.H.)

Remark  
For details concerning the earth point (example: **11**), refer to P.3-21.

## 9 TRUNK LID

Connector  
symbol**H**

&lt;L.H. drive vehicles&gt;

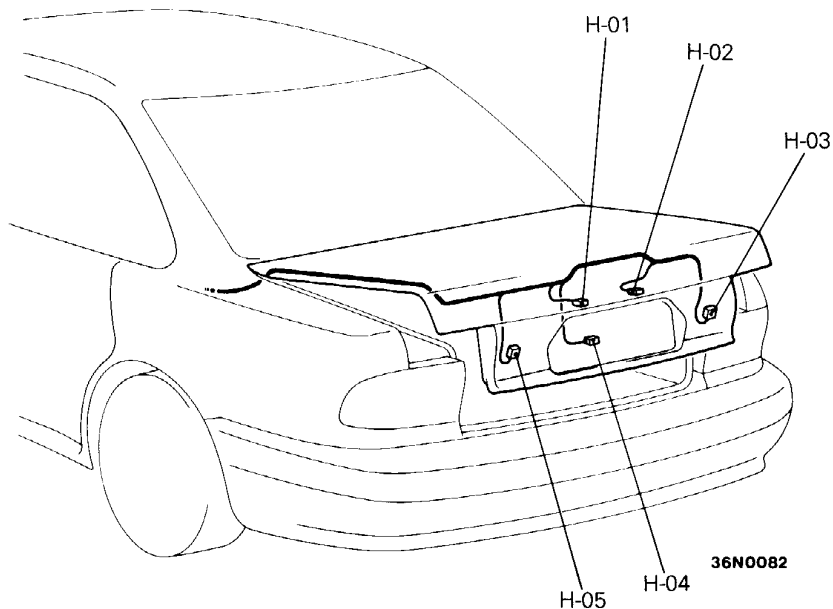

&lt;R.H. drive vehicles&gt;

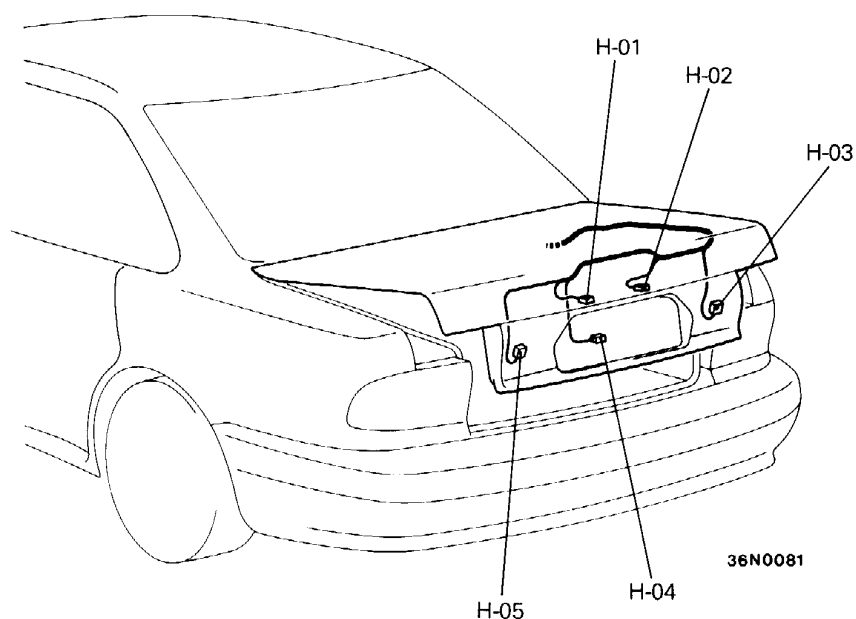

- H-01 License plate lamp (L.H.)
- H-02 License plate lamp (R.H.)
- H-03 Rear lid lamp (R.H.)
- H-04 Trunk room lamp switch
- H-05 Rear lid lamp (L.H.)

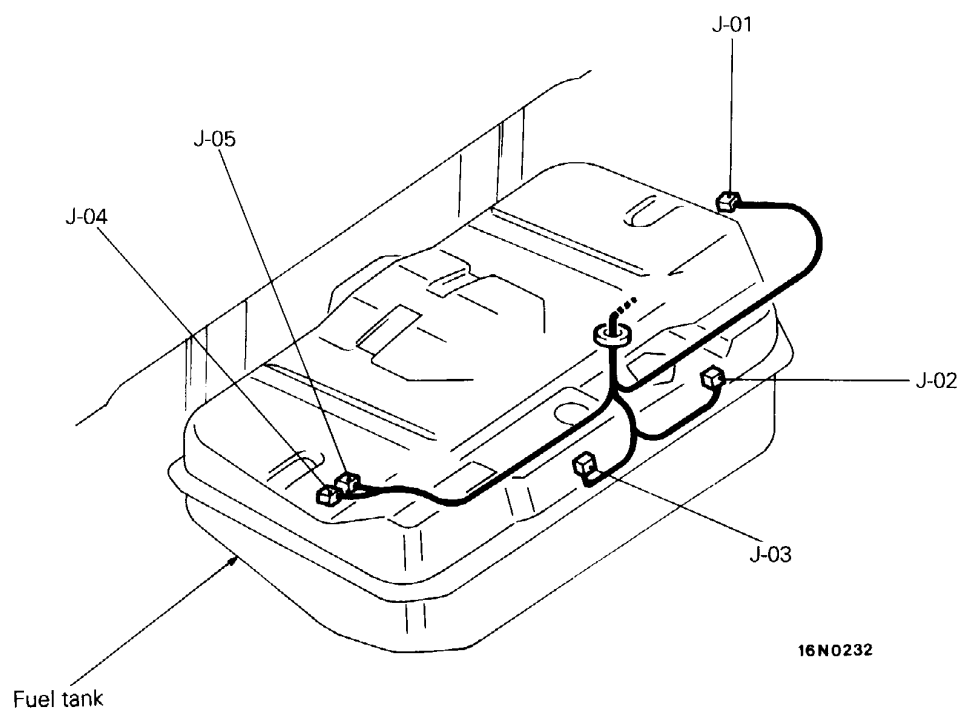
**10 UNDER REAR FLOOR**Connector  
symbol**J**

- J-01 ABS speed sensor (Rear: R.H.) <ABS>
- J-02 Fuel pump
- J-03 Fuel gauge unit
- J-04 ABS speed sensor (Rear: L.H.) <ABS>
- J-05 ACTIVE-ECS rear height sensor