

ACCELERATOR CONTROL, FUEL & EXHAUST SYSTEMS

SECTION FE

GI
MA
EM
LC
EC
FE
CL
MT
TF
PD
FA
RA
BR
ST
RS
BT
HA
EL
IDX

CONTENTS

PREPARATION/ACCELERATOR CONTROL SYSTEM2	Adjusting Accelerator Wire3	
Special Service Tool2	FUEL SYSTEM4	
Accelerator Control System.....2	EXHAUST SYSTEM6	

PREPARATION/ACCELERATOR CONTROL SYSTEM

Special Service Tool

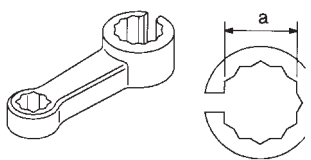
Tool number Tool name	Description
KV10114400 Heated oxygen sensor wrench	 <p>Loosening or tightening heated oxygen sensor</p> <p>a = 22 mm (0.87 in)</p>
	NT636

Accelerator Control System

CAUTION:

- When removing accelerator wire, make a mark to indicate lock nut's initial position.
- Check that throttle valve opens fully when accelerator pedal is fully depressed. Also check that it returns to idle position when pedal is released.
- Check accelerator control parts for improper contact with any adjacent parts.
- When connecting accelerator parts wire, be careful not to twist or scratch wire.

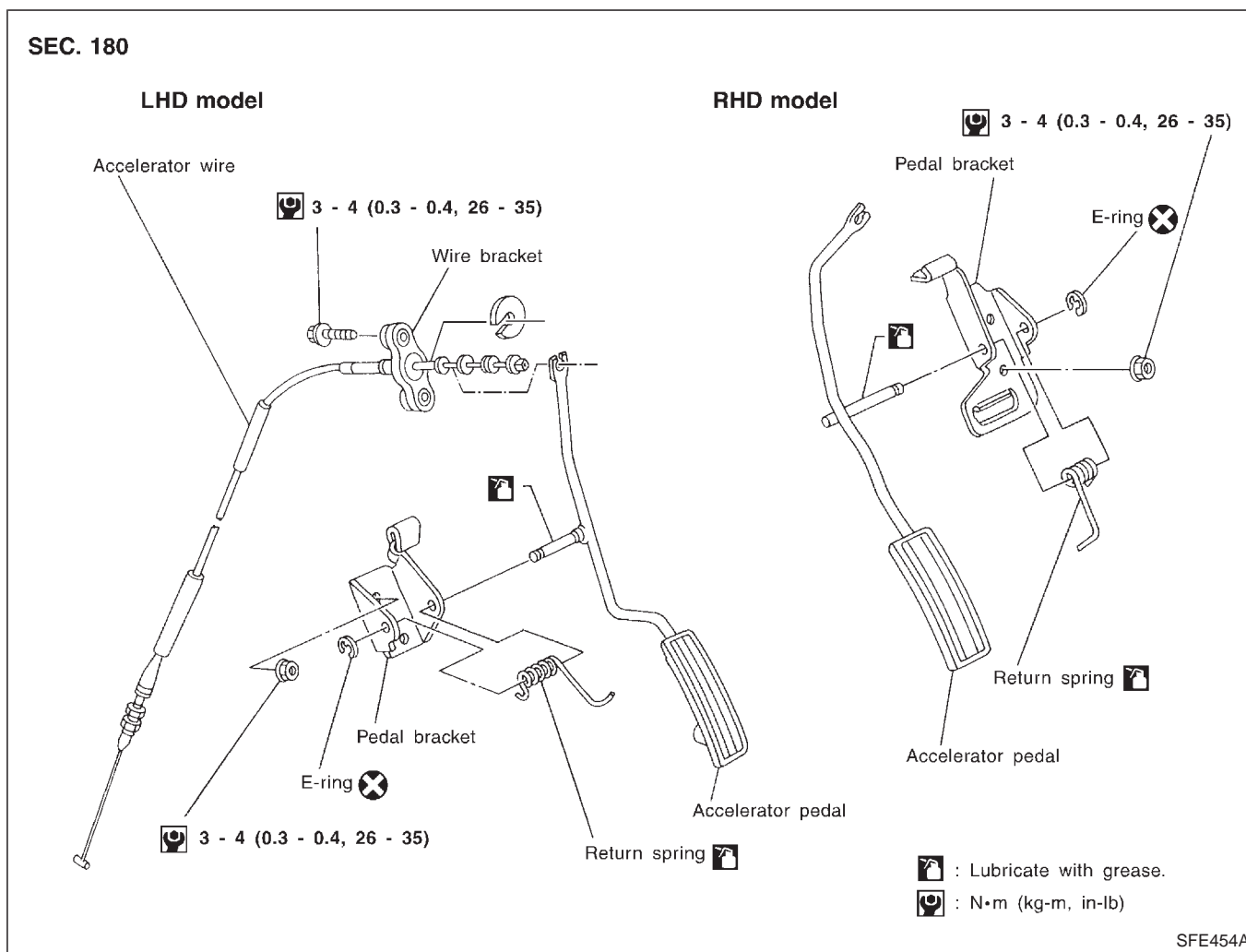

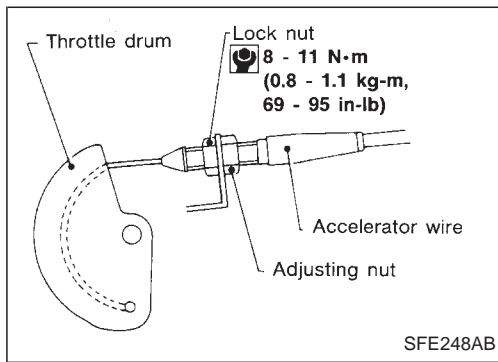

Adjusting Accelerator Wire

1. Loosen lock nut, and tighten adjusting nut until throttle drum starts to move.
2. From that position turn back adjusting nut 1.5 to 2 turns, and fasten it with lock nut.

GI

MA

EM

LC

EC

FE

CL

MT

TF

PD

FA

RA

BR

ST

RS

BT

HA

EL

IDX

FUEL SYSTEM

Diesel engine model
SEC. 172

 2.0 - 2.5
(0.2 - 0.26, 17.4 - 22.6)

 27 - 35
(2.8 - 3.6, 20 - 26)

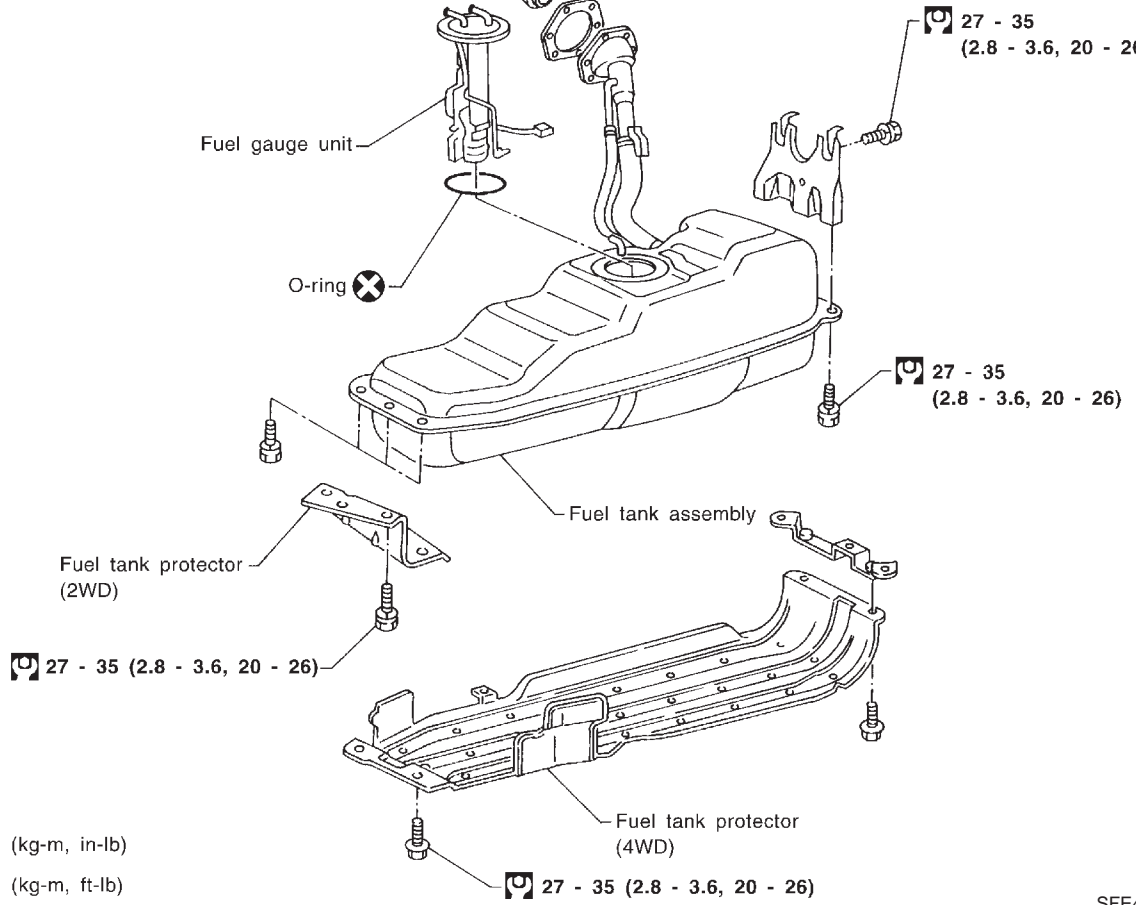

SFE460A

GI
MA
EM
LC
EC
FE
CL
MT
TF
PD
FA
RA
BR
ST
RS
BT
HA
EL
IDX

EXHAUST SYSTEM

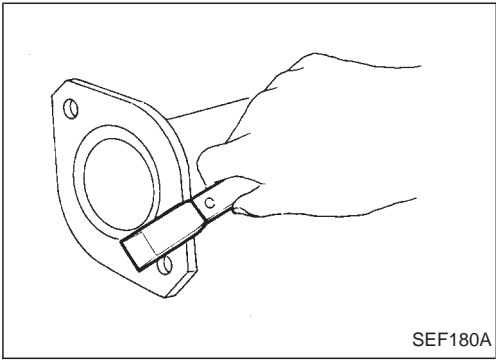

SEF180A

CAUTION:

- Always replace exhaust gaskets with new ones when reassembling. If gasket is left on flange surface, scrape off completely as shown at left.
- With engine running, check all tube connections for exhaust gas leaks, and entire system for unusual noises.
- Ensure that mounting brackets and mounting insulators are installed properly and free from undue stress. Improper installation could result in excessive noise or vibration.
- Discard any heated oxygen sensor which has been dropped from a height of more than 0.5 m (19.7 in) onto a hard surface such as concrete floor; use a new one.

KA24E ENGINE (2WD) MODEL

Without catalyzer
SEC. 200

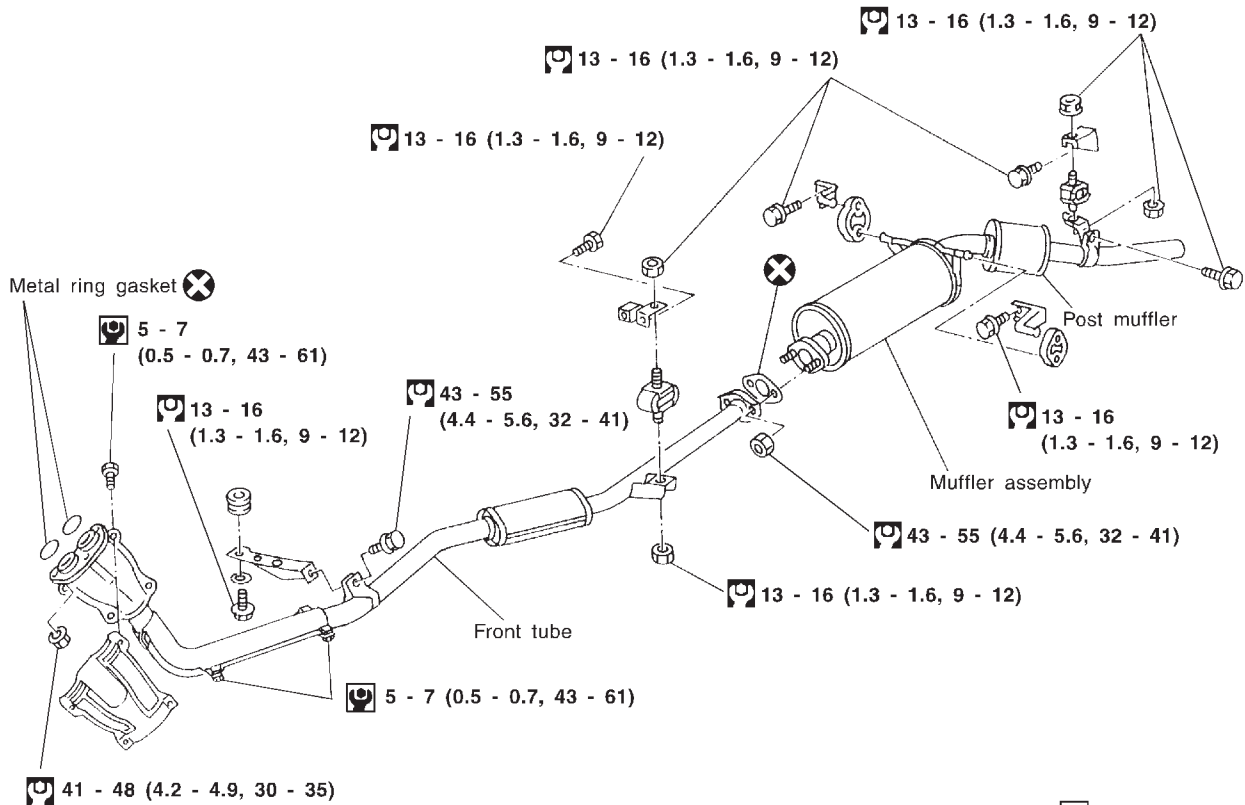

⊗ : N·m (kg-m, in-lb)
⊗ : N·m (kg-m, ft-lb)

SFE456A

EXHAUST SYSTEM

NA20 ENGINE MODEL

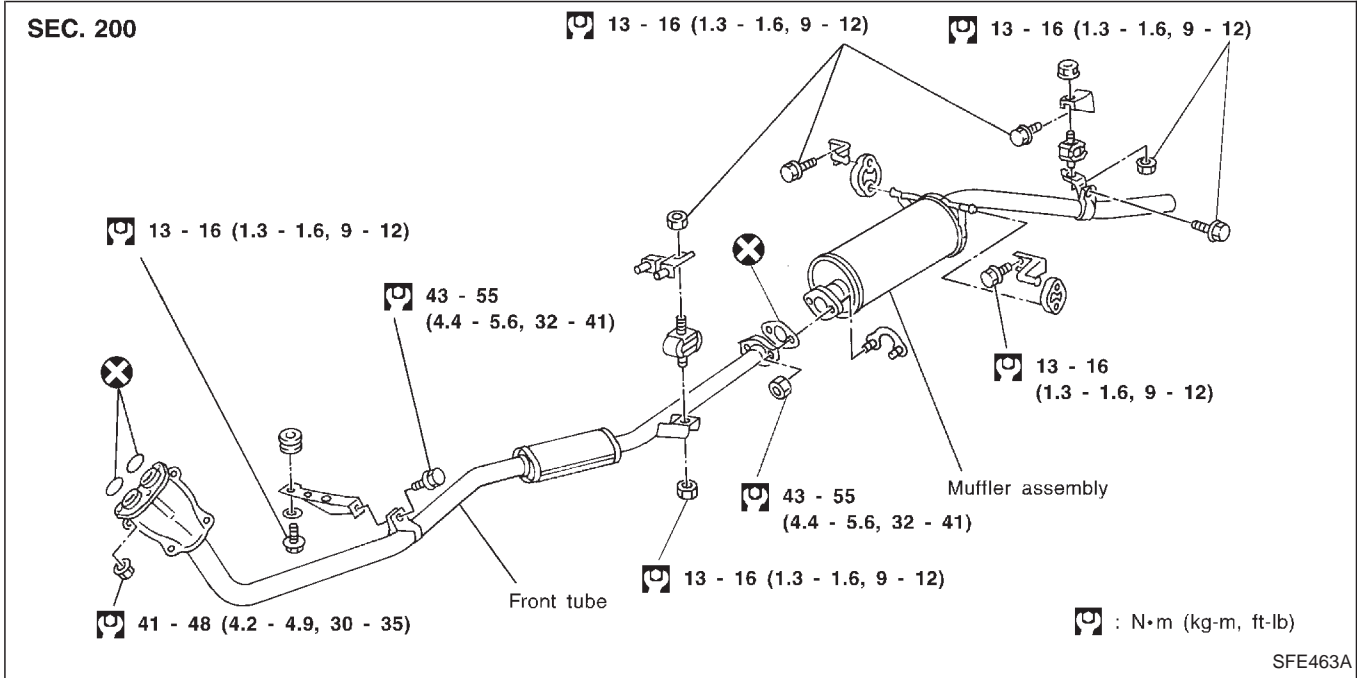

EXHAUST SYSTEM

DIESEL ENGINE MODEL

SEC. 200
4WD model

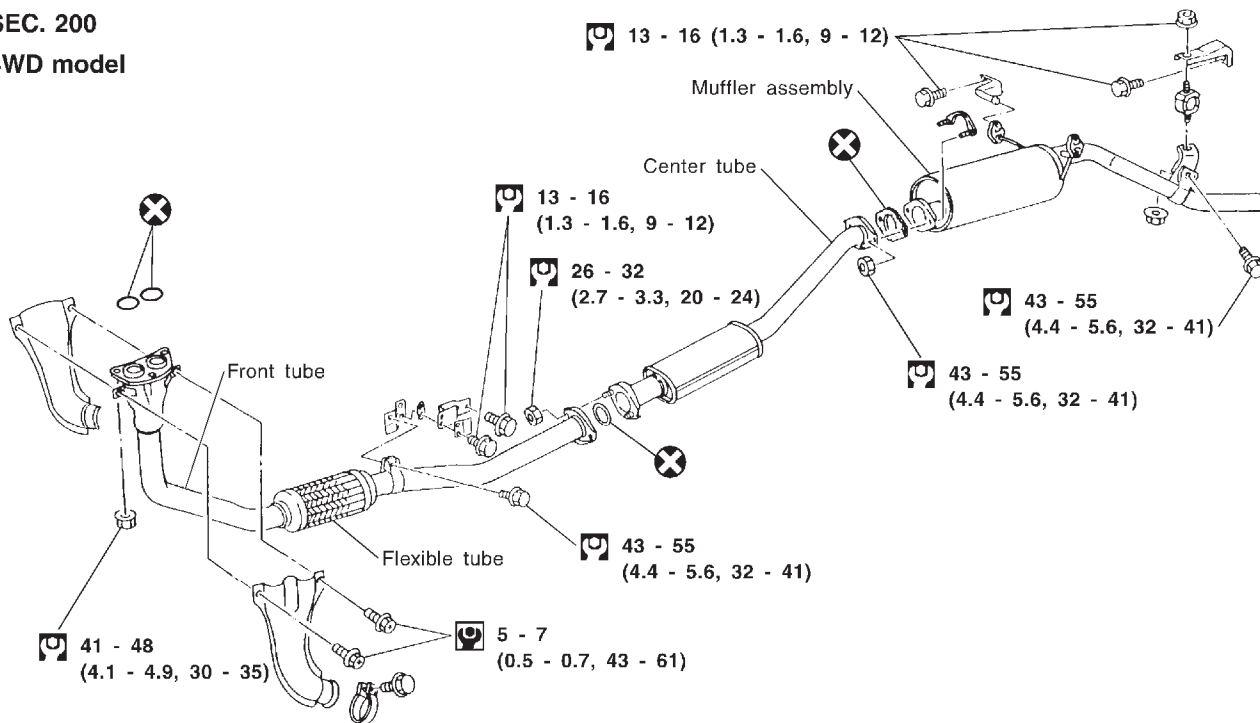

2WD model

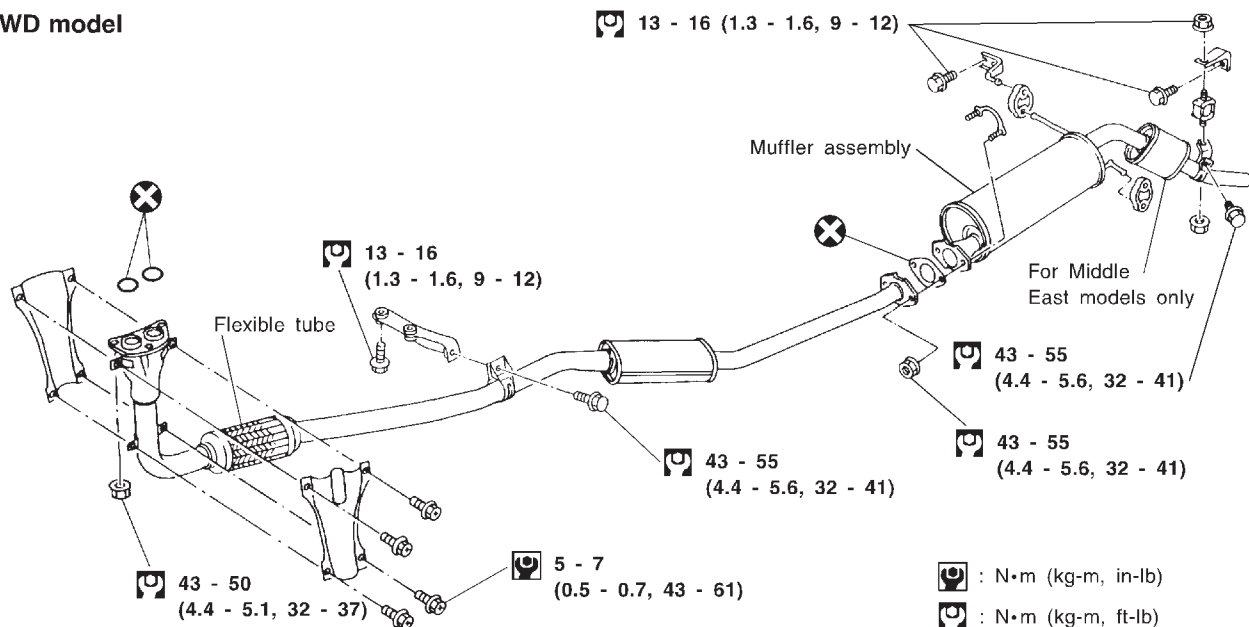

: N•m (kg-m, in-lb)
 : N•m (kg-m, ft-lb)

SFE455A