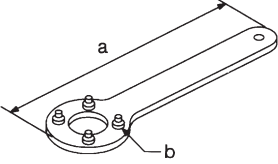
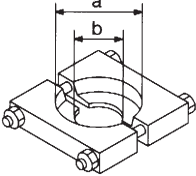
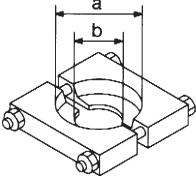
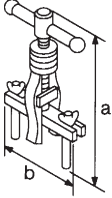
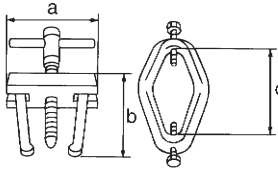
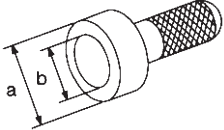
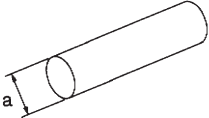

CONTENTS

PREPARATION	1	DISASSEMBLY	11
Special Service Tools	1	REPAIR FOR COMPONENT PARTS	16
Commercial Service Tools.....	2	Mainshaft.....	16
DESCRIPTION	3	Front Drive Shaft.....	18
Cross-sectional View	3	Counter Gear	19
ON-VEHICLE SERVICE	4	Main Gear	19
Replacing Oil Seal	4	Front Case	21
Position Switch Check	5	Front Case Cover	21
REMOVAL AND INSTALLATION	6	Bearing Retainer	22
Removal	6	Rear Case.....	22
Installation	6	Shift Control Components.....	23
TRANSFER GEAR CONTROL	7	ASSEMBLY	24
MAJOR OVERHAUL	8	SERVICE DATA AND SPECIFICATIONS (SDS) ...	30
Case Components	8	General Specifications	30
Gear Components.....	9	Inspection and Adjustment	30
Shift Control Components.....	10		

PREPARATION

Special Service Tools

Tool number Tool name	Description	
ST38060002 Flange wrench	NT428	 <p>a: 480 mm (18.90 in) b: Pitch dia.: 75 mm (2.95 in) Pin dia.: 10 mm (0.39 in)</p>
ST30021000 Puller	NT411	 <p>a: 110 mm (4.33 in) dia. b: 68 mm (2.68 in) dia.</p>
ST30031000 Puller	NT411	 <p>a: 90 mm (3.54 in) dia. b: 50 mm (1.97 in) dia.</p>
ST33290001 Puller	NT414	 <p>a: 250 mm (9.84 in) b: 160 mm (6.30 in)</p>
ST33051001 Puller	NT657	 <p>a: 135 mm (5.31 in) b: 100 mm (3.94 in) c: 130 mm (5.12 in)</p>
ST30720000 Drift	NT115	 <p>a: 77 mm (3.03 in) dia. b: 55.5 mm (2.185 in) dia.</p>
ST36710010 Drift	NT063	 <p>a: 34.5 mm (1.358 in) dia.</p>

PREPARATION

Special Service Tools (Cont'd)

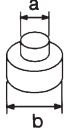
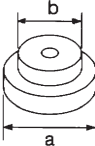
Tool number Tool name	Description
ST33061000 Drift	<div style="display: flex; justify-content: space-between;"> <div style="width: 30%;">  </div> <div style="width: 60%;"> <p>Removing main gear bearing</p> <p>a: 28.5 mm (1.122 in) dia. b: 38 mm (1.50 in) dia.</p> </div> </div>
ST30613000 Drift	<div style="display: flex; justify-content: space-between;"> <div style="width: 30%;">  </div> <div style="width: 60%;"> <p>Installing main gear bearing Installing cover oil seal</p> <p>a: 72 mm (2.83 in) dia. b: 48 mm (1.89 in) dia.</p> </div> </div>

Commercial Service Tools

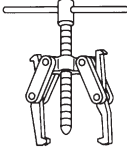
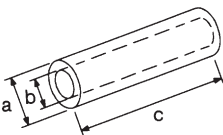
Tool name	Description
Puller	<div style="display: flex; justify-content: space-between;"> <div style="width: 30%;">  </div> <div style="width: 60%;"> <p>Removing front drive shaft front bearing Removing front drive shaft rear bearing Removing main gear bearing</p> </div> </div>
Drift	<div style="display: flex; justify-content: space-between;"> <div style="width: 30%;">  </div> <div style="width: 60%;"> <p>① Installing mainshaft rear bearing ② Installing L & H hub ③ Installing shift shaft oil seal</p> <p>① a: 50 mm (1.97 in) dia. b: 42 mm (1.65 in) dia. c: 180 mm (7.09 in)</p> <p>② a: 60 mm (2.36 in) dia. b: 50 mm (1.97 in) dia. c: 60 mm (2.36 in)</p> <p>③ a: 26 mm (1.02 in) dia. b: 20 mm (0.79 in) dia. c: 150 mm (5.91 in)</p> </div> </div>

DESCRIPTION

Cross-sectional View

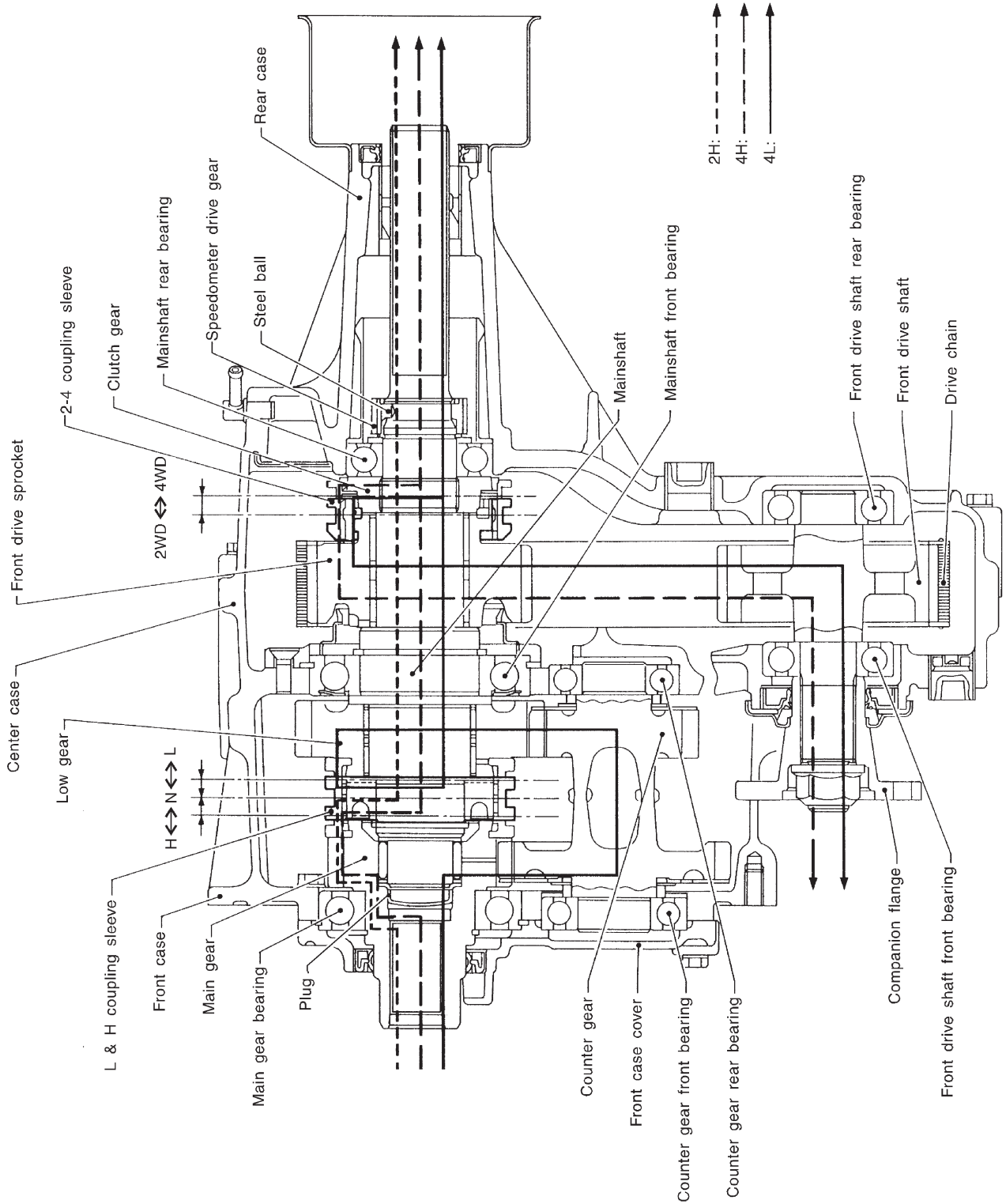

ON-VEHICLE SERVICE

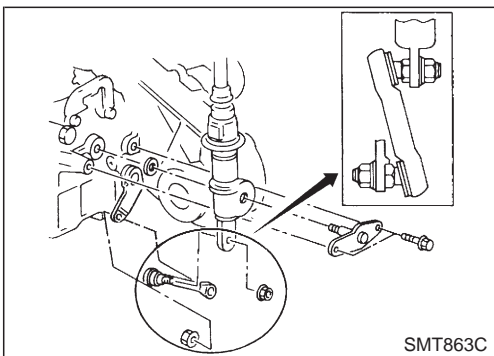
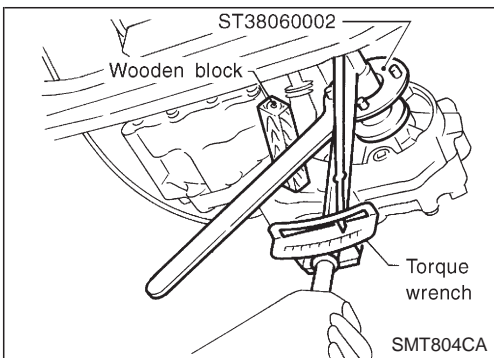
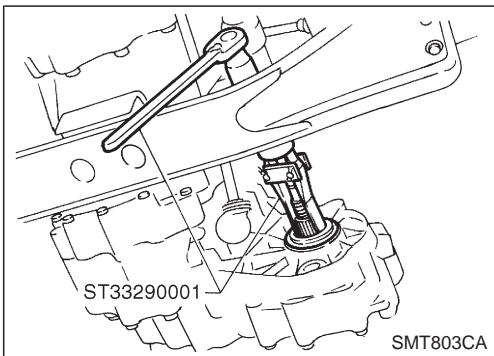
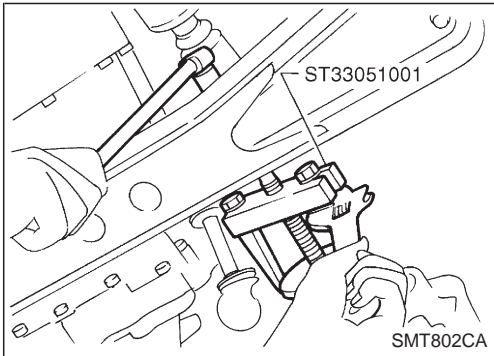
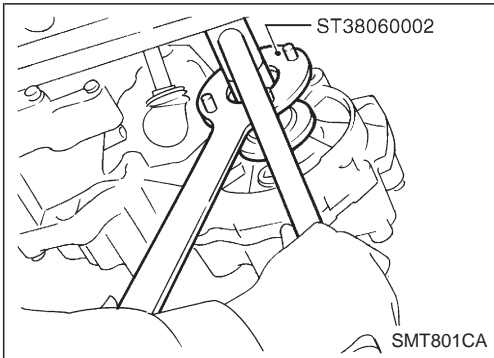

Replacing Oil Seal

CENTER CASE OIL SEAL

1. Remove exhaust front tube and heat insulator. Refer to "Removal", TF-6.
2. Remove front propeller shaft. Refer to PD section ("Removal and Installation", "PROPELLER SHAFT").
3. Remove companion flange nut.
4. Remove companion flange.
5. Remove center case oil seal.
6. Install center case oil seal.
 - **Before installing, apply multi-purpose grease to seal lip.**
7. Install companion flange.

8. Tighten nut to the specified torque.
9. Install front propeller shaft.

SHIFT SHAFT OIL SEAL

1. Remove front propeller shaft. Refer to PD section ("Removal and Installation", "PROPELLER SHAFT").
2. Remove companion flange. Refer to center case oil seal, TF-4.
3. Remove transfer control lever from transfer outer shift lever. Then remove outer shift lever.

ON-VEHICLE SERVICE

Replacing Oil Seal (Cont'd)

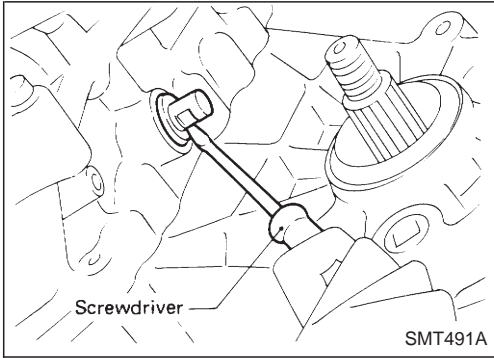

4. Remove shift shaft oil seal.
 - **Be careful not to damage cross shaft.**

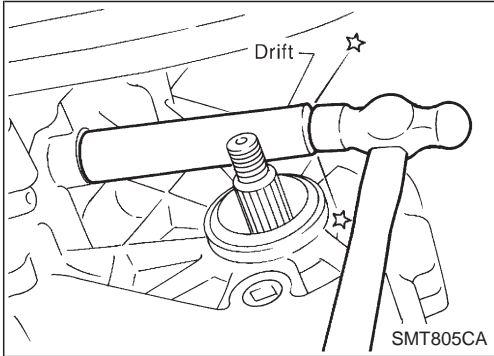

5. Install shift shaft oil seal.
 - **Before installing, apply multi-purpose grease to seal lip.**
6. Install transfer control linkage.
7. Install companion flange. Refer to center case oil seal, TF-4.
8. Install front propeller shaft.

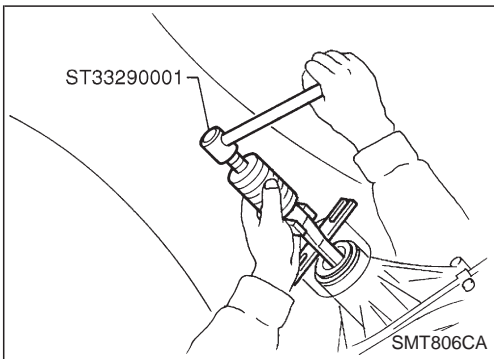

REAR OIL SEAL

1. Remove rear propeller shaft. Refer to PD section ("Removal and Installation", "PROPELLER SHAFT").
2. Remove rear oil seal.

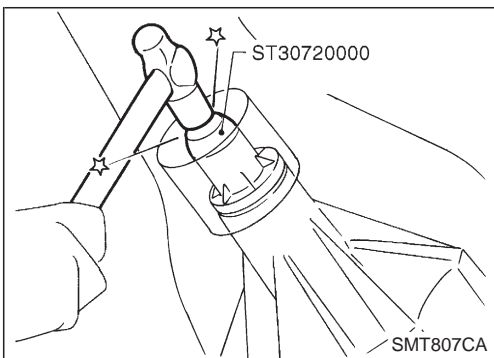

3. Install rear oil seal.
 - **Before installing apply multi-purpose grease to seal lip.**
4. Install rear propeller shaft.

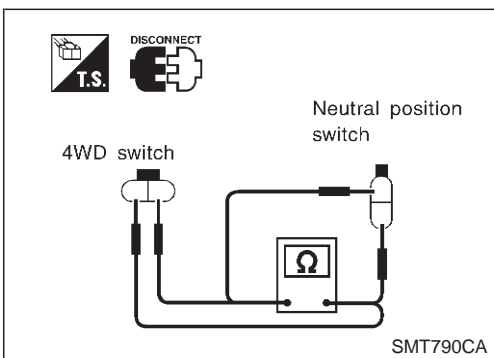

Position Switch Check

Switch	Gear position	Continuity
4WD switch	4WD	Yes
	Except 4WD	No
Neutral position switch	Neutral	Yes
	Except neutral	No

REMOVAL AND INSTALLATION

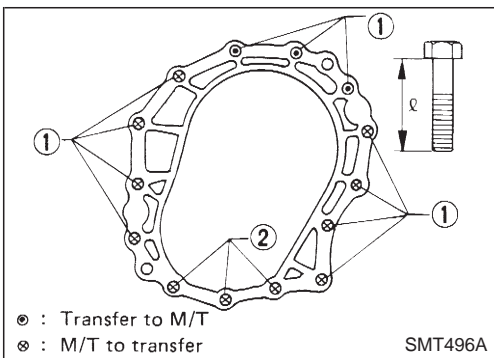
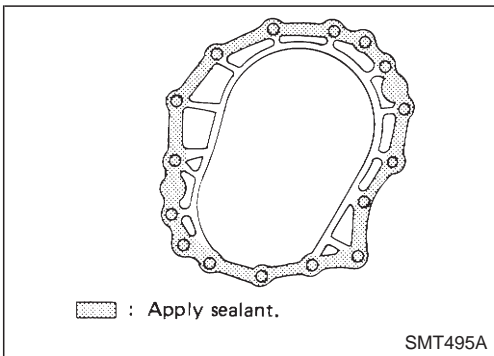
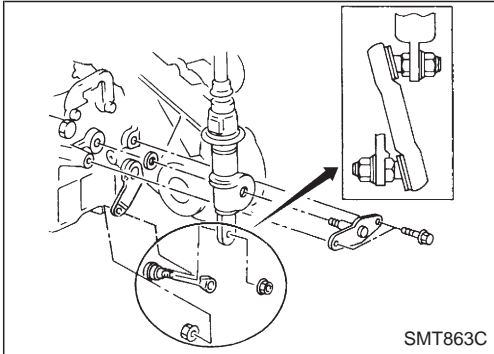
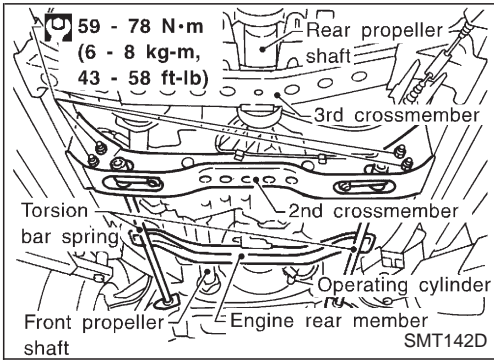

Removal

1. Drain oil from transfer and transmission.
2. Remove front and rear propeller shaft. Refer to PD section ("Removal and Installation", "PROPELLER SHAFT"). Insert plug into rear oil seal after removing propeller shaft.
3. Remove torsion bar spring. Refer to FA section ("Torsion Bar Spring", "FRONT SUSPENSION"). Then remove second crossmember.
4. Disconnect 4WD and neutral position switches.
5. Remove transfer control lever from transfer outer shift lever.
6. Separate transfer from transmission.

WARNING:

Support transfer while removing it.

Installation

- Apply recommended sealant to mating surface to transmission.

Recommended sealant:

Nissan genuine part KP610-00250, Three Bond 1215 or equivalent

- Tighten bolts securing transfer.

Bolt No.	Tightening torque (kg-m, ft-lb)	ℓ mm (in)
①	31 - 41 (3.2 - 4.2, 23 - 30)	45 (1.77)
②	31 - 41 (3.2 - 4.2, 23 - 30)	60 (2.36)

TRANSFER GEAR CONTROL

SEC. 333

: N•m (kg-m, in-lb)

: N•m (kg-m, ft-lb)

1 : Fill multi-purpose grease up.

2 : Apply multi-purpose grease.

*1 : Securely bend pawls during assembly.
Be careful not to damage boot.

*2 : Do not touch boot with a sharp-pointed
or a hard tool as it breaks easily.

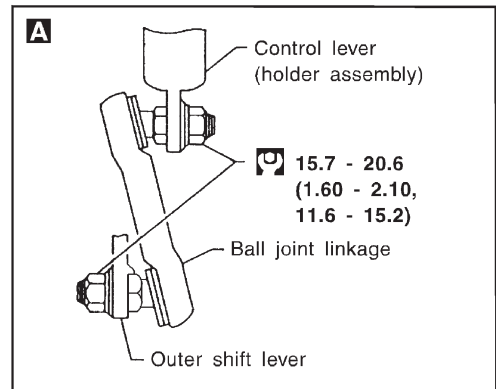
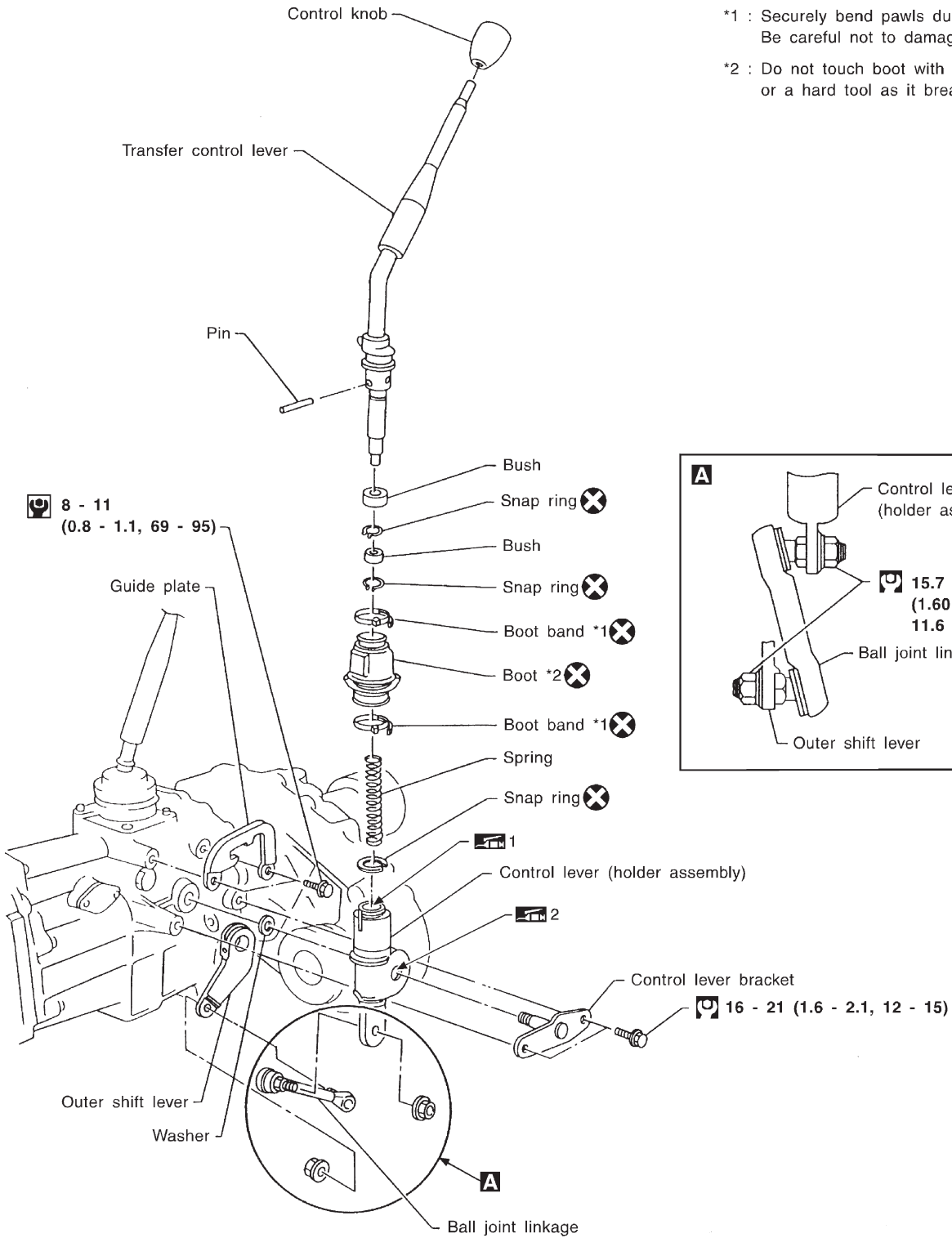

MAJOR OVERHAUL

Gear Components

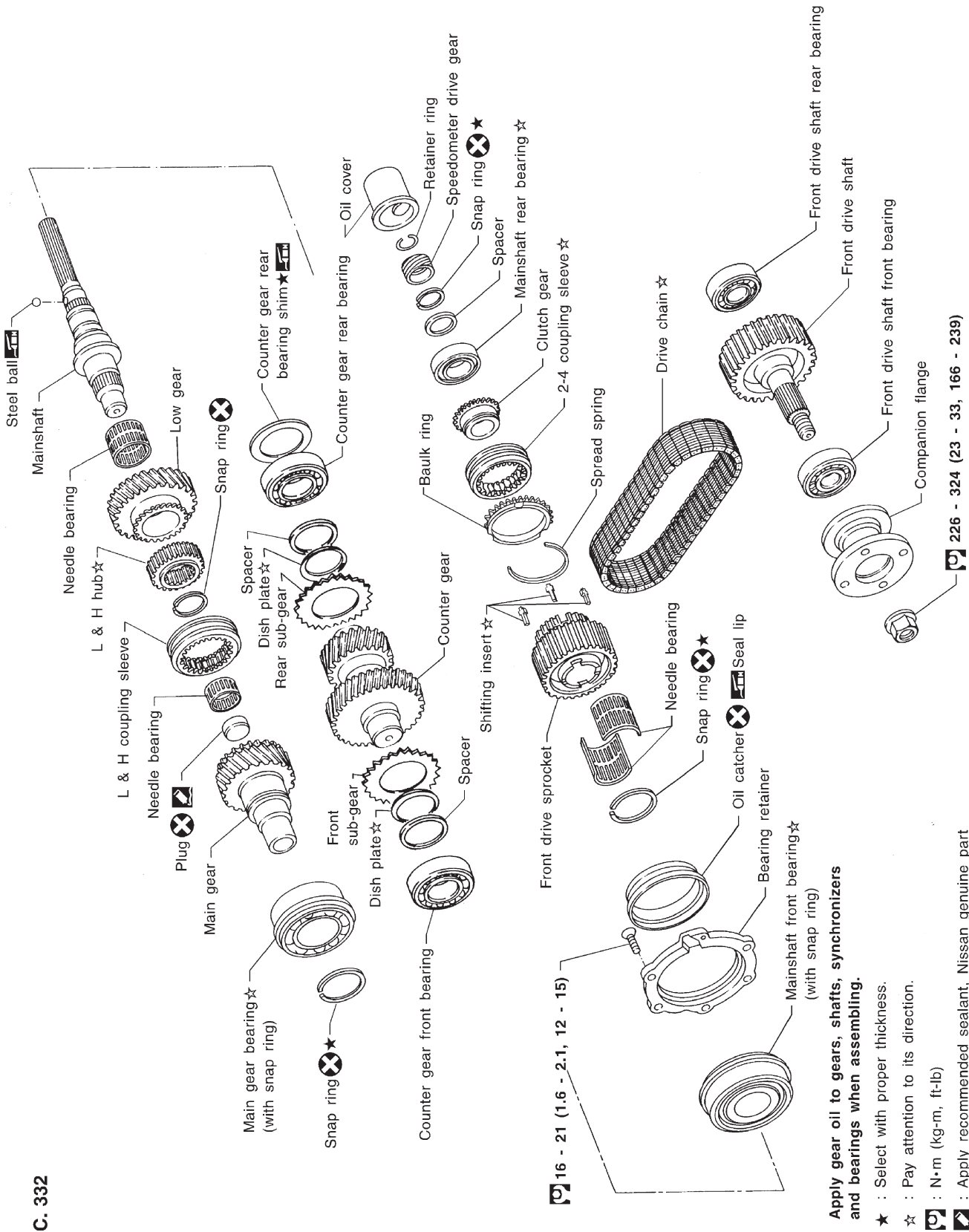

SEC. 332

16 - 21 (1.6 - 2.1, 12 - 15)

Apply gear oil to gears, shafts, synchronizers and bearings when assembling.

- ★ : Select with proper thickness.
- ☆ : Pay attention to its direction.
- ☒ : N-m (kg-m, ft-lb)
- ☑ : Apply recommended sealant, Nissan genuine part KP610-00250, Three Bond 1215 or equivalent.

226 - 324 (23 - 33, 166 - 239)

MAJOR OVERHAUL

Shift Control Components

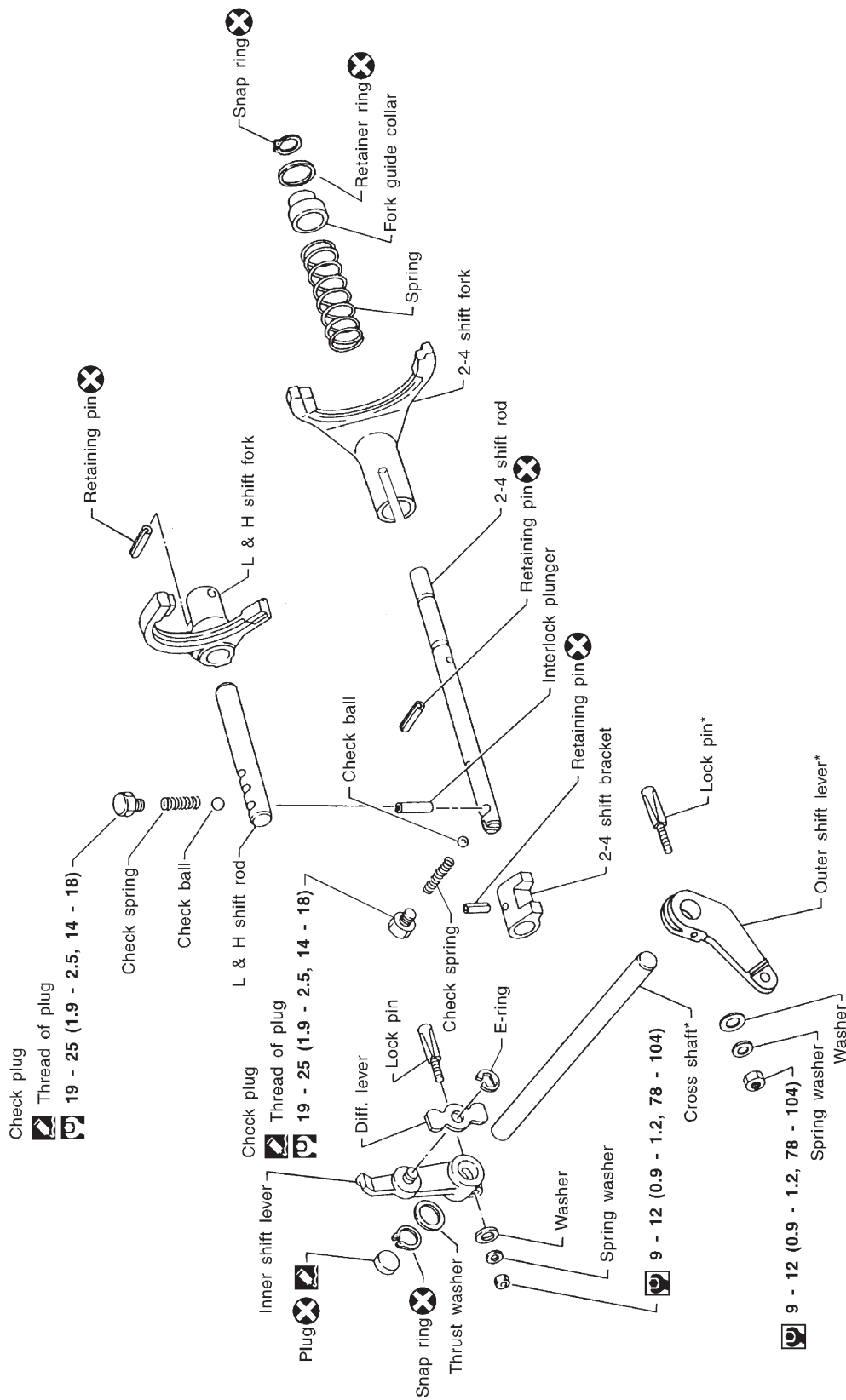

* : If these parts require to be replaced, replace them as a set.

: N•m (kg-m, in-lb)

: N•m (kg-m, ft-lb)

: Apply recommended sealant.

: Nissan genuine part KP610-00250, Three Bond 1215 or equivalent.

DISASSEMBLY

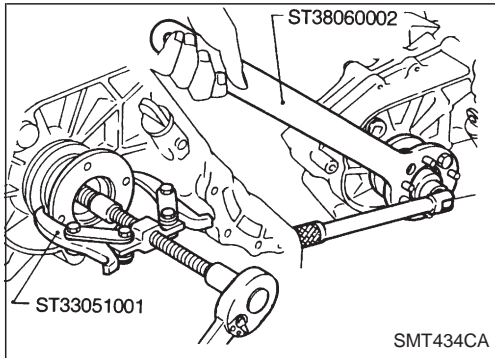

1. Remove nut of companion flange.
2. Remove companion flange.

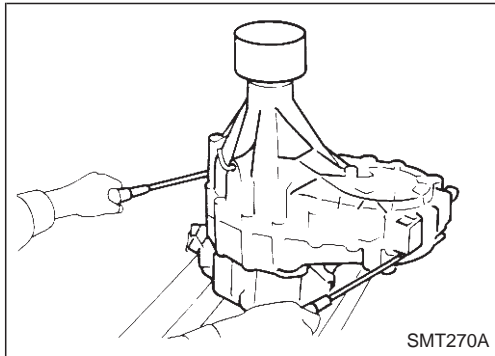

3. Remove 4WD switch.
4. Remove rear case.
 - Be careful not to damage the mating surface.

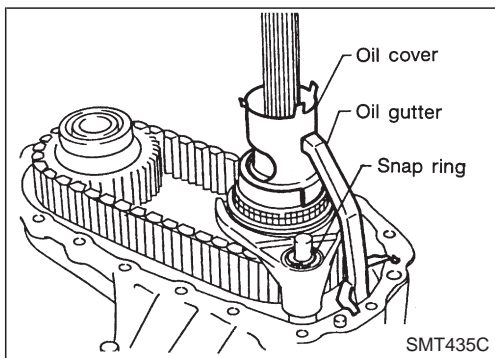

5. Remove oil cover and oil gutter.
6. Remove snap ring and retainer ring from 2-4 shift rod.

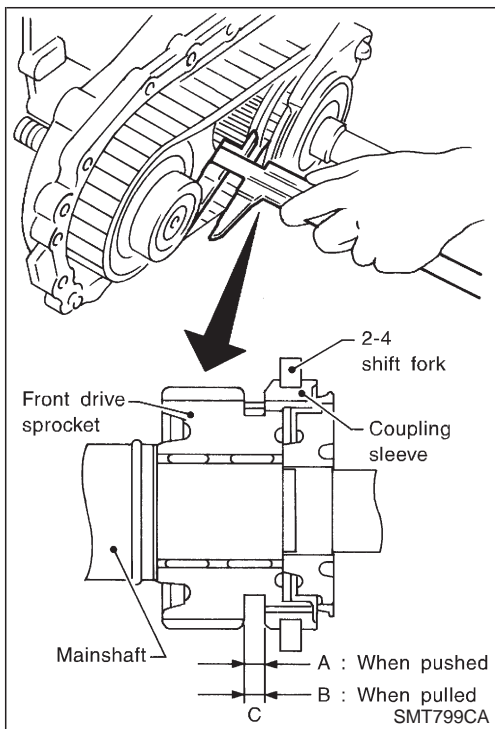

7. Using calipers, measure the difference between front drive sprocket and 2-4 coupling sleeve as outlined under Measuring method below. If it is outside specifications, check front drive sprocket, 2-4 coupling sleeve, clutch gear, 2-4 shift fork and 2-4 fork rod for abnormalities. Replace faulty part(s) as required.

Measuring method

- a. Move coupling sleeve until it is in contact with sprocket, then measure dimension A. Move coupling sleeve until it is in contact with clutch gear, then measure dimension B. Obtain dimensional difference C between two measurements A and B.

$$C = A - B$$

- b. To determine dimension A, measure at 3 or 4 different points by rotating sprocket and obtain average value of 3 or 4 measurements.

Specification C:

Refer to TF-30.

DISASSEMBLY

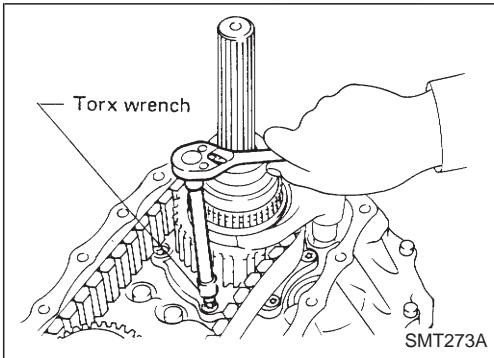

8. Remove bolts securing bearing retainer.
 - **This step is necessary to remove mainshaft from center case.**

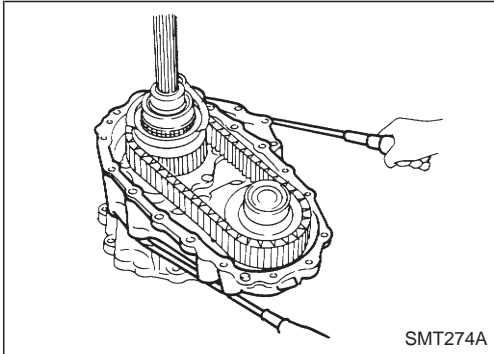

9. Remove bolts securing center case to front case and then separate center case and front case.

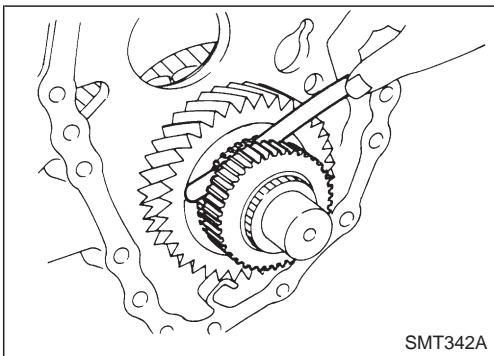

10. Measure end play of low gear.

Standard:

0.2 - 0.35 mm (0.0079 - 0.0138 in)

- **If end play is beyond the maximum value, check low gear and L & H hub for wear.**

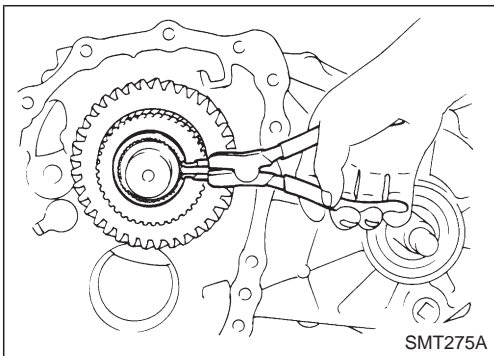

11. Disassemble center case assembly.

- a. Remove snap ring from mainshaft.

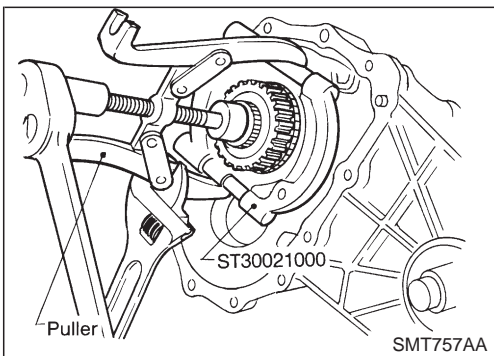

- b. Pull out low gear with L & H hub.

DISASSEMBLY

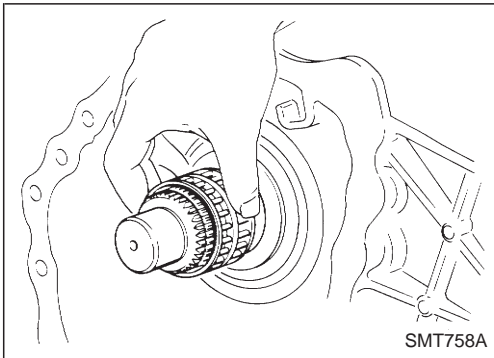

c. Remove needle bearing of low gear.

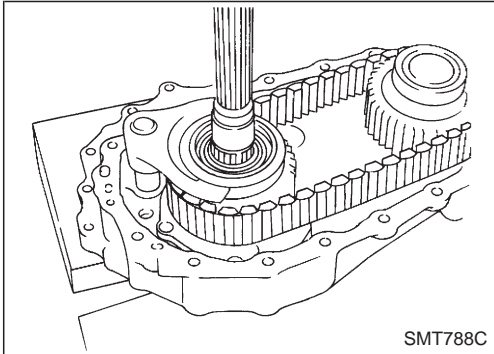

d. Make sure of the direction of the drive chain before removing it. (It must be reinstalled in the same direction.)

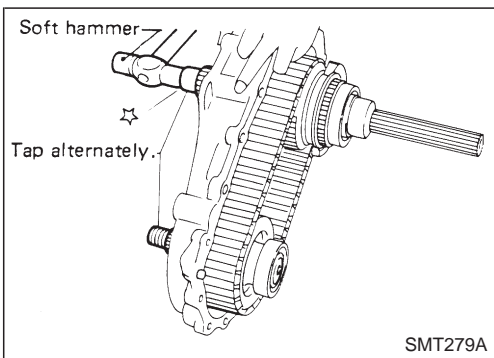

e. Remove mainshaft, front drive and drive chain as a set by tapping front end of mainshaft and front drive shaft alternately.

● **Be careful not to bend drive chain.**

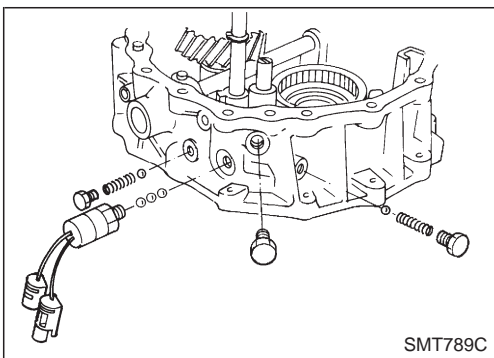

12. Disassemble front case assembly.

a. Remove switch, plugs, check springs and check balls.

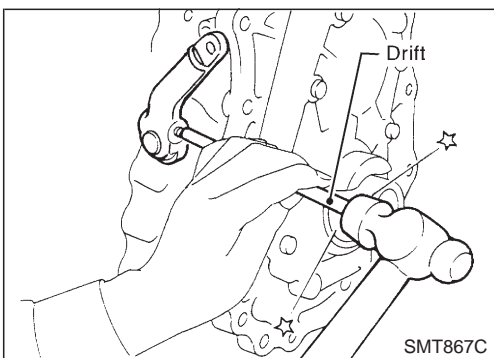

b. Remove outer shift lever.

DISASSEMBLY

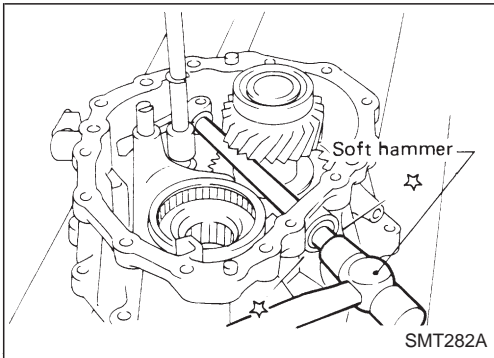

- c. Remove lock pin of inner shift lever and drive out cross shaft with plug.

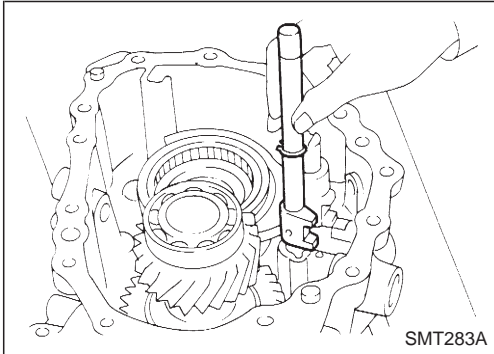

- d. Remove 2-4 shift rod.

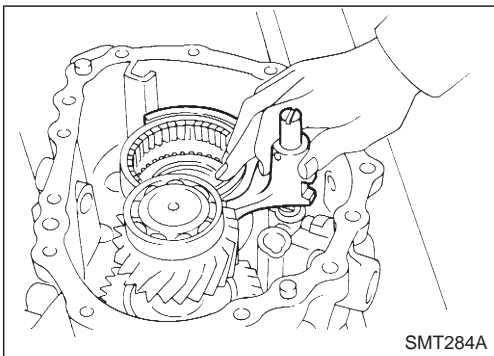

- e. Remove L & H shift rod and fork assembly with coupling sleeve.

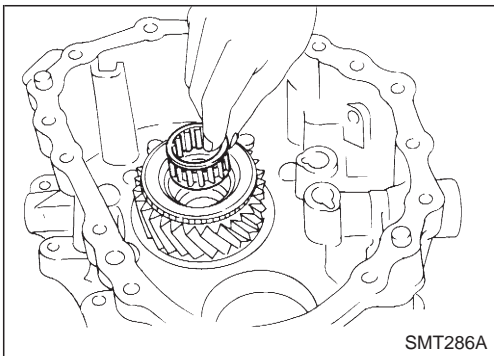

- f. Remove needle bearing from main gear.

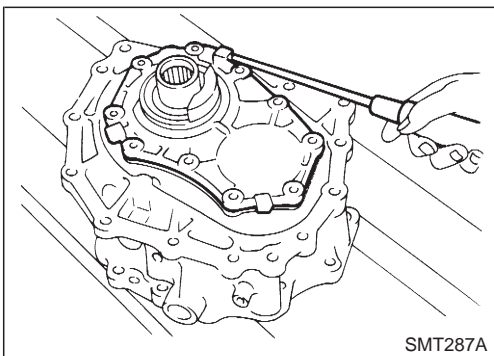

- g. Remove bolts securing front case cover and then remove case.

DISASSEMBLY

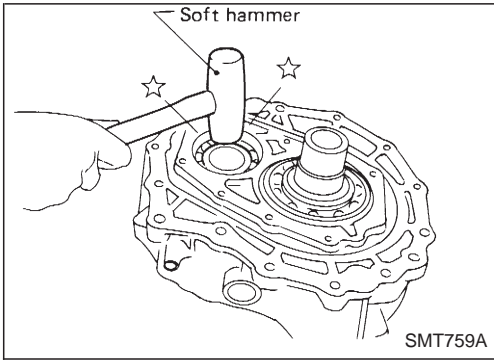

h. Remove counter gear by tapping lightly.

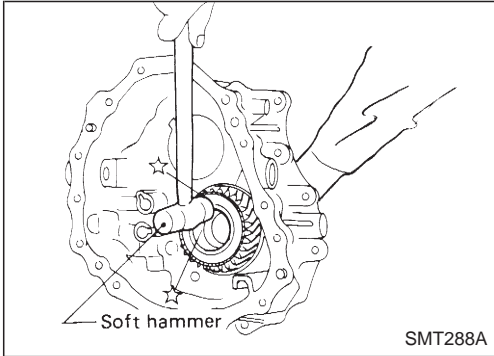

i. Remove main gear by tapping lightly.

REPAIR FOR COMPONENT PARTS

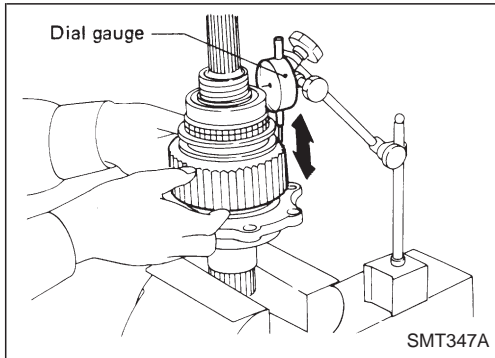

Mainshaft

DISASSEMBLY

1. Check end play of front drive sprocket.

Standard:

0.2 - 0.35 mm (0.0079 - 0.0138 in)

- If end play is beyond the maximum value, check front drive sprocket and clutch gear for wear.

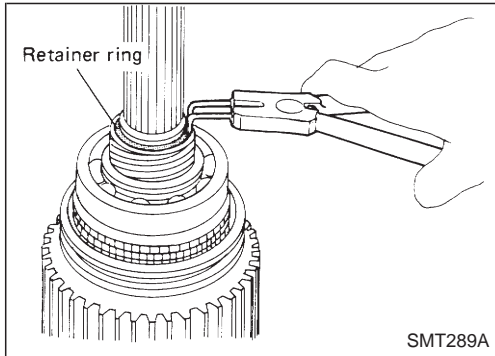

2. Remove retainer ring, speedometer drive gear and steel ball.
- **Be careful not to lose the steel ball.**

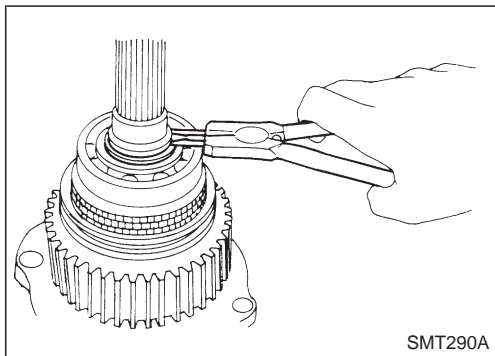

3. Remove snap ring and spacer.

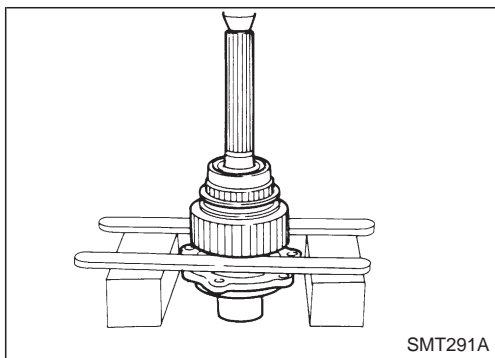

4. Press out front drive sprocket with mainshaft rear bearing and clutch gear together.
5. Remove needle bearing.

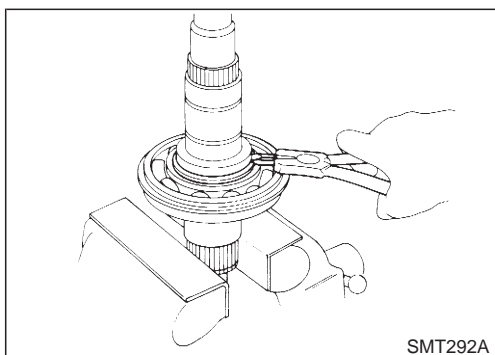

6. Remove bearing retainer and then remove snap ring and spacer.

REPAIR FOR COMPONENT PARTS

Mainshaft (Cont'd)

7. Press out mainshaft front bearing from mainshaft.

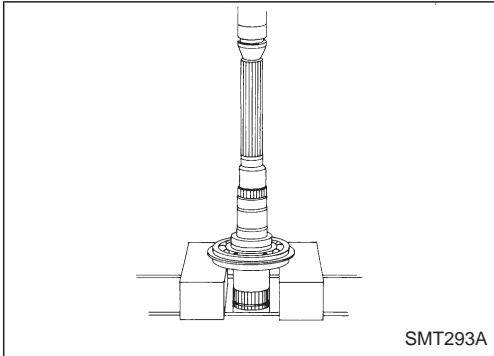

INSPECTION

Gear and shaft

- Check gears for excessive wear, chips or cracks.
- Check shaft for cracks, wear or bending.
- Check coupling sleeve for wear or damage.

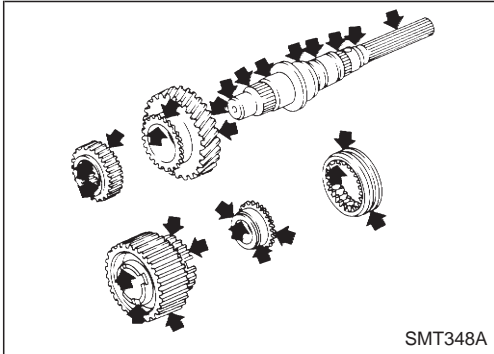

Bearing

- Make sure bearings roll freely and are free from noise, crack, pitting or wear.

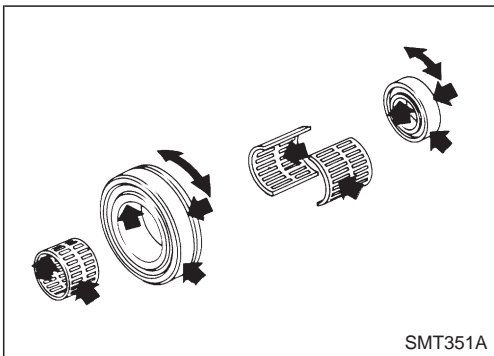

Baulk ring

- Check baulk ring for cracks or deformation.

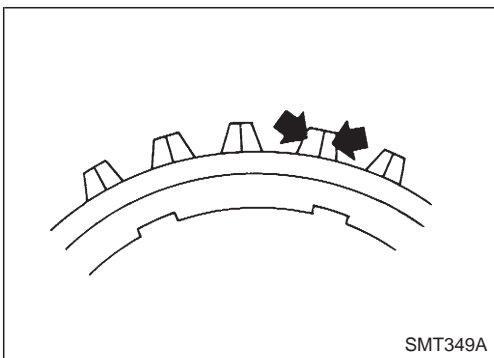

- Measure clearance between baulk ring and clutch gear.
Clearance between baulk ring and clutch gear:
Refer to SDS, TF-30.

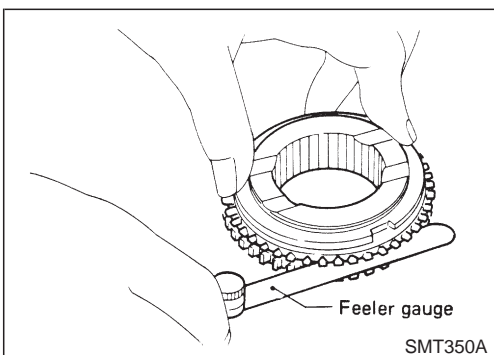

REPAIR FOR COMPONENT PARTS

Mainshaft (Cont'd)

ASSEMBLY

1. Press mainshaft front bearing onto mainshaft.
 - Pay special attention to its direction.

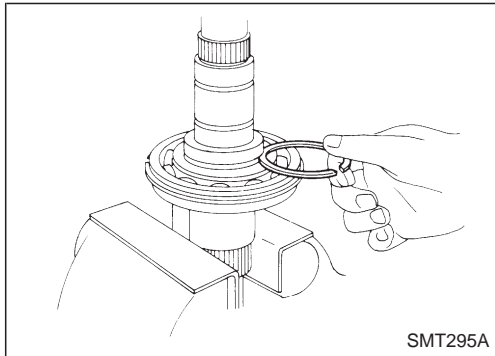
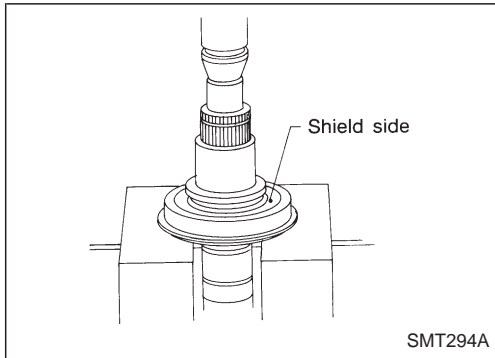

2. Install spacer.
3. Select snap ring with proper thickness and install it.
 - Allowable clearance between snap ring and groove:**
0 - 0.15 mm (0 - 0.0059 in)
 - Available snap ring for mainshaft front bearing:**
Refer to SDS, TF-30.
4. Regarding to further procedures, refer to "ASSEMBLY", TF-24.

Front Drive Shaft

DISASSEMBLY

- Front drive shaft front bearing and rear bearing

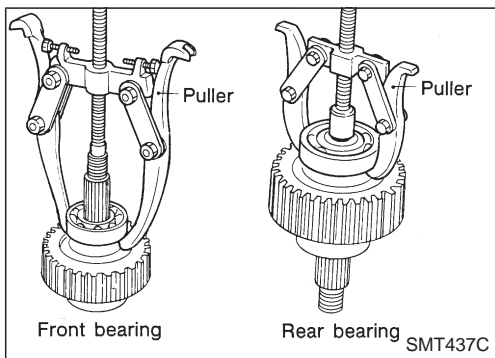

INSPECTION

Sprocket and shaft

- Check sprocket for excessive wear, chips or cracks.
- Check shaft for cracks or wear.

Bearing

- Make sure bearings roll freely and are free from noise, crack, pitting or wear.

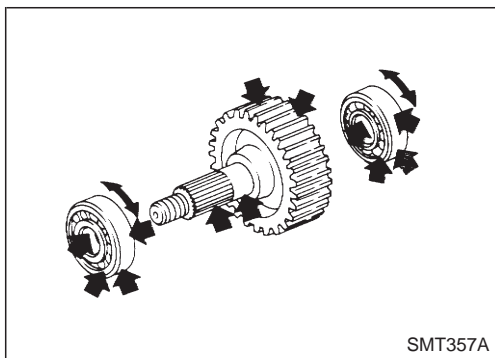

ASSEMBLY

- Press front drive shaft front bearing and rear bearing.

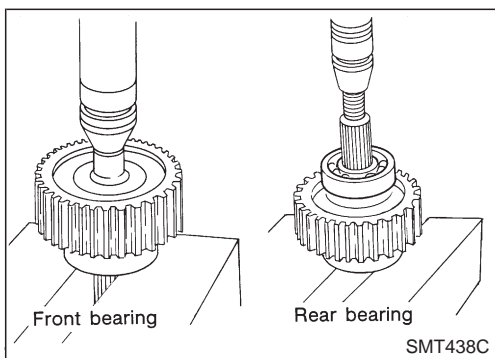

REPAIR FOR COMPONENT PARTS

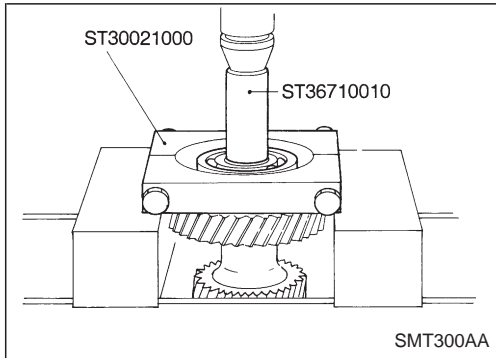

Counter Gear

DISASSEMBLY

1. Press out counter gear front bearing.
 - Remove front sub-gear, spacer and dish plate.

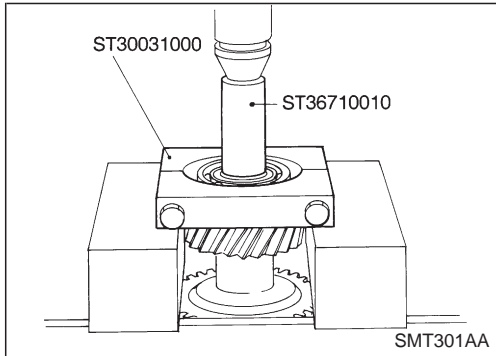

2. Press out counter gear rear bearing and then remove rear sub-gear, spacer and dish plate.

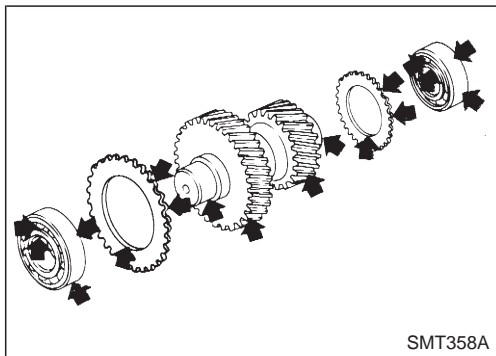

INSPECTION

Gear and shaft

- Check gears for excessive wear, chips or cracks.
- Check shaft for cracks or wear.

Bearing

- Make sure bearings roll freely and are free from noise, crack, pitting or wear.

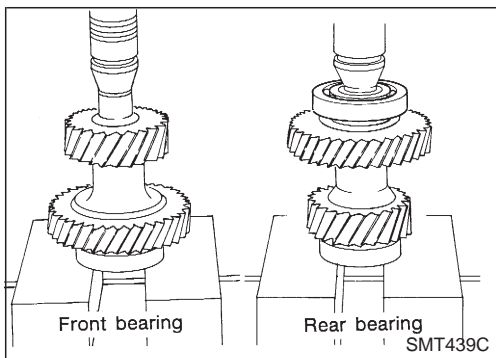

ASSEMBLY

1. Install front sub-gear, dish plate and spacer.
 - Press on counter gear front bearing.
2. Install rear sub-gear, dish plate and spacer, and then press on counter gear rear bearing.

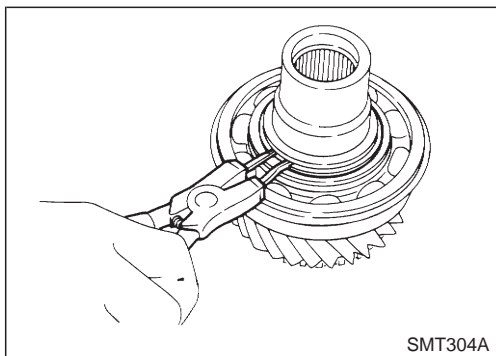

Main Gear

DISASSEMBLY

Main gear bearing

1. Remove snap ring.

REPAIR FOR COMPONENT PARTS

Main Gear (Cont'd)

2. Pull out main gear bearing.

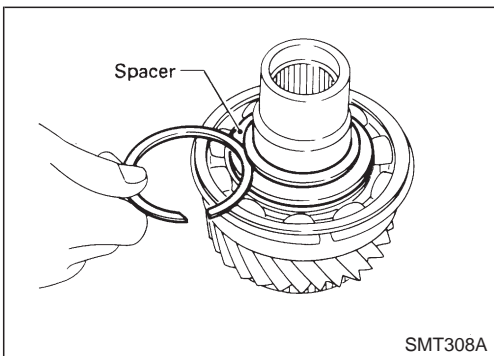
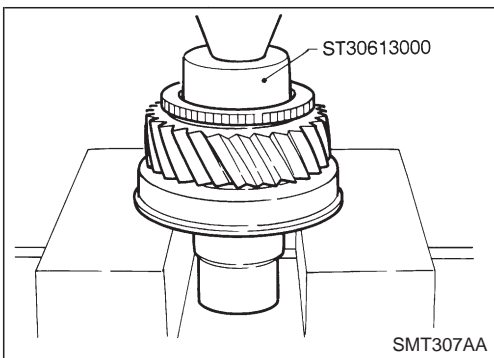
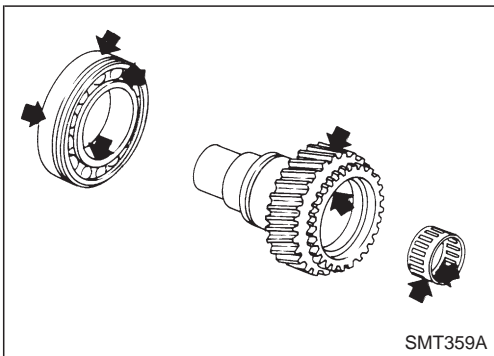
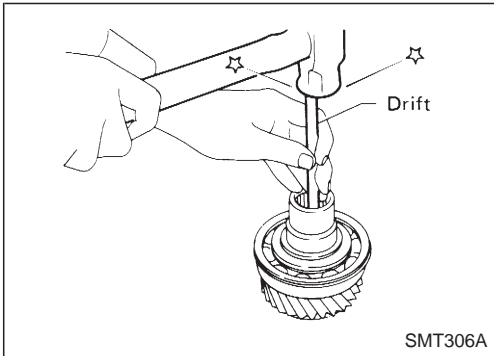
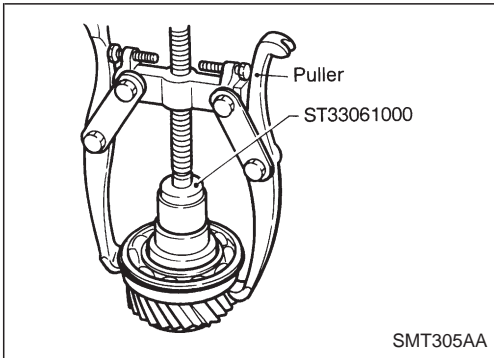

Plug

- Always replace it with new one whenever it is removed.

INSPECTION

Gear and shaft

- Check gears for excessive wear, chips or cracks.
- Check shaft for cracks or wear.

Bearing

- Make sure bearings roll freely and are free from noise, crack, pitting or wear.

ASSEMBLY

Main gear bearing

1. Press on main gear bearing.

2. Select snap ring with proper thickness and install it.
Allowable clearance between snap ring and groove:
0 - 0.15 mm (0 - 0.0059 in)
Available snap ring for main gear bearing:
Refer to SDS, TF-30.

REPAIR FOR COMPONENT PARTS

Main Gear (Cont'd)

Plug

- Apply sealant to plug and install it.

Sealant:

Refer to "Gear Components", TF-9.

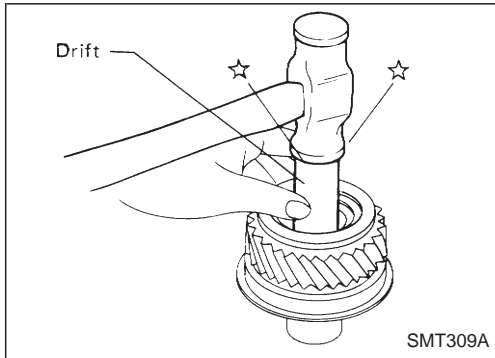

Front Case

SHIFT SHAFT OIL SEAL

Removal

- Use a screwdriver to pry out old seal.
- Be careful not to damage case.
- Always replace with a new one whenever it has been removed.

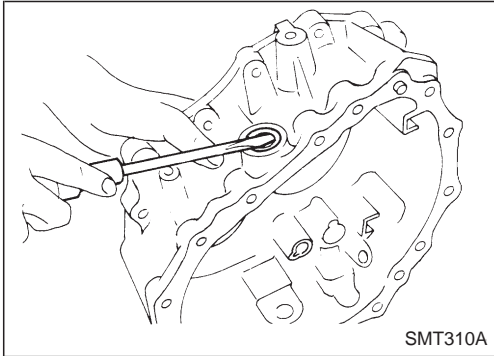

Installation

- Install new shift shaft oil seal until flush with case.
- Before installing, apply multi-purpose grease to seal lip.

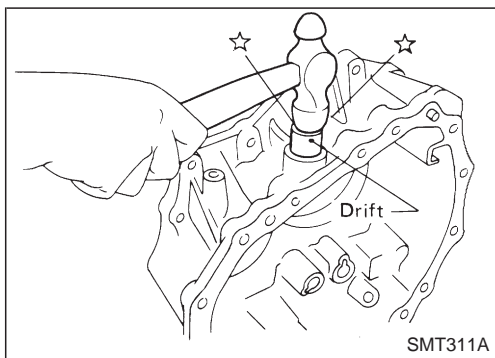

Front Case Cover

COVER OIL SEAL

Removal

- Drive out old seal from inside of front case cover.
- Be careful not to damage front case cover.

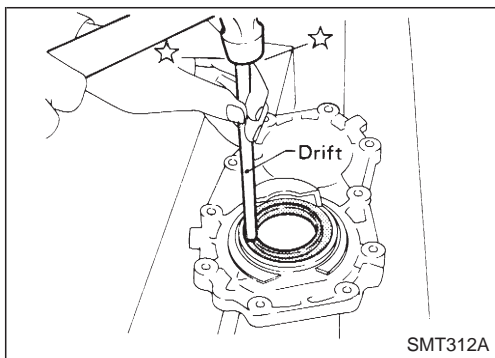

Installation

- Install new front case cover oil seal until it stops.
- Before installing, apply multi-purpose grease to seal lip.

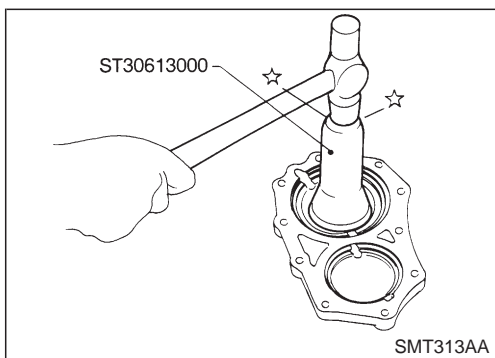

REPAIR FOR COMPONENT PARTS

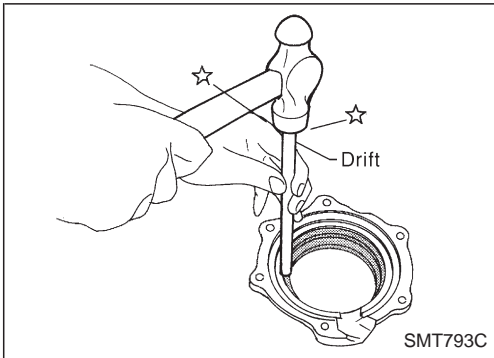

Bearing Retainer

OIL CATCHER

Removal

- Drive out oil catcher from inside of bearing retainer.
- Be careful not to damage bearing retainer.

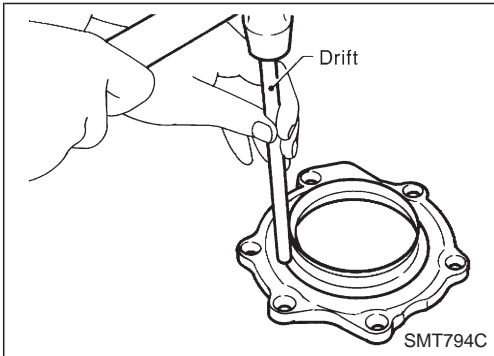

Installation

- Install oil catcher until it stops.
- Be careful not to damage or distort oil catcher or bearing retainer.
- Before installing, apply multi-purpose grease to seal lip.

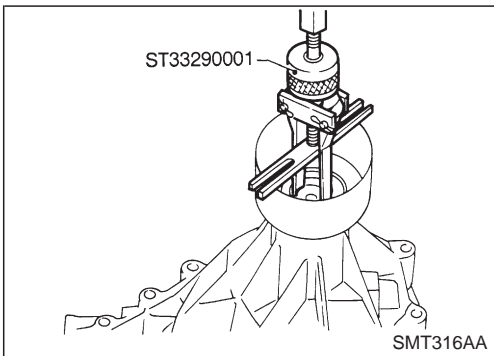

Rear Case

REAR OIL SEAL

Removal

- Pull out rear oil seal.

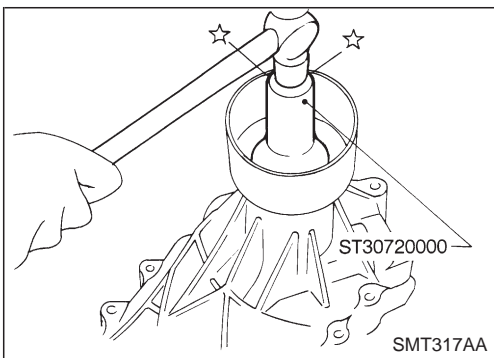

Installation

- Install new rear oil seal until it stops.
- Before installing, apply multi-purpose grease to seal lip.

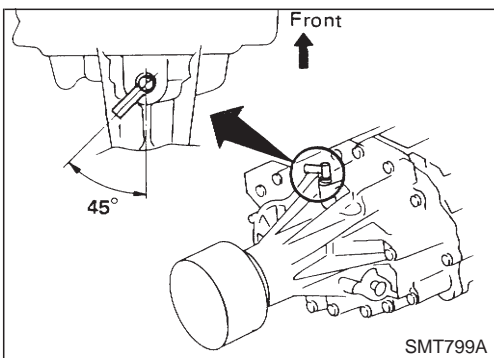

AIR BREATHER

- Install as shown in illustration.

Apply locking sealant:

Refer to "Case Components", TF-8.

REPAIR FOR COMPONENT PARTS

Shift Control Components

INSPECTION

- Check contact surface and sliding surface for wear, scratches, projections or other faulty conditions.

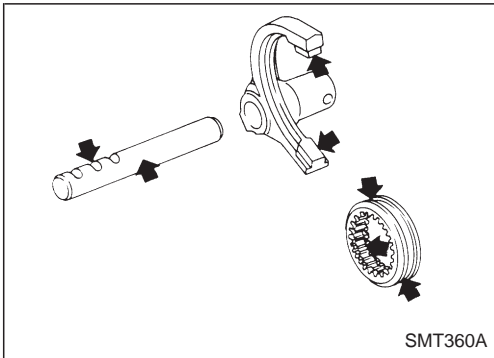

L & H SHIFT ROD & FORK

- Assemble as shown in illustration.

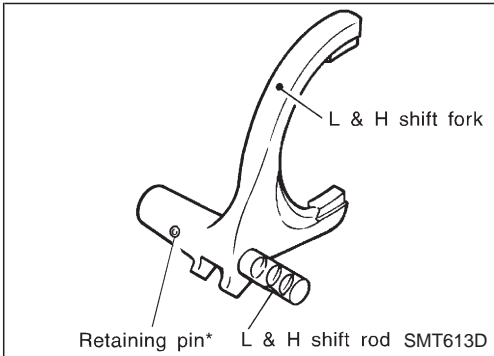

* Retaining pin is the same size as the one for 2-4 shift rod.

2-4 SHIFT ROD & FORK

- Assemble as shown in illustration.

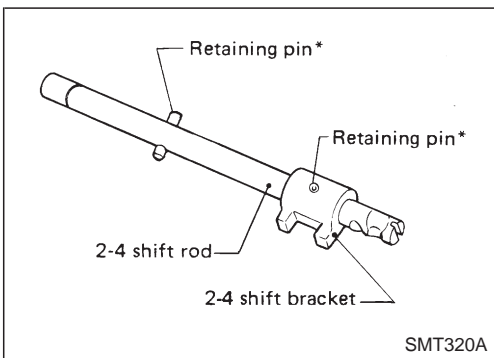

* Retaining pins are the same size.

- Pay special attention to the direction of fork guide collar.

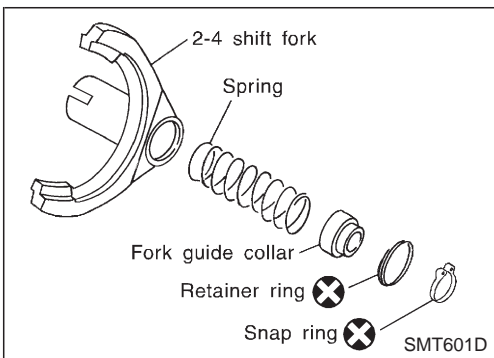

ASSEMBLY

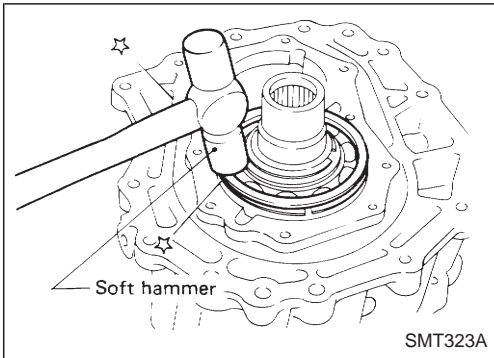

1. Assemble front case.
 - a. Install main gear assembly by tapping lightly.

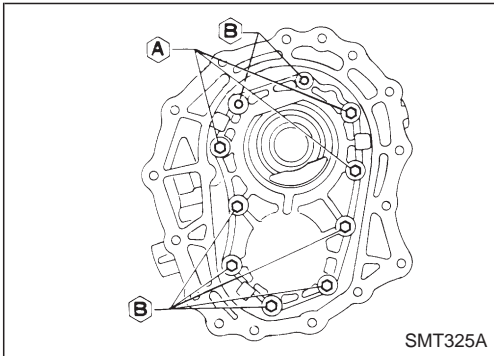

- b. Apply sealant to the mating surface and bolts of front case cover and install it on front case.

Sealant:

Refer to “Case Components”, TF-8.

- These ten bolts should be coated with sealant.
- Tightening torque
 - A : 16 - 21
(1.6 - 2.1 kg-m, 12 - 15 ft-lb)
 - B : 19 - 24
(1.9 - 2.4 kg-m, 14 - 17 ft-lb)

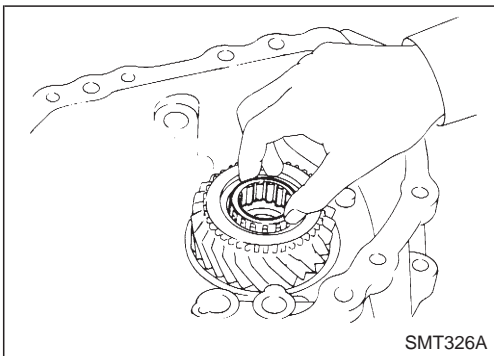

- c. Apply gear oil to needle bearing and install it into main gear.

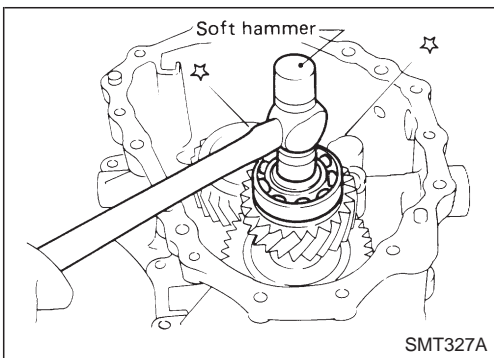

- d. Install counter gear assembly by tapping lightly.

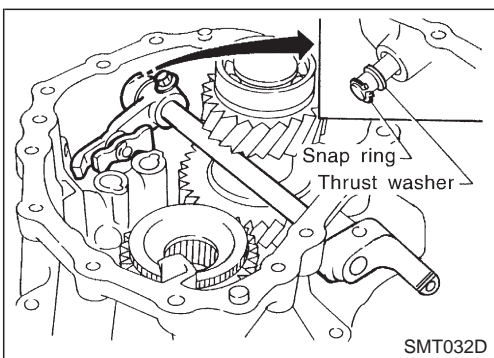

- e. Install cross shaft and inner shift lever.
 - When replacing cross shaft, outer shift lever or lock pin of outer shift lever, replace them as a set.

ASSEMBLY

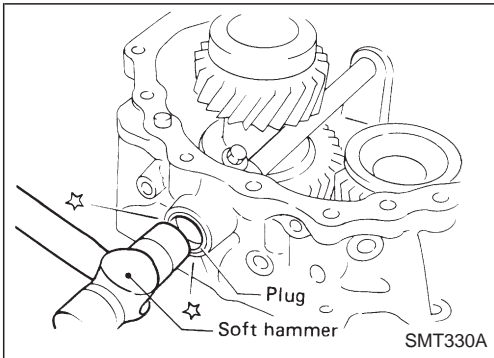

- f. Apply sealant to plug and install it into front case.
Sealant:
Refer to “Shift Control Components”, TF-10.

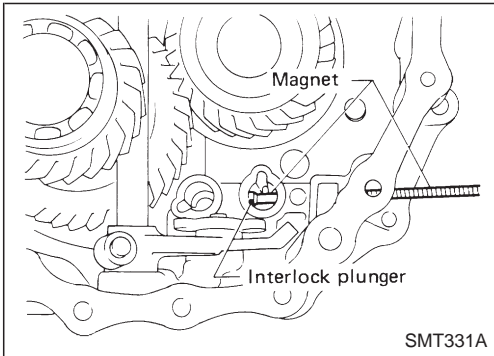

- g. Insert interlock plunger into front case.

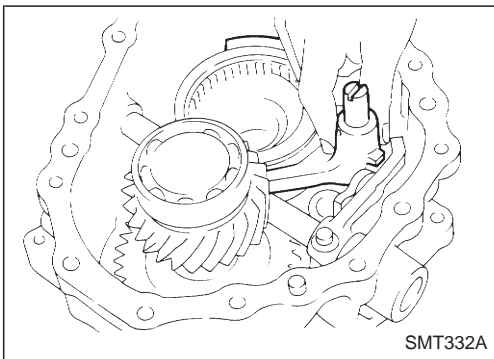

- h. Install L & H shift rod and fork assembly with coupling sleeve.

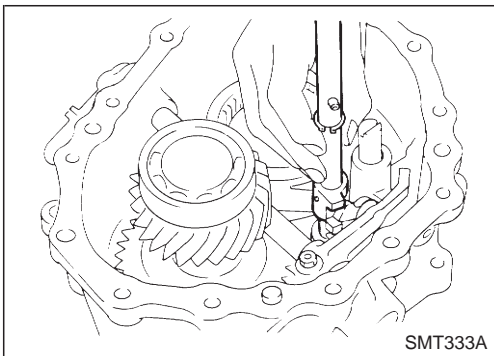

- i. Install 2-4 shift rod.

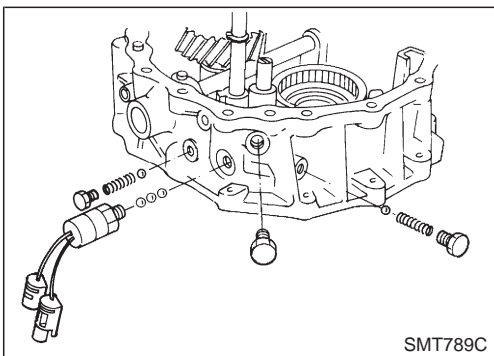

- j. Install switches, check balls, check springs and plugs.
● **Apply sealant to switches and plugs.**
Sealant:
Refer to “Case Components”, TF-8.

ASSEMBLY

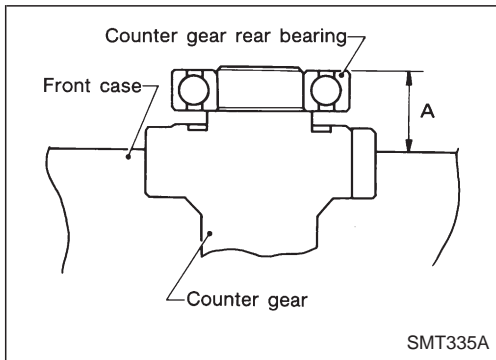

2. Select counter gear rear bearing shim.

Counter gear end play:

0 - 0.2 mm (0 - 0.008 in)

Counter gear rear bearing shim:

Refer to SDS, TF-30.

- a. Measure distance "A" between upper surface of counter gear rear bearing and mating surface of front case.

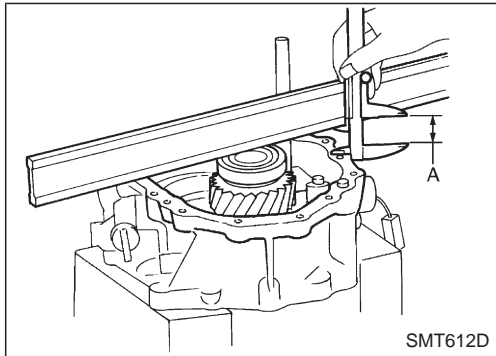

- b. Select suitable shim using SDS chart. Refer to SDS, TF-30.

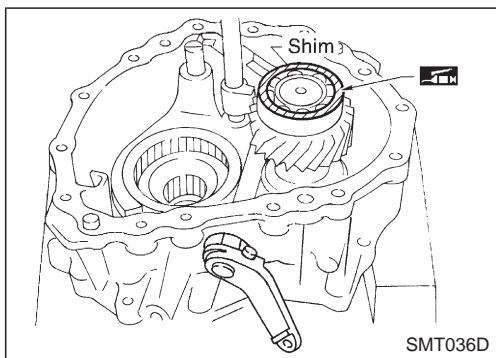

3. Place suitable shim on counter gear rear bearing with grease.
4. Apply gear oil to each part in front case.

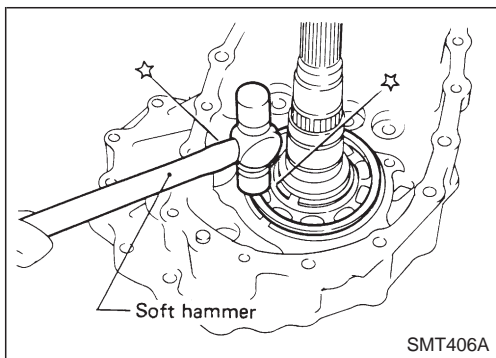

5. Assemble center case assembly.
 - a. Install mainshaft on center case by tapping lightly.
 - **Apply gear oil to mainshaft front bearing.**

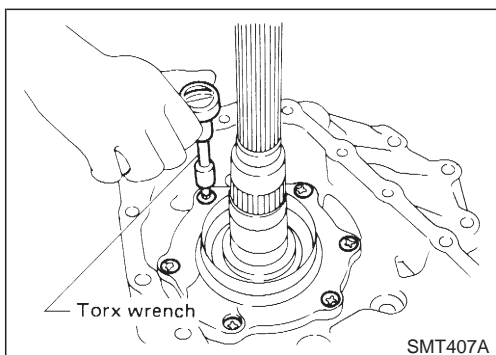

- b. Install bearing retainer.

ASSEMBLY

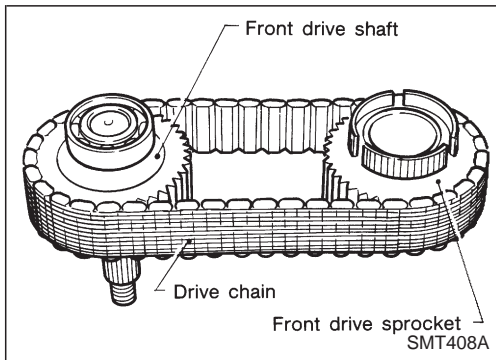

- c. Put drive chain onto the front drive sprocket and front drive shaft, and then put them in center case.

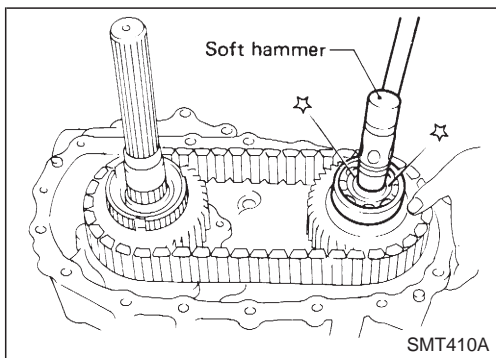
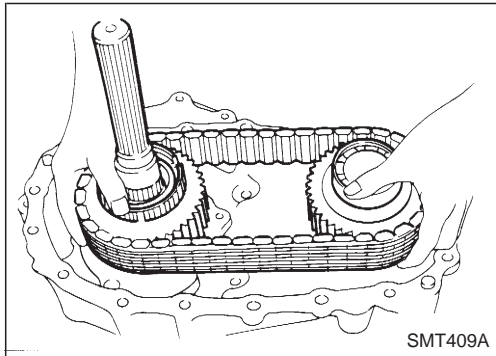

- d. Install front drive shaft by tapping lightly.
● **Make sure shafts are lined up in the case.**

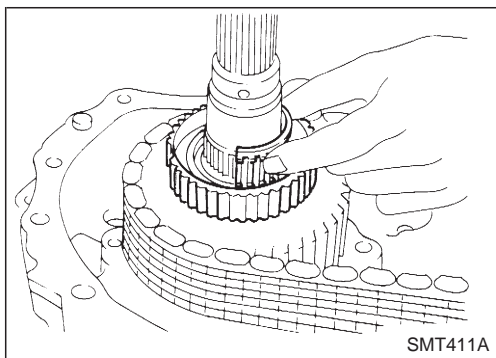

- e. Apply gear oil to needle bearings and install them into front drive sprocket.
● **These needle bearings will be installed move easily if front drive sprocket is rotated while installing them.**

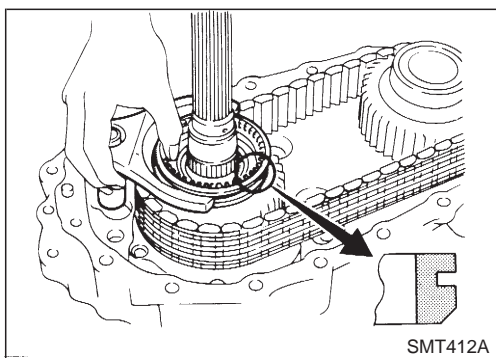

- f. Install 2-4 coupling sleeve with 2-4 shift fork.
● **Pay special attention to direction of coupling sleeve.**

ASSEMBLY

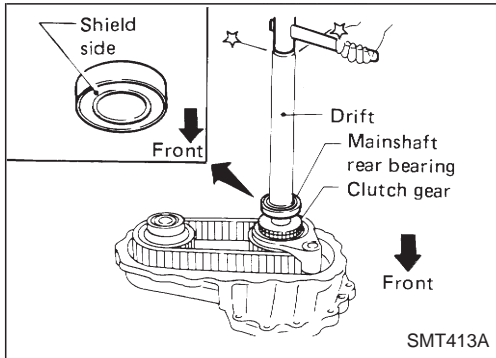

- g. Install clutch gear and mainshaft rear bearing.
- **Place wooden block under mainshaft in order to protect mainshaft front bearing.**

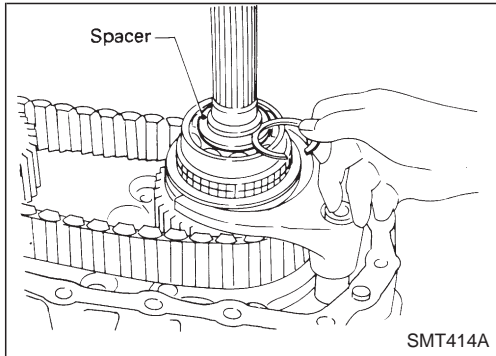

- h. Install spacer.
- i. Select snap ring with proper thickness and install it.
- **Allowable clearance between snap ring and groove:
0 - 0.15 mm (0 - 0.0059 in)**
 - **Available snap ring for mainshaft rear bearing:
Refer to SDS, TF-30.**

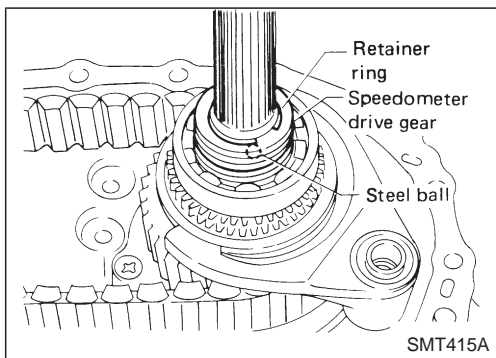

- j. Install steel ball, speedometer drive gear and retainer ring.
- **Steel ball is the smallest of check balls for this unit.**

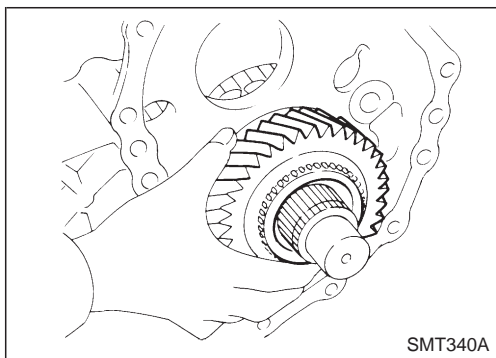

- k. Install low gear and its bearing to mainshaft.
- **Apply gear oil to needle bearing.**

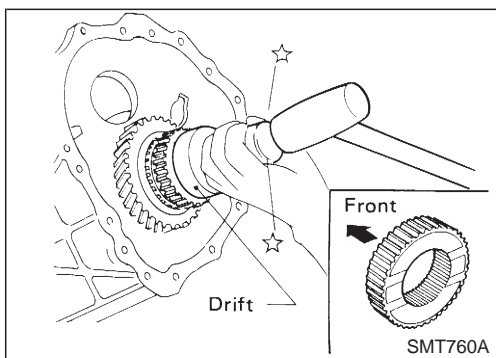

- l. Install L & H hub and snap ring to mainshaft.
- **Pay special attention to direction of L & H hub.**

ASSEMBLY

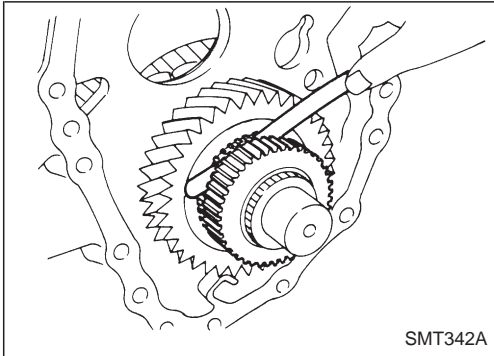

- m. Measure end play of low gear.
Standard: 0.2 - 0.35 mm (0.0079 - 0.0138 in)

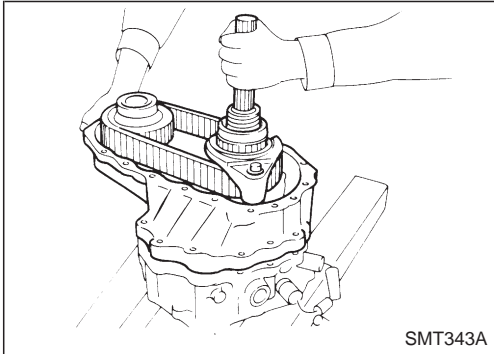

6. Apply sealant to mating surface and put center case assembly onto front case and tighten bolts.

Sealant:

Refer to "Case Components", TF-8.

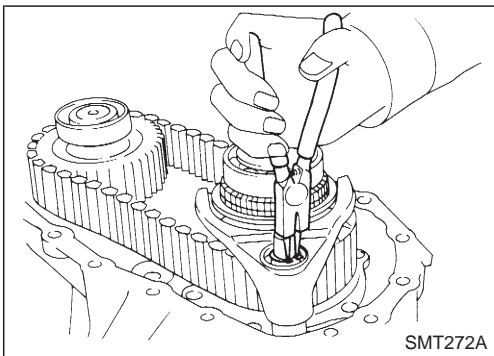

7. Install snap ring to 2-4 shift rod.

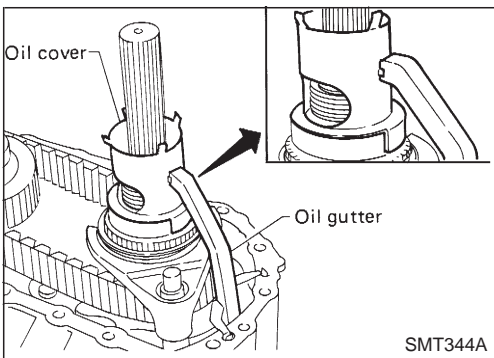

8. Install oil gutter and oil cover.

9. Apply gear oil to each part in center case.

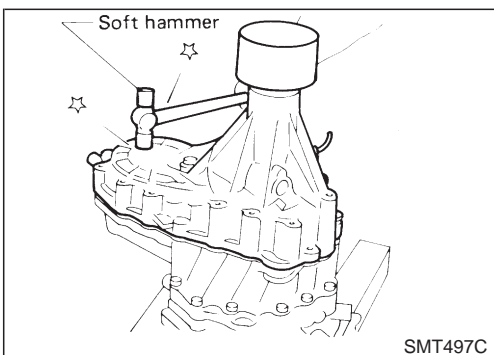

10. Apply sealant to mating surface and install rear case on center case.

11. Install 4WD switch.

- **Apply sealant to thread of switch.**

Sealant:

Refer to "Case Components", TF-8.

SERVICE DATA AND SPECIFICATIONS (SDS)

General Specifications

Transfer model		TX10A	
Gear ratio	High	1.000	
	Low	2.020	
Number of teeth	Main gear	29	
	Low gear	37	
	Counter gear	High	38
		Low	24
	Front drive sprocket	41	
Front drive shaft	41		
Fluid oil capacity*	ℓ (Imp qt)	2.2 (2)	

* Refer to MA section ("Fluids and Lubricants", RECOMMENDED FLUIDS AND LUBRICANTS).

Inspection and Adjustment

CLEARANCE BETWEEN FRONT DRIVE SPROCKET AND 2-4 COUPLING SLEEVE

Allowable clearance "C"	0.2 - 0.54 mm (0.0079 - 0.0213 in)
-------------------------	---------------------------------------

GEAR END PLAY

Unit: mm (in)

Front drive sprocket	0.2 - 0.35 (0.0079 - 0.0138)
Low gear	0.2 - 0.35 (0.0079 - 0.0138)
Counter gear	0 - 0.2 (0 - 0.008)

CLEARANCE BETWEEN BAULK RING AND CLUTCH GEAR

Unit: mm (in)

Standard	Wear limit
1.0 - 1.5 (0.039 - 0.059)	0.5 (0.020)

AVAILABLE SNAP RING

Mainshaft front bearing

Allowable clearance	0 - 0.15 mm (0 - 0.0059 in)
Thickness mm (in)	Part number
3.10 (0.1220)	33138-73P10
3.19 (0.1256)	33138-73P11
3.28 (0.1291)	33138-73P12

Mainshaft rear bearing

Allowable clearance	0 - 0.15 mm (0 - 0.0059 in)
Thickness mm (in)	Part number
1.80 (0.0709)	33138-73P20
1.89 (0.0744)	33138-73P21
1.98 (0.0780)	33138-73P22
2.07 (0.0815)	33138-73P23
2.16 (0.0850)	33138-73P24

Main gear bearing

Allowable clearance	0 - 0.15 mm (0 - 0.0059 in)
Thickness mm (in)	Part number
2.60 (0.1024)	33114-73P00
2.69 (0.1059)	33114-73P01
2.78 (0.1094)	33114-73P02

AVAILABLE SHIM

Counter gear rear bearing

Distance "A" mm (in)	Shim(s)	
	Thickness mm (in)	Part number
32.65 - 32.55 (1.2854 - 1.2815)	Not necessary	
32.55 - 32.45 (1.2815 - 1.2776)	0.1 (0.004)	33112-C6900
32.45 - 32.35 (1.2776 - 1.2736)	0.2 (0.008)	33112-C6901
32.35 - 32.25 (1.2736 - 1.2697)	0.3 (0.012)	33112-C6902
32.25 - 32.15 (1.2697 - 1.2657)	0.4 (0.016)	33112-C6903
32.15 - 32.05 (1.2657 - 1.2618)	0.5 (0.020)	33112-33G00
32.05 - 31.95 (1.2618 - 1.2579)	0.6 (0.024)	33112-33G01

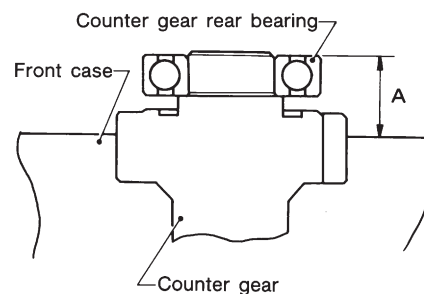

SMT335A