

STEERING COLUMN

1992 Infiniti G20

1991-92 STEERING
Infiniti - Steering Columns

G20, M30, Q45

WARNING: M30 and Q45 are equipped with Supplemental Restraint System (SRS). Observe following precautions before performing any repair. Disconnect and shield battery ground. Disconnect SRS connector at control unit located behind center console. All SRS wiring harnesses and connectors are Yellow. DO NOT use electrical test equipment on these circuits. Use caution when working around steering column as air bag could deploy.

ADJUSTMENTS

TILT MECHANISM

M30 & Q45

1) To adjust tilt mechanism on tilt steering column, move tilt lever to lock position. Securely tighten adjusting nut. See Fig. 1. Turn tilt lever to free position and ensure steering column moves smoothly without binding.

2) Return tilt lever to lock position. Ensure steering column does not move when steering wheel is pushed up or down. Ensure position pin works smoothly. See Fig. 1.

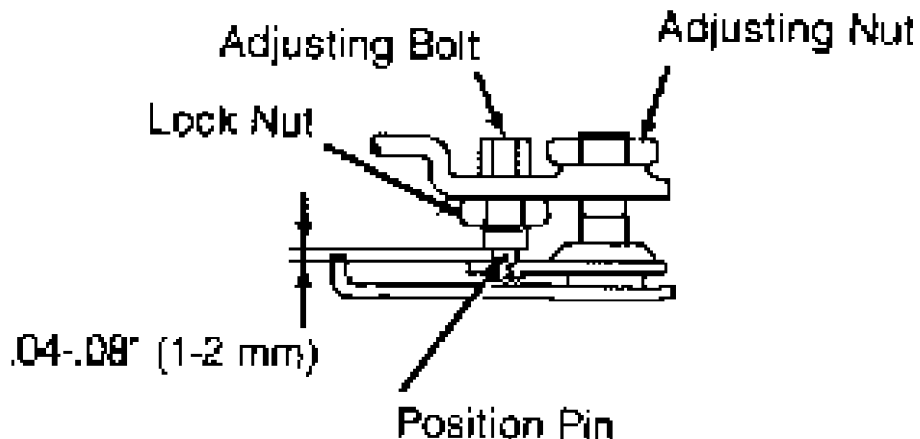

Fig. 1: Adjusting Tilt Mechanism (M30 & Q45)
Courtesy of Nissan Motor Co., U.S.A.

REMOVAL & INSTALLATION

STEERING WHEEL & HORN PAD

Removal

1) Before proceeding, disable air bag system (if equipped). See air bag service warning above. Remove lower lid (access cover) from steering wheel.

2) Air bag module is located on steering wheel hub.

Disconnect air bag module connector. Remove side access lids. Using a T50H Torx bit, remove bolts from left and right of air bag module (steering wheel pad). Carefully remove air bag module. DO NOT drop or strike air bag module.

3) Ensure steering wheel is in straight-ahead position. Disconnect horn connector, and remove nuts. Using steering wheel puller, remove steering wheel. DO NOT overtighten puller bolts on steering wheel. See Fig. 2.

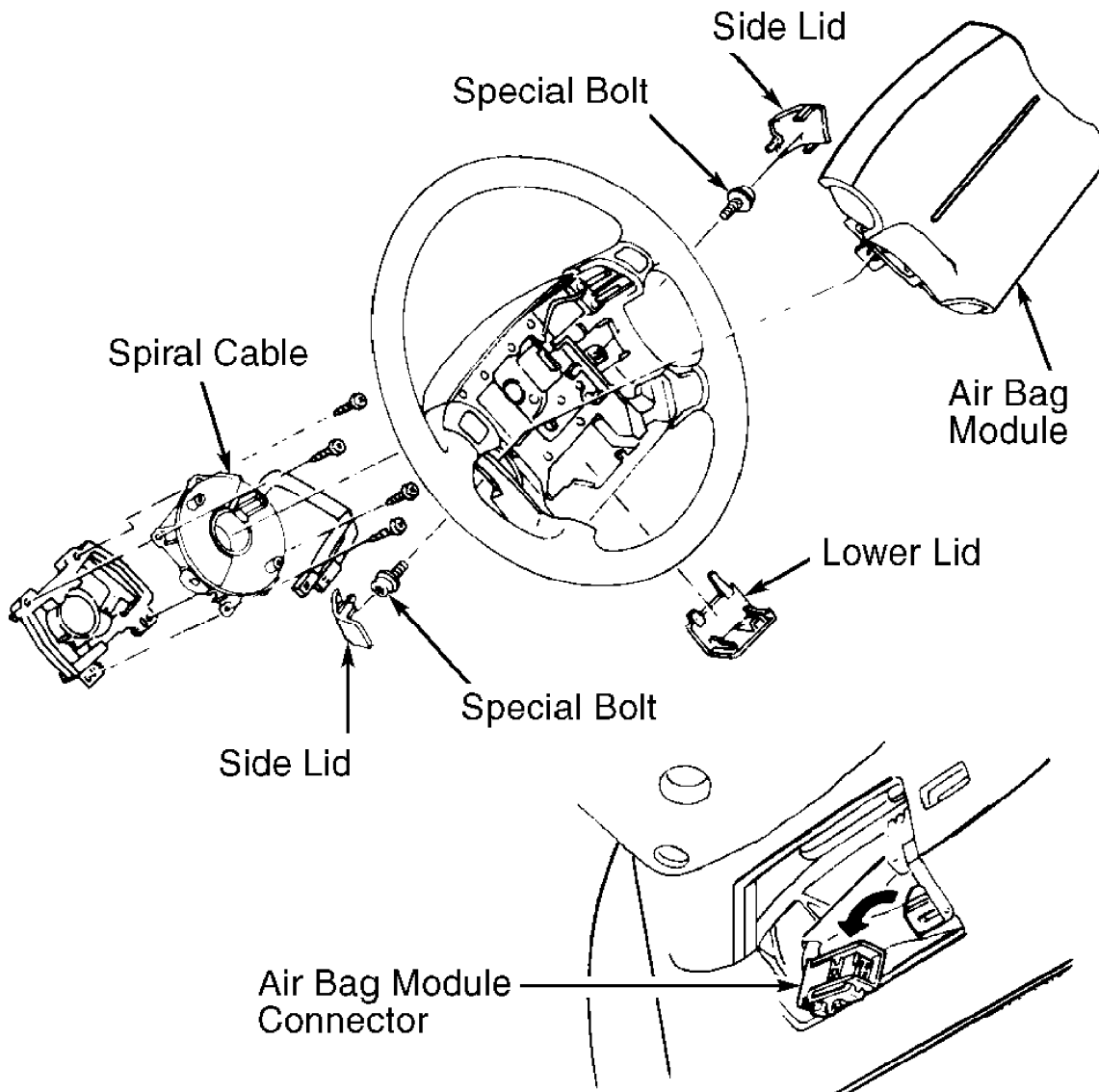

91F02841

Fig. 2: Removing Air Bag Module & Spiral Cable
Courtesy of Nissan Motor Co., U.S.A.

Installation

1) Install steering wheel, setting spiral cable pin guides,

and pull spiral cable through (if equipped). Connect horn connector, and engage spiral cable with pawls in steering wheel. Tighten nuts.

2) Install air bag module (if equipped). Tighten new bolts to 11-18 ft. lbs. (15-25 N.m). Connect air bag module connector. Install all access covers. Reactivate air bag system.

COMBINATION SWITCH

Removal & Installation

Unlock steering wheel. Remove steering column covers. See STEERING COLUMN under OVERHAUL. To remove combination switch, insert a screwdriver between switch halves. See Fig. 3. Lift switch bracket and pull it out. To install, reverse removal procedure.

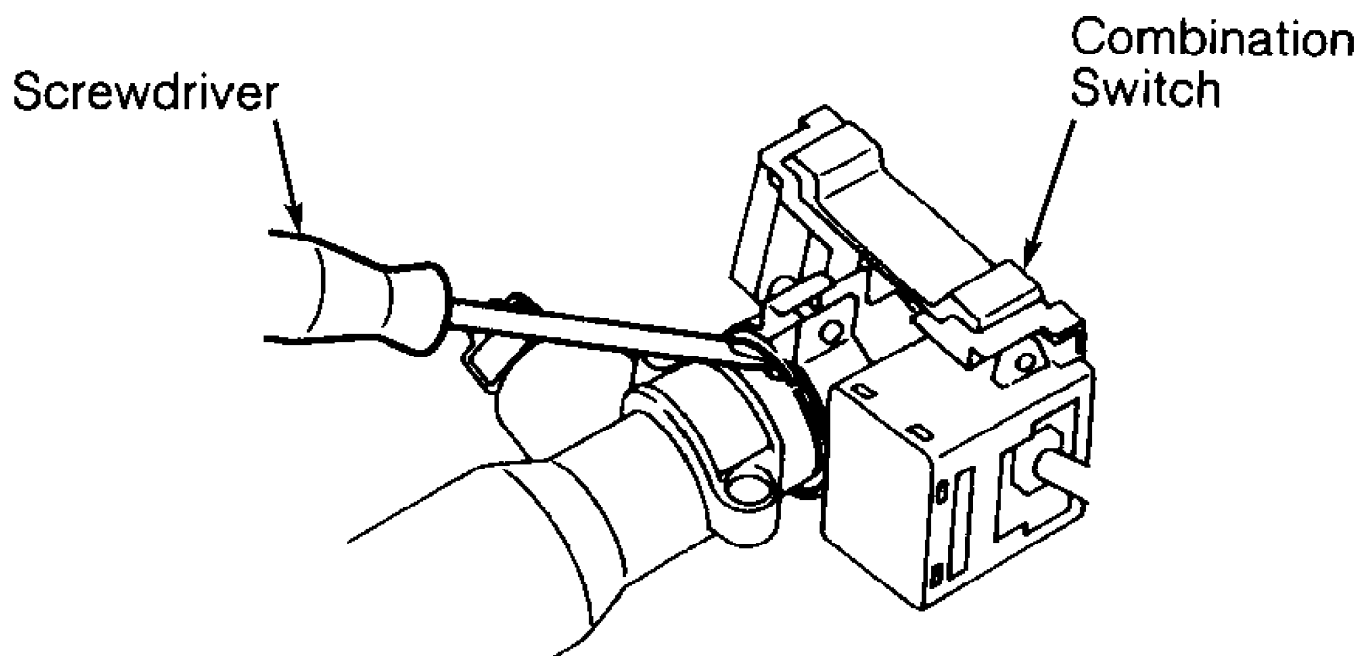

92E00319

Fig. 3: Removing Combination Switch
Courtesy of Nissan Motor Co., U.S.A.

IGNITION SWITCH

Removal & Installation

Unlock steering wheel. Remove steering column covers. See STEERING COLUMN under OVERHAUL. Drill out steering lock self-shear screws. See Fig. 4. To install, reverse removal procedure. Cut off self-shear screw heads.

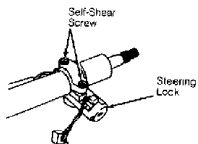

Fig. 4: Locating Self-Shear Screws
Courtesy of Nissan Motor Co., U.S.A.

OVERHAUL

STEERING COLUMN

NOTE: For exploded views of steering column assemblies, see Figs. 5-12.

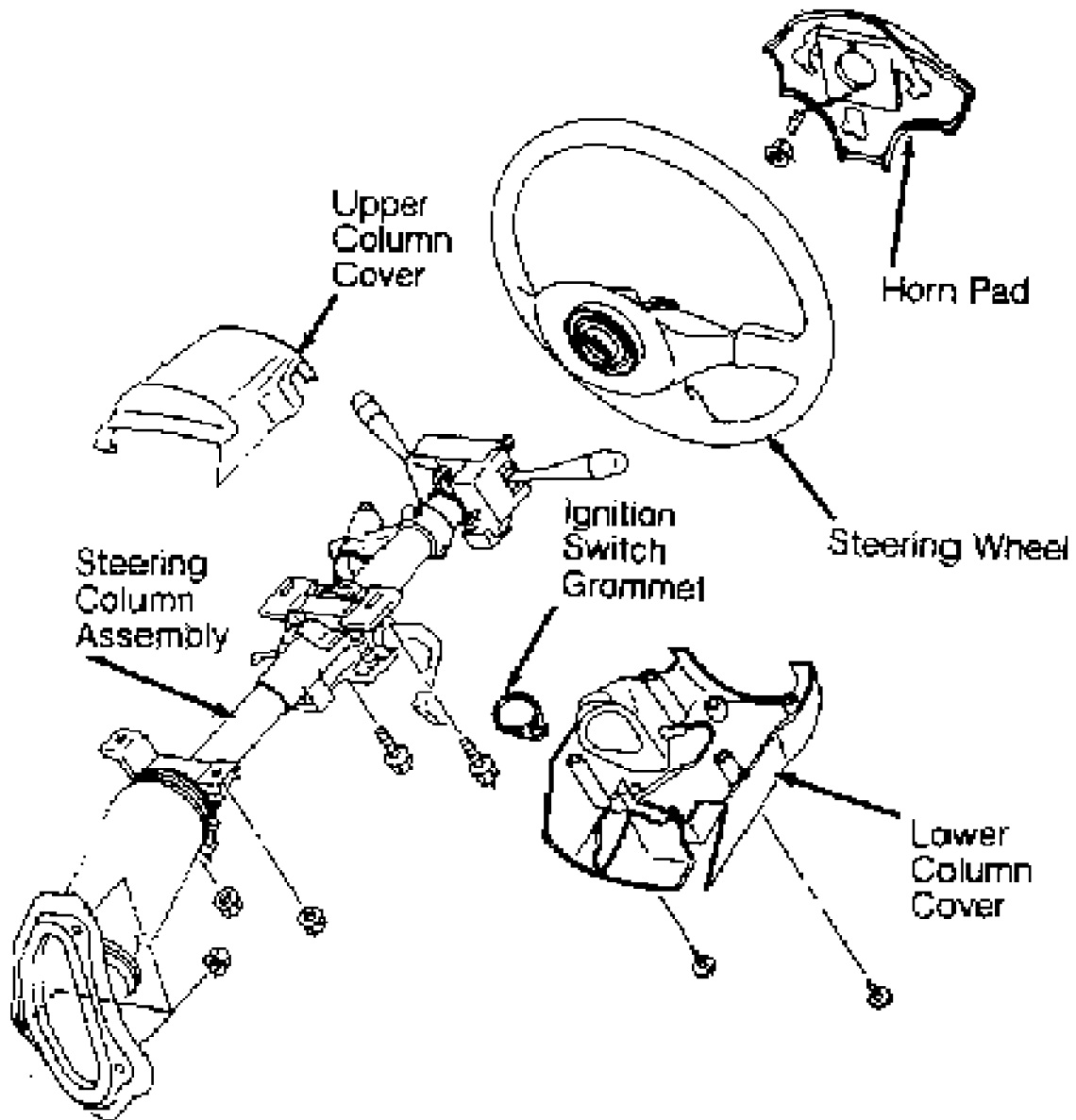
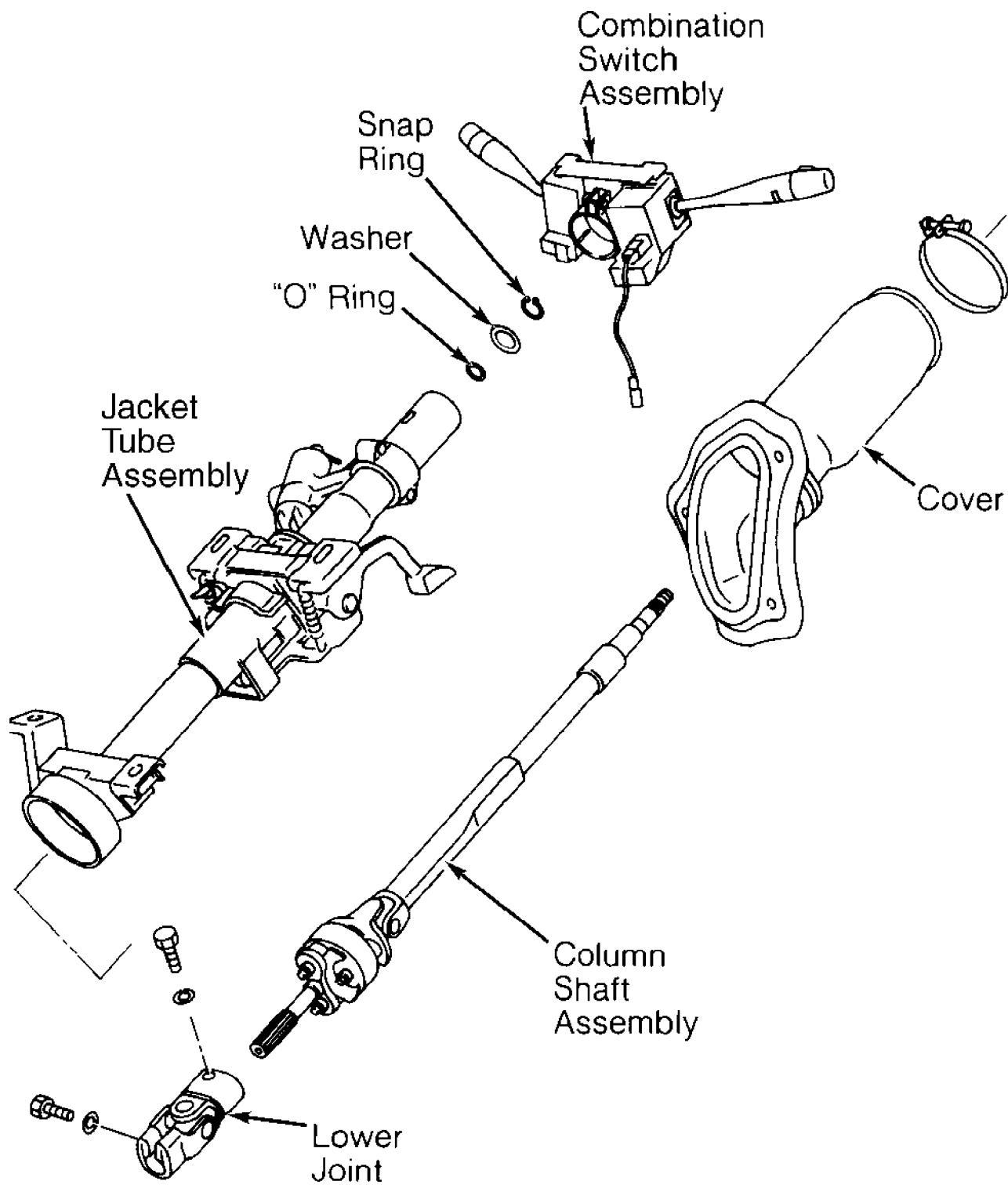

Fig. 5: Exploded View of Column Assy. (G20 - 1 of 2)
Courtesy of Nissan Motor Co., U.S.A.



92J00322

Fig. 6: Exploded View of Column Assy. (G20 - 2 of 2)
 Courtesy of Nissan Motor Co., U.S.A.

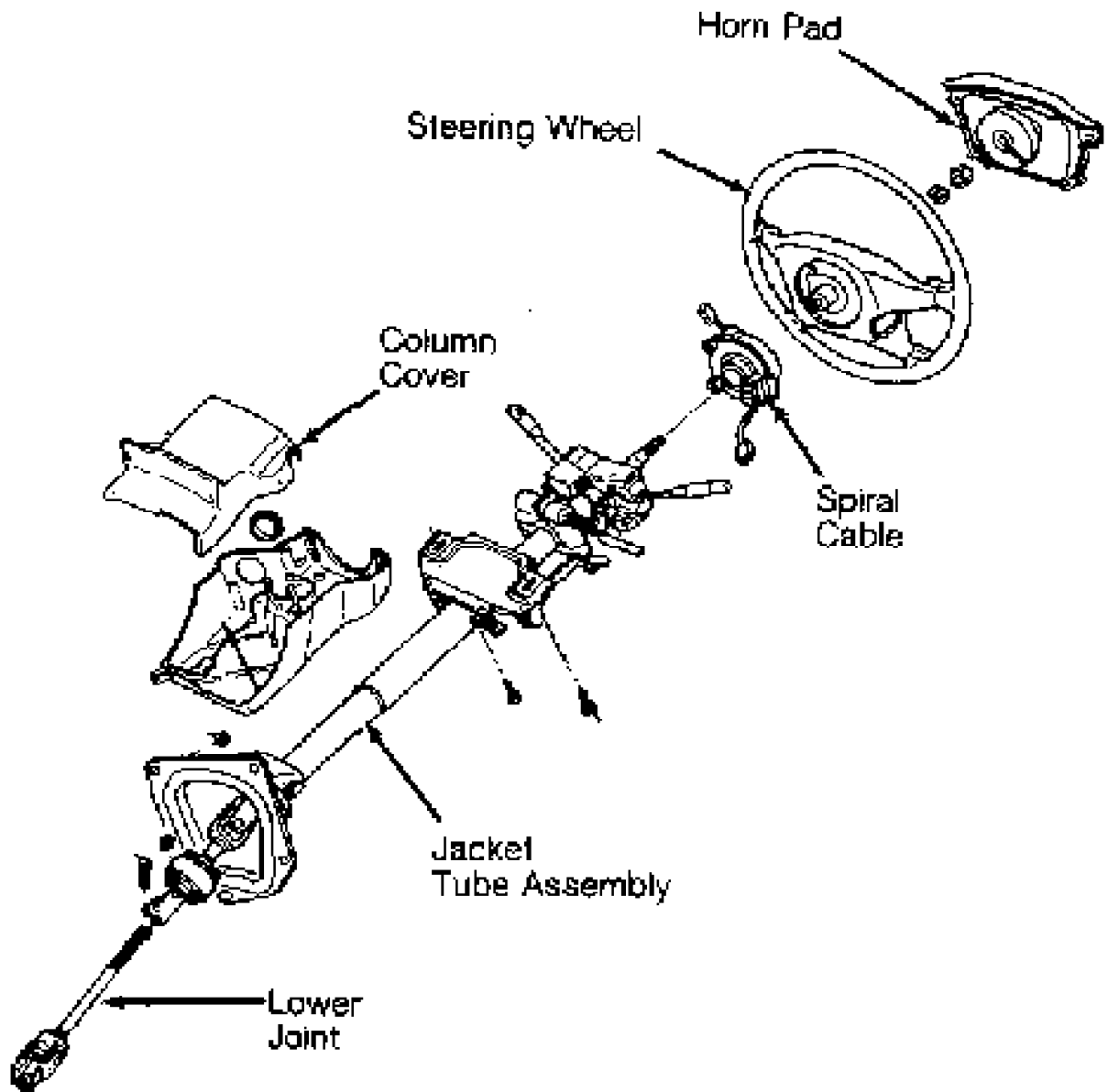

Fig. 7: Exploded View of Column Assy. (M30 - 1 of 2)
Courtesy of Nissan Motor Co., U.S.A.

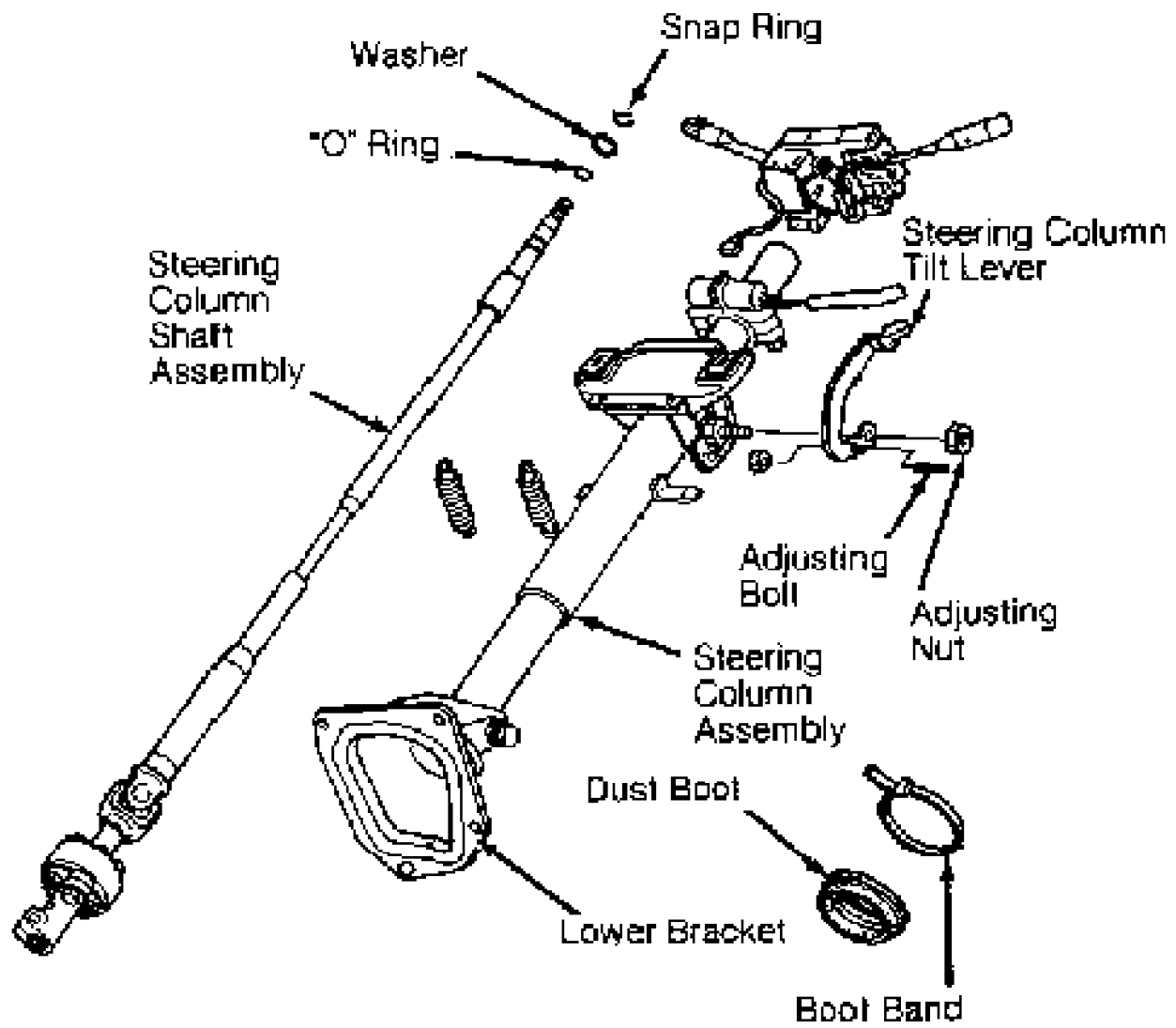

Fig. 8: Exploded View of Column Assy. (M30 - 2 of 2)
Courtesy of Nissan Motor Co., U.S.A.

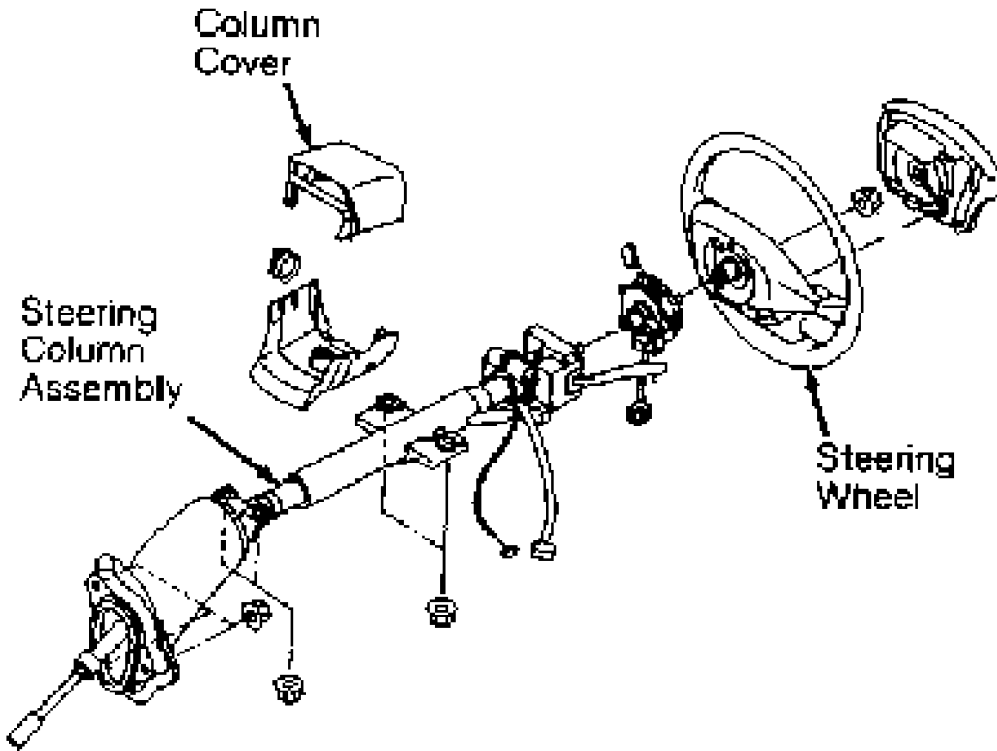
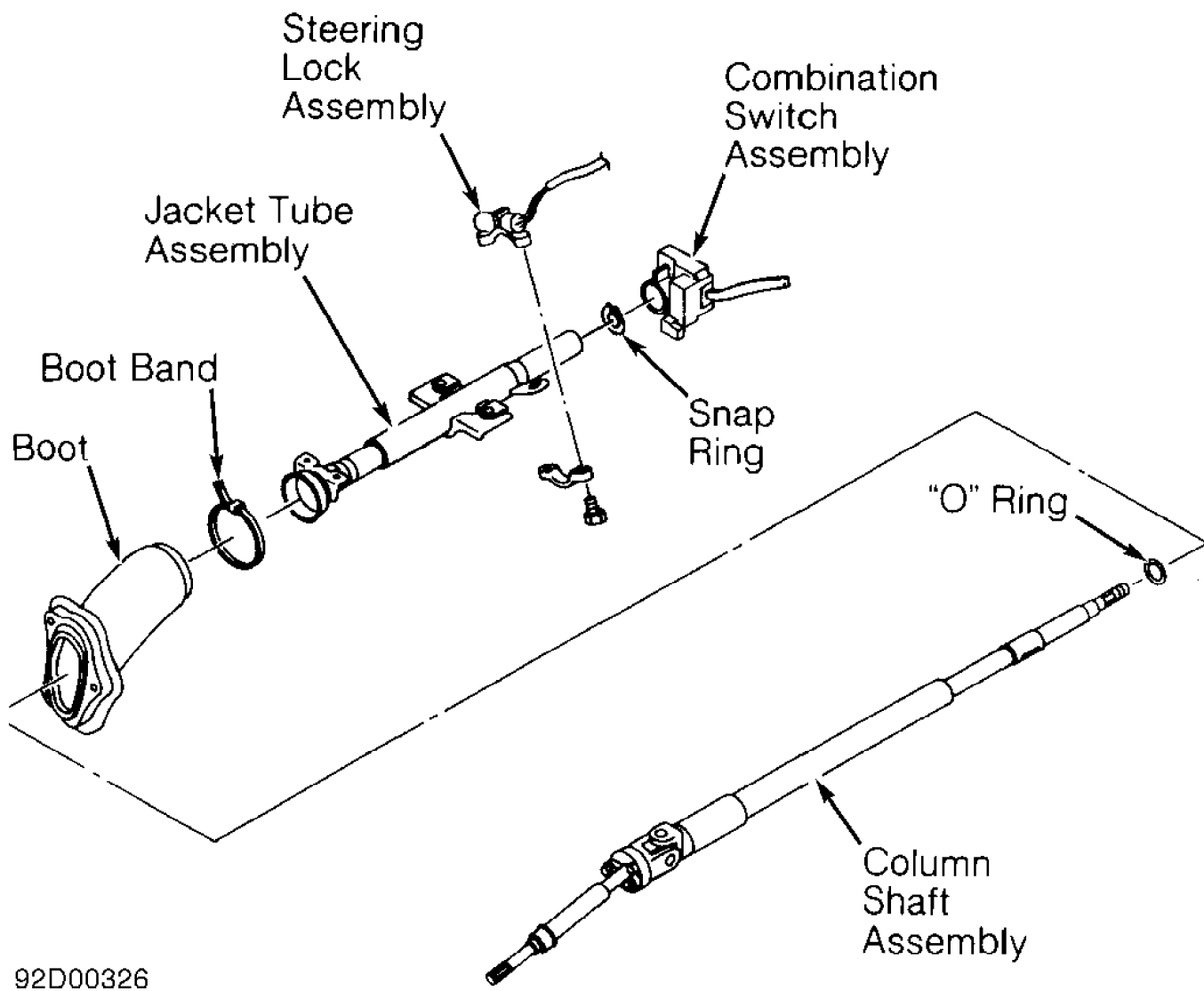

Fig. 9: Exploded View of Non-Tilt Column Assy (Q45 - 1 of 2)
Courtesy of Nissan Motor Co., U.S.A.



92D00326

Fig. 10: Exploded View of Non-Tilt Column Assy. (Q45 - 2 of 2)
 Courtesy of Nissan Motor Co., U.S.A.

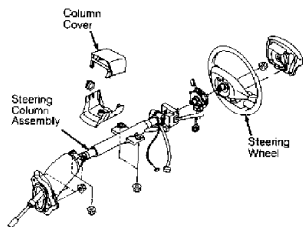
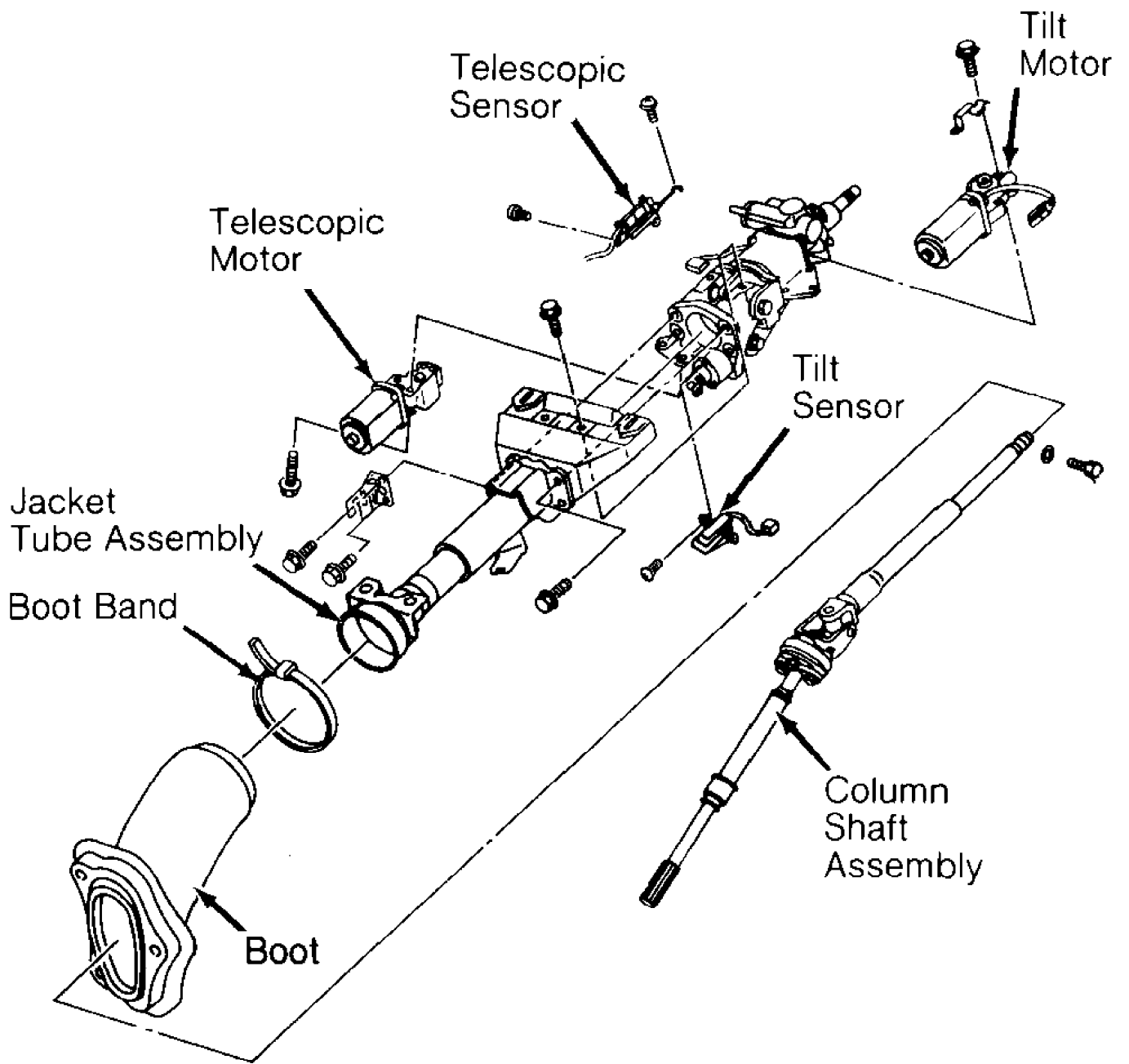

Fig. 11: Exploded View of Tilt Column Assy (Q45 - 1 of 2)
 Courtesy of Nissan Motor Co., U.S.A.



92E00327

Fig. 12: Exploded View of Tilt Column Assy. (Q45 - 2 of 2)
 Courtesy of Nissan Motor Co., U.S.A.

TORQUE SPECIFICATIONS

TORQUE SPECIFICATIONS TABLE

Application	Ft. Lbs. (N.m)
Lower Steering Shaft Joint Bolt	17-22 (24-29)
Lower Column Bracket Nut G20	11-14 (15-19)

Q45	9-13	(13-18)
Steering Wheel Nut	22-29	(29-39)
Tilt Wheel Adjusting Nut (M30)		
On Column	13-20	(18-27)
On Tilt Lever	17-22	(24-29)
Upper Column Bracket Bolts		
G20 & M30	9-13	(13-18)
Q45	12-15	(16-21)
