

REAR WIRING HARNESS AND REAR TAIL GATE CORD

WIRING SYSTEM

57. Rear Wiring Harness and Rear Tail Gate Cord

A: LOCATION

Connector				Connecting to	
No.	Pole	Color	Area	No.	Name
R15	6	Black	B-2	R57	Fuel tank cord
R17	1	★	B-4		Rear defogger (Power) (Without choke coil model)
R22	3	Black	B-3		Rear door switch LH
R26	6	★	C-3		Rear combination light RH
R28	6	★	C-1		Rear combination light LH
R46	2	★	C-2	R67	Fuel tank cord (With fuel pump control module model)
R47	3	★	C-3		Fuel tank pressure sensor
R57	6	★	B-3	R15	Rear wiring harness
R58	6	★	C-3		Fuel gauge module & fuel pump assembly
R59	2	★	C-3		Fuel gauge sub module
R62	2	★	C-3		Rear finisher light RH
R64	2	★	B-1		Rear finisher light LH
R67	2	★	B-2	R46	Rear wiring harness
R68	2	★	C-3		Pressure control solenoid valve
R69	2	★	C-4		Vent control solenoid valve
R76	2	★	C-2		License plate light LH
R77	2	★	C-2		License plate light RH
R79	2	★	C-4		Trailer connector
R97	2	★	B-4		Antenna amp.
R122	10	★	B-2		Fuel pump control module
R134	8	★	C-4	R135	On refueling vapor recovery cord
R135	8	★	C-4	R134	Rear wiring harness
R143	2	★	B-3		Drain valve
R144	2	★	C-4		Fuel tank sensor control valve
R150	16	★	C-4	R151	Rear wiring harness (Rear)
R151	16	★	B-4	R150	Rear wiring harness (Front)
R152	8	★	B-4	R153	Roof light cord
R153	8	★	B-4	R152	Rear wiring harness (Front)
R156	4	★	B-4		SPORT light
R158	2	★	B-3		Switch back gate latch switch

★: Non-colored

REAR WIRING HARNESS AND REAR TAIL GATE CORD

WIRING SYSTEM

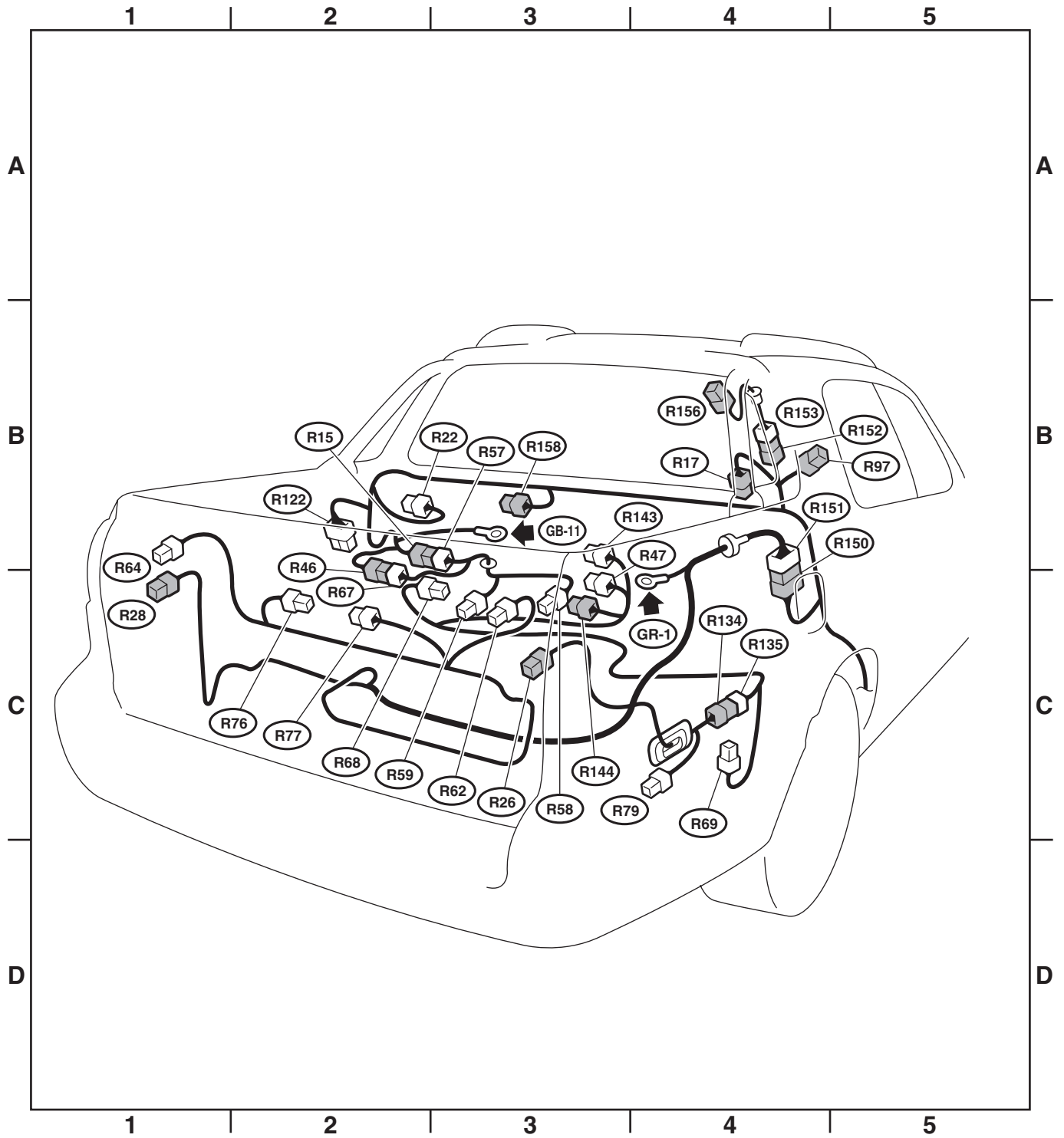

WI-05872