

8. Rear Drum Brake Shoe

A: REMOVAL

- 1) Set the vehicle on a lift.
- 2) Loosen the wheel nuts.
- 3) Lift-up the vehicle, and then remove the rear wheels.
- 4) Release the parking brake.
- 5) Remove the brake drum from brake assembly.

NOTE:

- If it is difficult to remove the brake drum, remove the adjusting hole cover from back plate, then turn the adjuster assembly claws using a flat tip screw-driver until the brake shoe separates from the drum.

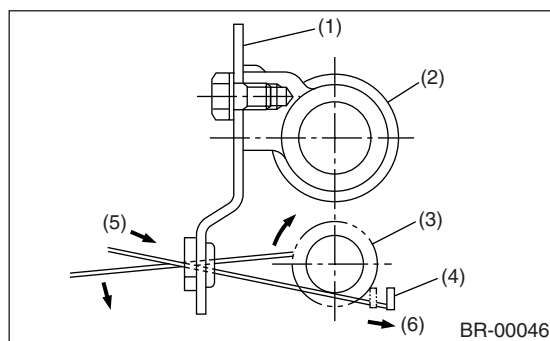

- (1) Back plate
- (2) Wheel cylinder ASSY
- (3) Adjuster ASSY claws
- (4) Adjusting lever
- (5) Tightening direction
- (6) Push direction

- If the brake drum is difficult to remove, drive it out by installing an 8-mm bolt into bolt hole in brake drum.

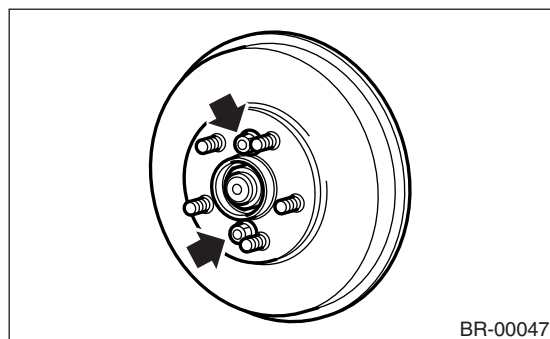

- 6) Hold the hold-down pin by securing rear of back plate with your hand.

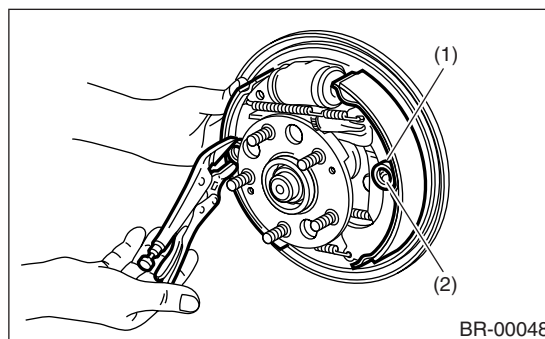

- (1) Hold-down cup
- (2) Hold-down pin

- 7) Rotate the hold down cup and remove from the hold down pin.

- 8) Disconnect the lower shoe return spring from the brake shoe.

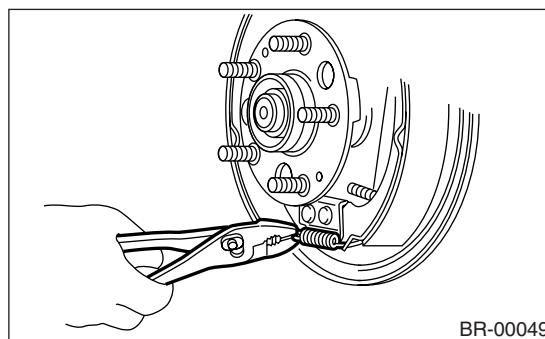

- 9) Remove each brake shoe along with the adjuster from the back plate.

CAUTION:

Be careful not to excessively bend the parking brake cable when removing the brake shoes.

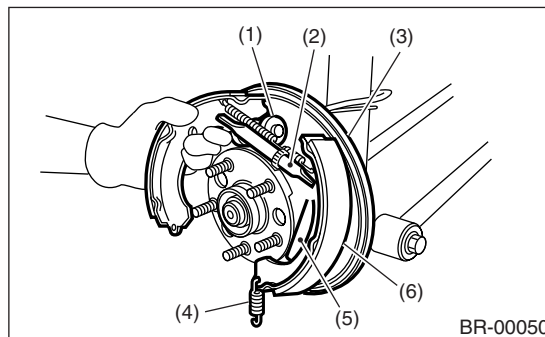

- (1) Wheel cylinder ASSY
- (2) Adjuster ASSY
- (3) Back plate
- (4) Lower shoe return spring
- (5) Parking lever
- (6) Brake shoe (Trailing)

- 10) Disconnect the parking brake cable from the parking brake lever.

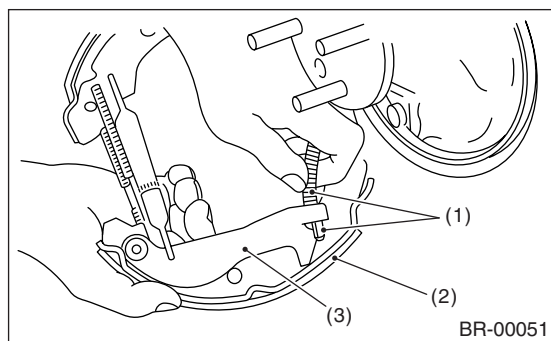

- (1) Parking brake cable
(2) Brake shoe (Trailing)
(3) Parking brake lever

- 11) Remove the upper shoe return spring and adjusting spring from the brake shoe.

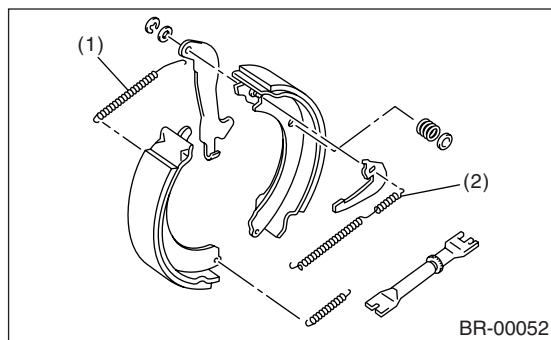

- (1) Upper shoe return spring
(2) Adjusting spring

B: INSTALLATION

- 1) Clean the back plate and wheel cylinder assembly.
2) Apply grease to the portions indicated by arrows in the figure.

Brake grease:

Dow Corning Molykote No. 7439 (Part No. 003602001)

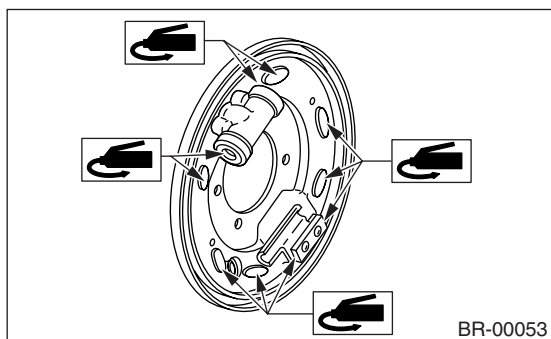

- 3) Apply grease to the adjusting screw and both ends of adjuster.

Brake grease:

Dow Corning Molykote No. 7439 (Part No. 003602001)

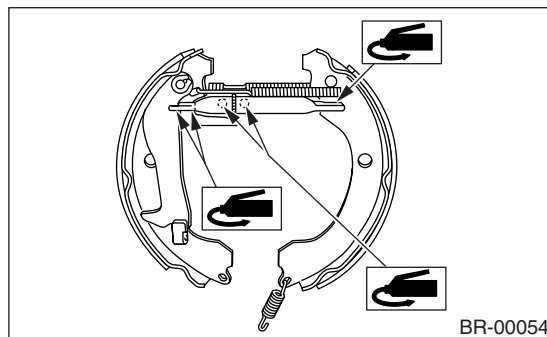

- 4) Attach the upper shoe return spring to the brake shoe.
5) Connect the parking brake cable to the parking lever.
6) While positioning the brake shoe (one at a time) in the groove of the wheel cylinder, secure the brake shoe in place.

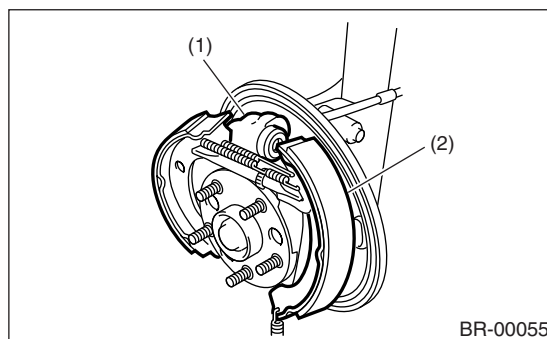

- (1) Wheel cylinder ASSY
(2) Brake shoe (Trailing)

- 7) Fix the shoes in place by connecting the hold-down cup to the hold-down pin.
8) Install the lower shoe return spring.
9) Set the outside diameter of brake shoes 0.5 to 0.8 mm (0.020 to 0.031 in) smaller in comparison with the inside diameter of the brake drum.

C: INSPECTION

1) Measure the lining thickness. If it exceeds the service limit, replace the brake shoe with a new one.

Lining thickness

Standard:

4.1 mm (0.161 in)

Service limit:

1.5 mm (0.059 in)

2) If the deformation or wear of back plate, shoe, etc. are severe, replace them.

3) If the tension of the shoe return spring is very low, replace it. Be careful not to confuse the upper and lower shoe return springs.