

General Diagnostic Table

POWER ASSISTED SYSTEM (POWER STEERING)

1. ABNORMAL NOISE & VIBRATION

CAUTION:

Do not keep the relief valve operating for over 5 seconds at a time or the inner parts of the oil pump may be damaged due to rapid increase of fluid temperature.

NOTE:

- A screeching noise may be heard immediately after the engine start in extremely cold conditions. In this case, if the noise goes away when the vehicle warms up, the system is functioning normally. This is due to the fluid characteristics in extremely cold condition.
- The oil pump normally makes a small whining noise due to its mechanism. Even if a noise is heard when steering wheel is turned at stand still, there is no abnormal function in the system provided that the noise eliminates when the vehicle is driving.

- When turning the steering wheel with the brake applied when the vehicle is parked, a screeching noise may be generated by the brake disc and pads. This is not a fault in the steering system.

- There may be a small vibration around the steering devices when turning the steering wheel at standstill, even though the component parts are operating properly

Hydraulic systems are likely to generate this kind of vibration as well as working noise and fluid noise because of combined conditions, i.e., road surface and tire surface, engine speed and turning speed of the steering wheel, fluid temperature and braking conditions.

These conditions do not indicate a problem in the system.

Confirm vibration for an AT model, by applying the parking brake on a concrete surface, shifting into the "D" range, and turning the steering wheel repeatedly at from slow to rapid, step by step.

Trouble	Possible cause	Corrective action
Hiss noise (continuous) While engine is running.	The relief valve emits an operating sound when steering wheel is completely turned in either direction. (Do not keep this condition over 5 seconds.)	Normal
	Relief valve emits an operating sound when steering wheel is not turned. This means that the relief valve is defective.	Replace the oil pump.
Rattling noise (intermittent) when engine is running.	Interference with adjacent parts	Check the clearance. <Ref. to PS-53, INSPECTION OF CLEARANCE, INSPECTION, General Diagnostic Table.> Correct if necessary. <Ref. to PS-39, INSPECTION, Pipe Assembly.>
	Loosened attachment of the oil pump, reservoir tank, pump bracket, gearbox or crossmember	Retighten.
	Loose oil pump pulley or other pulley(s)	Retighten.
	Looseness of the linkage, play in the steering, improper tightening (looseness) of suspension joints or steering column	Retighten or replace.
	Sound generates from the inside of gearbox or oil pump.	Replace faulty parts in the gearbox or oil pump.
Knocking When turning steering wheel in both directions with small angle repeatedly at engine ON or OFF.	Excessive backlash Loosened lock nut for adjusting backlash	Adjust and retighten.
	Insufficient tightening or play in the tie-rod or tie-rod end	Retighten or replace.
Grinding noise (continuous) While engine is running.	Air in vane pump	Inspect and retighten the fluid line connection. Refill the fluid and vent air.
	Vane pump seizing	Replace the oil pump.
	Oil pump pulley bearing seized	Replace the oil pump.
	Folded hose, flattened pipe	Replace.
Squeal, squeak (intermittent or continuous) While engine is running.	Improper adjustment of pulley belt Damaged or over tensioned pulley belt Unequal length of pulley belts	Adjust or replace. (Replace two belts as a set.)
	Runout or dirty V-groove surface of oil pump pulley	Clean or replace.

General Diagnostic Table

POWER ASSISTED SYSTEM (POWER STEERING)

Trouble	Possible cause	Corrective action
Sizzling noise (continuous) While engine is running.	Fluid aeration	Fix the faulty part causing aeration. Replace the fluid and vent air.
	Damaged pipe of gearbox	Replace the pipe.
	Faulty inside of hose or pipe Flattened hose or pipe	Repair or replace.
	Problem inside the reservoir tank	Replace.
	Missing reservoir tank cap	Install cap.
Whistle (continuous) While engine is running.	Faulty pipe of gearbox or faulty hose	Replace the faulty parts of the gearbox or the hose.
Whine or growl (intermittent or continuous) While engine is running with/without steering turned.	Looseness of oil pump, oil pump bracket attachment	Retighten.
	Fault inside of oil pump or hose	Replace the oil pump or hose, if the noise can be heard when vehicle is running as well as being stopped.
	Torque converter growl, air conditioner compression growl	Remove the power steering pulley belt and check.
Grinding noise (continuous) While engine is running with the steering turned.	Fault inside of gearbox	Replace the faulty parts of gearbox.
	Faulty steering shaft bearing	Apply grease or replace.
	Occurs when turning the steering wheel with brakes (service or parking) applied.	If the noise goes away when brake is released, it is normal.
Vibration While engine is running with/without steering turned.	Engine speed is too low.	Adjust, and notify customer.
	Air in vane pump	Repair faulty part Vent air.
	Damaged valve in oil pump or gearbox	Replace the faulty parts in gearbox and oil pump.
	Excessive play in steering, looseness of suspension parts	Retighten.

General Diagnostic Table

POWER ASSISTED SYSTEM (POWER STEERING)

2. MEASUREMENT OF STEERING EFFORT

Step	Check	Yes	No
1 CHECK STEERING EFFORT. 1) Stop the vehicle on paved road. 2) Start the engine. 3) Run the engine at idle. 4) Install a spring scale on the steering wheel. 5) Pull the spring scale at a right angle to the steering wheel, and measure both right and left steering wheel efforts. NOTE: When turning the steering more quickly than necessary from one direction to the other at an engine speed over 2,000 rpm, steering effort may be heavy. This is caused by flow characteristic of the fluid in the oil pump and is not a defect.	Is the steering effort less than 29.4 N (3.0 kgf, 6.6 lb)?	Go to step 2.	Adjust the backlash.
2 CHECK STEERING EFFORT. 1) Stop the engine. 2) Pull the spring scale at a right angle to the steering wheel, and measure both right and left steering wheel efforts.	Is the steering effort less than 314 N (35 kgf, 77 lb)?	Go to step 3.	Perform the adjustment.
3 CHECK STEERING WHEEL EFFORT. 1) Remove the universal joint. 2) Measure the steering wheel effort.	Is steering effort less than 2.26 N (0.23 kgf, 0.51 lb)?	Go to step 4.	Check, adjust and replace if necessary.
4 CHECK STEERING WHEEL EFFORT. Measure the steering wheel effort.	Is the steering effort difference in the left and right directions is less than 1.08 N (0.11 kgf, 0.24 lb)?	Go to step 5.	Check, adjust and replace if necessary.
5 CHECK UNIVERSAL JOINT. Measure the swing torque of the joint (yoke of steering column side). <Ref. to PS-14, INSPECTION, Universal Joint.>	Is the swing torque of the universal joint less than 7.3 N (0.74 kgf, 1.64 lb)?	Go to step 6.	Replace with a new part.
6 CHECK UNIVERSAL JOINT. Measure the swing torque of the joint (yoke of gearbox side). <Ref. to PS-14, INSPECTION, Universal Joint.>	Is the swing torque of the universal joint less than 7.3 N (0.74 kgf, 1.64 lb)?	Go to step 7.	Replace with a new part.
7 FRONT WHEEL CHECK Check the front wheels.	Does the front wheels have unsteady revolution or rattling, or does the brakes drag?	Inspect, readjust and replace if necessary.	Go to step 8.
8 CHECK TIE-ROD ENDS. Remove the tie-rod ends.	Is there any unsteady revolution or rattling of suspension tie-rod ends?	Inspect and replace if necessary.	Go to step 9.
9 BALL JOINT CHECK. Remove the ball joint.	Is there any unsteady revolution or rattling of suspension ball joints?	Inspect and replace if necessary.	Go to step 10.
10 GEARBOX. CHECK Measure the rotating resistance of the gearbox. <Ref. to PS-34, TURNING RESISTANCE OF GEARBOX, INSPECTION, Steering Gearbox.>	Is the rotating resistance of steering gearbox less than 9.33 N (0.95 kgf, 2.09 lb)? Is the difference between right and left sides less than 20%?	Go to step 11.	Readjust the backlash, and if ineffective, replace the faulty parts.
11 CHECK GEARBOX. Measure the sliding resistance of the gearbox. <Ref. to PS-33, SERVICE LIMIT, INSPECTION, Steering Gearbox.>	Is the sliding resistance of steering gearbox less than 304 N (31 kgf, 68 lb)? Is the difference between the right and left sliding resistances less than 20%?	Steering effort is normal.	Readjust the backlash, and if ineffective, replace the faulty parts.

General Diagnostic Table

POWER ASSISTED SYSTEM (POWER STEERING)

3. INSPECTION OF CLEARANCE

This table lists various clearances that must be correctly adjusted to ensure the normal vehicle driving without interfering noise, or any other faults.

Install locations	Minimum allowance
(1) Crossmember to pipe	5 mm (0.20 in)
(2) DOJ to shaft or joint	14 mm (0.55 in)
(3) DOJ to valve housing	11 mm (0.43 in)
(4) Pipe to pipe	2 mm (0.08 in)
(5) Stabilizer to pipe	5 mm (0.20 in)
(6) Exhaust pipe to pipe	11 mm (0.43 in)
(7) Exhaust pipe to gear box bolt	15 mm (0.59 in)
(8) Side frame to hose A and B	10 mm (0.39 in)
(9) Cruise control pump — Hoses A and B	15 mm (0.59 in)
(10) Pipe portion of hose A to pipe portion of hose B	1.5 mm (0.059 in)

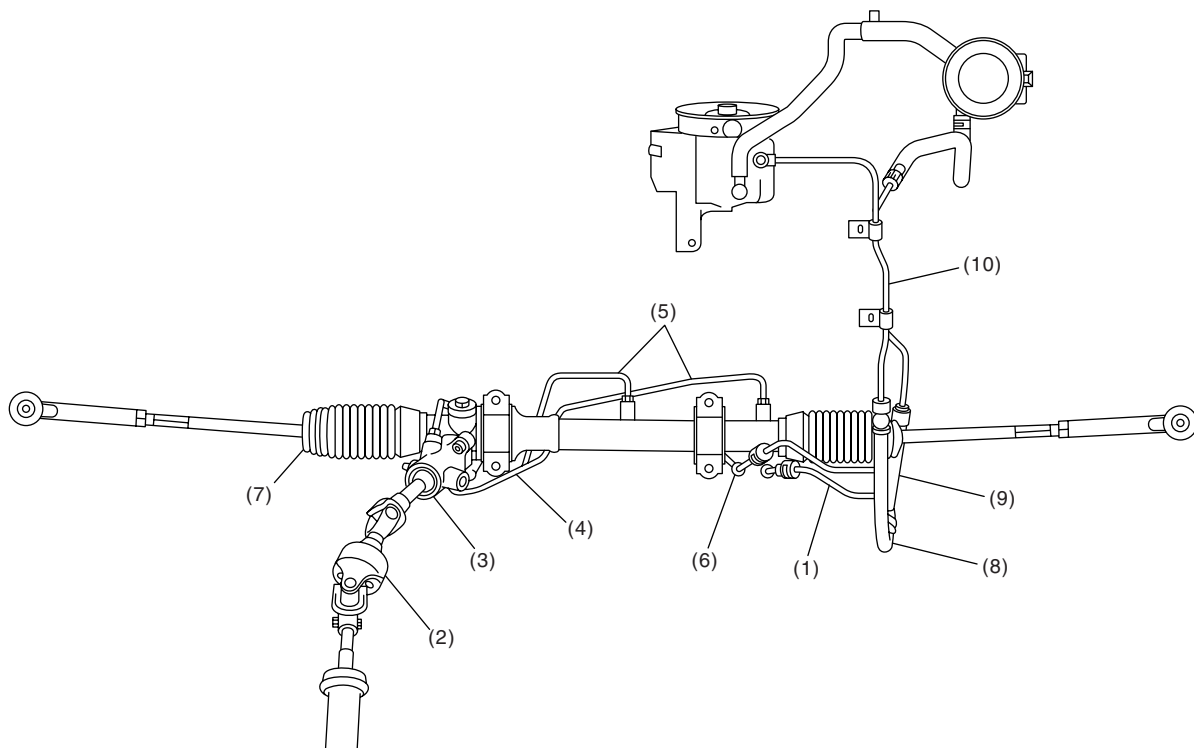

PS-00193

General Diagnostic Table

POWER ASSISTED SYSTEM (POWER STEERING)

BODY SECTION

This service manual has been prepared to provide SUBARU service personnel with the necessary information and data for the correct maintenance and repair of SUBARU vehicles.

This manual includes the procedures for maintenance, disassembling, reassembling, inspection and adjustment of components and diagnostics for guidance of experienced mechanics.

Please peruse and utilize this manual fully to ensure complete repair work for satisfying our customers by keeping their vehicle in optimum condition. When replacement of parts during repair work is needed, be sure to use SUBARU genuine parts.

All information, illustration and specifications contained in this manual are based on the latest product information available at the time of publication approval.

**HVAC SYSTEM
(HEATER, VENTILATOR AND A/C)** AC

**HVAC SYSTEM (AUTO A/C)
(DIAGNOSTICS)** AC(diag)

AIRBAG SYSTEM AB

AIRBAG SYSTEM (DIAGNOSTICS) AB(diag)

AIRBAG SYSTEM (TYPE B) (DIAGNOSTICS) AB(TYPE B)
(diag)

**OCCUPANT DETECTION SYSTEM
(DIAGNOSTICS)** OD(diag)

OCCUPANT DETECTION SYSTEM (TYPE B) (DIAGNOSTICS) OD(TYPE B)
(diag)

SEAT BELT SYSTEM SB

LIGHTING SYSTEM LI

WIPER AND WASHER SYSTEMS WW

ENTERTAINMENT ET

COMMUNICATION SYSTEM COM

GLASS/WINDOWS/MIRRORS GW

BODY STRUCTURE BS

INSTRUMENTATION/DRIVER INFO IDI

SEATS SE

SECURITY AND LOCKS SL

BODY SECTION**SUNROOF/T-TOP/CONVERTIBLE TOP
(SUNROOF)****SR****EXTERIOR/INTERIOR TRIM****EI****EXTERIOR BODY PANELS****EB****CRUISE CONTROL SYSTEM****CC****CRUISE CONTROL SYSTEM
(DIAGNOSTICS)****CC(ETC)(diag)****IMMOBILIZER (DIAGNOSTICS)****IM(diag)**

HVAC SYSTEM (HEATER, VENTILATOR AND A/C)

AC

	Page
1. General Description	2
2. Refrigerant Pressure with Manifold Gauge Set	19
3. Refrigerant Recovery Procedure	20
4. Refrigerant Charging Procedure	21
5. Refrigerant Leak Check	24
6. Compressor Oil	25
7. Blower Motor Unit Assembly	26
8. Blower Resistor (Manual A/C Model)	27
9. Heater Core	28
10. Control Unit	29
11. Compressor	30
12. Condenser	31
13. Condenser (Sub Fan)	32
14. Heater and Cooling Unit	33
15. Evaporator	34
16. Hose and Tube	35
17. Relay and Fuse	36
18. Pressure Switch (Triple Pressure Switch)	37
19. Ambient Sensor (Auto A/C Model)	38
20. Sunload Sensor (Auto A/C Model)	39
21. In-vehicle Sensor (Auto A/C Model)	40
22. Air Vent Grille	41
23. Heater Duct	42
24. Heater Vent Duct	43
25. General Diagnostic Table	44