

Parking Brake Cable

PARKING BRAKE

3. Parking Brake Cable

A: REMOVAL

CAUTION:

- Airbag system satellite safing sensor is located in the lower of the rear seat cushion center. Before removing the rear seat, refer to "CAUTION" of "General Description" in "AIRBAG SYSTEM" section. <Ref. to AB-9, CAUTION, General Description.>
- The airbag system is fitted with a backup power supply. After disconnecting the battery ground cable, the airbag may operate if you do not wait for 60 seconds before starting the service of airbag system.

- 1) Remove the lever assembly - hand brake. <Ref. to PB-4, REMOVAL, Parking Brake Lever.>
- 2) Remove the nut and remove the clamp A - hand brake cable (a).
- 3) Remove the inner cable end (c) from the equalizer (b).

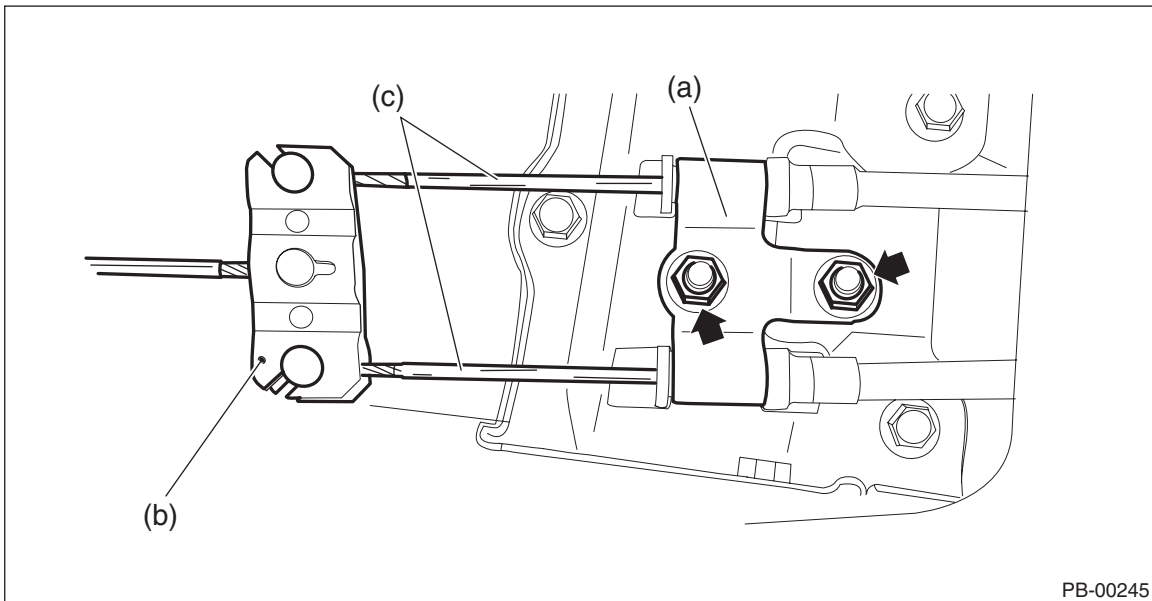

- 4) Remove the rear seat cushion assembly.
 - (1) Push the corners of the rear seat cushion from above.
 - (2) While pushing the corners of the rear seat cushion from above, pull the knob of the hook - seat cushion rear towards yourself.
 - (3) While pulling the knob towards yourself, disconnect the hooks by lifting up the rear seat cushion.

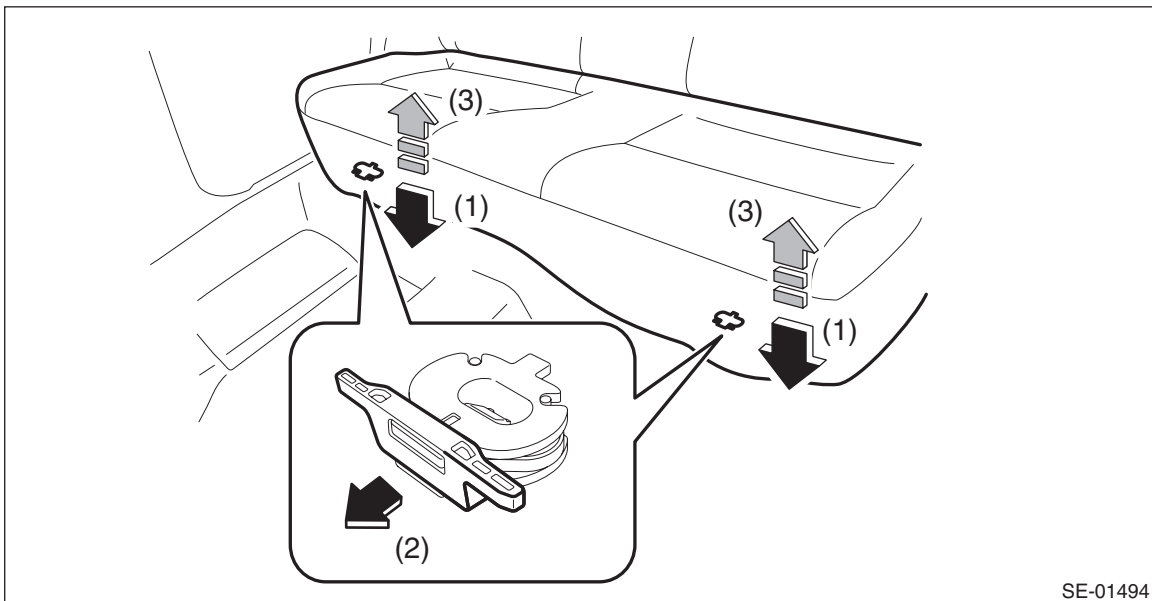

Parking Brake Cable

PARKING BRAKE

(4) Remove the hook (A) by pushing it back while lifting the front side of the rear seat cushion, and remove the rear seat cushion.

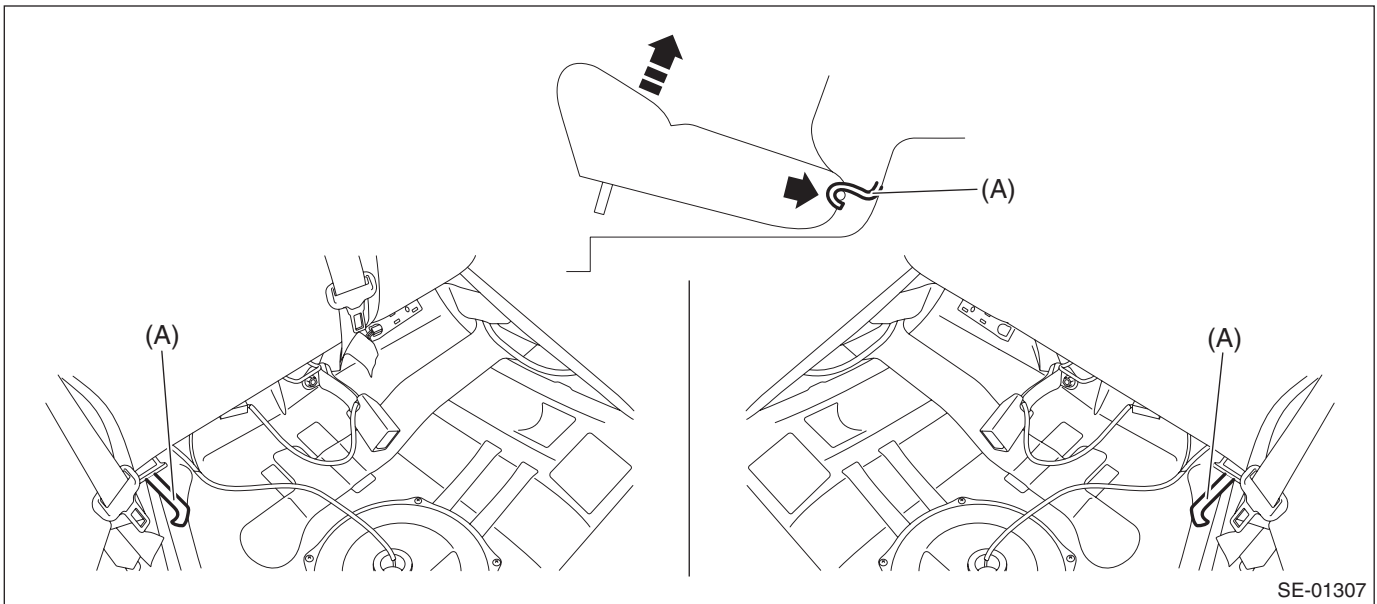

5) Release the clips and claws, and remove the side sill covers - rear INN on the left and right sides.

CAUTION:

Do not pull with excessive force. Doing so may damage the claws of the side sill cover - rear INN.

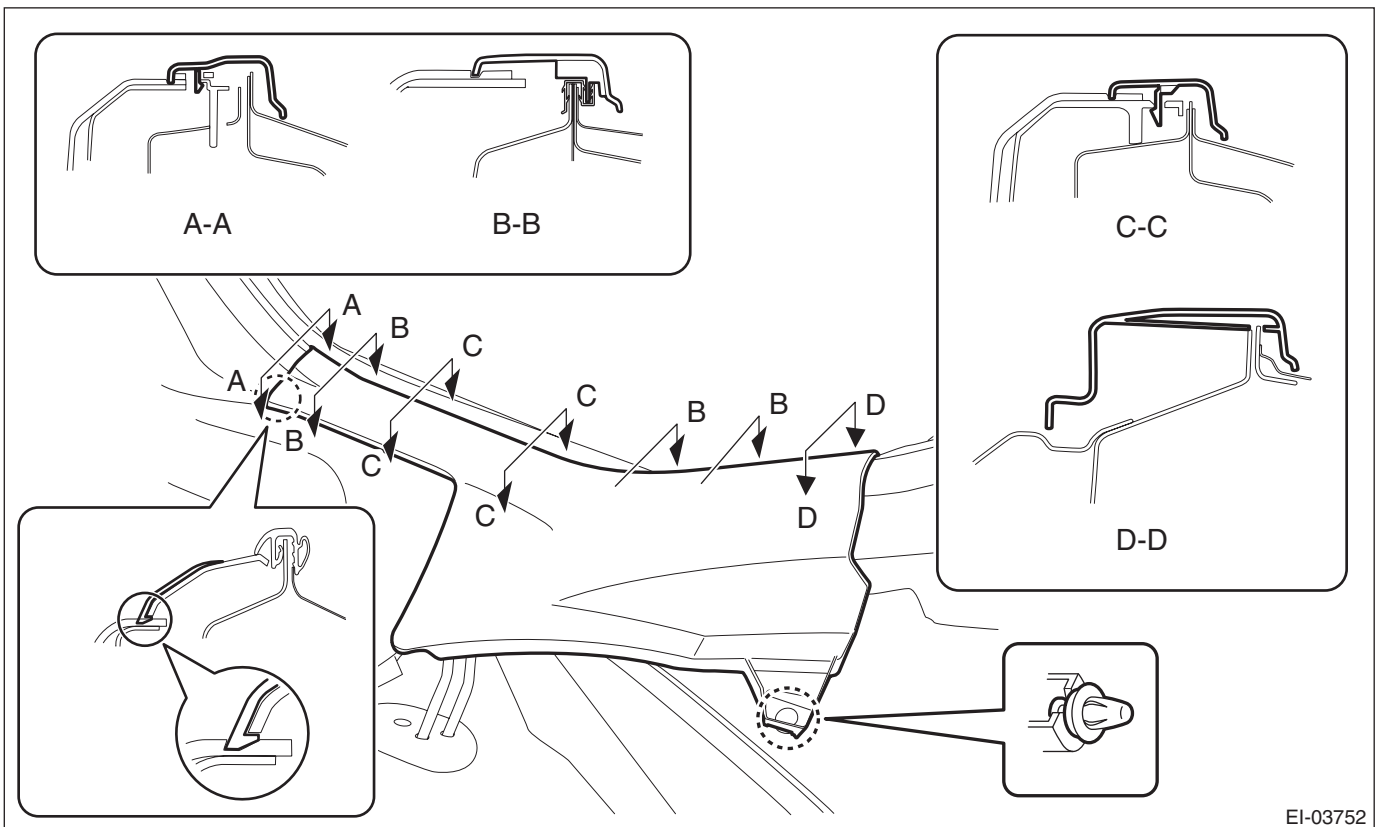

Parking Brake Cable

PARKING BRAKE

6) Remove the clips and knobs of the hook - seat cushion rear.

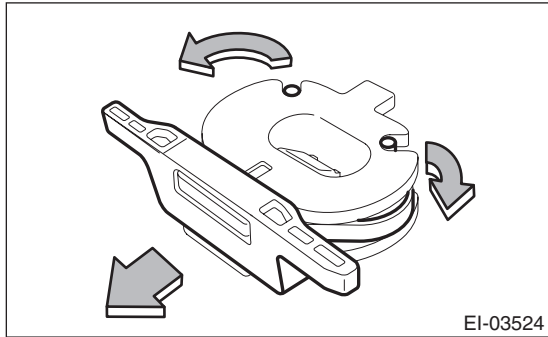

7) Turn over the floor carpet and remove the grommet of the cable assembly - parking brake from the rear floor.

8) Lift up the vehicle, and then remove the rear wheels.

9) Remove the bolt and nuts and remove the fuel tank protector.

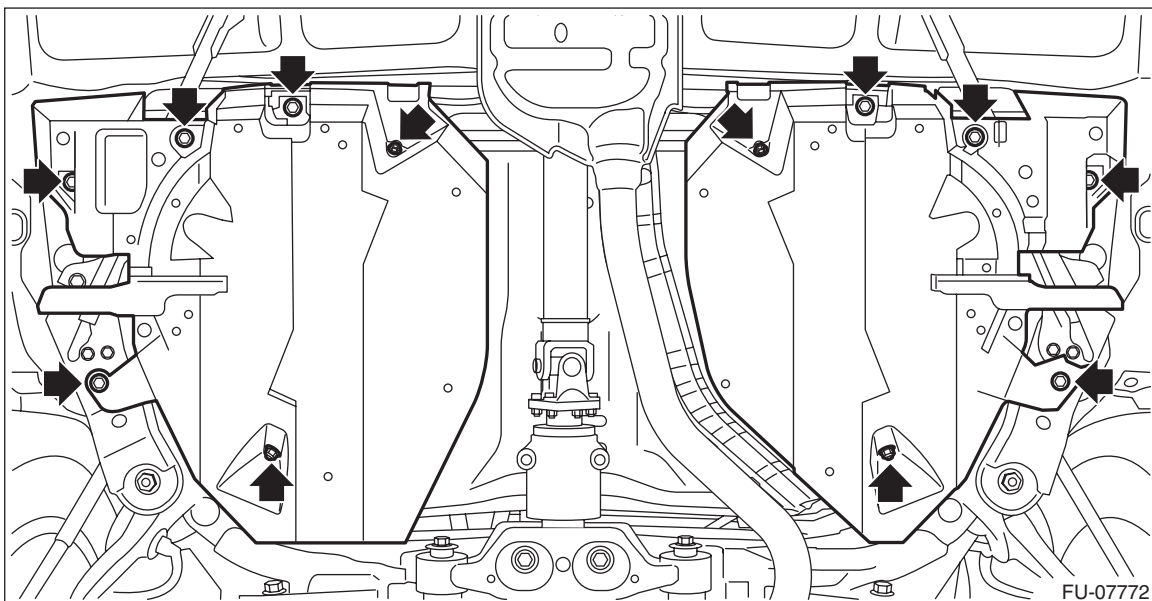

10) Remove the cable assembly - parking brake from the lever section of parking brake shoe. <Ref. to PB-16, REMOVAL, Parking Brake Assembly (Rear Disc Brake).>

11) Remove the exhaust pipe and muffler.

- Center exhaust pipe

Turbo model: <Ref. to EX(H4DOTC)-30, REMOVAL, Center Exhaust Pipe.>

Non-turbo model: <Ref. to EX(H4DO)-14, REMOVAL, Center Exhaust Pipe.>

- Rear exhaust pipe

Turbo model: <Ref. to EX(H4DOTC)-45, REMOVAL, Rear Exhaust Pipe.>

Non-turbo model: <Ref. to EX(H4DO)-18, REMOVAL, Rear Exhaust Pipe.>

- Muffler

Turbo model: <Ref. to EX(H4DOTC)-48, REMOVAL, Muffler.>

Non-turbo model: <Ref. to EX(H4DO)-21, REMOVAL, Muffler.>

12) Remove the bolts to remove the front heat shield cover.

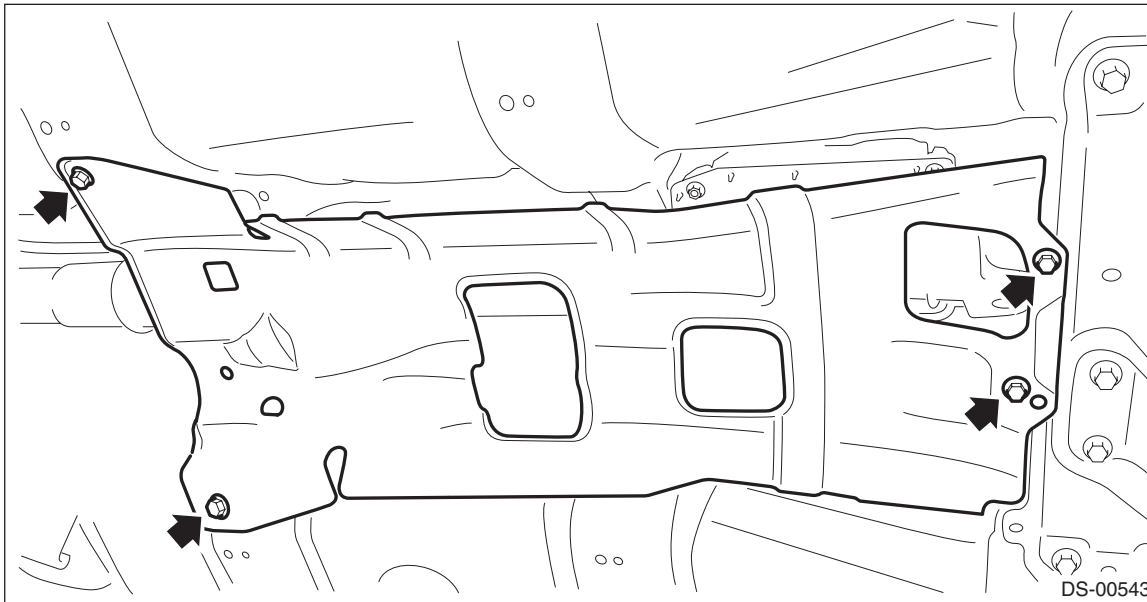

13) Remove the propeller shaft assembly.

CAUTION:

Do not disassemble the propeller shaft.

- (1) Place alignment marks (A) on the flange yoke and rear differential.
- (2) Remove four bolts holding the propeller shaft to the rear differential.

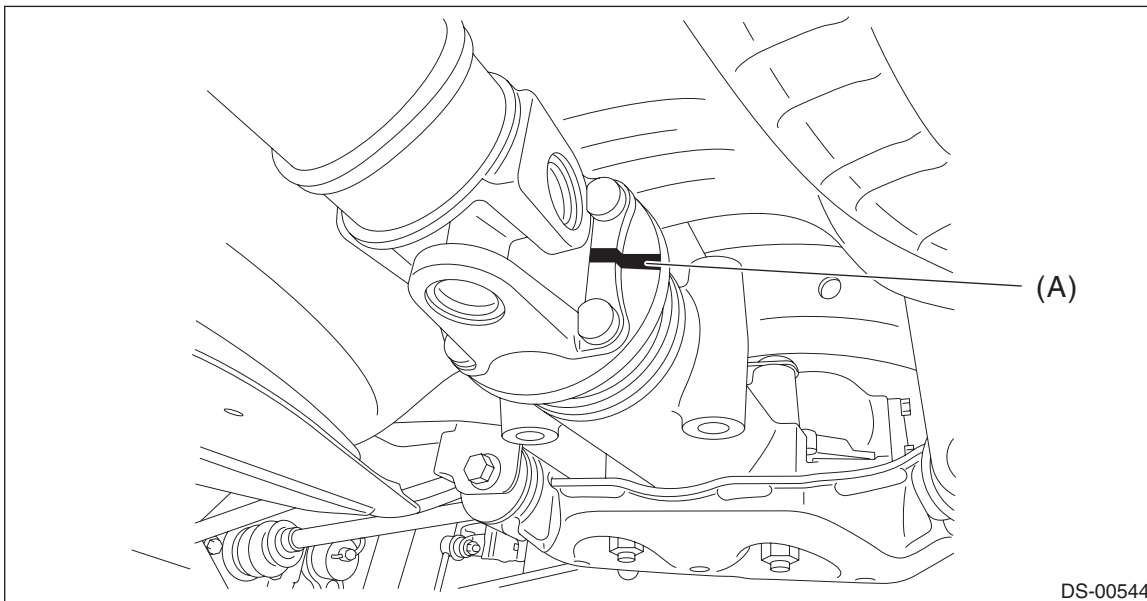

Parking Brake Cable

PARKING BRAKE

(3) Remove the center bearing.

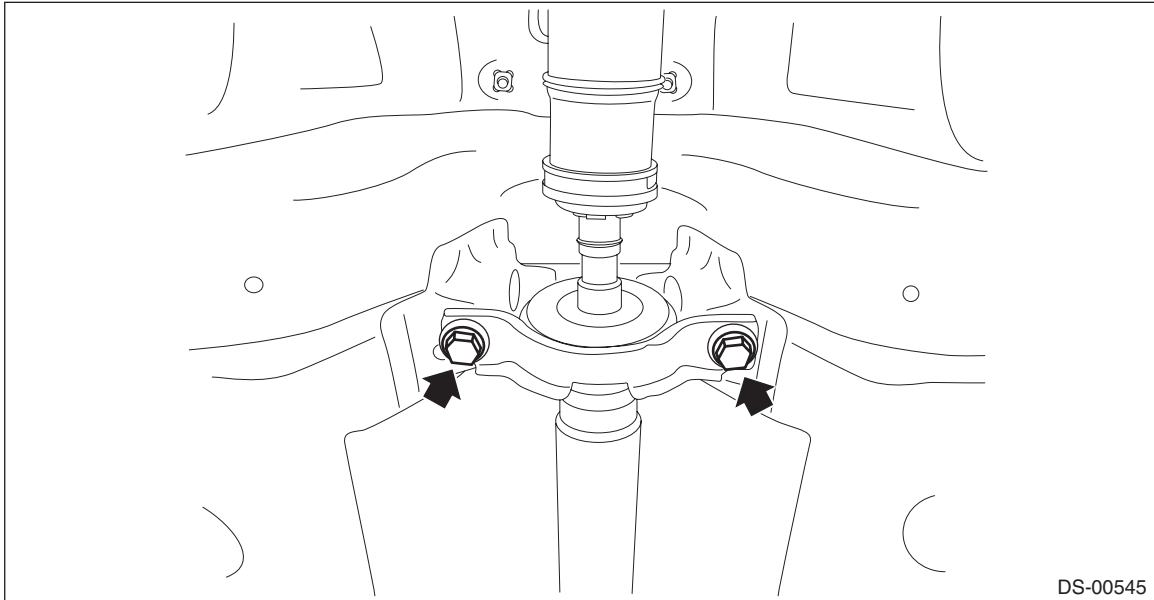

(4) Remove the propeller shaft from transmission.

CAUTION:

Be careful not to damage oil seals and contact surface of the sleeve yoke.

NOTE:

- Use a container to catch ATF or oil flowing from propeller shaft.
- To prevent ATF from leaking, install extension cap etc. to the transmission.

14) Remove the clamp B - hand brake cable (a) from the rear brake.

15) Remove the cable clamp (b) from the back plate - rear brake.

16) Remove the cable clamp (c) from the rear floor, and remove the cable assembly - parking brake.

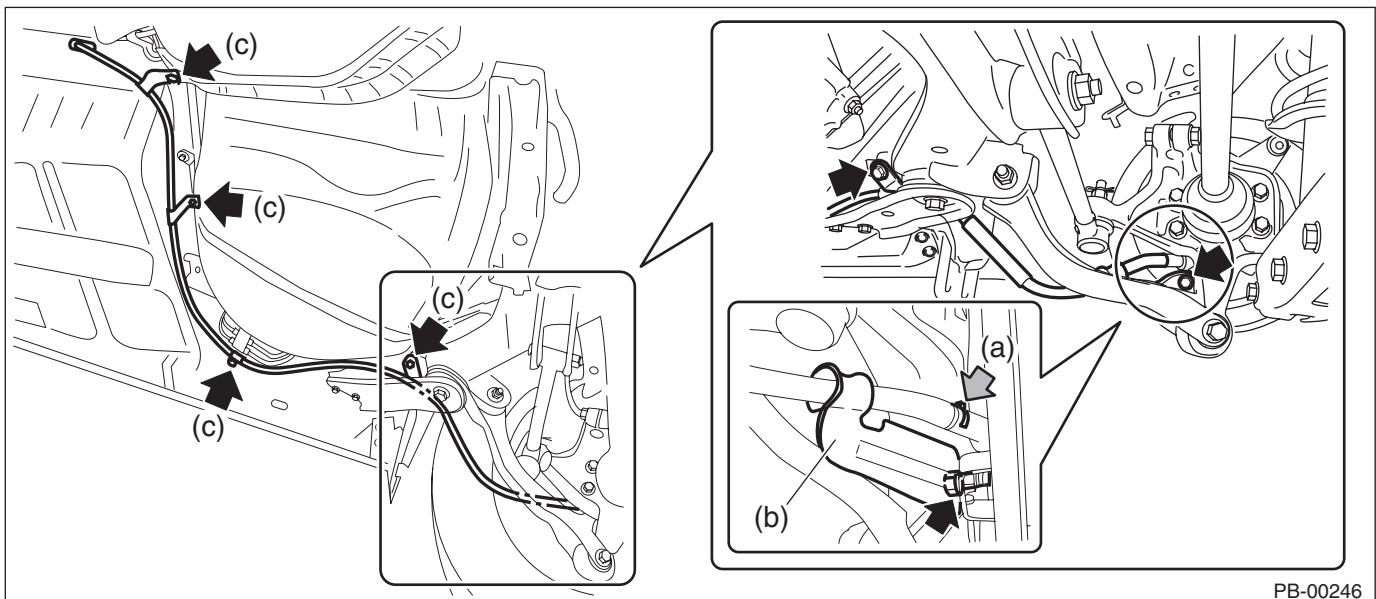

B: INSTALLATION

1) Install each part in the reverse order of removal.

CAUTION:

Do not reuse the nut (self locking nut). Always replace with a new part.

Tightening torque:

Protector - fuel tank nut: 9 N·m (0.92 kgf-m, 6.6 ft-lb)

Protector - fuel tank bolt: 18 N·m (1.84 kgf-m, 13.3 ft-lb)

Cable clamp: 18 N·m (1.84 kgf-m, 13.3 ft-lb)

Rear wheel: 120 N·m (12.24 kgf-m, 88.5 ft-lb)

NOTE:

- Apply grease to the cable guide inside the tunnel, and pass the cable through.
 - After installing the backrest assembly, make sure that each seat belt operates normally.
 - Make sure that they are properly secured on each hook on the vehicle side.
- 2) Be sure to adjust the lever stroke. <Ref. to PB-9, ADJUSTMENT, Parking Brake Lever.>

C: INSPECTION

Check the removed cable and replace if damaged, rusty or malfunctioning.

- 1) Check the cable for smooth operation.
- 2) Check the inner cable for damage and rust.
- 3) Check the outer cable for damage, bends and cracks.