

6. Washer Tank and Motor

A: REMOVAL

1. WASHER TANK

- 1) Open the hood COMPL - front.
- 2) Disconnect the ground cable from battery.
- 3) Remove the bumper face - front.
 - (1) Remove the screws and clips, and turn over the mud guard - front, and then disconnect the connectors of the fog light assembly - front on the LH and RH sides. (Model with fog light)

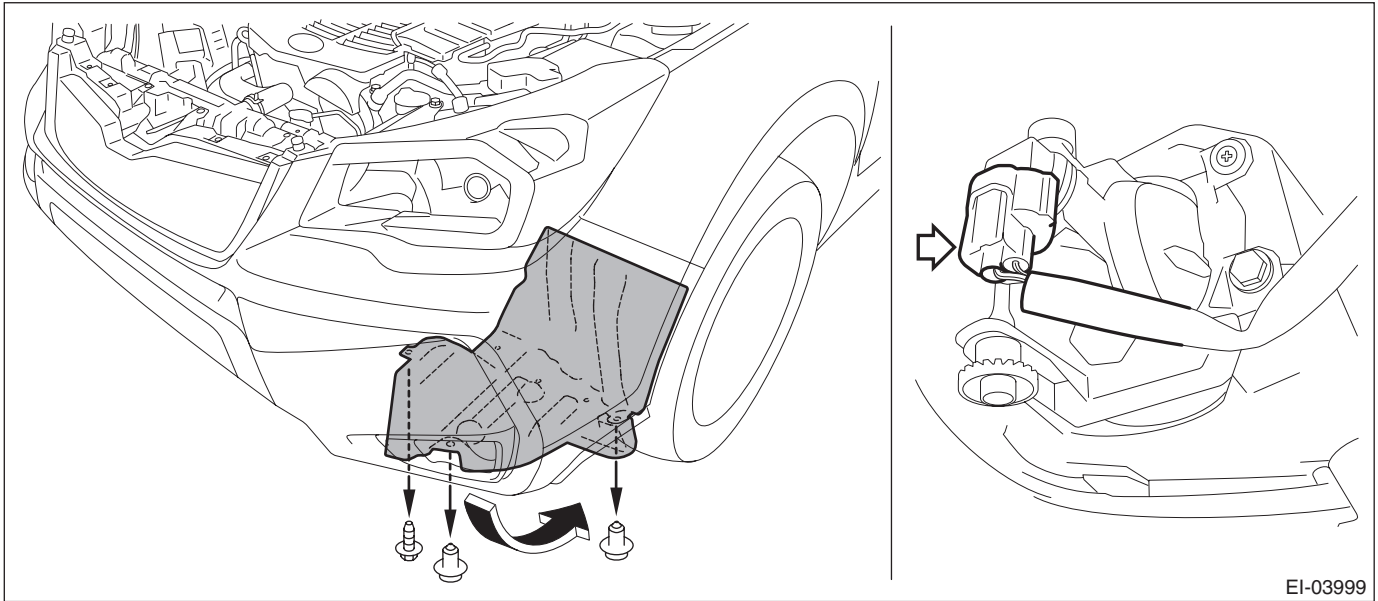

- (2) Remove the clips at the upper side of the bumper face - front.
- (3) Remove the clips from the fender.

WIPER AND WASHER SYSTEMS

[illegible]

(6) Release the clips, and while pushing up the lower side (a) of the bumper face - front, remove in the order from (b) to (e).

Do not pull forcibly. It may damage the flange sections of the bumper face - front.

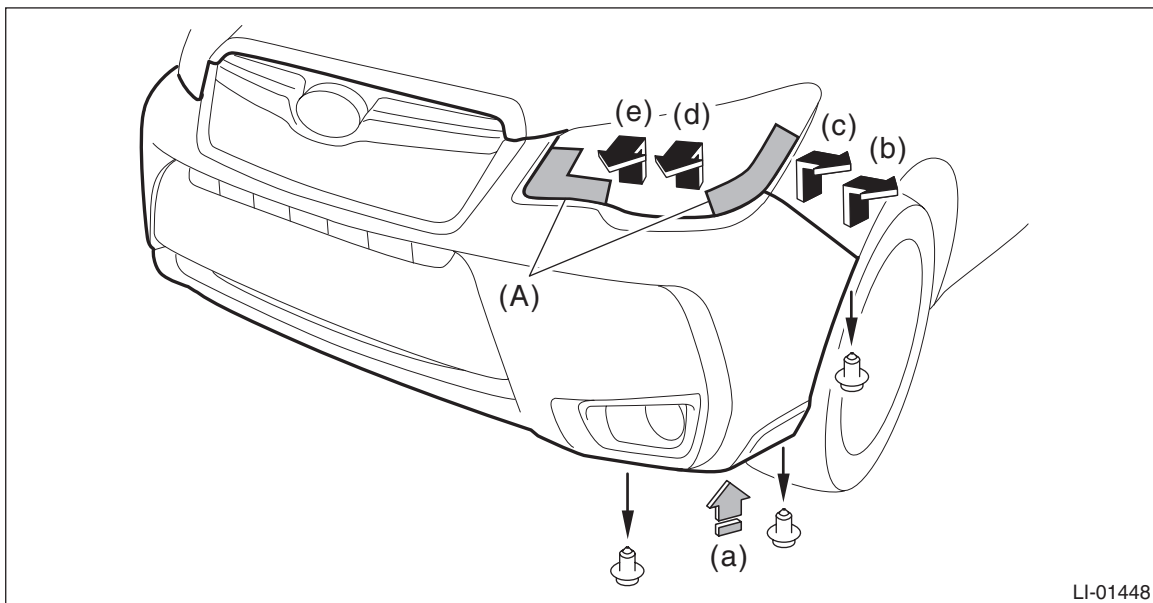

Detach the opposite side in the same manner.

4) Remove the tank - washer assembly.

(1) Remove the clip of the holder - windshield washer tank.

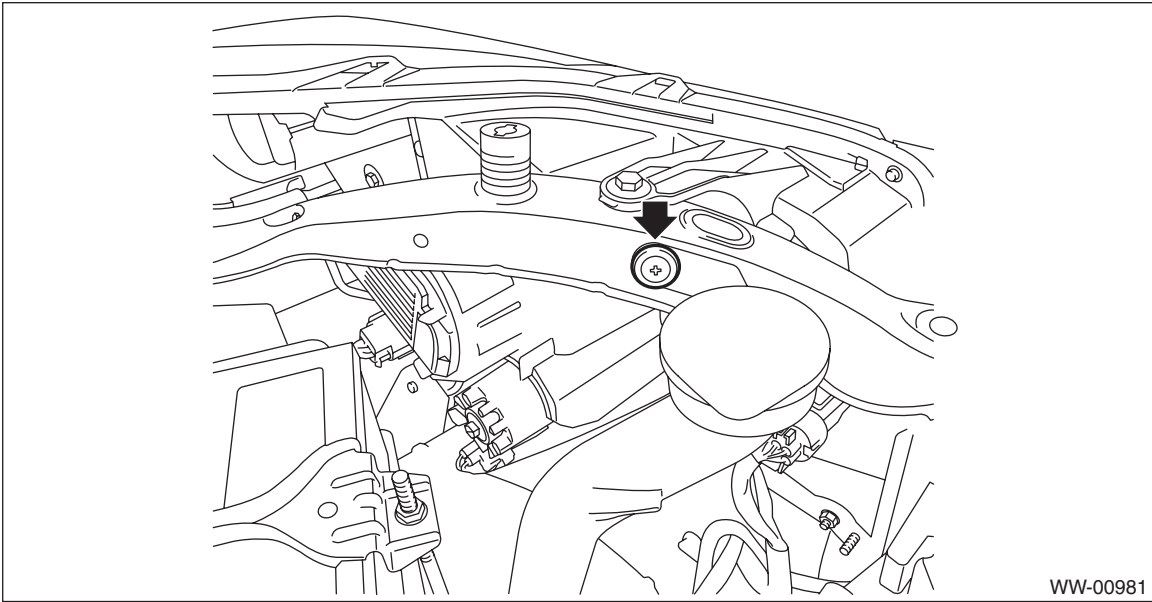

(2) Disconnect the connector from the motor pump assembly - washer and the sensor - washer tank, and then remove the harness clip.

(3) Prepare a container before disconnecting the hose - washer, and drain all washer fluid in the tank - washer.

(4) Remove the bolt and nuts and remove the tank - washer assembly.

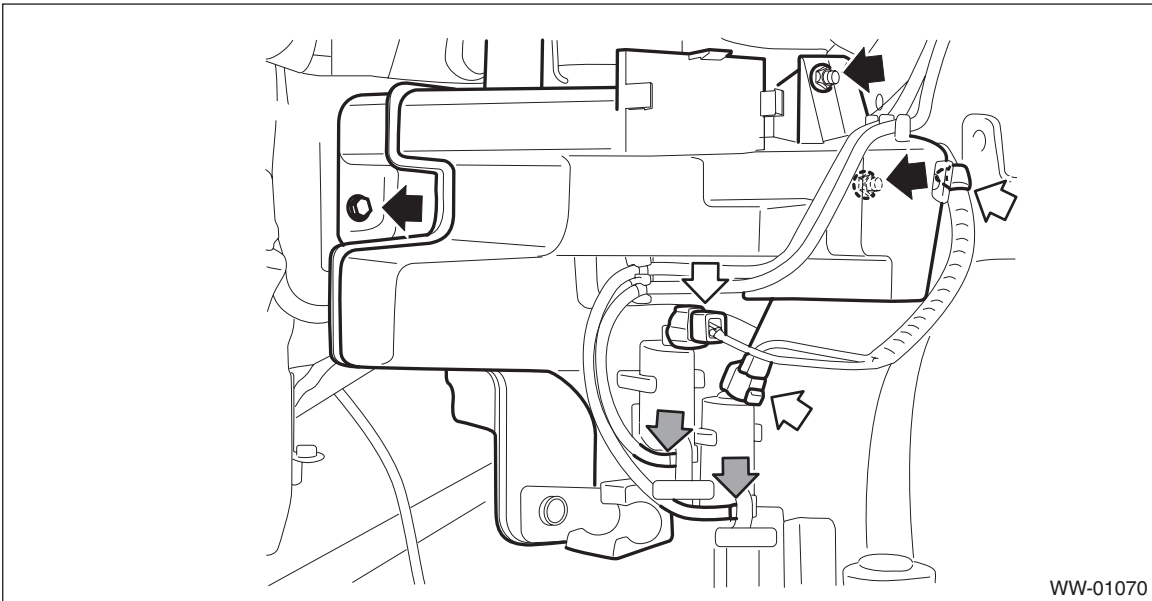

Washer Tank and Motor

WIPER AND WASHER SYSTEMS

2. WASHER MOTOR

- 1) Open the hood COMPL - front.
- 2) Disconnect the ground cable from battery.
- 3) Remove the screw and clips, and turn over the mud guard - front LH.
- 4) Disconnect the connector of the fog light assembly - front LH. (Model with fog light)

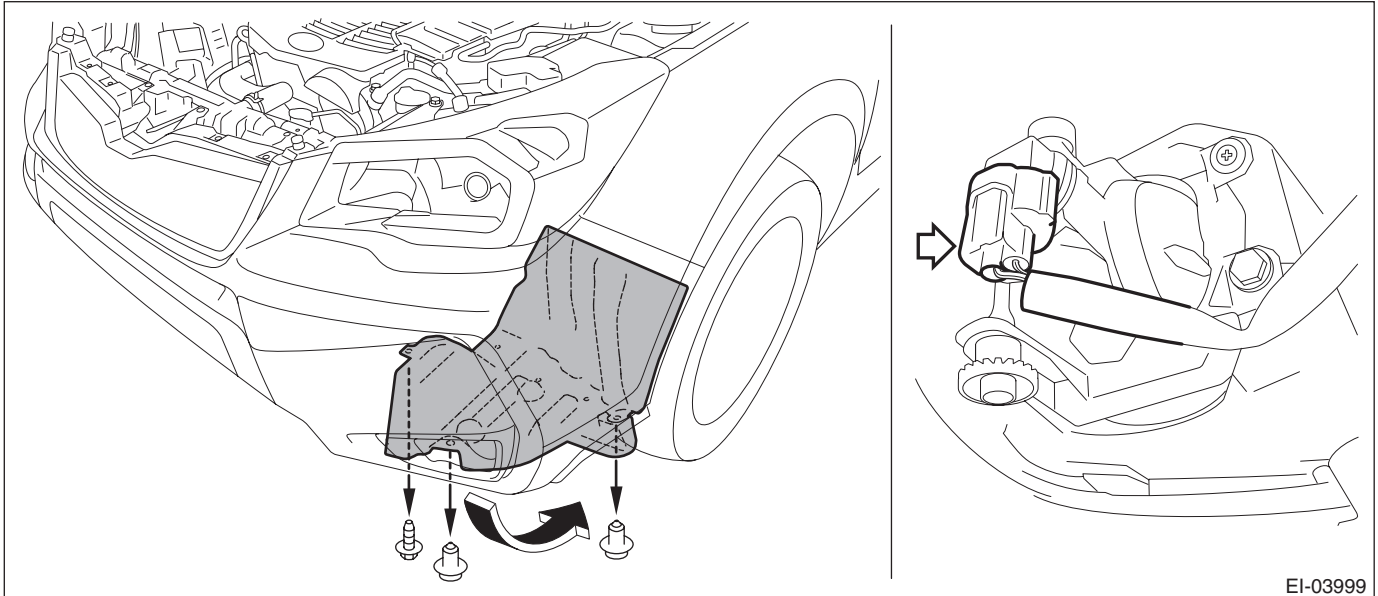

- 5) Disconnect the connector from the motor pump assembly - washer and remove the harness clip.
- 6) Prepare a container before disconnecting the hose - washer, and drain all washer fluid in the tank - washer.
- 7) Remove the motor pump assembly - washer from the tank - washer.

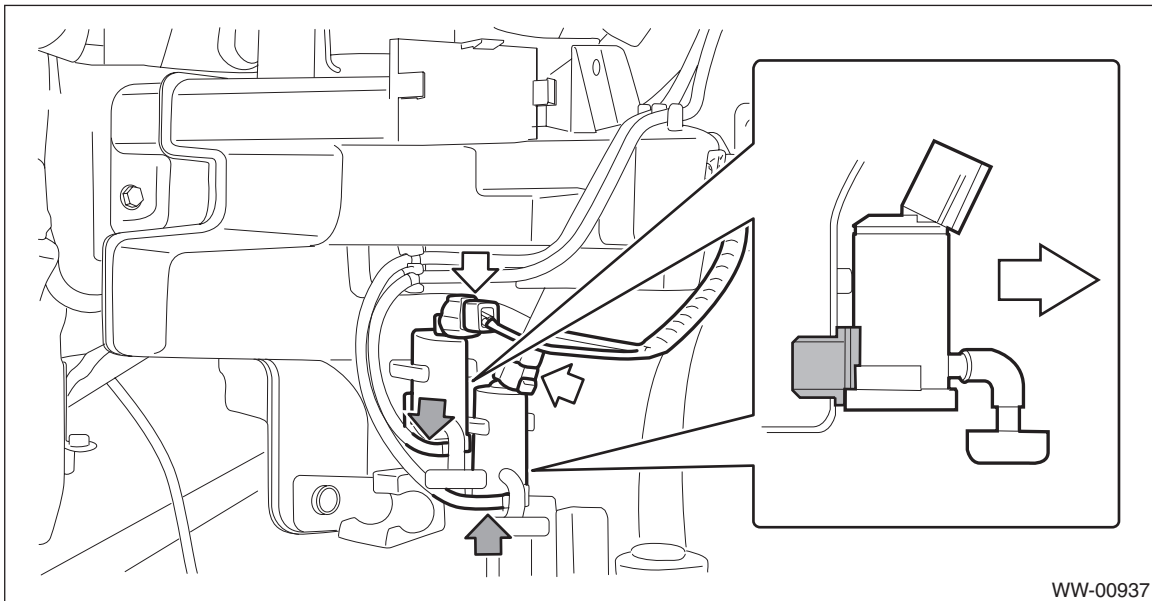

B: INSTALLATION

1) Install each part in the reverse order of removal.

Tightening torque:

6 N·m (0.61 kgf-m, 4.4 ft-lb)

2) Add new washer fluid.

3) Adjust the fog light beam. (Model with fog light) <Ref. to LI-47, FOG LIGHT AIMING, ADJUSTMENT, Front Fog Light Assembly.>

C: INSPECTION

1. WASHER PUMP

Apply battery voltage to the connector terminal of the motor pump assembly - washer, and make sure that the motor operates.

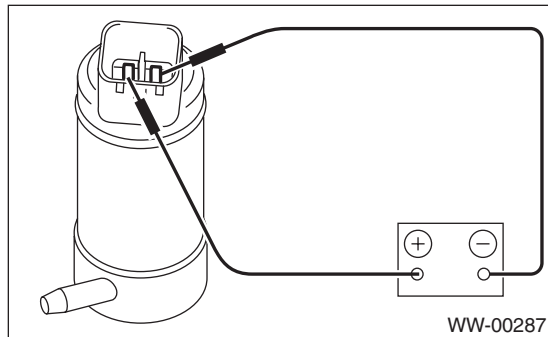

2. WASHER FLUID LEVEL SENSOR

1) Check the connection status of washer fluid level sensor connector.

2) Does the low washer fluid warning light illuminate after draining the washer fluid? And does the low washer fluid warning light go off after refilling the washer fluid?

- **Yes** → **Normal operation.**

- **No** → **Perform step 3.**

3) Using a tester, measure the voltage of the washer fluid level sensor connector.

(1) Is the voltage approx. 8.5 V or more?

- **Yes** → **Perform step 4.**

- **No** → **Check harness, meter and integrated unit, and replace if necessary.**

4) Does the meter indicator illuminate if you short the washer fluid level sensor connector?

- **Yes** → **Perform step 5.**

- **No** → **Check meter and integrated unit, and replace if necessary.**

Washer Tank and Motor

WIPER AND WASHER SYSTEMS

- 5) Using a tester, measure the resistance of the washer fluid level sensor.
- (1) Turn over the mud guard.
 - (2) Measure the resistance of the washer fluid level sensor.

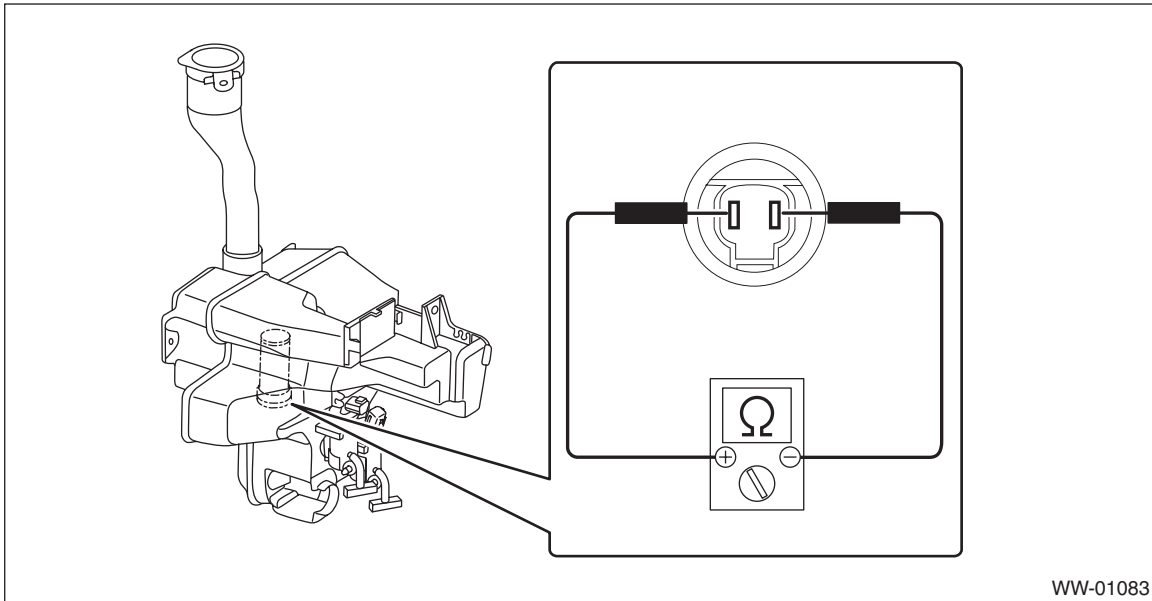

Amount of washer fluid in the tank	Standard
No remaining quantity (ON)	Less than 10 Ω
There is remaining quantity (OFF)	1 MΩ or more

(3) Is the resistance within the standard?

- **Yes** → **Normal operation.**
- **No** → **Replace the washer fluid level sensor along with the washer tank.**