

8. Rear Drive Shaft Boots

A: INSPECTION

Inspect the wear, warping, breakage or scratches for boot. If faulty, repair or replace.

B: REPLACEMENT

- 1) Disconnect the ground terminal from battery.
- 2) Lift-up the vehicle, and remove the rear wheel cap and wheels.

NOTE:

Axle nut need not be removed.

- 3) Remove the ABS sensor clamps and parking brake cable bracket.
- 4) Disconnect the stabilizer link from the lateral link.
- 5) Remove the bolts which secure lateral link assembly to the rear housing.
- 6) Remove the bolts which secure trailing link assembly to the rear housing.
- 7) Remove the DOJ from rear differential using ST.

ST 28099PA100 DRIVE SHAFT REMOVER

NOTE:

The side spline shaft circlip comes out together with the shaft.

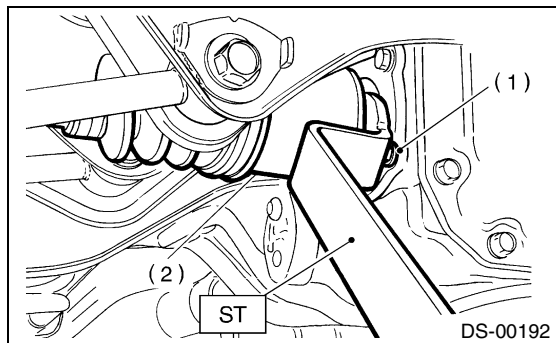

- (1) Bolt
- (2) DOJ

CAUTION:

Be careful not to damage the side bearing retainer. Always use bolt as shown in figure, as supporting point for ST during removal.

ST 28099PA100 DRIVE SHAFT REMOVER

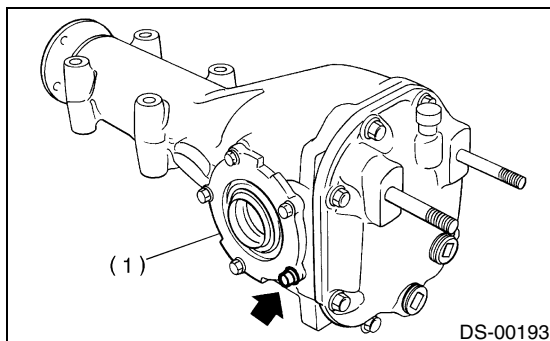

- (1) Side bearing retainer

- 8) Remove the DOJ and BJ or EBJ boots from the drive shaft. <Ref. to DS-41, DISASSEMBLY, Rear Drive Shaft.>

- 9) Install the DOJ and BJ or EBJ boots to the drive shaft. <Ref. to DS-42, ASSEMBLY, Rear Drive Shaft.>

- 10) Using ST, install the DOJ into differential.

ST 28099PA090 SIDE OIL SEAL PROTECTOR

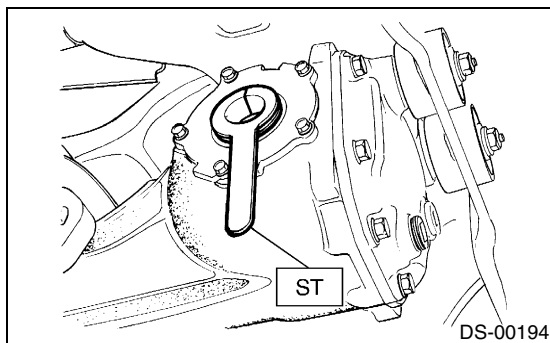

11) Insert the DOJ spline end into the bore of side oil seal, and remove ST.

CAUTION:

Do not allow DOJ splines to damage side oil seal.

ST 28099PA090 SIDE OIL SEAL PROTECTOR

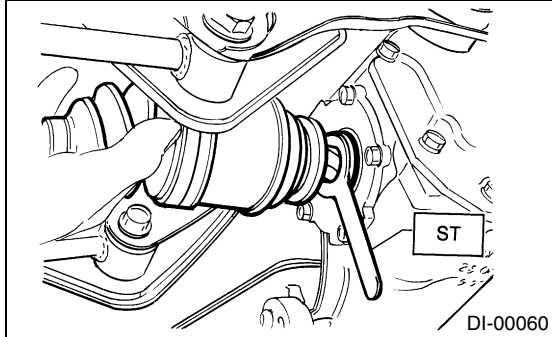

12) Align the DOJ and differential splines.

13) Push the housing to insert DOJ into the differential.

NOTE:

- Make sure the DOJ is inserted properly.

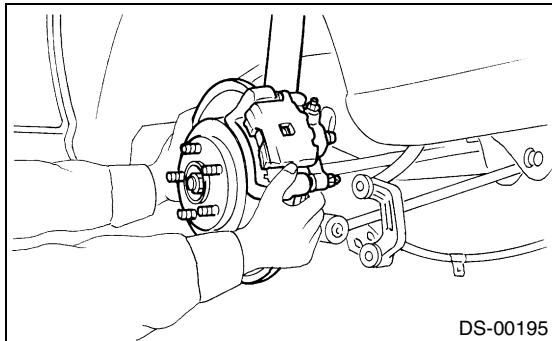

CAUTION:

Discard old self-locking nut. Replace with a new one.

14) Connect the rear housing assembly to the trailing link assembly, and tighten the self-locking nut.

15) Connect the rear housing assembly to the lateral link assembly, and tighten the self-locking nut.

16) Connect the stabilizer link to the lateral link.

17) Install the ABS sensor clamps and parking brake cable bracket.