

5. Spark Plug

A: REPLACEMENT

Spark plug:

Refer to "SPECIFICATION" for spark plug.
 <Ref. to SPC-2, ELECTRICAL, Impreza.>

1. RH SIDE

- 1) Disconnect the ground cable from battery.

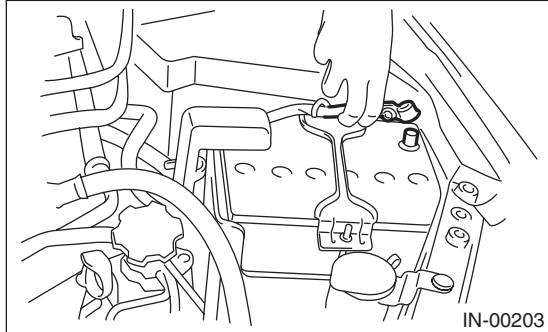

- 2) Remove the air cleaner case. <Ref. to IN(H4SO)-5, REMOVAL, Air Cleaner Case.>

- 3) Remove the spark plug cords by pulling the boot. (Do not pull the cord itself.)

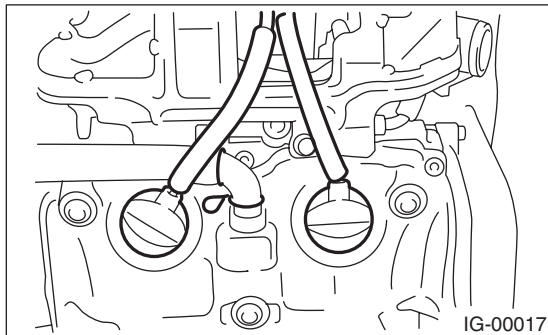

- 4) Remove the spark plug with a spark plug socket.

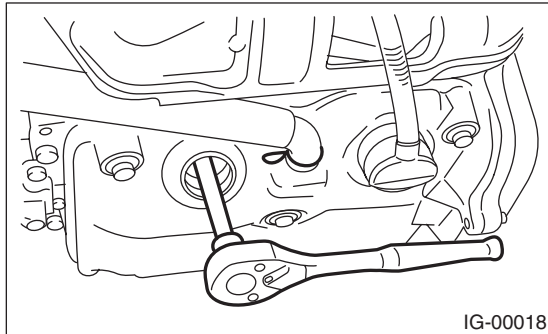

- 5) Install in the reverse order of removal.

Tightening torque:

21 N·m (2.1 kgf-m, 15.5 ft-lb)

2. LH SIDE

- 1) Remove the battery. <Ref. to SC(H4SO)-22, REMOVAL, Battery.>

- 2) Remove the spark plug cords by pulling the boot. (Do not pull the cord itself.)

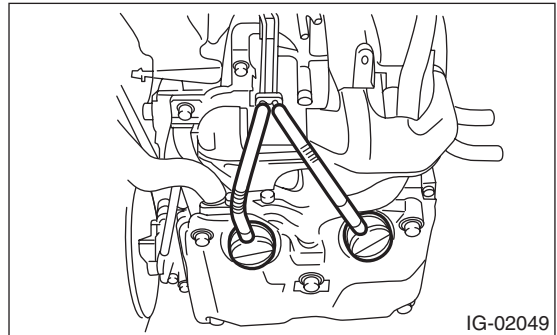

- 3) Remove the spark plug with a spark plug socket.

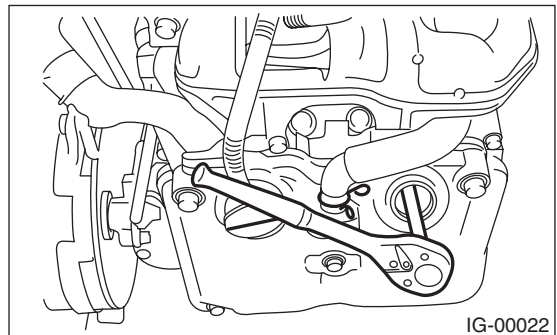

- 4) Install in the reverse order of removal.

Tightening torque:

21 N·m (2.1 kgf-m, 15.5 ft-lb)