

Drum brake: Perform steps 9) through 11).

9) Clean brake pipe connection. Using a flare-nut wrench, connect brake pipe to wheel cylinder.

10) Connect parking brake cable to lever.

11) Install brake drum on rear housing assembly.

12) Bleed air from brake system. <Ref. to 4-4 [W11B0].>

13) Adjust parking brake lever stroke by turning adjuster.

14) Move brake lever back to apply brakes. While depressing brake pedal, tighten axle nut using a socket wrench. Lock axle nut after tightening.

**Tightening torque:**

***186±20 N·m (19±2 kg-m, 137±14 ft-lb)***

**CAUTION:**

- Use a new axle nut.
- Always tighten axle nut before installing wheel on vehicle. If wheel is installed and comes in contact with ground when axle nut is loose, wheel bearings may be damaged.
- Be sure to tighten axle nut to specified torque. Do not overtighten it as this may damage wheel bearing.

15) Install wheel and tighten wheel nuts to specified torque.

**Tightening torque:**

***88±10 N·m (9±1 kg-m, 65±7 ft-lb)***

### 3. Rear Axle (FWD Model)

#### A: REMOVAL

1) Disconnect ground cable from battery.

2) Jack-up vehicle, and remove rear wheel cap and wheels.

**CAUTION:**

**Be sure to loosen and retighten axle nut after removing wheel from vehicle. Failure to follow this rule may damage wheel bearings.**

3) Pry hub cap off with a screwdriver placed between it and hub.

4) Unlock axle nut.

5) Remove axle nut using a socket wrench. Remove washer.

**CAUTION:**

**Do not re-use old axle nut. Replace with a new one.**

**NOTE:**

Temporarily tighten axle nut to hold hub in place.

## 3. Rear Axle (FWD Model)

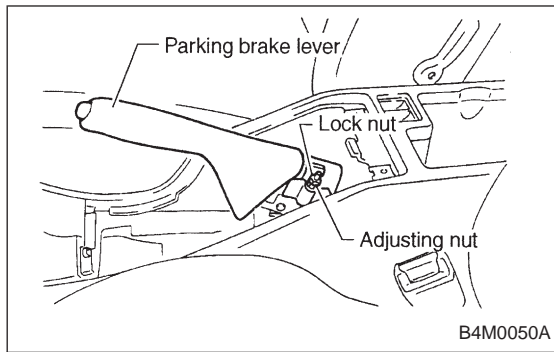

- 6) Return parking brake lever and loosen adjusting nut.  
 (1) Disc brake: Perform steps 7) through 9).  
 (2) Drum brake: Perform steps 10) through 13).

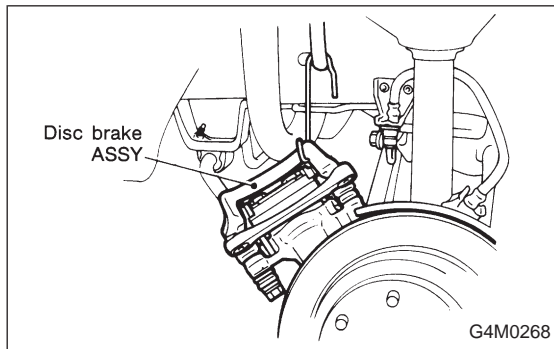

- 7) Remove disc brake assembly from back plate. Suspend disc brake assembly from strut using a wire.

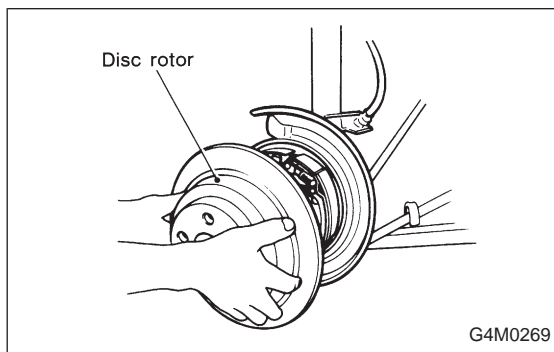

- 8) Remove disc rotor from hub.  
 If disc rotor seizes up within hub, drive it out by installing an 8-mm bolt in bolt hole on disc rotor.  
 9) Disconnect end of parking brake cable.

- 10) Remove brake drum from hub.

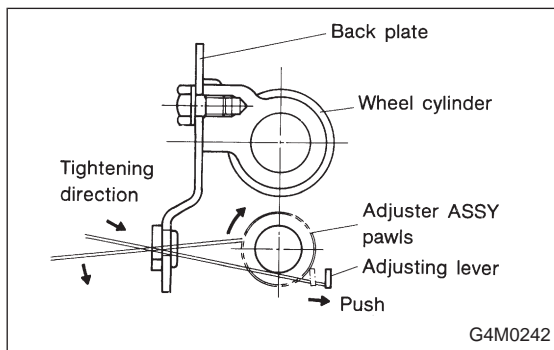

- 11) If it is difficult to remove brake drum, remove adjusting hole cover from back plate, and then turn adjusting screw using a slot-type screwdriver until brake shoe separates from the drum.

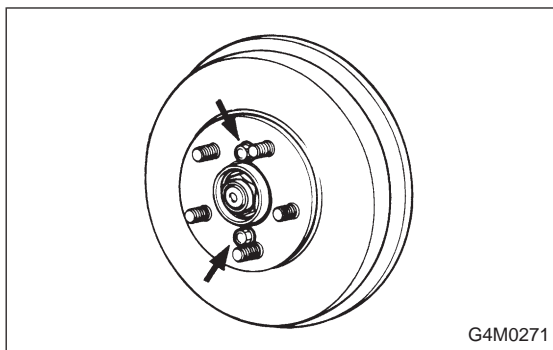

**NOTE:**  
If brake drum seizes up within hub, drive it out by installing an 8-mm bolt in bolt hole on brake drum.

- 12) Disconnect end of parking brake cable.
- 13) Using a flare-nut wrench, disconnect brake pipe from wheel cylinder.

**CAUTION:**  
Cover brake pipe connection to prevent entry of foreign particles.

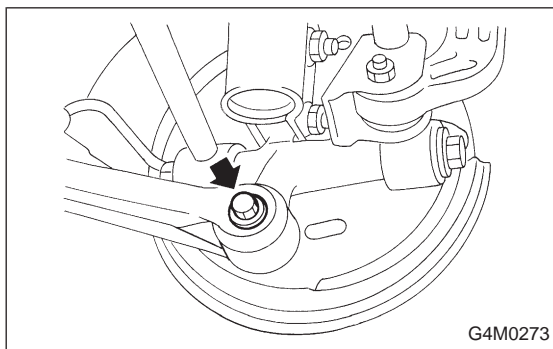

- 14) Remove bolts which secure trailing link assembly to rear spindle.

**CAUTION:**  
Discard old self-locking nut. Replace with a new one.

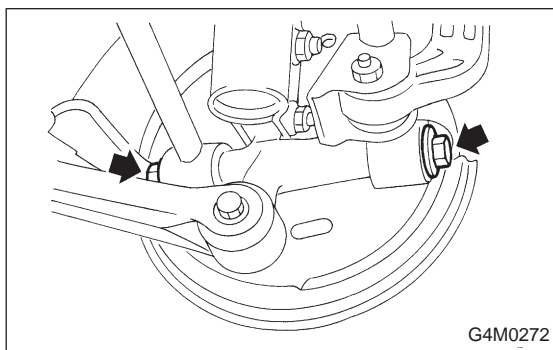

- 15) Remove bolts which secure lateral link assembly to rear spindle.

**CAUTION:**  
Discard old self-locking nut. Replace with a new one.

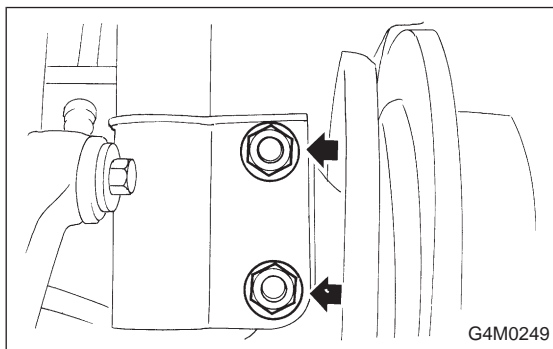

- 16) Remove bolts which secure strut assembly to rear spindle.  
Remove rear spindle, back plate and hub as a unit.

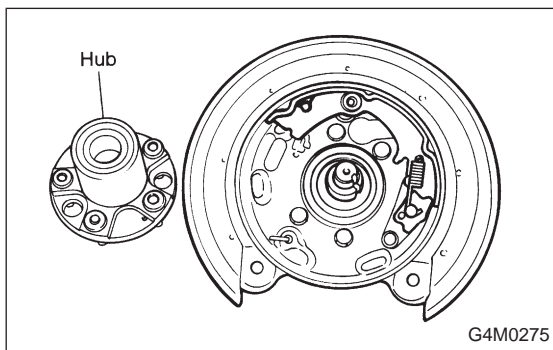

**B: DISASSEMBLY**

- 1) Remove hub from rear spindle.

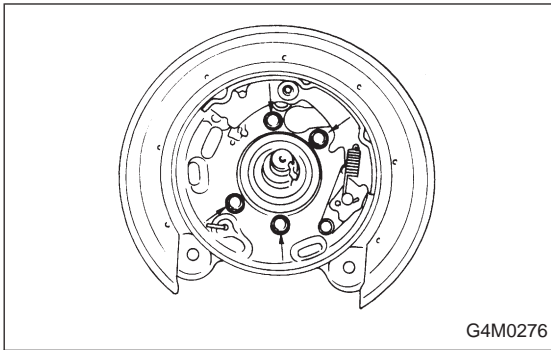

2) Remove back plate from rear spindle.

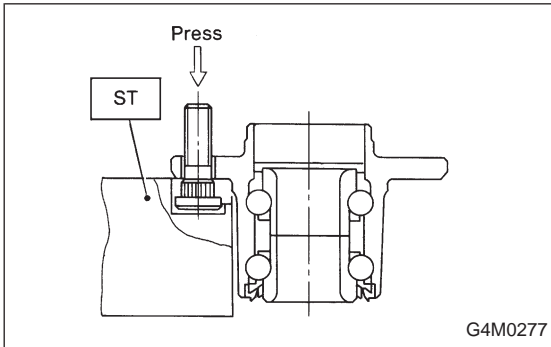

3) Using ST, press hub bolts out.

**CAUTION:**

**Do not hammer hub bolt since this may deform hub.**

ST 927080000 HUB STAND

**C: INSPECTION**

Clean the removed parts and check them for wear, damage and corrosion. If faulty, replace.

**CAUTION:**

**Hub unit cannot be disassembled. If faulty, replace it as a unit.**

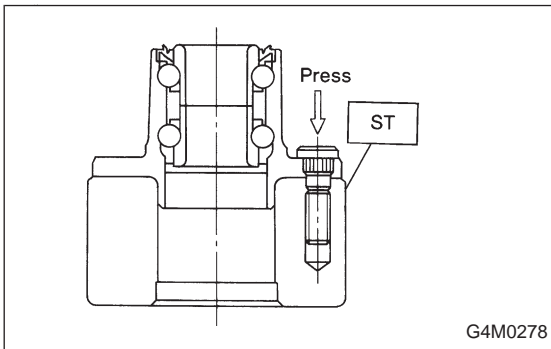

**D: ASSEMBLY**

1) Using ST, press new hub bolts into place.

**NOTE:**

- Use a 12 mm (0.47 in) hole in ST to prevent hub bolt from tilting during installation.
- Ensure hub bolt closely contacts hub.

ST 927080000 HUB STAND

2) Completely clean dust or dirt from the mating/polished surface of rear spindle back plate.

3) Install back plate to rear spindle.

**Tightening torque:**

**$52 \pm 6$  N·m ( $5.3 \pm 0.6$  kg·m,  $38.3 \pm 4.3$  ft·lb)**

4) Charge oil seal located on the rear of hub with grease.

**Specified grease:**

**SHELL 6459N**

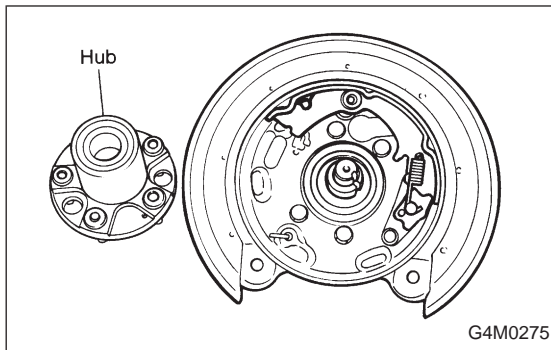

5) Install hub on rear spindle. Temporarily tighten axle nut and washer to hold hub in place.

**CAUTION:**

**Discard old axle nut. Replace with a new one.**

**E: INSTALLATION**

1) Connect rear spindle assembly to strut assembly.

**Tightening torque:**

**$147\pm 15$  N·m ( $15\pm 1.5$  kg·m,  $108\pm 11$  ft·lb)**

**CAUTION:**

**Use a new self-locking nut.**

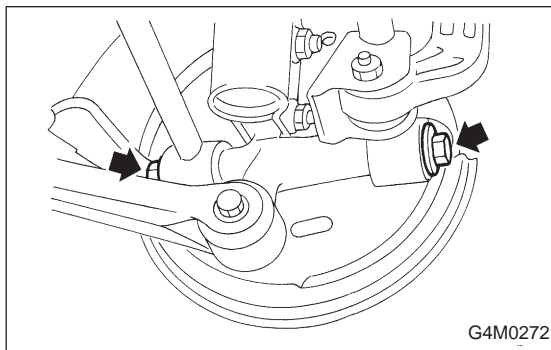

2) Connect rear spindle assembly to lateral link assembly.

**Tightening torque:**

**$137\pm 20$  N·m ( $14\pm 2$  kg·m,  $101\pm 14$  ft·lb)**

**CAUTION:**

**Use new self-locking nut.**

3) Connect rear spindle assembly to trailing link assembly.

**Tightening torque:**

**$113\pm 15$  N·m ( $11.5\pm 1.5$  kg·m,  $83\pm 11$  ft·lb)**

**CAUTION:**

**Use a new self-locking nut.**

Disc brake: Perform steps 4) through 6).

4) Connect end of parking brake cable.

5) Install disc rotor to hub unit.

6) Install disc brake assembly to back plate.

**Tightening torque:**

**$52\pm 6$  N·m ( $5.3\pm 0.6$  kg·m,  $38.3\pm 4.3$  ft·lb)**

Drum brake: Perform steps 7) through 10).

7) Completely clean brake pipe connection. Using a flare-nut wrench, connect brake pipe to wheel cylinder.

8) Connect parking brake cable to lever.

9) Install brake drum on hub unit.

10) Bleed air from brake system. <Ref. to 4-4 [W11B0].>

11) Tighten axle nut using a socket wrench, and lock securely.