

## 4. Oil Pump

### A: REMOVAL

- 1) Set the vehicle on a lift.
- 2) Remove the collector cover.
- 3) Disconnect the ground cable from the battery.

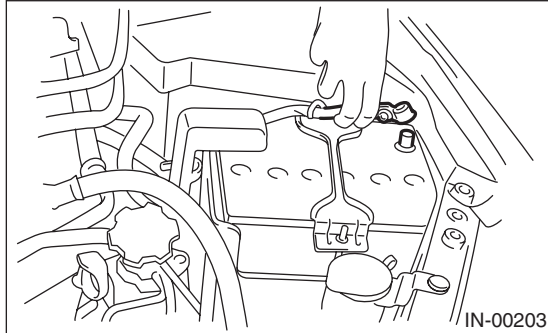

- 4) Lift up the vehicle.
- 5) Remove the under cover.
- 6) Remove the bolts which install water pipe of oil cooler to oil pump.

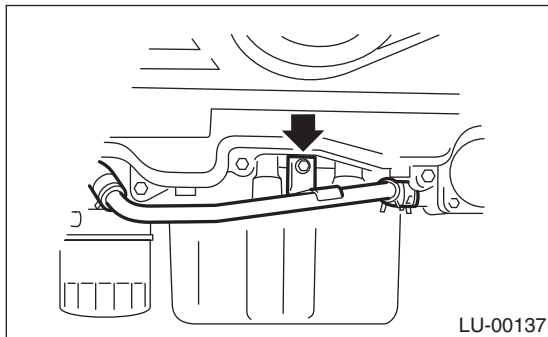

- 7) Remove the water pipe and hoses between oil cooler and water pump.

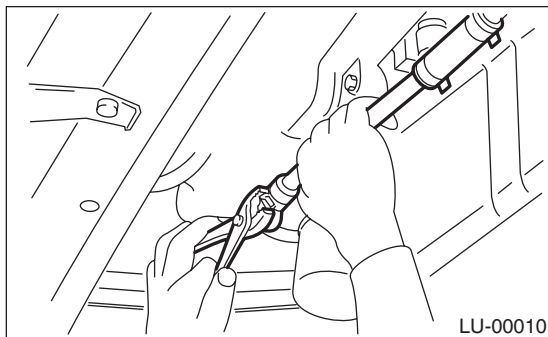

- 8) Lower the vehicle.
- 9) Remove the radiator. <Ref. to CO(H4DOTC)-19, REMOVAL, Radiator.>

- 10) Remove the crankshaft position sensor.

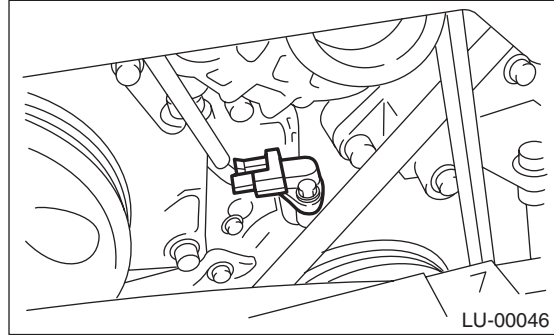

- 11) Remove the V-belts. <Ref. to ME(H4DOTC)-37, REMOVAL, V-belt.>

- 12) Remove the belt tensioner.

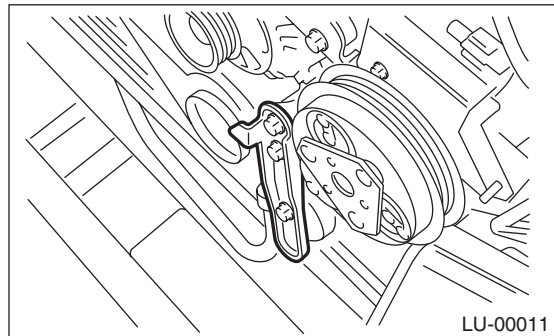

- 13) Remove the crank pulley using ST. <Ref. to ME(H4DOTC)-40, REMOVAL, Crank Pulley.>

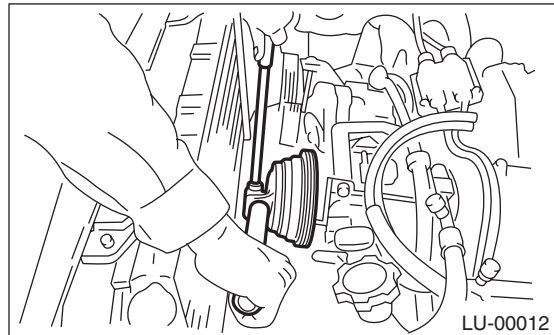

- 14) Remove the water pump. <Ref. to CO(H4DOTC)-15, REMOVAL, Water Pump.>

- 15) Remove the timing belt guide. (MT model)

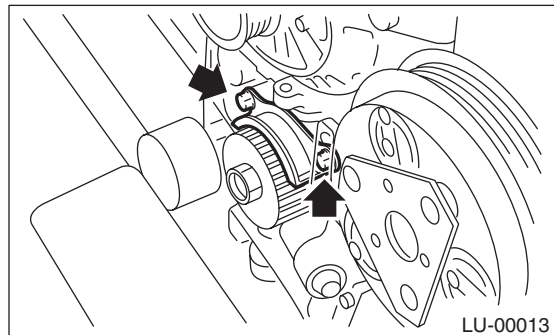

# Oil Pump

## LUBRICATION

16) Remove the crank sprocket.

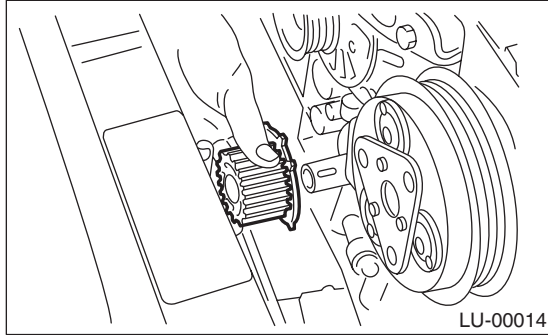

17) Remove the bolts which install oil pump onto cylinder block.

### NOTE:

When disassembling and checking the oil pump, loosen the relief valve plug before removing the oil pump.

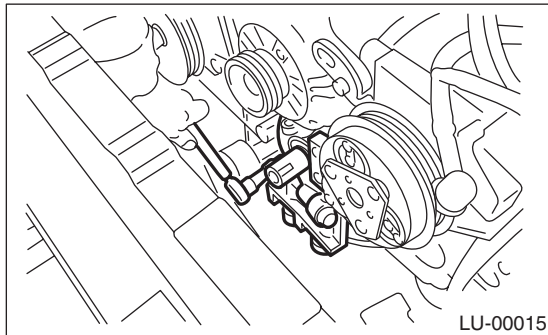

18) Remove the oil pump by using flat tip screwdriver.

### CAUTION:

Be careful not to scratch mating surfaces of cylinder block and oil pump.

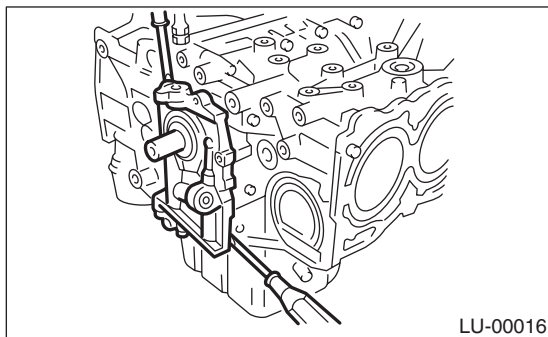

## B: INSTALLATION

Install in the reverse order of removal.  
Perform the following.

1) Using the ST, install the front oil seal.  
ST 499587100 OIL SEAL INSTALLER

### NOTE:

Use a new oil seal.

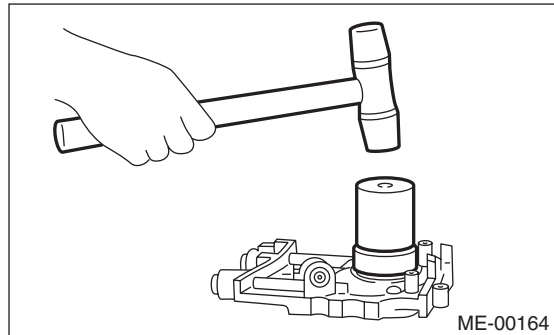

2) Apply liquid gasket to the matching surface of oil pump.

### Liquid gasket:

**THREE BOND 1215 (Part No. 004403007) or equivalent**

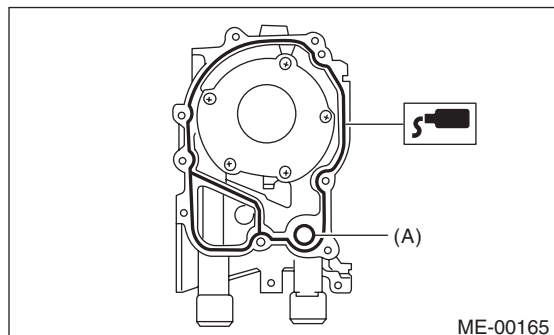

(A) O-ring

3) Apply a coat of engine oil to the inside of oil seal.

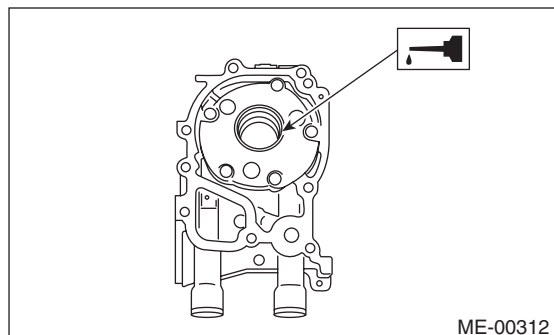

4) Install the oil pump to cylinder block. Be careful not to damage the oil seal during installation.

**NOTE:**

- Make sure the oil seal lip is not folded.
- Align the flat surface of oil pump's inner rotor with crankshaft before installation.
- Use a new O-ring and oil seal.

5) Apply liquid gasket to the three bolts thread shown in figure. (when reuse the bolts)

**Liquid gasket:**

**THREE BOND 1324 (Part No. 004403042) or equivalent**

**Tightening torque:**

**6.4 N·m (0.65 kgf-m, 4.7 ft-lb)**

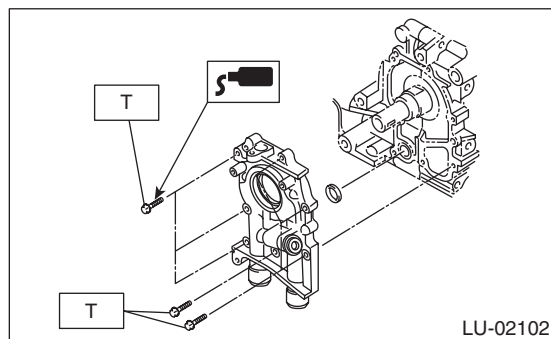

## C: DISASSEMBLY

Remove the screw which secures oil pump cover and then disassemble oil pump. Inscribe alignment marks on the inner and outer rotors so that they can be replaced in their original positions during reassembly.

**NOTE:**

Before disassembling the oil pump, remove the relief valve.

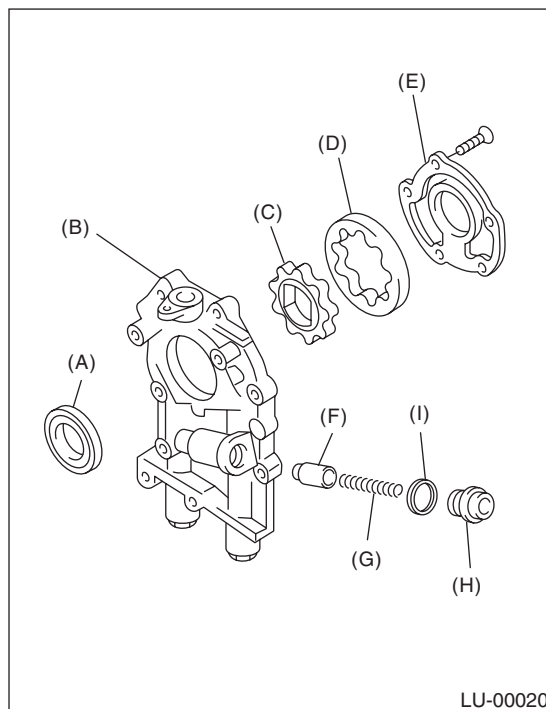

- (A) Oil seal
- (B) Pump case
- (C) Inner rotor
- (D) Outer rotor
- (E) Pump cover
- (F) Relief valve
- (G) Relief valve spring
- (H) Plug
- (I) Gasket

# Oil Pump

## LUBRICATION

### D: ASSEMBLY

- 1) Using the ST, install the front oil seal.  
ST 499587100 OIL SEAL INSTALLER

NOTE:

Use a new oil seal.

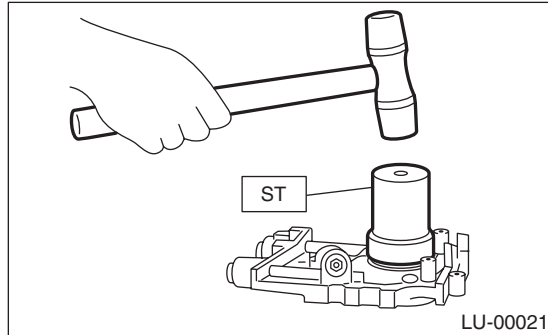

- 2) Apply a coat of engine oil to inner and outer rotors.  
3) Assemble the inner and outer rotors in their original positions.  
4) Assemble the oil relief valve and install relief valve spring and plug.

NOTE:

Use a new gasket.

- 5) Install the oil pump cover.

**Tightening torque:**

**T1: 5.4 N·m (0.55 kgf-m, 4.0 ft-lb)**

**T2: 44 N·m (4.5 kgf-m, 32.5 ft-lb)**

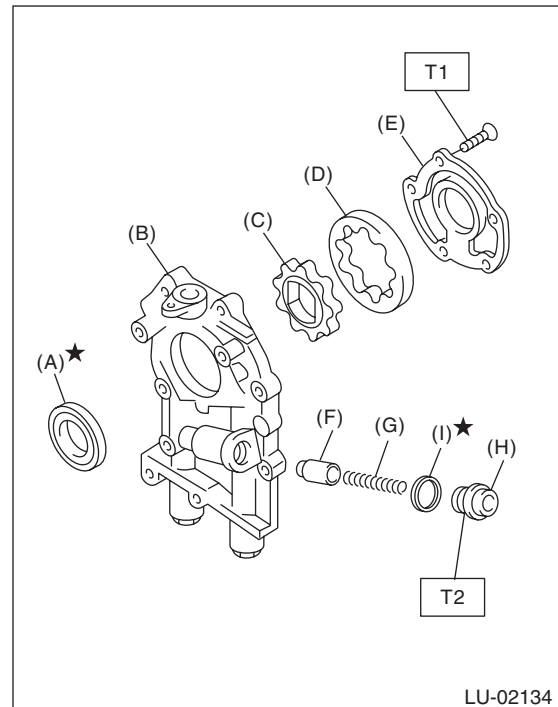

- (A) Oil seal
- (B) Pump case
- (C) Inner rotor
- (D) Outer rotor
- (E) Pump cover
- (F) Relief valve
- (G) Relief valve spring
- (H) Plug
- (I) Gasket

## E: INSPECTION

### 1. TIP CLEARANCE

Measure the tip clearance of rotors. If the clearance is out of specification, replace the rotors as a set.

**Tip clearance:**

**Standard**

**0.04 — 0.14 mm (0.0016 — 0.0055 in)**

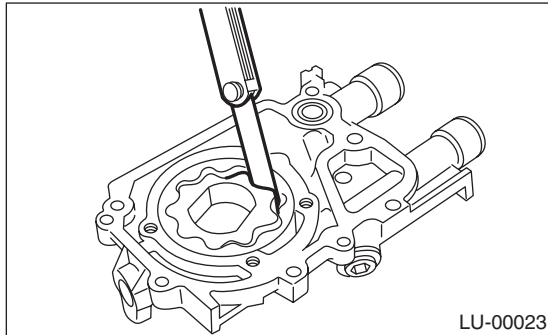

### 2. CASE CLEARANCE

Measure the clearance between the outer rotor and the oil pump rotor housing. If clearance is out of standard, replace the oil pump case.

**Case clearance:**

**Standard**

**0.10 — 0.175 mm (0.0039 — 0.0069 in)**

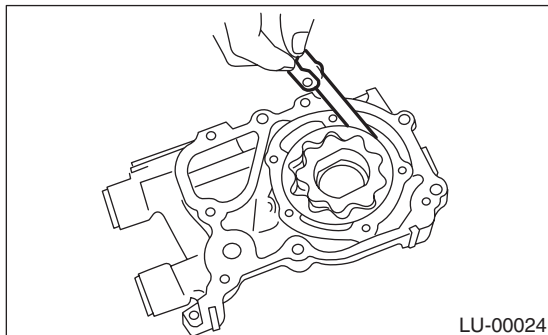

### 3. SIDE CLEARANCE

Measure the clearance between oil pump inner rotor and pump cover. If the clearance is out of specification, replace the rotors and the pump body.

**Side clearance:**

**Standard**

**0.02 — 0.07 mm (0.0008 — 0.0028 in)**

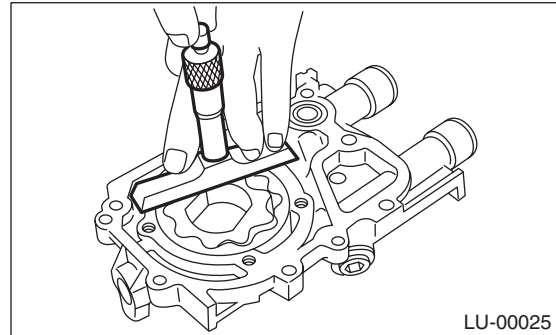

### 4. OIL RELIEF VALVE

Check the valve for assembly condition and damage, and the relief valve spring for damage and deterioration. Replace the parts if defective.

**Relief valve spring:**

**Free length**

**73.7 mm (2.902 in)**

**Installed length**

**54.7 mm (2.154 in)**

**Load when installed**

**93.1 N (9.49 kgf, 20.88 lb)**

### 5. OIL PUMP CASE

Check the oil pump case for worn shaft hole, clogged oil passage, worn rotor chamber, cracks and other faults.

### 6. OIL SEAL

Check the oil seal lips for deformation, hardening, wear, etc. and replace if defective.