

28.Reduction Driven Gear

A: REMOVAL

- 1) Remove the transmission assembly from vehicle body. <Ref. to 4AT-34, REMOVAL, Automatic Transmission Assembly.>
- 2) Remove the rear wheel speed sensor, and separate the extension case from transmission case. <Ref. to 4AT-67, REMOVAL, Extension Case.>
- 3) Set the range select lever to the "P" range.
- 4) Lift the crimped section, and then remove the lock nut.

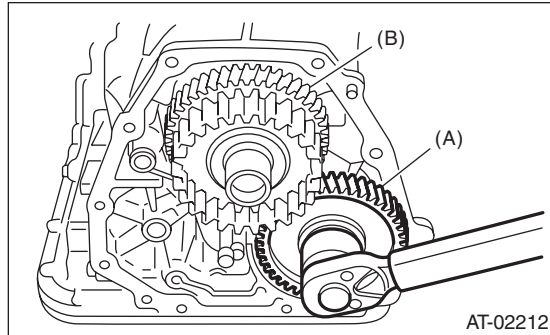

- (A) Reduction driven gear
(B) Reduction drive gear

- 5) Using the ST1 and ST2, extract the reduction driven gear.

ST1 499737000 PULLER
ST2 899524100 PULLER SET

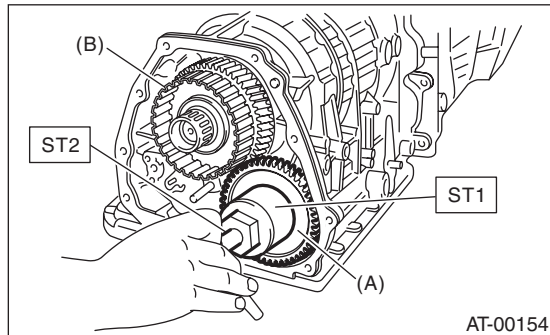

- (A) Reduction driven gear
(B) Reduction drive gear

B: INSTALLATION

- 1) Set the range select lever to the "P" range.
- 2) Using a plastic hammer, install the reduction driven gear assembly and the new washer, and tighten the new drive pinion lock nut.

Tightening torque:

100 N·m (10.2 kgf-m, 73.8 ft-lb)

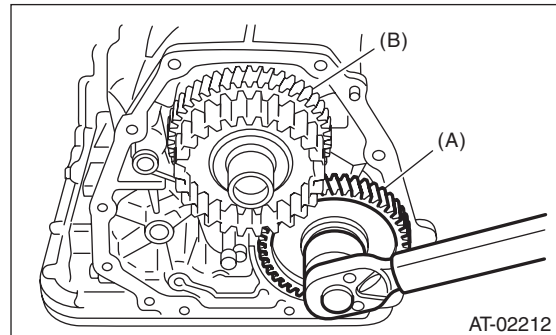

- (A) Reduction driven gear
(B) Reduction drive gear

- 3) After tightening, stake the lock nut securely.
- 4) Join the transmission case and the extension case, and then install the rear vehicle speed sensor. <Ref. to 4AT-67, INSTALLATION, Extension Case.>
- 5) Install the transmission assembly to the vehicle. <Ref. to 4AT-36, INSTALLATION, Automatic Transmission Assembly.>

C: DISASSEMBLY

- 1) Remove the snap ring from reduction driven gear.

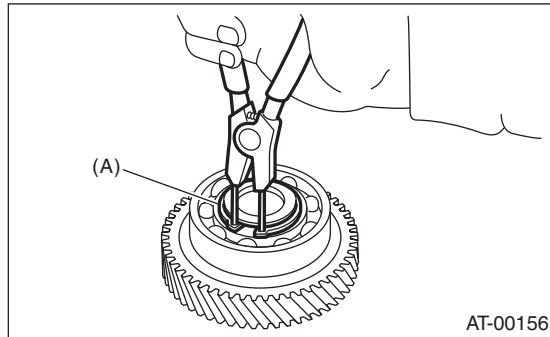

(A) Snap ring

- 2) Remove the ball bearing from reduction driven gear using ST.

ST 498077600 REMOVER

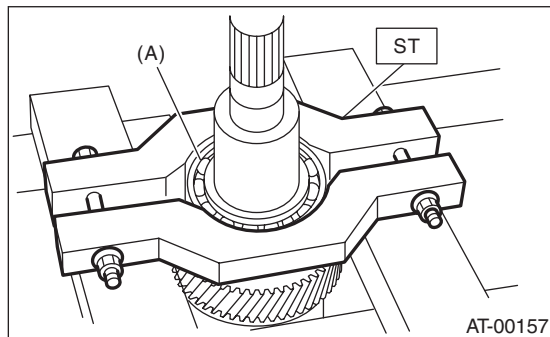

(A) Ball bearing

- 3) Remove the snap ring from reduction driven gear.

D: ASSEMBLY

- 1) Install the snap ring to reduction driven gear.
- 2) Install the new ball bearing to reduction driven gear using press.

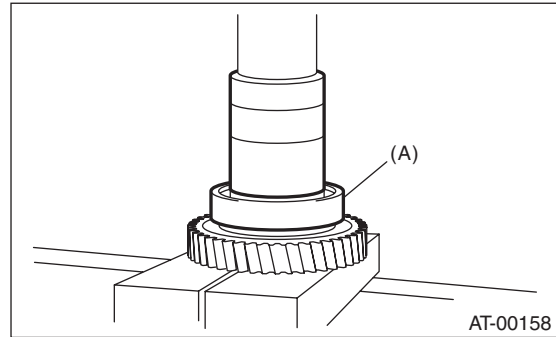

(A) Ball bearing

- 3) Install the snap ring to reduction driven gear.

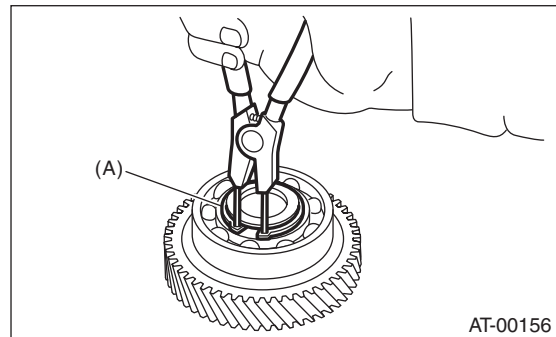

(A) Snap ring

E: INSPECTION

Make sure the ball bearing and gear is not deformed or damaged.