

### 36. Transmission Control Device

#### A: REMOVAL

- 1) Remove the transmission assembly from vehicle body. <Ref. to 4AT-34, REMOVAL, Automatic Transmission Assembly.>
- 2) Pull out the torque converter assembly. <Ref. to 4AT-66, REMOVAL, Torque Converter Assembly.>
- 3) Remove the input shaft.
- 4) Lift-up the lever on the rear side of transmission harness connector, and then remove it from the stay.
- 5) Disconnect the air breather hose. <Ref. to 4AT-64, REMOVAL, Air Breather Hose.>
- 6) Remove the inhibitor switch connector from the stay.
- 7) Wrap vinyl tape around the nipple attached to the air breather hose.
- 8) Remove the pitching stopper bracket.
- 9) Remove the inhibitor switch.

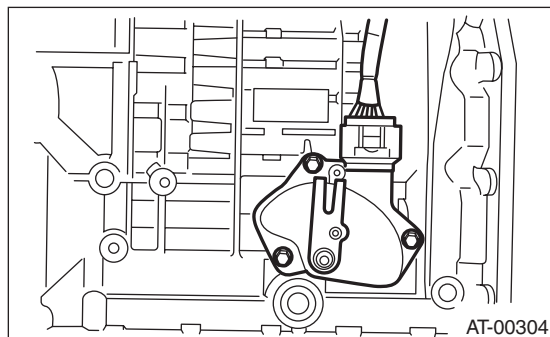

- 10) Remove the control valve body assembly. <Ref. to 4AT-55, REMOVAL, Control Valve Body.>
- 11) Pull out the straight pin of manual plate.

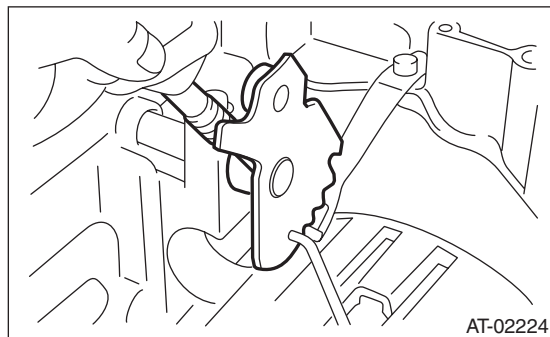

- 12) Remove the bolts securing select lever, and then remove the select lever, manual plate and parking rod.

#### NOTE:

Be careful not to damage the lips of press-fitted oil seal in the case.

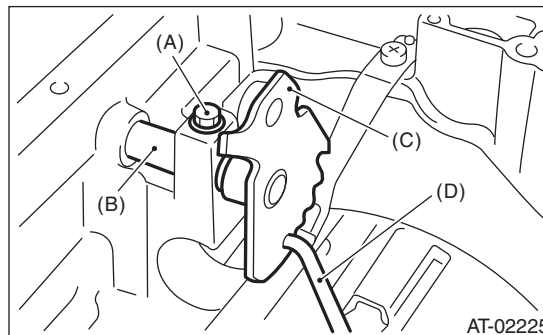

- (A) Bolt
- (B) Range select lever
- (C) Manual plate
- (D) Parking rod

- 13) Remove the detention spring.

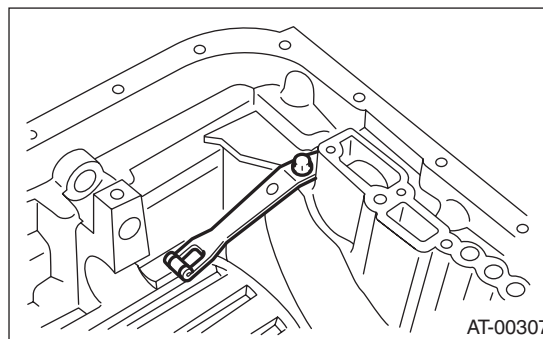

#### B: INSTALLATION

- 1) Install the detention spring to the transmission case.

#### Tightening torque:

**6 N·m (0.6 kgf-m, 4.3 ft-lb)**

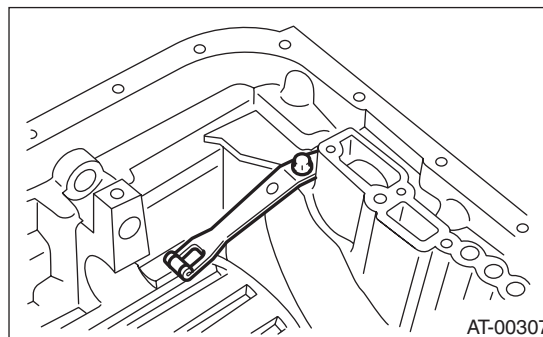



2) Insert the select lever, and then tighten the bolt.

**Tightening torque:**

**6 N·m (0.6 kgf-m, 4.3 ft-lb)**

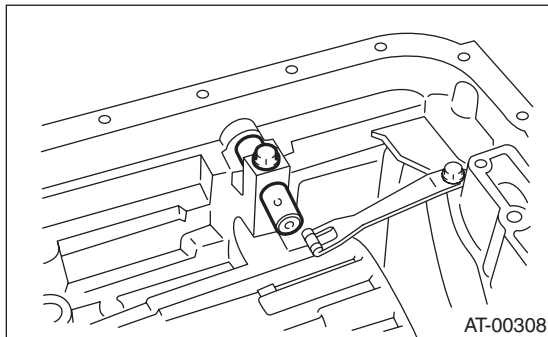

3) Insert the manual plate and parking rod.

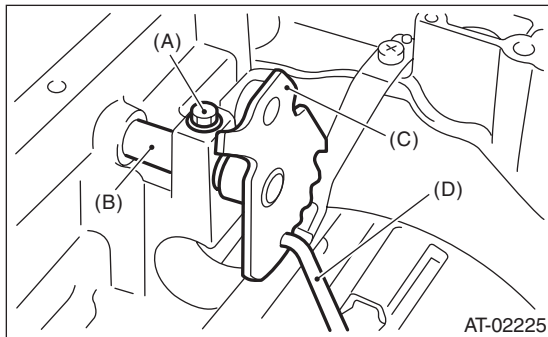

- (A) Bolt
- (B) Range select lever
- (C) Manual plate
- (D) Parking rod

4) Insert a new straight pin to manual plate.

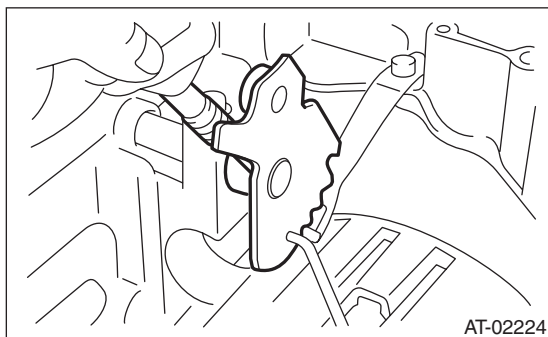

5) Install the oil pan and the control valve assembly. <Ref. to 4AT-56, INSTALLATION, Control Valve Body.>

6) Turn over the transmission case to its original position.

7) Install the pitching stopper bracket.

**Tightening torque:**

**41 N·m (4.2 kgf-m, 30.4 ft-lb)**

8) Install and adjust the inhibitor switch. <Ref. to 4AT-45, Inhibitor Switch.>

9) Insert the inhibitor switch and transmission connector to the stay.

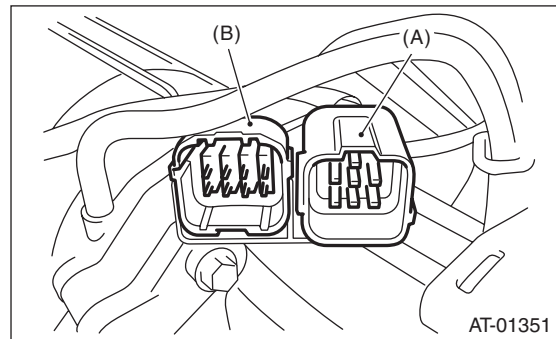

- (A) Transmission connector
- (B) Inhibitor switch connector

10) Install the air breather hose. <Ref. to 4AT-64, INSTALLATION, Air Breather Hose.>

11) Insert the input shaft while rotating it lightly by hand, and then check the amount of protrusion.

**Normal protrusion A:**

**50 — 55 mm (1.97 — 2.17 in)**

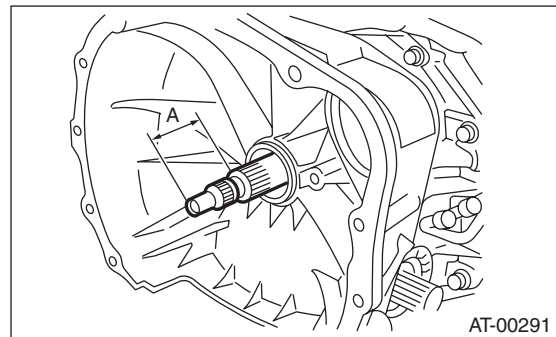

12) Install the torque converter assembly. <Ref. to 4AT-66, INSTALLATION, Torque Converter Assembly.>

13) Install the transmission assembly to the vehicle. <Ref. to 4AT-36, INSTALLATION, Automatic Transmission Assembly.>

### C: INSPECTION

Make sure that the manual lever and detention spring are not worn or otherwise damaged.



# Transmission Control Device

AUTOMATIC TRANSMISSION

---



# AUTOMATIC TRANSMISSION (DIAGNOSTICS)

## *4AT(diag)*

---

	Page
1. Basic Diagnostic Procedure .....	2
2. Check List for Interview .....	4
3. General Description .....	5
4. Electrical Component Location .....	7
5. Transmission Control Module (TCM) I/O Signal .....	12
6. Subaru Select Monitor .....	15
7. Read Diagnostic Trouble Code (DTC) .....	18
8. Inspection Mode .....	19
9. Clear Memory Mode .....	20
10. AT Oil Temp Warning Light Display .....	21
11. Diagnostic Procedure for Subaru Select Monitor Communication .....	24
12. List of Diagnostic Trouble Code (DTC) .....	28
13. Diagnostic Procedure with Diagnostic Trouble Code (DTC) .....	30
14. Diagnostic Procedure without Diagnostic Trouble Code (DTC) .....	83
15. Diagnostics with Phenomenon .....	94