

7. Switches and Harness

A: REMOVAL

1. BACK-UP LIGHT SWITCH & NEUTRAL POSITION SWITCH

- 1) Disconnect the ground cable from battery.
 - 2) Remove the air intake chamber and cleaner case. (Non-turbo model) <Ref. to IN(H4SO)-5, REMOVAL, Air Cleaner Case.> <Ref. to IN(H4SO)-7, REMOVAL, Air Intake Chamber.>
 - 3) Remove the intercooler. (Turbo model) <Ref. to IN(H4DOTC)-12, REMOVAL, Intercooler.>
 - 4) Disconnect the connector back-up light switch & neutral position switch.
- Non-turbo model

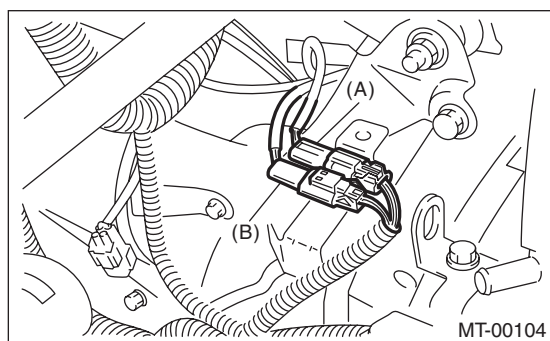

(A) Neutral position switch connector (Brown)
(B) Back-up light switch connector (Gray)

- Turbo model

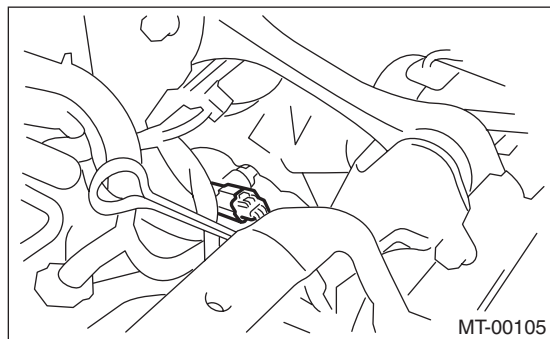

- 5) Lift the vehicle.

- 6) Remove the back-up light switch & neutral position switch with the harness.

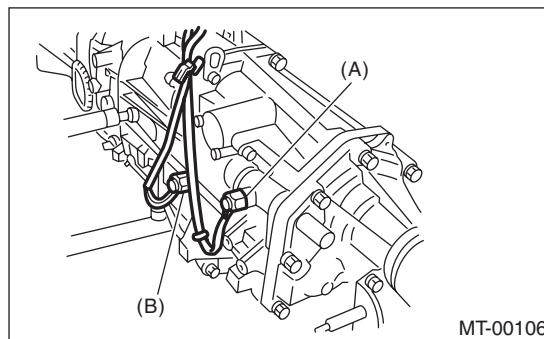

(A) Neutral position switch (Brown)
(B) Back-up light switch (Gray)

B: INSTALLATION

1. BACK-UP LIGHT SWITCH & NEUTRAL POSITION SWITCH

- 1) Install the back-up light switch & neutral position switch with the harness.

Tightening torque:

32 N·m (3.3 kgf-m, 23.6 ft-lb)

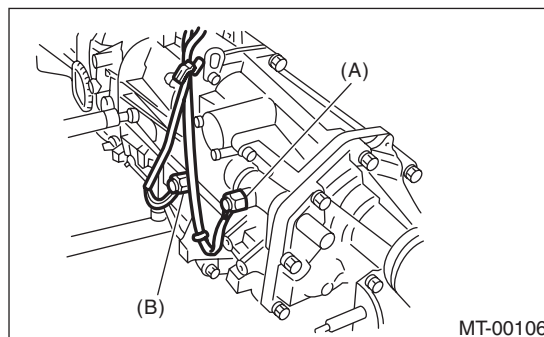

(A) Neutral position switch
(B) Back-up light switch

- 2) Connect the connectors of back-up light switch & neutral position switch.
- 3) Install the air intake chamber and cleaner case. (Non-turbo model) <Ref. to IN(H4SO)-6, INSTALLATION, Air Cleaner Case.> <Ref. to IN(H4SO)-7, INSTALLATION, Air Intake Chamber.>
- 4) Install the intercooler. (Turbo model) <Ref. to IN(H4DOTC)-12, INSTALLATION, Intercooler.>
- 5) Connect the battery ground cable to the battery.

C: INSPECTION

1. BACK-UP LIGHT SWITCH

Check the back-up light switch. <Ref. to LI-8, INSPECTION, Back-up Light System.>

2. NEUTRAL POSITION SWITCH

- 1) Turn the ignition switch to OFF.
- 2) Disconnect the connector of neutral position switch.
- 3) Measure the resistance between neutral position switch terminals.

- Non-turbo model

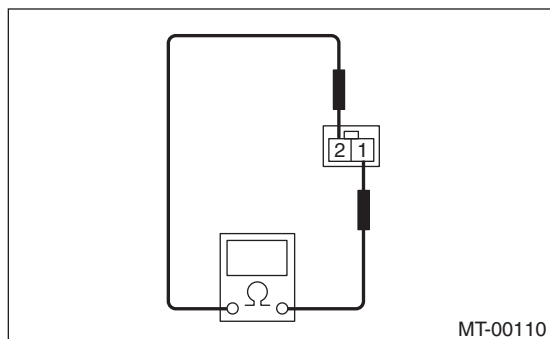

Gear shift position	Terminal No.	Specified resistance
Neutral position	1 and 2	Less than 1 Ω
Other positions		1 M Ω or more

- Turbo model

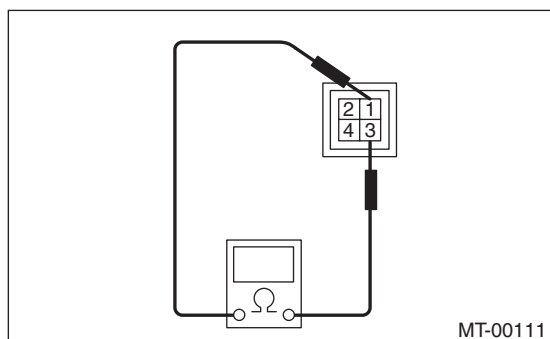

Gear shift position	Terminal No.	Specified resistance
Neutral position	1 and 3	Less than 1 Ω
Other positions		1 M Ω or more

- 4) Replace faulty parts.