

General Description

ABS

1. General Description

A: SPECIFICATION

Item				Specification or identification
ABS wheel speed sensor	ABS wheel speed sensor gap (for reference)		Front	0.77 — 1.43 mm (0.030 — 0.056 in)
			Rear	0.64 — 1.56 mm (0.025 — 0.061 in)
	Identifications of harness (marks, color)	Front	RH	K1 (White)
			LH	K2 (Yellow)
		Rear	RH	K5 (White)
			LH	K6 (Yellow)
G sensor	G sensor voltage			2.3±0.2 V
ABSCM & H/U identification	AT (Except for OUTBACK)			J9
	MT (Except for OUTBACK)			JA
	AT (OUTBACK)			JB
	MT (OUTBACK)			JE

B: COMPONENT

1. ABS WHEEL SPEED SENSOR

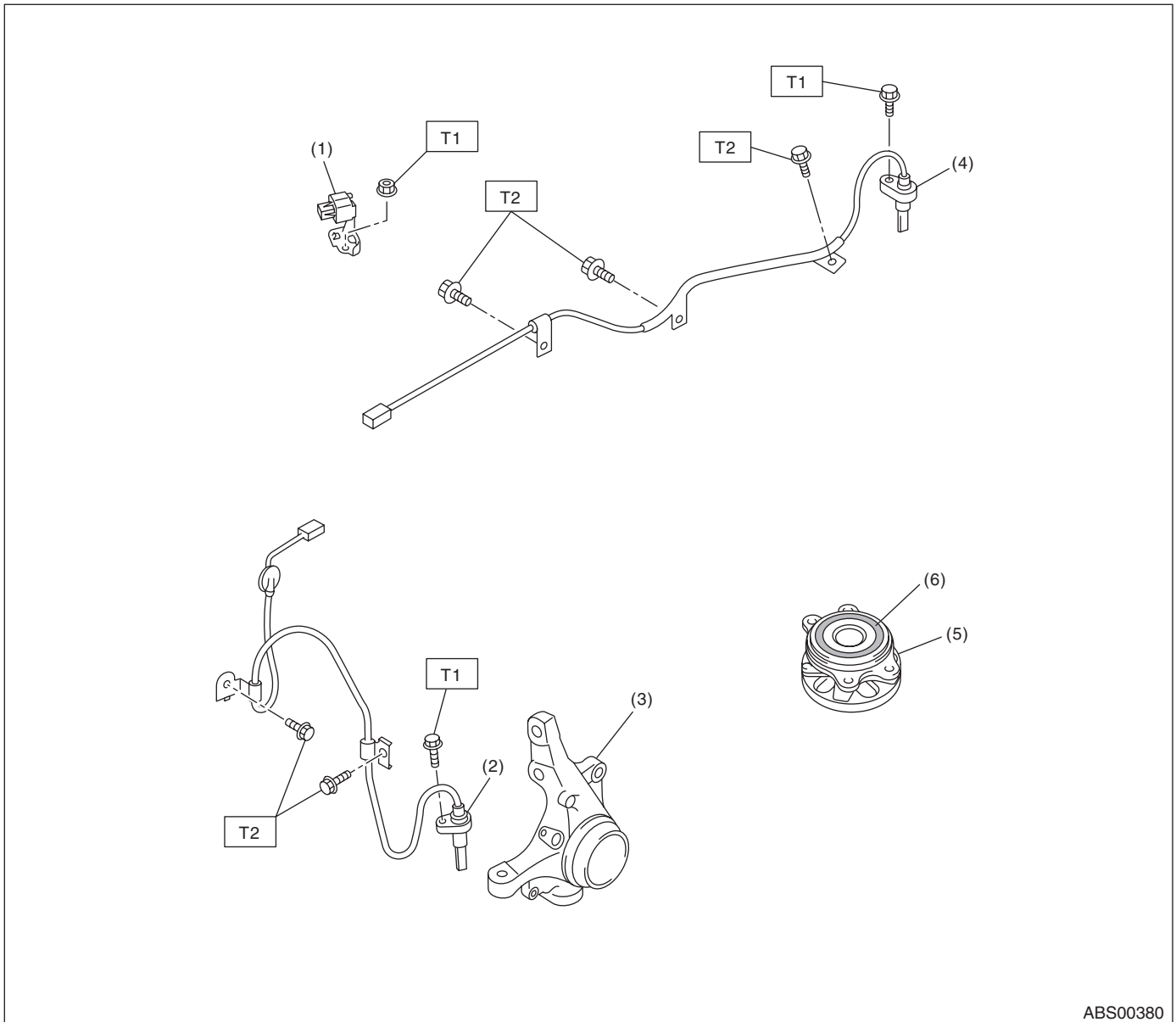

- | | |
|-------------------------------------|------------------------------------|
| (1) G sensor | (4) Rear ABS wheel speed sensor LH |
| (2) Front ABS wheel speed sensor LH | (5) Hub unit bearing |
| (3) Front housing | (6) Magnetic encoder |

Tightening torque: N·m (kgf-m, ft-lb)

T1: 7.5 (0.76, 5.5)

T2: 33 (3.3, 24)

General Description

ABS

2. ABS CONTROL MODULE AND HYDRAULIC CONTROL UNIT (ABSCM&H/U)

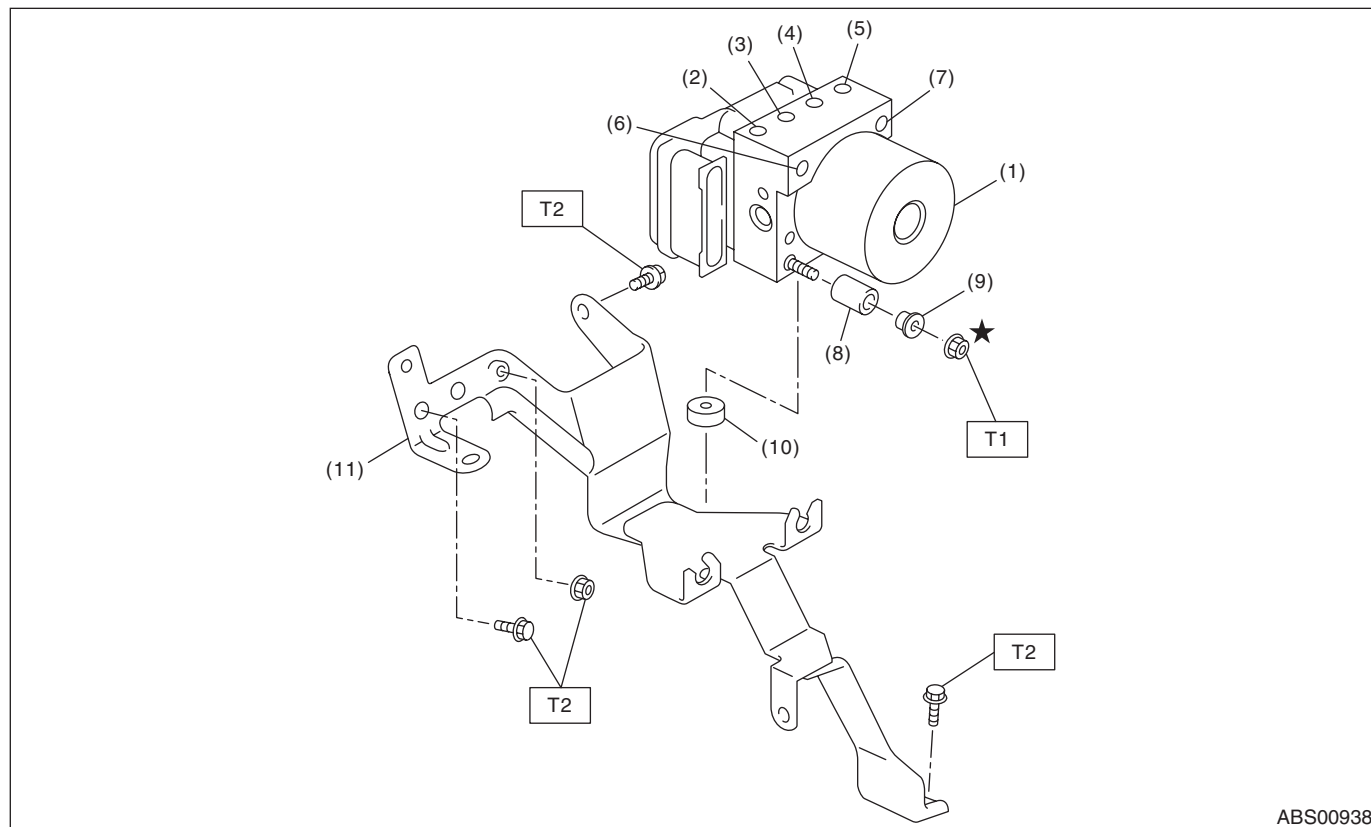

ABS00938

- | | |
|---|---------------------|
| (1) ABS control module and hydraulic control unit (ABSCM&H/U) | (6) Primary inlet |
| (2) Front outlet RH | (7) Secondary inlet |
| (3) Rear outlet LH | (8) Damper |
| (4) Rear outlet RH | (9) Spacer |
| (5) Front outlet LH | (10) Damper |

- (11) Bracket

Tightening torque: N·m (kgf-m, ft-lb)

T1: 7.5 (0.76, 5.5)

T2: 33 (3.3, 24)

C: CAUTION

- Wear appropriate work clothing, including a cap, protective goggles and protective shoes when performing any work.
- Before disconnecting connectors of sensors or units, be sure to disconnect the ground cable from the battery.
- Before removal, installation or disassembly, be sure to clarify the failure. Avoid unnecessary removal, installation, disassembly and replacement.
- Vehicle components are extremely hot after driving. Be wary of receiving burns from heated parts.
- Be sure to tighten fasteners including bolts and nuts to the specified torque.
- Place shop jacks or rigid racks at the specified points.

D: PREPARATION TOOL**1. SPECIAL TOOL**

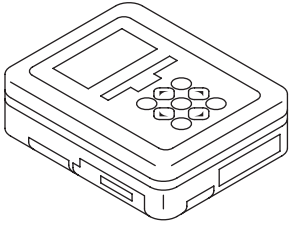
ILLUSTRATION	TOOL NUMBER	DESCRIPTION	REMARKS
 <p>ST1B020XU0</p>	1B020XU0	SUBARU SELECT MONITOR KIT	Used for troubleshooting the electrical system.

2. GENERAL TOOL

TOOL NAME	REMARKS
Circuit tester	Used for measuring resistance, voltage and current.
Pressure gauge	Used for measuring oil pressure.
Oscilloscope	Used for measuring the sensor.
TORX® bit E5	Used for replacing the ABSCM.