

5. Upper Link

A: REMOVAL

- 1) Lift up the vehicle, and then remove the rear wheels.
- 2) Support the rear arm horizontally using a transmission jack.

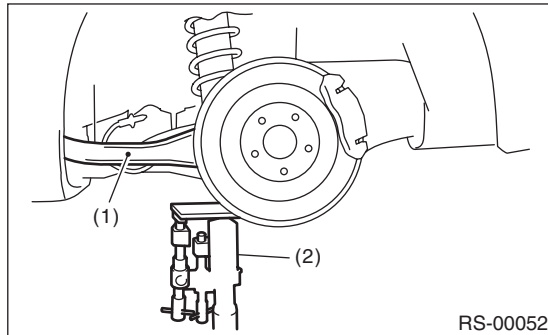

- (1) Rear arm
- (2) Transmission jack

- 3) Remove the bolt which secures the upper link to sub frame.

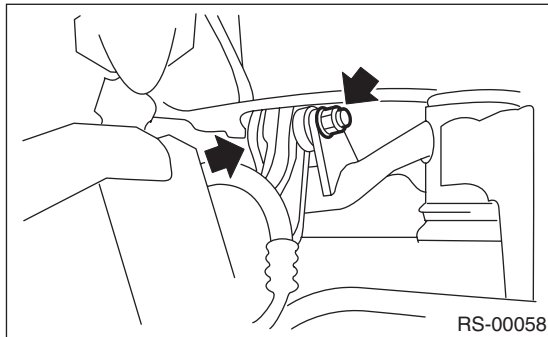

- 4) Remove the bolts which secure the upper link to the rear arm, and then remove the upper link.

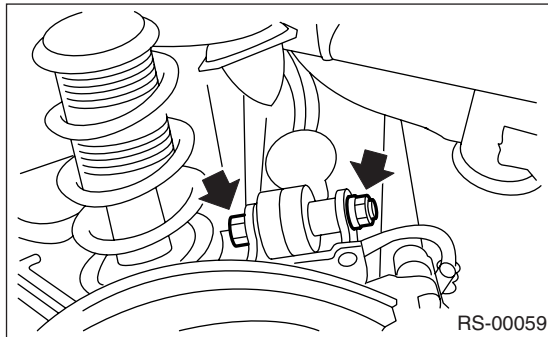

B: INSTALLATION

- 1) Support the rear arm horizontally using a transmission jack.
- 2) Using new self-locking nuts, install the upper link.

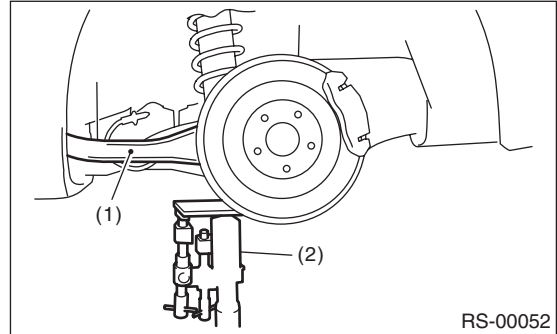

- (1) Rear arm
- (2) Transmission jack

NOTE:

Inspect the wheel alignment and adjust if necessary.

Tightening torque:

Upper link-to-Sub frame

57 N·m (5.8 kgf-m, 42 ft-lb)

Upper link-to-Rear arm

65 N·m (6.6 kgf-m, 48 ft-lb)

C: DISASSEMBLY

Using the ST, press the bushing out.

ST 20099AE010 INSTALLER & REMOVER

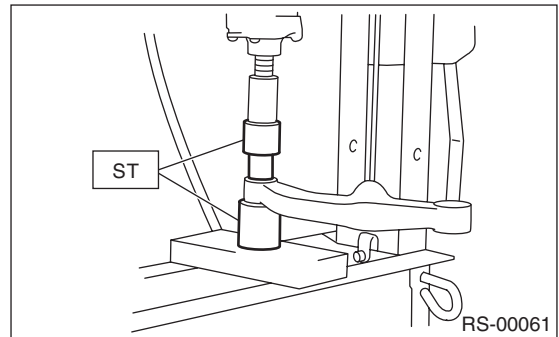

D: ASSEMBLY

Using the ST, press the bushing into place.

ST 20099AE010 INSTALLER & REMOVER

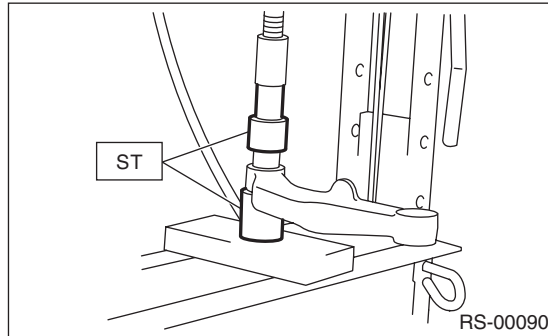

CAUTION:

Outer side bushing has an orientation. Assemble it with the longer protrusion faced to the rear side of vehicle.

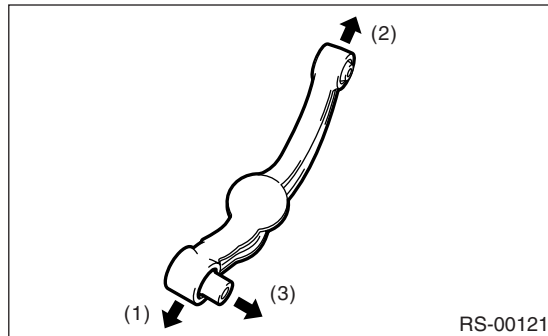

- (1) Rear arm
- (2) Rear sub frame
- (3) Rear side of vehicle

E: INSPECTION

- 1) Visually check the upper link for abnormal fatigue or damage.
- 2) Visually check the bushing for abnormal fatigue or damage.