

# Rear Washer

## WIPER AND WASHER SYSTEMS

### 11.Rear Washer

#### A: REMOVAL

- 1) Disconnect the ground cable from battery.
- 2) Remove the rear gate upper trim.
  - (1) Remove the claws on the trim edge.
  - (2) Disconnect the claws in the center of trim, and remove the rear gate upper trim.

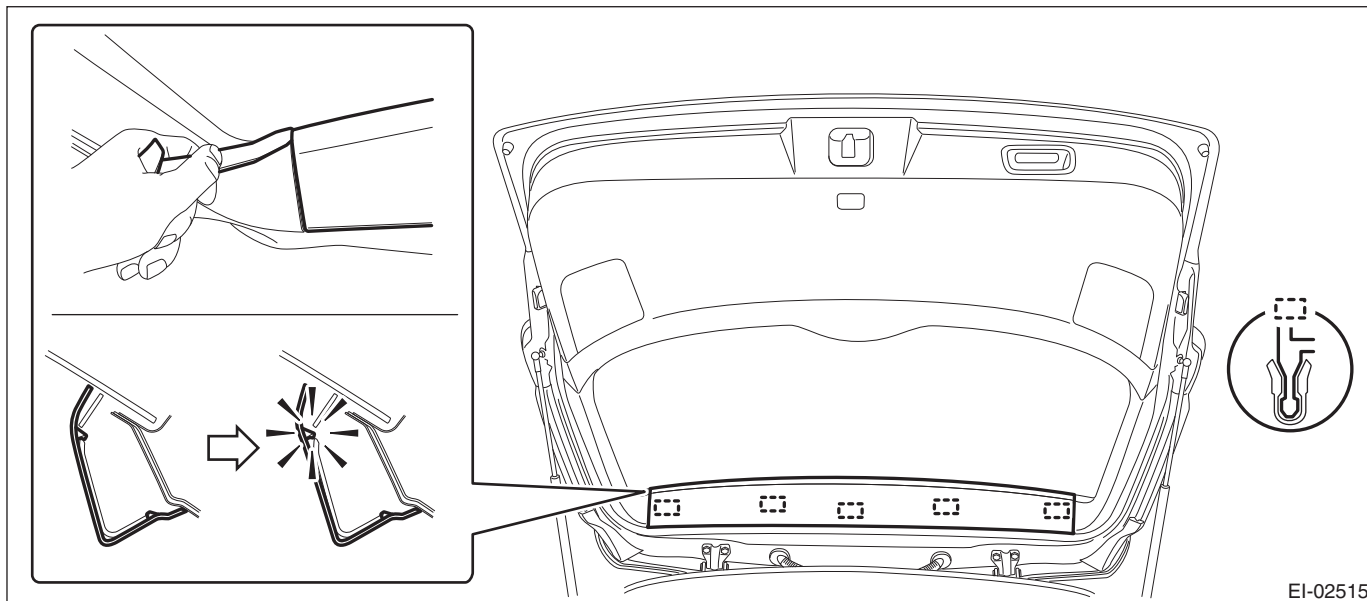

- 3) Remove the high-mounted stop light.
  - (1) Remove the nuts.

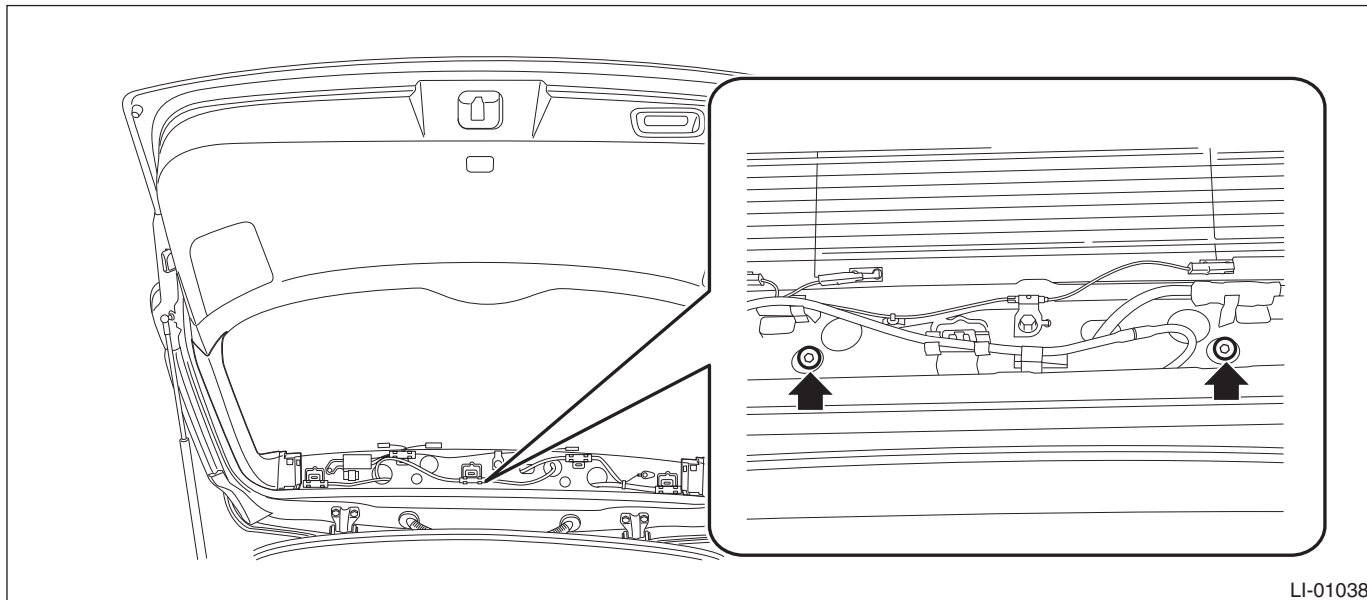

- (2) Disconnect the connector and remove the high-mounted stop light.

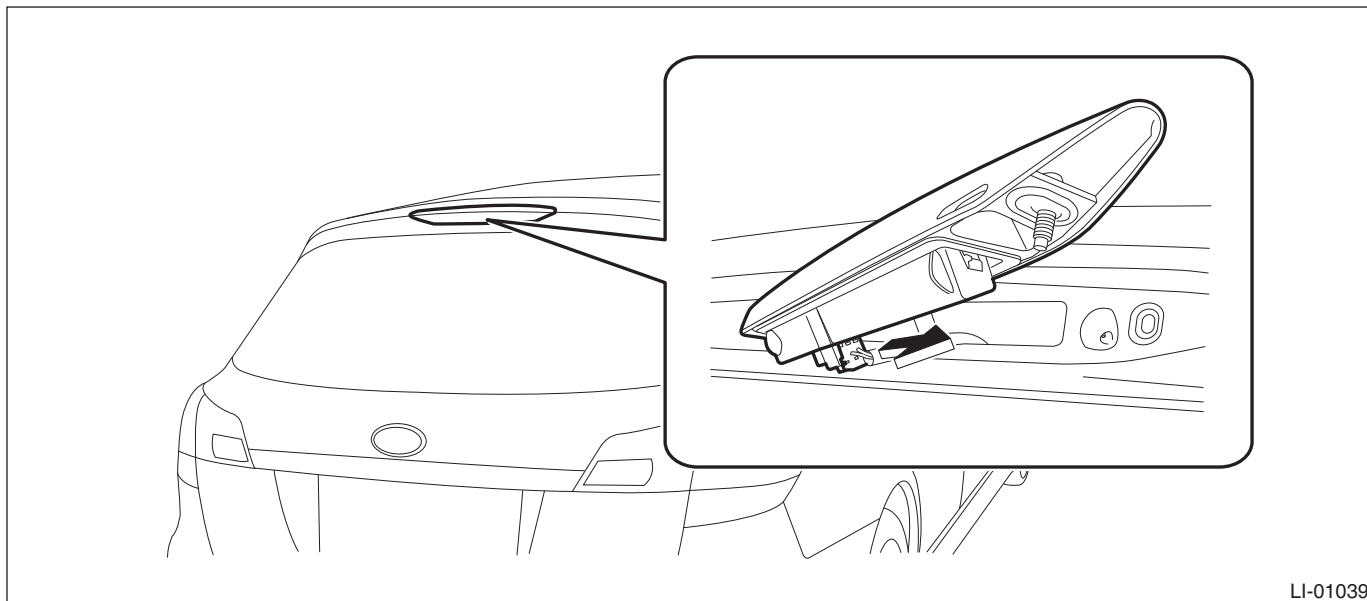

LI-01039

- 4) Remove the rear washer nozzle.

**CAUTION:**

**Before removing, apply protective tape to the body panel and used tools not to damage the rear gate panel.**

- (1) Push the claw using a flat tip screwdriver, etc.
- (2) When the washer nozzle lifts up, pull out the nozzle using a clip remover, etc.
- (3) Disconnect the washer hose and remove the washer nozzle.

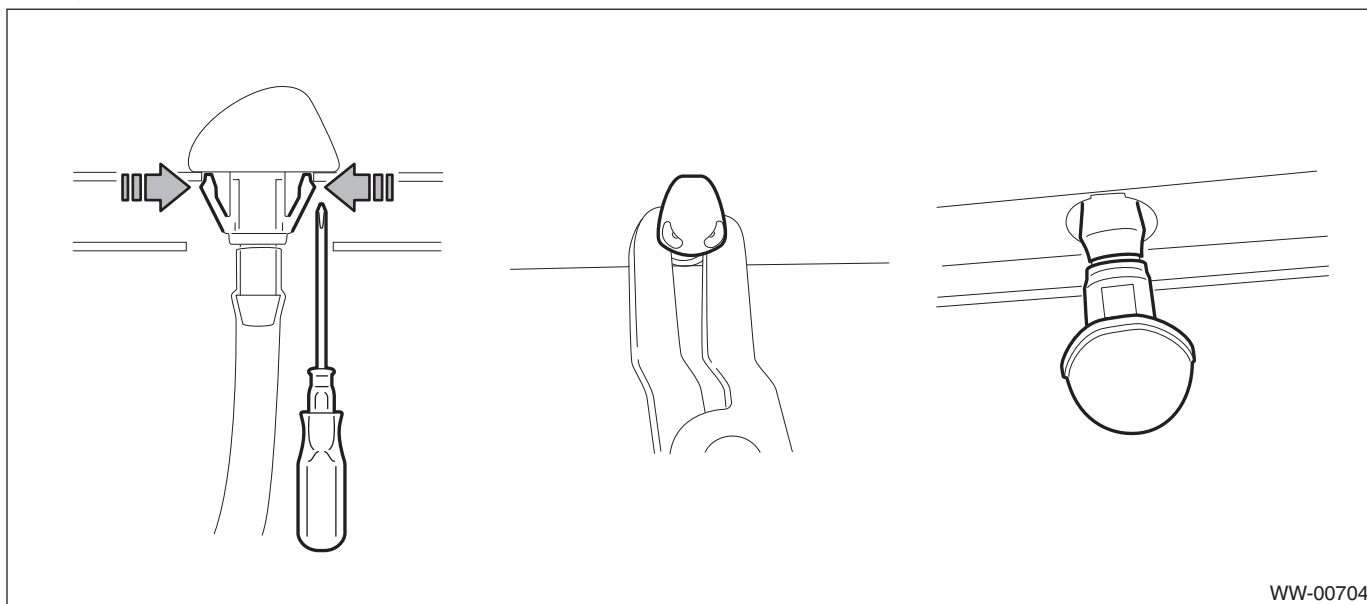

WW-00704

**B: INSTALLATION**

- 1) Install each part in the reverse order of removal.

**Tightening torque:**

**High-mounted stop light assembly: 4.5 N·m (0.46 kgf·m, 3.3 ft·lb)**

- 2) Check the washer nozzle position. <Ref. to WW-44, VISUAL INSPECTION, INSPECTION, Rear Washer.>

# Rear Washer

## WIPER AND WASHER SYSTEMS

### C: INSPECTION

#### 1. VISUAL INSPECTION

Check for the following items, and if any malfunction is found, replace the corresponding part.

- Make sure the nozzle and hose are not clogged.
- Make sure the hose is not bent.

#### 2. INSPECTING THE SPRAY POSITION

- 1) Turn the wiper switch to OFF position.
- 2) While the vehicle is stopped, check that the washer spray position is as shown in the figure.
- 3) After inspection, if the spray position is out of the specified range, adjust the position or replace with the new washer nozzle.

