

9. Scavenge Pump

A: REMOVAL

CAUTION:

If engine oil is spilt onto the exhaust pipe, wipe it off with cloth to avoid emission of smoke or causing a fire.

NOTE:

Turbo model is equipped with scavenge pump.

- 1) Lift up the vehicle.
- 2) Remove the under cover. <Ref. to EI-35, REMOVAL, Front Under Cover.>
- 3) Remove the union bolt (A) that holds the oil pipe (C) to the scavenge pump (E).
- 4) Remove the bolt (D) that holds the scavenge pump (E) to the cylinder head, and remove the scavenge pump using a flat tip screwdriver.

CAUTION:

Be careful not to damage the mating surface of the cylinder head and scavenge pump.

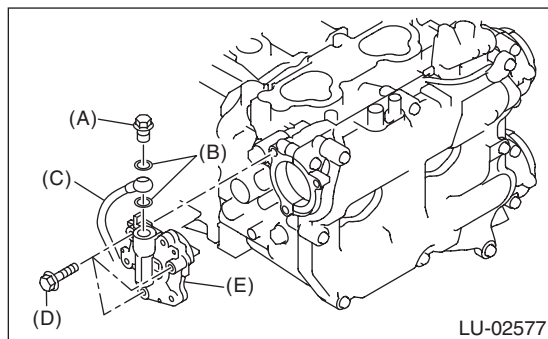

- (A) Union bolt
- (B) Gasket
- (C) Oil pipe
- (D) BOLT
- (E) Scavenge pump

B: INSTALLATION

Install in the reverse order of removal.

CAUTION:

Do not start applying liquid gasket from (A) as shown in the following figure.

NOTE:

- Use a new gasket.
- Install within 5 min. after applying liquid gasket.

Liquid gasket:

THREE BOND 1217G (Part No. K0877Y0100) or equivalent

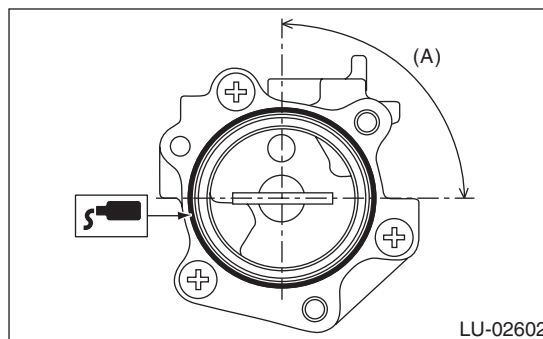

Tightening torque:

T1: 6.4 N·m (0.7 kgf-m, 4.7 ft-lb)
T2: 29 N·m (3.0 kgf-m, 21.4 ft-lb)

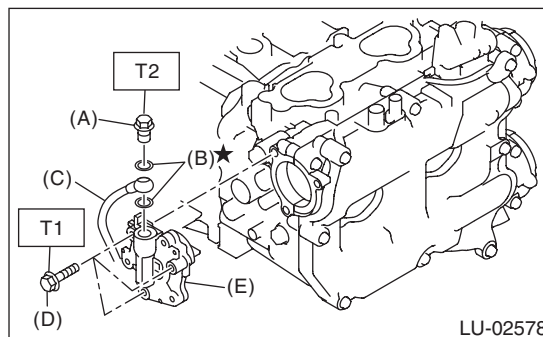

- (A) Union bolt
- (B) Gasket
- (C) Oil pipe
- (D) BOLT
- (E) Scavenge pump

C: INSPECTION

- 1) Check that the scavenge pump and oil pipe have no deformation, cracks and other damages.
- 2) Check that the scavenge pump has no cracks, damage or loose part.