

Timing Belt Cover

MECHANICAL

14. Timing Belt Cover

A: REMOVAL

- 1) Remove the crank pulley. <Ref. to ME(H4SO)-44, REMOVAL, Crank Pulley.>
- 2) Remove the stopper rod.

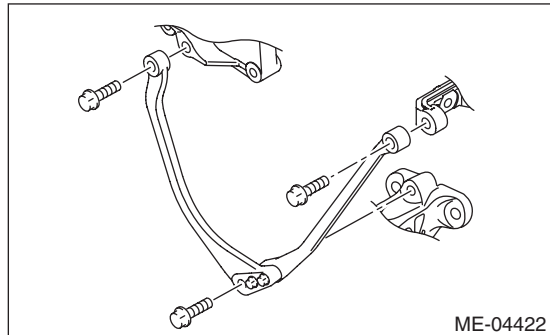

- 3) Remove the timing belt cover LH (A).
- 4) Remove the front timing belt cover (B).

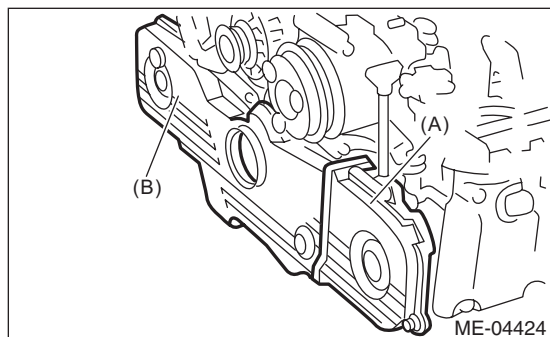

B: INSTALLATION

- 1) Install the front timing belt cover (B).

Tightening torque:

5 N·m (0.5 kgf-m, 3.7 ft-lb)

- 2) Install the timing belt cover LH (A).

Tightening torque:

5 N·m (0.5 kgf-m, 3.7 ft-lb)

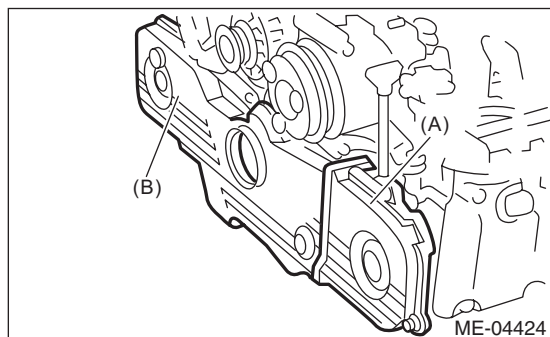

- 3) Install the stopper rod.

Tightening torque:

36 N·m (3.7 kgf-m, 26.6 ft-lb)

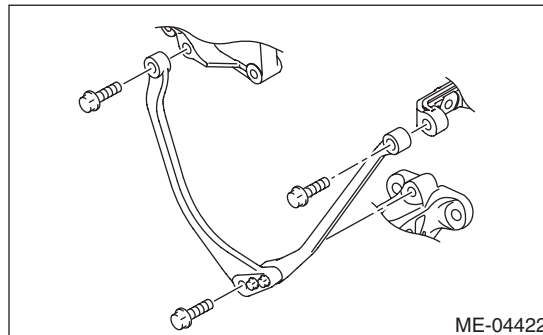

- 4) Install the crank pulley. <Ref. to ME(H4SO)-44, INSTALLATION, Crank Pulley.>

C: INSPECTION

Check the timing belt cover for damage.