

# PCV Hose Assembly

EMISSION CONTROL (AUX. EMISSION CONTROL DEVICES)

## 14.PCV Hose Assembly

### A: REMOVAL

#### CAUTION:

**Do not remove except when the hose is broken.**

- 1) Remove the collector cover.
- 2) Remove the intercooler. <Ref. to IN(H4DOTC)-17, REMOVAL, Intercooler.>
- 3) Disconnect the vacuum hose from intake manifold and remove the PCV hose assembly from cylinder block RH and blow-by pipe assembly.

#### NOTE:

Pinch the clamp of the PCV hose assembly by fitting the cut out in the ST with the protrusion on the clamp as shown in the figure, and unlock the clamp.

ST 18353AA000 CLAMP PLIERS

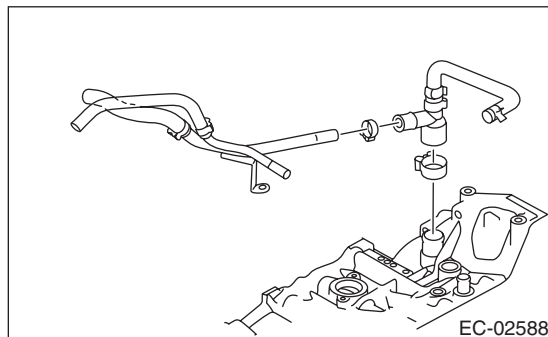
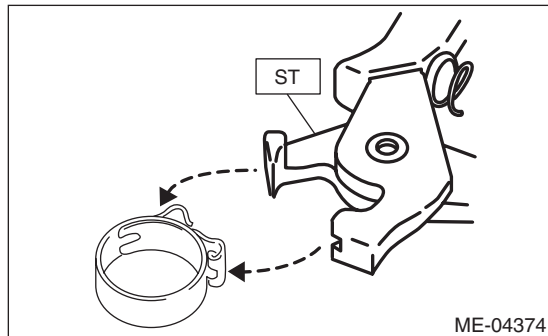

### B: INSTALLATION

- 1) Install the PCV hose assembly to the cylinder block RH and blow-by pipe assembly and connect the vacuum hose to the intake manifold.

#### NOTE:

Use a new clamp for the PCV hose assembly, fit the cut out in the ST with the protrusion on the clamp as shown in the figure, and lock the clamp.

ST 18353AA000 CLAMP PLIERS

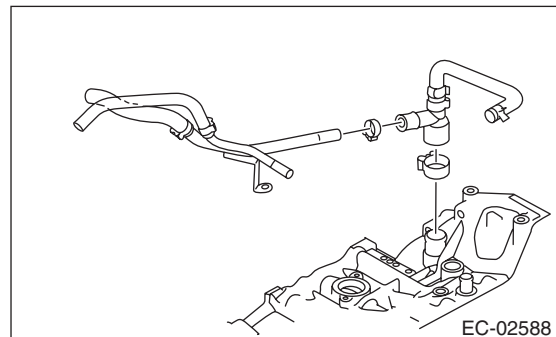
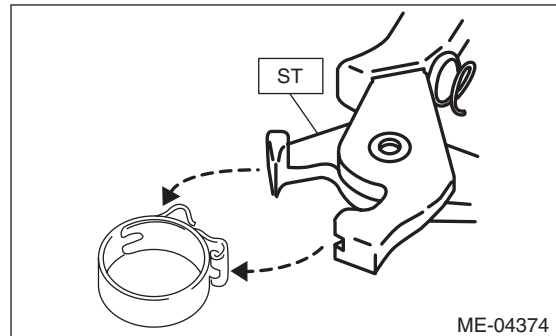

- 2) Install the intercooler. <Ref. to IN(H4DOTC)-18, INSTALLATION, Intercooler.>
- 3) Install the collector cover.

### C: INSPECTION

Check the PCV hose assembly for cracks, damage or looseness.