

## 31.Rear Gate Garnish

### A: REMOVAL

- 1) Disconnect the ground cable from battery.
- 2) Remove the rear gate trim.
  - (1) Remove the rear gate upper trim.
    - a) Remove the claws on the trim edge.
    - b) Disconnect the claws in the center of trim, and remove the rear gate upper trim.

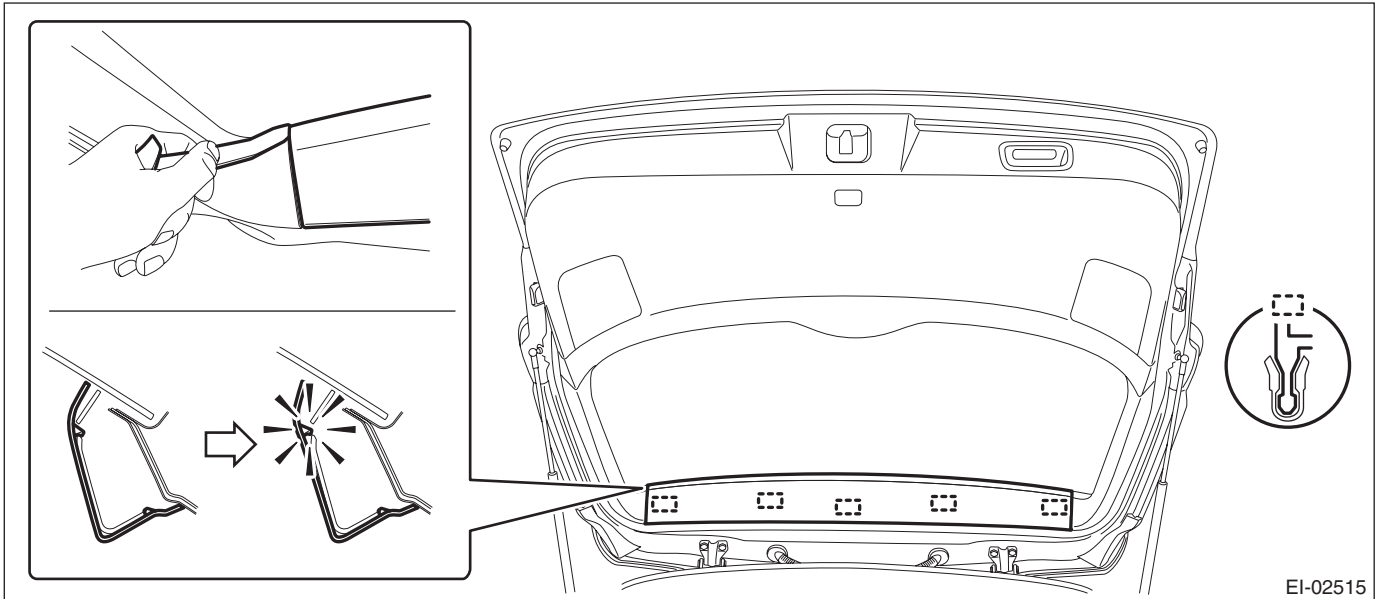

- (2) Remove the rear gate pillar trim.
  - a) Release the claws.
  - b) Remove the claws on the bottom of trim, and remove the rear gate pillar trim.

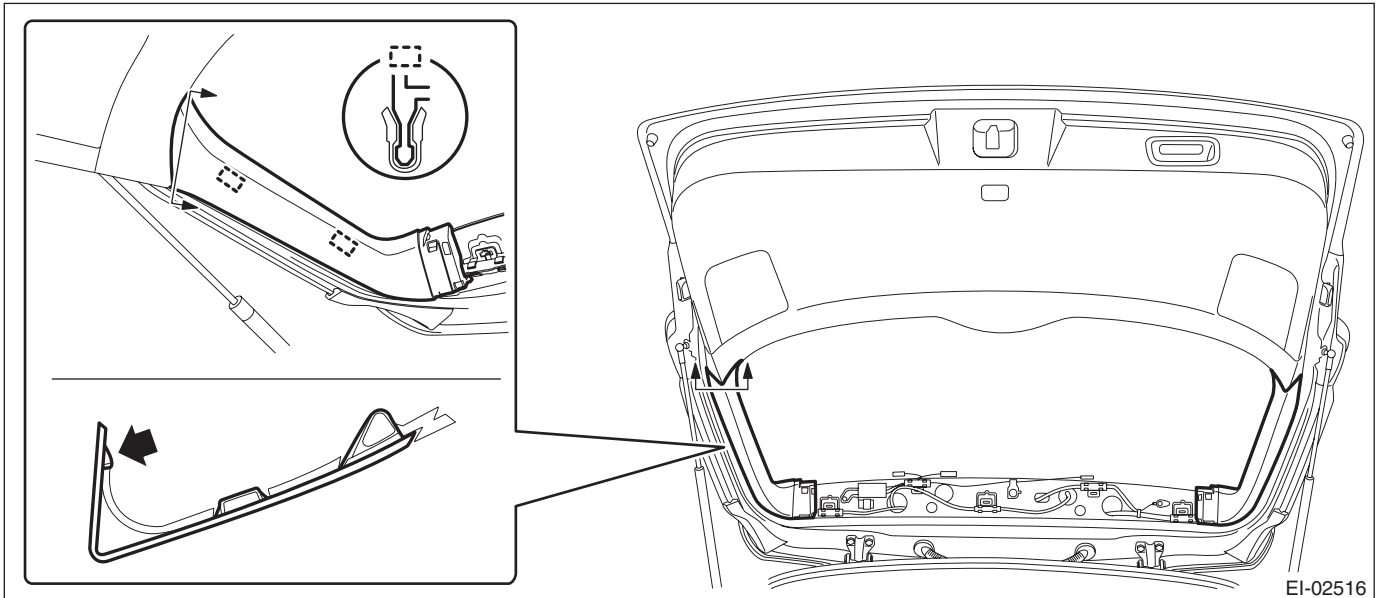

(3) Remove the hand grip of rear gate.

**CAUTION:**

- Be careful not to scratch the trim.
- To protect the trim from damage, attach a protective tape to the tool in use.
  - a) Insert a precision screwdriver (a).
  - b) With the screwdriver inserted, push it down to release the claw and pull it toward you.
  - c) Remove the screws and detach the hand grip.

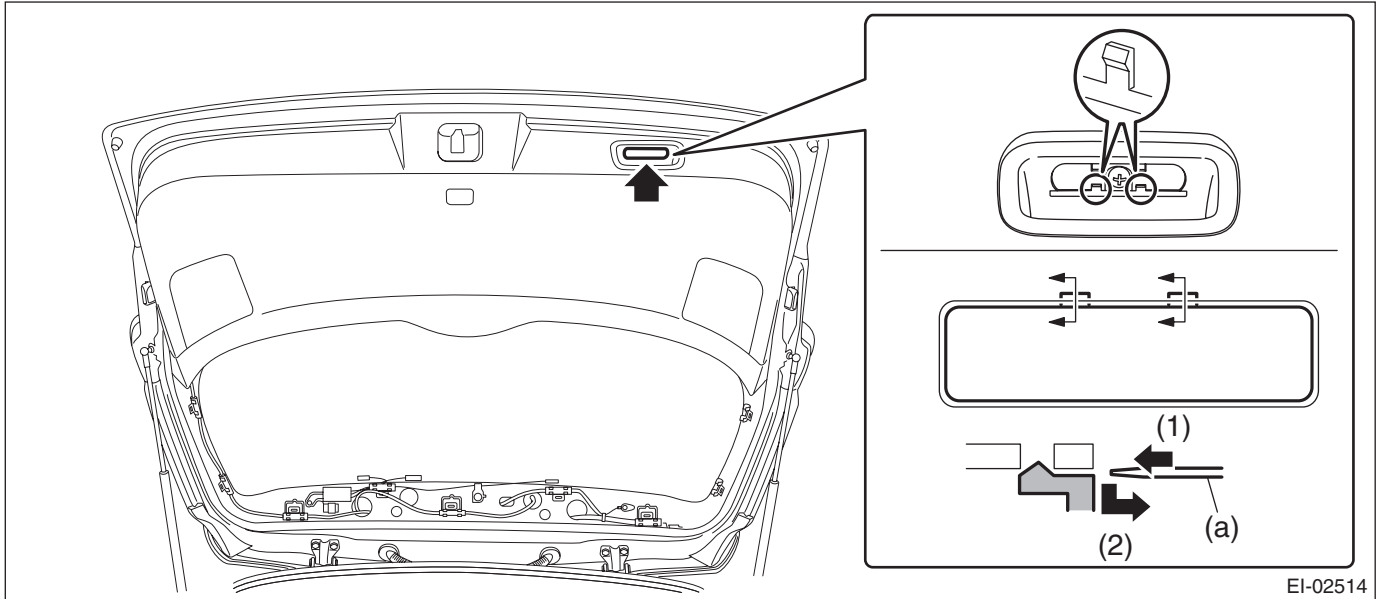

(4) Remove the rear gate lower trim.

- a) Remove the clips on both ends.
- b) Release the clips and remove the rear gate lower trim.

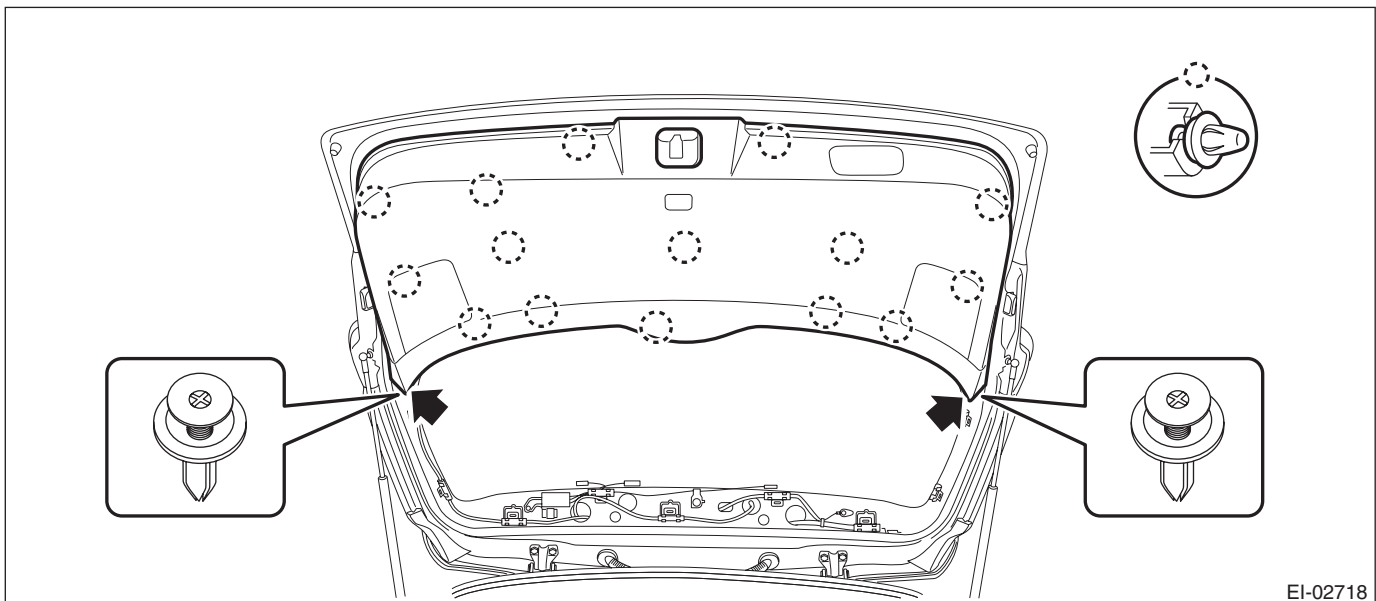

## Rear Gate Garnish

### EXTERIOR/INTERIOR TRIM

3) Remove the rear gate garnish.

(1) Release the clips and claws, then detach the rear finisher light side cover.

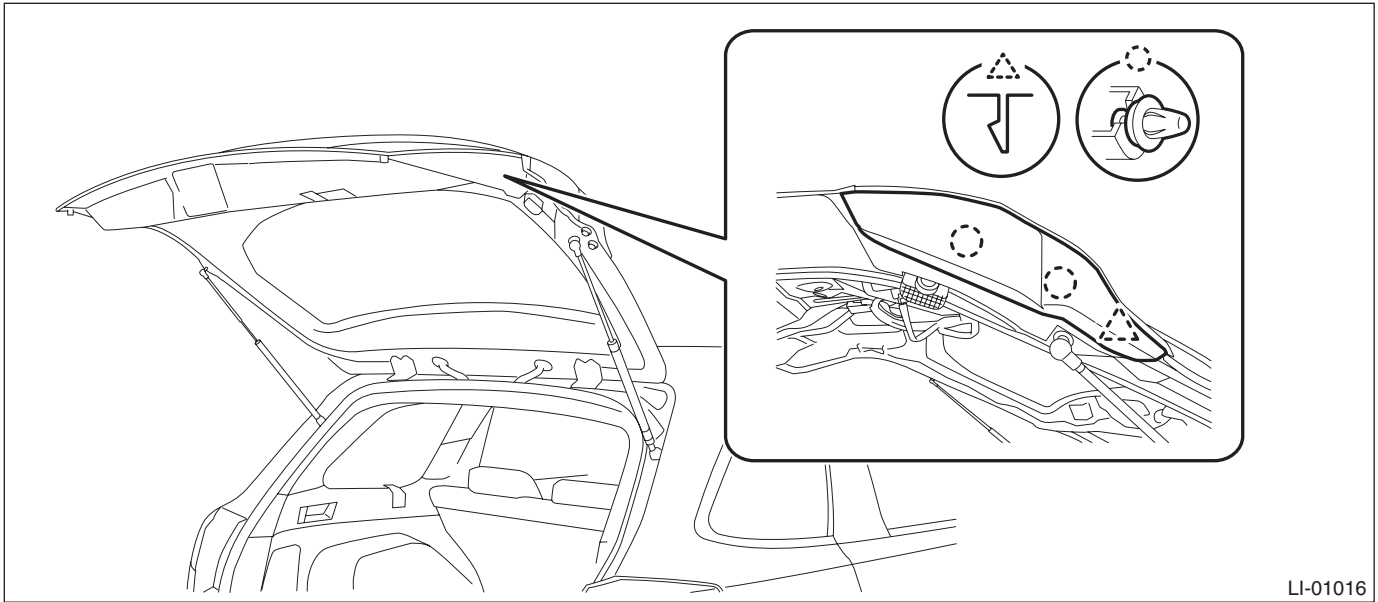

(2) Disconnect the harness connector of license plate light assembly.

(3) Remove the nuts.

(4) Remove the clips, and remove the rear gate garnish.

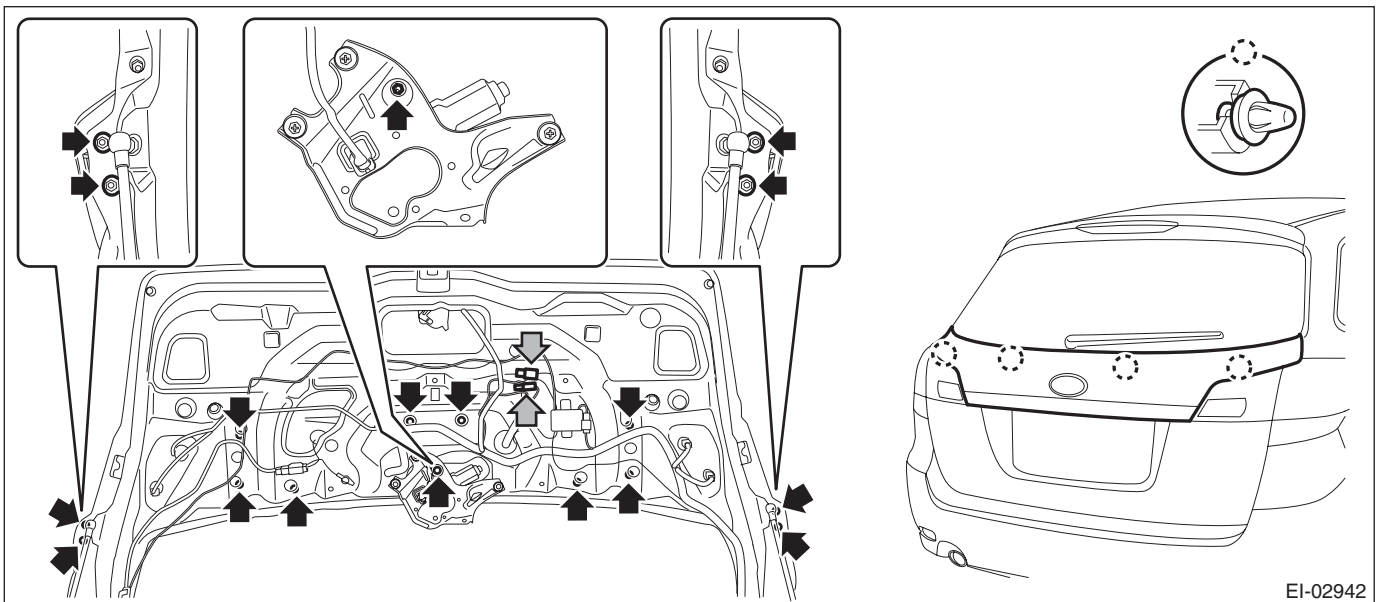

## B: INSTALLATION

### CAUTION:

**Make sure that the harness grommet is installed securely.**

**Incomplete installation causes water leak.**

Install each part in the reverse order of removal.

### Tightening torque

**Rear gate garnish: 4.5 N·m (0.46 kgf·m, 3.3 ft·lb)**