

## 11. Combination Switch (Light)

### A: REMOVAL

#### CAUTION:

Before handling the airbag module, refer to “CAUTION” of “General Description” in the “AB” section. <Ref. to AB-9, CAUTION, General Description.>

- 1) Position the front wheels straight ahead. (After moving a vehicle 5 m (16 ft) or more with front wheels positioned straight ahead, make sure that the vehicle moves straight ahead.)
- 2) Turn the ignition switch to OFF.
- 3) Disconnect the ground cable from battery and wait for at least 60 seconds before starting work.
- 4) Remove the driver's airbag module assembly.

#### Preparation tool: TORX® T30

- (1) Loosen the TORX® bolts located on the sides of the steering wheel.

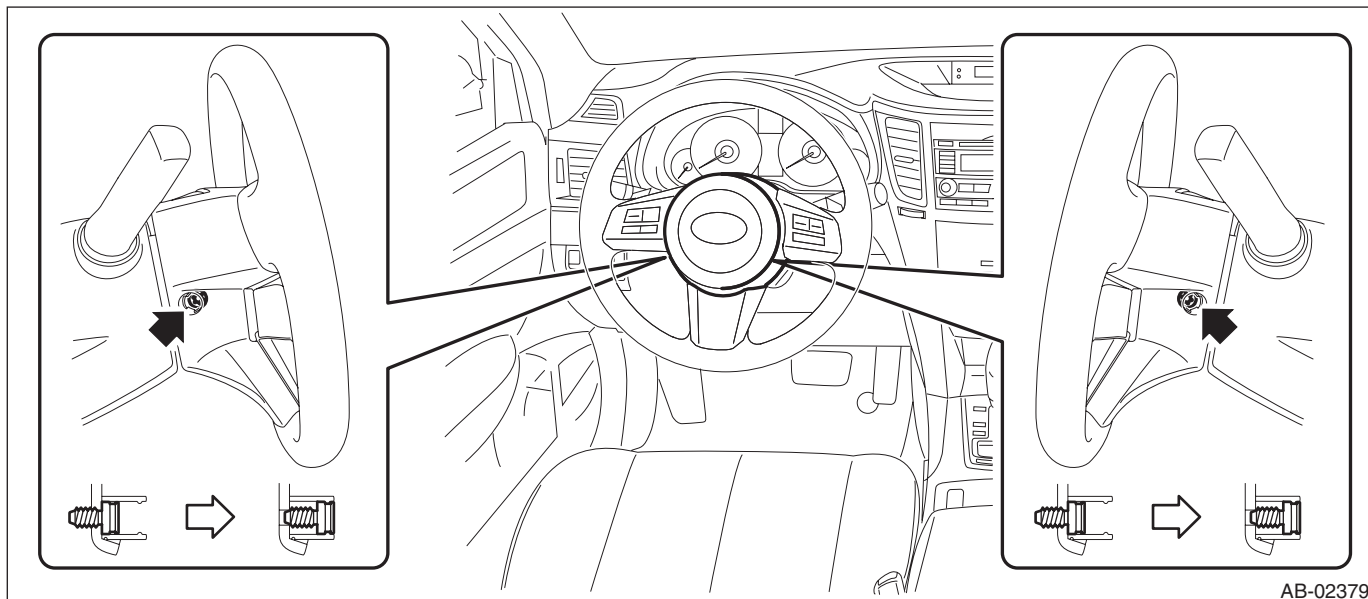

- (2) Disconnect the horn harness and airbag connector and remove the airbag module assembly. <Ref. to AB-18, PROCEDURE, Airbag Connector.>

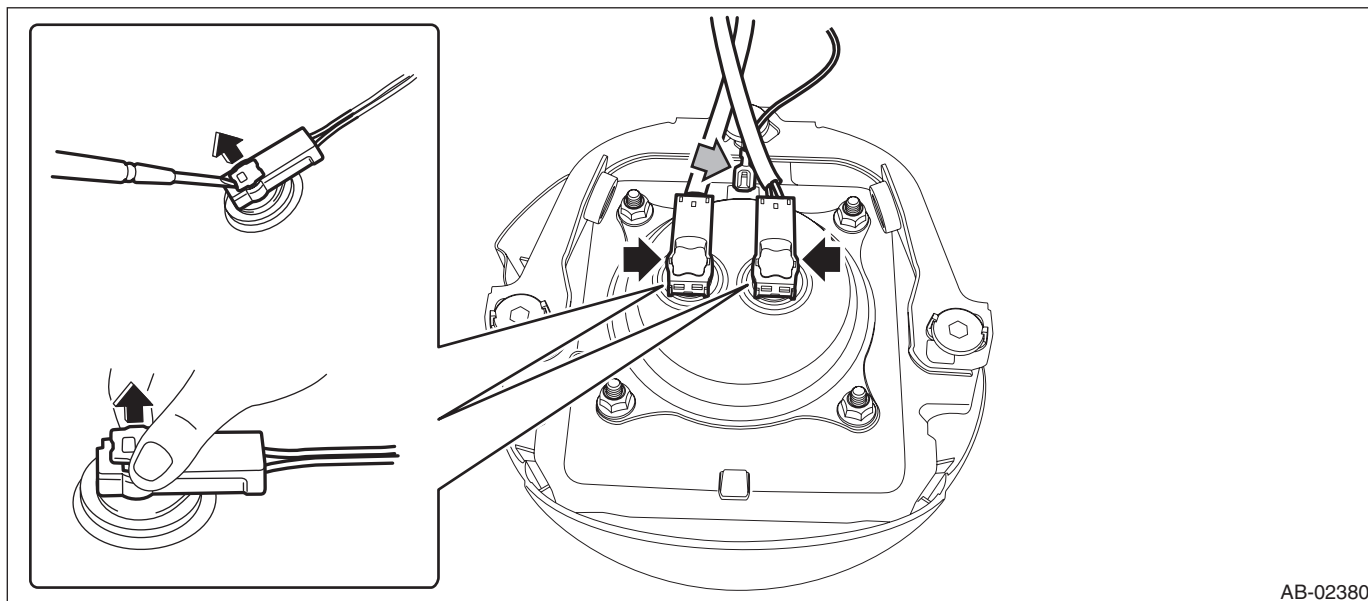

5) Remove the steering wheel.

**CAUTION:**

- Always use the steering wheel puller for removal to avoid deforming the steering wheel.
- If the steering wheel has been removed, make sure that the roll connector is not turned from the original position.

**Preparation tool: Steering wheel puller**

- (1) Disconnect the connector and remove the nut.
- (2) Put alignment marks and remove the steering wheel using a steering puller.

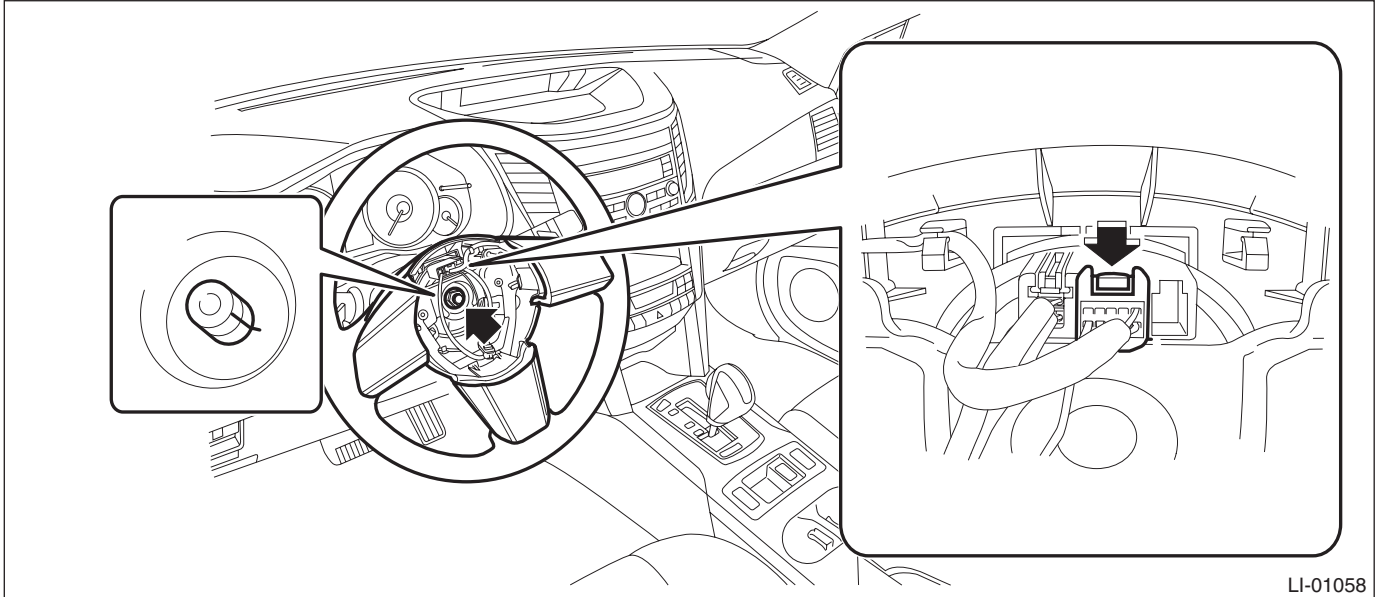

6) Remove the steering column cover.

- (1) Lower the lever of the steering column.
- (2) Release the claws and remove the screws, then detach the steering column lower cover.

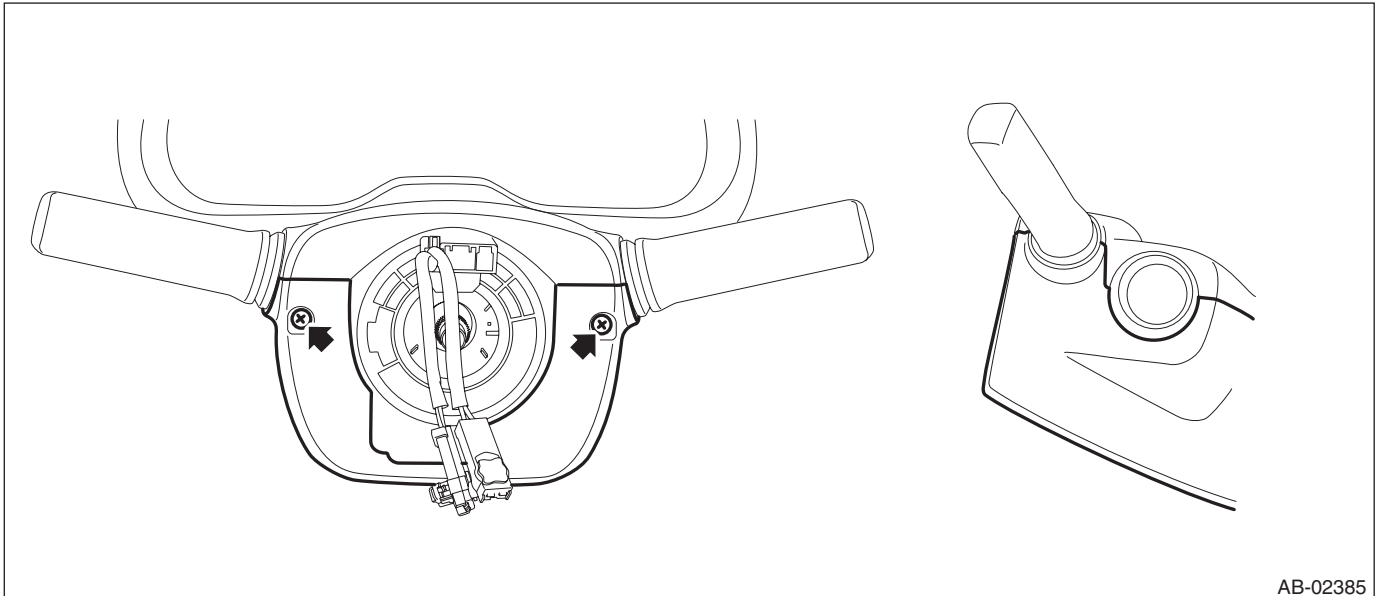

## Combination Switch (Light)

### LIGHTING SYSTEM

- (3) Separate the steering column upper cover and steering upper cover, and remove the steering column upper cover.

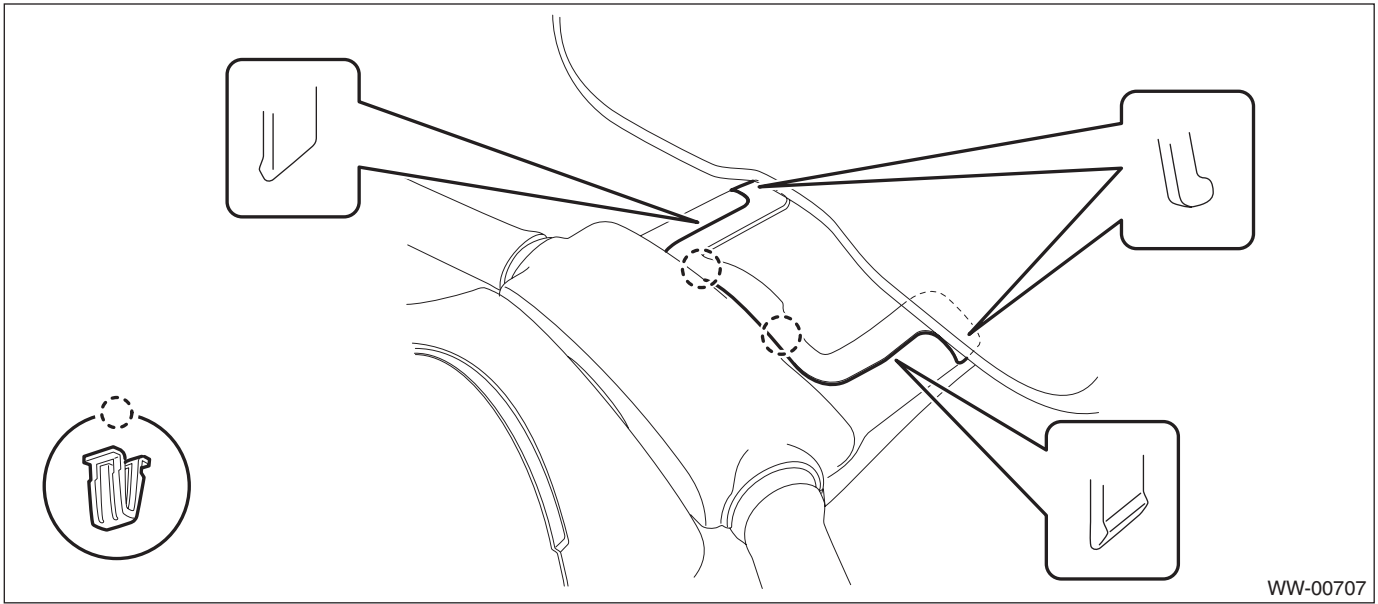

- 7) Remove the wiper switch assembly.

- (1) Disconnect the connector from wiper switch.
- (2) Release the claws, and pull out the wiper switch assembly.

#### CAUTION:

**Do not press the claws with excessive force. They may be damaged.**

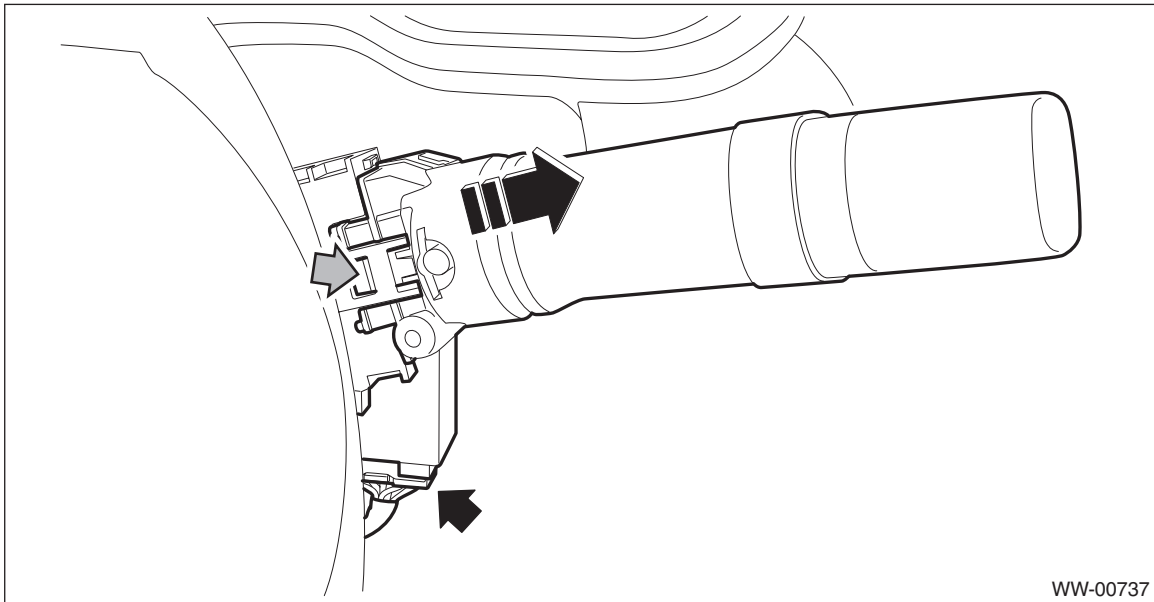

- 8) Remove the combination switch (light).
  - (1) Disconnect the connector of combination switch.
  - (2) Remove the screws and detach the combination switch (light).

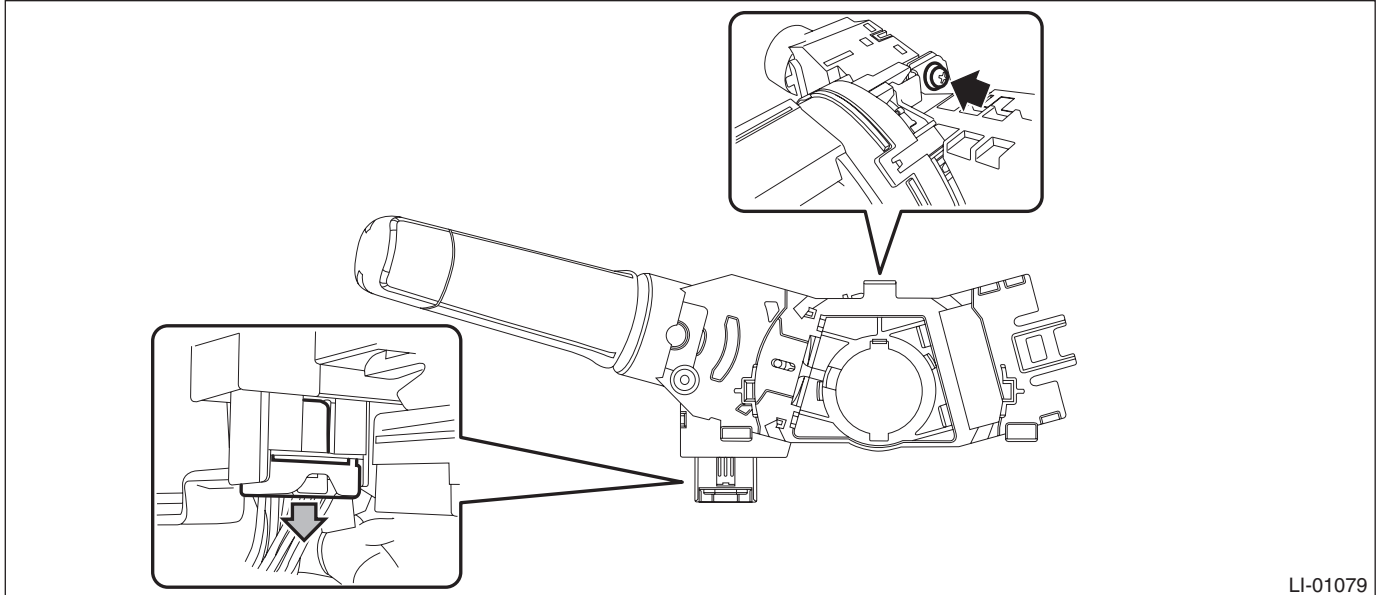

LI-01079

## B: INSTALLATION

### CAUTION:

- Before handling the airbag module, refer to “CAUTION” of “General Description” in the “AB” section. <Ref. to AB-9, CAUTION, General Description.>
  - Do not allow harness and connectors to interfere or get tangled up with other parts.
- 1) Align the center position of the roll connector. <Ref. to AB-100, ADJUSTMENT, Roll Connector.>
  - 2) Align the alignment marks on the steering wheel and steering shaft.
  - 3) Install each part in the reverse order of removal.

### Tightening torque:

**Combination switch (light): 3.5 N·m (0.36 kgf-m, 2.6 ft-lb)**

**Driver's airbag module: 10 N·m (1.02 kgf-m, 7.4 ft-lb)**

**Steering wheel: 39 N·m (3.98 kgf-m, 28.8 ft-lb)**

**Clearance between column cover and steering wheel: 2 — 4 mm (0.08 — 0.16 in)**

# Combination Switch (Light)

## LIGHTING SYSTEM

### C: INSPECTION

- 1) Disconnect the combination switch (light) connector.
- 2) Measure the resistance between combination switch (light) connector terminals.

**Preparation tool: Circuit tester**

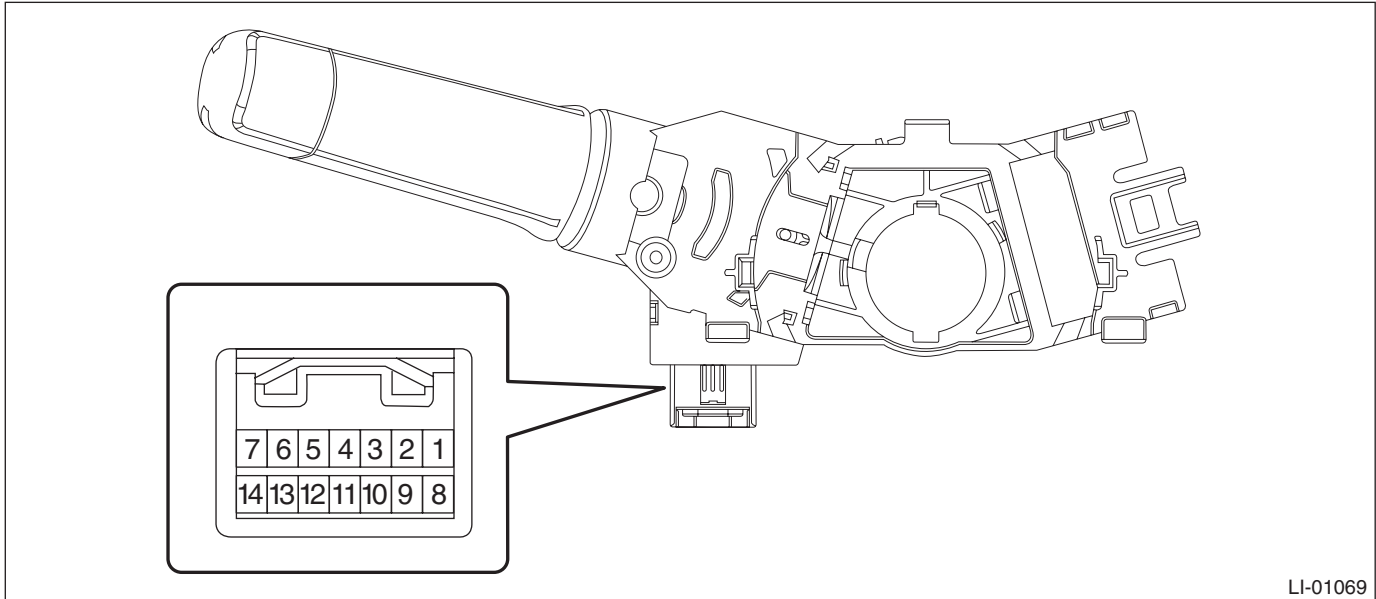

LI-01069

- 3) Replace the combination switch (light) if the inspection result is not within the standard value.

#### 1. LIGHTING SWITCH

Terminal No.	Inspection Conditions	Specification
—	Switch OFF	1 M $\Omega$ or more
5 — 7	Switch 1 (TAIL)	Less than 1 $\Omega$
6,5 — 7	Switch 2 (HEAD)	Less than 1 $\Omega$
14 — 7	Switch AUTO	Less than 1 $\Omega$

#### 2. DIMMER & PASSING SWITCH

Terminal No.	Inspection Conditions	Specification
4,3 — 7	Switch PASS	Less than 1 $\Omega$
4 — 7	Switch UP	Less than 1 $\Omega$

#### 3. TURN SIGNAL SWITCH

Terminal No.	Inspection Conditions	Specification
1 — 7	Switch TURN (RH)	Less than 1 $\Omega$
2 — 7	Switch TURN (LH)	Less than 1 $\Omega$

#### 4. FRONT FOG LIGHT SWITCH

Terminal No.	Inspection Conditions	Specification
12 — 11	Switch OFF	1 M $\Omega$ or more
	Switch ON	Less than 1 $\Omega$