

# Turn Signal Light and Hazard Light System

## LIGHTING SYSTEM

### 7. Turn Signal Light and Hazard Light System

#### A: WIRING DIAGRAM

Refer to “Turn Signal and Hazard Light System” in the WIRING DIAGRAM. <Ref. to WI-225, WIRING DIAGRAM, Turn Signal Light and Hazard Light System.>

#### B: INSPECTION

##### 1. CHECK TURN SIGNAL SWITCH

Measure the resistance between turn signal switch terminals. <Ref. to LI-22, INSPECTION, Combination Switch (Light).>

##### 2. CHECK HAZARD SWITCH

1) Remove the A/C control panel.

- Manual A/C model: <Ref. to AC-44, MANUAL A/C MODEL, REMOVAL, Control Panel.>
- Auto A/C model: <Ref. to AC-41, AUTO A/C MODEL, REMOVAL, Control Panel.>

2) Measure the resistance between hazard switch terminals.

**Preparation tool: Circuit tester**

- AUTO A/C MODEL

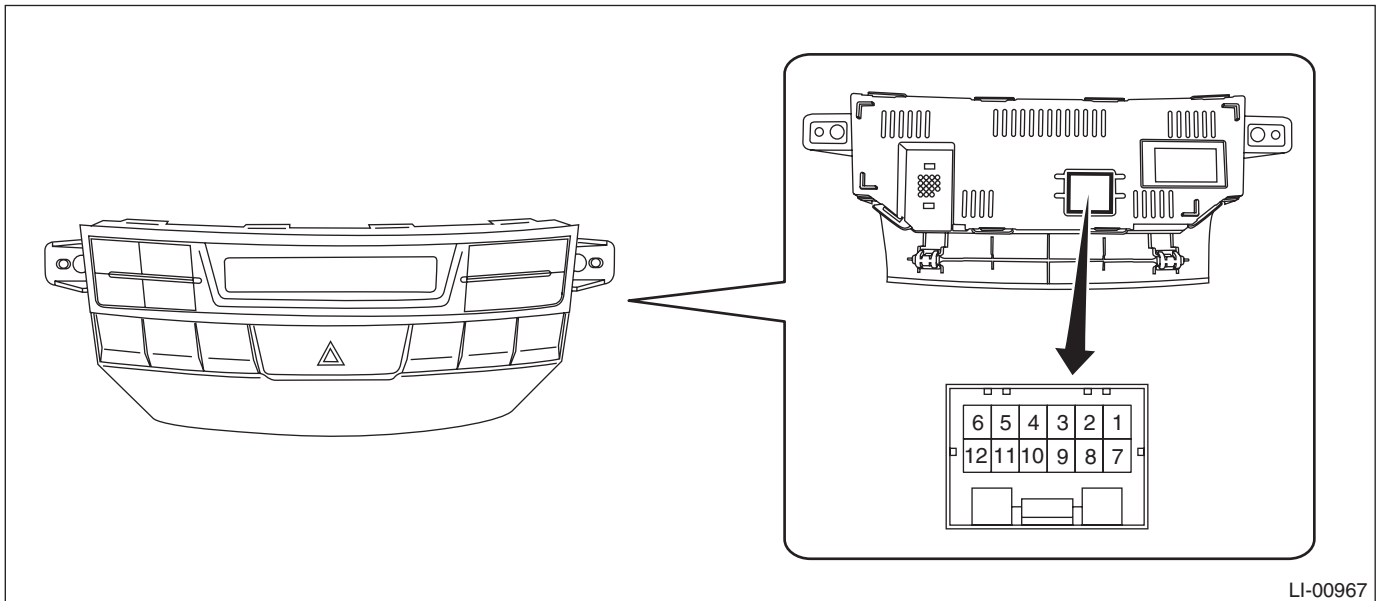

LI-00967

Terminal No.	Inspection conditions	Specification
1 — 2	Switch OFF	1 MΩ or more
	Switch ON	Less than 1 Ω

• MANUAL A/C MODEL

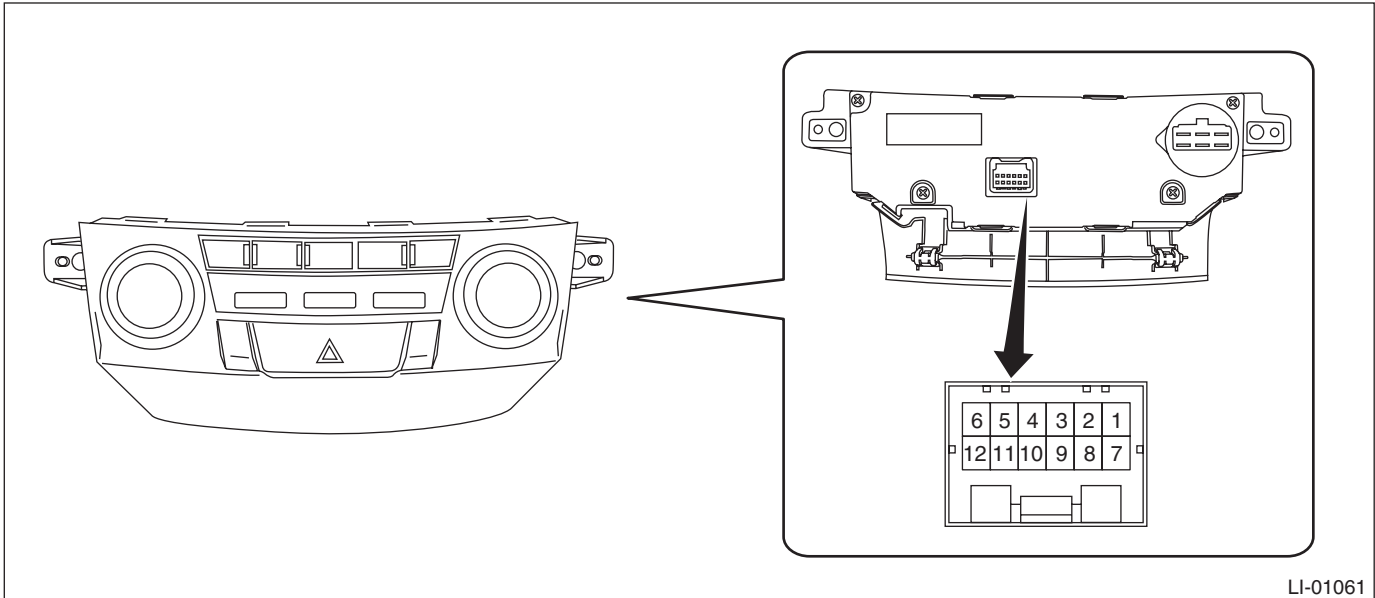

Terminal No.	Inspection conditions	Specification
4 — 5	Switch OFF	1 MΩ or more
	Switch ON	Less than 1 Ω

3) Replace the A/C control panel if the inspection result is not within the standard value.

### 3. CHECK TURN SIGNAL AND HAZARD MODULE

1) Measure the voltage between turn signal & hazard module connector and chassis ground.

**Preparation tool: Circuit tester**  
**Connector**

Terminal No.	Input/Output	Inspection conditions	Standard
6 ↔ Chassis ground	Input	Turn signal switch (Right) OFF → ON	9 V or more → less than 1 V
5 ↔ Chassis ground	Input	Turn signal switch (Left) OFF → ON	9 V or more → less than 1 V
8 ↔ Chassis ground	Input	Hazard switch OFF → ON	9 V or more → less than 1 V
2 ↔ Chassis ground	Output	Turn signal switch (Right) OFF → ON	Repeat less than 1 V → less than 1 V ↔ more than 9 V at 60 to 120 times per minute.
3 ↔ Chassis ground	Output	Turn signal switch (Left) OFF → ON	Repeat less than 1 V → less than 1 V ↔ more than 9 V at 60 to 120 times per minute.
2 ↔ Chassis ground	Output	Hazard switch OFF → ON	Repeat less than 1 V → less than 1 V ↔ more than 9 V at 60 to 120 times per minute.
3 ↔ Chassis ground	Output	Hazard switch OFF → ON	Repeat less than 1 V → less than 1 V ↔ more than 9 V at 60 to 120 times per minute.

2) Replace the turn signal and hazard module if the inspection result is not within the standard value.

### C: NOTE

For operation procedures of each component of the turn signal and hazard light system, refer to the respective sections.

- Combination switch (light): <Ref. to LI-18, Combination Switch (Light).>
- Front turn signal light bulb: <Ref. to LI-34, Front Turn Signal Light Bulb.>
- Side turn signal light assembly: <Ref. to LI-43, Side Turn Signal Light Assembly.>
- Rear combination light assembly: <Ref. to LI-44, Rear Combination Light Assembly.>
- Rear turn signal light bulb: <Ref. to LI-50, Rear Turn Signal Light Bulb.>