

### 8. Back-up Light System

#### A: WIRING DIAGRAM

Refer to “Back-up Light System” in the WIRING DIAGRAM. <Ref. to WI-66, WIRING DIAGRAM, Back-up Light System.>

#### B: INSPECTION

##### 1. CHECK BACK-UP LIGHT SWITCH (MT MODEL)

- 1) Disconnect the back-up light switch connector.
- 2) Measure the resistance between back-up light switch terminals.

**Preparation tool: Circuit tester**

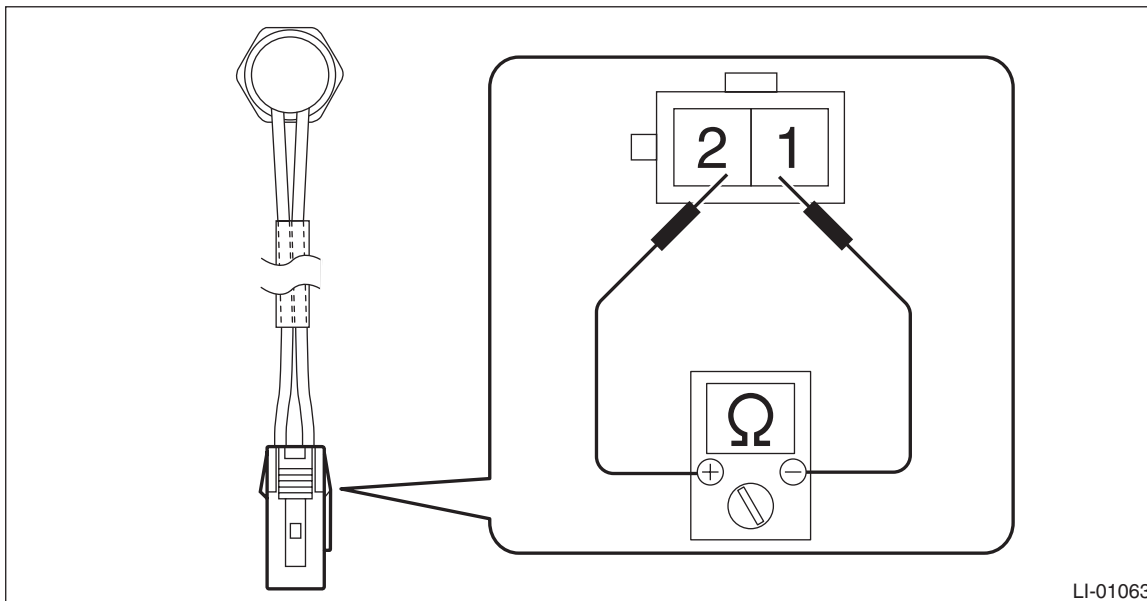

Terminal No.	Inspection conditions	Specification
1 — 2	When shift lever is set in reverse position	Less than 1 Ω
	Other positions	1 MΩ or more

- 3) Replace the back-up light switch if the inspection result is not within the standard value.

## 2. CHECK INHIBITOR SWITCH (AT/CVT MODEL)

- 1) Disconnect the inhibitor switch connector.
- 2) Measure the resistance between inhibitor switch terminals.

**Preparation tool: Circuit tester**

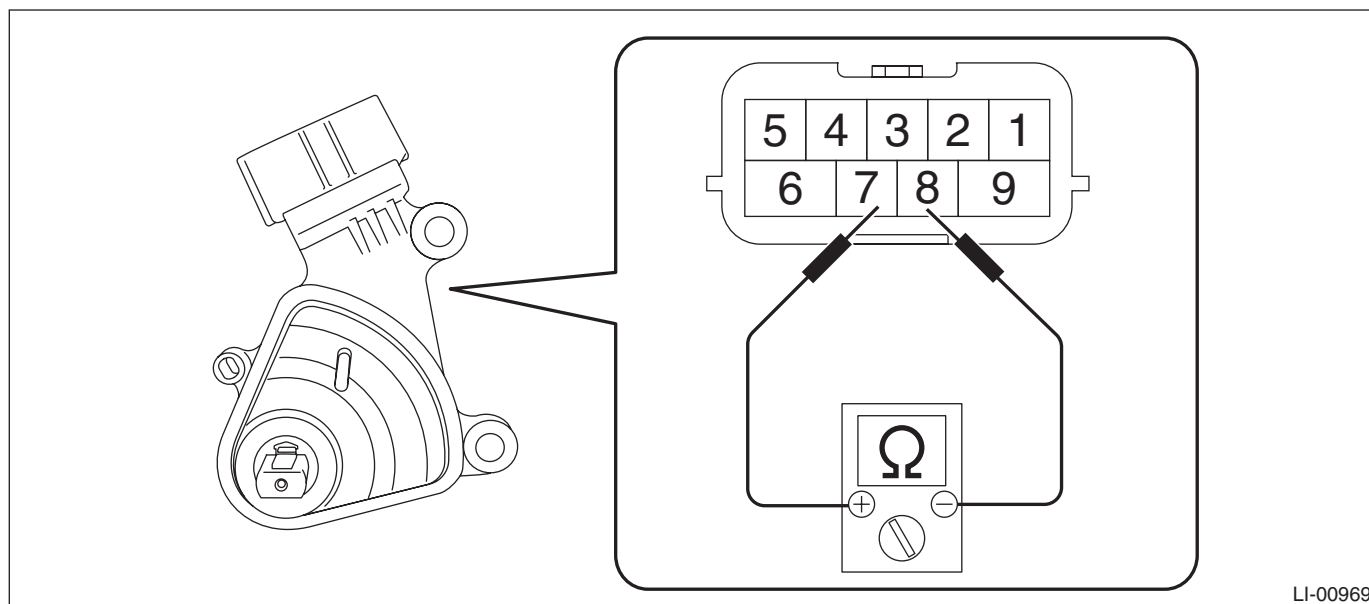

Terminal No.	Inspection conditions	Specification
7 — 8	When the selector lever is in the “R” range	Less than 1 $\Omega$
	Other positions	1 M $\Omega$ or more

- 3) Replace the inhibitor switch if the inspection result is not within the standard value.

### C: NOTE

For operation procedures of each component of the back-up light system, refer to the respective section.

- Rear combination light assembly: <Ref. to LI-44, Rear Combination Light Assembly.>
- Rear finisher light assembly: <Ref. to LI-53, Rear Finisher Light Assembly.>
- Back-up light bulb: <Ref. to LI-55, Back-up Light Bulb.>