

## 11.Rear Washer

### A: REMOVAL

- 1) Disconnect the ground cable from battery.
- 2) Remove the rear gate upper trim.
  - (1) Remove the claws on the trim edge.
  - (2) Disconnect the claws in the center of trim, and remove the rear gate upper trim.

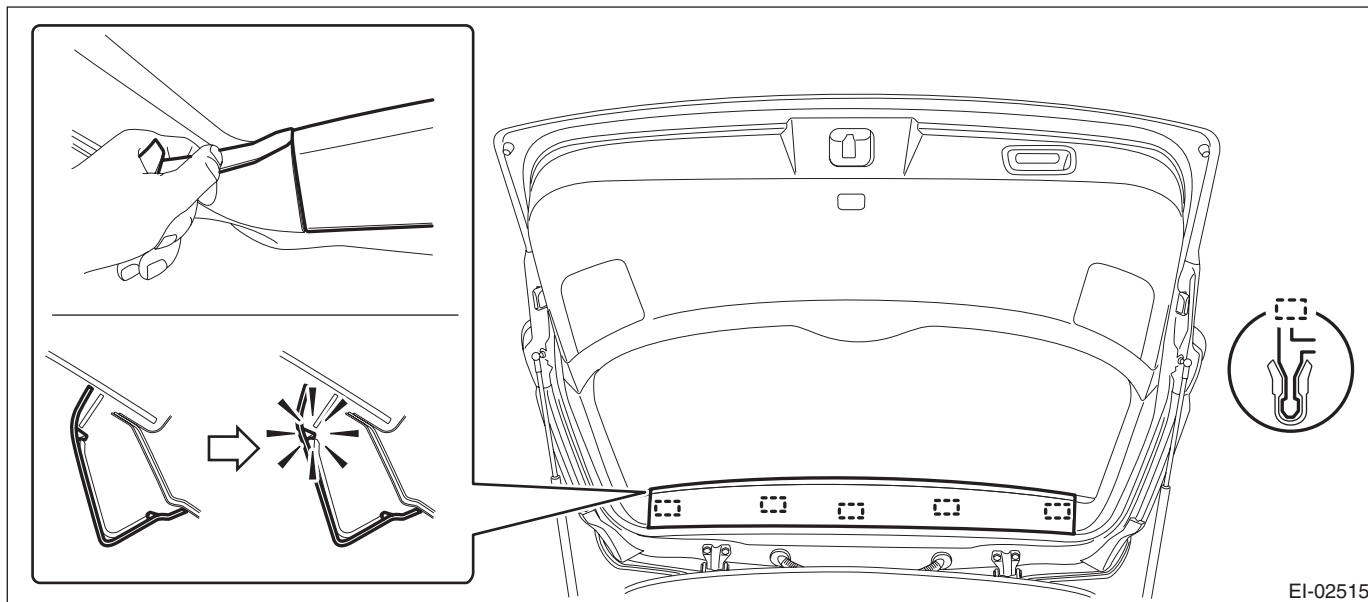

- 3) Remove the high-mounted stop light.
  - (1) Remove the nuts.

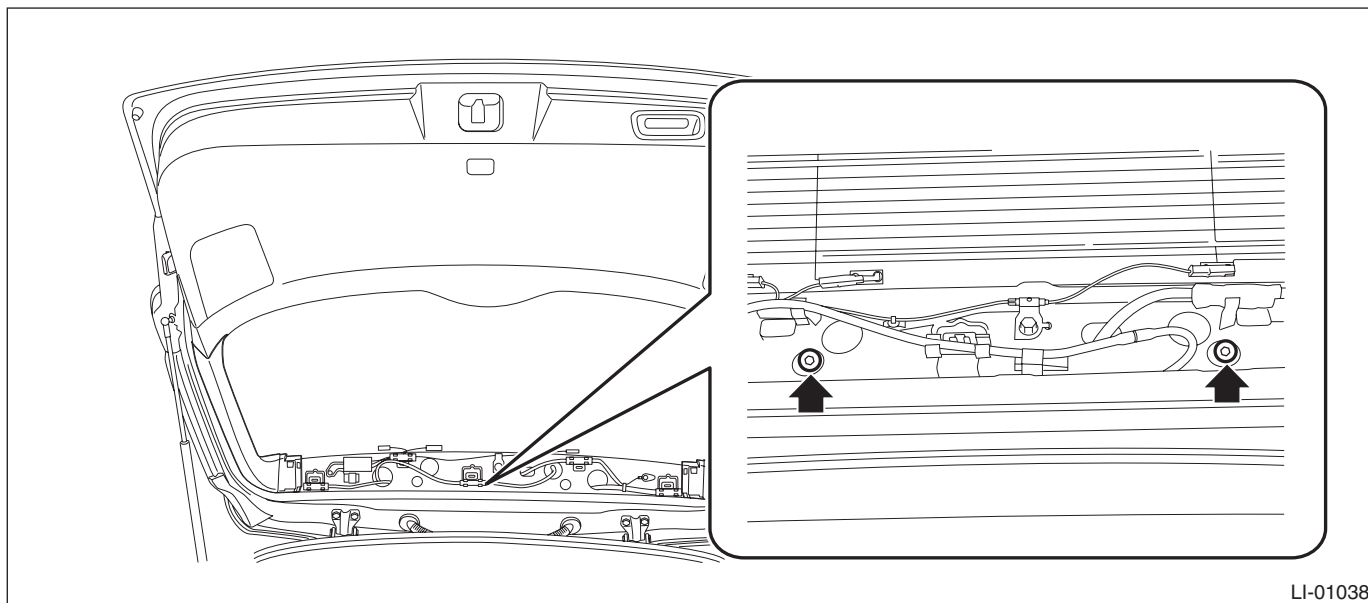

## Rear Washer

### WIPER AND WASHER SYSTEMS

- (2) Disconnect the connector and remove the high-mounted stop light.

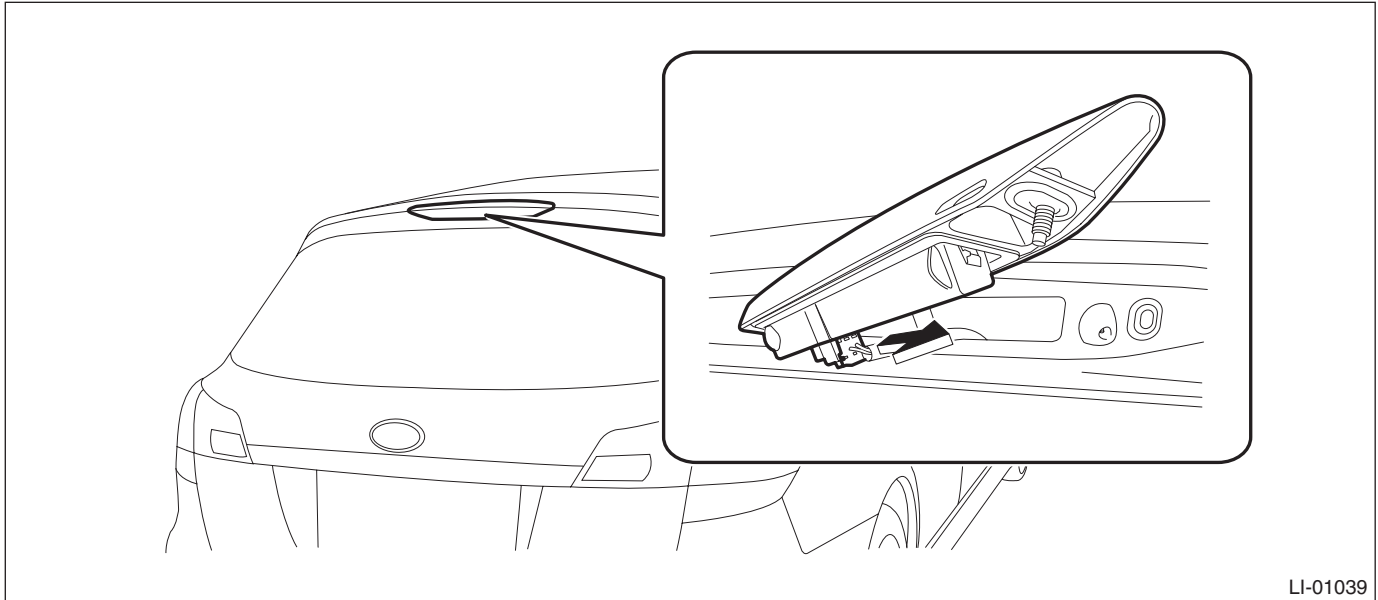

- 4) Remove the rear washer nozzle.

#### CAUTION:

**Before removing, apply protective tape to the body panel and used tools not to damage the rear gate panel.**

- (1) Push the claw using a flat tip screwdriver, etc.
- (2) When the washer nozzle lifts up, pull out the nozzle using a clip remover, etc.
- (3) Disconnect the washer hose and remove the washer nozzle.

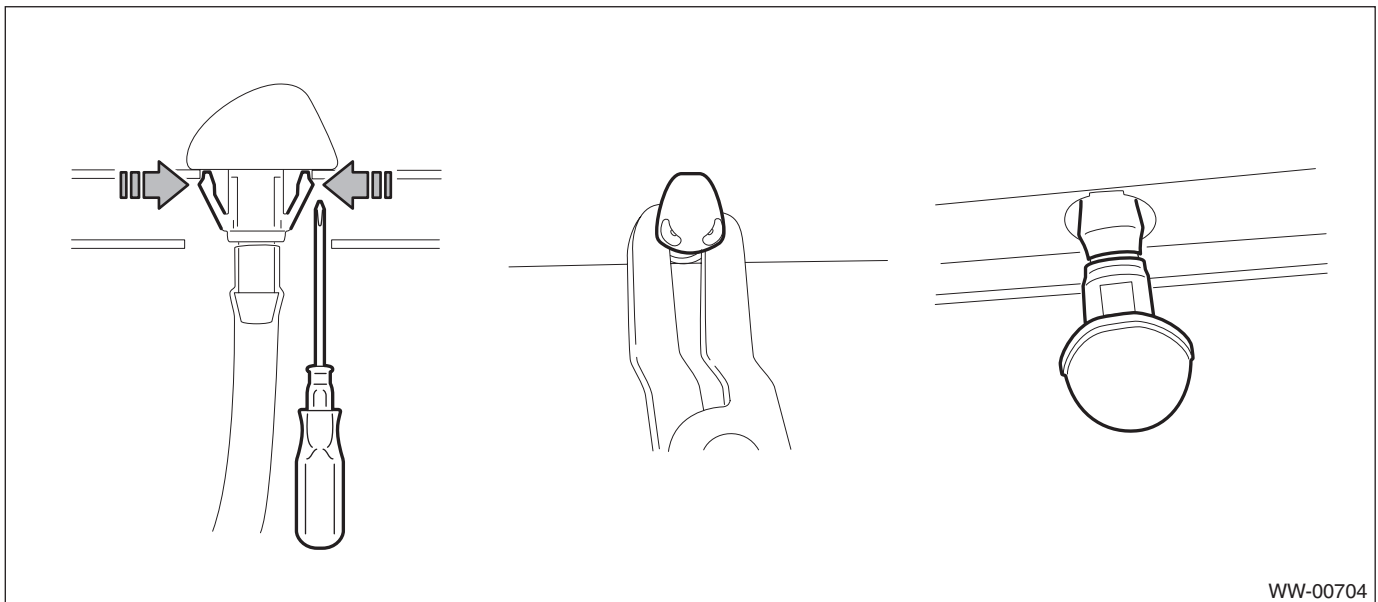

## B: INSTALLATION

- 1) Install each part in the reverse order of removal.

#### **Tightening torque:**

**High-mounted stop light assembly: 4.5 N·m (0.46 kgf-m, 3.3 ft-lb)**

- 2) Check the washer nozzle position. <Ref. to WW-45, VISUAL INSPECTION, INSPECTION, Rear Washer.>

## C: INSPECTION

### 1. VISUAL INSPECTION

Check for the following items, and if any malfunction is found, replace the corresponding part.

- Make sure the nozzle and hose are not clogged.
- Make sure the hose is not bent.

### 2. INSPECTING THE SPRAY POSITION

- 1) Turn the wiper switch to OFF position.
- 2) While the vehicle is stopped, check that the washer spray position is as shown in the figure.
- 3) After inspection, if the spray position is out of the specified range, adjust the position or replace with the new washer nozzle.

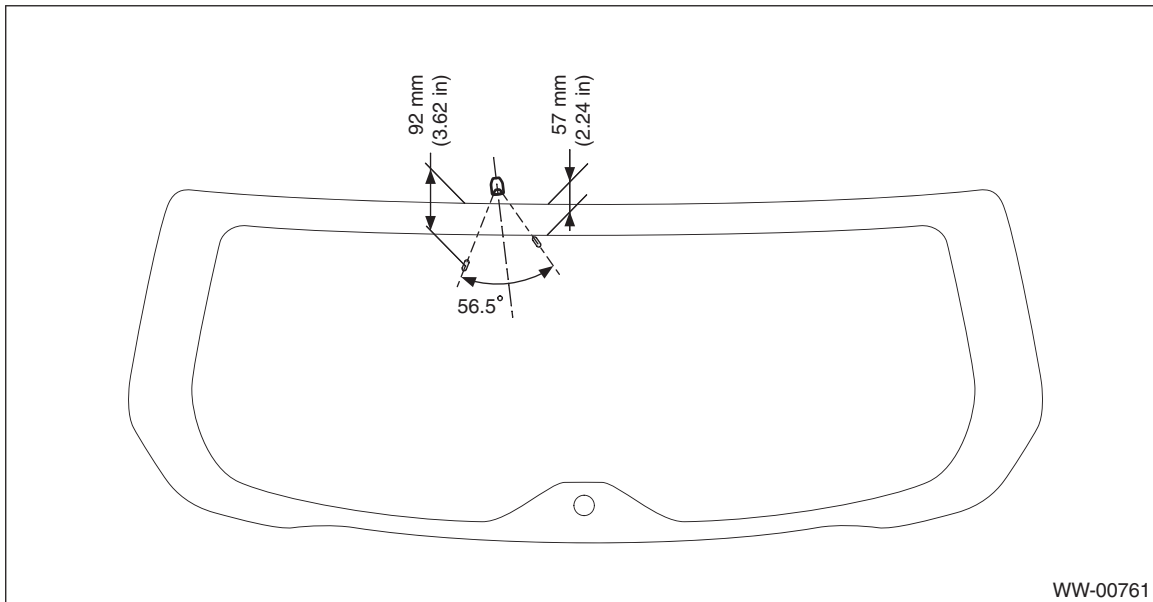

## Rear Washer

WIPER AND WASHER SYSTEMS

---

---

	Page
1. General Description .....	2
2. Audio System .....	3
3. Navigation System .....	4
4. Audio .....	8
5. Front Speaker .....	11
6. Rear Speaker .....	14
7. Woofer .....	16
8. Power Amplifier .....	18
9. Antenna .....	19
10. Noise Suppressor .....	27
11. Steering Satellite Switch .....	29
12. Navigation Body .....	34
13. GPS Antenna .....	37
14. Rearview Camera System .....	42
15. Front Accessory Power Supply Socket .....	51
16. Rear Accessory Power Supply Socket .....	55
17. AUX Input Terminal .....	58