

# Torque Converter Assembly

## AUTOMATIC TRANSMISSION

## 22. Torque Converter Assembly

### A: REMOVAL

1) Remove the transmission assembly from vehicle body. <Ref. to 5AT-36, REMOVAL, Automatic Transmission Assembly.>

2) Pull out the torque converter and oil pump shaft horizontally.

#### NOTE:

- Be sure not to scratch the inside of bushing in oil pump shaft.
- Be careful that the oil pump shaft may drawn out simultaneously.

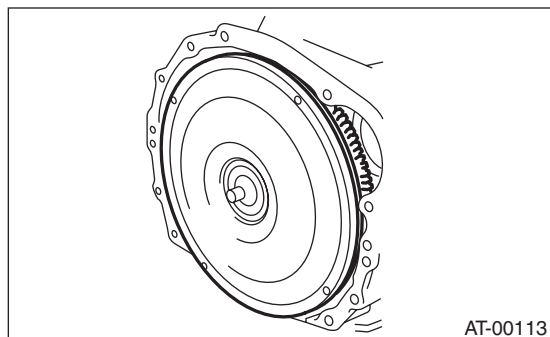

3) Remove the oil pump shaft from torque converter as necessary.

### B: INSTALLATION

1) When the oil pump shaft is removed, install the shaft to torque converter.

#### NOTE:

- Use a new circlip.
  - Make sure the circlip is firmly inserted.
- 2) Install the oil pump shaft to torque converter, and then make sure that the clip is secured on groove.
- 3) Apply ATF to the revolving and sliding surface of the oil pump shaft.
- 4) Holding the torque converter assembly by hand, lightly rotate it to engage with the oil pump rotor.
- 5) Check the protruding dimension of the torque converter assembly.

#### **Dimension A:**

**8 mm (0.31 in) or less**

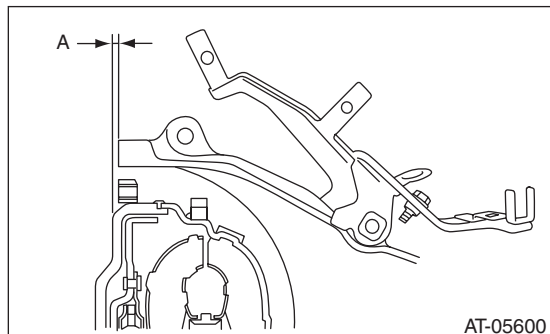

6) Install the transmission assembly to the vehicle. <Ref. to 5AT-41, INSTALLATION, Automatic Transmission Assembly.>

### C: INSPECTION

Make sure the ring gear and protrusion of torque converter end are not deformed or damaged.