

35. Transmission Control Device

A: REMOVAL

- 1) Remove the transmission assembly from the vehicle. <Ref. to 5AT-36, REMOVAL, Automatic Transmission Assembly.>
- 2) Pull out the torque converter assembly. <Ref. to 5AT-62, REMOVAL, Torque Converter Assembly.>
- 3) Lift up the lever on the rear side of transmission harness connector, and then disconnect it from the stay.
- 4) Wrap vinyl tape around the nipple attached to the air breather hose.
- 5) Remove the transmission hanger COMPL.
- 6) Remove the control valve body assembly. <Ref. to 5AT-54, REMOVAL, Control Valve Body.>
- 7) Pull out the straight pin of manual plate.

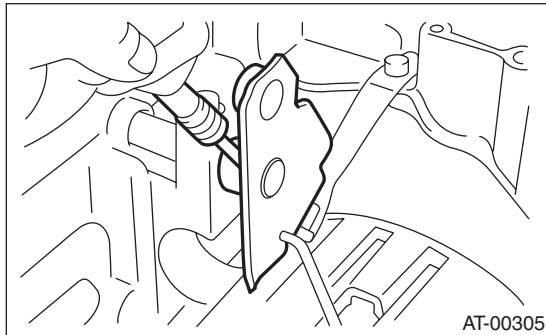

- 8) Remove the bolts securing range select lever, and then remove the select lever, manual plate and parking rod.

NOTE:

Be careful not to damage the lips of press-fitted oil seal in the case.

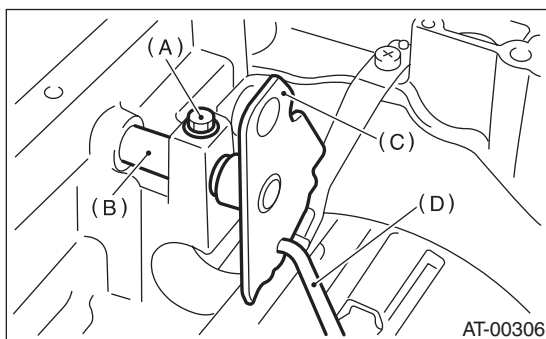

- (A) Bolt
- (B) Range select lever
- (C) Manual plate
- (D) Parking rod

- 9) Remove the detent spring.

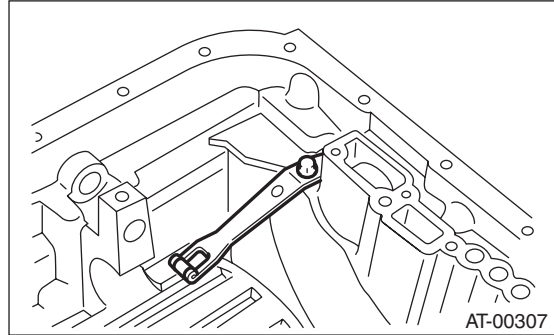

B: INSTALLATION

- 1) Install the detent spring to the transmission case.

Tightening torque:

7 N·m (0.7 kgf-m, 5.2 ft-lb)

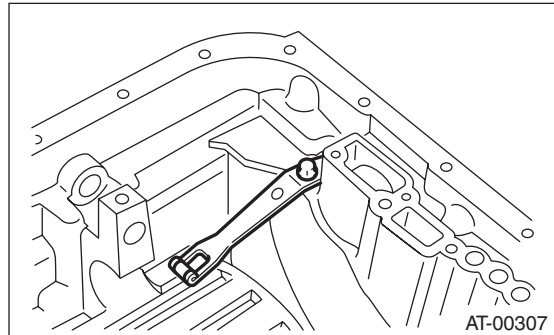

- 2) Insert the range select lever, and tighten the bolts.

Tightening torque:

6 N·m (0.6 kgf-m, 4.4 ft-lb)

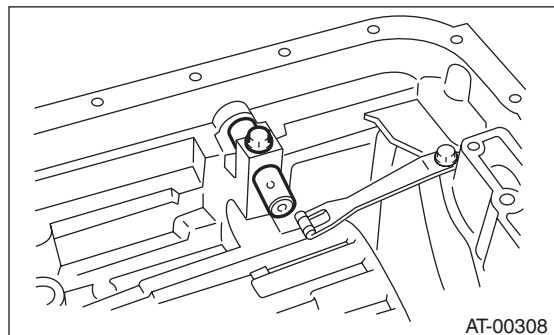

Transmission Control Device

AUTOMATIC TRANSMISSION

- 3) Insert the manual plate and parking rod.

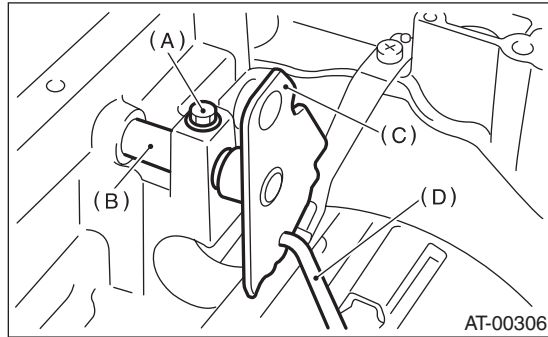

- (A) Bolt
- (B) Range select lever
- (C) Manual plate
- (D) Parking rod

- 4) Insert the straight pin to the manual plate.

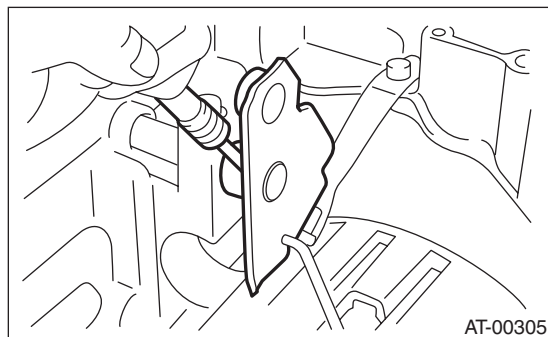

- 5) Install the oil pan and the control valve body assembly. <Ref. to 5AT-54, INSTALLATION, Control Valve Body.>

- 6) Install the transmission hanger COMPL.

Tightening torque:

41 N·m (4.2 kgf-m, 30.2 ft-lb)

- 7) Insert the transmission connector to the stay.
- 8) Install the air breather hose. <Ref. to 5AT-60, INSTALLATION, Air Breather Hose.>
- 9) Install the torque converter assembly. <Ref. to 5AT-62, INSTALLATION, Torque Converter Assembly.>
- 10) Install the transmission assembly to the vehicle. <Ref. to 5AT-41, INSTALLATION, Automatic Transmission Assembly.>

C: INSPECTION

Make sure the manual lever and detent spring are not worn or otherwise damaged.