

### 5. Horn Switch

#### A: REMOVAL

##### NOTE:

Horn switch is a unit with the driver's airbag module.

- 1) Position the front wheels straight ahead. (After moving a vehicle 5 m (16 ft) or more with front wheels positioned straight ahead, make sure that the vehicle moves straight ahead.)
- 2) Turn the ignition switch to OFF.
- 3) Disconnect the ground cable from battery and wait for at least 60 seconds before starting work.
- 4) Remove the driver's airbag module assembly.

##### CAUTION:

**Before handling the airbag module, refer to "CAUTION" of "General Description" in "AIRBAG SYSTEM". <Ref. to AB-10, CAUTION, General Description.>**

- (1) Using a hexagon wrench etc. wrapped by protective tape, insert the snap pins and release the locks (3 locations).

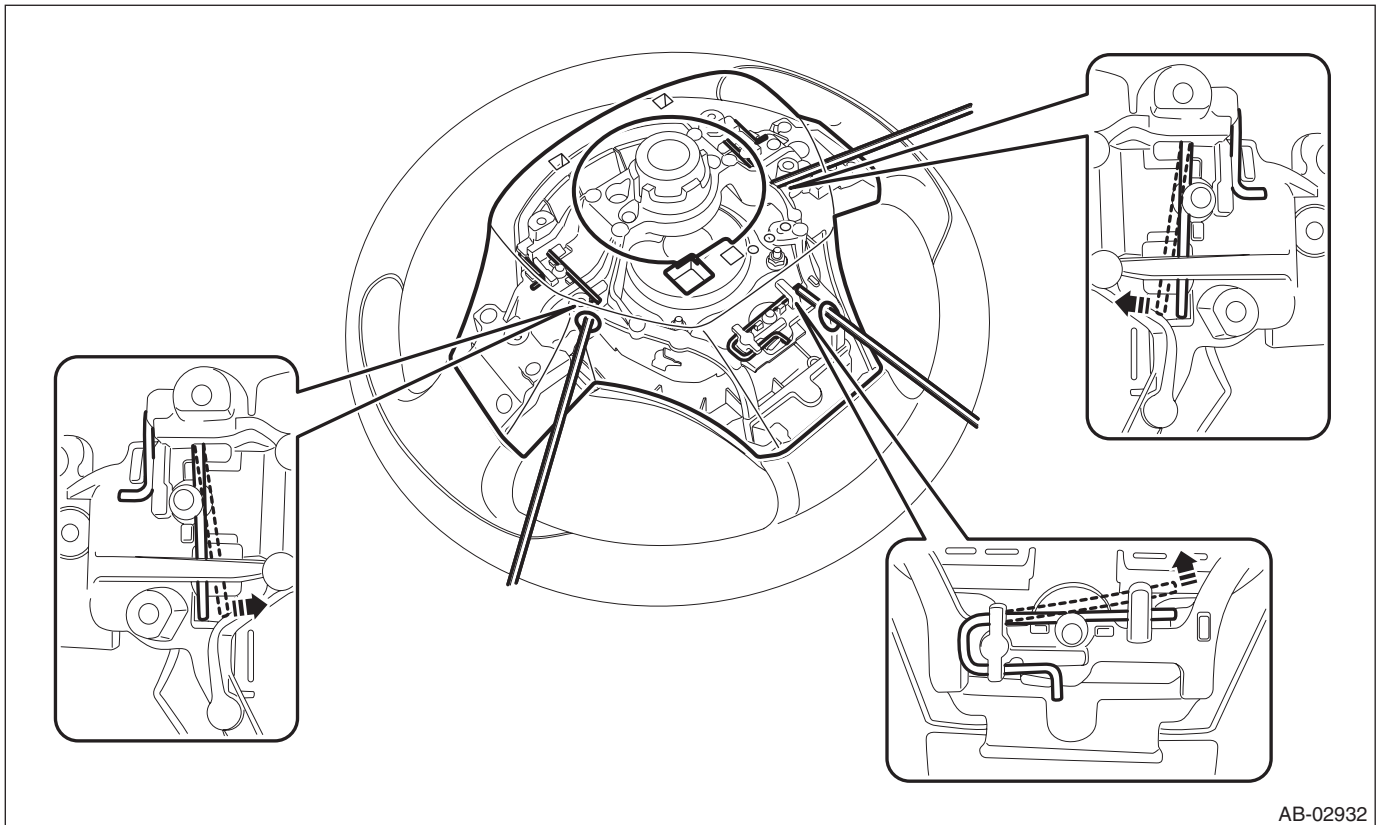

AB-02932

(2) Disconnect the horn harness and airbag connector and remove the airbag module assembly. <Ref. to AB-22, DRIVER' AIRBAG MODULE, CURTAIN AIRBAG MODULE, PRETENSIONER & LAP SEAT BELT PRETENSIONER, PROCEDURE, Airbag Connector.>

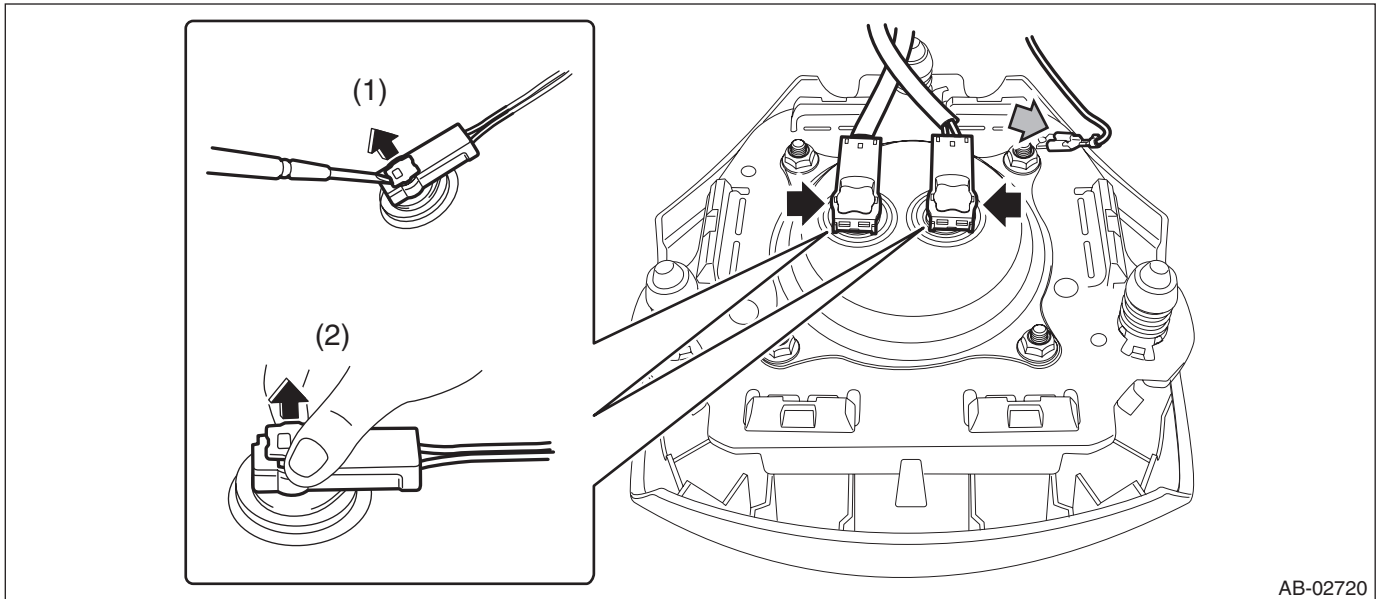

AB-02720

## B: INSTALLATION

### CAUTION:

- Before handling the airbag module, refer to “CAUTION” of “General Description” in “AIRBAG SYSTEM”. <Ref. to AB-10, CAUTION, General Description.>
  - Do not allow harness and connectors to interfere or get tangled up with other parts.
- 1) Install the driver's airbag module. <Ref. to AB-38, INSTALLATION, Driver's Airbag Module.>
- 2) Install each part in the reverse order of removal.

C: INSPECTION

1. CHECK HORN SWITCH

- 1) Remove the horn switch. <Ref. to COM-8, REMOVAL, Horn Switch.>
- 2) Check that the connection of the horn switch harness connector is correct.
- 3) Disconnect the horn switch harness connector and check the resistance between the harness connectors.

Preparation tool:  
Circuit tester

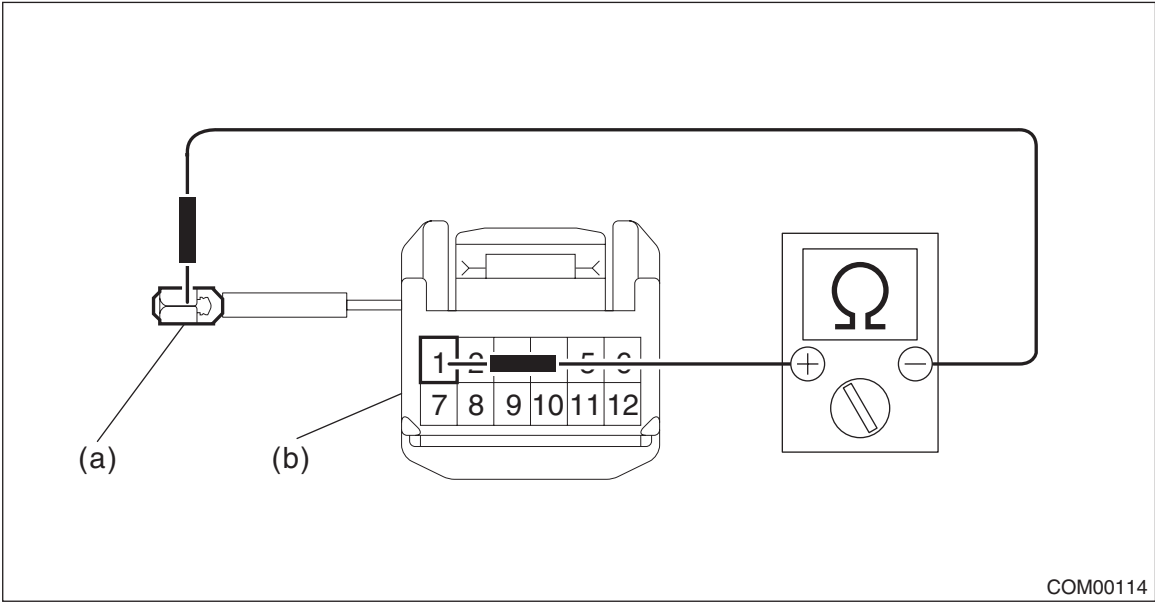

(a) Ground terminal (b) Horn switch terminal

Terminal No.	Inspection conditions	Standard
Ground terminal (a) — Horn switch terminal (b)	The airbag module bracket being pushed	Less than 1 $\Omega$
	The airbag module bracket being separated	1 M $\Omega$ or more

- 4) Replace the driver's airbag module if the inspection result is not within the standard value.

2. CHECK ROLL CONNECTOR

- 1) Remove the roll connector. <Ref. to AB-102, REMOVAL, Roll Connector.>
- 2) Check the resistance between roll connector terminals.

Preparation tool:  
Circuit tester

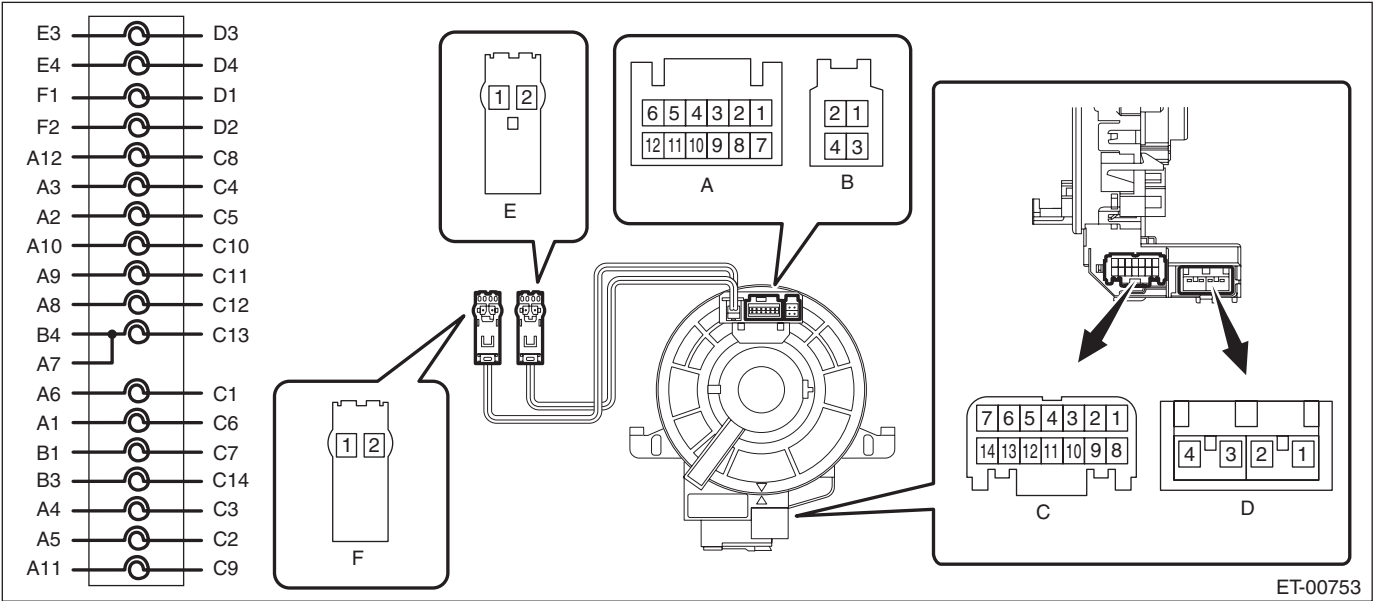

Terminal No.	Inspection conditions	Standard
A1 — C6	Always	Less than 1 Ω

- 3) Replace the roll connector if the inspection result is not within the standard value.

# Horn Switch

COMMUNICATION SYSTEM

---

# GLASS/WINDOWS/MIRRORS

# GW

---

	Page
1. General Description .....	2
2. Relay and Fuse .....	8
3. Power Window System .....	10
4. Power Window Control Switch .....	12
5. Front Door Glass .....	17
6. Front Regulator and Motor Assembly .....	19
7. Remote Control Mirror System .....	22
8. Scalp Cap .....	23
9. Outer Mirror Assembly .....	28
10. Outer Mirror .....	30
11. Remote Control Mirror Switch .....	32
12. Rear Door Glass .....	34
13. Rear Regulator and Motor Assembly .....	36
14. Windshield Glass .....	40
15. Rear Gate Glass .....	48
16. Rear Window Glass .....	52
17. Rear Window Defogger System .....	55
18. Rear Quarter Glass .....	58
19. Rearview Mirror .....	60
20. Wiper Deicer System .....	63