

A: COMPONENT

(A)

This diagram shows an exploded view of a mechanical assembly. The components are numbered as follows:

- (1) Main housing or base unit.
- (2) A bracket or support arm.
- (3) A long, curved handle or lever.
- (4) A small rectangular component, possibly a switch or sensor.
- (5) A small cylindrical component, possibly a pin or bush.
- (6) A small rectangular component, possibly a switch or sensor.
- (7) A small rectangular component, possibly a switch or sensor.
- (8) A long, curved handle or lever.
- (9) A small rectangular component, possibly a switch or sensor.
- (10) A small rectangular component, possibly a switch or sensor.

Torque specifications are indicated by boxes labeled T1, T2, and T3:

- T1: Torque specification for the screw securing the main housing (1).
- T2: Torque specification for the screws securing the handle components (3, 8) and the bracket (2).
- T3: Torque specification for the screw securing the small rectangular component (10).

The diagram illustrates the assembly sequence and the relative positions of the components.



SECURITY AND LOCKS

SL-4

2. REAR GATE LOCK AND TRUNK LID LOCK

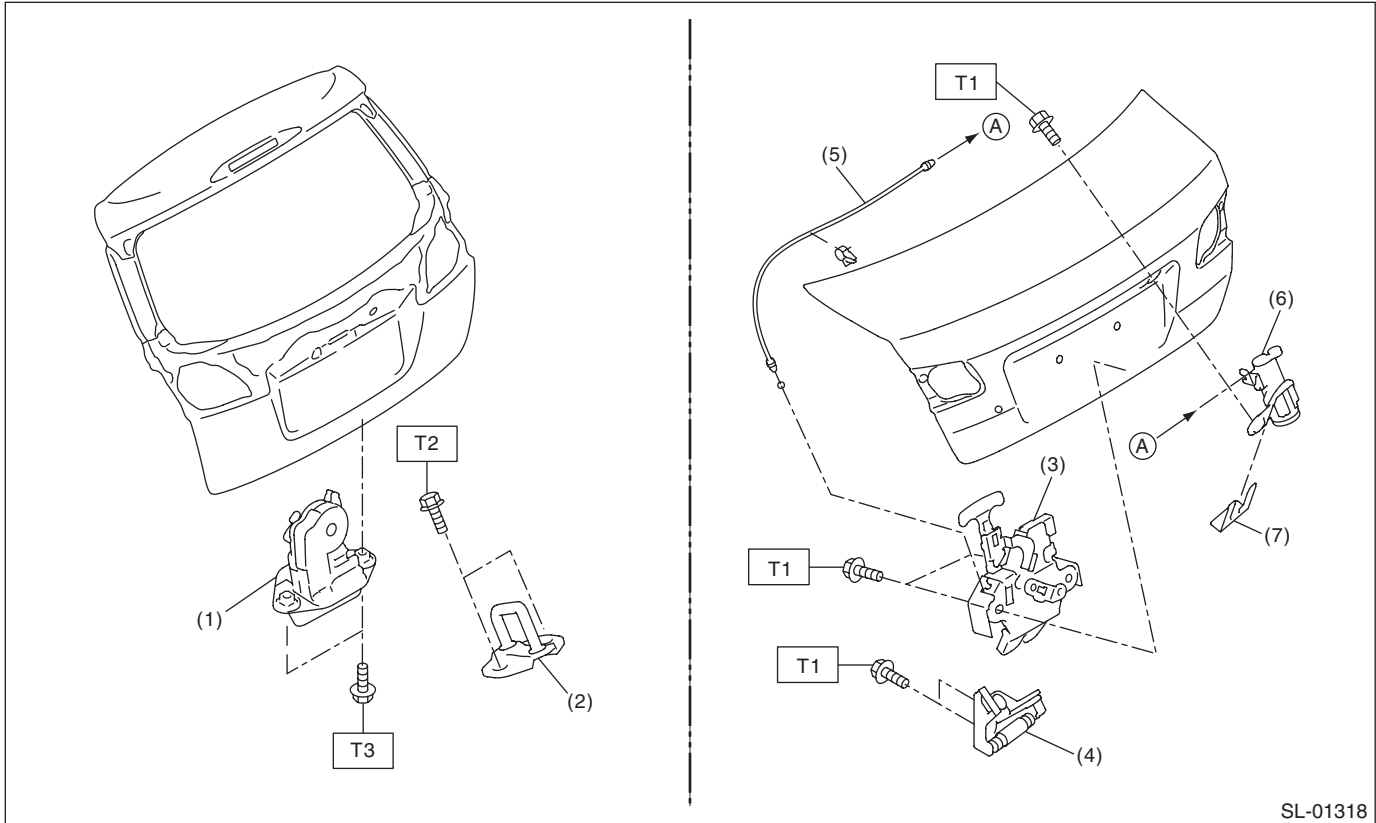

- | | |
|---------------------------------------|-----------------------------------|
| (1) Rear gate latch and actuator ASSY | (5) Cable |
| (2) Rear gate striker | (6) Key cylinder (trunk lid only) |
| (3) Trunk lid latch and actuator ASSY | (7) Clip |
| (4) Trunk lid striker | |

Tightening torque: N·m (kgf-m, ft-lb)

T1: 7.5 (0.76, 5.5)

T2: 25 (2.55, 18.4)

T3: 28 (2.86, 20.7)

General Description

SECURITY AND LOCKS

3. FRONT HOOD LOCK AND REMOTE OPENERS

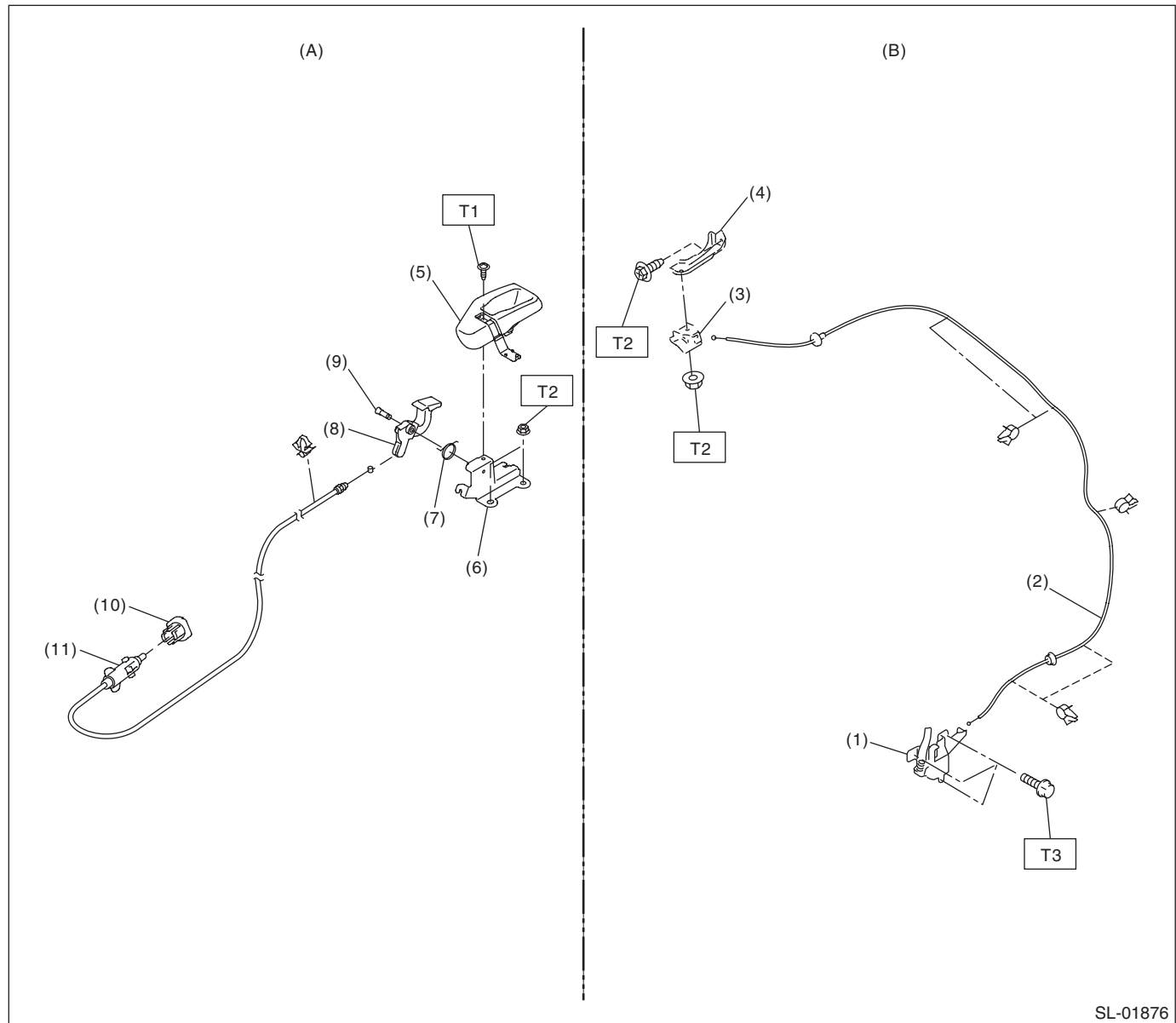

SL-01876

(A) Fuel lock release

(B) Hood lock release

- (1) Front hood lock ASSY
- (2) Cable
- (3) Lever ASSY
- (4) Bracket
- (5) Cover
- (6) Bracket

- (7) Spring
- (8) Pull handle ASSY
- (9) Pin
- (10) Holder
- (11) Fuel lock

Tightening torque: N-m (kgf-m, ft-lb)

T1: 4.5 (0.46, 3.3)

T2: 7.5 (0.76, 5.5)

T3: 33 (3.36, 24.3)

4. KEYLESS ENTRY SYSTEM

NOTE:

Except for model with keyless access.

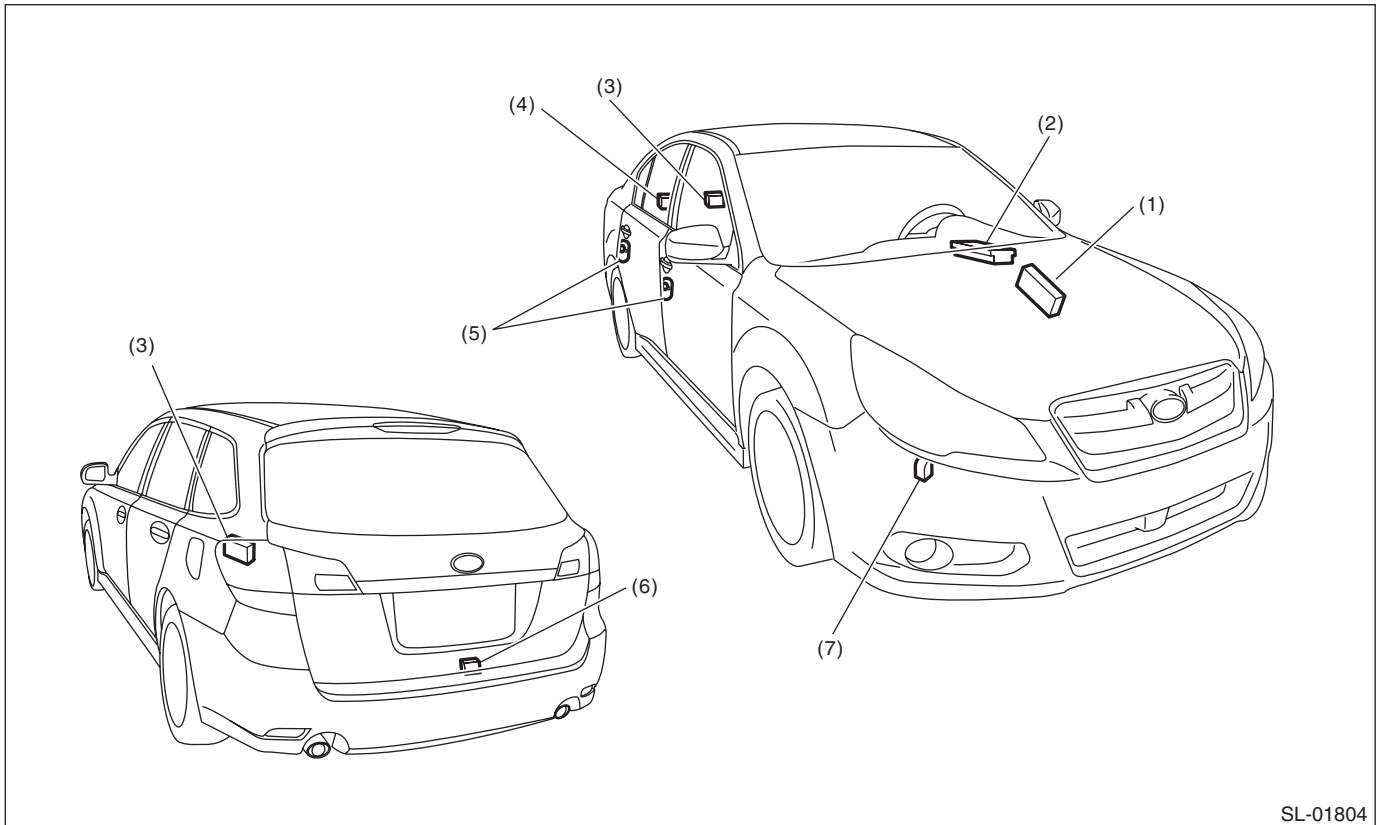

SL-01804

- | | | |
|----------------------------------|--|--|
| (1) Body integrated unit | (4) Trunk lid latch switch (Sedan model) | (6) Rear gate latch switch (OUTBACK model) |
| (2) Power window main switch | (5) Door switch | (7) Keyless buzzer |
| (3) Keyless entry control module | | |

General Description

SECURITY AND LOCKS

5. KEYLESS ACCESS WITH PUSH BUTTON START SYSTEM

NOTE:

Except for model without keyless access.

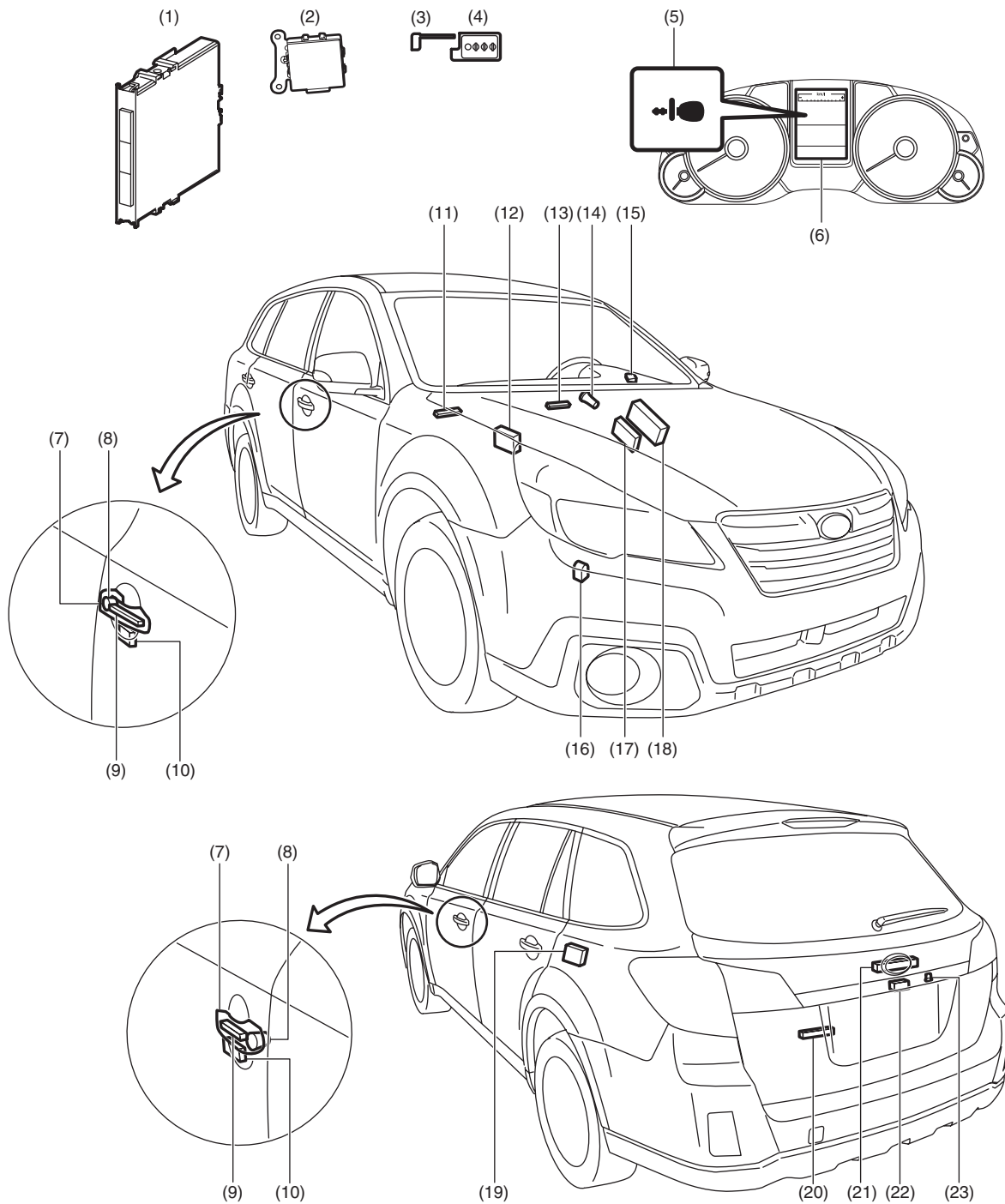

SL-01740

- | | | |
|--|----------------------------------|------------------------------|
| (1) Keyless access CM | (10) Oscillator | (19) Receiver |
| (2) ID code box (only for Canada models) | (11) Center interior antenna | (20) Rear interior antenna |
| (3) Mechanical key | (12) ECM | (21) Rear exterior antenna |
| (4) Access key | (13) Front interior antenna | (22) Rear gate opener button |
| (5) Access key warning light | (14) Push button ignition switch | (23) Rear lock button |
| (6) Multi information display | (15) Steering lock CM | |
| (7) Touch sensor | (16) Access buzzer | |
| (8) Front lock button | (17) TCM | |
| (9) Front exterior antenna | (18) Body integrated unit | |

6. SECURITY SYSTEM

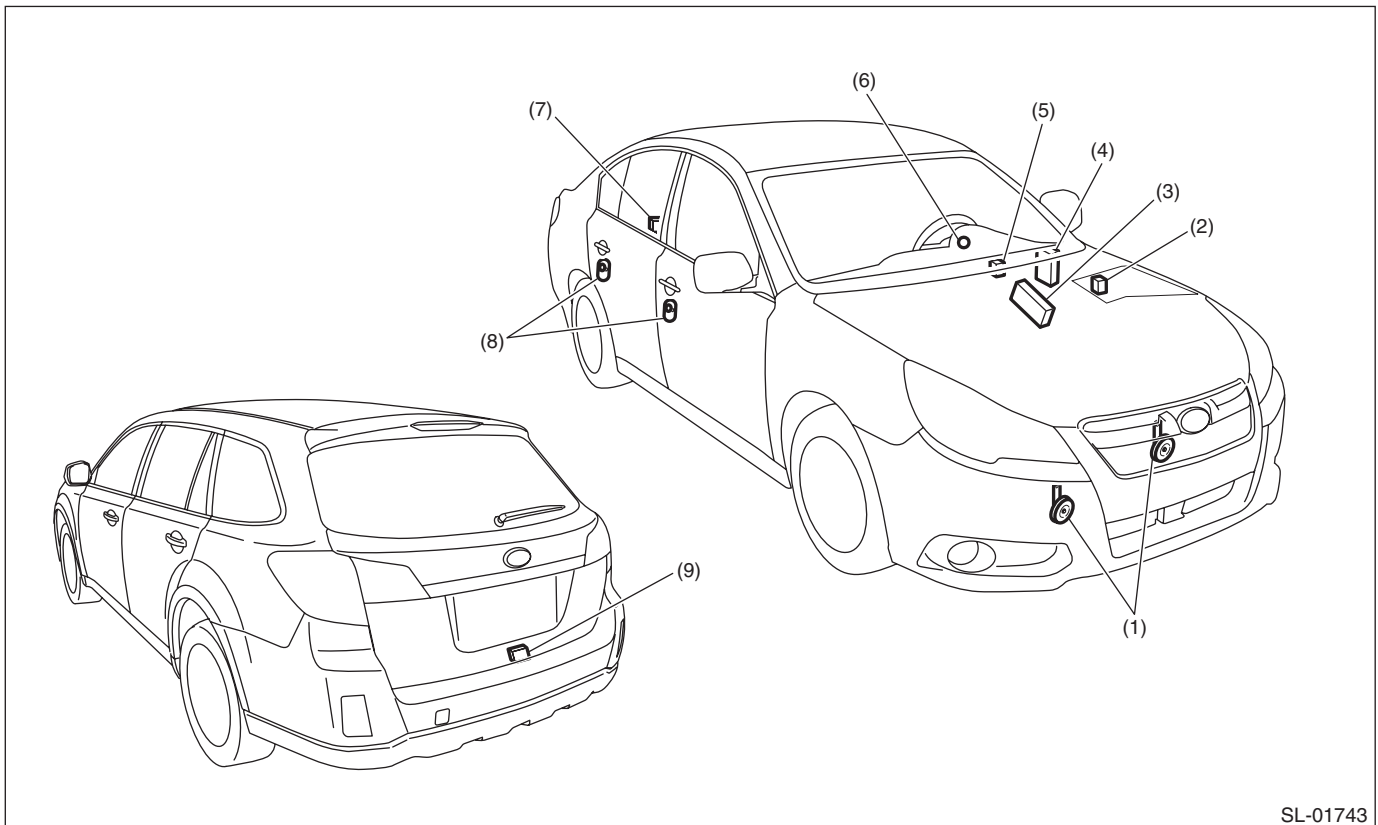

SL-01743

- | | | |
|-----------------------------------|---|--|
| (1) Horn | (4) Impact sensor (driver's seat instrument panel side) (dealer option) | (7) Trunk lid latch switch (Sedan model) |
| (2) Horn relay (in main fuse box) | (5) Turn signal and hazard module | (8) Door switch |
| (3) Body integrated unit | (6) Security indicator light (in combination meter) | (9) Rear gate latch switch (OUTBACK model) |

General Description

SECURITY AND LOCKS

B: CAUTION

- Before disassembling or reassembling parts, always disconnect the battery ground cable from battery. When replacing the audio, control module and other parts provided with memory functions, record the memory contents before disconnecting the battery ground cable. Otherwise, the memory is cleared.
- Reassemble the parts in the reverse order of disassembly procedure unless otherwise indicated.
- Connect the connectors securely during reassembly.
- After reassembly, make sure that the functional parts operate normally.
- If any immobilizer related part has been replaced, make sure to register the immobilizer.
- Do not use any electrical test equipment on the airbag system wiring harnesses and connector circuits.
- Be careful not to damage the airbag system wiring harness when servicing the ignition key cylinder and steering lock CM.

C: PREPARATION TOOL

1. SPECIAL TOOL

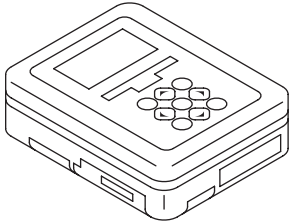
ILLUSTRATION	TOOL NUMBER	DESCRIPTION	REMARKS
 ST1B022XU0	1B022XU0	SUBARU SELECT MONITOR III KIT	Used for troubleshooting the electrical system.

2. GENERAL TOOL

TOOL NAME	REMARKS
Circuit tester	Used for measuring resistance and voltage.
Drill	Used for replacing the ignition key lock and steering lock CM.
TORX® T30	Used for removing and installing door outer handle.
Clip remover	Used for removing trim clip.