

12.Rear Outer Handle

A: REMOVAL

- 1) Raise the rear door glass to the top position.
- 2) Remove the rear door trim. <Ref. to EI-58, REAR DOOR, REMOVAL, Door Trim.>
- 3) Remove the sealing cover.

CAUTION:

- Carefully remove the butyl tape. Excessive force will easily break the cover.
- If the sealing cover gets broken, replace it with a new part.

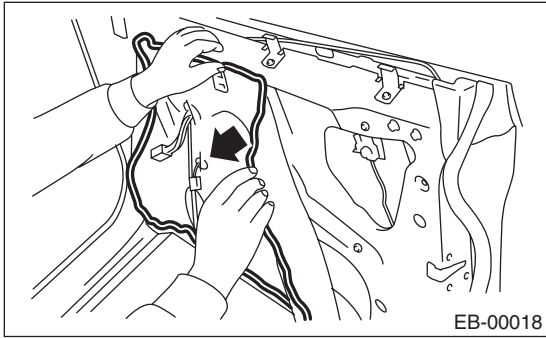

- 4) Move downward the rear door latch & door lock actuator assembly.
 - (1) Disconnect the connector.
 - (2) Remove the screws and move downward the rear door latch & door lock actuator assembly.

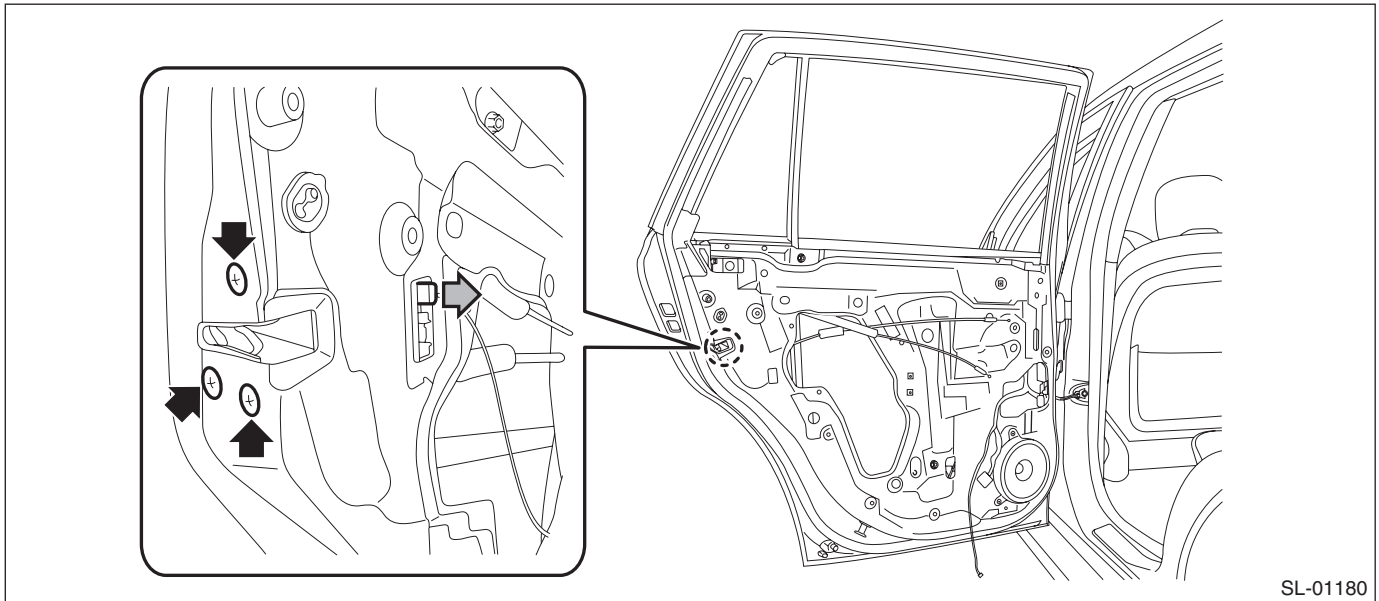

5) Remove the door outer handle cover.

Preparation tool:

TORX® T30

- (1) Remove the child protector cover.
- (2) Loosen the TORX® bolt and remove the door outer handle cover.

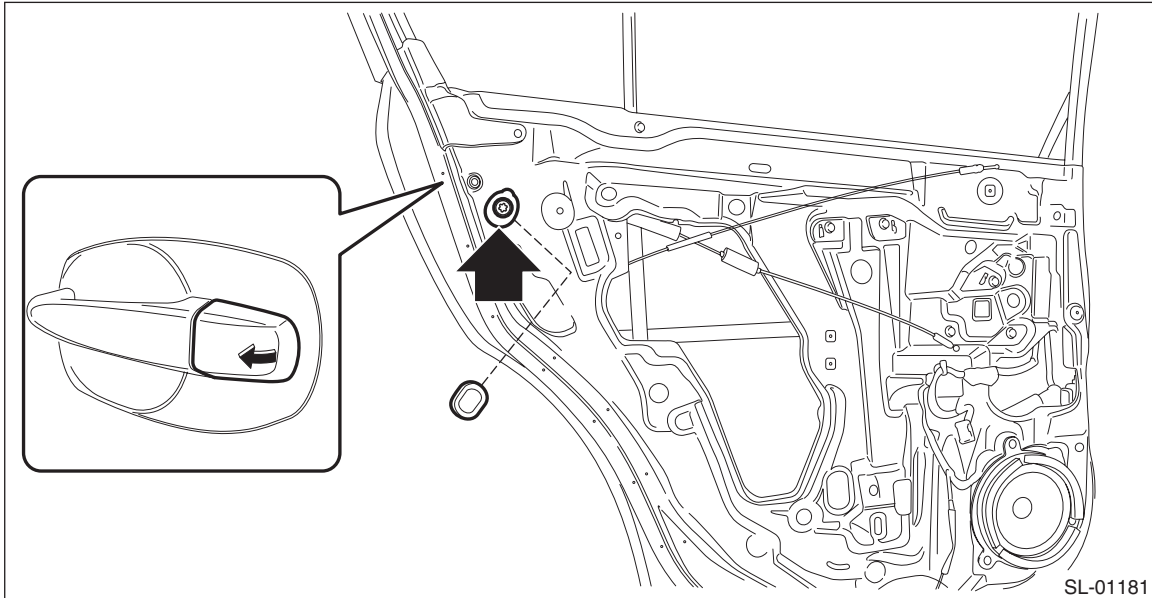

6) Remove the rear outer handle by moving it rearward.

CAUTION:

Do not apply excessive force to remove the handle from the door panel. The door panel may become deformed.

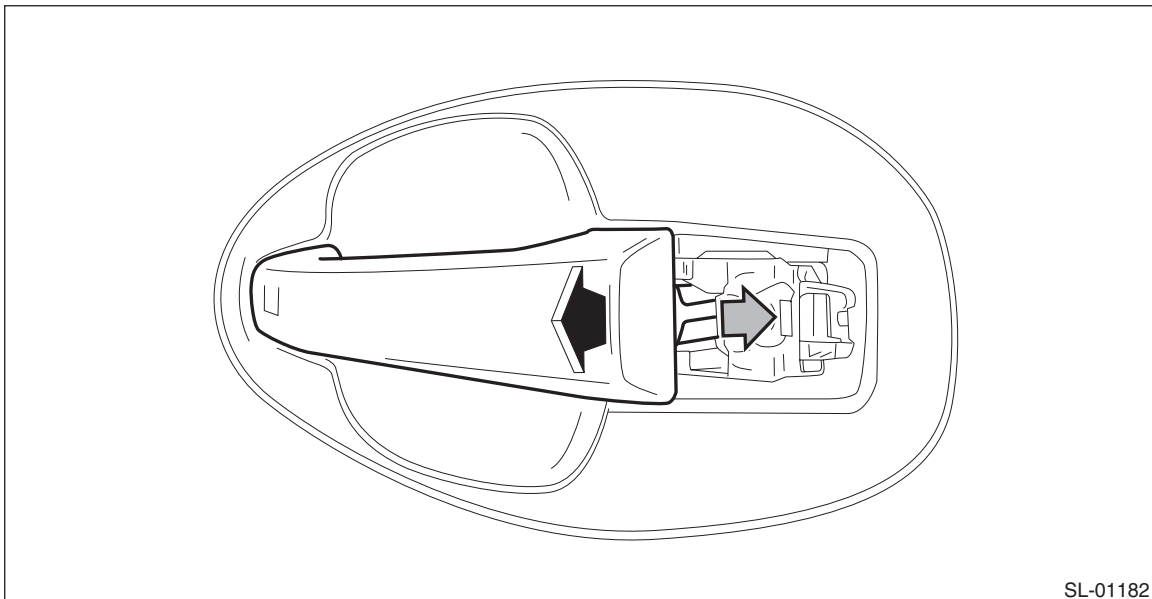

7) Remove the frame assembly.

Preparation tool:

TORX® T30

Rear Outer Handle

SECURITY AND LOCKS

- (1) Remove the outer side spacer.

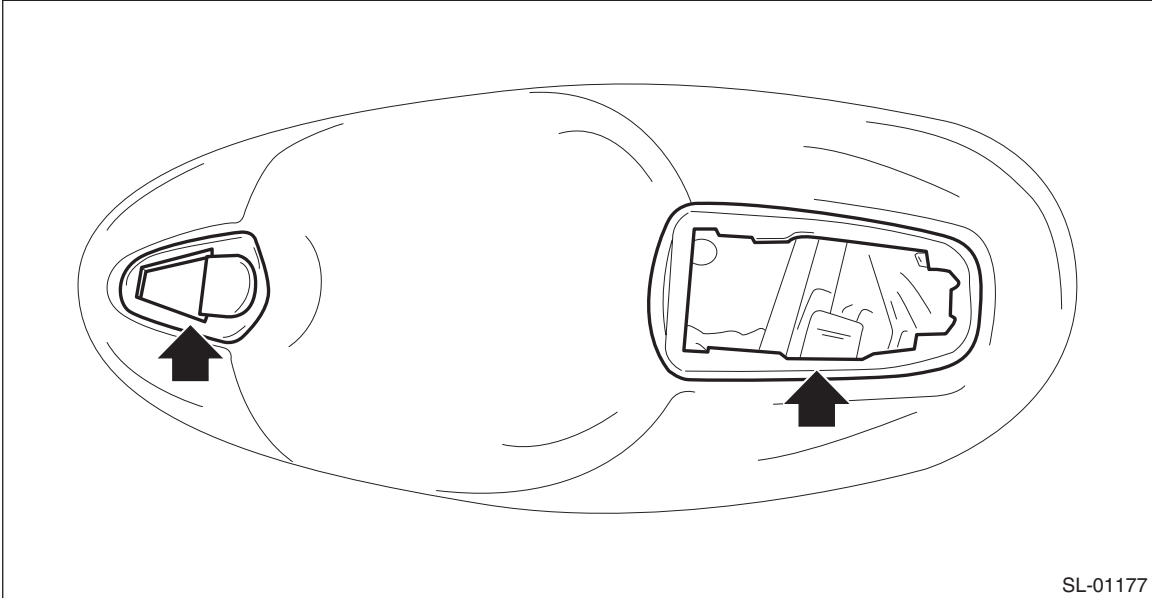

- (2) Remove the TORX® bolt and remove the frame assembly from the door panel.

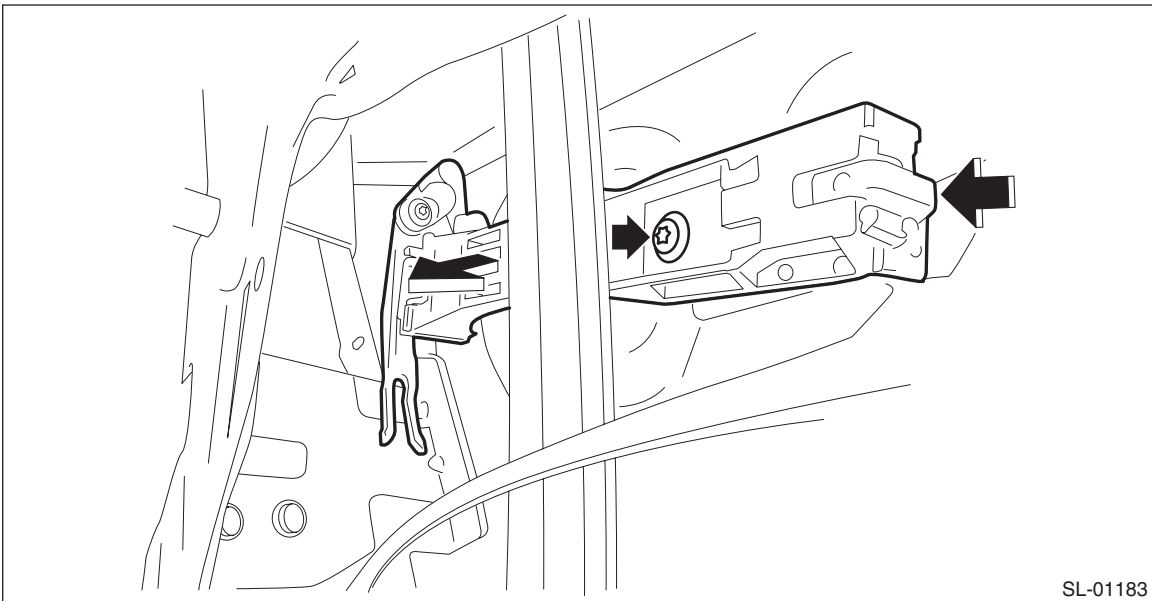

B: INSTALLATION

- 1) Before installation, check the following items.

- Lever is free from deformation.
- Grease is applied sufficiently to lever joints.

If grease is insufficient, add it as necessary before assembling.

- 2) Install each part in the reverse order of removal.

Tightening torque:

Refer to “COMPONENT” of “General Description”. <Ref. to SL-3, DOOR LOCK ASSEMBLY, COMPONENT, General Description.>

C: INSPECTION

Check if the rear outer handle operates normally.

If the lever is faulty, replace the rear outer handle.