

32.Keyless Access Indoor Antenna

A: REMOVAL

1. FRONT ANTENNA

- 1) Disconnect the ground cable from battery.
- 2) Remove the center panel assembly.

CAUTION:

Do not put your finger on the fin of the air vent grille. Doing so may damage the fin.

- (1) Attach the protective tape (a) to the meter visor.

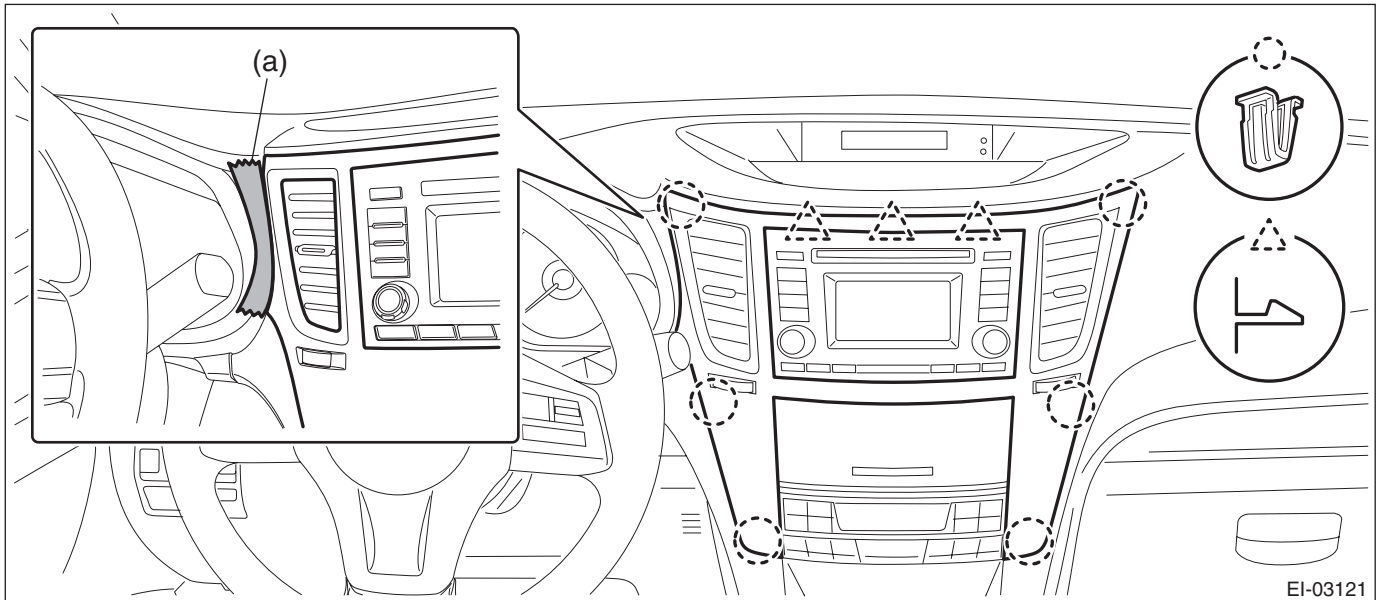

- (2) Insert a finger into the air vent grille and release the left and right clips at the top of the center panel.
(A), (B)
- (3) Insert a finger into the air vent grille and release the left and right clips at the center of the center panel.
(C), (D)

Keyless Access Indoor Antenna

SECURITY AND LOCKS

- (4) Release the clips at the bottom of the center panel and remove the center panel assembly.

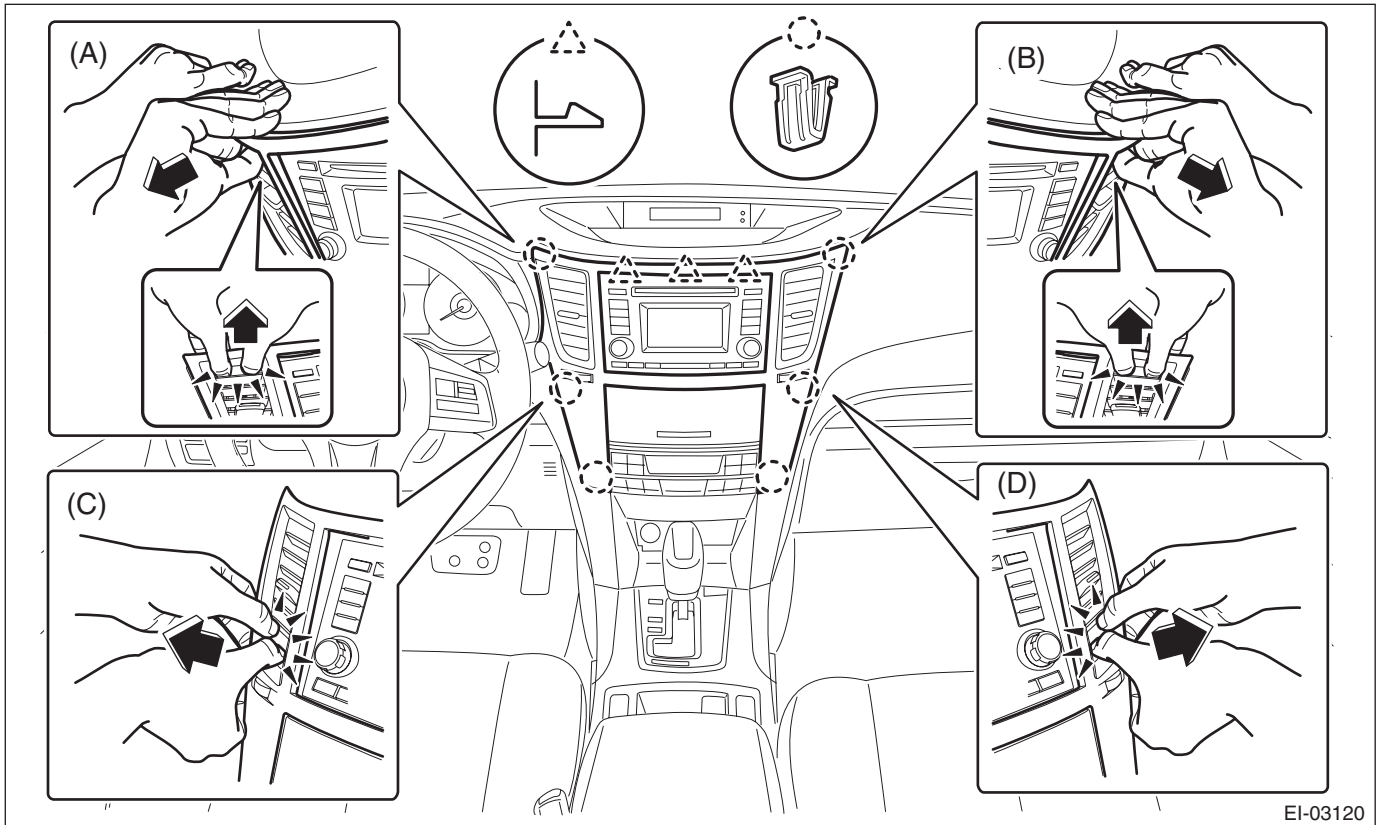

- 3) Remove the audio assembly.

- (1) Remove the left and right screws, and partially pull the audio out from center console.
- (2) Disconnect the connectors, and remove the audio assembly.

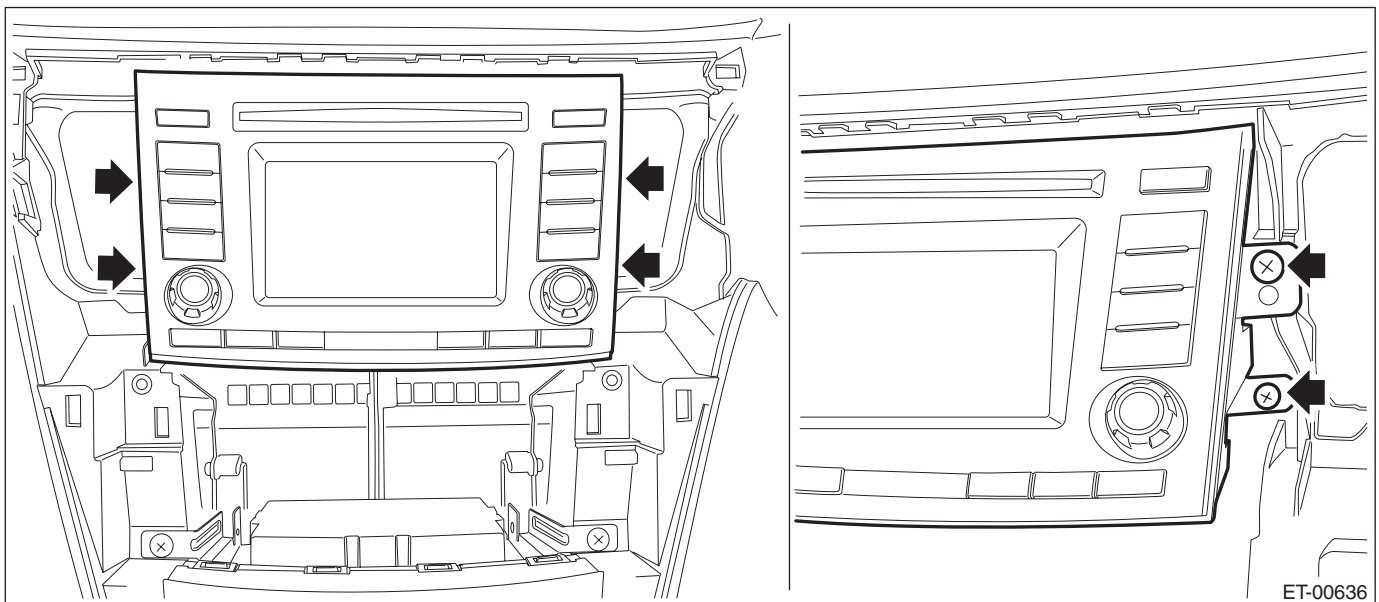

- 4) Remove the navigation assembly. (model with navigation)
- (1) Remove the left and right screws.
 - (2) Disconnect the connectors, and remove the navigation assembly.

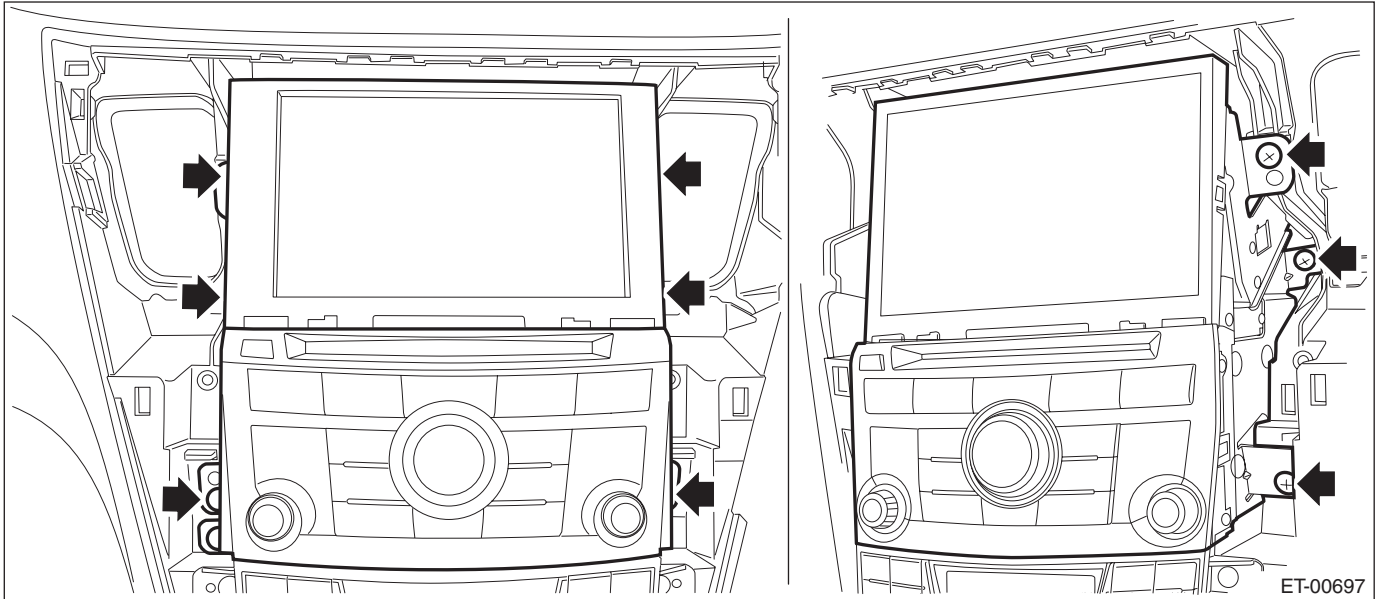

- 5) Remove the control panel.
- (1) Remove the screws.

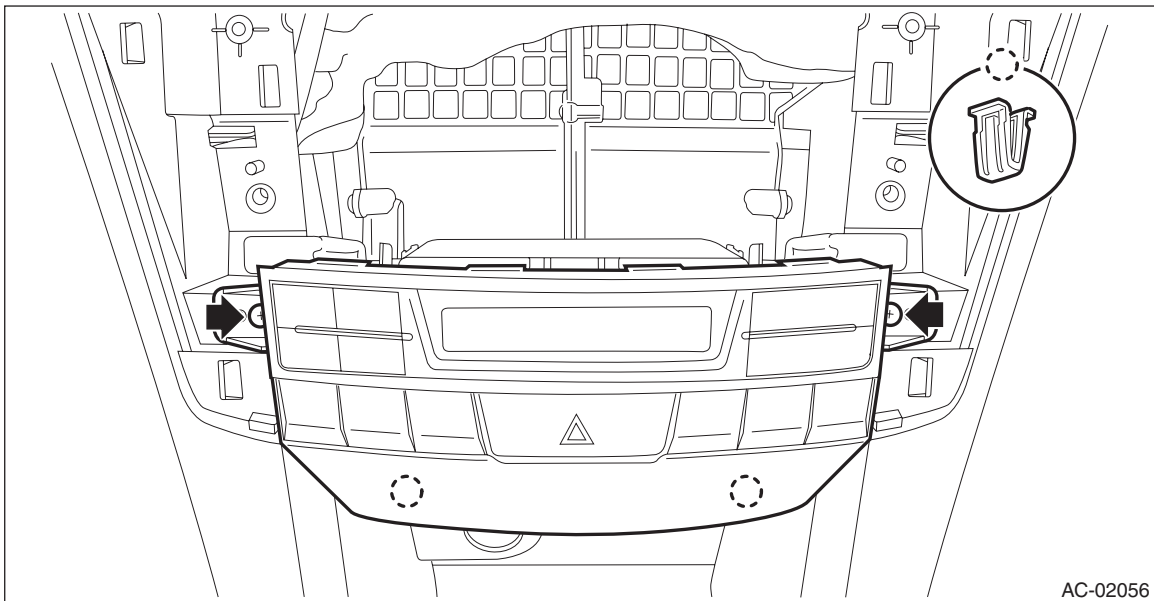

Keyless Access Indoor Antenna

SECURITY AND LOCKS

- (2) Pull forward the control module and disconnect the connector.

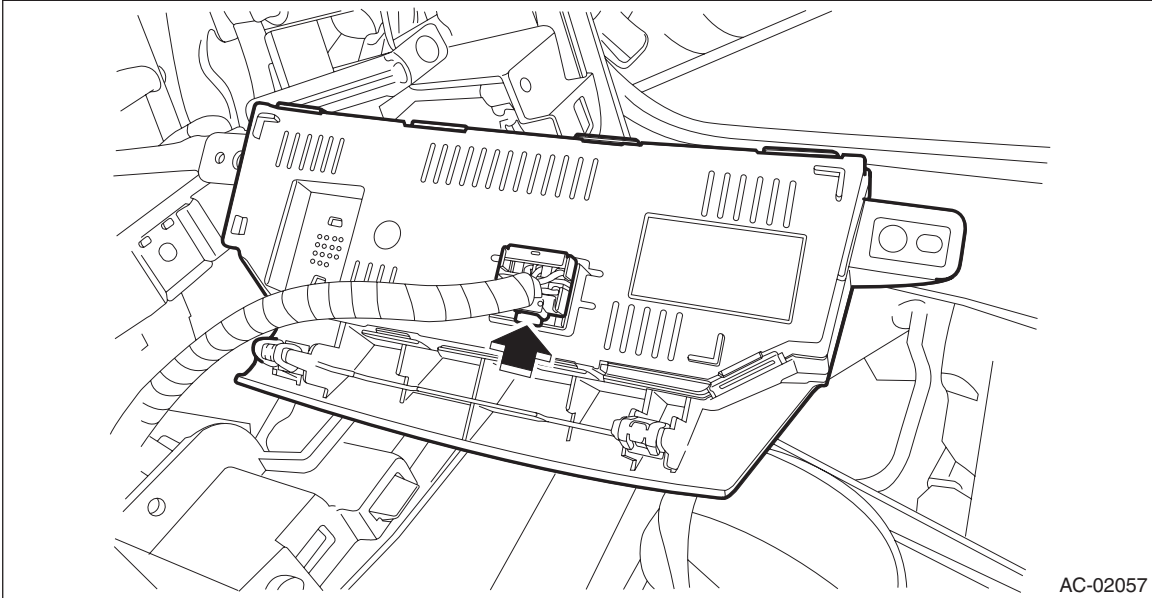

- 6) Disconnect the connector and remove the front interior antenna.

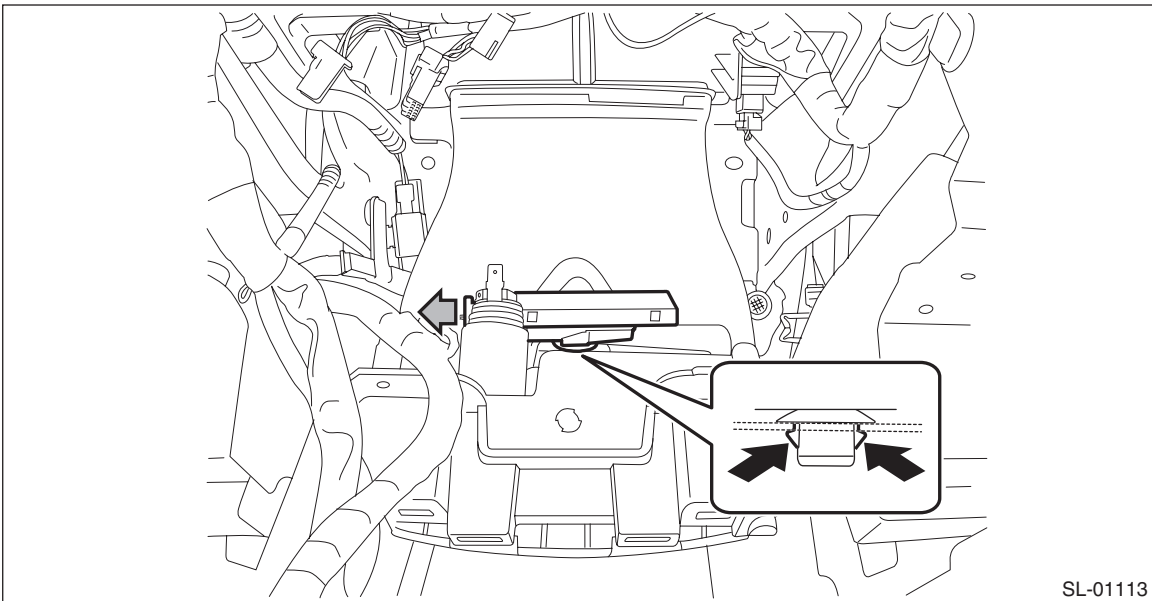

2. CENTER ANTENNA

- 1) Disconnect the ground cable from battery.
- 2) Remove the rear seat cushion. <Ref. to SE-38, OUTBACK MODEL, REMOVAL, Rear Seat.>
- 3) Remove the center antenna.
 - (1) Disconnect the center antenna connector.
 - (2) Remove the two bolts and remove the center antenna case.
 - (3) Release the claws, and then remove the center antenna from the center antenna case.

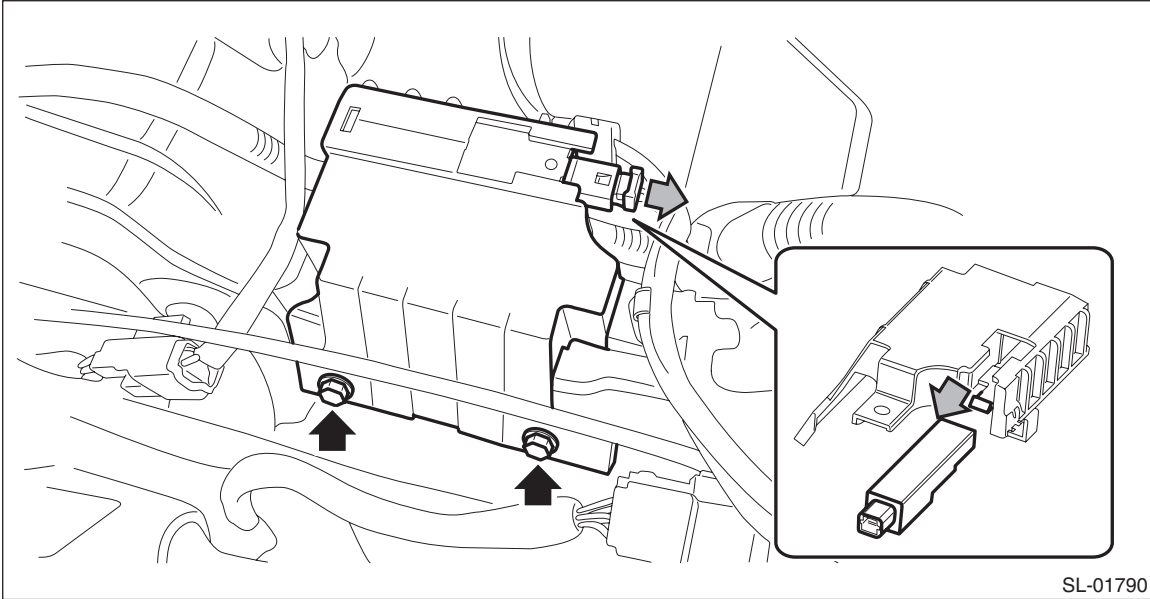

SL-01790

3. REAR ANTENNA

• OUTBACK model

- 1) Disconnect the ground cable from battery.
- 2) Remove the luggage floor box.

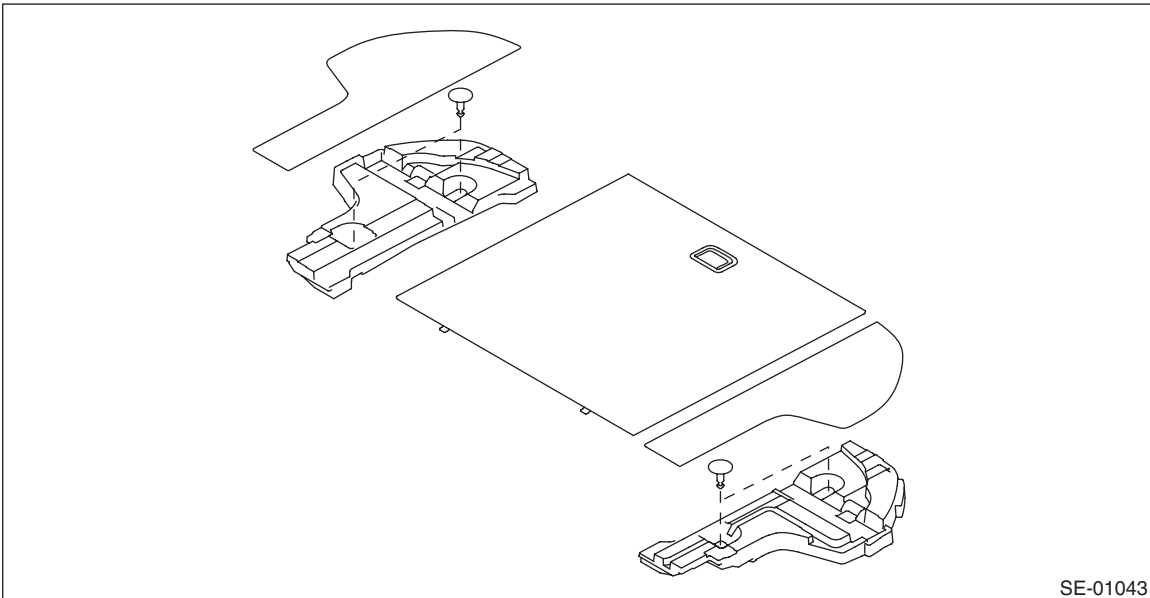

SE-01043

Keyless Access Indoor Antenna

SECURITY AND LOCKS

3) Tilt the backrest and turn over the seat backrest cover.

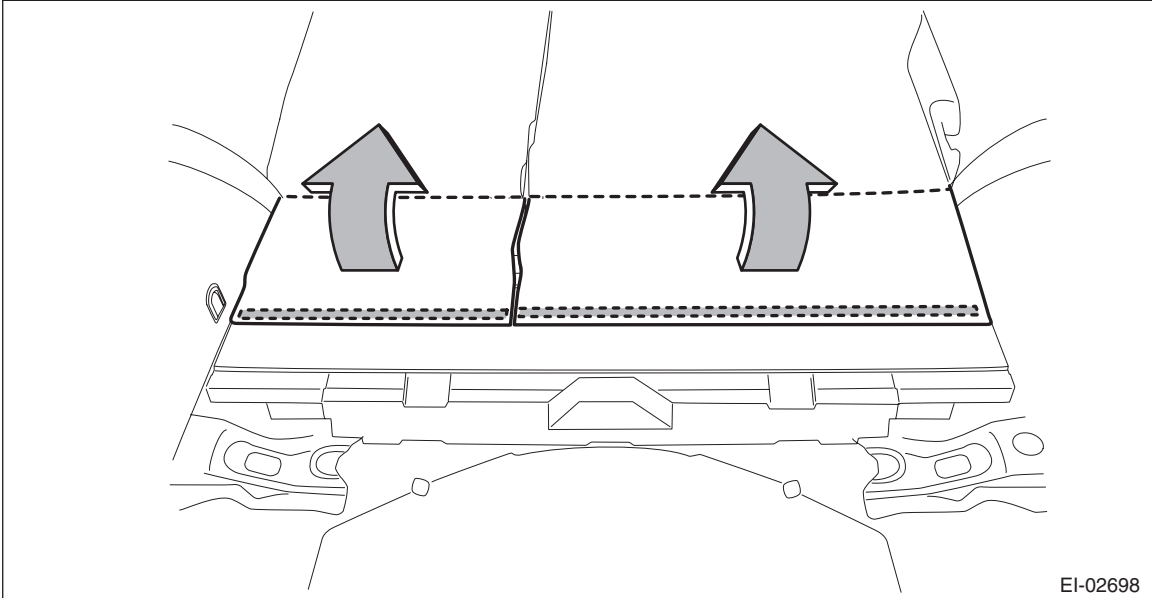

4) Remove the rear floor spacer CTR - front.

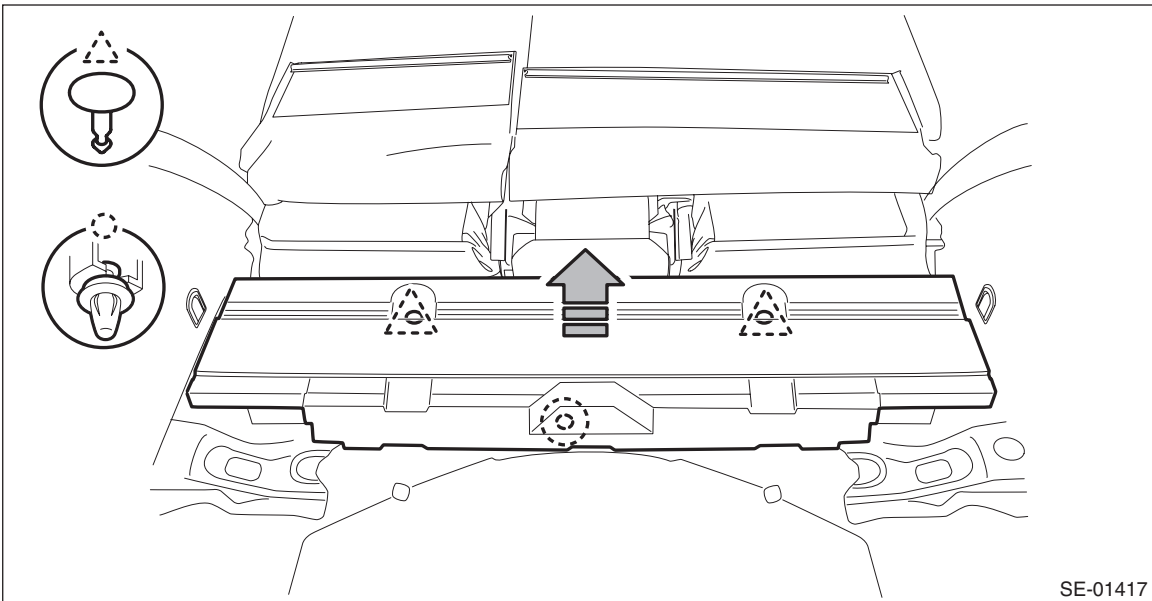

5) Disconnect the connector and remove the rear interior antenna.

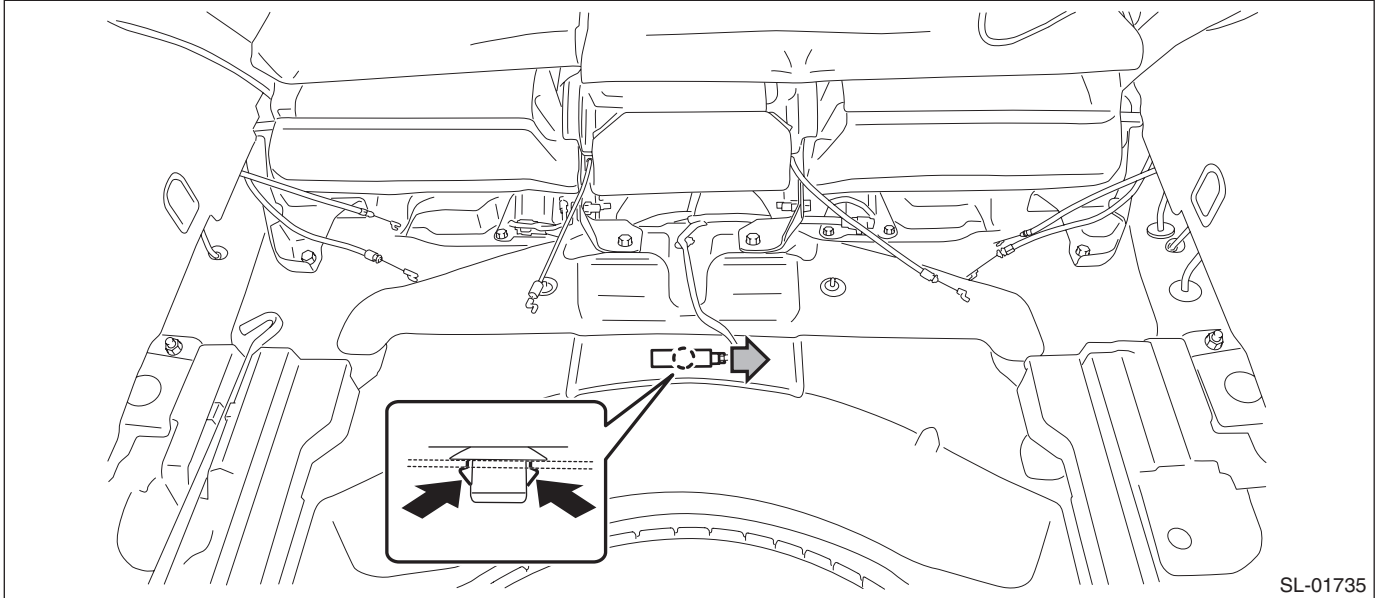

B: INSTALLATION

Install each part in the reverse order of removal.

Tightening torque:

Antenna bracket: 7.5 N·m (0.76 kgf-m, 5.5 ft-lb)

C: INSPECTION

- 1) Check the setting by performing Keyless access system check using the Subaru Select Monitor. <Ref. to KPS(diag)-30, OPERATION, Keyless Access System Check.>
- 2) Disconnect the Subaru Select Monitor. After placing the access key in the compartment, operate the push button ignition switch to check that the power can be switched.
- 3) If the system does not operate normally as the result of inspection, refer to “General Diagnostic Table” of the “KEYLESS ACCESS WITH PUSH BUTTON START SYSTEM (DIAGNOSTICS)” section. <Ref. to KPS(diag)-90, KEYLESS ACCESS SYSTEM, INSPECTION, General Diagnostic Table.>