

5. Washer Tank and Motor

A: REMOVAL

- 1) Open the front hood.
- 2) Disconnect the ground cable from battery.
- 3) Remove the front bumper face assembly.
 - (1) Remove the clips and turn over the front end of front mud guard. (Model with fog light)

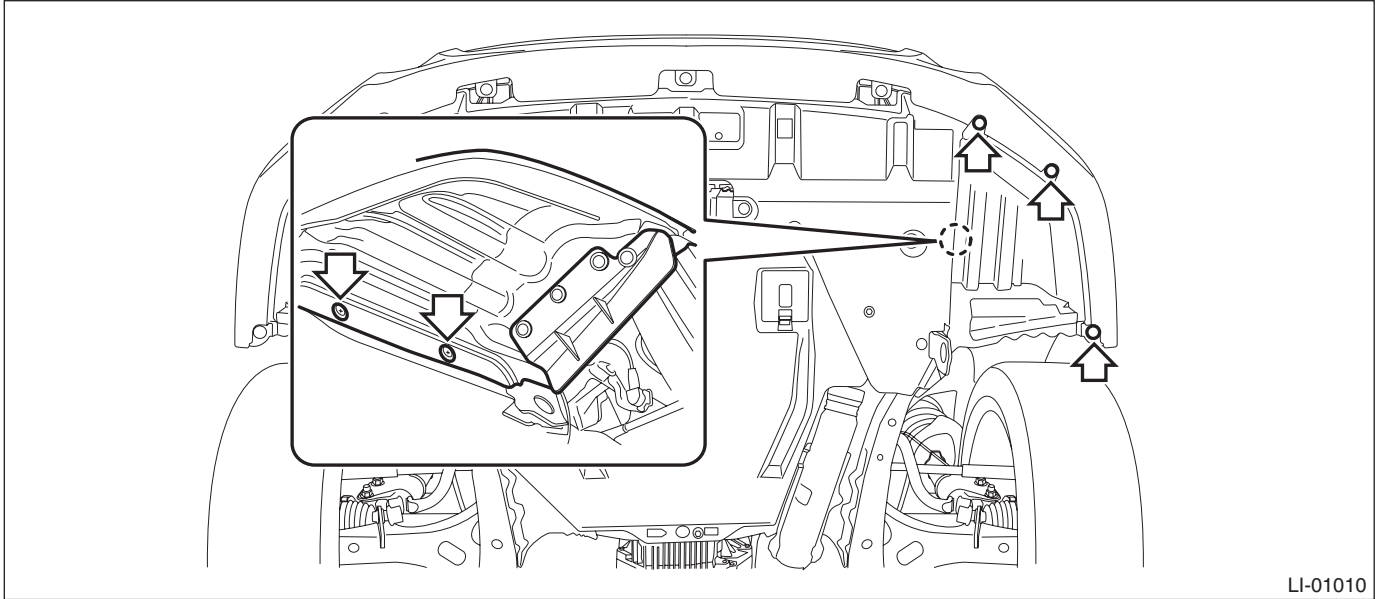

- (2) Disconnect the front fog light connector. (Model with fog light)

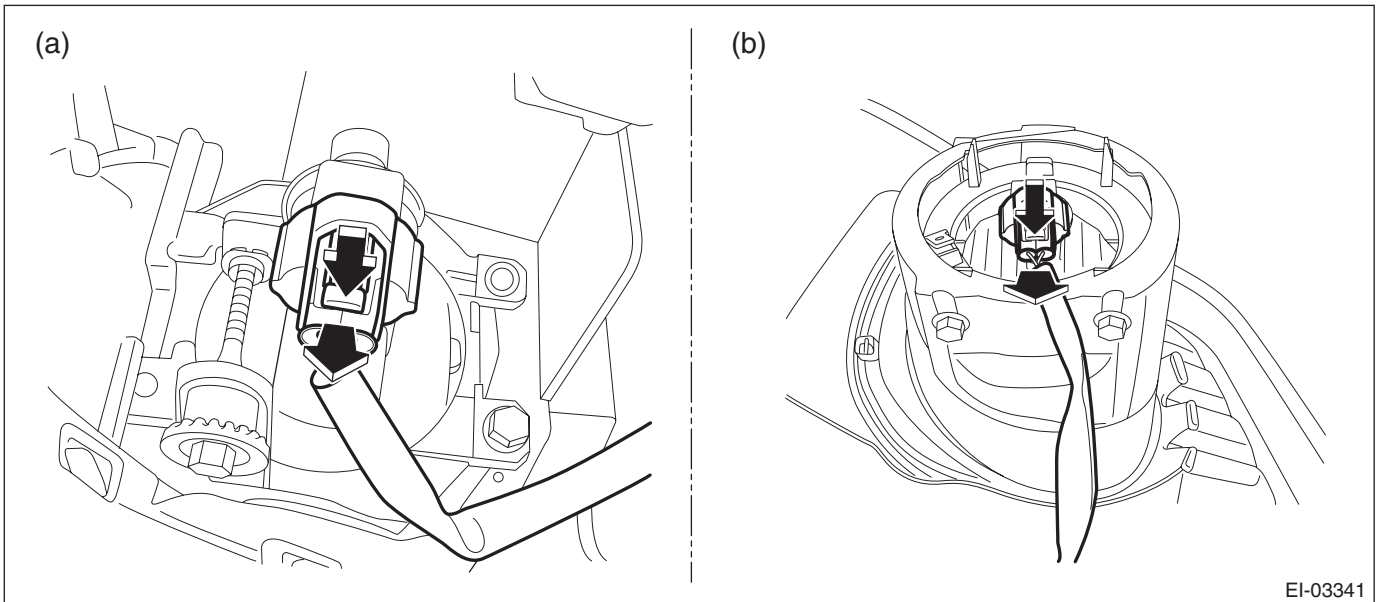

- (a) Except for OUTBACK model (b) OUTBACK model

- (3) Remove the clips at the upper side of the bumper.
- (4) Remove the clips from the fender.

Washer Tank and Motor

WIPER AND WASHER SYSTEMS

(5) Remove the clips at the lower side of bumper.

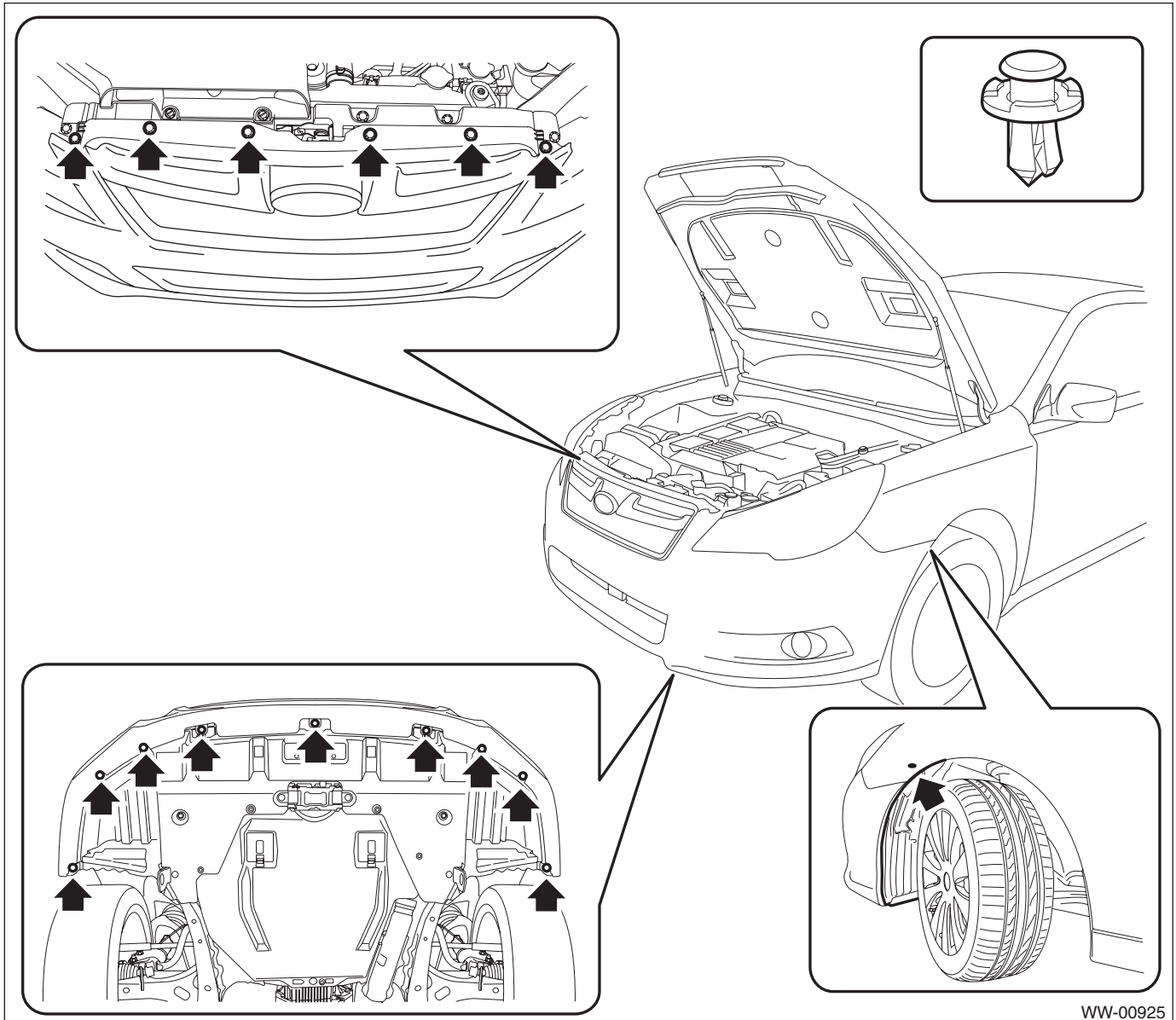

WW-00925

- (6) Detach the flange section on the bumper face side from the bracket side front UPR.

CAUTION:

Do not pull forcibly. It may damage the flange sections of the bumper face.

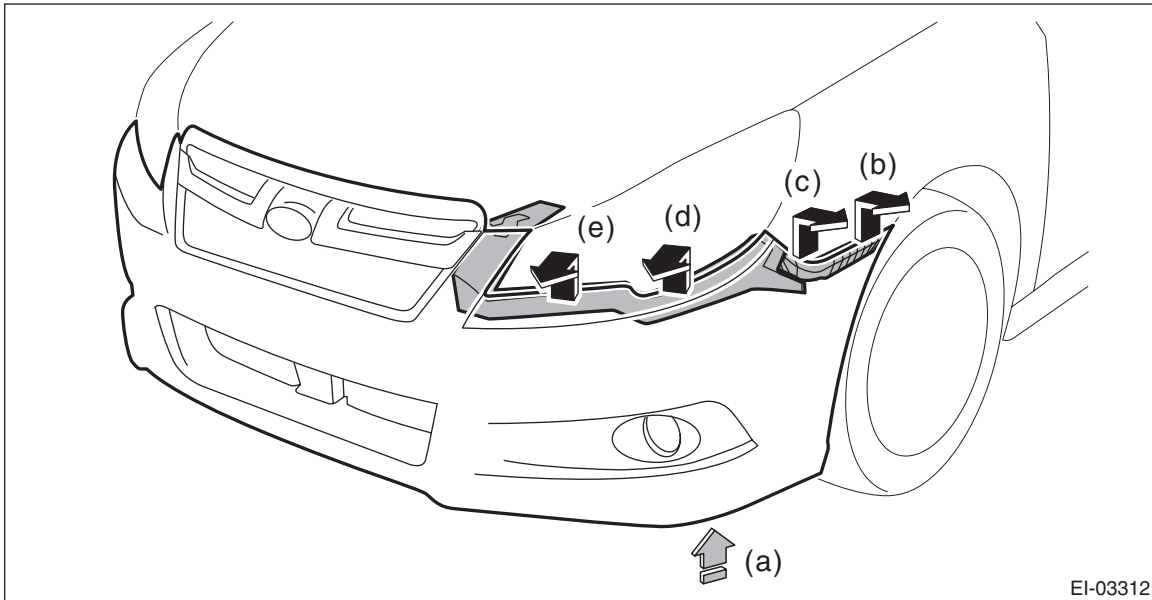

EI-03312

NOTE:

Pushing up the lower side (a) of the fog light, remove from (b) to (e).

Detach the opposite side in the same manner.

- 4) Remove the washer tank assembly.

- (1) Remove the clip of the washer tank duct.

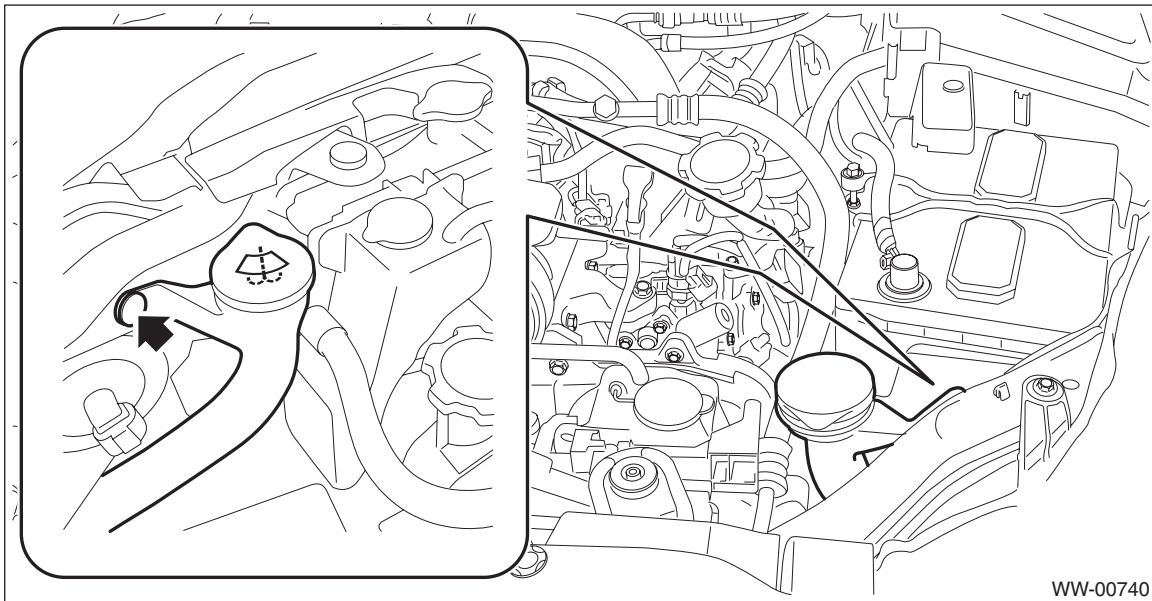

WW-00740

- (2) Prepare a container before disconnecting the washer hose and drain all washer fluid in the tank.

- (3) Disconnect the connector from the washer motor and washer tank level sensor, and then remove the harness clip.

Washer Tank and Motor

WIPER AND WASHER SYSTEMS

- (4) Remove the bolt and nuts and remove the washer tank assembly.

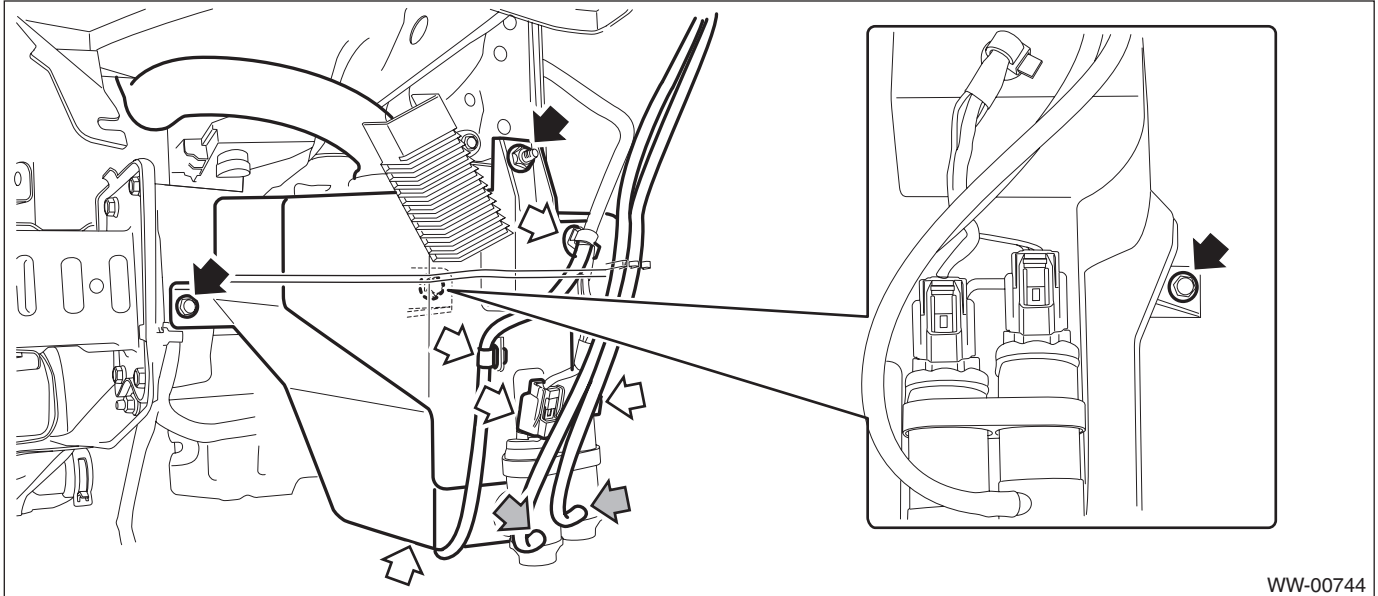

- 5) Remove the washer motor from the tank.

B: INSTALLATION

- 1) Install each part in the reverse order of removal.

CAUTION:

Install the bumper face so that the under cover front end (b) comes inside the front bumper face (a).

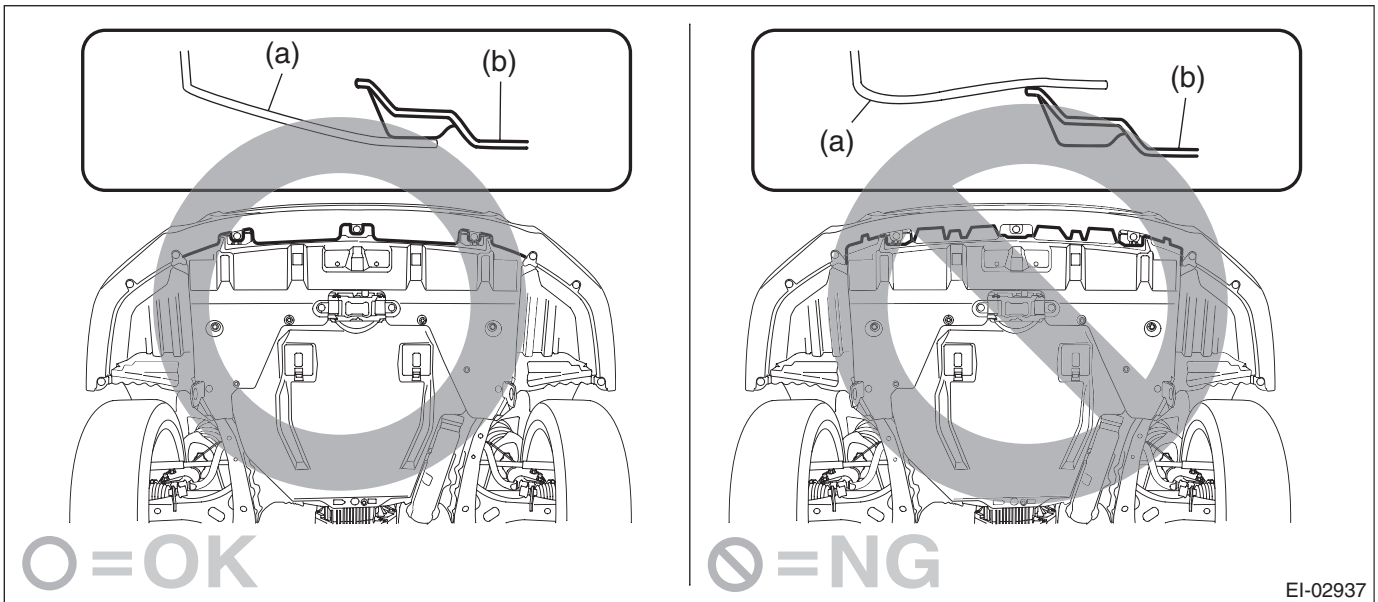

- 2) Add new washer fluid.

Tightening torque:

6 N·m (0.61 kgf·m, 4.4 ft-lb)

- 3) Adjust the fog light beam. (Model with fog light) <Ref. to LI-42, FOG LIGHT AIMING, ADJUSTMENT, Front Fog Light Assembly.>

C: INSPECTION

1. WASHER MOTOR

Apply battery voltage to the connector terminal of the washer motor and make sure that the motor operates.

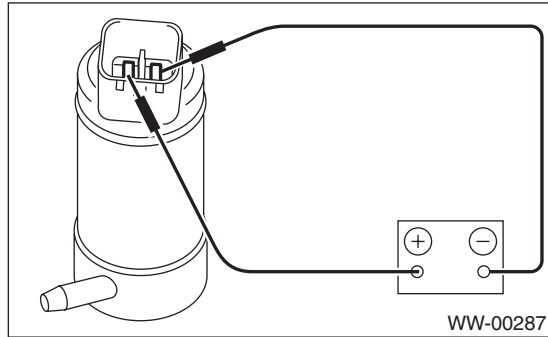

2. WASHER FLUID LEVEL SENSOR

- 1) Check the connection status of washer fluid level sensor connector.
- 2) Does the low washer fluid warning light illuminate after draining the washer fluid? And does the low washer fluid warning light go off after refilling the washer fluid?
 - **Yes** → Normal
 - **No** → Go to step 3.
- 3) Using a tester, measure the voltage of the washer fluid level sensor connector.
 - (1) Is the voltage approx. 8.5 V or more?
 - **Yes** → Go to step 4.
 - **No** → Check harness, meter and body integrated unit, and replace if necessary.
- 4) Does the meter indicator illuminate if you short the washer fluid level sensor connector?
 - **Yes** → Go to step 5.
 - **No** → Check meter and body integrated unit, and replace if necessary.
- 5) Using a tester, measure the resistance of the washer fluid level sensor.
 - (1) Turn over the mud guard.
 - (2) Measure the resistance of the washer fluid level sensor.

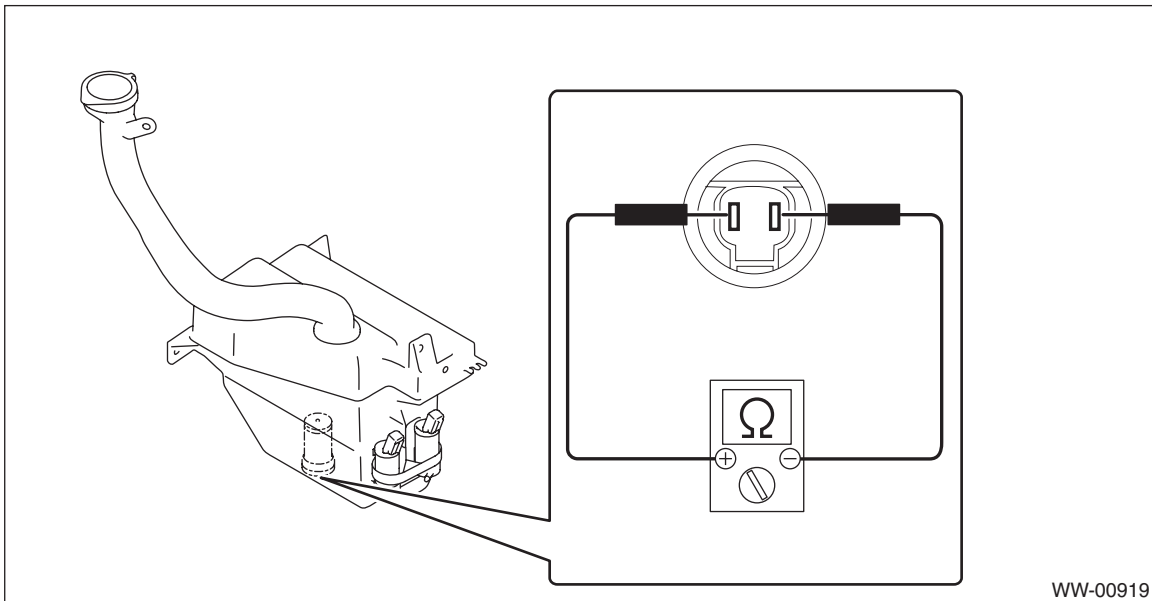

Amount of washer fluid in the tank	Standard
No remaining quantity (ON)	Less than 10 Ω
There is remaining quantity (OFF)	1 M Ω or more

Washer Tank and Motor

WIPER AND WASHER SYSTEMS

(3) Is the resistance within the standard?

- **Yes** → Normal
- **No** → Replace the washer fluid level sensor along with the washer tank.