

## Rear Vent Door Actuator

HVAC SYSTEM (HEATER, VENTILATOR AND A/C)

### 30.Rear Vent Door Actuator

#### A: REMOVAL

- 1) Remove the instrument panel assembly. <Ref. to EI-75, REMOVAL, Instrument Panel Assembly.>
- 2) Remove the foot duct RH.
  - (1) Turn over the floor carpet and remove the rear heater duct slide lock.
  - (2) Remove the screws and remove the foot duct RH.

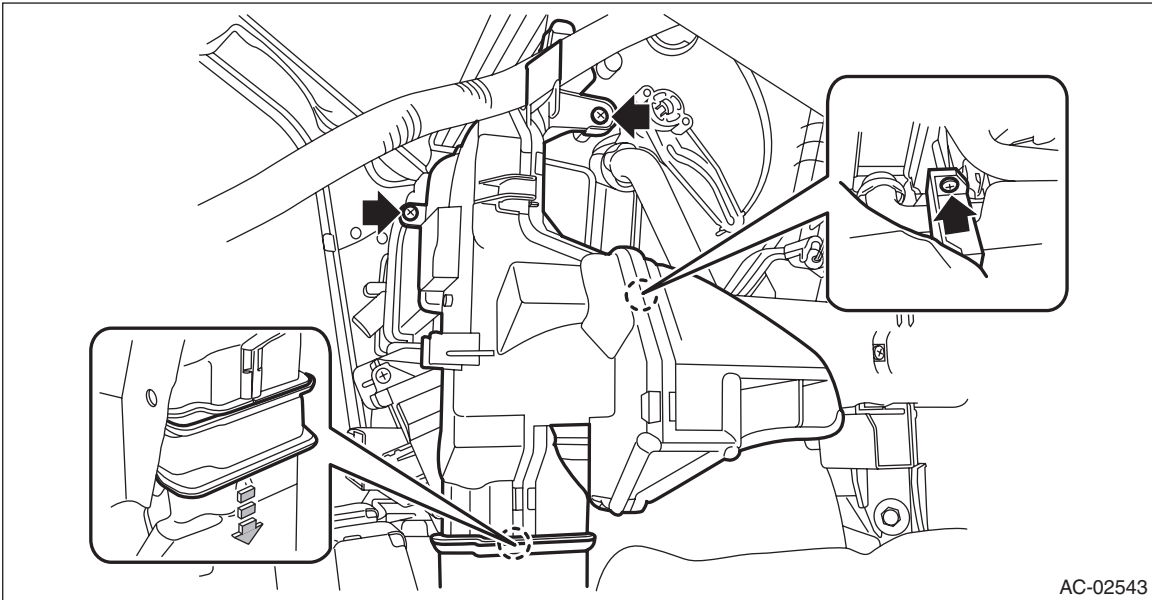

- 3) Remove the screws, and remove the rear vent actuator.

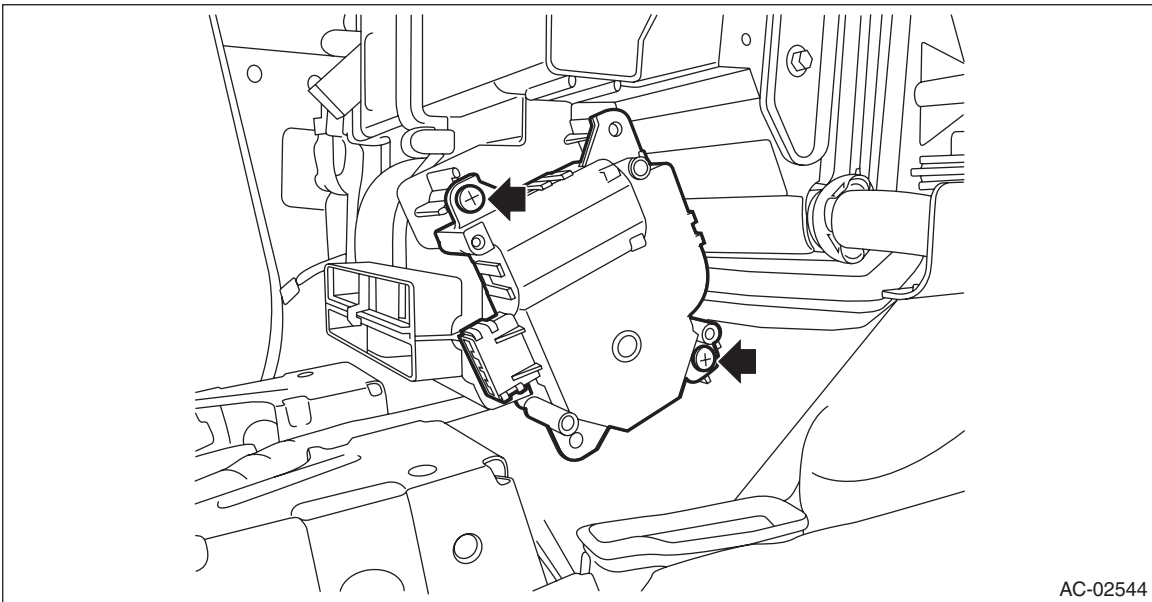

#### B: INSTALLATION

Install each part in the reverse order of removal.

##### NOTE:

Refer to "INSTALLATION" of "Instrument Panel Assembly". <Ref. to EI-96, INSTALLATION, Instrument Panel Assembly.>

# Rear Vent Door Actuator

HVAC SYSTEM (HEATER, VENTILATOR AND A/C)

## C: INSPECTION

### 1. ACTUATOR LINK

- 1) Visually check the operating range of the link, and remove the foreign matter if any.
- 2) Operate the temperature control switch, and check that the link operates normally.
- 3) If it does not operate normally, check the rear vent actuator unit.

### 2. CHECK ACTUATOR OPERATION

#### Preparation tool: Circuit tester

- 1) Check the actuator operation when battery voltage is applied between the terminals of rear vent actuator.

#### CAUTION:

**Disconnect the battery immediately after the actuator stops operation. Otherwise, the motor may be damaged.**

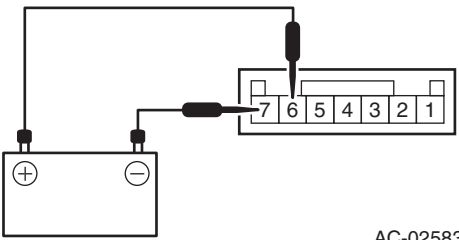
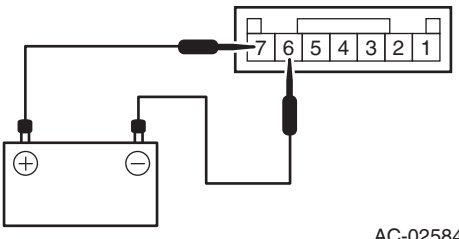
Terminal No.	Inspection conditions	Operating position	Connection diagram
6 (+) — 7 (–)	Connect battery to the terminals	COOL	 <p>AC-02583</p>
7 (+) — 6 (–)		HOT	 <p>AC-02584</p>

- 2) Check the resistance between terminals of rear vent actuator.

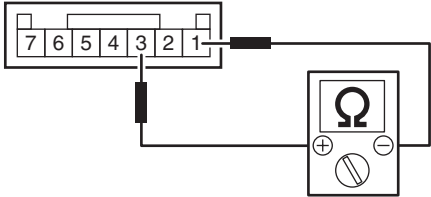
Terminal No.	Inspection conditions	Standard	Connection diagram
1 — 3	Always	4.2 — 7.8 Ω	 <p>AC-02585</p>

- 3) Connect the rear vent actuator connector, turn the ignition switch to ON and check the voltage between terminals of rear vent actuator.

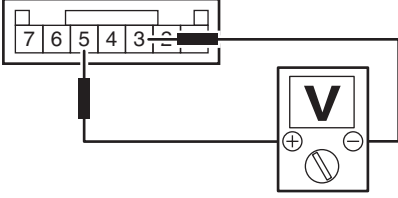
Terminal No.	Inspection conditions	Standard	Connection diagram
5 (+) — 3 (–)	HOT	Approx. 1.0 V	 <p>AC-02587</p>
	COOL	Approx. 4.0 V	

- 4) Replace the rear vent actuator if it is found defective.