

### 32.Heater Duct

#### A: REMOVAL

##### 1. REAR HEATER DUCT

- 1) Remove the front seats. <Ref. to SE-10, REMOVAL, Front Seat.>
- 2) Remove the instrument panel pad and frame assembly. <Ref. to EI-75, REMOVAL, Instrument Panel Assembly.>
- 3) Remove the rear heater duct.
  - (1) Turn over the floor carpet and remove the rear heater duct slide lock.
  - (2) Release the claws, and then remove the rear heater duct LH and RH.

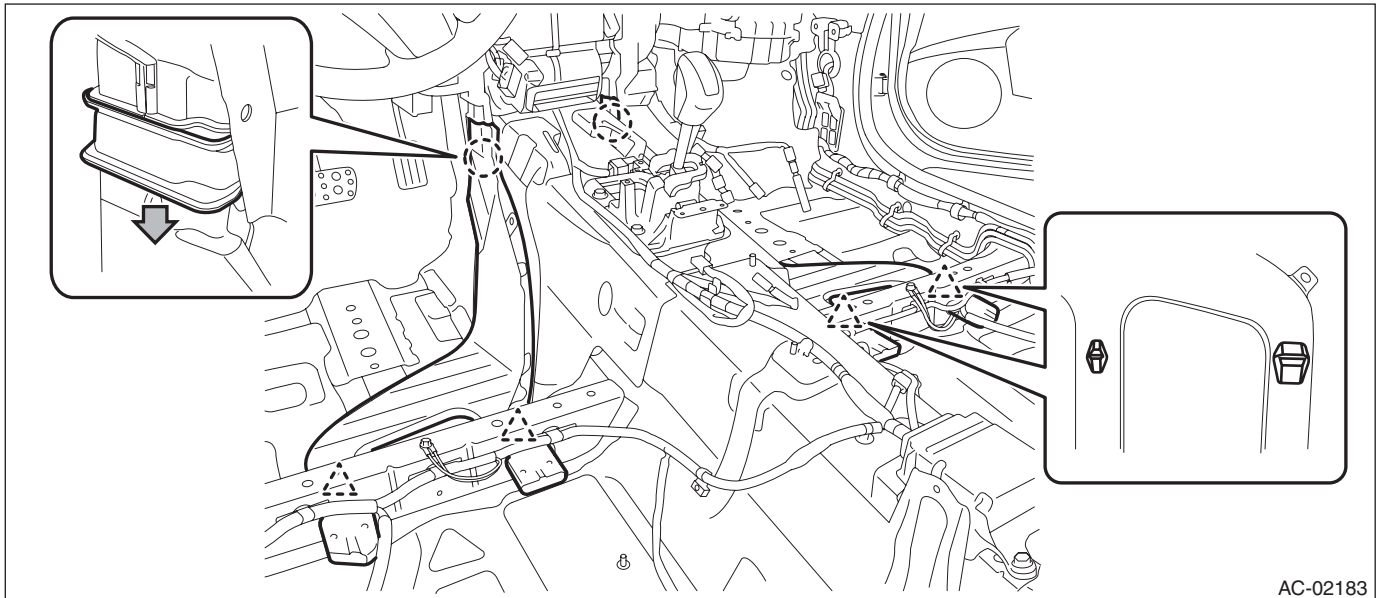

#### NOTE:

For the model with premium audio system, remove the extension duct.

##### 2. CONSOLE FRONT DUCT

- 1) Remove the instrument panel pad and frame assembly. <Ref. to EI-75, REMOVAL, Instrument Panel Assembly.>
- 2) Remove the clip, and remove the console front duct.

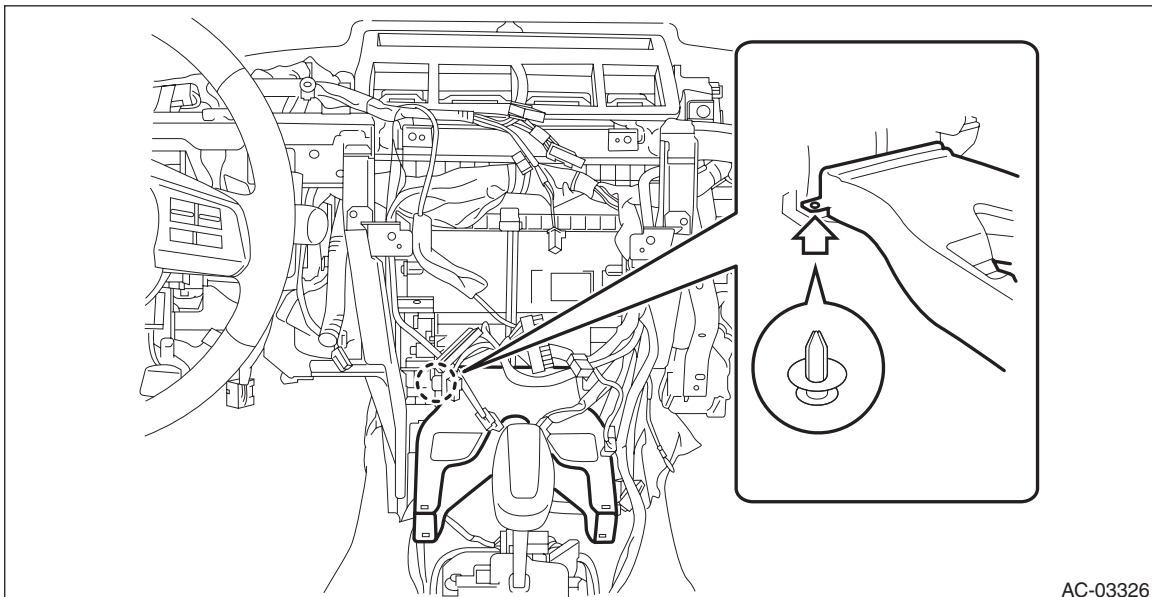

## Heater Duct

HVAC SYSTEM (HEATER, VENTILATOR AND A/C)

---

### 3. CENTER CONSOLE DUCT

- 1) Remove the console box. <Ref. to EI-72, REMOVAL, Console Box.>
- 2) Remove the screws, and remove the center console duct.

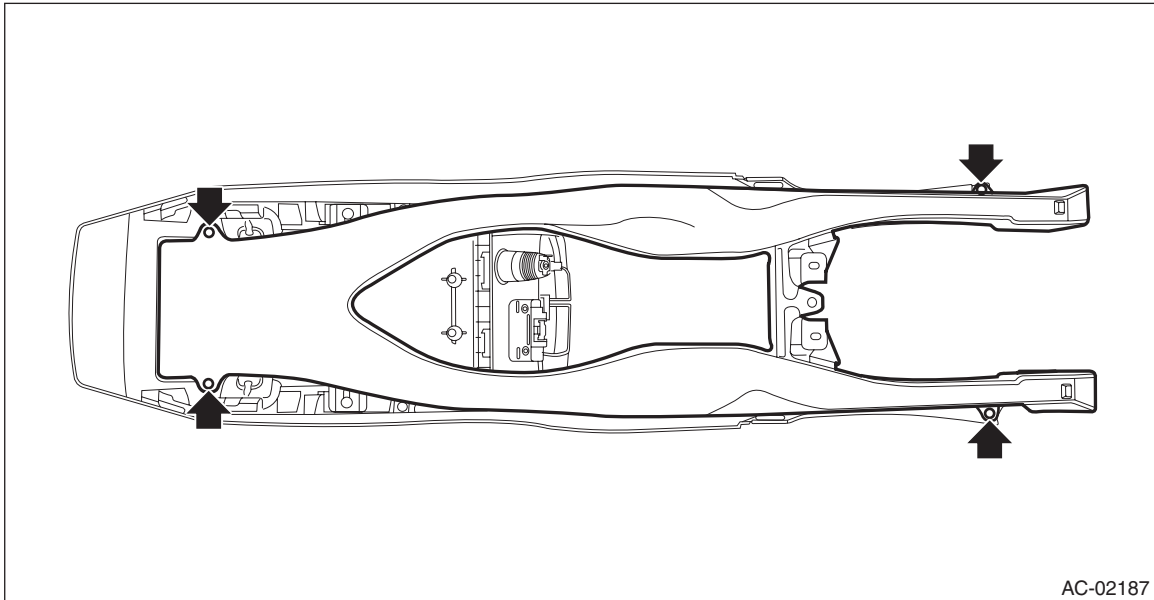

AC-02187

### B: INSTALLATION

Install each part in the reverse order of removal.

#### NOTE:

Refer to "INSTALLATION" of the following parts.

- Front seat (when removing rear heater duct): <Ref. to SE-11, INSTALLATION, Front Seat.>
- Instrument panel assembly (when removing console front duct and rear heater duct): <Ref. to EI-96, INSTALLATION, Instrument Panel Assembly.>
- Console box (when removing center console duct): <Ref. to EI-74, INSTALLATION, Console Box.>

### C: INSPECTION

- 1) Check installation condition of duct. Connect the duct properly if defective.
- 2) Check that no foreign matter is mixed in the duct. Remove the foreign matter if any.