

General Description

INTAKE (INDUCTION)

1. General Description

A: COMPONENT

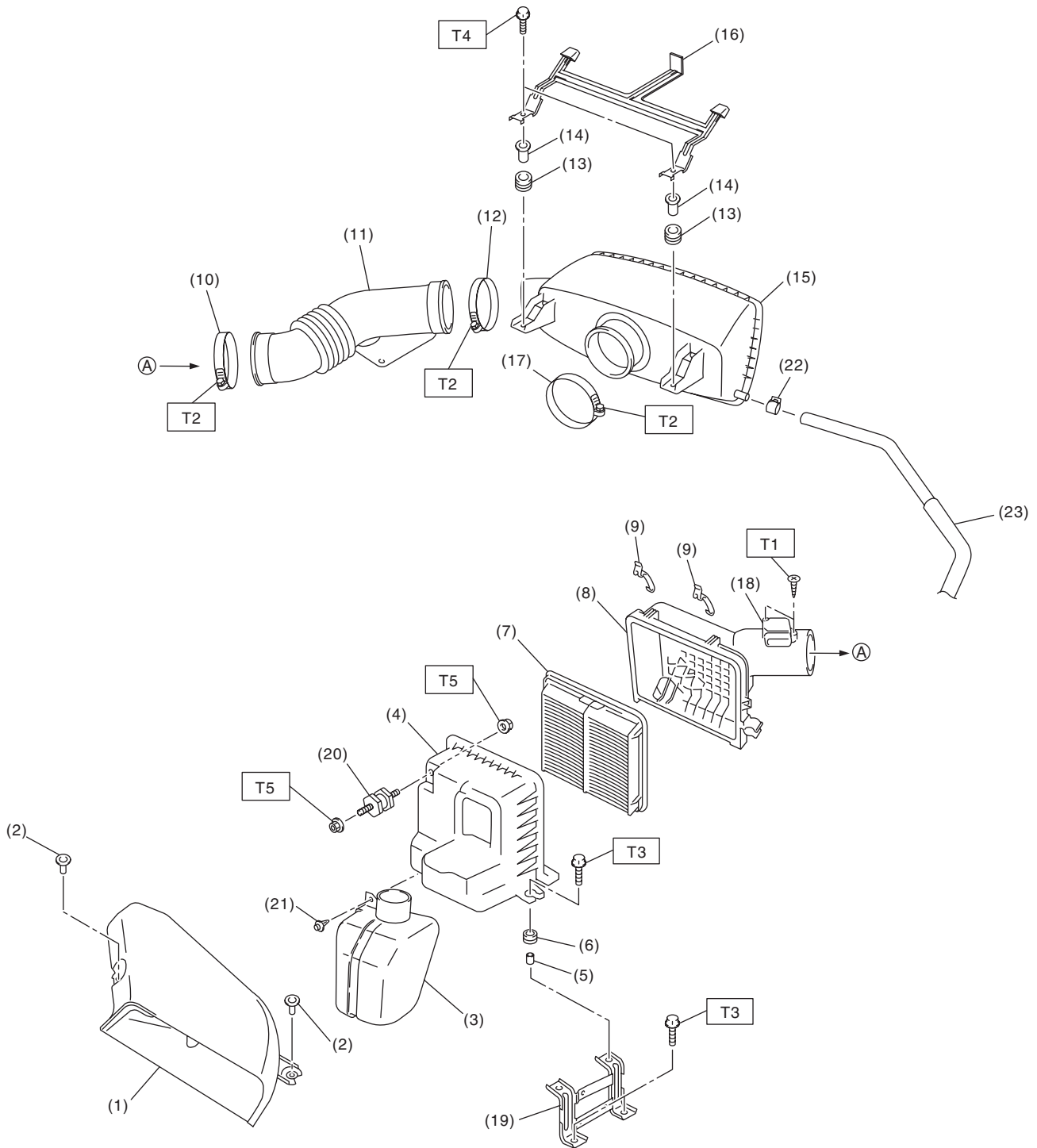

IN-03136

General Description

INTAKE (INDUCTION)

| | | |
|------------------------------|--|--|
| (1) Air intake duct | (11) Intake boot | (21) Clip |
| (2) Clip | (12) Clamp | (22) Clip |
| (3) Resonator chamber | (13) Cushion | (23) Blow-by hose |
| (4) Air cleaner case (front) | (14) Spacer | |
| (5) Spacer | (15) Air intake chamber | Tightening torque: N·m (kgf·m, ft·lb) |
| (6) Cushion | (16) Collector cover bracket | T1: 1 (0.1, 0.7) |
| (7) Air cleaner element | (17) Clamp | T2: 3 (0.3, 2.2) |
| (8) Air cleaner case (rear) | (18) Mass air flow and intake air temperature sensor | T3: 6 (0.6, 4.4) |
| (9) Clip | (19) Air cleaner bracket | T4: 6.5 (0.7, 4.8) |
| (10) Clamp | (20) Cushion | T5: 7.5 (0.8, 5.5) |

B: CAUTION

- Prior to starting work, pay special attention to the following:
 1. Always wear work clothes, a safety cap, protective shoes. Additionally, wear a helmet, protective goggles, etc. if necessary.
 2. Protect the vehicle using a seat cover, fender cover, etc.
 3. Prepare the service tools, clean cloth, containers to catch grease and oil, etc.
- Vehicle components are extremely hot immediately after driving. Be wary of receiving burns from heated parts.
- When performing a repair, identify the cause of trouble and avoid unnecessary removal, disassembly and replacement.
- Before disconnecting connectors of sensors or units, be sure to disconnect the ground cable from battery.
- Always use the jack-up point when the shop jacks or rigid racks are used to support the vehicle.
- Remove contamination including dirt and corrosion before removal, installation, disassembly or assembly.
- Keep the removed parts in order and protect them from dust and dirt.
- All removed parts, if to be reused, should be reinstalled in the original positions with attention to the correct directions, etc.
- Bolts, nuts and washers should be replaced with new parts as required.
- Be sure to tighten the fasteners including bolts and nuts to the specified torque.