

# Cam Sprocket

MECHANICAL

## 16. Cam Sprocket

### A: REMOVAL

- 1) Remove the V-belts. <Ref. to ME(H6DO)-46, REMOVAL, V-belt.>
- 2) Remove the crank pulley. <Ref. to ME(H6DO)-47, REMOVAL, Crank Pulley.>
- 3) Remove the chain cover. <Ref. to ME(H6DO)-48, REMOVAL, Chain Cover.>
- 4) Remove the timing chain assembly. <Ref. to ME(H6DO)-55, REMOVAL, Timing Chain Assembly.>
- 5) Remove the cam sprocket. To lock the camshaft, use the ST.

ST 499977500 CAM SPROCKET WRENCH

- IN side

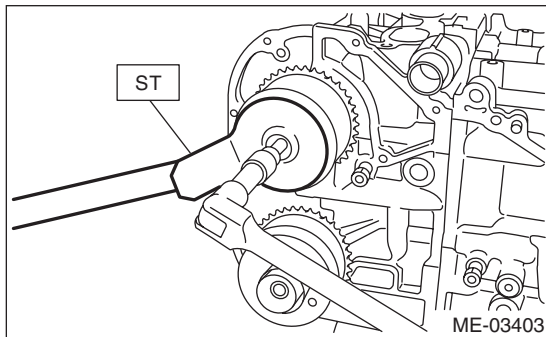

- EX side

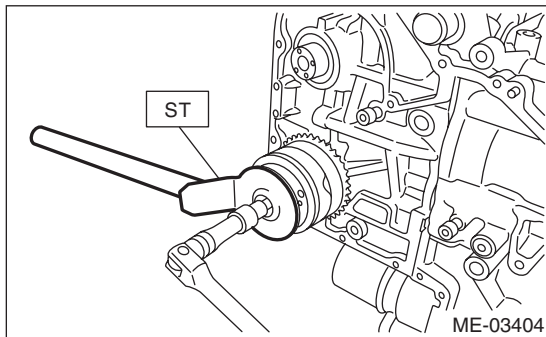

### B: INSTALLATION

- 1) Install the cam sprocket. To lock the camshaft, use the ST.

#### Tightening torque:

**29.5 N·m (3.0 kgf-m, 21.8 ft-lb)**

- 2) Further tighten the bolt.

#### Tightening angle:

**45° ± 5°**

ST 499977500 CAM SPROCKET WRENCH

- IN side

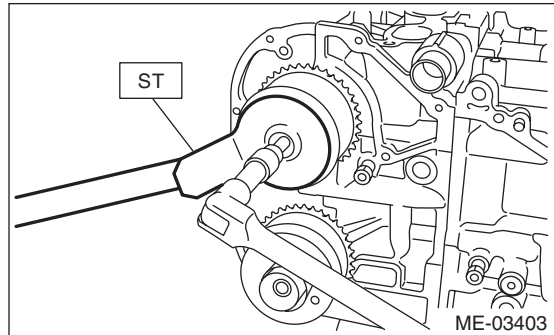

- EX side

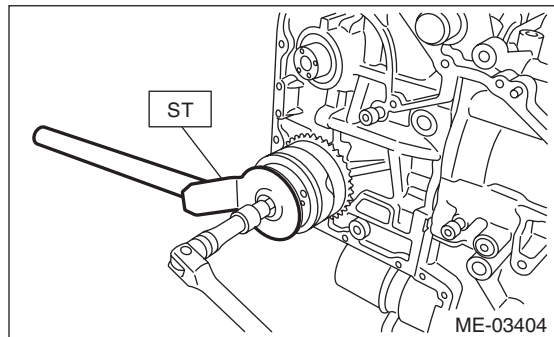

- 3) Install the timing chain assembly. <Ref. to ME(H6DO)-61, INSTALLATION, Timing Chain Assembly.>

- 4) Install the chain cover. <Ref. to ME(H6DO)-50, INSTALLATION, Chain Cover.>

- 5) Install the crank pulley. <Ref. to ME(H6DO)-47, INSTALLATION, Crank Pulley.>

- 6) Install the V-belts. <Ref. to ME(H6DO)-46, INSTALLATION, V-belt.>

### C: INSPECTION

- 1) Check the cam sprocket teeth for abnormal wear and scratches.
- 2) Make sure there is no free play between cam sprocket and key.